

illustrated

Spare Parts List



TYPE 225-2

Mark 4T, 4T/SK & 4T/SRK

TWIN-CYLINDER, TWO-STROKE

ROAD-VEHICLE ENGINES

Price :
TWO SHILLINGS & SIXPENCE

MAY, 1964

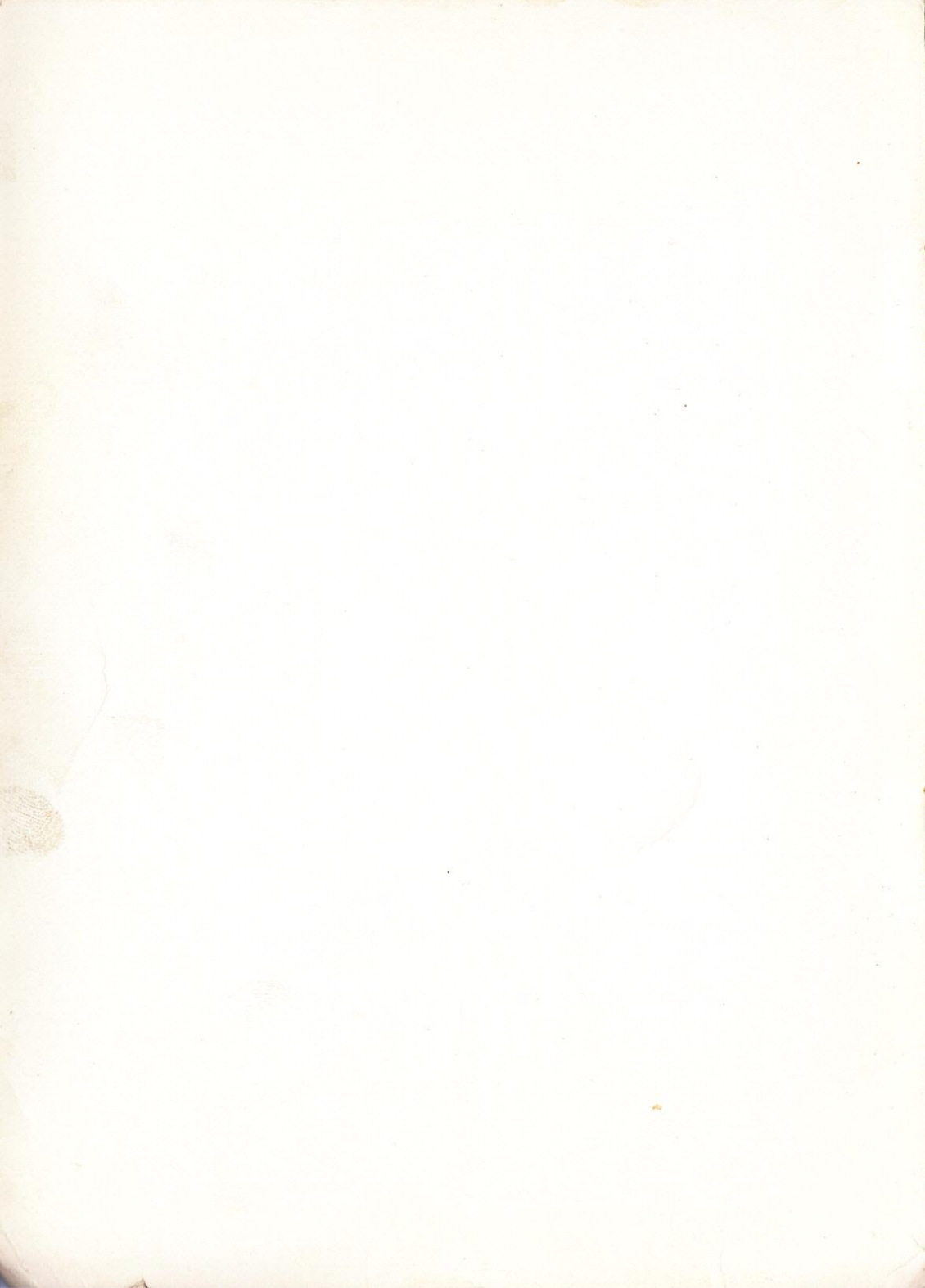

Spare-Parts List



TYPE 225-2

Mark 4T, 4T/SK & 4T/SRK

TWIN-CYLINDER

TWO-STROKE

ROAD-VEHICLE
ENGINES

Issued by

THE VILLIERS ENGINEERING COMPANY LTD.

Marston Road, Wolverhampton, England.

Telephone : 22399 (20 lines). Telegrams : Villiers, Wolverhampton

TECHNICAL DATA

Bore	50 mm.—1.95 in.
Stroke	63.5 mm.—2.48 in.
Capacity	249 c.c.—15.2 cu in.
Compression ratio	8.75
Engine sprocket, $\frac{3}{8}$ in. pitch:	Mark 4T	20T.
	Mark 4T/SRK	25T.
Clutch sprocket, $\frac{3}{8}$ in. pitch	43T.
Primary-drive ratio:	Mark 4T	2.15 : 1
	Mark 4T/SRK	1.72 : 1
Gearbox ratios:						
	Mark 4T standard:	3.06, 1.9, 1.325, 1 : 1
	Mark 4T/SRK	4.0, 2.24, 1.556, 1 : 1
Final-drive sprocket:						
	Mark 4T: $\frac{1}{2}$ in. pitch	×	.305 in. wide	18T.
	Mark 4T/SRK: $\frac{1}{2}$ in. pitch	×	.295 in. wide	17T.
Carburettor	Villiers Type S.25/6
Sparking plugs	Lodge H.H.14., Champion L.7
Plug gap018 in./0.025 in.
Ignition timing	$\frac{3}{2}$ in. before top dead centre
Contact-breaker point gap:	Mark 4T012 in./0.015 in.
	Mark 4T/SRK020 in./0.022 in.

AFTER-SALES SERVICE

Technical advice relating to the engines can be obtained from Villiers Technical Advisory Bureau at Wolverhampton, but all other questions involving after-sales service must be directed to an authorised dealer of Villiers-engined vehicles. Replacement parts can be obtained through any Villiers-spares stockist. In case of difficulty, an owner should communicate with the manufacturer of his machine.

In all matters relating to the engine, the engine type, together with the specification and serial numbers must be given in full. The numbers are stamped on a plate riveted to the inner chaincase.

WORKSHOP MANUAL

Owners who wish to carry out overhauls which involve dismantling the engine can obtain a comprehensive workshop manual, price 8s. 6d., post free, from the Technical Publications Department, The Villiers Engineering Co. Ltd., Wolverhampton, or from any Villiers-spares stockist.

Owners who have not the facilities for undertaking major overhauls are advised to have the work done by a qualified Villiers-engine service dealer.

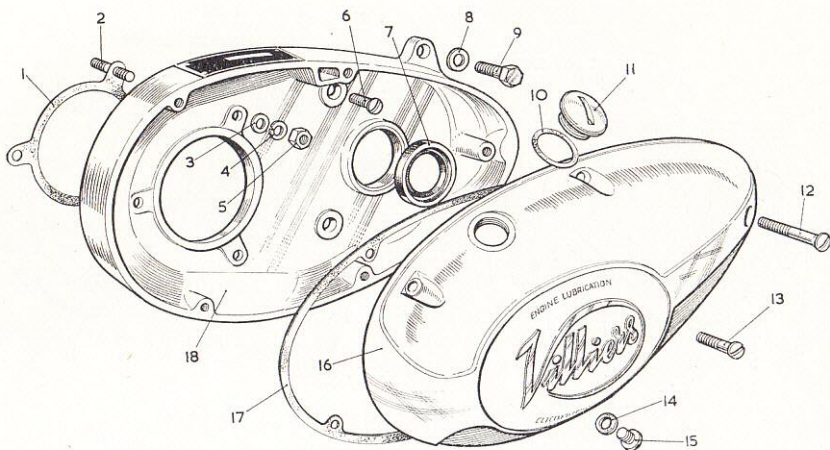

Chaincase assembly

CHAINCASE

Illus. No.	Part No.	DESCRIPTION
1	D.9057	Chaincase/crankcase gasket
2	E.5146	Chaincase fixing stud (3)
3	E.2924	Chaincase fixing-stud washer (3)
4	E.1430	Chaincase fixing-stud spring washer (3)
5	E.401	Chaincase fixing nut (3)
6	E.8185	Chaincase fixing screw (2)
7	E.1042C	Chaincase oil seal
8	E.2667	Chaincase fixing-bolt washer
9	FG.153	Chaincase fixing bolt
10	E.8261	Chaincase filler washer
11	E.12241	Chaincase filler plug
12	E.7129	Chaincase-cover screw (2)
13	E.7326	Chaincase screw, short (4)
14	E.1905	Chaincase level-screw washer
or	V.1995E	Chaincase level-screw washer (4T/SRK)
15	E.8275	Chaincase level screw
or	E.8479	Chaincase level screw (4T/SRK)
16	C.10388	Chaincase, outer half
or	40576	Chaincase, outer half (4T/SRK)
17	C.8196	Chaincase gasket
18	A.8060/1	Chaincase, inner half

NOTE

Villiers components and sub-assemblies marked "4T/SRK" apply to all engines fitted with either reversible or uni-directional Siba Dynastart equipment.

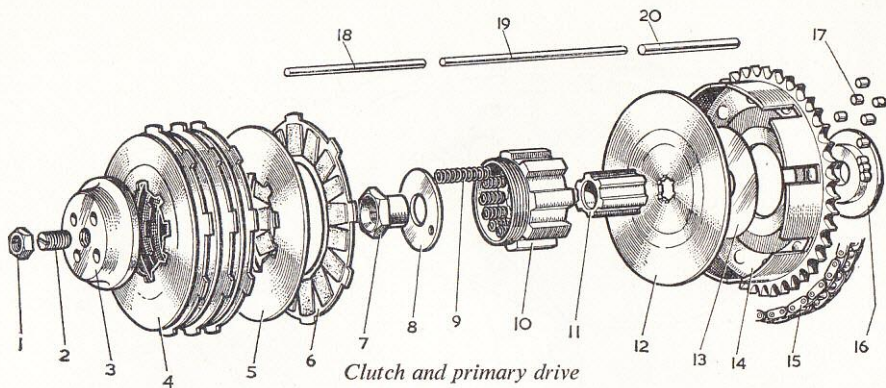

Clutch and primary drive

CLUTCH & PRIMARY-DRIVE

Illus. No.	Part No.	DESCRIPTION
1	E.8473	Clutch-adjuster locknut, internal
2	E.8472	Clutch-adjuster screw, internal
3	E.11029	Clutch-cap nut
4	D.8463	Clutch pressure plate
or	28261	Clutch pressure plate (4T/SRK)
5	D.8462	Clutch plate, intermediate (3)
or	28548	Clutch plate, intermediate (3)—4T/SRK
6	E.8349/2	Clutch plate, driving (4)
or	E.11919	Clutch plate, driving (4)—4T/SRK
7	E.10014	Clutch chainwheel centre nut
or	E.8356	Clutch chainwheel centre nut (4T/SRK)
8	E.10015	Clutch washer
9	E.9989	Clutch springs (9)
or	27888	Clutch spring, large (4T/SRK)
—	27889	Clutch spring, small (4T/SRK)
10	E.9988/1	Clutch sliding sleeve
or	25954	Clutch sliding sleeve (4T/SRK)
11	E.8354	Clutch hub
12	D.8459	Clutch backplate
13	E.9645	Clutch-backplate shim
14	E.8347	Clutch-chainwheel assembly
15	Renold 110038	Clutch primary chain (60 pitches)
or	Renold 110038	Clutch primary chain (62 pitches)—4T/SRK
16	E.8216/2	Clutch-chainwheel centre
17	E.9777	Clutch rollers (25)
18	E.8236	Clutch push rod
19	E.11024	Clutch push rod
20	E.11023	Clutch push rod
—	E.11019	Packing piece, sliding sleeve (as reqd.)
or	E.11020	Packing piece, sliding sleeve (as reqd.)

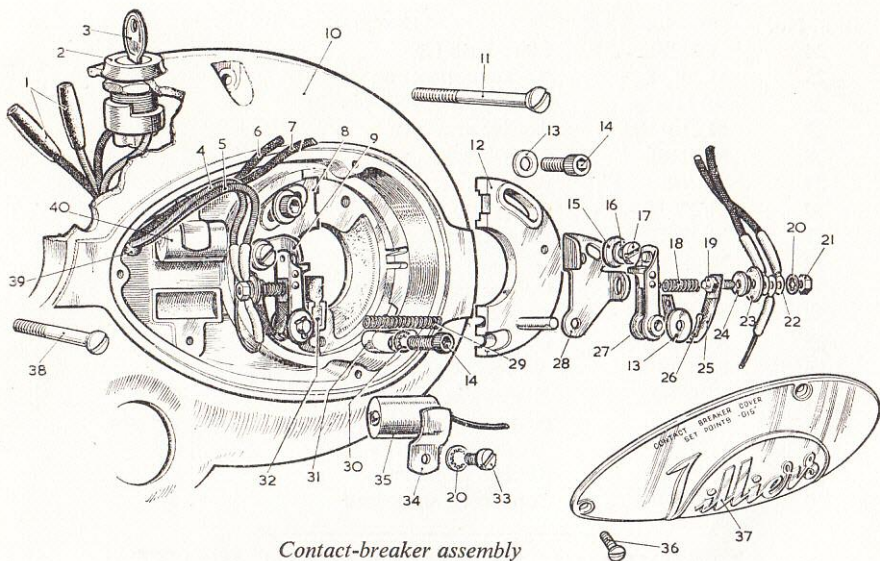

Contact-breaker assembly

CONTACT-BREAKER ASSEMBLY

Illus. No.	Part No.	DESCRIPTION
1	M.2857E	Connector, L.T. lead (2)
2	M.2740E	Ignition switch
3	Quote Engine No.	Ignition key (two per set)
4	M.2891E	Rocker lead, left-hand switch (green)
5	M.2891E/1	Rocker lead, left-hand connector (green)
6	M.2891E/2	Rocker lead, right-hand switch (blue)
7	M.2891E/3	Rocker lead, right-hand connector (blue)
8	M.2795D	Contact-breaker base plate, left-hand
9	M.2293E	Point bracket, left-hand
10	A.10179	Right-hand cover
11	E.7916	Right-hand-cover screw (2)
12	M.2794D	Contact-breaker base plate, right-hand
13	E.5257	Washer (4)
14	E.10418	Base-plate fixing screw (3)
15	M.1802E	Brass washer (2)
16	1113 x 5E	Point-bracket-screw washer (2)
17	M.1801E	Point-bracket lock screw (2)
18	1047 x 3E	Rocker spring (2)
19	M.2120E	Point-bracket pin (2)
20	M.2714E	Shakeproof washer (4)
21	1113 x 4E	4.B.A. nut (2)
22	M.2911E	Shoe, L.T. and condenser leads (6)
23	M.1805E	Fibre washer (2)

Illus. No.	Part No.	DESCRIPTION
24	M.2138E	Fibre bush (2)
25	M.2365E	Rocker connecting strip (2)
26	V.111 x 2E	Rocker-pivot split pin (2)
27	M.2141D/1	Rocker arms (2)
28	M.2118E	Point bracket, right-hand
29	V.369E	Base-plate spring
30	M.2707E	Base-plate shakeproof washer
31	M.2797E	Base-plate clamp
32	M.2859E	Oil pad
33	V.1304E	Condenser-clip screw (2)
34	M.2342/1E	Condenser clip (2)
35	M.2593E	Condenser, long lead
36	E.9570	Nameplate screw, right-hand cover (3)
37	B.10180	Nameplate, right-hand cover
or	60348	Nameplate, right-hand cover—Villiers-Enfield
38	E.7129	Right-hand-cover screw
39	M.2788E	Rubber grommet
40	M.2143/2E	Condenser, short lead

FLYWHEEL & ARMATURE PLATE

Illus. No.	Part No.	DESCRIPTION
1	A.151	Armature-plate assembly with coils, cables and 5-pin socket
2	A.28863	Lighting coil (1 pr.)
3	M.2707E	Shakeproof washer
4	M.2811E	Coil fixing screw (8)
5	E.9713	Armature-plate oil seal
6	A.29021	Energising coil

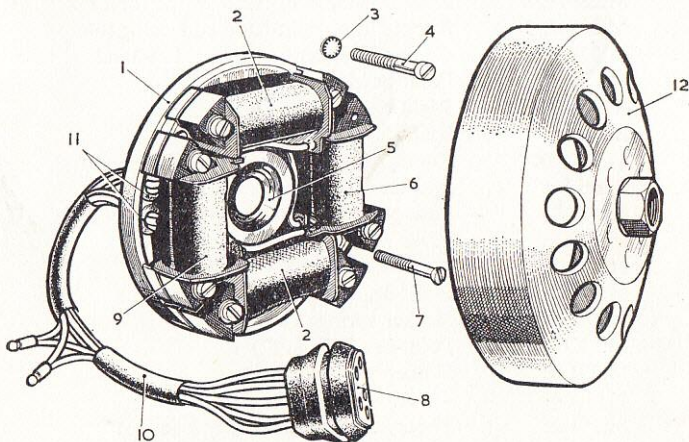

Flywheel and armature-plate assembly

Illus. No.	Part No.	DESCRIPTION
7	M.1702E	Armature-plate screw (4)
8	M.2798D/1	5-way connector with pins
9	A.29019	Energising coil
10	A.40666	Harness complete (less connector)
11	M.2788E	Armature-plate grommet (2)
12	R.138	Flywheel rotor complete
—	A.28853	External ignition coil (2)
—	Quote Engine No.	H.T. lead (2)
—	M.2490E	Waterproof cover and suppressor

MARK 4T/SRK RIGHT-HAND COVER

Illus. No.	Part No.	DESCRIPTION
1	E.401	Nut (5)
2	2539	Nut (2)
3	E.11030	Rubber washer (4)
4	E.4011	Stud (3)
5	D.10105	Coil bracket
6	29144	Locknut (2)
7	27758	Washer, small (2)
8	29142	Grommet (2)
9	29143	Washer, large (4)
10	28845	Bolt (2)

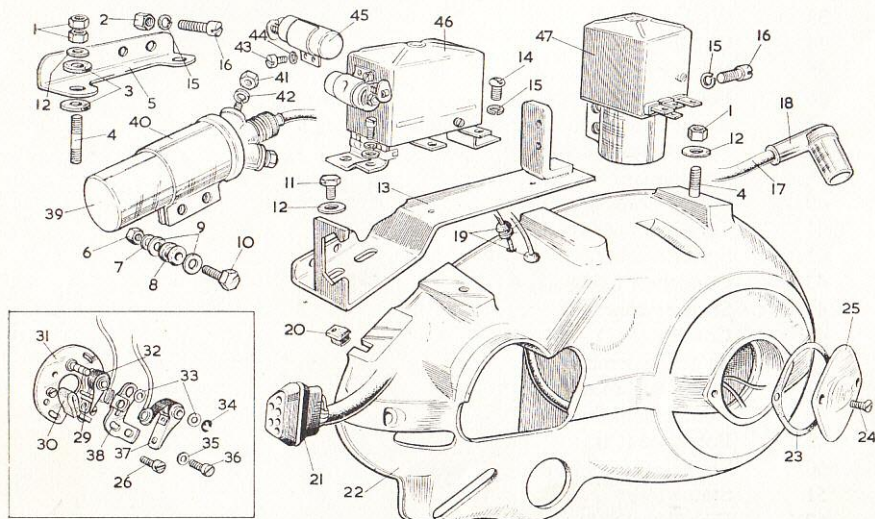

Right-hand cover for Mark 4T/SRK engine

Illus. No.	Part No.	DESCRIPTION
11	26378	Bracket bolt
12	E.9486	Washer (4)
13	C.10317	Bracket
14	M.2562E	Regulator-box screw (2)
15	E.1430	Spring washer (6)
16	E.478	Screw (4)
17	Quote Engine No.	H.T. lead (2)
18	M.2490E	Waterproof cover and suppressor (2)
19	M.2736E	Grommet (2)
20	M.2782E	Indicator-cable grommet
21	M.2793/1D	Connector (6-way)
22	80304	Cover, right-hand
23	E.9564/1	Cover joint washer
24	E.9570	Cover screw (2)
25	D.9563/1	Contact-breaker cover
26	M.2739E	Contact-breaker fixing screw (2)
27	25172	Stator-fixing washer (3)—4T/SRK
28	E.10008	Stator fixing screw (3)—4T/SRK

SIBA DYNASTART PARTS FOR MARK 4T/SRK ENGINE

For part numbers see Siba Dynastart Spares List

Illus. No.	DESCRIPTION
29	Point bracket, right-hand
30	Oiling pad
31	Base plate with pins
32	Rocker arm with cable, right-hand
33	Washer (4)
34	Circlip (2)
35	Washer (2)
36	Point-bracket screw (2)
37	Rocker arm with cable, left-hand
38	Point bracket, left-hand
39	Ignition coil (2)
40	Support bracket (3)
41	Terminal nut (4)
42	Spring washer (4)
43	Condenser fixing screw (2)
44	Spring washer (2)
45	Condenser (2)
46	Switch, assembly-box
47	Reversing solenoid
48	Countersunk screw (12)
49	Pole-shoe (12)
50	Shunt or series windings (1 set)
51	Stator
52	Fibre sheath (8)
53	Fibre insert (8)

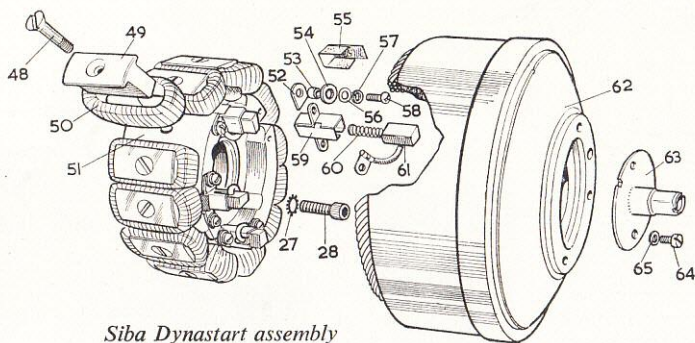

Siba Dynastart assembly

Illus. No.	DESCRIPTION
54	Fibre washer (8)
55	Insulating sheath (4)
56	Steel washer (8)
57	Spring washer (8)
58	Screw (8)
59	Brush holder (4)
60	Spring (4)
61	Carbon brush (4)
62	Armature
63	Cam
64	Screw (2)
65	Spring washer (2)

CYLINDER AND PISTON

Illus. No.	Part No.	DESCRIPTION
1	60243	Cylinder head, right-hand
2	C.9899	Cylinder-head gasket (2)
3	60244	Cylinder head, left-hand
4	E.9985	Cylinder fixing-nut washer (8)
5	E.9983	Cylinder-fixing nuts (8)
6	80256	Cylinder, right-hand
7	27447	Exhaust-pipe ring (2)
8	E.5578	Exhaust-pipe washer (2)
9	E.9984	Cylinder fixing stud (8)
10	80255	Cylinder, left-hand
11	D.9973	Cylinder-base gasket (2)
12	C.9733	Cylinder-base joint plate
13	28242	Piston complete (2)
or	29305	Piston complete, .020" O/S.
or	29306	Piston complete, .040" O/S.
14	60303	Piston
or	60360	Piston, .020" O/S.
or	60361	Piston, .040" O/S.

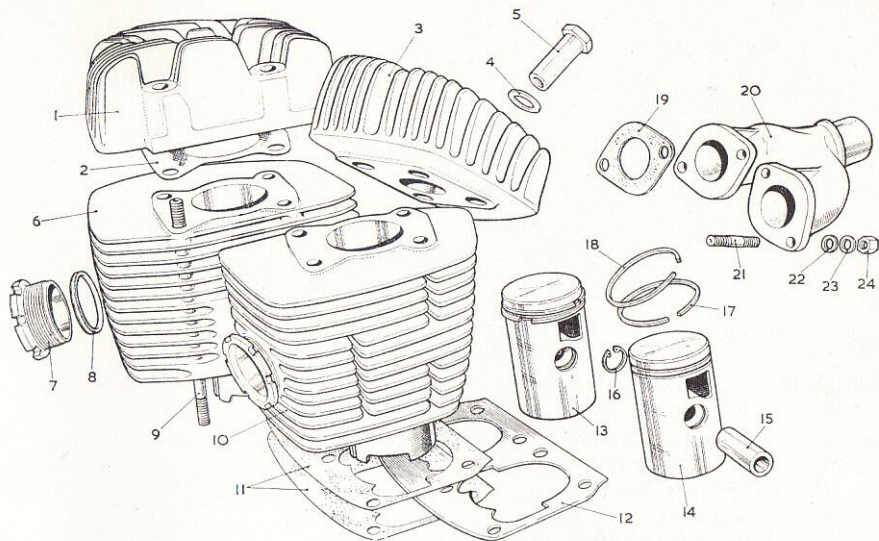

Cylinder and piston assembly

Illus. No.	Part No.	DESCRIPTION
15	28238	Gudgeon pin
16	28241	Circlip (4)
17	28240	Piston ring, lower (2)
or	29302	Piston ring, lower .020" O/S.
or	29304	Piston ring, lower .040" O/S.
18	28239	Piston ring, upper (2)
or	29301	Piston ring, upper .020" O/S.
or	29303	Piston ring, upper .040" O/S.
19	28210	Inlet-pipe joint washer (2)
20	40555	Inlet pipe
21	E.4011	Inlet-pipe stud (4)
22	E.10104/1	Inlet-pipe stud insulation washer (4)
23	E.2924	Inlet-pipe fixing washer (4)
24	E.401	Inlet-pipe fixing nut (4)

CRANKCASE

Illus. No.	Part No.	DESCRIPTION
1	E.9618	Crankcase pinch bolt
2	E.2924	Crankcase pinch-bolt washer
3	EG.532	Crankcase pinch-bolt trunnion
4 & 8	A.8370/A.8371	Crankcase, left and right-hand (pair)
or	80361/40511	Crankcase, left and right-hand (pair)—4T/SRK
5	E.1905	Crankcase-drain and level-screw washer (2)
6	E.1962	Crankcase-drain and level screw (2)

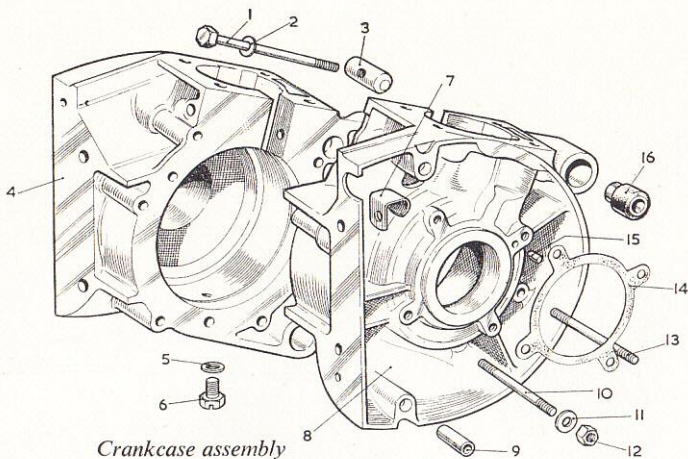

Crankcase assembly

Illus. No.	Part No.	DESCRIPTION
7	M.2800E	Cable clip
9	E.8250	Crankcase dowel, right-hand (2)
10	E.8199	Crankcase fitting stud (2)
11	E.2924	Crankcase washer (12)
12	E.2539	Crankcase nut (12)
13	E.8183	Crankcase fixing stud (4)
14	E.8928	Armature-plate joint washer
15	E.8015	Armature-plate dowel
16	E.10287	Crankcase-mounting bush (4)

DRIVESHAFT

Illus. No.	Part No.	DESCRIPTION
1	E.8361	Engine sprocket (20T)
or	E.11756	Engine sprocket (25T)—4T/SRK
2	E.5706	Driving-shaft spring washer
3	E.3931	Driving-shaft nut
4	E.4150	Engine shim (as reqd.)
5	E.9310	Engine distance piece
6	A.3235	Crankcase oil seal
7	—	Driving-shaft ball bearing, 25 x 52 x 15 mm
8	E.10419	Driving-shaft-bearing circlip (Seegar)
9	E.5581	Engine key (2)
10	C.9893	Driving shaft, left-hand
11	C.9895	Driving-shaft centre wheel (2)
12	E.7189	Driving-shaft-bearing circlip (3)
or	E.7189	Driving-shaft-bearing circlip (5)—4T/SRK
13	—	Driving-shaft roller bearing, 25 x 52 x 15 mm (2)
or	R.320	Driving-shaft roller bearing (4T/SRK)

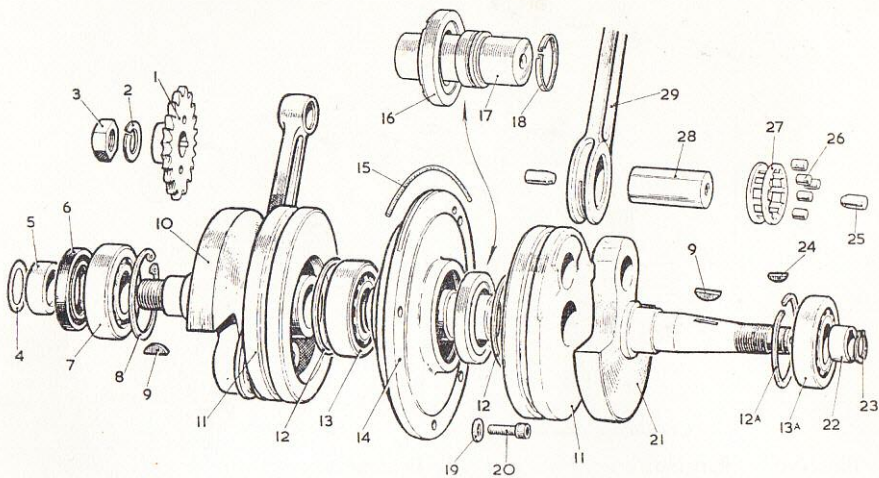

Driveshaft assembly

Illus. No.	Part No.	DESCRIPTION
—	28266	Bearing spacer (4T/SRK)
14	40512	Crankcase centre plate
15	28227	Crankcase centre-plate sealing rubber
16	28213	Crankcase centre-plate adaptor
17	28212	Driving-shaft centre
18	28528	Crankcase centre-plate sealing ring
19	V.157 x 2E	Crankcase centre-plate washer (3)
20	E.10008	Crankcase centre-plate screw (3)
21	C.9892	Driving shaft, right-hand
22	M.2277/1E	Cam, ignition
23	E.9732	Circlip
24	M.2333E	Key, ignition cam
25	E.5593	Crankpin plugs (4)
26	E.10658	Crankpin rollers (18)
27	E.10383	Big-end cage (2)
28	E.8400	Crankpin (2)
29	A.28248	Connecting rods (2)
—	E.9688	Driving-shaft nut, right-hand (4T/SRK)

With the exception of illustration Nos. 1—9, 12A, 13A, 15, 19, 20, 22—24, the driveshaft can only be supplied as a complete assembly.

ALWAYS USE GENUINE



REPLACEMENT PARTS

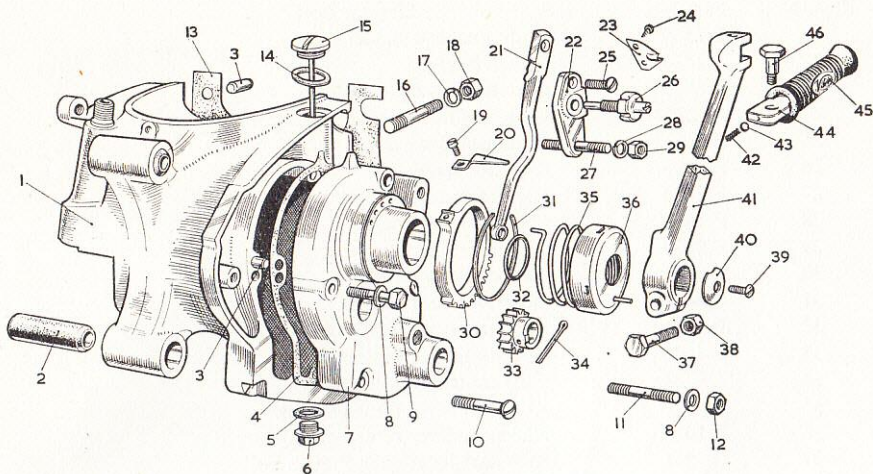

Gearbox shell and kickstart assembly

GEARBOX SHELL & KICKSTART UNIT

Illus. No.	Part No.	DESCRIPTION
1	C.10246	Gearbox
2	E.10458	Mounting-lug bush (2)
3	E.7619	Gearbox end-cover dowel (4)
4	D.8929	Gearbox end-cover gasket
5	V.107 x 3E	Gearbox end-cover drain-plug washer
6	E.6292/1	Gearbox end-cover drain plug
7	C.12316	Gearbox end cover
8	E.2924	Gearbox end-cover washer (4)
9	E.783	Gearbox end-cover bolt (2)
10	E.8187	Gearbox end-cover screw
11	25541	Gearbox end-cover stud (2)
12	E.401	Gearbox end-cover nut (2)
13	C.8927	Gasket (as required)
14	E.6593	Gearbox end-cover washer
15	E.8193/1	Dipstick and knob
or	E.9673	Dipstick and knob (4T/SRK)
16	E.2152	Gearbox/crankcase stud (4)
17	E.5808	Gearbox end-cover washer
—	E.1050	Gearbox end-cover washer (3)
18	E.3961	Gearbox end-cover nut (4)
19	V.1304E	Gear indicator-pointer screw
20	E.8422	Gear-indicator pointer
21	D.8436	Clutch lever
—	E.4900	Clutch-cable adjuster

Illus. No.	Part No.	DESCRIPTION
—	E.2539	Clutch cable-adjuster nut
22	E.8435	Clutch bridge
23	E.6829	Clutch-adjuster lockplate
24	M.2704E	Clutch adjuster lockplate screw (2)
25	EG.527	Clutch-bridge screw
26	E.8503	Adjuster screw
27	E.8624	Kickstart-stop stud
28	E.1430	Clutch-bridge washer
29	E.2539	Clutch-bridge nut
30	E.8421	Gear-indicator ring
31	E.8424	Gear-indicator circlip
32	E.9721	Kickstart-shaft "O" ring
33	E.8423	Gear-indicator pinion
34	E.9734	Gear-indicator split pin
35	E.8175	Kickstart lever-return spring
36	E.10123	Kickstart-lever return-spring cover
37	E.5251	Kickstart-lever gear-change bolt
38	E.4252	Kickstart-lever gear-change nut
39	E.8479	Kickstart end-cover screw
—	E.8265	Kickstart end cover
40	E.9596	Kickstart-shaft washer (4T/SRK)
41	D.10234	Kickstart lever
42	E.4270	Kickstart-pedal spring
43	E.9776	Kickstart-pedal ball
44	E.4096	Kickstart pedal
45	E.8467	Kickstart-lever rubber
46	E.4098	Kickstart pedal-pivot pin

On some engines, Illus. Nos. 41 and 44 are replaced by:—
D.12068—Kickstart lever, and E.11751—Pedal.

MARK 4T/SRK GEARBOX END-COVER

Illus. No.	Part No.	DESCRIPTION
1	E.11484	Clutch bridge
2	E.1430	Washer
3	E.5908	Bolt
4	25566	Adjuster screw
5	E.2539	Locknut
6	E.4008	Stud
7	25462	Circlip
8	25459	Collar
9	27179	Thrust race (2)
10	27180	Thrust bearing
11	25460	Housing
12	M.3186E	Screw (3)
13	V.136 x 6E	Spring

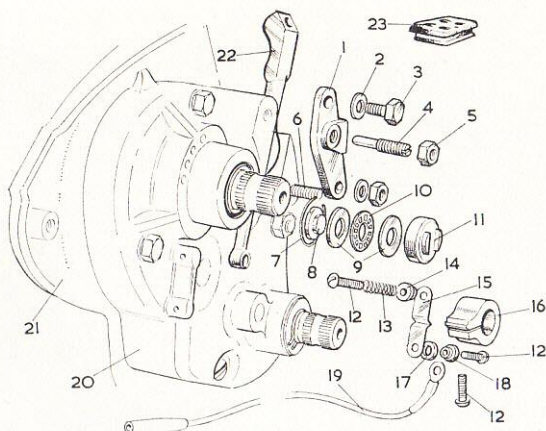

Gearbox end-cover assembly for Mark 4T/SRK engine

Illus. No.	Part No.	DESCRIPTION
14	28194	Insulator
15	28038	Contact
16	28039	Cam
17	M.2986E	Washer
18	1013 x 13E	Bush
19	29421	Cable (8") assembly
20	60277	Gearbox end cover
21	80307	Gearbox
22	27980	Lever
23	M.2777E	Grommet
or	M.2806E	Grommet (fitted instead of M.2777E on uni-directional Siba engines).

GEAR-CHANGE MECHANISM

Illus. No.	Part No.	DESCRIPTION
1	E.8537	Cam-barrel-plunger end plug
2	E.8783	Cam-barrel-plunger spring
3	E.8540	Cam-barrel-plunger bush
4	E.8539	Cam-barrel plunger
5	E.8097	Cam-barrel thrust washer
6	E.8096	Cam-barrel-bearing pin
7	C.8089	Cam barrel
—	E.9451	Cam-barrel stop peg
8	E.10716	Sliding-gear forks (2)
9	E.8393	Sliding-gear guide split pin (2)
10	25653	Sliding-gear guide peg (2)
11	E.8155	Cam-barrel thrust washer (2)
12	E.9777	Cam-barrel roller (24)

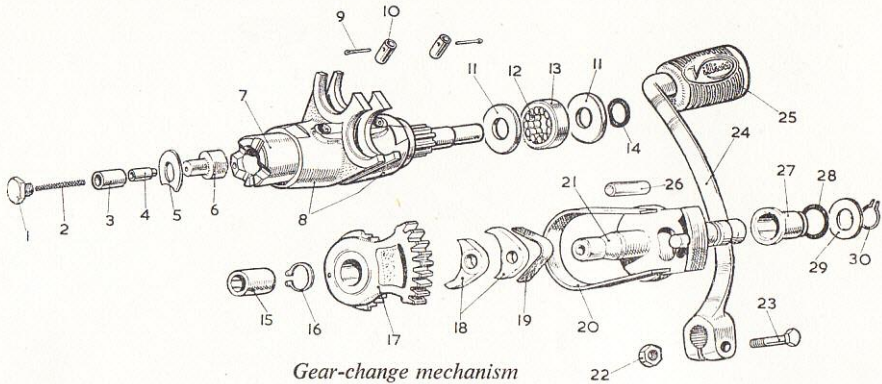

Gear-change mechanism

Illus. No.	Part No.	DESCRIPTION
13	E.8154	Cam-barrel-bearing outer race
14	E.9257	Cam-barrel "O" ring
15	E.6595	Gearbox bush (only supplied with C.10246)
16	25184	Gear-change-spindle circlip
17	26659	Ratchet assembly
18	25743	Gear-control pawl (2)
19	E.11886	Gear-control-pawl spring
20	E.11875	Gear-control spring
21	D.11884	Gear-change-spindle assembly
22	E.4252	Gear-change-lever nut
23	E.4251	Gear-change-lever bolt
24	D.9175	Gear-change lever
or	D.9798/1	Gear-change lever (4T/SRK)
25	D.6861	Gear-change rubber
26	E.11876	Gear-control stop pin (only supplied with C.12316)
27	E.11877	Spindle bush (only supplied with C.12316)
28	E.8776	Gear-change "O" ring
29	E.4150	Gear-change-spindle washer
30	E.6552	Gear-change-spindle circlip

On some engines, Illus. Nos. 22, 23 and 24 are replaced by:—
 E.364—Nut, E.11713—Bolt, E.1060—Washer and D.9199—Lever.

GEAR CLUSTER

Illus. No.	Part No.	DESCRIPTION
1	E.8161	Final-drive-sprocket nut
2	E.8162	Final-drive-sprocket lockwasher
3	E.9106	Final-drive-sprocket (18T)
or	E.8160	Final-drive-sprocket (17T)—4T/SRK
4	E.9729	Mainshaft oil seal
5	E.8153	Mainshaft-bearing thrust washer (2)
6	E.9731	Mainshaft rollers (38)

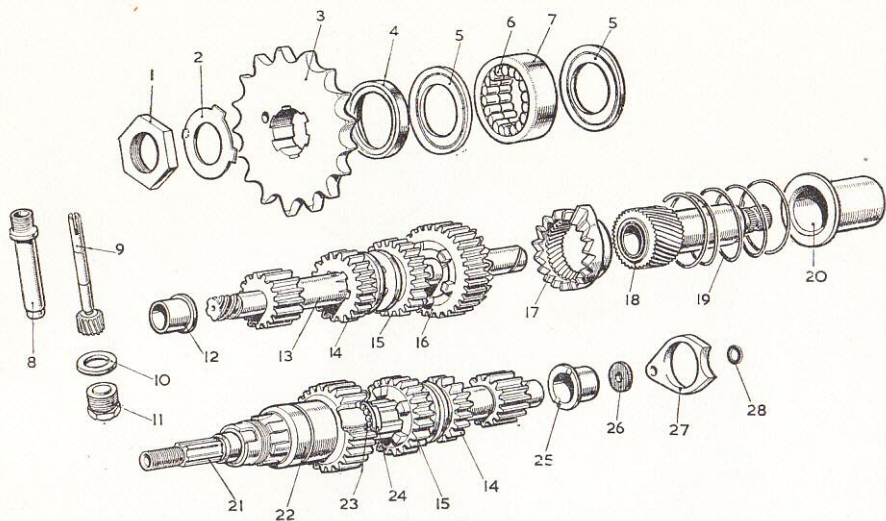

Gear cluster

Illus. No.	Part No.	DESCRIPTION
7	E.8152	Mainshaft-bearing outer race
8	E.8171	Speedometer-drive worm-wheel bush
9	E.8621	Speedometer-drive worm wheel
10	E.8195	Speedometer-drive housing-plug washer
11	E.8172	Speedometer-drive housing plug
12	E.8157	Layshaft bush (supplied only with C.10246)
13	C.12166	Layshaft
or	D.11015	Layshaft (4T/SRK)
14	D.12168	Sliding gear without dogs (2)
15	D.12167	Sliding gear with dogs (2)
16	D.12169	Kickstart-ratchet pinion
or	D.10599	Kickstart-ratchet pinion (4T/SRK)
17	D.8086	Kickstart ratchet
18	D.10112	Kickstart shaft
19	E.8177	Kickstart-ratchet spring
20	E.8159	Kickstart shaft-housing bush (only supplied with C.12316)
21	C.12171	Mainshaft
or	C.10600	Mainshaft (4T/SRK)
22	C.12170	High-gear pinion
or	E.11014	High-gear pinion (4T/SRK)
23	E.9775	High-gear ball thrust race (16)
24	E.8101	Mainshaft pressure washer
25	E.8158	Mainshaft bush (supplied only with C.12316)
26	E.11030	Mainshaft rubber washer
27	E.8100	Kickstart-ratchet stop
28	E.9789	Sealing washer

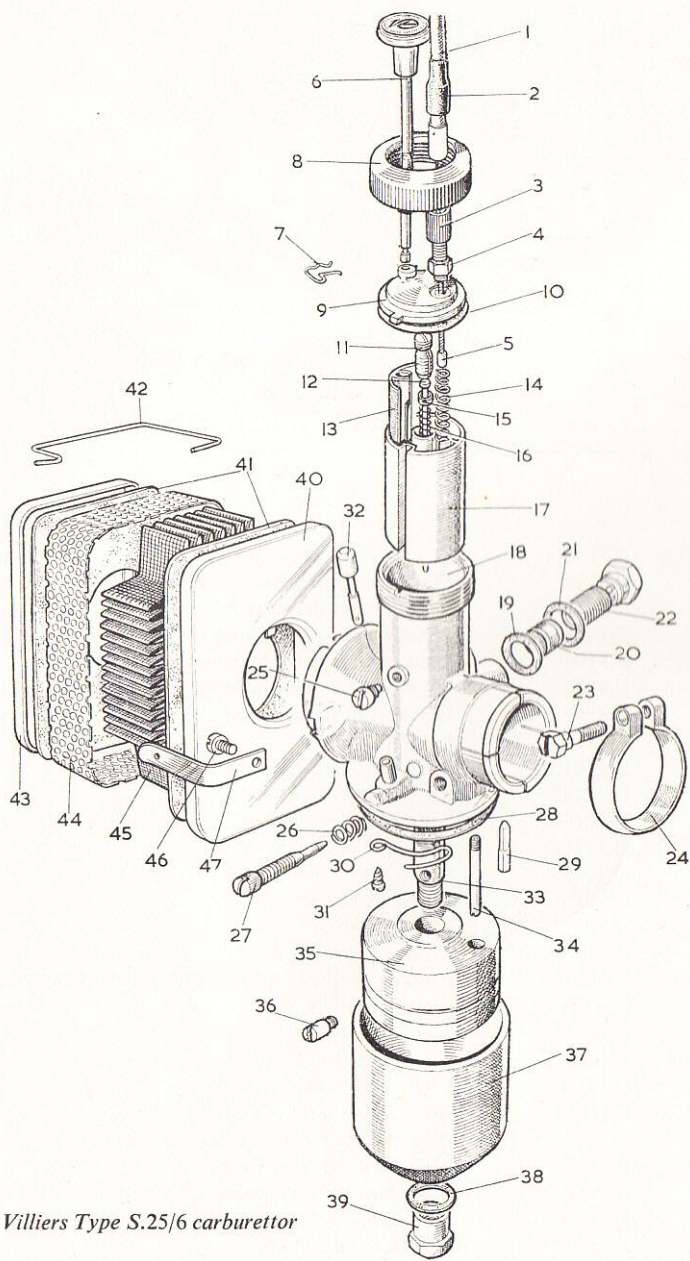

Villiers Type S.25/6 carburettor

CARBURETTOR, TYPE S.25/6

Illus. No.	Part No.	DESCRIPTION
1	Quote Engine No.	Throttle cable complete with adjuster and nipple
2	V.826E	Cable-adjuster cover
3	V.105 x 1E	Cable adjuster
4	V.105 x 2E	Cable-adjuster nut
5	V.108 x 15E	Cable nipple
6	V.1167E	Control knob and spindle
7	V.1178/1E	Spring clip
8	V.815E	Top ring
9	V.1161E	Top disc
or	V1952E	Top disc (4T/SRK)
10	V.828E	Top-disc washer
—	V.1951E	Strangler spindle (4T/SRK)
—	V.1950E	Cable stop (4T/SRK)
—	V.586E	Return spring (4T/SRK)
—	Quote Engine No.	Strangler cable (4T/SRK)
11	V.786E	Needle adjusting screw
12	V.748E	Needle No. 3½
13	V.958/1D	Strangler slide
14	V.107 x 8E	Throttle spring
15	V.787E	Needle collar
16	V.1235E	Needle spring
17	V.2024E	Throttle No. 3 cutaway
or	V.1308E	Throttle No. 3 cutaway (4T/SRK)
18	V.1437D	Carburettor body
or	28472	Carburettor body, 1" choke (4T/SRK)
19	V.383E	Banjo washer
20	V.404E	Banjo gauze
21	H.104 x 8E	Banjo washer
22	V.382E	Banjo bolt
23	V.754E	Carburettor body-clip screw
24	V.818E	Carburettor-body clip
25	V.829/1E	Throttle-guide screw
26	V.749E	Pilot-jet adjuster screw and needle spring
27	V.775E	Pilot-jet adjuster screw and needle
—	V.1948E	Stop screw (4T/SRK)
—	V.749E	Stop screw spring (4T/SRK)
28	V.125 x 8E	Float-cup washer
29	V.1284E	Fuel needle
30	V.830E	Tickler spring
31	M.2704E	Tickler-spring screw
32	V.742E	Tickler rod
33	V.827E	Centrepiece
34	V.717E	Pilot jet, 35 c.c.
35	V.1076E	Float
36	V.1716E	Main jet, 180 c.c.

Illus. No.	Part No.	DESCRIPTION
or	V.1717E	Main jet, 200 c.c. (4T/SRK)
37	V.773E	Float cup
38	V.107 x 3E	Bottom-nut washer
39	V.361E	Bottom nut
40	29054	End cover
41	29057	Sealing washer, felt (2)
42	29059	Clip, air-cleaner
43	29055	End cover
44	29056	Perforated strip
45	29053	Filter element
46	V.831E	Clip screw
47	29060	Spring clip
—	V.381E	Banjo union

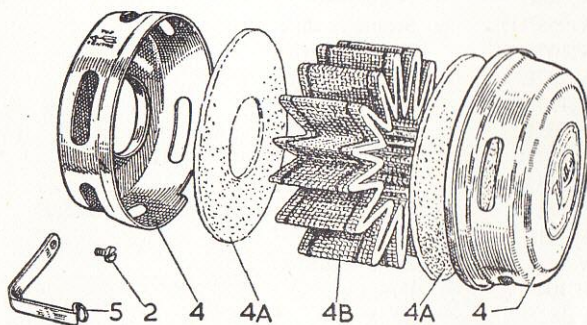

Villiers "1800" air cleaner

AIR CLEANER FOR 4T/SRK ENGINES

Illus. No.	Part No.	DESCRIPTION
2	V.831E	Filter-clip screw (2)
—	V.1800B	Air filter complete
4	V.1101/2D	Filter end caps (not supplied separately)
4A	V.1142E	Felt sealing washer (2)
4B	V.1821D	Star element
5	V.1134E	Clip for air filter (2)

GUARANTEE

We give the following guarantee with Villiers engines and accessories in place of any implied guarantee by statute or otherwise, all such guarantees being in all cases excluded. No statement or representation contained in this booklet shall be construed as enlarging or varying this guarantee. In the case of engines and accessories which have been used for "hiring out" purposes or are used for competition work such as "trials" or "scrambles", or have had components not of our manufacture fitted or from which our trade-mark, name or manufacturing number has been removed, no guarantee of any kind is given or is to be implied.

We guarantee, subject to the conditions mentioned below, that all precautions which are usual and reasonable have been taken by us to secure excellence of materials and workmanship, but this guarantee is to extend and to be in force for six months only from the date of purchase by the first owner-user and the damages for which we make ourselves responsible under this guarantee are limited to the replacement of a part manufactured by us which may have proved defective. We cannot accept responsibility for the replacement of any proprietary articles or parts not manufactured by us, unless the makers of these parts agree to replacement.

We do not undertake to refit or bear the cost of replacement or refitting such new part. We guarantee, subject to the conditions mentioned below, to make good at any time within six months any defects in these respects. As VILLIERS Engines and accessories are liable to derangement by neglect or misuse, this guarantee does not apply to defects caused by misuse and neglect.

CONDITIONS OF GUARANTEE

If a defective part should be found in our engines or accessories it must be sent carriage paid to an approved dealer or to the manufacturer of the machine, together with the engine number and full particulars of purchase, and with the intimation that the sender desires to have it replaced or repaired free of charge under our guarantee. Failing compliance with the above, no notice will be taken of anything that may arrive, but such articles will remain at the risk of the sender, and this guarantee or any implied guarantee shall not be enforceable.

THE TERM "AGENT" is used in a complimentary sense only, and those firms whom we style our agents are not authorised to advertise, incur any debts or transact any business whatsoever on our account other than the sale of goods which they may purchase from us, nor are they authorised to give any warranty or make any representation on our behalf or sell subject to or with any conditions other than those contained in the above guarantee.

The guarantee becomes void if any parts not made or supplied by THE VILLIERS ENGINEERING COMPANY, LTD., are fitted to a VILLIERS engine. To safeguard his own interests, the owner should always insist upon genuine VILLIERS parts.



IceniCAM Information Service

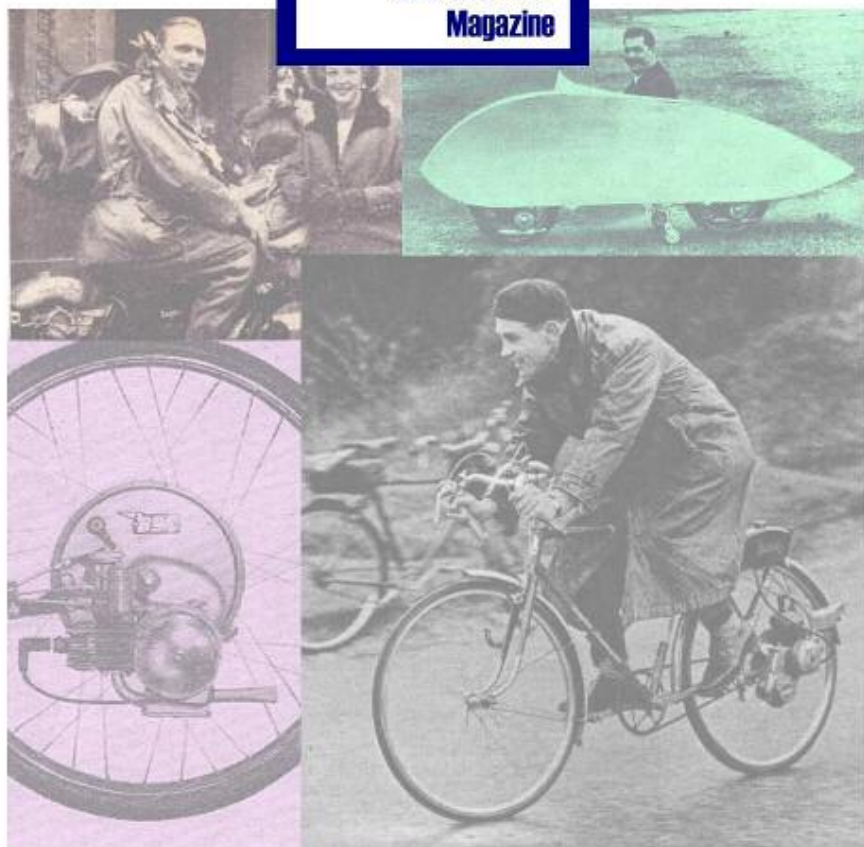

www.icenicam.org.uk