

SOLEX

CYCLE PARTS LIST
nomenclatura_ciclo

SOLEX 5000

07/1973

**SOCIÉTÉ INDUSTRIELLE NOUVELLE DE FABRICATION POUR
L'AUTOMOBILE ET LE CYCLE S.I.N.F.A.C.**

**68, BOULEVARD DE VERDUN - 92-COURBEVOIE
TÉLÉPHONE (1) 333 37-15**

**SOCIÉTÉ À RESPONSABILITÉ LIMITÉE AU CAPITAL DE 44.000.000 DE F.
C.C.P. PARIS N° 8352-38 . R. C. SEINE 85 B 8231 . I.N.S.E.E. N° 366 92 026 1012**

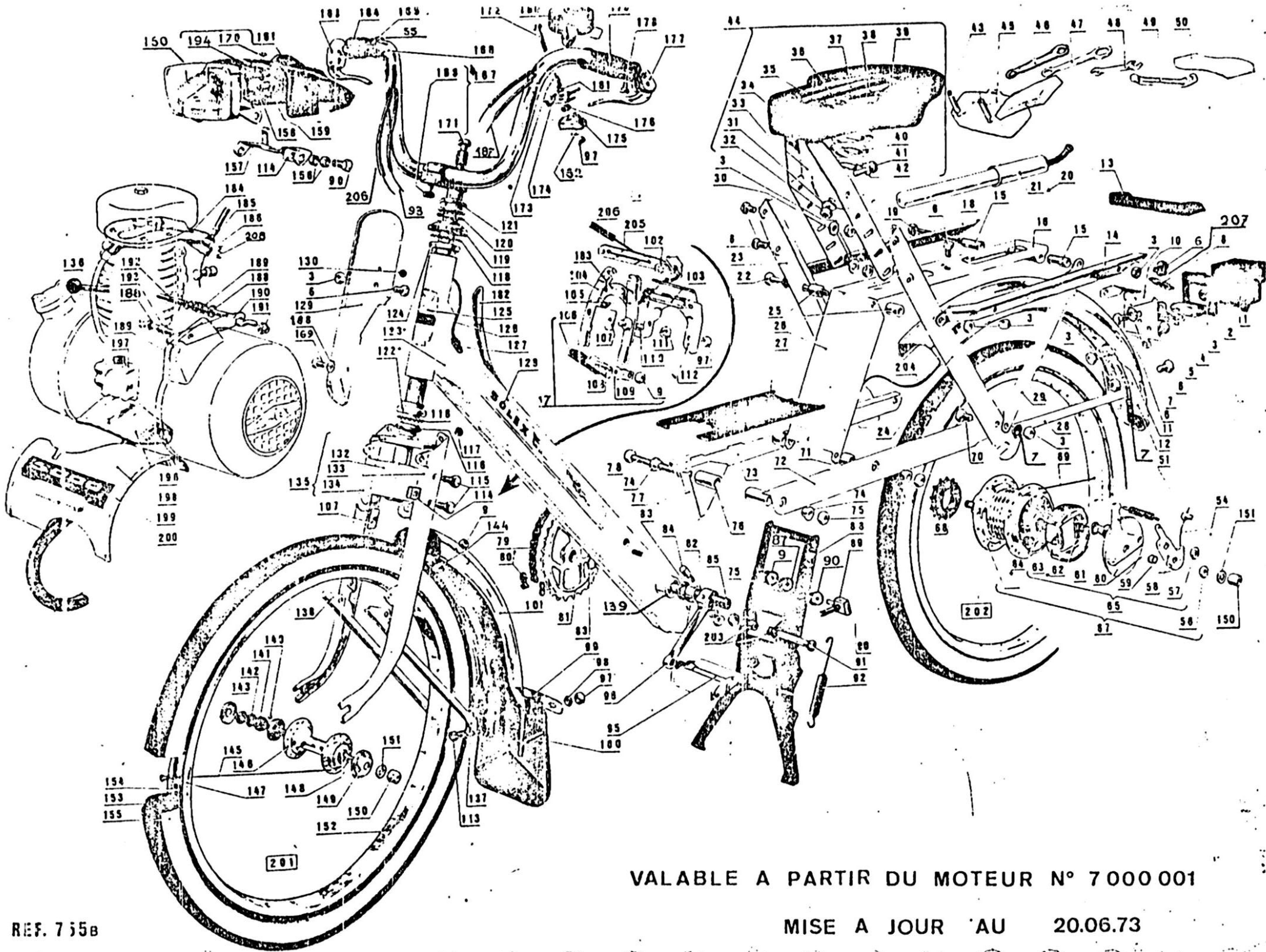

VALABLE A PARTIR DU MOTEUR N° 7 000 001

MISE A JOUR AU 20.06.73

ARTS-LIST, CYCLE, SOLEX 5000

Nº	Ref.	DESCRIPTION	Nº	Ref.	DESCRIPTION	Nº	Ref.	DESCRIPTION
1	41344	Combined rear lamp / reflector shell	71	11580	Bottom bracket reinforcing spacer 14x18x16	139	10735	Pedal spindle bush
2	50106	Rear light gasket	72	50010	Lower rear fork blade L/H	140	10404	Ball bearing
3	12057	Lamp bracket securing nut	73	50009	Lower rear fork blade R/H	141	00727	Hub cone
4	10883	Rear lamp bulb	74	20393	Spacer centering bush	142	11369	Lock washer
5	20464	Bulb holder	75	40613	Nut $\phi 9.5 \times 100$ 13 / flats	143	11367	Front hub lock nut $\phi 9.5 \times 100$ H 4.2
6	41359	Securing screw $\phi 8 \times 100$ (Length 17 mm)	76	50043	Front bottom bracket spacer 14 x 18 x 36.7	144	00670	Screw $\phi 6 \times 100$ (Length 10 mm)
7	50123	Serrated washer $\phi 8.50$	77	50008	Chain guard	145	41354	Front wheel spoke (Length 179 mm) $\phi 2.7$
8	50020	Rear lamp fixing plate	78	50049	Screw $\phi 9.5 \times 100$ (Length 139.5)	146	10994	Front hub complete
9	00050	Nut $\phi 6 \times 100$ H. 6	79	50060	89 - link chain	147	41352	Spoke nut
10	50022	Rear lamp bracket	80	00776	Spring link	148	00724	Front hub spindle
11	50023	Guide for rear lamp wire	81	50018	24-tooth chain wheel, crank R/H	149	00591	Hub cap
12	50013	Rear mudguard	82	10736	16 x 23 x 10 spacer, crank L/H	150	20394	Wheel nut $\phi 9.5 \times 100$ 13/flats
13	40597	Maker's badge	83	10764	Thick washer 16,1 x 23 x 1	151	20406	Wheel nut washer 10 x 17 x 2
14	40581	Luggage carrier bar L/H	84	00738	Cotter pin complete	152	41351	Rim
15	50050	Rear luggage carrier spacer 9x13x33.7	85	50059	Pedal spindle	153	41003	Inner tube
16	50107	Luggage carrier	87	10612	Serrated washer	154	41002	Rim tape
17	12662	Brake bar assembly	88	50122	Cycle stand/bracket assembly	155	50066	Tyre 2 x 16 Y
18	40580	Luggage carrier bar R/H	89	13141	Rear brake adjuster	156	12251	Front lamp spacer $\phi 8.2 \times 11.2 \times 3$
19	41028	Rear luggage carrier assembly screw, Length 141 mm.	90	00291	Washer	157	12505	Front lamp bracket complete
20	00769	Connector, tyre pump	91	50058	Main frame / screw $\phi 9.5 \times 100$ (Length 86 mm)	158	00764	Front lamp bulb
21	41011	Tyre pump with connector	92	40567	Stand return spring	159	41151	Bulb holder
22	40619	Screw for rear fork/saddle mounting $\phi 8 \times 100$, L 112 mm	93	50063	Slow-down cam (Length 690 mm)	160	41149	Front lamp lens
23	50006	Upper rear fork R/H	95	00741	Pedal complete	161	41150	Front lamp cover with switch
24	50005	Upper rear fork L/H	96	40596	Crank L/H	162	13174	Washer 6,1 x 20 x 1
25	40589	Spacer 9 x 13 x 18, fork/saddle mounting	97	00788	Nut H. 5 - $\phi 6 \times 100$ 9/flats	163	12178	Brake lever R/H
26	50002	Saddle mounting	98	11793	Washer 6.5 x 17.3 x 1.5	164	12146	Handlebar grip R/H
27	50038	Foot rest	99	11942	Splashguard clamp	165	12145	Slow-down cam
28	50004	Rear mudguard stay	100	40628	Grey splashguard	166	41475	Handlebar
29	50011	Luggage carrier stay	101	50003	Stainless steel front mudguard	167	12241	Handlebar bracket complete
30	00310	Washer 8.5 x 16.1 x 1.2	102	10338	Front brake slotted bar	168	20575	Handlebar lock screw
31	11501	Washer 8.5 x 25 x 3	103	10750	Brake arm return spring	169	00445	Screw $\phi 6 \times 100$ (Length 15 mm)
32	11719	Nut for bolt 11 590 (No 41)	104	10948	R.H. brake arm	170	41325	Parabola fixing screw
33	11565	Saddle cradle and support assembly	105	10949	L.H. brake arm	171	41242	Expander bolt complete
34	11587	Saddle top and cushion	106	00772	Brake block assembly	172	10307	Decompressor control bolt $\phi 6 \times 100$ (Length 45 mm)
35	11728	Attachment rod to spring	107	11661	Rectangular nut $\phi 6 \times 100$	173	11541	Decompressor spacer 6.3 x 9.3 x 12.5
36	11727	Saddle spring anchorage 11 723 (No 38)	108	10921	Brake shoe	174	41387	Sleeve end bracket
37	11722	Central spring for top of saddle	109	10919	Brake shoe clamp	175	41303	Decompressor lever
38	11723	Side saddle spring	110	50054	Brake arm fixing screw 13/flats	176	11146	Spacer washer 6.3 x 9.3 x 207
39	11721	Saddle cushion	111	50055	Brake arm nut	177	12341	Brake lever L/H
40	11589	Central saddle spring	112	10946	Brake housing	178	12183	Bracket fixing screw
41	11590	Bolt for saddle spring $\phi 8 \times 125$ 14/flats Length 25 mm	113	10266	Bottom fixing screw, front mudguard $\phi 6 \times 100$ (L 12 mm)	179	12345	Handlebar grip L/H
42	11718	Washer 8.5 x 20 x 2	114	00803	Square nut $\phi 8 \times 100$ 14/flats	180	41116	Bell
43	40753	Tool box spring	115	12072	Screw securing caliper to fork head $\phi 8 \times 100$, L 13 mm	181	11089	Spacer washer 6.3 x 9.5 x 3 Decompressor
44	50085	Saddle complete	116	11937	Crown frame	182	11561	Joint seal
45	41085	Tool box	117	50153	Rubber stop for fork arm L/H	183	10947	Front brake spacer
46	41078	13 x 21 ring spanner	118	11675	Ball cage, fork bearing	184	50026	Cylinder head plate
47	50046	9 x 13 ring spanner	119	11939	Threaded seat	185	20485	Sleeve end
48	00401	Flat 7 x 9 spanner	120	12273	Serrated washer	186	12386	Decompressor lever
49	00775	Tyre lever	121	11940	Bearing cup lock-nut	187	50071	Decompressor cable (Length 440 mm)
50	11479	Tool box padding	122	10113	Bottom bearing cup	188	00231	Washer 6.2 x 12 x 1.2
51	13108	Cable clamp	123	50099	Main frame with bearing cups and joint seal	189	11169	Crank spring
			124	10114	Top bearing cup	190	50021	Motor engaging lever
54	50167	Rear brake cable (Length 1 660 mm)	125	13057	Front maker's badge	191	50124	Crank guide
55	12182	Twist grip ring	126	12877	Rear lamp cable, (front end)	192	50025	Motor raising crank
56	11754	Brake disc fixing nut	127	11019	Lamp cable guide	193	50030	Raising lever spacer
57	50104	Brake cam securing nut (13/flats)	128	50150	Transfer	194	41326	Parabola fixing nut
58	11709	Brake cam lever	129	10969	Shield	195	08258	Sleeve $\phi 4.4$ (decompressor : 350 mm-slow-down : 510mm)
59	11753	Rear brake spacer	130	11930	Plug	196	20410	Motor mud shield
60	11807	Brake arm spring				197	11470	Petrol pump complete
61	11751	Rear brake cam				198	50079	Motor cover with badge
62	11746	Brake segment return spring	132	41277	Fork head	199	50039	Front maker's shield
63	12355	Brake block assembly	133	50134	Front fork L/H	200	50341	Silencer
64	11737	Hub axle complete	134	50035	Front fork R/H	201	41111	Front wheel complete
65	12361	Brake action plate	135	50072	Fork complete	202	50082	Rear wheel complete
66	50019	Rear hub drum	136	50031	Raising lever knob	203	11753	Cross-wise stand spacer
67	10769	Free wheel	137	50014	Front mudguard stay L.H.	204	50268	Rear lamp cable, (rear end)
68	41353	Rear wheel spoke $\phi 2.7$ (Length 152 mm)	138	50015	Front mudguard stay R.H.	205	50361	Front brake cable (Length 910 mm)
69	50056	Screw for bottom bracket to rear fork $\phi 8 \times 100$ (L 21 mm)				206	10270	Brake cable cover $\phi 5$ mm (Front : 735 mm - Rear 1155mm)
						207	00536	Washer 8,1 x 14 x 2
						208	10878	spring

- - Specify the colour when ordering
- - Specify the make when ordering
- ▲ - Specify the make and colour when ordering
- * Wires, pipes, castings, are sold only by metre

VERY IMPORTANT : Each spare has a reference number of 10 figures. To make it clear, our list of spare parts only shows the radical of 5 figures ; Refer to our price list of spare parts to know the complete reference number of the ordered part. In order to avoid any mistake in indicating the make, the colour or the colour.

IceniCAM Information Service

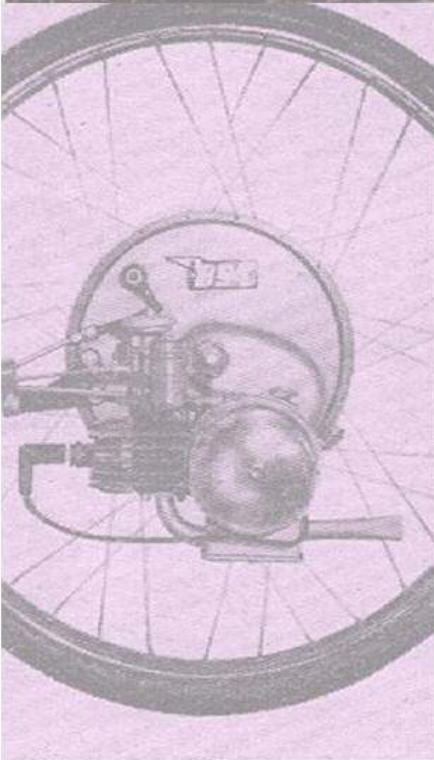

www.icenicam.org.uk