

FRAME SPARE PARTS LIST

Published by RALEIGH INDUSTRIES LTD • NOTTINGHAM

RALEIGH MOPED FRAME COMPONENTS

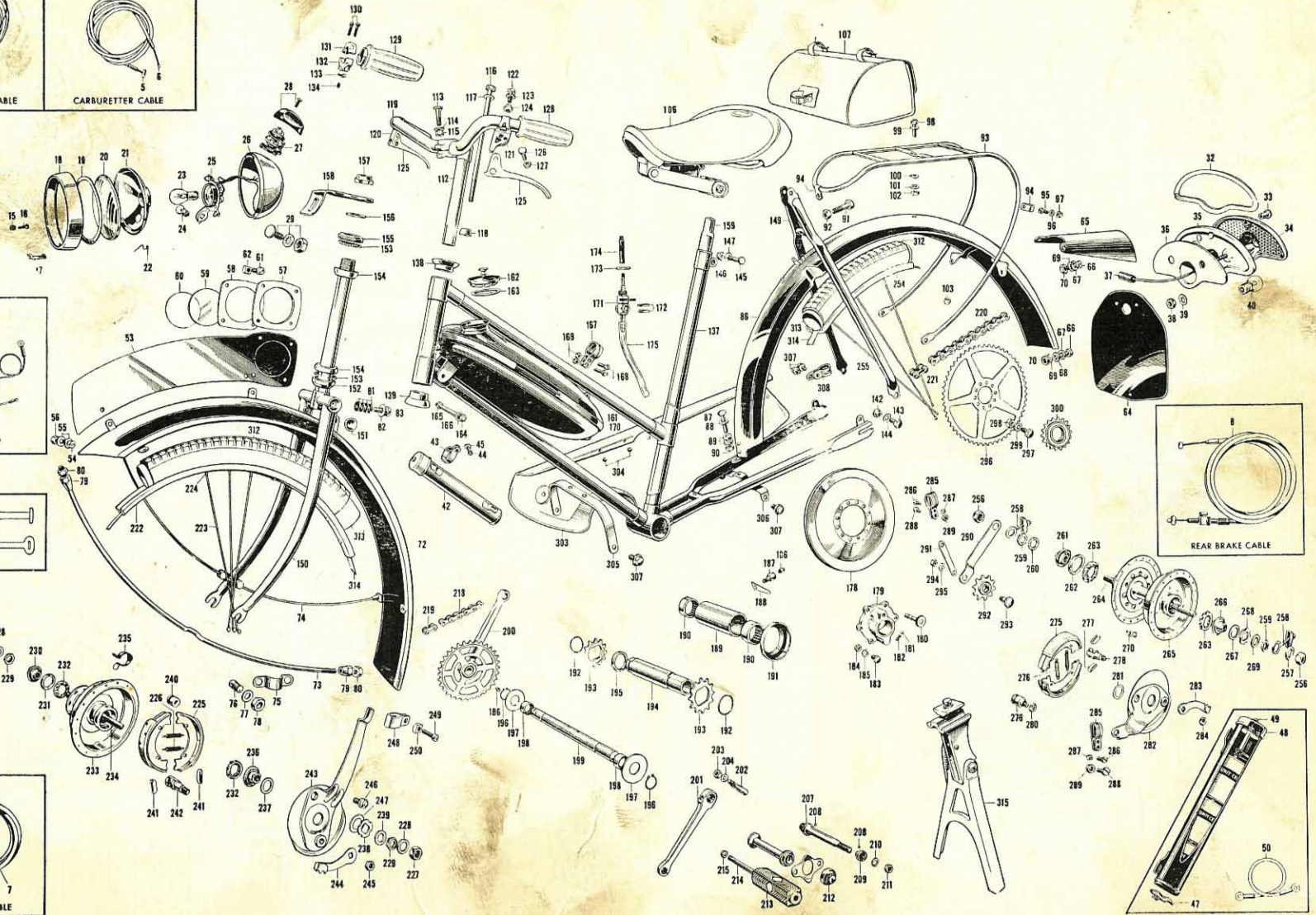
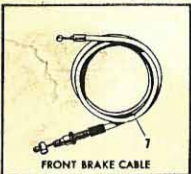
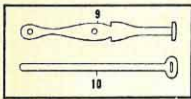
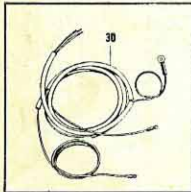
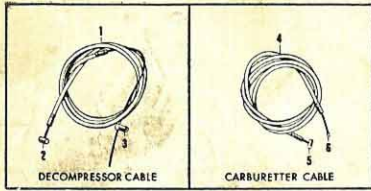

Illus.No.	Part No.	Quantity	Description	Retail Price each	
				£	s. d.
CABLE GROUP					
1	244/1377	1	De-compressor Cable Complete ..	2	9
2	344/007	1	Twist Grip Nipple for De-compressor Cable ..	2	
3	4561290	1	No. 21 Solderless Nipple Complete ..	4	
4	244/1376	1	Throttle Cable Assembly Complete ..	2	6
5	334/064	1	Twist Grip Nipple for Throttle Cable..	2	
		1 each	Part Nos. 334/004 & 334/007 are supplied, packeted (pkt. of 2)	4	
6	308/051	1	Throttle Cable Nipple (Throttle Valve End) ..	2	
7	GD./431	1	Front Brake Cable. Silver ..	4	1
8	GD./433A	1	Rear Brake Cable. Silver ..	5	0
9	MF. 108	4	Rubber Cable Band ..	3	
10	DU. 96	3	Metal Wire Band (Alum. Cable Clip) ..	1½	

LIGHTING GROUP

Headlamp

N.I.	Complete	Part No.	Quantity	Description	Retail Price each	
				£	s. d.	
N.I.	58206	1	Headlamp Complete. (Lucas MCH 64)	2	7 6	
15	517337	1	Lamp Rim Fixing Nut. (2/- pkt. of 10)	3		
16		1	Headlamp Rim Fixing Screw (not supplied as separate item). Part of headlamp Body 517382) ..	3		
17	517333	1	Headlamp Rim Fixing Clip ..	6	0	
18	517332	1	Headlamp Rim ..	4		
19	656118	1	Rubber Lens Seating for Headlamp. (2/9 pkt. of 10) ..	2	6	
20	656105	1	Lens (Glass) ..	5	0	
21	517296	1	Headlamp Reflector ..	3		
22	524991	3	Headlamp Lens Fixing Spring Clip. (2/- pkt. of 10) ..	4	6	
23	386	1	Headlamp Bulb 6.v. 15 w/15.w. (- P.T. 8½) ..	4	6	
24	974	1	Parking Light Bulb. 3.5v. 0.15 AMP .. (- P.T. 1d) ..	4		
25	517388	1	Bulb Holder Complete ..	5	0	
26	517382	1	Headlamp Body ..	13	6	
27	54033018	1	Headlamp Switch ..	10	0	
28	54331313	1	Knob and Screw (Headlamp Switch) (Screw only. 101371) ..	1	3	
29	122530	1	Headlamp Body Fixing Bolt ..	5		
	170510		Headlamp Body Fixing Nut ..	2½		
	188471		Headlamp Body Fixing Washer ..	½		
30	54940046	1	Wiring Harness ..	4	3	

Illus. No.	Part No.	Quantity	Description	Retail Price each	
				£	s. d.
N.I.	138449	1	Switch Knob Fixing Screw ..	3	
N.I.	54331427	1	Plate and Spindle (for Headlamp Switch)	2	3

LIGHTING GROUP

Tail Lamp

N.I.	Complete	Part No.	Quantity	Description	Retail Price each	
				£	s. d.	
N.I.	53555	1	Tail Lamp Complete ..	13	0	
32	526565	1	Tail Lamp Rubber Lens Seating ..	9		
33	526567	1	Tail Lamp Lens Fixing Nut (2/3 pkt. of 10) ..	3		
34	526563	1	Tail Lamp Lens ..	4	6	
35	526568	1	Tail Lamp Base Assembly ..	14	6	
36	MF. 66	1	Rear Light Insulation ..	5		
37	900288	1	Connector (2/9 pkt. of 10) ..	4		
38	166014	2	Nut (Rear Lamp Fixing) ..	1	9	
39	188330	2	Washer for Rear Lamp Fixing Nut ..	3	0	
			(pkt. of 100)	1	1	
40	990	1	Tail Lamp Bulb. 6v. 3w. (inc. P.T. 2d)	1	1	

Stand-By Lighting

	Part No.	Quantity	Description	Retail Price each	
				£	s. d.
42	GA.393	1	Dry Battery Unit S/A. Complete Less.. Batteries and Flex ..	8	9
43	GL.483	2	Clip for Fixing Battery Unit to Frame	7	
44	X.90	2	Screw for Clip ..	1½	
45	X.111A	2	Nut for Clip Screw ..	2½	
47	GL.540	1	Spring Ring for Battery Casing ..	8	
48	GL.487B	1	Rubber Cover for Battery Case ..	6	
49	GL.316	1	Terminal Nut ..	1	3
50	MF.90	1	Earth Wire ..	6	

SEE OVER
FOR
FURTHER
DETAILS

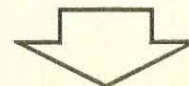

<i>Illus. No.</i>	<i>Part No.</i>	<i>Quantity</i>	<i>Description</i>	<i>Retail Price each</i>
-------------------	-----------------	-----------------	--------------------	--------------------------

NUMBER PLATE AND LICENCE HOLDER GROUP

Front Number Plate

				£	s.	d.
53	MF.77	1	Front Number Plate Enamelled ..	3	8	
54	X.90	2	Front Number Plate Fixing Screw ..			1½
55	P.1056	4	Front Number Plate Fixing Screw Washer. .. doz			3
56	S.98	2	Front Number Plate Fixing Nut ..			1

Licence Holder

57	MF.78	1	Licence Holder Cover Plate	9		
58	MF.79	1	Licence Holder Seal	4		
59	MF.80	1	Licence Holder Glass	4		
60	MF.81	1	Packing Disc	1		
61	S.35	4	Licence Holder Fixing Screw	1		
62	S.386	4	Nut for Licence Holder Fixing Screw ..	1		

Rear Number Plate

64	MF.52	1	Rear Number Plate (Enamelled) ..	3	4	
65	MF.63	1	Tail Piece (Enamelled)	2	6	
66	X.90	3	Screw for Number Plate Fixing ..			1½
67	P.1056	3	Plain Washer doz.			3
68	P.89A	1	Washer (Distance Piece)			½
69	GL.654	3	Shake Proof Washer			1
70	S.98	3	Nut (For Number Plate Fixing Screw)			1

MUDGUARD AND CARRIER GROUP

Front Mudguard

72	MF.43	1	Front Mudguard (Enamelled & Lined)	9	1	
73	MF.46	1	Mudguard Stay. Left Hand	1	5	
74	MF.50	1	Mudguard Stay. Right Hand	1	5	
75	MF.47	2	Mudguard Stay Clip	3		
76	MF.48	4	Stay Bolt	3		
77	P.1546	4	Stay Bolt Washer			½
78	MF.49	4	Stay Bolt Nut	3		
79	S.791	4	Mudguard Stay Lock Nut	2		
80	S.98	4	Hexagon Nut for Stay	1		
81	MF.113	4	Rubber Washer for Mudguard Fixing	1		
82	MF.114	1	Plain Washer for Mudguard Fixing Bolt	1		
83	MF.115	1	Bolt (Mudguard Fixing to Fork Crown)	4		
N.I.	MF.161	1	Rubber Grommet	6		
N.I.	MF.162	1	Tube	1	0	

<i>Illus. No.</i>	<i>Part No.</i>	<i>Quantity</i>	<i>Description</i>	<i>Retail Price each</i>
-------------------	-----------------	-----------------	--------------------	--------------------------

124	S.638	2	Nut for Clip Bolt	£ s. d. 3
125	K.141	2	Brake Lever	2 3
126	S.583	2	Fulcrum Bolt	3
127	S.443	2	Nut for Fulcrum Bolt	1
128	334/006	1	Dummy Handlebar Grip	1 6
129	334/005	1	Rubber Grip for Twist Grip	1 3
130	376/079	2	Body Fixing Screw	2
131	334/001	1	Body Top Half (Twist Grip)	3 0
132	334/002	1	Body. Bottom Half	4 0
133	336/007	1	Friction Spring	10
134	366/008	1	Screw for Friction Spring	3
N.I.	S.32BC	1	Locking Bolt Comp. (S.32B/S.25/P.1122)	6
N.I.	S.607BC	1	Expander Bolt Complete. (S.607B/P.160/S.128B)	1 4
N.I.	K.141C/RH	1	Brake Lever Ass. R.H. (P.1055B/S.637/P.1056/S.638/K.141/S.583/S.443) ..	5 0
N.I.	K.141C/LH	1	Brake Lever Ass. L.H. (P.1055C/S.637/P.1056/S.638/K.141/S.583/S.443) ..	5 0
N.I.	334/1	1	Twist Grip Complete. Amal. ..	10 6

FRAME AND FORK GROUP

137	MF.1	1	*Frame (Bare) Comprising: Top Head Cup. P.830. Bottom Head Cup. P.831. Chainstay Bushes S.404. (2 off) Head Crest. All fitted	4 12 6
138	P.830	1	Top Head Cup	1 0
139	P.831	1	Bottom Head Cup	1 9
142	S.404	2	Chainstay Bushes	3
143	S.562	2	Chainstay Screw	3
144	GL.654	1	Shakeproof Washer for ChainstayScrew	1
145	S.32	1	Seat Lug Bolt	5
146	S.25	1	Nut for Seat Lug Bolt	2
147	P.1546	1	Washer for Seat Lug Bolt	½
N.I.	S.32C	1	Seat Lug Bolt Complete	6
149	MF.73	1	Backstay Assembly	8 6
150	MF.42	1	Front Fork c/w Fork Crown Thimbles	1 7 9
151	P.407	2	Fork Crown Thimbles (2 off)	6
152	S.418	1	Fork Crown Race	1 0
153	4510376	42	3/16" Dia Ball Bearings .. gross	3 8
154	S.417	2	Head Race (2 off)	1 0
155	P.832A	1	Top Head Screwed Race	2 7½
156	MF.104	1	Head Spacing Washer	3
157	S.179A	1	Top Head Locknut	1 6
158	MF.53	1	Lamp Bracket	1 9
159	T.433	1	Seat Pillar	2 4
315	4519444	1	Centre Stand. Shuresta	18 11

Rear Mudguard

86	MF.54	1	Rear Mudguard (Enam. Lined) ..	9	1
87	MF.201	1	Bolt Lower Mudguard Fixing to Chainstay	4	
88	P.1056	1	Washer for S.569 Bolt. .. doz.	3	
89	P.89A	2	Spacing Washer for S.569 Bolt ..	1	1/2
90	S.98	1	Nut for S.569 Bolt	1	
91	S.193	1	Bolt Backstay Mudguard Fixing ..	3	
92	S.98	1	Nut for S.193 Bolt	1	

Carrier

93	MF.56	1	Carrier	15	5
94	MF.60	3	Carrier Fixing Clip	5	
95	X.90	2	Screw for Carrier Fixing Clip ..	1	1/2
96	GL.654	2	Shake Proof Washer for Screw X.90 ..	1	
97	S.98	2	Nut for Screw X.90	1	
98	X.90	1	Screw. Carrier to Mudguard Fixing ..	1	1/2
99	P.1056	1	Plain Washer for Screw X.90 doz.	3	
100	P.1315	1	Washer for Screw X.90 doz.	4	
101	GL.654	1	Shake Proof Washer for Screw X.90 ..	1	
102	S.98	1	Nut for Screw X.90	1	
103	M.1047	3	Wire Clip	3	

SADDLE AND TOOLBAG GROUP

106	L.100	1	Saddle Lycett Complete	1	5	0
107	MF.121	1	Saddle Bag (complete) Brooks (incl. P.T. 1/6)	9	0	

HANDLEBAR GROUP

112	MF.116	1	Extension	9	0
113	S.32B	1	Locking Bolt	5	
114	P.1122	1	Washer for S.32B Bolt. .. doz.	3	
115	S.25	1	Nut for S.32B Bolt	2	
116	S.607B	1	Expander Bolt	10	
117	P.160	1	Washer for Expander Bolt	3	
118	S.128B	1	Cone (for Expander Bolt)	5	
119	MF.110	1	Handlebar Bend	10	6
120	P.1055B	1	Brake Fulcrum. Right Hand ..	2	0
121	P.1055C	1	Brake Fulcrum. Left Hand ..	2	0
122	S.637	2	Clip Bolt	3	
123	P.1056	2	Washer for Clip Bolt .. doz.	3	
	MF.116C	1	Handlebar Ext. Compl. Comprising of MF.116, S.32B, P.1122, S.25, S.607B, P.160, S.128B.. ..	10	10

PETROL TANK AND FITTINGS

161	MF.6	1	Petrol Tank (Bare)	1	5	10
162	M.7600/A/CP	1	Filler Cap c/w Sealing Washer for Petrol Tank	5	4	
163	R.7	1	Sealing Washer for Petrol Cap ..	2		
164	MF.9	1	Bolt for Petrol Tank Fixing (Front) ..	7		
165	S.98	1	Nut for Bolt MF.9	1		
166	GL.654	1	Shakeproof Washer for Bolt MF.9 ..	1		
167	MF.11	1	Clip for Petrol Tank Fixing (Rear) ..	5		
168	X.90	2	Screw for Fixing Clip MF.11 (2 off) ..	1	1/2	
169	S.98	2	Nut for X.90 (2 off)	1		
170	MF.97	1	Plastic Cover Strip for Petrol Tank ..	2	0	
171	M.9428/E	1	Petrol Tap. complete	9	6	
172	4561330	2	Petrol Tap Corks. (2 off)	4		
173	MF.157	1	Fibre Washer for petrol tap	2		
174	4519480	1	Gauze for Petrol Tap	1	6	
175	MF.67	1	Petrol Pipe (Plastic)	1	1	
N.I.	MF.155	1	Pyramid Gauze	3		

BOTTOM BRACKET GROUP

178	MT.13	1	Bottom Bracket Pulley	3	2	
179	MT.1	1	Pulley Hub	5	9	
180	MT.10	1	Driving Pin	1	5	
181	4510377	1	5/32" Dia Ball Bearing (per 100) ..	1	3	
182	MT.40	1	Compression Spring	1		
183	ME.60	6	Pulley Hub Bolts. (6 off)	2		
184	ME.30	6	Nut for Pulley Hub Bolt	2		
185	M.208	6	Spring Washers for Pulley Hub Bolt gr.	7	1/2	
186	4512194	2	Grease Nipple	3		
187	MT.19	1	Location Pin for Bottom Bracket Sleeve	8		
188	MT.38	1	Cable Clip	1		
189	MT.2	1	Bottom Bracket Sleeve (Bare) ..	7	8	
190	4519440	2	Bearing. Torrington Drawn Cup Roller Bearing J.1812 or Ina Needle Shell Cage Bearing SC.1812	8	3	
189/190	MT.20	1	Bottom Bkt. Sleeve and Bearing Assem. (2 off)	1	5	6
191	MT.45	1	Dust Cover	3		
192	MT.8	2	Spring Ring for Driving Shaft ..	2		
193	MT.4	2	Final Drive Sprocket	2	6	
194	MT.5	1	Driving Shaft (Bare)	1	1	6
195	MT.100	1	Spacer	9		
196	4519441	2	Circlip. Seeger External 5/8" Diam. ..	3		
197	MT.6	2	Thrust Washer	3		
198	4519439	2	Driving Shaft Bearing. Torrington Drawn Cup Roller Bearing J.108 or Ina Needle Shell Cage Bearing SC.108	5	9	
194 & 198 (20FF)	MT.18	1	Driving Shaft Assembly	1	14	6
199	MT.7	1	Axle. Bottom Bracket	5	2	

Illus. No.	Part No.	Quantity	Description	Retail Price each	
				£	s. d.
200	MT.47	1	Chain Wheel and Right Hand Crank (32T)	16	0
201	MT.46	1	Left Hand Crank	8	6
202	S.172	2	Cotter Pin	4½	
203	S.15	2	Nut for Cotter S.172	1	
204	P.70	2	Plain Washer for Cotter S.172	½	
N.I.	S.172C	2	Cotter Pin Complete	7	

PEDALS

N.I.	MT.52	1 pr.	Pedals 4¼" R.I.	10	6
207	S.677	1	Pedal Spindle. Left Hand	2	3
N.I.	S.677A	1	Pedal Spindle. Right Hand	2	3
208	4510377	22	5/32" Dia Ball (22 per pedal) per 100..	1	3
209	S.380	1	Cone (One per Pedal)	5	
210	P.1092	1	Lock Washer for Cone (1 per Pedal)	4	
211	S.381	1	Lock Nut for Cone. (1 per Pedal)	1	
212	P.707	2	Dust Cap (1 per Pedal)	5	
213	MT.51	2	Pedal Rubber (2 per Pedal)	9	
214	S.52A	2	Stretcher Bar (2 per Pedal)	3½	
215	S.443	4	Nut for Stretcher Bar (4 per Pedal)	1	

per doz
Pedal Barrel and End Plate only supplied when ordered separately.

CHAINS

218	4512260		Pedal Chain 105 Links. ½" × ⅜" Perry	8	0
219	4518183		Connecting Link. ½" × ⅜" Perry	6	
220	4519486		Driving Chain 112 Links ½" × ⅜"	12	9
221	4512274		Connecting Link	6	

WHEEL GROUP

Front Wheel

222	MF.100	1	Rim (32 Hole)	18	0
223	MF.86/87	16 of each	Spokes. MF.86 (14g × 10.19/32") MF.87 (14g × 10.7/32")	1	
224	S.726	32	Nipples .. per gross	3	0
225	K.458ZA	1 pr.	Brake Shoe c/w. Linings, End caps, springs and K.456 Fulcrum Sleeve	9	3
226	K.166	2	Brake Shoe Spring	3½	
227	LB.162	2	Axle Nut	4	
228	X.42A	2	Axle Washer ⅜" thick	2	
229	LB.155A	2	Cone Lock Nut	3	

Illus. No.	Part No.	Quantity	Description	Retail Price each	
				£	s. d.
282	K.457BZ	1	Rear Brake Plate	4	3
283	LB.166	1	Cam Lever	1	0
284	K.175	1	Cam Lever Nut	2	
285	N.43A	2	Brake Arm Clip or Chain Tensioner Arm Clip	7	
286	X.69	2	Brake Arm Clip Screw	2	
287	S.386	2	Brake Arm Clip Screw Nut	1	
288	X.69A	2	Screw	2	
289	K.175	2	Nut	2	
290	MT.25	1	Chain Tensioner Arm (Large)	10	
291	MT.32	1	Chain Tensioner Arm (Small)	9	
292	MT.30	1	Chain Tensioner Sprocket Assembly	3	9
293	MT.27	1	Chain Tensioner Sprocket Spindle	7	
294	ME.30	1	Chain Tensioner Spindle Nut	2	
295	M.208	1	Chain Tensioner Spindle Washer gross	7½	
296	MT.23	1	Rear Wheel Sprocket. 55T	17	2
297	MH.7	5	Bolt for Rear Wheel Sprocket	3	
298	K.175	5	Nut for Sprocket Bolt	2	
299	GL.432	5	Washer for Sprocket Bolt	1	3
300	4511827	1	Freewheel. Bayliss Wiley 20T.	7	3
N.I.	MF.107	1	Rear Wheel complete inc., Brake Plate and Shoes. Less tyre, tube, freewheel and sprocket	3	13 3

FAIRING AND FITTINGS

303	MF.35	1	Fairing. Right Hand	16	6
304	HV.2551	2	Grommet for Right Hand Fairing	2	
N.I.	MF.36	1	Fairing. Left Hand	16	6
305	MF.39	1	Fairing Bracket (Front)	1	0
306	MF.40	1	Fairing Bracket (Lower Rear)	7	
307	MF.181	9	Fairing Screws	2	
308	MF.41	2	Fairing Clip for Backstay	9	

TYRE GROUP

312	4519460	2	Tyre. 26 × 2.00 (1755 mill. rim circ.)	1	7 0
313	4519461	2	Tube. 26 × 2.00	8	6
314	4519483	2	Rim Tape	11	

TOOL KIT

N.I.	ME.73		Screwdriver	6	
N.I.	ME.74		Sparking Plug Spanner	1	0

230	LB.358Z	1	Right Hand Cone with Dust Cap	..	1	9
231	LB.405	1	Outer Dust Cap	1	1/2
232	K.67Z	2	Ball Cage	7	
233	LB.401Z	1	Front Hub (32 Holes) Shell only	..	15	0
234	LB.426B	1	Front Wheel Spindle. 4 3/4"	1	1
235	M.355	1	Lubricator	2	
236	LB.357AZ	1	Left Hand Cone with Dust Cap	..	1	9
237	LB.159	1	Packing Washer	1/2	
238	K.428	1	Notched Cone Adjuster	3	
239	X.42A	1	Axle Washer 1/2" thick	2	
240	K.456	1	Brake Fulcrum Sleeve	10	
241	K.459A	2	Brake Shoe End Cap	2	
242	K.452	1	Brake Operating Cam	1	7
243	LB.416AZ	1	Brake Plate and Arm	4	9
244	LB.149	1	Cam Lever	1	0
245	K.175	1	Cam Lever Nut	2	
246	K.171	1	Wire Guide	1	0
247	K.360	1	Spacing Washer	2	
248	LB.112	1	Brake Arm Clip	8 1/2	
249	X.69	1	Clip Screw	2	
250	S.386	1	Clip Screw Nut	1	
	LB.112Z	1	Brake Arm Clip c/w Nut and Screw	..	1	0
N.I.	MF.106	1	Front Wheel complete inc , Brake Plate, Shoes etc. Less tyre and tube		2	18 6

Rear Wheel

254	MF.101	1	Rim (40 Hole)	18	0
255	MF.88	40	Spokes 12/14g x 10.7/16"	2	
256	K.520	2	Axle Nut	4	
257	X.42A	1	Axle Nut Washer	2	
258	S.20AC	2	Chain Adjuster Complete	1	0
259	K.47A	2	Cone Lock Nut	2	
260	X.42	1	Axle Washer 1/16" thick	1	
261	K.506Z	1	Right Hand Cone with Dust Cap	..	1	9
262	LB.405	1	Outer Dust Cap	1 1/2	
263	K.67Z	2	Ball Cage	7	
264	MH.6	1	Axle (Rear)	1	5
265	MH.2	1	Rear Hub Shell	1	1 0
266	K.105AZ	1	Adjusting Cone (Left Hand)	1	9
267	K.360	1	Packing Washer	2	
268	K.428	1	Notched Cone Adjuster	3	
269	X.42A	1	Axle Washer 1/2" thick	2	
270	L.23	1	Lubricator (Plastic)	3	
275	K.458AZ	1 pr.	Brake Shoes c/w. Linings, Springs, Fulcrum Pin K.456A and End Caps	pr.	9	3
276	K.166	2	Brake Shoe Springs	3 1/2	
277	K.459A	2	Brake Shoe End Caps	2	
278	K.452	1	Brake Operating Cam	1	7
279	K.456A	1	Brake Fulcrum Pin	11	
280	K.175	1	Brake Fulcrum Pin Nut	2	
281	LB.159	1	Packing Washer	1/2	

N.I.	ME.75	Cylinder Head Spanner	9
N.I.	P.1463	Combination Spanner	1 5
N.I.	ME.76	Spanner	1 6
N.I.	P.1658	Spanner	1 3

ACCESSORIES

N.I.	4519498	Legshields c/w Fittings	3	14	9
N.I.	4519497	Windscreen c/w Fittings	3	9	6
N.I.	4519455	Speedometer c/w Fittings	2	9	6
N.I.	4519456	Panniers (2 per set) (+ 3/7 Pur, Tax)	1	1	11
N.I.	4519457	Inflator	7	3

SPECIAL SERVICE TOOLS

N.I.	MS.1	1	Crankshaft Jig	2	8 4
N.I.	MS.2	1	Crankshaft Removal Adaptor	11	3
N.I.	MS.3	1	Crankshaft Assembly Adaptor	3	6
N.I.	MS.4	1	Crankshaft Thread Adaptor Nut	2	8
N.I.	MS.6	1	Crankshaft Bearing Rolling-in-Tool	17	4
N.I.	MS.7	1	Oil Seal Assembly Tool	2	11
N.I.	MS.8	1	Flywheel Extractor	4	9
N.I.	MS.9	1	Crankshaft Pulley Extractor	9	9
N.I.	MS.10	1	Crankshaft Pulley Assembly Tool	6	9
N.I.	MS.11	1	Crankcase Dowel Extractor	2	10
N.I.	MS.12	1	Piston Stop	1	8
N.I.	MS.13	1	Gudgeon Pin Assembly and Removal Tool	18	6
N.I.	MS.14	1	Engine Needle Bearing Assembly Tool	8	4
N.I.	MS.15	1	Engine Mounting Bush Tool	5	9
N.I.	MS.18	1	Bottom Bracket Sleeve Bearing Assembly Tool	15	9
N.I.	MS.19	1	Driving Shaft Bearing Assembly Tool	12	3
N.I.	MS.20	1	Driving Shaft Spring Ring Assembly Tool	10	1
N.I.	MS.21	1	Driving Pin Ball & Spring Assembly Tool	1	0
N.I.	MS.69		C/Shaft Thread Adaptor for use with Flywheel Extractor. Supplied with MS.8	1	9
N.I.	MS.24	1	Clutch Brake Assy. Tool	13	9
N.I.	MS.74	1	Clutch Plate Assy. Tool	14	9

*New frames can only be supplied to replace existing ones damaged beyond repair.

ABBREVIATIONS USED

N.I. Not Illustrated.
c/w Complete with.
P.T. Purchase Tax



IceniCAM Information Service



www.icenicam.org.uk