

FRAME SPARE PARTS LIST

Published by RALEIGH INDUSTRIES LTD • NOTTINGHAM

RALEIGH MOPED FRAME COMPONENTS

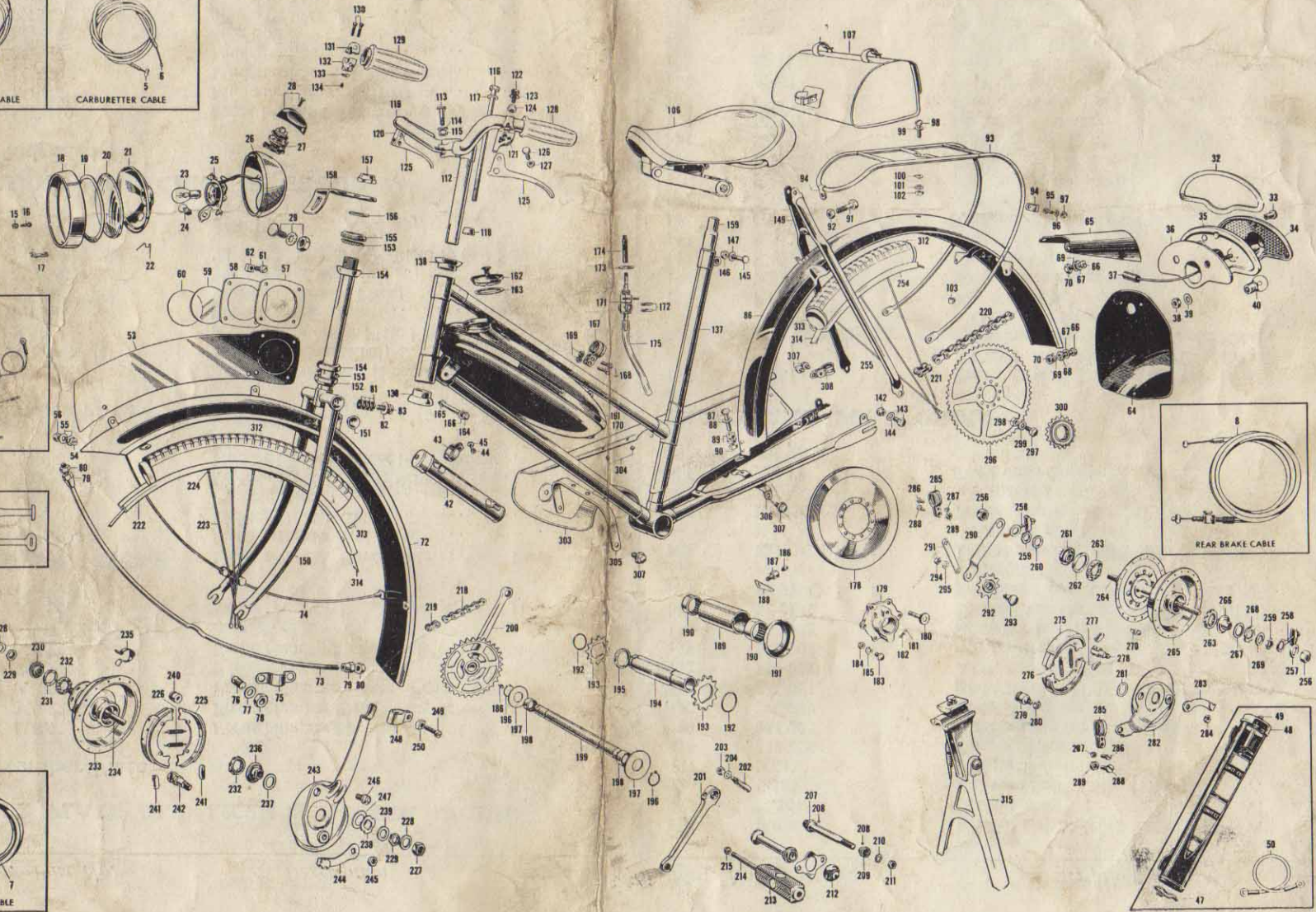
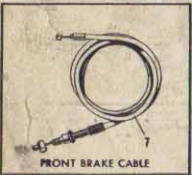
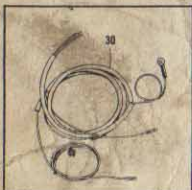
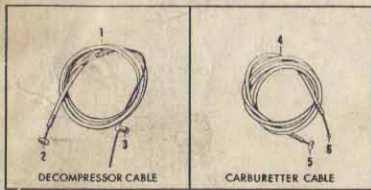

Illus. No. Part No.

Description

Retail
Price
each

CABLE GROUP

			£	s.	d.
1	244/1574	De-compressor Cable Complete ..	4	6	
2	334/007	Twist Grip Nipple for De-compressor Cable ..			2
3	4561290	No. 21 Solderless Nipple Complete ..			4
4	244/1376	Throttle Cable Assembly Complete ..	2	6	
5	334/064	Twist Grip Nipple for Throttle Cable ..			2
		Part Nos. 334/004 & 334/007 are supplied, packeted (pkt. of 2)			4
6	308/051	Throttle Cable Nipple (Throttle Valve End) ..			2
7	GD./431	Front Brake Cable. Silver ..	4	1	
8	GD./433A	Rear Brake Cable. Silver ..	5	0	
9	MF. 108	Rubber Cable Band ..			4
10	GL.241	Metal Wire Band (Alum. Cable Clip) ..			1½

LIGHTING GROUP

Headlamp

			£	s.	d.
N.I.					
Complete	54052019	Headlamp Complete. (Lucas MCH 64)	2	7	6
15	517337	Lamp Rim Fixing Nut. (2/- pkt. of 10)			3
16		Headlamp Rim Fixing Screw (not supplied as separate item). Part of headlamp Body 517382) ..			3
17	517333	Headlamp Rim Fixing Clip (2/6 pkt.10)			3
18	517332	Headlamp Rim ..	6	0	
19	656118	Rubber Lens Seating for Headlamp. (2/9 pkt. of 10)			4
20	656105	Lens (Glass) ..	2	6	
21	517296	Headlamp Reflector ..	5	0	
22	524911	Headlamp Lens Fixing Spring Clip. (2/- pkt. of 10)			3
23	386	Headlamp Bulb 6.v. 15 w/15.w. (-/- P. Tax 8½)	4	6	
24	974	Parking Light Bulb. 3.5v. 0.15 AMP .. (-/- P. Tax 1d.)			4
25	517388	Bulb Holder Complete ..	5	0	
26	517382	Headlamp Body ..	13	6	
27	54033018	Headlamp Switch ..	10	0	
28	54331313	Knob and Screw (Headlamp Switch)	1	3	
29	122530	Headlamp Body Fixing Bolt ..			5
	170510	Headlamp Body Fixing Nut ..			2½
	188471	Headlamp Body Fixing Washer ..			½
30	54940046	Wiring Harness ..	4	3	
N.I.	138449	Switch Knob Fixing Screw ..			½
N.I.	54331427	Plate and Spindle (for Headlamp Switch)	2	3	

Illus. No. Part No.

Description

Retail
Price
each

LIGHTING GROUP

Tail Lamp

			£	s.	d.
N.I.					
Complete	53555	Tail Lamp Complete ..	13	0	
32	526565	Tail Lamp Rubber Lens Seating ..			9
33	526567	Tail Lamp Lens Fixing Nut .. (2/3 pkt. of 10)			3
34	526563	Tail Lamp Lens ..			4
35	526568	Tail Lamp Base Assembly ..	10	6	
36	MF. 66	Rear Light Insulation ..			6
37	900288	Connector (2/9 pkt. of 10) ..			4
38	166019	Nut (Rear Lamp Fixing) ..	1	9	
39	188330	Washer for Rear Lamp Fixing Nut .. (pkt. of 100)			3
40	990	Tail Lamp Bulb. 6v. 3w. (-/- P. Tax 2d.)	1	1	

Stand-By Lighting

42	GA.393	Dry Battery Unit S/A. Complete Less Batteries and Flex ..	8	9	
43	GL.483	Clip for Fixing Battery Unit to Frame			7½
44	X.90	Screw for Clip ..			1½
45	X.111	Nut for Clip Screw ..			2½
47	GL.540	Spring Ring for Battery Casing ..			8
48	GL.487B	Rubber Cover for Battery Case ..			6
49	GL.316	Terminal Nut ..	1	3doz	
50	MF.90	Earth Wire ..			7

SEE OVER
FOR
FURTHER
DETAILS



Illus. No.	Part No.	Description	Retail Price each
------------	----------	-------------	-------------------

NUMBER PLATE AND LICENCE HOLDER GROUP

Front Number Plate

			£	s.	d.
53	MF.77	Front Number Plate Enamelled	4	5	
54	MF.225	Front Number Plate Fixing Screw	2	½	
55	P.1056	Front Number Plate Fixing Screw Washer	3	doz	
56	MF.241	Front Number Plate Fixing 'Nyloc' Nut	4		

Licence Holder

57	MF.78	Licence Holder Cover Plate	11		
58	MF.79	Licence Holder Seal	5		
59	MF.80	Licence Holder Glass	5		
60	MF.81	Packing Disc	1		
61	S.35	Licence Holder Fixing Screw	1		
62	S.98	Nut for Licence Holder Fixing Screw	1		

Rear Number Plate

64	MF.52	Rear Number Plate (Enamelled)	4	0	
65	MF.148	Tail Piece (Enamelled)	3	0	
66	X.90	Screw for Number Plate Fixing	1	½	
67	P.1056	Plain Washer	3	doz	
68	P.89A	Washer (Distance Piece)	½		
69	GL.654	Shake Proof Washer	1		
70	MF.241	'Nyloc' Nut (For No. Plate Fixing Screw)	4		

MUDGUARD AND CARRIER GROUP

Front Mudguard

72	MF.160	Front Mudguard (Enamelled & Lined)	11	0	
73	MF.46	Mudguard Stay. Left Hand	1	9	
74	MF.50	Mudguard Stay. Right Hand	1	9	
75	MF.47	Mudguard Stay Clip	4		
76	MF.48	Stay Bolt	4		
77	P.1546	Stay Bolt Washer	½		
78	MF.49	Stay Bolt Nut	4		
79	S.791	Mudguard Stay Lock Nut	2		
80	MF.241	'Nyloc' Nut for Stay	4		
N.I.	MF.161	Rubber Grommet	7		
N.I.	MF.162	Tube	1	3	
N.I.	M.F181	Screw	2		

Illus. No.	Part No.	Description	Retail Price each
------------	----------	-------------	-------------------

			£	s.	d.
124	S.638	Nut for Clip Bolt	3		
125	K.141	Brake Lever	2	3	
126	S.583	Fulcrum Bolt	3		
127	S.443	Nut for Fulcrum Bolt	1		
128	334/006	Dummy Handlebar Grip	1	6	
129	334/005	Rubber Grip for Twist Grip	1	3	
130	376/079	Body Fixing Screw	2		
131	334/001	Body Top Half (Twist Grip)	3	0	
132	334/002	Body. Bottom Half	4	0	
133	366/007	Friction Spring	10		
134	366/008	Screw for Friction Spring	3		
N.I.	S.32BC	Locking Bolt Comp. (S.32B/S.25/P.1122)	6		
N.I.	S.607BC	Expander Bolt Complete. (S.607B/P.160/S.128B)	1	4	
N.I.	K.141C/RH	Brake Lever Ass. R.H. (P.1055B/S.637/P.1056/S.638/K.141/S.583/S.443)	5	0	
N.I.	K.141C/LH	Brake Lever Ass. L.H. (P.1055C/S.637/P.1056/S.638/K.141/S.583/S.443)	5	0	
N.I.	334/1	Twist Grip Complete. Amal.	10	6	

FRAME AND FORK GROUP

137	MF.1	*Frame (Bare) Comprising: Top Head Cup. P.830. Bottom Head Cup. P.831. Chainstay Bushes S.404. (2 off) Head Crest. All fitted	5	10	0
		Top Head Cup	1	0	
		Bottom Head Cup	1	9	
		Chainstay Bushes	3		
		Chainstay Screw	3		
		Shakeproof Washer for Chainstay Screw	1	3	doz
		Seat Lug Bolt	5		
		Nut for Seat Lug Bolt	2		
		Washer for Seat Lug Bolt	½		
		Seat Lug Bolt Complete	6		
		Backstay Assembly	10	3	
		Front Fork c/w Fork Crown Thimbles	13	6	
		Fork Crown Thimbles (2 off)	6		
		Fork Crown Race	1	0	
		3/16" Dia Ball Bearings	3	8	grs
		Head Race (2 off)	1	0	
		Top Head Screwed Race	2	7	½
		Head Spacing Washer (2 off)	4		
		Top Head Locknut	1	6	
		Lamp Bracket	2	1	
		Seat Pillar	1		
		Centre Stand. Shuresta	18	1	
138	P.830				
139	P.831				
142	S.404				
143	S.562				
144	GL.432				
145	S.32				
146	S.25				
147	P.1546				
N.I.	S.32C				
149	MF.73				
150	MF.42				
151	P.407				
152	S.418				
153					
154	S.417				
155	P.832A				
156	MF.104				
157	S.179A				
158	MF.53				
159	T 433				
315	4519444				

Rear Mudguard

86	MF.54	Rear Mudguard (Enam. Lined)	..	11	0
87	MF.201	Bolt Lower Mudguard Fixing to Chainstay	5	
88	P.1056	Washer	3doz	
89	MF.159	Spacing Washer	$\frac{1}{2}$	
90	MF.241	'Nyloc' Nut	4	
91	MF.201	Bolt Backstay Mudguard Fixing	3	
92	MF.241	'Nyloc' Nut	4	

Carrier

93	MF.56	Carrier	18	8
94	MF.60	Carrier Fixing Clip	6	
95	MF.225	Screw for Carrier Fixing Clip	2 $\frac{1}{2}$	
96	GL.654	Shake Proof Washer	1	
97	MF.241	'Nyloc' Nut	4	
98	MF.225	Screw, Carrier to Mudguard Fixing	2 $\frac{1}{2}$	
99	P.1056	Plain Washer	3doz	
100	P.1315	Washer	4doz	
101	GL.654	Shake Proof Washer	1	
102	S.98	Nut	1	
103	M.1047	Wire Clip	3	

SADDLE AND TOOLBAG GROUP

106	L.100	Saddle Lycett Complete	1	5 0
107	MF.121	Saddle Bag (complete) Brooks	8	9

HANDLEBAR GROUP

112	MF.116	Extension	10	10
113	S.32B	Locking Bolt	5	
114	P.1122	Washer for S.32B Bolt.	3doz	
115	S.25	Nut for S.32B Bolt	2	
116	S.607B	Expander Bolt	10	
117	P.160	Washer for Expander Bolt	3	
118	S.128B	Cone (for Expander Bolt)	5	
119	MF.110	Handlebar Bend	12	8
120	P.1055B	Brake Fulcrum. Right Hand	2	0
121	P.1055C	Brake Fulcrum. Left Hand	2	0
122	S.637	Clip Bolt	3	
123	P.1056	Washer for Clip Bolt	3doz	
	MF.116C	Handlebar Ext. Compl. Comprising of MF.116, S.32B, P.1122, S.25, S.607B, P.160, S.128B.	13	0

PETROL TANK AND FITTINGS

161	MF.6	Petrol Tank only (CF.48)	11	5
162	M.7600/A/CP	Filler Cap c/w Sealing Washer for Petrol Tank	6	5
163	R.7	Sealing Washer for Petrol Cap	2 $\frac{1}{2}$	
164	MF.9	Bolt for Petrol Tank Fixing (Front)	8	
165	S.98	Nut for Bolt MF.9	1	
166	GL.654	Shakeproof Washer for Bolt MF.9	1	
167	MF.11	Clip for Petrol Tank Fixing (Rear)	6	
168	ME.105	Screw for Fixing Clip MF.11 (2 off)	2	
169	S.98	Nut for X.90 (2 off)	1	
170	MF.97	Plastic Cover Strip for Petrol Tank	2	5
171	TI35R1	Rotherham Petrol Tap. complete	9	6
172	4561330	Petrol Tap Corks. (2 off)	4	
173	MF.157	Fibre Washer for petrol tap	2 $\frac{1}{2}$	
174	4519480	Gauze for Petrol Tap	1	6
175	MF.67	Petrol Pipe (Plastic)	1	4
N.I.	MF.155	Pyramid Gauze	3	

BOTTOM BRACKET GROUP

178	MT.13	Bottom Bracket Pulley	4	0
179	MT.1	Pulley Hub	7	0
180	MT.10	Driving Pin	1	9
181		5/32" Dia Ball Bearing	2	0 grs
182	MT.40	Compression Spring	1	
183	ME.60	Pulley Hub Bolts. (6 off)	2 $\frac{1}{2}$	
184	ME.30	Nut for Pulley Hub Bolt	2 $\frac{1}{2}$	
185	M.208	Spring Washers for Pulley Hub Bolt	7 $\frac{1}{2}$	grs
186	4512194	Grease Nipple	4	
187	MT.19	Location Pin for Bottom Bracket Sleeve	10	
188	MT.38	Cable Clip	1	
189	MT.2	Bottom Bracket Sleeve (only)	9	3
190	4519440	Bearing, Torrington J.1812 or Ina SC.1812	8	3
189/190	MT.20	Bottom Bkt. Sleeve and Bearing Assem. (2 off)	1	7 6
191	MT.45	Dust Cover	4	
192	MT.8	Spring Ring for Driving Shaft	2 $\frac{1}{2}$	
193	MT.4	Final Drive Sprocket (12T)	3	0
194	MT.5	Driving Shaft (only)	1	6 0
195	MT.3	Spacer	11	
196	4519441	Circlip. Seeger External $\frac{5}{8}$ " Diam.	3	
197	MT.6	Thrust Washer	4	
198	4519439	Driving Shaft Bearing Torrington J.108 or Ina SC.108	5	9
194 & 198 (2 OFF)	MT.18	Driving Shaft Assembly	1	17 6
199	MT.7	Axle. Bottom Bracket	6	3

Illus. No.	Part No.	Description	Retail Price each		
			£	s.	d.
200	MT.47	Chain Wheel and Right Hand Crank (32T)
			19	4	
201	MT.46	Left Hand Crank
			10	3	
202	S.172	Cotter Pin
			4	½	
203	S.15	Nut for Cotter S.172
			1		
204	P.70	Plain Washer for Cotter S.172
			1	½	
N.I.	S.172C	Cotter Pin Complete
			7		

PEDALS

N.I.	MT.52	Pedals 4¼" R.I.
			11	0	
207	S.677	Pedal Spindle. Left Hand
			2	3	
N.I.	S.677A	Pedal Spindle. Right Hand
			2	3	
208		5/32" Dia Ball (22 per pedal)
			2	0	grs
209	S.380	Cone
			5		
210	P.1092	Lock Washer for Cone
			4	doz	
211	S.381	Lock Nut for Cone.
			1		
212	P.707	Dust Cap
			5		
213	MT.51	Pedal Rubber
			9		
214	S.52A	Stretcher Bar
			3	½	
215	S.443	Nut for Stretcher Bar
			1		

Pedal Barrel and End Plate only supplied when ordered separately.

CHAINS

218	4512260	Pedal Chain 105 Links. ½" × ⅜" Perry
			8	0	
219	4518183	Connecting Link. ½" × ⅜" Perry
			6		
220	4519486	Driving Chain 112 Links ½" × ⅜"
			12	9	
221	4512274	Connecting Link
			6		

WHEEL GROUP

Front Wheel

222	MF.100	Rim (32 Hole)
			18	0	
223	MF.86/87	16 of each Spokes. MF.86 (14g × 10.19/32") MF.87 (14g × 10.7/32")
			6	9	grs
224	S.726	Nipples
			3	0	grs
225	K.458ZA	Brake Shoe c/w. Linings, End caps, springs and K.456 Fulcrum Sleeve
			9	3	pr
226	K.166	Brake Shoe Spring
			3	½	
227	I.B.162	Axle Nut
			4		
228	X.42A	Axle Washer ½" thick
			2		
229	LB.155A	Cone Lock Nut
			3		

Illus. No.	Part No.	Description	Retail Price each		
			£	s.	d.
282	K.457BZ	Rear Brake Plate
			4	3	
283	LB.166	Cam Lever
			1	0	
284	K.175	Cam Lever Nut
			2		
285	N.43A	Brake Arm Clip or Chain Tensioner Arm Clip
			7		
286	X.69	Brake Arm Clip Screw
			2		
287	S.98	Brake Arm Clip Screw Nut
			1		
288	X.69A	Screw
			2		
289	K.175	Nut
			2		
290	MT.25	Chain Tensioner Arm (Large)
			1	0	
291	MT.32	Chain Tensioner Arm (Small)
			1	0	
292	MT.30	Chain Tensioner Sprocket Assembly
			4	6	
293	MT.27	Chain Tensioner Sprocket Spindle
			8		
294	ME.30	Chain Tensioner Spindle Nut
			2	½	
295	M.208	Chain Tensioner Spindle Washer
			7	½	grs
296	MT.23	Rear Wheel Sprocket. 55T
			1	0	9
297	MH.7	Bolt for Rear Wheel Sprocket
			4		
298	K.175	Nut for Sprocket Bolt
			2		
299	GL.654	Washer for Sprocket Bolt
			1	3	doz
300	4511827	Freewheel. Bayliss Wiley 20T.
			8	4	
N.I.	MF.107	Rear Wheel complete inc., Brake Plate and Shoes. Less tyre, tube, freewheel and sprocket
			4	5	0

FAIRING AND FITTINGS

303	MF.35	Fairing. Right Hand
			1	0	0
304	HV.2551	Grommet for Right Hand Fairing
			2	½	
N.I.	MF.36	Fairing. Left Hand
			1	0	0
305	MF.39	Fairing Bracket (Front)
			1	3	
306	MF.40	Fairing Bracket (Lower Rear)
			8		
307	MF.181	Fairing Screws
			2		
308	MF.41	Fairing Clip for Backstay
			11		

TOOL KIT

N.I.	ME.73	Screwdriver
			7		
N.I.	ME.74	Sparking Plug Spanner
			1	3	
N.I.	ME.75	Cylinder Head Spanner
			11		
N.I.	P.1463	Combination Spanner
			1	5	
N.I.	ME.76	Spanner
			1	10	
N.I.	P.1658	Spanner
			1	3	

230	LB.358Z	Right Hand Cone with Dust Cap	..	1	9	
231	LB.405	Outer Dust Cap	..	1	1/2	
232	K.67Z	Ball Cage	..	7		
233	LB.401Z	Front Hub (32 Holes) Shell only	..	15	0	
234	LB.426B	Front Wheel Spindle. 4 3/4"	..	1	1	
236	LB.357AZ	Left Hand Cone with Dust Cap	..	1	9	
237	LB.159	Packing Washer	..	1	3/8	
238	K.428	Notched Cone Adjuster	..	3		
239	X.42A	Axle Washer 1/8" thick	..	2		
240	K.456	Brake Fulcrum Sleeve	..	10		
241	K.459A	Brake Shoe End Cap	..	2		
242	K.452	Brake Operating Cam	..	1	7	
243	LB.430Z	Brake Plate and Arm	..	5	9	
244	LB.149	Cam Lever	..	1	0	
245	K.175	Cam Lever Nut	..	2		
246	K.171	Wire Guide	..	1	0	
247	K.360	Spacing Washer	..	2		
248	LB.112A	Brake Arm Clip (Chrome)	..	8	1/2	
249	X.69A	Clip Screw	..	2		
250	S.93	Clip Screw Nut	..	1		
	LB.112AZ	Brake Arm Clip c/w Nut and Screw	..	1	0	
N.I.	MF.106	Front Wheel complete inc. Brake Plate, Shoes etc. Less tyre and tube	..	3	7	6

Rear Wheel

254	MF.101	Rim (40 Hole)	..	18	0	
255	MF.88	Spokes 12/14g x 10.7/16"	..	2	1/2 ea	
256	K.520	Axle Nut	..	4		
257	X.42A	Axle Nut Washer	..	2		
258	S.20AC	Chain Adjuster Complete	..	1	0	
259	K.47A	Cone Lock Nut	..	2		
260	X.42	Axle Washer 1/16" thick	..	1		
261	K.506Z	Right Hand Cone with Dust Cap	..	1	9	
262	LB.405	Outer Dust Cap	..	1	1/2	
263	K.67Z	Ball Cage	..	7		
264	MH.6	Axle (Rear)	..	1	9	
265	MH.2	Rear Hub Shell	..	1	5	6
266	K.105AZ	Adjusting Cone (Left Hand)	..	1	9	
267	K.360	Packing Washer	..	2		
268	K.428	Notched Cone Adjuster	..	3		
269	X.42A	Axle Washer 1/8" thick	..	2		
275	K.458AZ	Brake Shoes c/w. Linings, Springs, Fulcrum Pin K.456A and End Caps	..	9	3	pr
276	K.166	Brake Shoe Springs	..	3	1/2	
277	K.459A	Brake Shoe End Caps	..	2		
278	K.452	Brake Operating Cam	..	1	7	
279	K.456A	Brake Fulcrum Pin	..	11		
280	K.175	Brake Fulcrum Pin Nut	..	2		
281	LB.159	Packing Washer	..	1	1/2	

ACCESSORIES

N.I.	4519498	Legshields c/w Fittings (grey)	..	2	19	6
N.I.	4519497	Windscreen c/w Fittings	..	3	9	6
N.I.	4519455	Speedometer c/w Fittings	..	2	9	6
N.I.	4519456	Panniers (2 per set) (incl.3/7 P/tax)	..	1	5	6
N.I.	4519457	Inflator	..	7	3	

SPECIAL SERVICE TOOLS

N.I.	MS.1	Crankshaft Jig	..	2	18	6
N.I.	MS.2	Crankshaft Removal Adaptor	..	13	7	
N.I.	MS.3	Crankshaft Assembly Adaptor	..	4	3	
N.I.	MS.4	Crankshaft Thread Adaptor Nut	..	3	3	
N.I.	MS.6	Crankshaft Bearing Rolling-in-Tool	..	1	1	0
N.I.	MS.7	Oil Seal Assembly Tool	..	3	6	
N.I.	MS.8	Flywheel Extractor	..	5	9	
N.I.	MS.9	Crankshaft Pulley Extractor	..	11	10	
N.I.	MS.10	Crankshaft Pulley Assembly Tool	..	8	2	
N.I.	MS.11	Crankcase Dowel Extractor	..	3	5	
N.I.	MS.12	Piston Stop	..	2	0	
N.I.	MS.13	Gudgeon Pin Assembly and Removal Tool	..	1	2	5
N.I.	MS.14	Engine Needle Bearing Assembly Tool	..	10	0	
N.I.	MS.15	Engine Mounting Bush Tool	..	7	0	
N.I.	MS.18	Bottom Bracket Sleeve Bearing Assembly Tool	..	19	0	
N.I.	MS.19	Driving Shaft Bearing Assembly Tool	..	14	10	
N.I.	MS.20	Driving Shaft Spring Ring Assembly Tool	..	12	0	
N.I.	MS.21	Driving Pin Ball & Spring Assembly Tool	..	1	3	
N.I.	MS.69	C/Shaft Thread Adaptor for use with Flywheel Extractor. Supplied with MS.8	..	2	0	
N.I.	MS.24	Clutch Brake Assy. Tool	..	16	8	
N.I.	MS.74	Clutch Plate Assy. Tool	..	17	10	

*New frames can only be supplied to replace existing ones damaged beyond repair.

ABBREVIATIONS USED

N.I. Not Illustrated.
c/w Complete with.
P.T. Purchase Tax.

A.D.-M/14/26/62/85/158

PRINTED IN ENGLAND

SUPPLEMENT TO MOPED FRAME LIST FOR R.M.2C

PETROL TANK AND FITTINGS

		£	s.	d.
6235000	Petrol Tank (CF.8)	2	12	6
MF.221	Chrome Cover Plate	2	9	
MF.224	Spring Clip			4
MF.97	Plastic Cover Strip	2	5	
MF.216	Tank Bkt. Plate (CF.8)			11
S.562	Screw for Tank Bkt. Plate			3
M.208	Spring Washer			7½ grs
6235001	Tank Fairing Assy.	7	3	
MF.11	Clip (Heavy Gauge)			7
ME.105	Screw			2
MF.241	"Nyloc" Nut			4
MF.159	Spring Washer			7½ grs
MF.9	Tank Bolt			8
GL.654	Shakeproof Washer			1
MF.241	"Nyloc" Nut			4
T.135/R1	Rotherham Petrol Tap	9	6	
MF.157	1/16" Fibre Washer			2½
MF.192	3/32" Fibre Washer			1
MF.67	Fuel Pipe. 6⅞"			11
MF.155	Fuel Pipe Filter (Intermit Ltd.) ..			4

BOTTOM BRACKET GROUP

MT.99	Low Gear Sprocket. 11T	3	0
MT.100	Spacer		11

NOTE:- Mudguards, Tailpiece and Fairings can be supplied in Grey Finish (C.F.48) or Maroon Finish. (CF.8).

IceniCAM Information Service

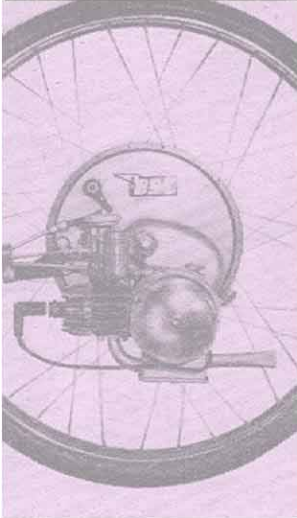

www.icenicam.org.uk