

IceniCAM Information Service

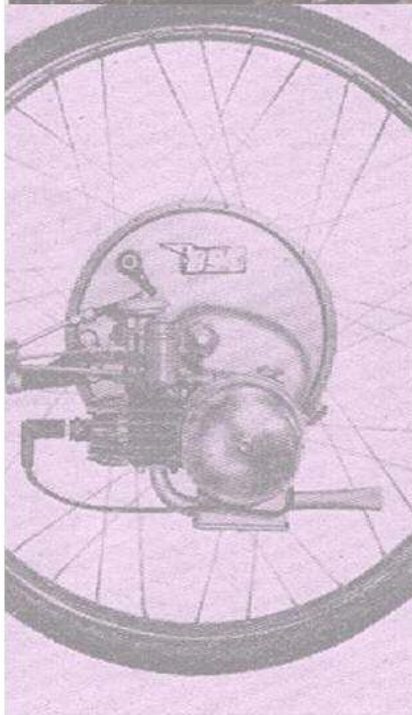

www.icenicam.org.uk

Steyr-Daimler-Puch (Great Britain) Ltd.

Steyr-Puch House
211 Lower Parliament Street
Nottingham NG 1 1 FZ
ENGLAND

Telephone: Nottingham (0 6 02) 56 5 21
Telex 37197



England

VS50 SPORT (VZ50-3P) Spare-Parts Catalogue

Edition May 1972

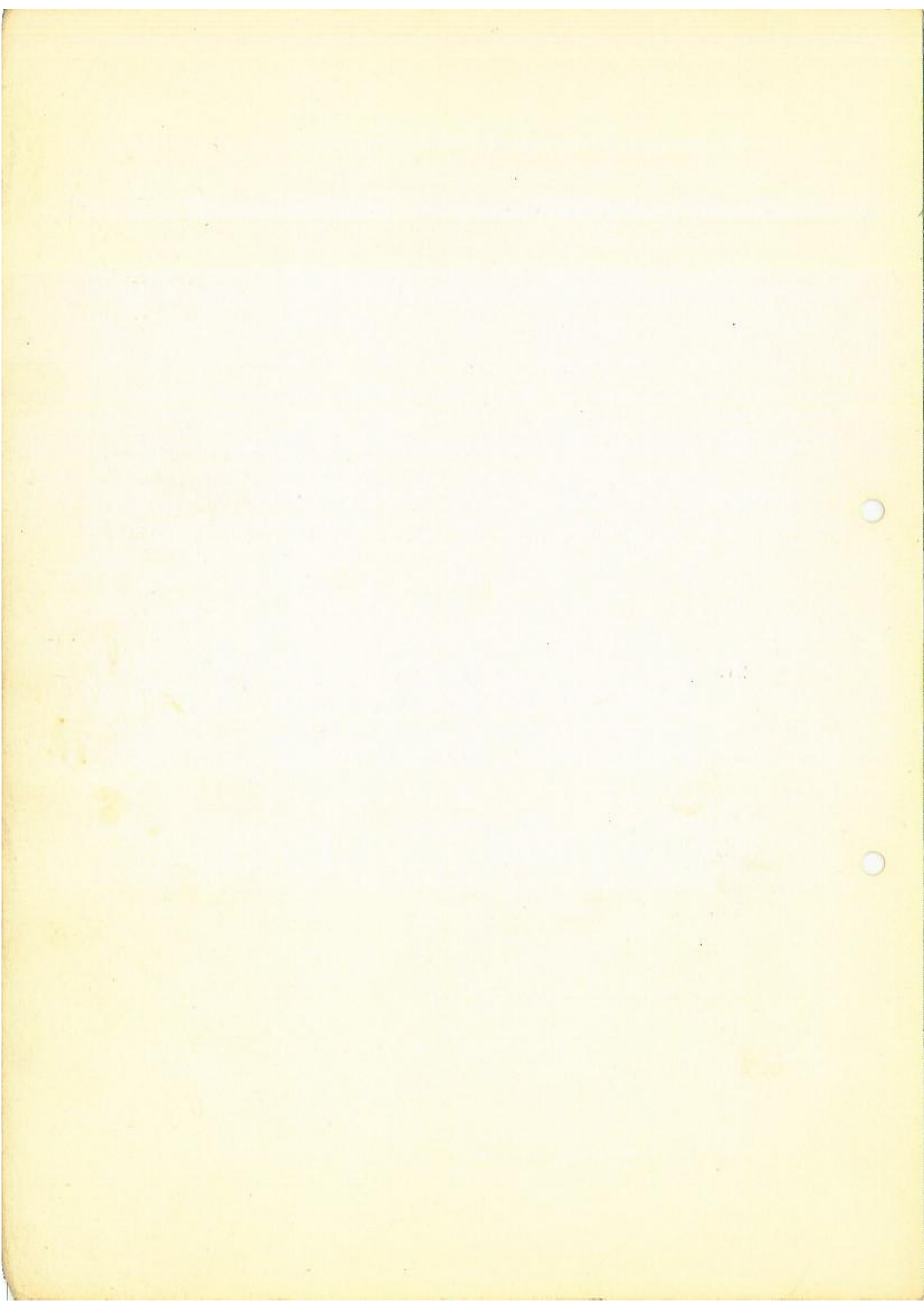



CONTENTS

ENGINE

1. CRANKCASE
2. CYLINDER, ENGINE PARTS
3. CLUTCH
4. GEARBOX 3rd SPEED
5. STARTER MECHANISM, CRANKS, PEDALS
(version with pedals and back-peddalling-brake)
6. HAND CONTROL 3rd SPEED (parts of gearbox)
7. CARBURETTOR (manufacture-Bing dia.12)
8. INTAKE SILENCER FOR CARBURETTOR dia.12
9. EXHAUST
10. GENERATOR

CHASSIS

13. FUEL TANK
14. FRAME
15. MUDGUARD
16. SINGLE SEAT, CARRIER
17. PIVOTED FORK, CENTRE STAND
18. SUSPENSION UNIT FOR REAR WHEEL

FRONT FORK

19. FRONT FORK WITH STEERING
20. HANDLEBAR AND CONTROLS
21. BOWDEN CABLES

ROAD WHEELS

22. SPEEDOMETER AND DRIVING SHAFT
23. FRONT WHEEL WITH SPEEDOMETER DRIVE
24. REAR WHEEL, DRIVING CHAIN

ELECTRICAL EQUIPMENT

25. HEADLAMP, DIP SWITCH, BUZZER, TAIL-
STOP-LIGHT

ACCESSORIES

26. TOOLS

To convert millimeters to inches, multiply by 0,03937

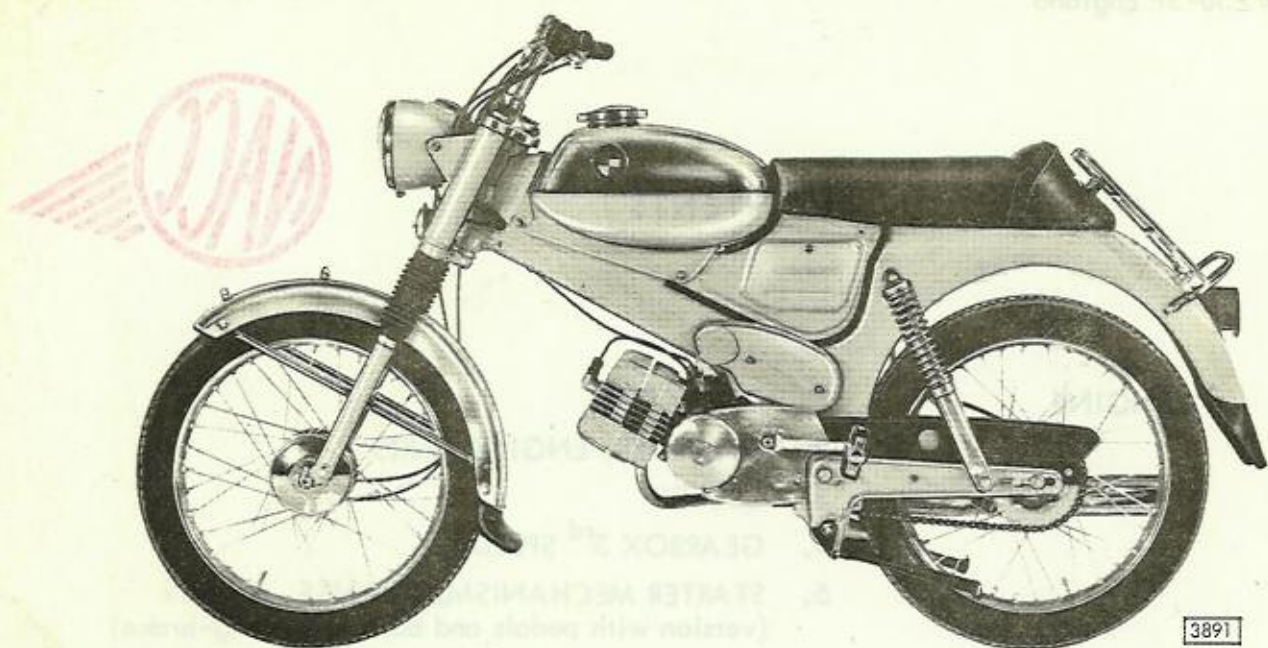

VZ 50 - 3 P / 1972 VIEW l.h.s.

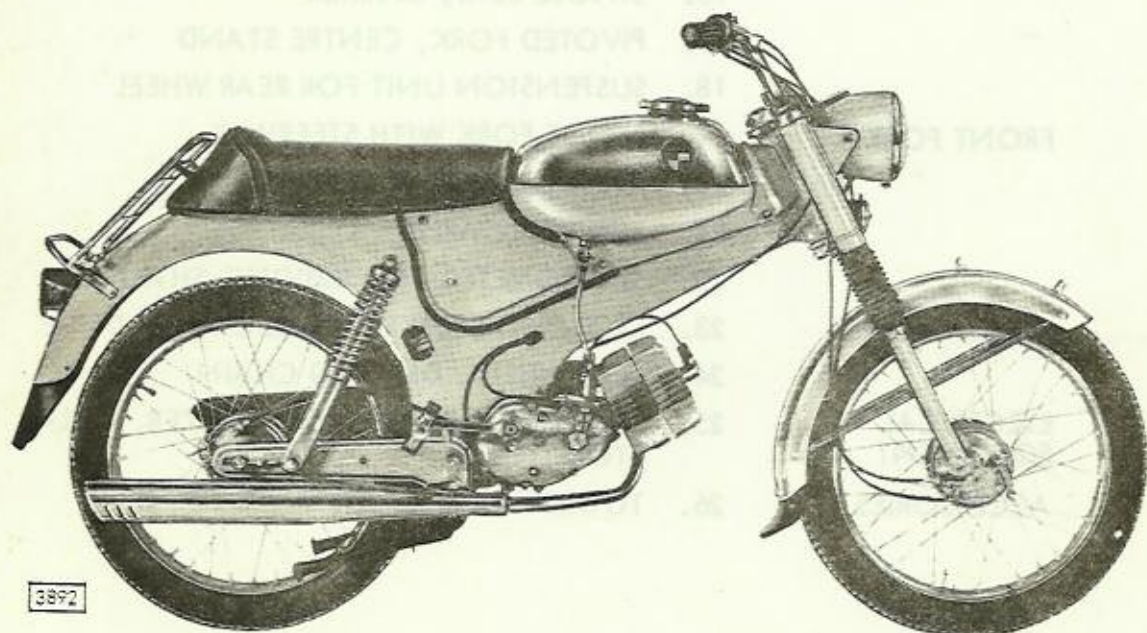

VZ 50 - 3 P / 1972 VIEW r.h.s.

PUCH VZ50 - 3P

ENGINE

PUCH V250 - 3P

ENGINE

IMPORTANT I

To get a quick and correct settlement of your spare parts orders following statements are necessary:

1. Exact statement of vehicle
2. Engine no.
3. Spare parts no.
4. Description
5. Colour
6. Required quantity
7. Wanted way of delivery

Beside this our general terms of sale and delivery are valuable.

Please direct your orders to:

place for stamp

GENERAL EXPLANATIONS

Statements as "left", "right", "front", "rear" at the description of spare parts are referring to the moving direction of vehicle. The given dimensions (in mm) for particular parts have to be considered as standards. (To convert millimeters to inches, multiply by 0,03937).

A ref.no. within brackets before a spare part means, that the said part is only similar to the illustration.

A "N" before the statement of reqd. quantity is marking a standard part. The abbreviation "as reqd." means "as required"; the abbreviation "p.m." means "per meter".

The content of the present manual is not obliging for delivery and equipment of vehicle.

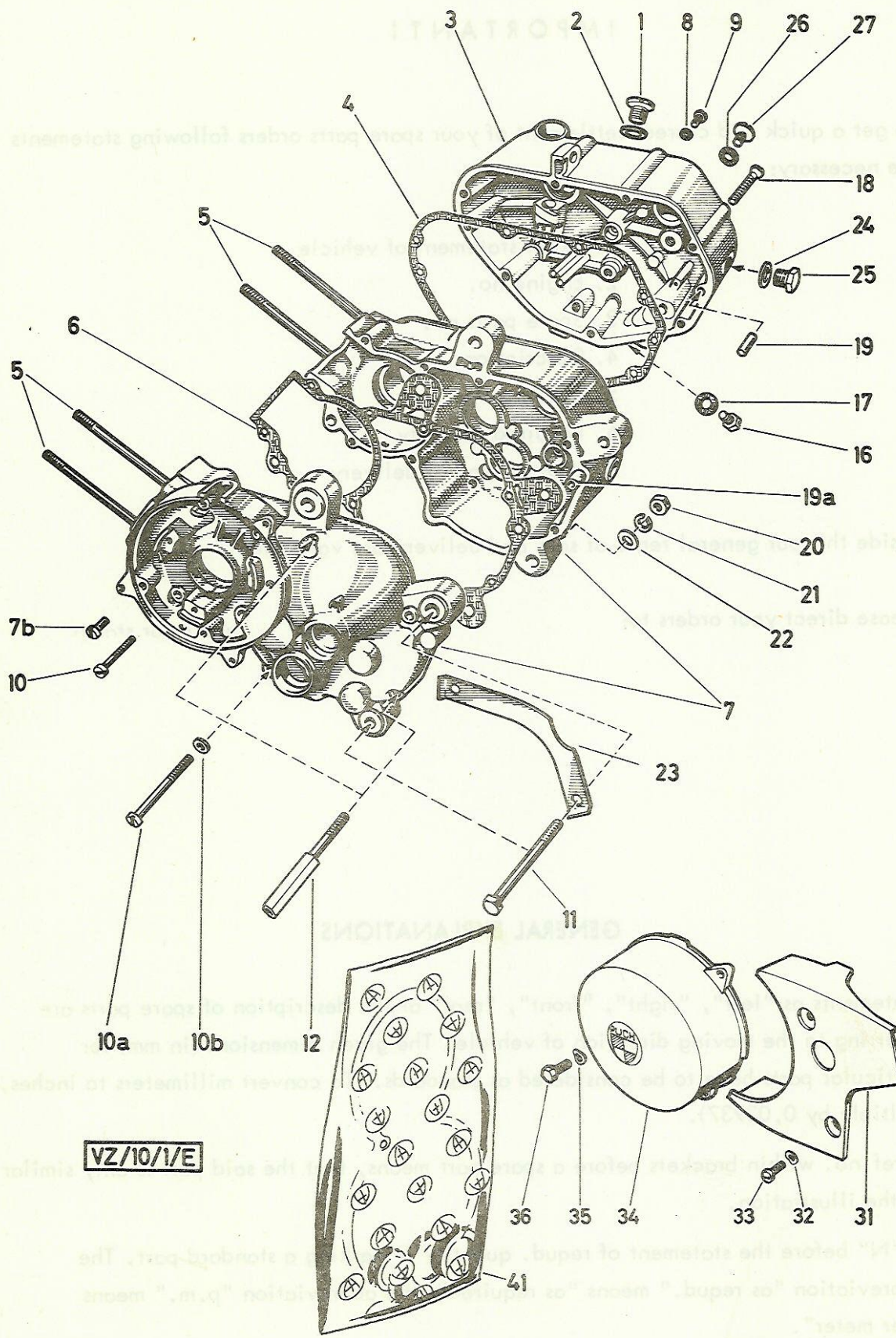

VZ/10/1/E

The content of the present manual is not obliging for delivery and equipment of vehicles.

Edition May 1972

1. CRANKCASE

Pos- No.	Part-No.	Description	Required No.
1	364.1.10.660.1	OIL FILLER PLUG	1
2	27071	SEAL WASHER A10x14 DIN 7603	N 1
3	360.6.10.035.0	CRANKCASE COVER compl.	1
4	050.1.1049	CRANKCASE COVER GASKET	1
5	360.1.10.034.1	STUD BOLT (M6, 103 long)	4
6	328.1.10.731.1	CRANKCASE GASKET (replacement for 050.10.1031)	1
7	360.1.10.532.0	CRANKCASE compl.	1
7b	1426	CHEESE HEAD SCREW M5x8 DIN 84 (for tapped hole lock)	N 4
8	24365	SEAL WASHER A6x12 DIN 7603	N 1
9	900.1305	CHEESE HEAD SCREW M6x8 DIN 84	N 1
10	900.1319	CHEESE HEAD SCREW M6x35 DIN 84	N 6
10a	901.1310	CHEESE HEAD SCREW M6, 83 long DIN 84	N 2
10b	901.3925	WASHER AL 11/6/2	2
11	901.1001	HEXAGON HEAD SCREW M8x1x75 DIN 960-8G for engine suspension	N 3
12	350.2.10.030.1	SCREW (M6, 90 long) for sheating-fixing	2
16	901.1053	HEXAGON HEAD SCREW M8x10 Sz DIN 933	N 1
(16)	366.1.10.036.2	MAGNETIC SCREW (M8)	as req.
17	26482	SEAL WASHER A8x14 DIN 7603	N 1
18	900.1637	LENS HEAD SCREW CM6x70 DIN 91	N 4
18	900.1653	LENS HEAD SCREW M6x50 DIN 91	N 2
18	900.1614	LENS HEAD SCREW M6x45 DIN 91	N 1
19	900.4810	CYLINDRICAL PIN 6h8x18 DIN 7	N 2
19a	050.10.1054	SPACER 10/8/20	2
20	900.2021	HEXAGON NUT M8x1 DIN 934-8G	N 3
21	26819	SPRING RING B8 DIN 127	N 1
22	24806	WASHER 8,4 DIN 433	N 1
23	050.1.1096	LOCKING PLATE	1
24	27071	SEAL WASHER A10x14 DIN 7603	as req.
25	350.1.13.048.1	THREADING	as req.
26	26482	SEAL WASHER A8x14 DIN 7603	N 1
27	900.1512	LENS HEAD SCREW AM8x10 DIN 85	N 1

1. CRANKCASE (cont.)

Pos- No.	Part-No.	Description	Required No.
31	357.1.10.564.1	SHEATING	1
32	900.3205	SPRING WASHER A5 DIN 137	N 2
33	27157	LENS HEAD SCREW AM5x20 DIN 85	N 2
34	325.1.50.012.1	COVER	1
35	900.3213	SPRING WASHER B6 DIN 137	N 3
36	24928	HEXAGON HEAD SCREW M6x16 DIN 933	N 3
41	357.1.10.510.0	SET OF GASKET	1
		CHEESE HEAD SCREW M6x8 DIN 84	1
		(for tapped hole lock)	
		SEAL WASHER A6x12 DIN 7603	8
		CHEESE HEAD SCREW M6x8 DIN 84	9
		CHEESE HEAD SCREW M6x35 DIN 84	10
		CHEESE HEAD SCREW M6, 83 long	10a
		DIN 84	
		WASHER A11x12	10b
		HEXAGON HEAD SCREW	11
		M6x12 DIN 933-80	
		for engine suspension	
		SCREW (M6, 90 long) for sheathing-fixing	12
		HEXAGON HEAD SCREW	16
		M6x10 2x DIN 933	
		MAGNETIC SCREW (M8)	(18)
		SEAL WASHER A6x14 DIN 7603	17
		LENS HEAD SCREW CMx20 DIN 91	18
		LENS HEAD SCREW M6x30 DIN 91	18
		LENS HEAD SCREW M6x5 DIN 91	18
		CYLINDRICAL PIN 6x6x18 DIN 7	19
		SPACER 10x8x30	19a
		HEXAGON NUT M6x1 DIN 934-80	20
		SPRING RING B6 DIN 137	21
		WASHER B, 4 DIN 433	22
		LOCKING PLATE	23
		SEAL WASHER A10x14 DIN 7603	24
		THREADING	25
		SEAL WASHER A6x14 DIN 7603	26
		LENS HEAD SCREW AM6x10 DIN 85	27

MSE 1073



MSE/10/3

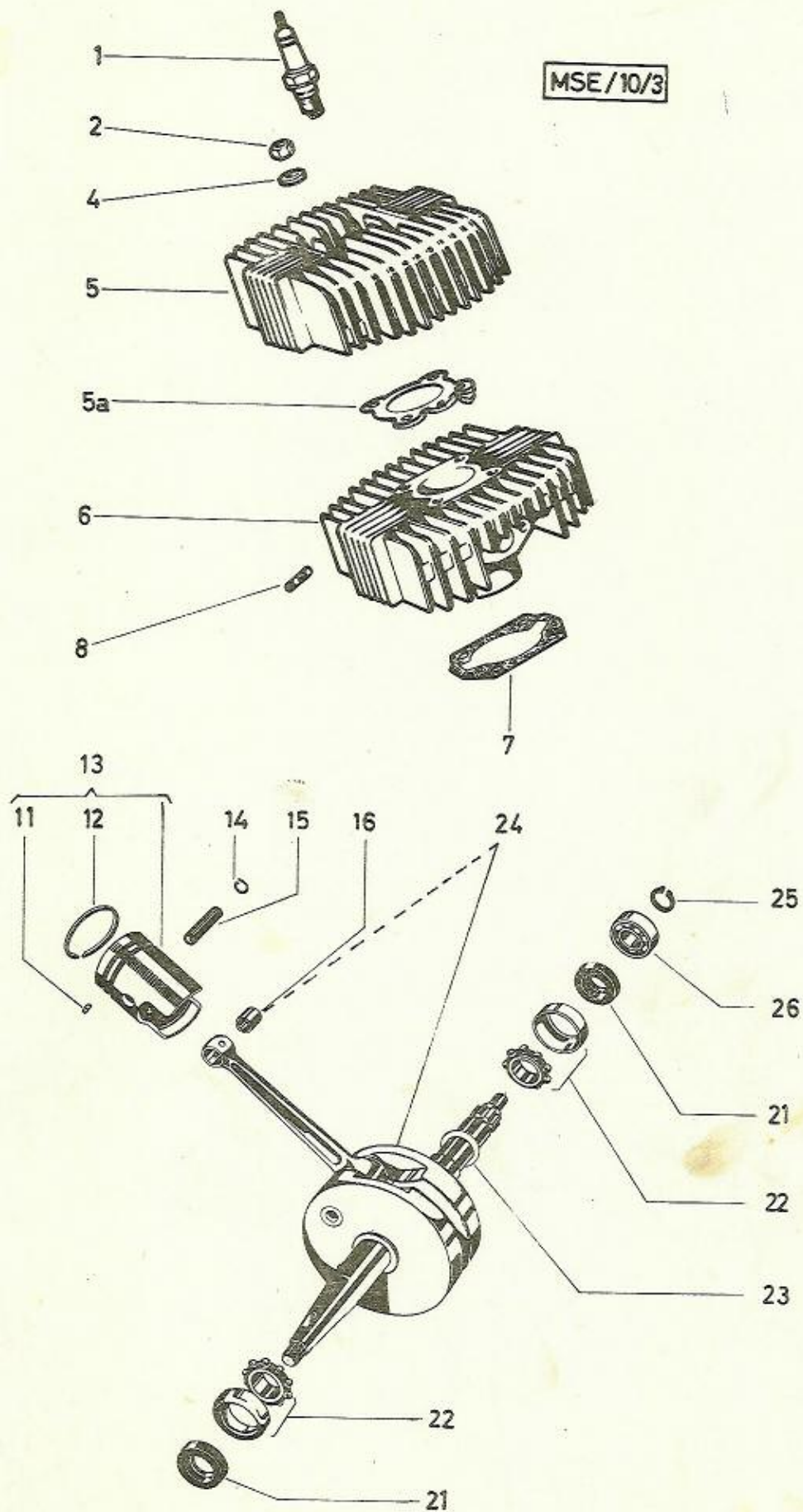

2. CYLINDER, ENGINE PARTS

Pos- No.	Part-No.	Description	Required No.
1	902.0727	SPARK PLUG Champion L5	1
2	900.2014	HEXAGON NUT M6 DIN 934	} for cylinder cover N 4
4	24804	WASHER 6,4 DIN 433	
5	328.3.10.501.1	CYLINDER HEAD COVER	1
5a	349.1.10.004.1	CYLINDER HEAD GASKET (Alu-folie 0,1mm thick, 4-fold)	1
6	328.7.10.505.2	CYLINDER normal dia.38	} we recommend to keep in stock only cylinder with piston compl.
6	328.7.10.505.3	CYLINDER, oversize dia.38,5	
6	328.7.10.505.0	CYLINDER with piston compl.350.1.10.006.0 dia.38 with gudgeon pin and wire spring ring	1
6	328.7.10.505.6	CYLINDER with piston compl.350.1.10.006.4, oversize 38,5, with gudgeon pin and wire spring ring, new part, part for exchange ^x	1
7	328.2.10.513.1	CYLINDER FLANGE GASKET	1
8	050.1.1014	FIXING STUD (M6x16)	2
11	900.4855	LOCKING PIN dia.2x6 DIN 1473	N 2
12	320.1.10.060.1	PISTON RING AZ38x2ac DIN 73102	N 2
12	320.1.10.060.3	PISTON RING AZ38,5x2ac oversize	2
13	350.1.10.006.0/03 ^{xx}	PISTON compl., normal, dia.38, sort.1	1
13	350.1.10.006.0/04 ^{xx}	PISTON compl., normal, dia.38, sort.2	1
13	350.1.10.006.4/03 ^{xx}	PISTON compl., oversize dia.38,5, sort.1	1
13	350.1.10.006.4/04 ^{xx}	PISTON compl., oversize dia.38,5, sort.2	1
14	901.4701	WIRE SPRING RING B12 DIN 73123	N 2
15	331.1.10.011.1/12 ^{xx}	GUDGEON PIN dia.12, 31 long, sort.2 (white)	} as req. 1
15	331.1.10.011.1/13 ^{xx}	GUDGEON PIN dia.12, 31 long, sort.3 (blue)	
16	349.1.10.021.1	BUSH for connecting rod 14/11,6/12	1
16	349.1.10.021.3	BUSH for connecting rod (for repair)	as req.
21	900.3807	SEAL WASHER BA35/17/7	2
22	900.2.6007	BALL BEARING L17 40/17/10 DIN 615	(N)2
23	900.3992	DIFFERENTIAL WASHER 24/18,1/0,05	} as required -
23	900.3922	DIFFERENTIAL WASHER 24/18,1/0,1	
23	900.3923	DIFFERENTIAL WASHER 24/18,1/0,2	

^xIf you exchange parts the cylinder must not have damages, for instance rupturing ribs.

^{xx}Ordering pistons or gudgeon pins we ask to state the required piston assortment 1 or 2.
(Pressed-on no.1 or 2 on piston ground, choose piston as recommendet in our
Service Bulletins).

2. CYLINDER, ENGINE PARTS (cont.)

Pos- No.	Part-No.	Description	Required No.
24	360.3.10.115.0	CRANKSHAFT compl. (with connecting rod, dia.12mm) bevel 1:5	1
25	900.4619	CIRCLIP Sg 15x1 DIN 471	1
26	900.6202	BALL RACE 6202 C3 35/15/11 DIN 625 (replaceable by 900.4.6202)	(N)1

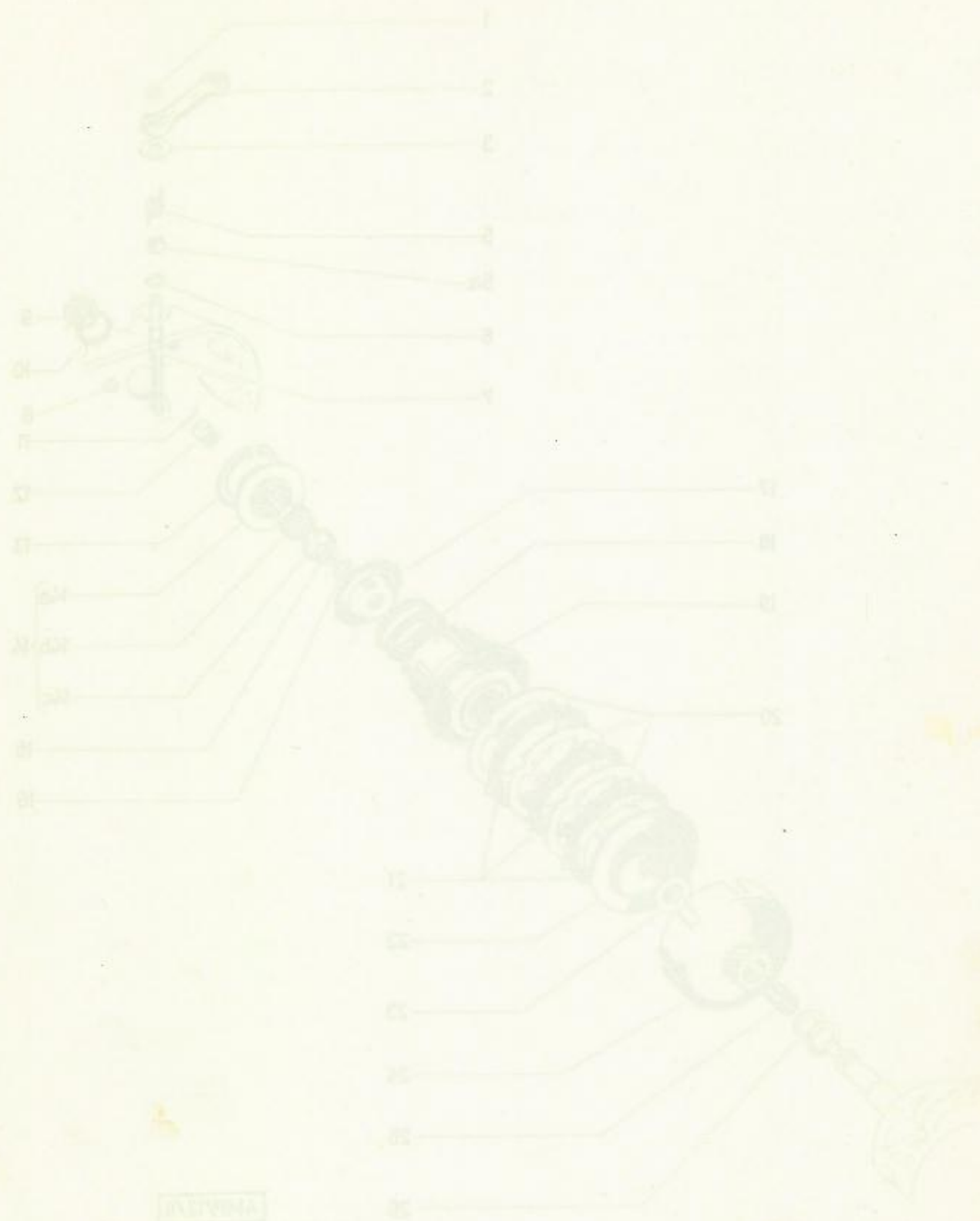

YAMAHA

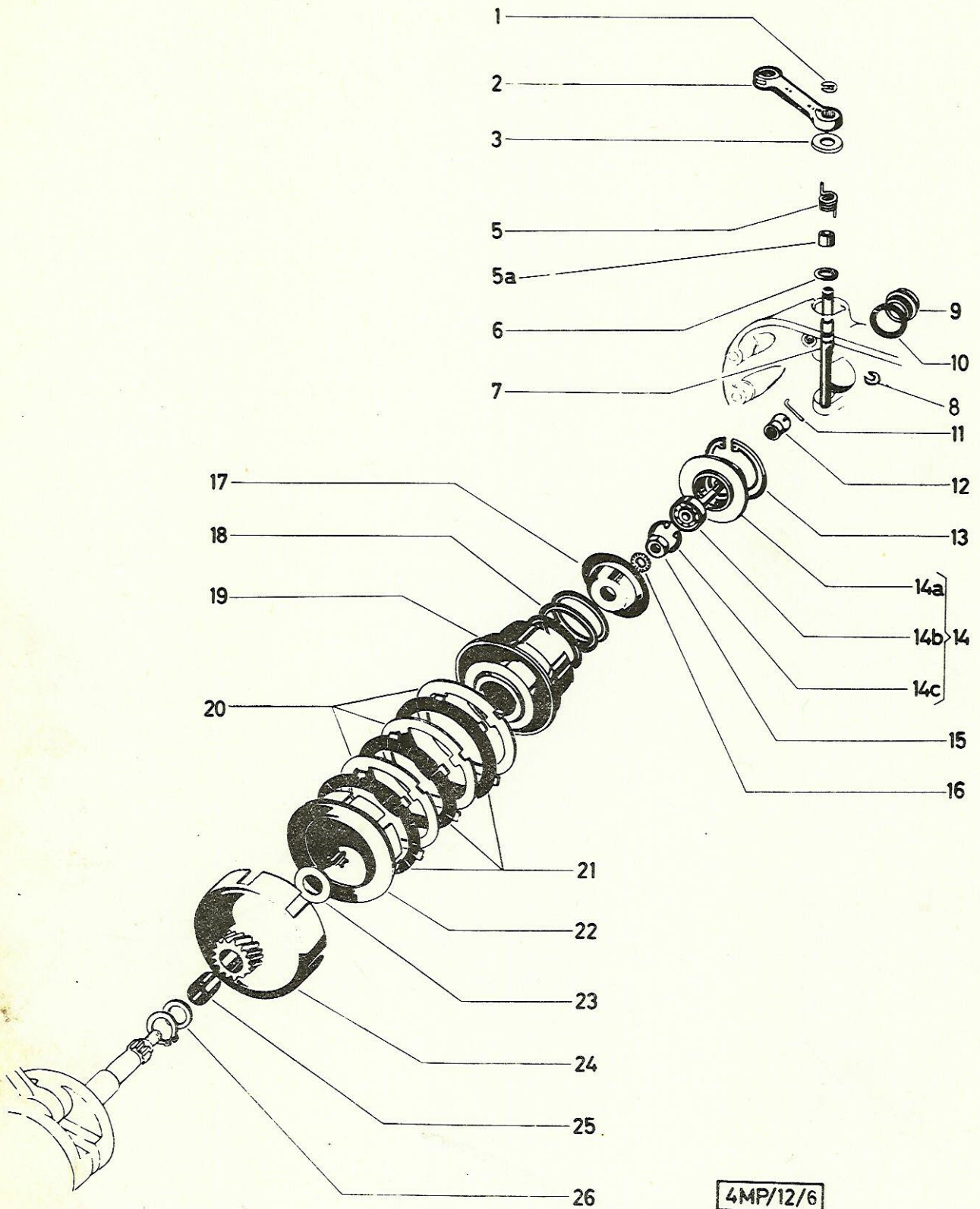

4MP/12/6

3. CLUTCH

Pos- No.	Part-No.	Description	Required No.
1	900.4606	BZ-WASHER 6 DIN 6799	N 1
2	050.2.1231	DECLUTCHING LEVER	1
3	350.1.12.019.1	COVERING PLATE (plastic)	1
5	350.2.12.022.1	TORSION SPRING dia.15 thickness of wires dia.1,8	1
5a	350.1.12.029.1	SPRING GUIDE	1
6	900.3883	OIL SEAL RS 6-9-1,5	1
7	350.3.12.028.1	DECLUTCHING SHAFT	1
8	900.4693	SEEGER-O-RING H10x1	1
9	050.1.1233	CENTERING SCREW	1
10	900.3718	FIBRE SEAL WASHER 26,5/22/1	1
11	050.1237	WIRE PIN dia.2	1
12	050.1234	BALL NUT M8x1	1
13	900.4745	SNAP RING Sg 45x1,75 DIN 472	N 1
14	362.1.12.030.0	TENSION BOLT compl. (with ball bearing, bearing housing 362.1.12.010.1 and snap ring 900.4721)	1
14a	362.1.12.010.1	BEARING HOUSING	1
14b	050.1240.2	TENSION BOLT (with ball bearing, without bearing housing)	1
14c	900.4721	SNAP RING Sg 21x1 DIN 472 for bearing housing	N 1
15	26820	HEXAGON NUT M8x1 DIN 934	N 1
16	900.3265	SERRATED LOCK WASHER A8,4 DIN 6798	N 1
17	362.1.12.007.1	SPRING CUP	1
18	050.1206	CLUTCH-SPRING	1
19	362.1.12.005.1	SPRING CAGE	1
20	050.1212	INTERIOR CLUTCH DISC	3
21	050.1224.2	EXTERIOR CLUTCH DISC (with lining Semperit)	3
22	362.1.12.004.1	CLUTCH HUB	1
23	050.1215	THRUST WASHER 26/15/1	1
24	364.2.12.602.2	CLUTCH DRUM (19 teeth)	1
25	050.1211	BEARING BUSH 17/15/16,3	1
26	050.1213	THRUST WASHER 22/15/1,7	1

3. CLUTCH

Part No.	Description	Required No.
----------	-------------	--------------

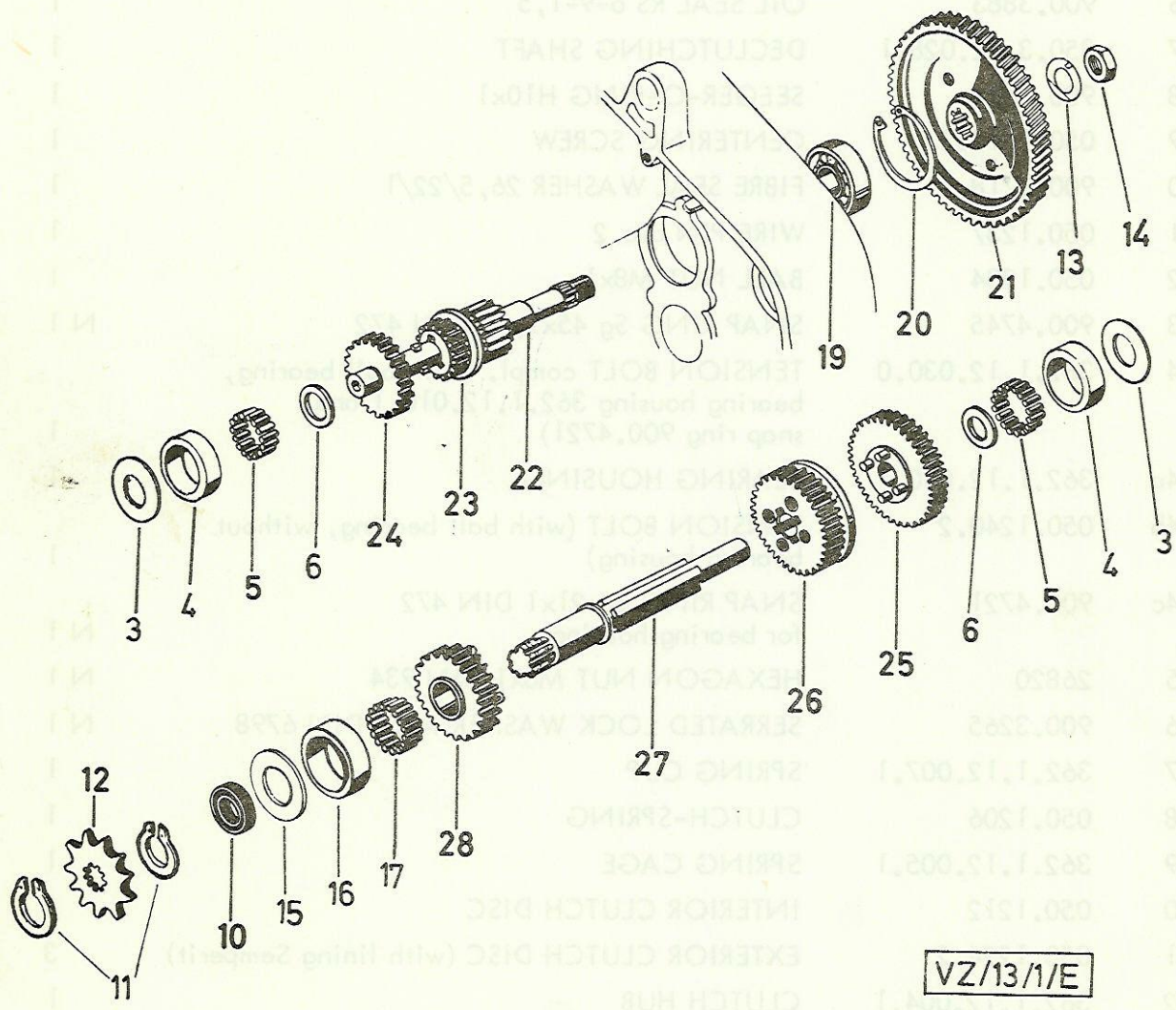

VZ/13/1/E

4. GEARBOX 3rd-SPEED

Pos- No.	Part-No.	Description	Required No.			
3	329.1.13.009.1	BEARING WASHER 27,8x16x1	2			
4	329.1.13.010.1	ROLLER RACE dia.28	2			
5	900.6104	ROLLER dia.3,5x7,5 (14 rollers to each race)	28			
6	350.1.13.075.1	THRUST WASHER 18/12,5/1,6	-			
	350.1.13.078.1	THRUST WASHER 18/12,5/1,8	-			
	350.1.13.076.1	THRUST WASHER 18/12,5/2	-			
	350.1.13.079.1	THRUST WASHER 18/12,5/2,25	-			
	350.1.13.077.1	THRUST WASHER 18/12,5/2,5	-			
	350.1.13.080.1	THRUST WASHER 18/12,5/2,75	-			
		as required				
10	050.1321	SEAL WASHER BA 28/17/7	1			
11	900.4616	LOCKING RING 16x1 DIN 471	N 2			
12	56.1.1322	GEARBOX CHAIN SPROCKET (13 teeth)	1			
13	360.1.13.004.1	LOCKING PLATE 22/12,5/1 for countershaft	1			
14	24787	HEXAGON NUT M12x1 for countershaft	1			
15	329.1.13.065.1	OUTER RACE dia.32	1			
16	329.1.13.066.1	BEARING WASHER 31,7x20x1,5	1			
17	900.6104	ROLLER dia.3,5x7,5	18			
19	900.6202	RADIAL BALL BEARING 6202 C3 35/15/11 DIN 625 (replaceable by 900.4.6202)	(N)1			
20	900.4735	SNAP RING Sg 35x1,5 DIN 472	N 1			
21	350.1.13.000.1	DRIVING GEAR (helical gear) 69 teeth	1			
22 } 23 } 24 }	360.2.13.001.2	COUNTERSHAFT(11/17/19 teeth)	1			
25				360.3.13.011.1	GEAR 1st speed (39 teeth) with groove	1
26				360.1.13.012.1	GEAR 2nd speed (34 teeth)	1
27	365.4.13.020.1	LAYSHAFT 113 long	1			
28	360.1.13.013.1	GEAR 3rd speed (24 teeth)	1			

4. GEARBOX 3rd SPEED

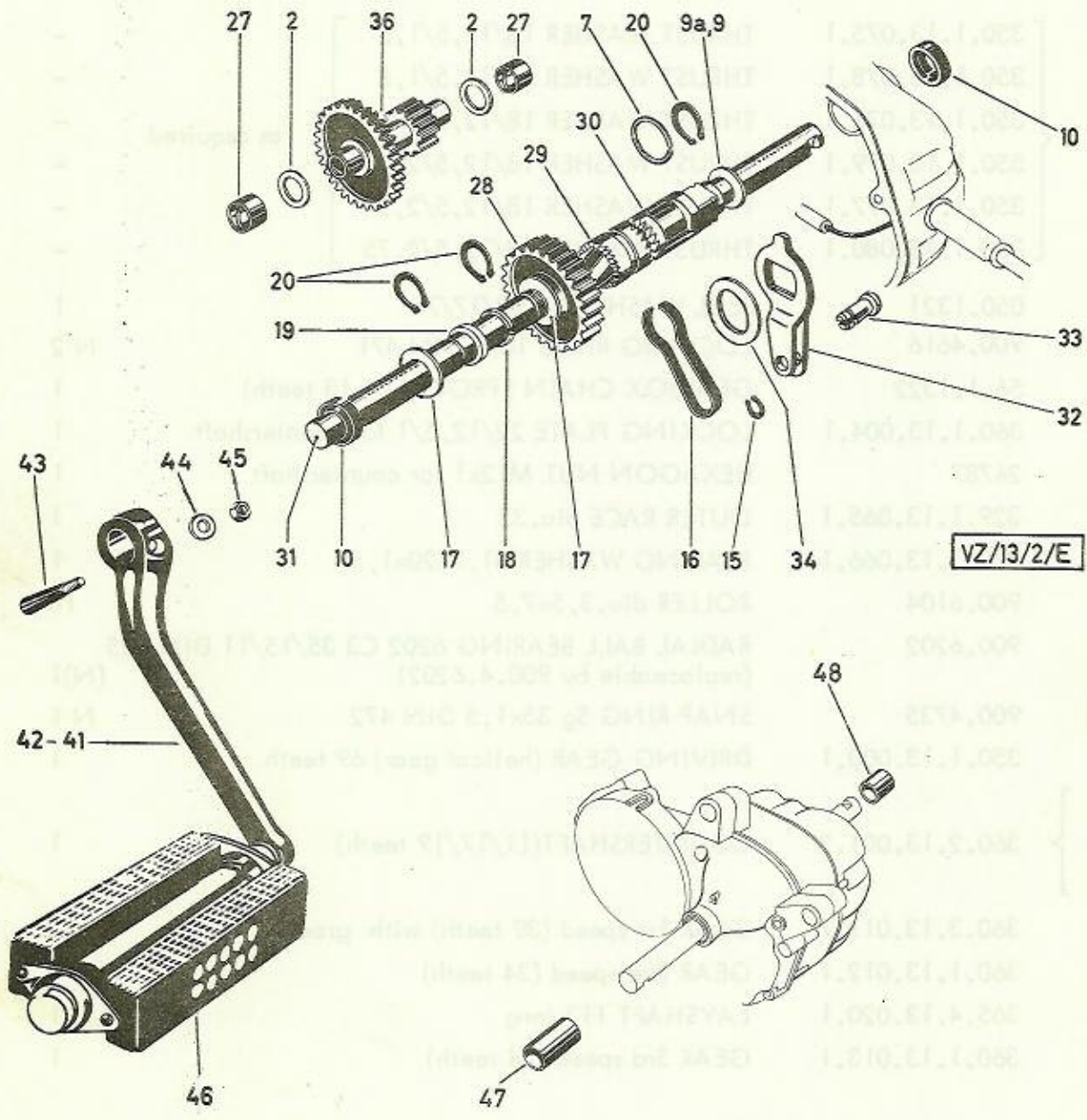

5. STARTER MECHANISM, CRANKS, PEDALS

(version with pedals and back-peddalling-brake)

Pos- No.	Part-No.	Description	Required No.
2	050.1329	THRUST WASHER 20,5/14/1,9	-
2	050.1329.2	THRUST WASHER 20,5/14/2	-
2	050.1329.3	THRUST WASHER 20,5/14/2,1	-
2	050.1329.4	THRUST WASHER 20,5/14/2,4	-
7	900.3221	RETAINING RING 26 DIN 9045	N 1
9	050.4.1353	THRUST WASHER 26/16,2/1	1
9a	900.3922	THRUST WASHER 24/18,1/0,1	-
9a	900.3923	THRUST WASHER 24/18,1/0,2	-
9a	900.3924	THRUST WASHER 24/17,1/0,5	-
10	050.1335	RUBBER SEAL RING BAOF 24/16/7	2
15	900.4610	CIRCLIP Sg 10x1 DIN 471	N 1
16	050.1.1334	BRAKE SPRING for driver	1
17	050.1343	THRUST WASHER 26/16/2	2
18	350.3.13.051.1	RETAINING RING	2
19	350.3.13.052.1	LOCKING RING	2
20	900.4616	CIRCLIP Sg 16x1 DIN 471	N 3
27	360.1.13.033.1	BUSH 17/14/10 for countershaft	2
28	364.1.13.031.1	STARTER GEAR (31/20 teeth)	1
29	360.1.13.027.1	DRIVER (20 teeth) 24 long	1
30	360.1.13.037.1	CLAW COLLAR (20 teeth) 45 long	1
31	357.3.13.032.1	PEDAL SHAFT 296 long	1
32	350.2.13.038.2	BRAKE LEVER	1
33	350.2.13.047.1	CLEVIS BOLT 22 long	1
34	900.3987	WASHER 38/27/2,5	1
36	364.1.13.030.2	COUNTERSHAFT (32 and 15 teeth)	1
41	050.1341	CRANK l.h.s.	1
42	050.1340	CRANK r.h.s.	1
43	605.1313	COTTER for crank	2
44	900.3926	WASHER for crank 14/6,5/2	2
45	900.2909	HEXAGON NUT 1/4" 26 gear/inch	2
46	600.3.18.035.0	PEDAL l.h.s. and r.h.s. compl. (with rear reflector black)	per pair 1
47	357.1.13.054.1	PROTECTION SLEEVE 18/16/38 (for pedal shaft l.h.s.)	1
48	357.1.13.055.1	PROTECTION SLEEVE 18/16/25 (for pedal shaft r.h.s.)	1

5. STARTER MECHANISM, CRANKS, PEDALS
(version with pedals and back-peddelling-brake)

Part-No. Description Required No.

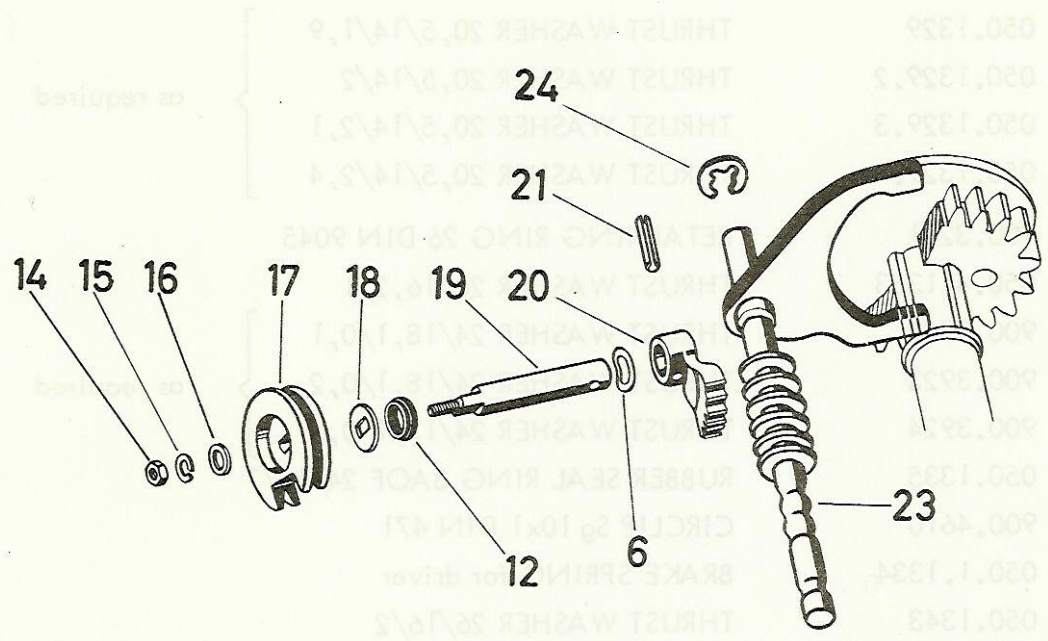

DS 60C/14/0

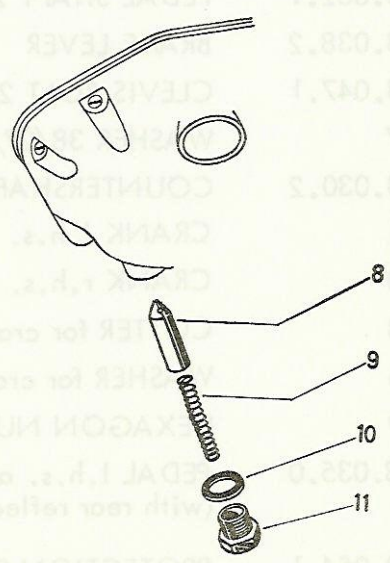

DS60C/14

per pair

PROTECTION SLEEVE 18/18/38
(for pedal shaft l.h.s.)

PROTECTION SLEEVE 18/18/25
(for pedal shaft r.h.s.)

6. HAND CONTROL 3rd SPEED (parts of gearbox)

Pos- No.	Part-No.	Description	Required-No.
6	050.1.1426	SPRING WASHER A8	1
8	050.1.4121	CATCH 19 long	1
9	100.1423	CATCH SPRING	1
10	900.4212	FIBRE SEAL RING 18/12/1	1
11	050.1.1422	CATCH GUIDE SCREW	1
12	050.1.1406	RUBBER SEAL RING dia.12/8	1
14	24772	HEXAGON NUT M5 DIN 934	N 1
15	29190	SPRING RING B5 DIN 127	N 1
16	24794	WASHER 5,3 DIN 125	N 1
17	360.1.14.017.1	GEARSHIFT DISC	1
18	360.1.14.006.1	PRESSURE WASHER dia. 14	1
19	360.1.14.002.1	GEARSHIFT LEVER SHAFT 45 long	1
20	360.1.14.003.1	GEARSHIFT SEGMENT	1
21	900.4813	SLOTTED HOLLOW PIN 4x16 DIN 1481	N 1
23	360.2.14.025.0	GEARSHIFT FORK compl. (with gearshift rail and Bz-washer)	1
24	900.4606	BZ-WASHER 6 DIN 6799	N 1

7. CARBURETTOR (manufacture - Bing dia.12)

Pos- No.	Part-No.	Description	Required-No.
--	360.5.15.500.0/52	CARBURETTOR compl. with tickler, without air filter (Bing 1/12/..., Jet-No.52)	1
1	050.1520	BOWDEN CABLE ADJUSTING SCREW (M5)	1
2	050.1517	NUT for bowden cable adjusting screw M5	1
3	050.1519	SCREW COVER	1
4	050.1518	HEAD with tube band	1
5	050.1531	THRUST SPRING for throttle	1
6	050.1513	CLAMP SPRING	1
6a	350.1.15.014.1	WASHER dia.11, 0,5 thick	1
7	050.1516	JET NEEDLE	1
8	050.1515/.. ^{xx}	THROTTLE SLIDE	1
9	900.3218	SPRING WASHER A5	1
10	360.1.15.552.1	NECK SCREW	1
11	050.1529	SPRING CLIP for air filter	} for carburettor without intake muffler
12	050.1540.2	AIR FILTER	
17	360.1.15.553.1	CHOKE VALVE	1
18	050.1509/52	MAIN JET No.52	1
18	050.1509/.. ^x	MAIN JET No... ^x	as required -
19	050.1535	CAP SCREW	2
20	364.1.15.032.2	FLOAT CHAMBER COVER with tickler	1
21	050.1536	FLOAT CHAMBER COVER GASKET	1
22	050.1530	FLOAT NEEDLE	1
23	050.1525	FLOAT	1
24	360.1.15.501.2	CARBURETTOR BODY (outside ventilation)	1
25	900.1107	HEXAGON SCREW M6x25 DIN 933	N 2
26	24804	WASHER 6,4 DIN 433	N 2
27	350.1.15.021.2	GASKET for carburettor flange	1
28	050.1508	NEEDLE JET	1
29	27071	SEAL RING A10x14 DIN 7603	N 1
30	050.1523	SCREW PLUG	1
31	050.1511	THROTTLE SLIDE STOP SCREW	1
32	24771	NUT M4 DIN 934	N 1
33	501.1.7179	RUBBER PLUG	as required 1
60	350.1.15.016.1	DIRT SPLASH GUARD	1

7. CARBURETTOR (manufacture - Bing dia.13)

Part-No.	Description	Pos- No.
----------	-------------	-------------

360.5.15.500.0/52 CARBURETTOR compl. with tickler, without air filter
(Bing 1/13, Jet-No.32)

050.1520 BOWDEN CABLE ADJUSTING SCREW (MS)

050.1517 NUT for bowden cable adjusting screw MS

050.1519 SCREW COVER

050.1518 HEAD with tube band

050.1521 THRUST SPRING for throttle

050.1513 CLAMP SPRING

350.1.15.014.1 WASHER dia. 13, 0.5 thick

050.1516 JET NEEDLE

050.1515 THROTTLE SLIDE

900.3218 SPRING WASHER A3

360.1.15.252.1 NECK SCREW

050.1529 SPRING CLIP

050.1510.3 AIR FILTER

360.1.15.252.1 CHAMFER SCREW

050.1508.3 AIR FILTER

050.1511.3 CAP SCREW

360.1.15.252.3 FLOAT CHAMBER COVER with tickler

050.1516.3 FLOAT CHAMBER COVER GASKET

050.1516.3 GASKET

050.1516.3 GASKET

050.1525 FLOAT

360.1.15.301.3 CARBURETTOR BODY (outside ventilation)

900.1107 HEXAGON SCREW Max 25 DIN 933

24804 WASHER 4 DIN 433

350.1.15.021.3 GASKET for carburetor flange

050.1508 NEEDLE JET

37071 SEAL RING 10x14 DIN 3603

050.1523 SCREW PLUG

050.1511 THROTTLE SLIDE STOP SCREW

34771 NUT M4 DIN 934

501.1.7179 RUBBER PLUG

350.1.15.016.1 DIRT SPLASH GUARD

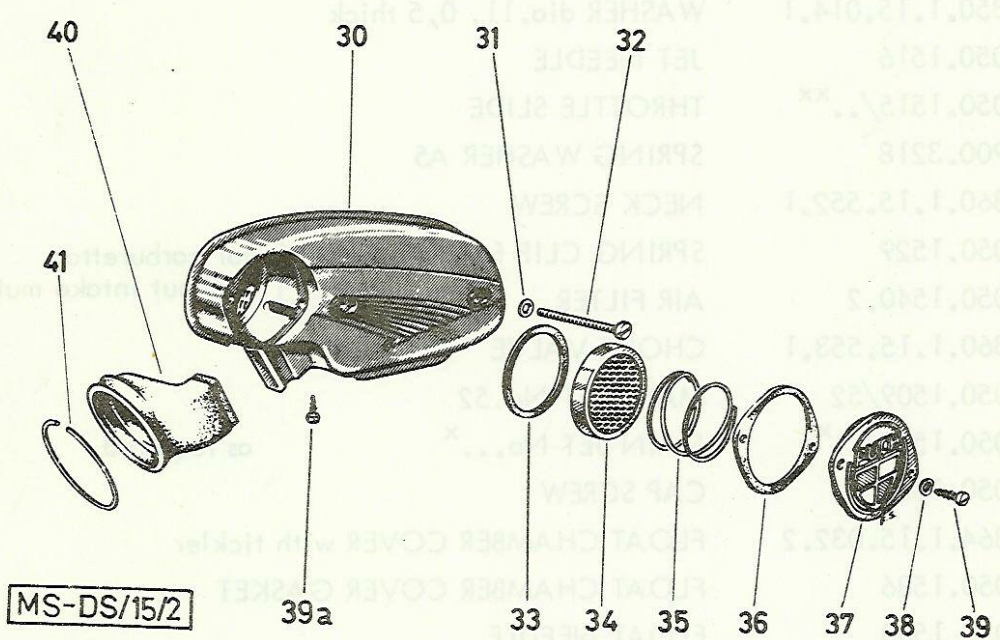

MS-DS/15/2

8. INTAKE SILENCER FOR CARBURETTOR dia.12

Pos- No.	Part-No.	Description	Required No.
30	357.1.15.070.0	INTAKE SILENCER compl. with air filter (with parts 30 and 33-39a)	1
31	24794	PLAIN WASHER 5,3 DIN 125	N2
32	900.1336	CHEESE HEAD SCREW AM5x55 DIN 84	N2
33	050.1576	SEAL RING 52/45/2	1
34	050.1540.2	AIR FILTER	1
35	250.1327	THRUST SPRING	1
36	357.1.15.079.1	GASKET for cover (replacement for 050.10.1579)	1
37	357.1.15.078.1	COVER	1
38	900.3202	SPRING WASHER A4 DIN 137	N2
39	900.9516	CHEESE HEAD TAPPING SCREW A4x13 DIN 7971	N2
39a	900.9513	CHEESE HEAD TAPPING SCREW A4x9,5 DIN 7971	N1
40	050.10.1577	CONNECTING SLEEVE	1
41	364.1.15.081.1	RETAINING RING for connecting sleeve	1

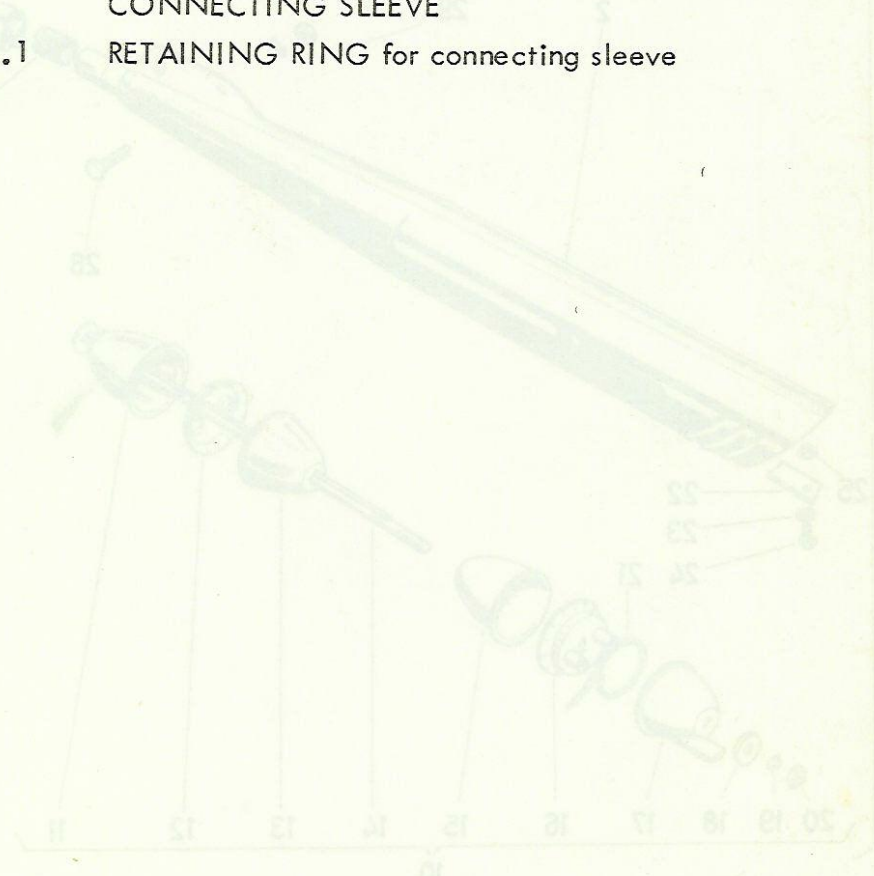

8. INTAKE SILENCER FOR CARBURETTOR 416.13

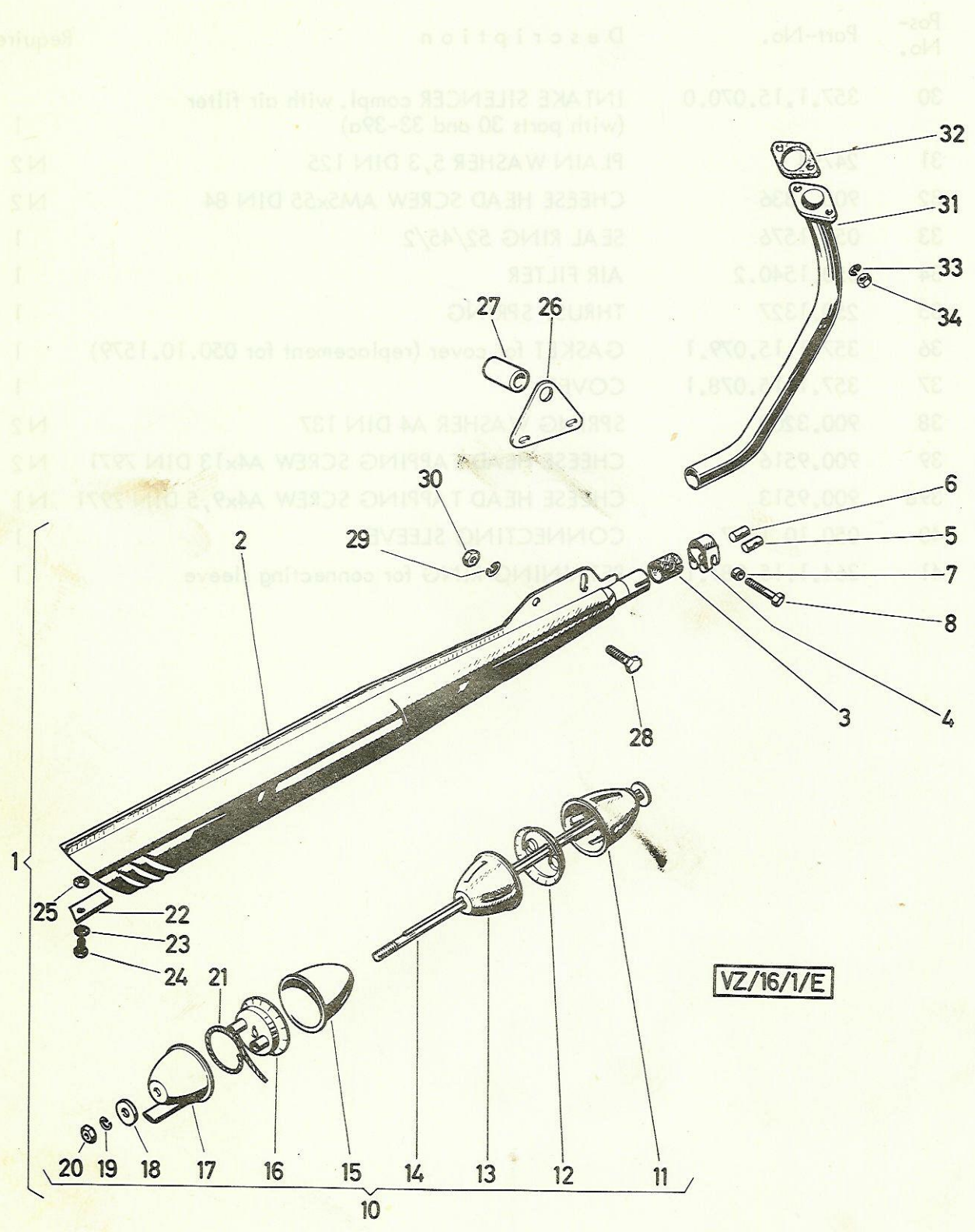

9. EXHAUST

Pos- No.	Part-No.	Description	Required-No.
1	357.2.16.500.0	EXHAUST SILENCER compl. (with parts 2-25)	1
2	357.2.16.500.2	EXHAUST COVER	1
3	328.1.16.508.1	GASKET	1
4	328.2.16.505.1	CLAMPING BAND (No.28)	1
5	367.1.16.214.1	CLAMPING BOLT dia.10, 18 long (without thread)	1
6	367.1.16.215.1	CLAMPING BOLT dia.10, 18 long (with thread M6)	1
7	367.1.16.213.1	SLEEVE 8/6/5,5	1
8	360.1.16.506.1	ADJUSTING SCREW M6, 35 long	1
10	328.1.16.220.0	SILENCER compl.	1
11	} -----	no spare-parts	-
12			
13			
14	328.1.16.224.2	TENSION BOLT	1
15	} -----	no spare-parts	-
16			
17			
18			
19	26834	SPRING RING B6 DIN 127	N 1
20	24773	HEXAGON NUT M6 DIN 934	N 1
21	253.1635/07	ASBEST-CORD dia.3, 450 long, (to use by manifold winding)	p.m.
22	328.1.16.216.1	SPACER LINING	1
23	22803	TOOTHED LOCK WASHER J5,3 DIN 6797	N 1
24	26509	HEXAGON SCREW M5x10 DIN 933	N 1
25	900.2105	HEXAGON NUT M5 DIN 555	N 1
26	357.1.16.308.1	EXHAUST BRACKET	1
27	357.1.16.026.1	INTERMEDIATE SLEEVE (16/12, 2/27, 3)	1
28	24928	HEXAGON SCREW M6x15 DIN 933	N 2
29	26834	SPRING RING B6 DIN 127	N 2
30	24773	HEXAGON NUT M6 DIN 934	N 2
31	357.2.16.501.2	EXHAUST TUBE	1
32	050.1615	EXHAUST-FLANGE GASKET	1
33	26834	SPRING RING B6 DIN 127	N 2
34	24773	HEXAGON NUT M6 DIN 934	N 2

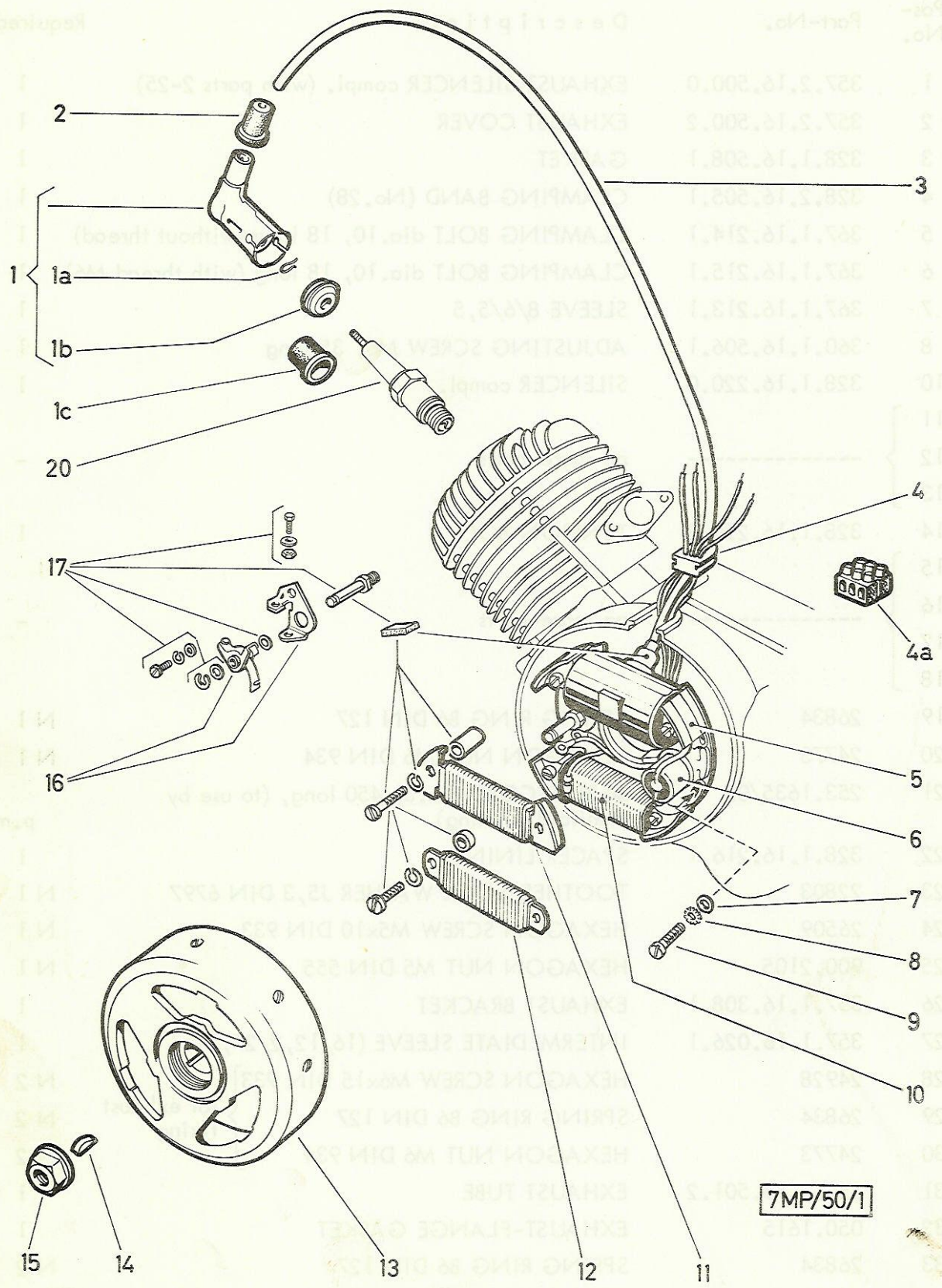

7MP/50/1

10. GENERATOR

Pos- No.	Part-No.	Description	Required-No.
--	360.5.50.000.0	MAGNETO GENERATOR compl. (Bosch 0 212 122 027) RB1 (L) 6V 17/5W	1
1	350.7.52.005.0	SUPPRESSOR PLUG (cable plug) Bosch	1
1a	050.5206	LOCK SPRING (inside of the cable plug)	1
1b	350.7.52.006.1	SEAL RING	1
1c	-----	not for this model	1
2	350.1.52.007.1	CAP for ignition cable gasket outside	1
3	050.5207	IGNITION CABLE dia.5 (530mm long)	p.m.
4	352.2.10.010.1	RUBBER SOCKET	1
4a	51.1.5703	SOFT-RUBBER CLAMPING (two rows)	1
5	364.4.50.512.2	IGNITION ARMATURE	1
6	500.2.50.013.2	CONDENSER	1
7	901.3941	WASHER 8/4, 2/1	3
8	900.3253	SERRATED LOCK WASHER J4,3 DIN 6798	N 3
9	27458	LENS HEAD SCREW AM4x15 DIN 85	N 3
10	360.2.50.011.2	GENERATOR ARMATURE	1
11	360.5.50.014.2	GENERATOR ARMATURE	1
12	-----	not for this model	
13	364.4.50.510.2	FLYWHEEL	1
14	900.4503	WOODRUFF-KEY 3x3,7 DIN 6888	N 1
15	901.2943	HEXAGON NUT with band M10x1-8G	1
16	302.2.50.015.0	CONTACT-SET	1
17	360.5.50.017.0	SET FOR PARTS compl.	1
20	-----	PLUG please see group cylinder, engine parts	

Parts not identified by a number are not available singly from Messrs. Bosch

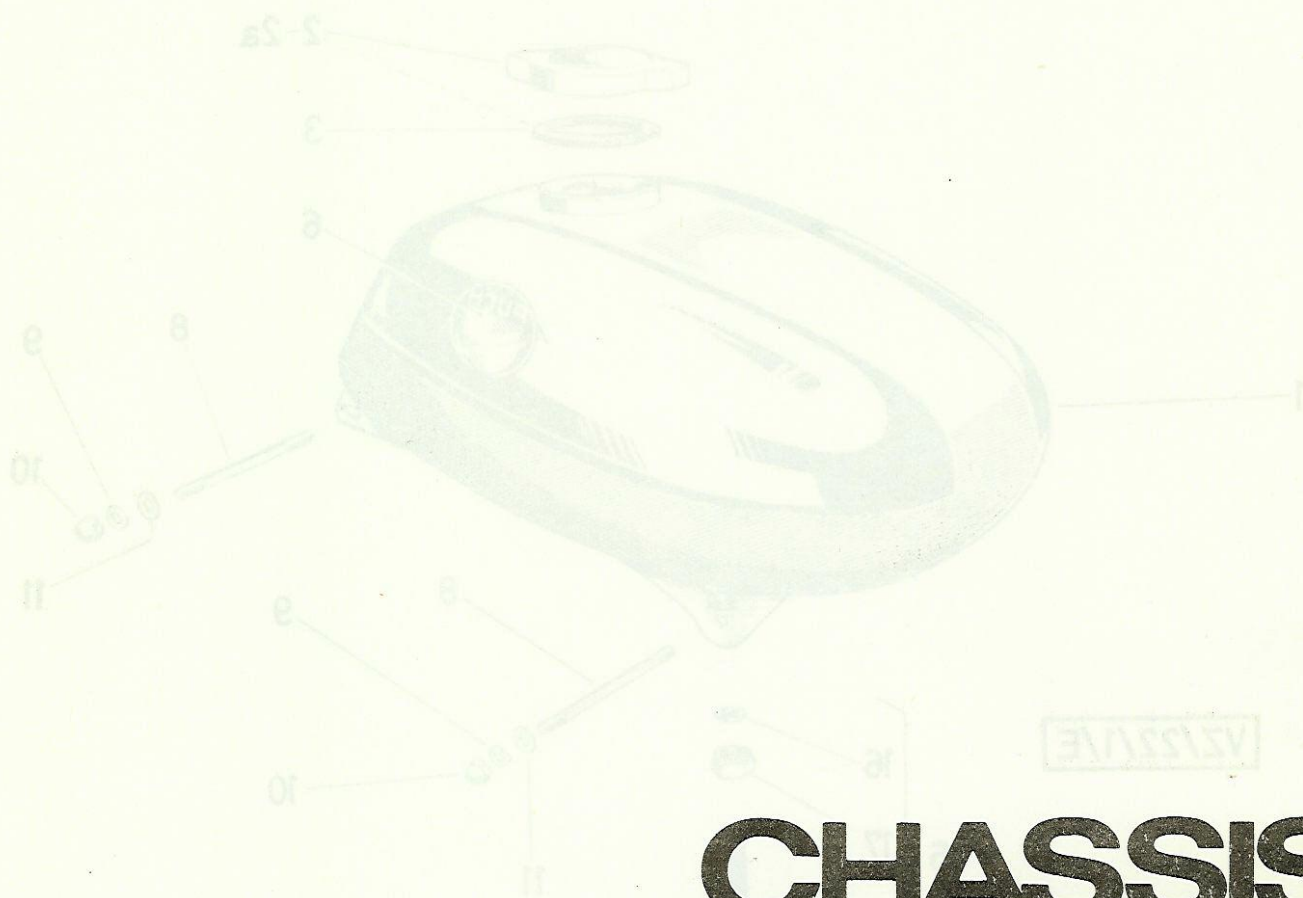

CHASSIS

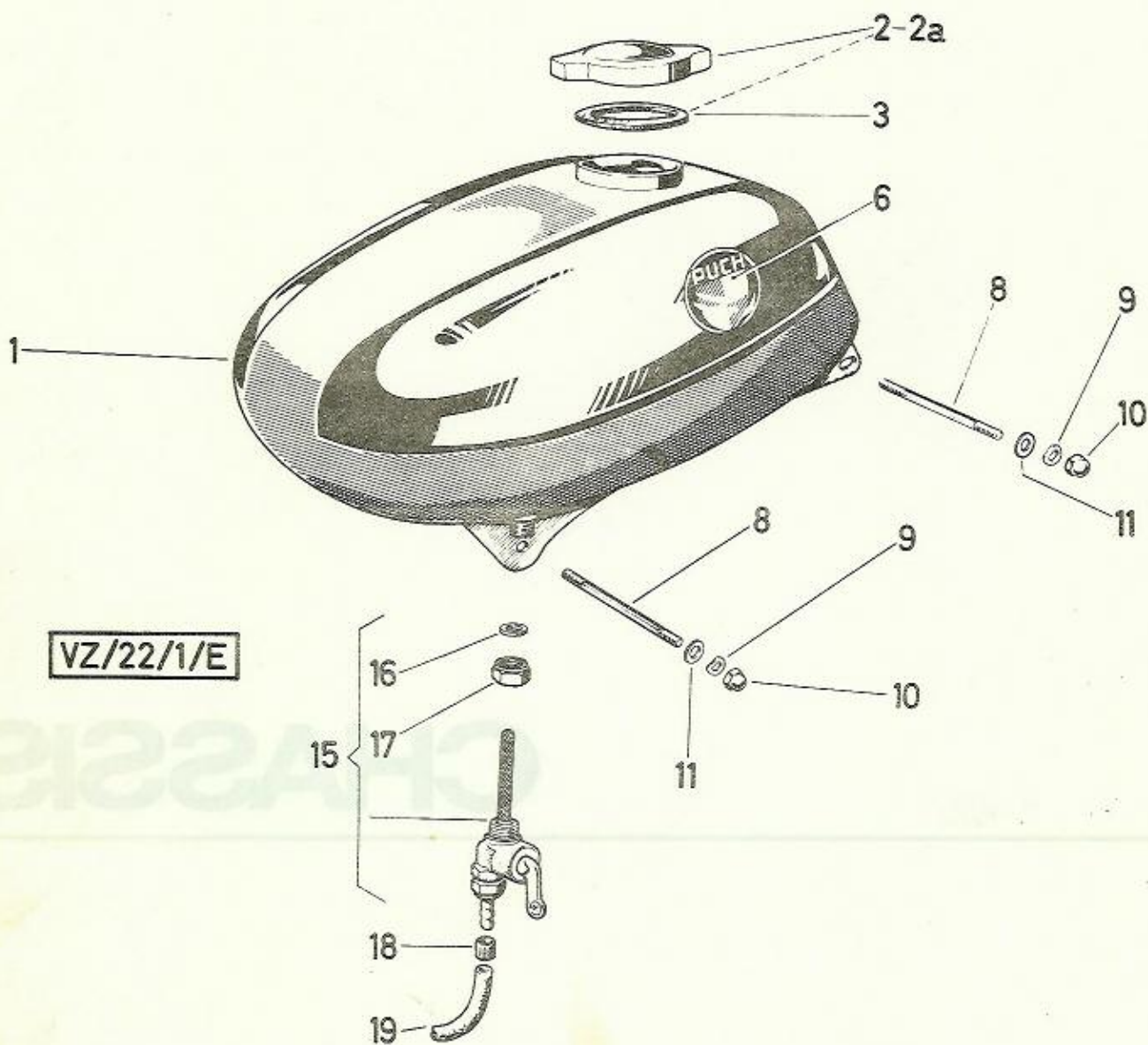

VZ/22/1/E

CHASSIS

13. FUEL TANK

Pos- No.	Part-No.	Description	Required No.
1	367.3.22.000.9	FUEL TANK (with imprint for name-plate) (without name-plate)	1
2	170.2220.0	TANK CAP compl. (with oil measure)	as req.
2a	270.2220.0	TANK CAP compl. (without oil measure)	as req.
3	27642	SEAL RING (84/60/3,5)	1
6	366.3.22.015.1	NAME-PLATE "PUCH"	2
8	901.1978	THREADED BOLT M6x85 DIN 938	N 2
9	900.3213	SPRING WASHER B6 DIN 137	N 4
10	900.2933	DOMED NUT M6 DIN 1587	N 4
11	28909	WASHER 6,5/14/1	4
15	350.5.22.030.0	PETROL TAP compl. (Type "KARCO")	1
16	16636	SEAL RING 14/10,5/1,5	1
17	27634	CONNECTING NUT M16x1	1
18	24456	HOSE BUSH	2
19	900.0902/07	FUEL HOSE dia.9/5, (150 long)	p.m.

13. FUEL TANK

Description

FUEL TANK (with lock for name-plate)
(without name-plate)

TANK CAP cover (with oil warning)
TANK CAP cover (without oil warning)

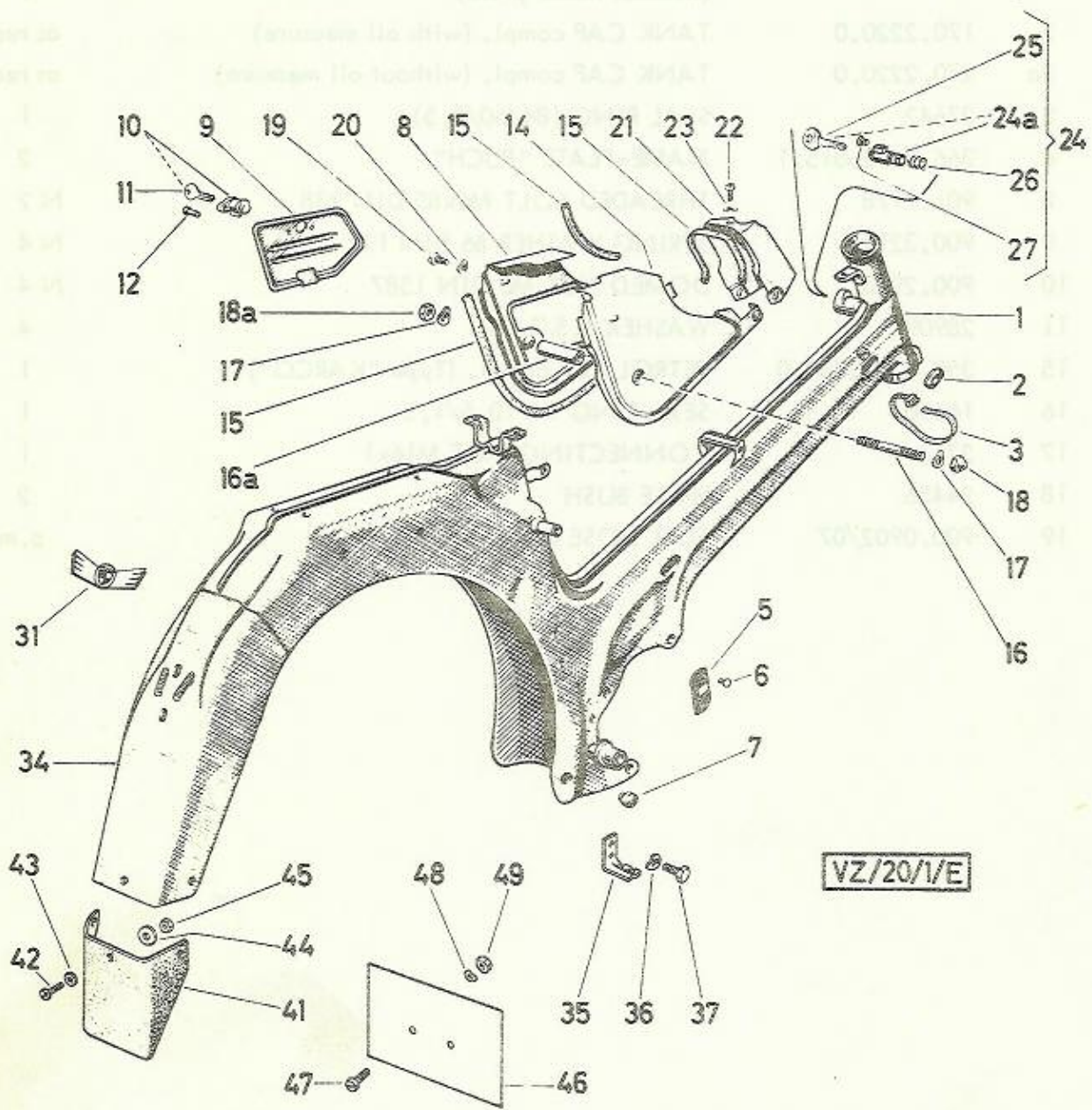

VZ/20/VE

14. FRAME

Pos- No.	Part-No.	Description	Required No.
1	367.6.20.100.0	FRAME compl. (with bearing bushing pressed-in) (for lock version "Neiman" with locking bolt dia. 10mm)	1
2	364.2.30.052.1	CABLE SLEEVE	3
3	364.1.53.227.1	CABLE BINDER 120 long	1
5	357.1.20.333.1	TYPE PLATE "VZ50"	1
6	900.4052	RIVET 2,6x6 DIN 660	N 2
7	050.1.2123	RUBBER STOP	1
8	367.1.20.042.2	FRAME CASING left	1
9	367.1.20.044.9	COVER (without lock)	1
10	357.1.26.003.0	LOCK compl. (with 2 keys)	1
11	350.2.30.023.1	RESERVE KEY (please indicate key-no!)	as req.
12	900.4013	RIVET 3x10 DIN 660	N 2
14	367.1.20.046.2	FRAME CASING right	1
15	364.2.20.660.8	EDGING (for frame casing left and right above each 175mm long for frame casing left and right below each 490mm long for cover plate front 280mm long	as req.
16	901.1978	STUD M6x85 DIN 938	N 1
16a	331.1.15.074.1	SPACER 60 long	1
17	900.3213	SPRING WASHER B6 DIN 137	N 2
18	900.2933	DOMED NUT M6 DIN 1587	N 1
18a	24773	HEXAGON NUT M6 DIN 934	N 1
19	1426	CHEESE HEAD SCREW M5x8 DIN 84	N 2
20	900.3217	SPRING WASHER B5 DIN 137	N 2
21	367.1.20.041.1	COVER PLATE front	1
22	900.1312	CHEESE HEAD SCREW AM5x10 DIN 84	N 1
23	900.3912	WASHER 12/5,5/1	1
24	367.1.20.152.0/10	LOCK compl. (version "Neiman" with locking bolt dia. 10mm) (with parts 24a-27)	1
24a	367.1.20.152.0	LOCK compl. (version "Neiman" with locking bolt dia. 10mm) (with 2 keys)	1
25	350.2.30.023.1	RESERVE KEY (please indicate key-no!)	as req.
26	367.1.20.159.1	TENSION SPRING	1
27	367.1.20.160.1	NOTCHED ALUMINIUM PIN	1
31	050.5.2025	NAMEPLATE "Puch" neutral	1
34	367.5.20.020.1	FRAME FINAL PIECE (unvarnished for repair)	as req.
35	357.1.14.029.1	ADJUSTING ANGLE	1

14. FRAME (cont.)

Pos- No.	Part-No.	Description	Required No.
36	900.3212	SPRING WASHER A6 DIN 137	N 1
37	25399	HEXAGON SCREW M6x10 DIN 933	N 1
41	367.1.20.026.1	SPLASH GUARD	1
42	900.1312	CHEESE HEAD SCREW AM5x10 DIN 84	N 3
43	24803	WASHER 5,3 DIN 433	N 3
44	900.3909	WASHER 21/5,5/0,75	3
45	900.2105	HEXAGON NUT M5 DIN 555	N 3
46	364.1.27.744.1	LICENSE PLATE rear	1
47	900.1321	CHEESE HEAD SCREW AM6x12 DIN 84	N 2
48	900.3212	CURVED WASHER A6 DIN 137	N 2
49	900.2106	HEXAGON NUT M6 DIN 555	N 2

ASSEMBLY



VZ/27/1/E

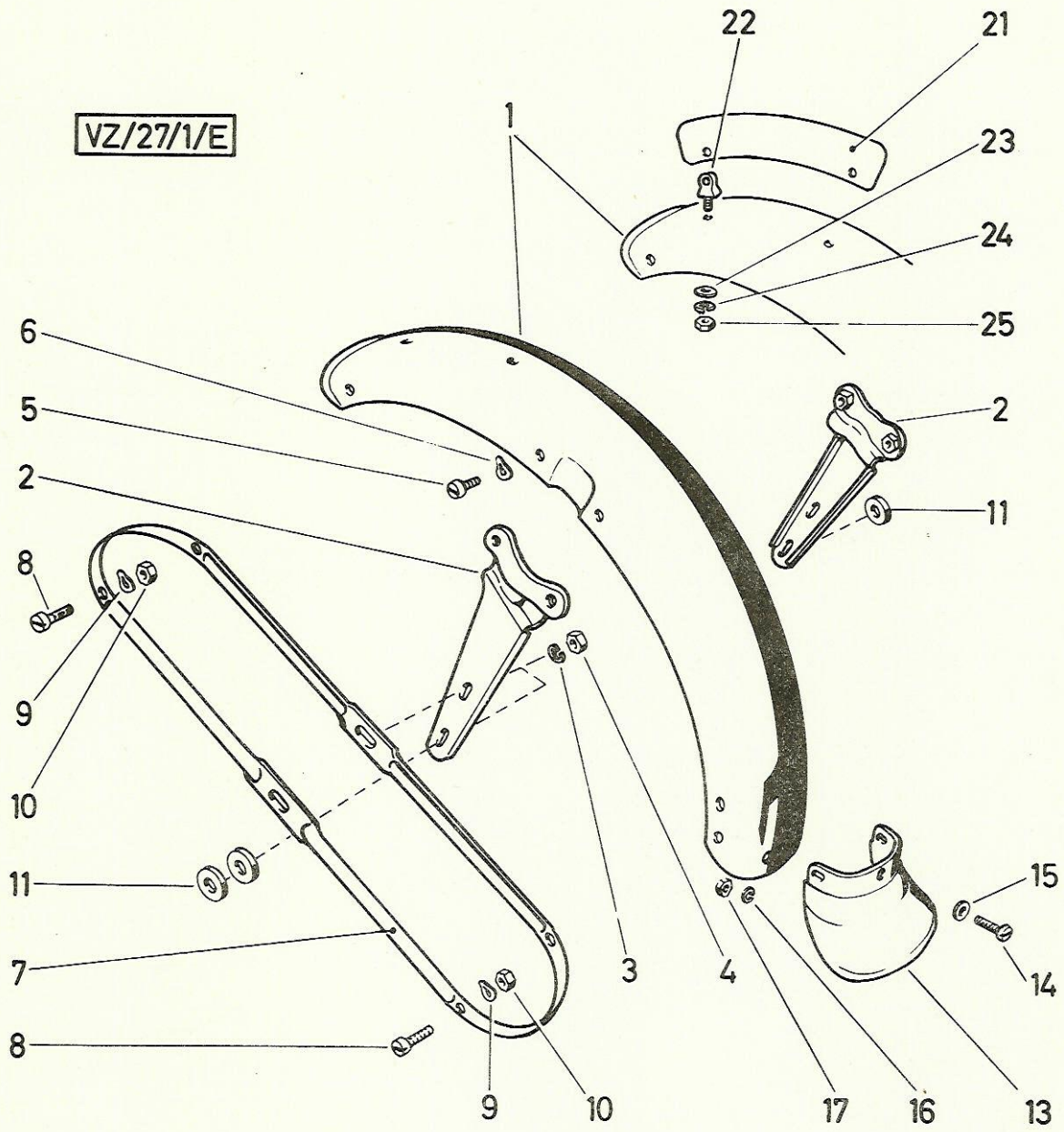

15. MUDGUARD

Pos- No.	Part-No.	Description	Required No.
1	367.6.27.000.1	FRONT MUDGUARD	1
2	367.3.27.002.2	SUPPORT FOR MUDGUARD	2
3	29189	SPRING RING B7 DIN 127	N 4
4	24774	HEXAGON NUT M7 DIN 934	N 4
5	1426	CHEESE HEAD SCREW AM5x8 DIN 84	N 4
6	900.3205	SPRING WASHER A5 DIN 137	N 4
7	367.4.27.012.2	STRUT FOR MUDGUARD	1
8	900.1312	CHEESE HEAD SCREW AM5x10 DIN 84	N 4
9	900.3205	SPRING WASHER A5 DIN 137	N 4
10	900.2105	HEXAGON NUT M5 DIN 555	N 4
11	250.3025	WASHER 17/7,5/2,5	2
13	367.1.27.014.1	SPLASH GUARD	1
14	900.1321	CHEESE HEAD SCREW AM6x12 DIN 84	N 3
15	900.3076	WASHER A6,4 DIN 9021	N 3
16	26834	SPRING RING B6 DIN 127	N 3
17	24773	HEXAGON NUT M6 DIN 934	N 3
21	050.1.2705	PLATE FOR NUMBER front	1
22	050.1.2707.2	SUPPORT for number-plate, front	2
23	24804	WASHER 6,4 DIN 433	N 2
24	26834	SPRING RING B6 DIN 127	N 2
25	900.2106	HEXAGON NUT M6 DIN 555	N 2

1. MUGGUARD

Part No.	Description	Part No.	Qty
----------	-------------	----------	-----

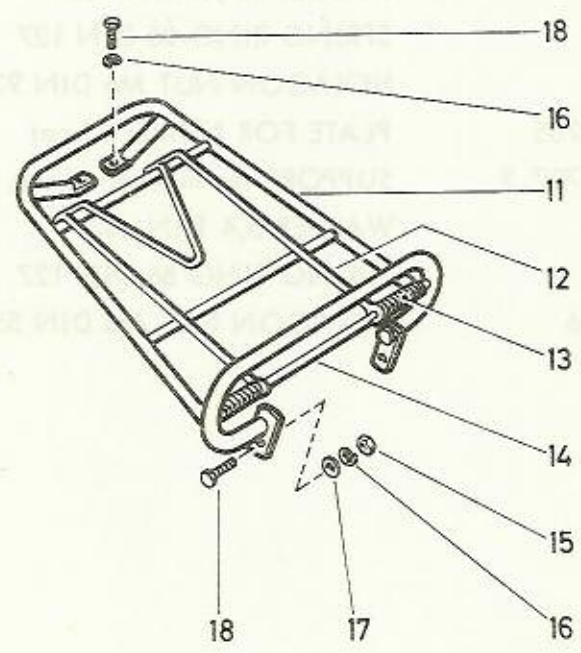
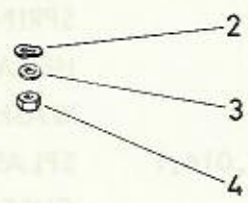
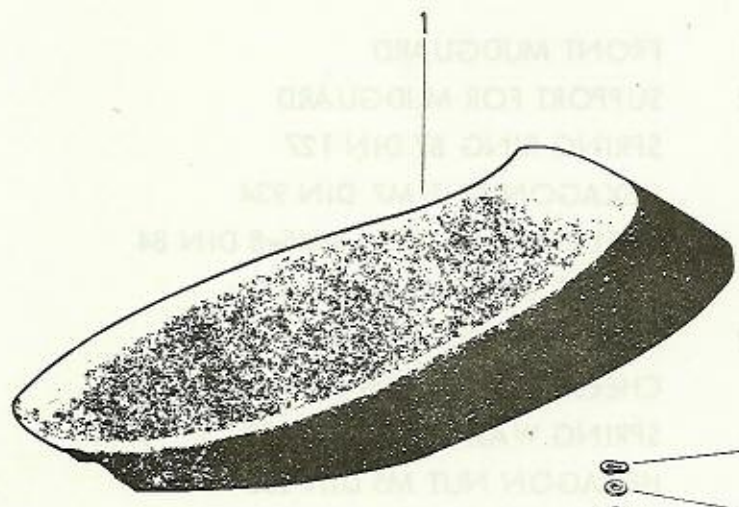

VZ/33/1/E

16. SINGLE SEAT, CARRIER

Pos- No.	Part-No.	Description	Required No.
1	367.2.33.000.0	SINGLE SEAT compl.	1
2	900.3213	SPRING WASHER B6 DIN 137	N 4
3	24804	WASHER 6,4 DIN 433	N 4
4	900.2106	HEXAGON NUT M6 DIN 555	N 4
11	367.4.29.020.0	CARRIER compl. (Messrs. Denfeld)	1
12	350.1.29.027.1	SPRING CLIP	1
13	350.1.29.025.1	TORSION SPRING left (mounted on the right side)	1
13	350.1.29.026.1	TORSION SPRING right (mounted on the left side)	1
14	367.2.29.024.1	SPRING STUD (dia.6, 205 long)	1
15	900.2106	HEXAGON NUT M6 DIN 555	N 2
16	26834	SPRING RING B6 DIN 127	N 4
17	24804	WASHER 6,4 DIN 433	N 2
18	24928	HEXAGON SCREW M6x15 DIN 933	N 4

17. PIVOTED FORK, CENTRE STAND

Pos- No.	Part-No.	Description	Required No.
PIVOTED FORK			
1	367.2.21.001.0	PIVOTED FORK compl. (including rubber mounting pressed-in)	1
2	367.1.21.011.2	RUBBER MOUNTING	2
3	367.2.21.021.1	STAND BEARING BUSH	2
4	050.1.2123	RUBBER BUFFER for stand stop	2
5	357.1.21.010.2	BEARING BOLT, 262 long	1
6	900.3013	WASHER 13 DIN 125	N 1
7	900.2316	THIN HEXAGON NUT M12x1 DIN 936	N 1
8	367.1.21.025.1	CHAIN TENSIONING SCREW (M7) 52 long	2
9	24774	HEXAGON NUT M7 DIN 934	N 2
10	368.1.21.318.1	UPPER CHAIN GUARD	1
14	900.1513	LENS HEAD SCREW M5x10 DIN 85	N 4
15	900.3217	SPRING WASHER B5 DIN 137	N 6
15a	900.3912	WASHER 5,5/12/1	6
16	330.1.27.003.1	CAP	1
STAND			
20	367.1.24.000.2	STAND	1
21	367.1.24.013.1	STAND BEARING SPINDLE	1
22	14778	WASHER 21/10,5/1	2
23	900.4609	BZ-WASHER 9 DIN 6799	N 2
24	100.1.1235	SPRING WASHER 18/10,5/0,2	1
25	128.2410	STAND SPRING	1

12. PIVOTED FORK, CENTRE STAND

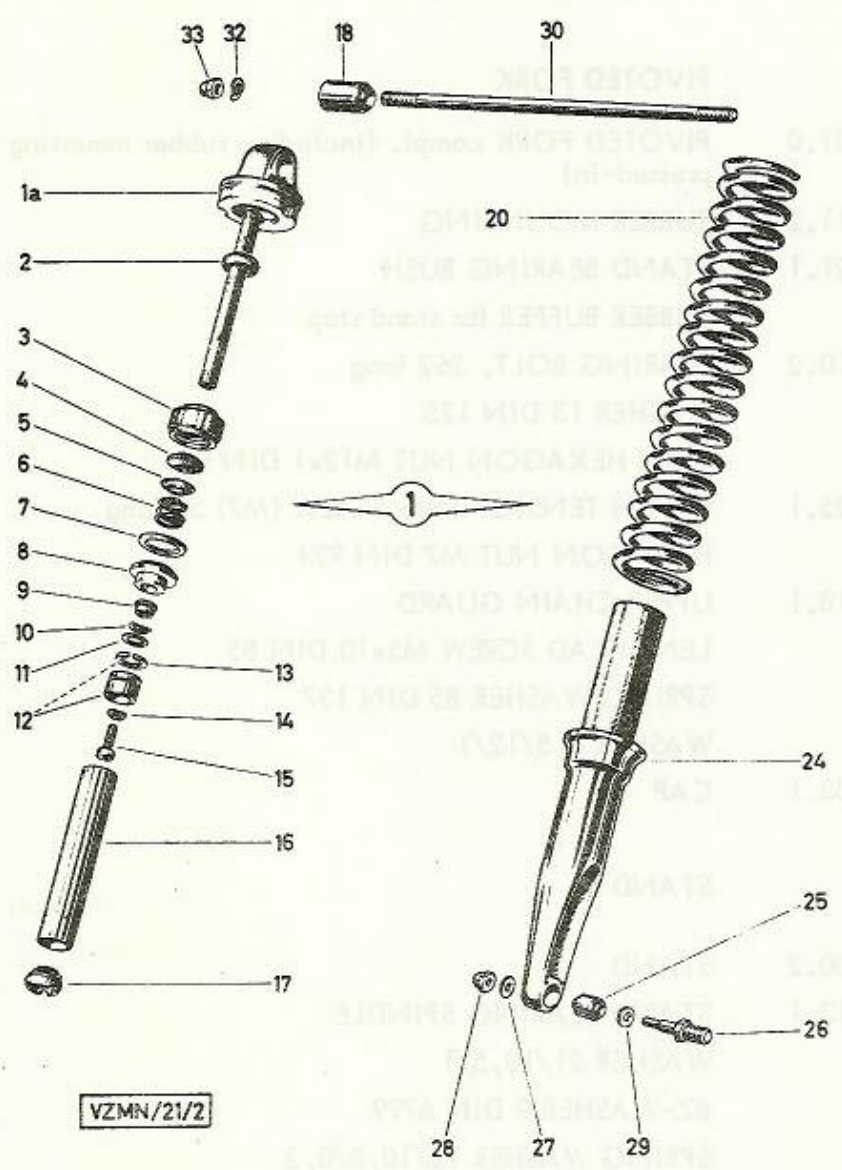

18. SUSPENSION UNIT FOR REAR WHEEL

Pos- No.	Part-No.	Description	Required No.
1	368.2.21.050.0	SUSPENSION UNIT compl.	2
1a	368.2.21.058.1	TOP UNIT HEAD	2
2	253.2.21 ⁷²	BUFFER RING dia.17/8	2
3	367.1.21.052.1	SEALING SCREW	2
4	367.1.21.078.1	SEAL	2
5	367.1.21.077.1	CUP WASHER	2
6	367.1.21.080.1	CUP SPRING	2
7	367.1.21.079.1	GASKET 31, 8/24, 8/2, 5	2
8	367.1.21.056.1	GUIDE BUSH	2
9	253.2.2184	DISTANCE BUSH	2
10	253.2.2182	WOODRUFF KEY	2
11	367.2.30.151.1	RING VALVE	2
12	253.4.21.062.0	DAMPER PISTON compl. (with piston ring)	2
13	253.4.21.059.1	PISTON RING	2
14	900.3207	SPRING WASHER A7 DIN 137	N 2
15	367.1.21.063.1	JET SCREW	2
16	367.1.21.064.1	DAMPER CYLINDER	2
17	253.2.2165.2	END CAP	2
18	364.1.30.035.2	RUBBER MOUNTING 16/8/28 (top absorber bearing)	2
20	368.1.21.266.1	SPRING dia.42, 165 long, wire dia.6, 5(chromed)	2
24	367.1.21.054.1	SUSPENSION UNIT	2
25	128.2153	RUBBER MOUNTING 18/10/20	2
26	367.2.21.027.1	BOLT	2
27	24806	WASHER 8,4 DIN 433	N 2
28	900.2907	DOMED NUT M8x1 DIN 917	N 2
29	901.3904	WASHER 16/10, 1/3, 5	2
30	364.1.21.013.1	THREADED BOLT (M8, 202 long)	1
32	900.3211	SPRING WASHER B8 DIN 137	N 2
33	900.2935	DOMED NUT M8 DIN 1587	N 2

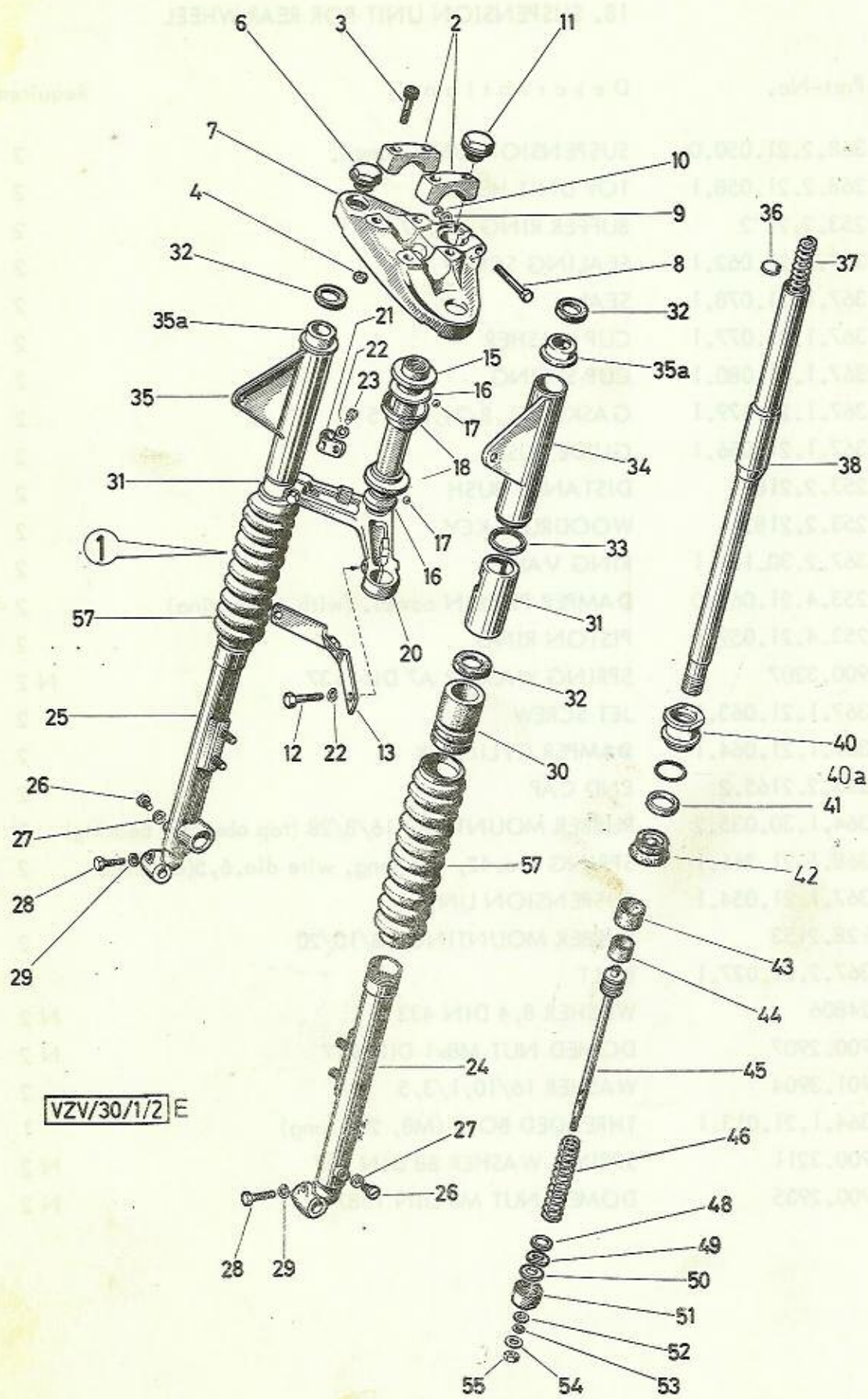

19. FRONT FORK WITH STEERING

Pos- No.	Part-No.	Description	Required No.
1	367.6.30.300.0	FRONT FORK compl.	1
2	366.1.30.102.1	HANDLEBAR CLAMP	2
3	900.1374	CHEESE HEAD SCREW M7x35 (8G) with hexagon socket	4
4	900.2015	HEXAGON NUT M7 DIN 934	N 4
6	367.1.30.112.1	COVER SCREW	2
7	328.1.30.007.1	TOP FORK YOKE	1
8	900.1135	HEXAGON SCREW M7x45 DIN 931-8G	N 1
9	24796	WASHER 7,4 DIN 125	N 1
10	900.2012	HEXAGON NUT M7 - 8G	1
11	367.1.30.052.1	SCREW	1
12	901.1018	HEXAGON SCREW M7x28 DIN 931-8G	N 2
13	367.2.30.025.2	FITTING BRACKET for buzzer	1
15	25222	DUST PROTECTOR	1
16	25220	TAPERED RING	2
17	25226	BALL dia.5	42
18	25221	BALL SLEEVE	2
20	367.3.30.006.2	LOWER FORK YOKE	1
21	128.6305	CLAMP	1
22	29189	SPRING RING B7 DIN 127	N 3
23	900.1517	LENS HEAD SCREW M7x10 DIN 85	N 1
24	367.3.30.315.2	FORK SLIDER left	1
25	367.3.30.316.2	FORK SLIDER right	1
26	1426	CHEESE HEAD SCREW AM5x8 DIN 84	N 2
27	902.3780	O-RING OR 5-1,5	2
28	900.1128	HEXAGON SCREW M7x20 DIN 933	N 2
29	24796	WASHER 7,4 DIN 125	N 2
30	367.2.30.036.1	RUBBER BUFFER 40,5/28,5/45	2
31	367.3.30.037.1	OUTER TUBE	2
32	367.2.30.040.1	INTERMEDIATE RING 39/31,5/3,7	4
33	175.2.3041	CENTERING RING	2
34	367.2.30.043.2	HEADLAMP CARRIER left	1
35	367.2.30.044.2	HEADLAMP CARRIER right	1
35a	367.1.30.047.1	UPPER CENTERING RING	2
36	367.1.30.031.1	WASHER for thrust spring	6
37	367.2.30.134.1	THRUST SPRING (435 long)	2

19. FRONT FORK WITH STEERING (cont.)

Pos- No.	Part-No.	Description	Required No.
38	367.2.30.108.2	INNER TUBE compl.	2
40	360.1.30.127.1	GROOVED SLEEVE	2
40a	901.3792	O-RING OR 30,3-2,4	2
41	050.4.3049	FELT RING 32,5/25/6	2
42	050.4.3029	RUBBER SLEEVE (average dia.29)	2
43	050.4.3026	TOP GUIDE BUSH 29,5/25/26	2
44	050.4.3009	LOWER GUIDE BUSH 28/23/26	2
45	367.1.30.150.2	PISTON with spring rod	2
46	367.1.30.133.1	DAMPING SPRING	2
48	901.3920	WASHER 21,7/11/1,38	2
49	253.2.2182	WOODRUFF-KEY	2
50	367.1.30.151.1	RING VALVE 18/11/0,3	2
51	367.1.30.110.1	CAP	2
52	3665	WASHER 12/6/1	2
53	900.3883	GASKET 9/6/1,5	2
54	24804	WASHER 6,4 DIN 433	N 2
55	900.2106	HEXAGON NUT M6 DIN 555	N 2
57	367.1.30.028.1	RUBBER CUFF	2

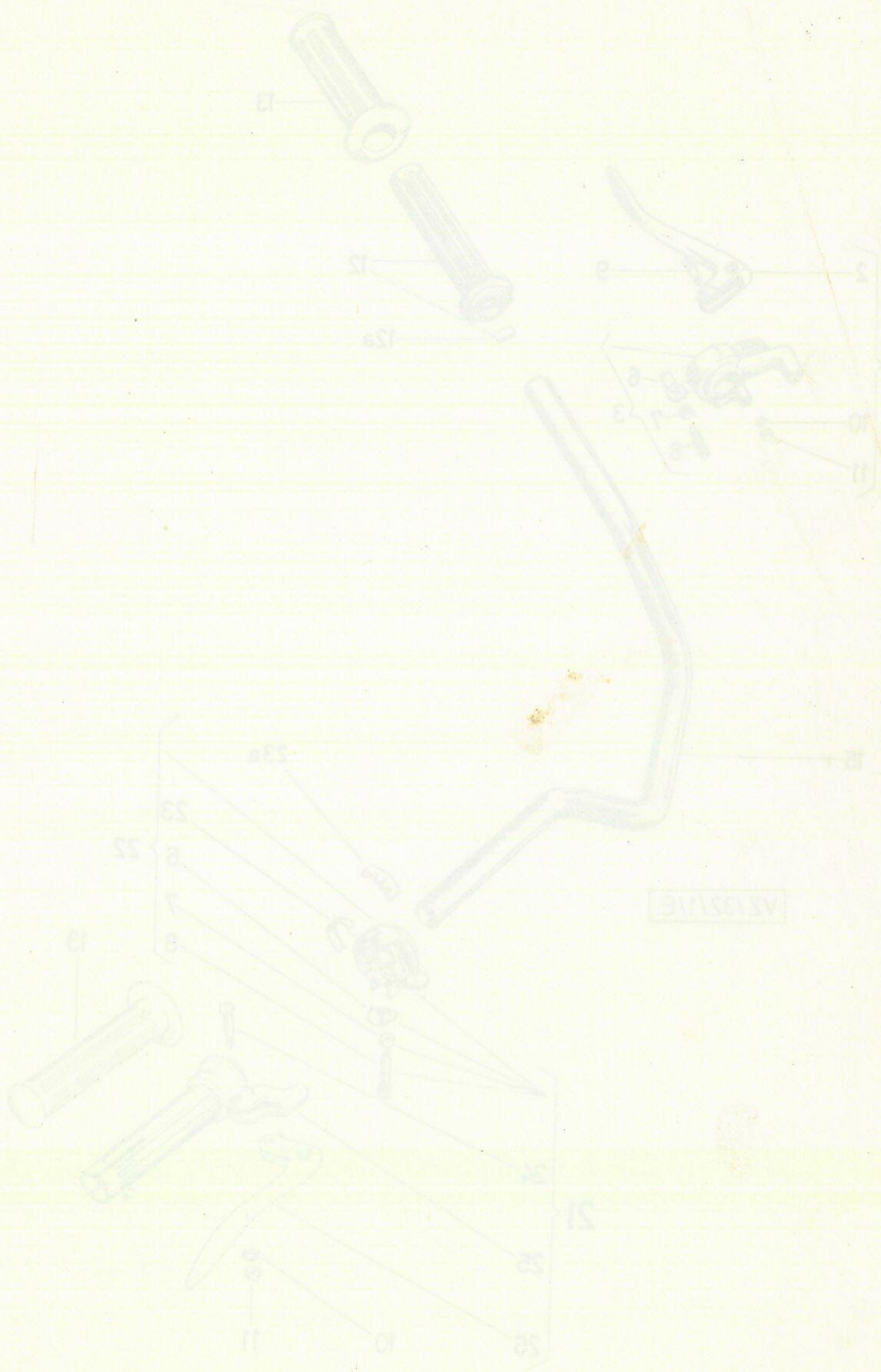

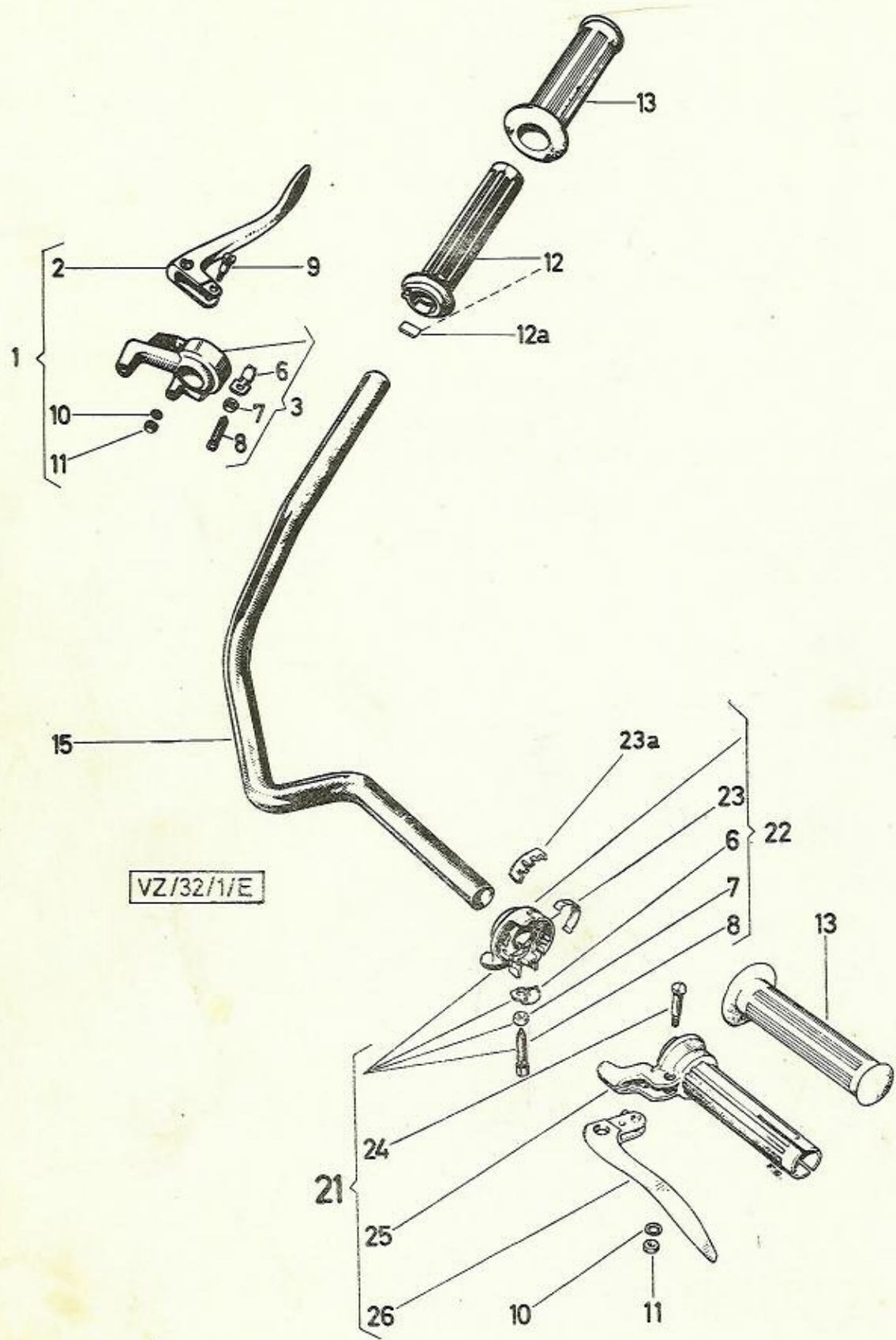

20. HANDLEBAR AND CONTROLS

Pos- No.	Part-No.	Description	Required No.
1	350.1.32.105.0	THROTTLE GRIP UNIT compl. (with parts 2 to 12a)	1
2	050.2.3228	BRAKE LEVER	1
3	350.2.32.121.0	THROTTLE GRIP compl. (with parts 6 to 8)	1
6	350.1.32.113.1	HOLDING BRACKET	1
7	350.1.32.112.1	HEXAGON NUT (M6)	1
8	350.2.32.111.1	HEXAGON SCREW (6mm SW)	1
9	050.3227	LEVER SCREW (M5)	1
10	22803	TOOTHED LOCK WASHER J5,3 DIN 6797	N 1
11	24772	HEXAGON NUT M5 DIN 934	N 1
12	350.2.32.126.0	THROTTLE GRIP compl. (with part 12a)	1
12a	349.1.32.009.1	TENSION SPRING	1
13	360.2.32.016.1	GRIP dia.24 (black)	2
15	367.2.32.001.1	HANDLEBAR	1
21	360.2.32.104.0	GEARSHIFT TWIST GRIP compl. (3rd-speed circular pull) (with parts 6 to 8, 10,11 and 22 to 26)	1
22	360.2.32.110.0	GEARSHIFT TWIST GRIP HOUSING compl. (with parts 6 to 8, 23 and 23a)	1
23	360.2.32.120.1	SHIELD for scale	1
23a	360.2.32.116.1	GEARSHIFTING quadrant	1
24	350.1.32.114.1	LEVER BOLT (M5)	1
25	350.1.32.115.2	GEARSHIFT TWIST GRIP TUBE	1
26	350.1.32.117.2	CLUTCH LEVER	1

XX. HANDLEBAR AND CONTROLS

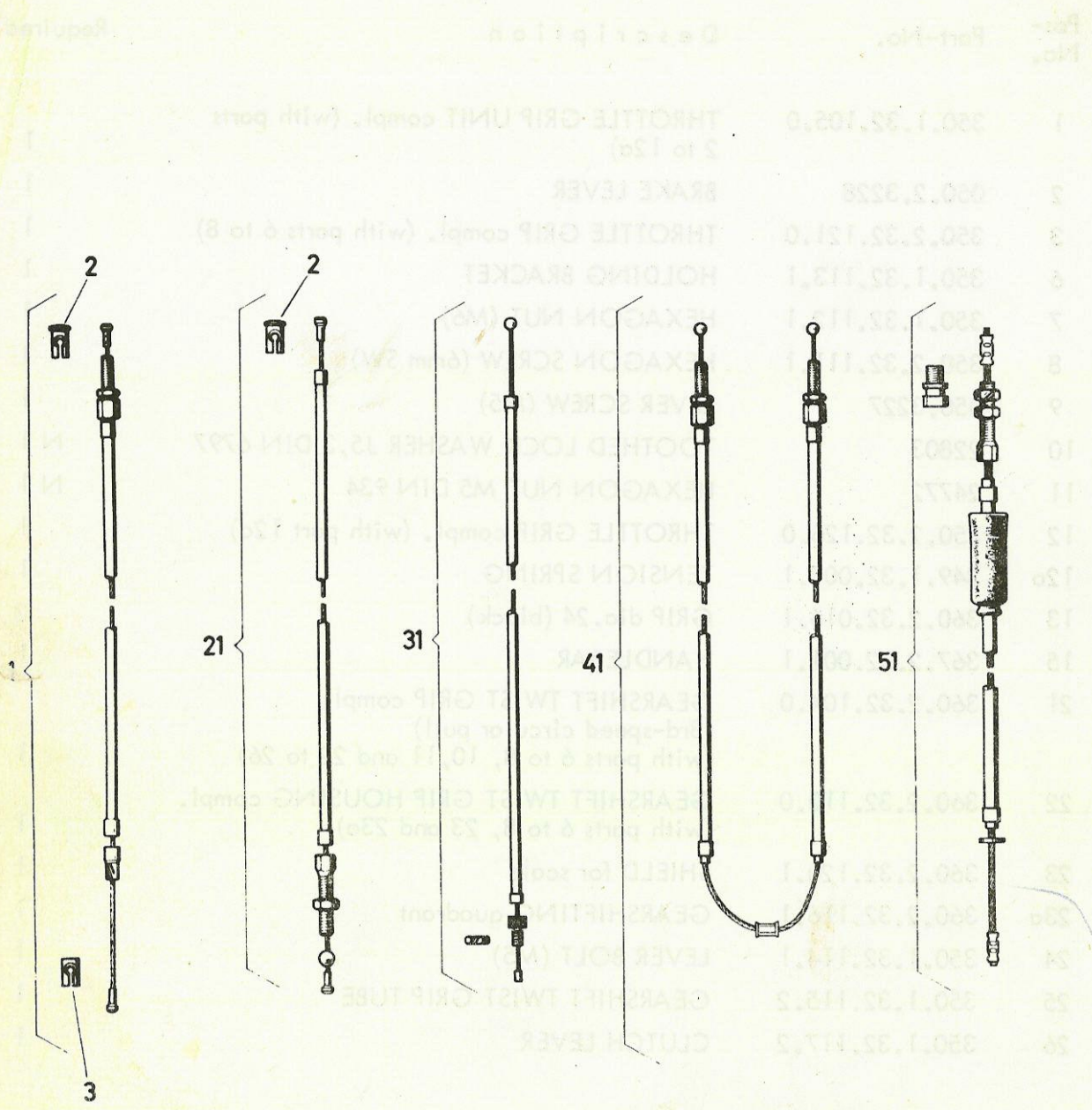

VZ/60/1/E

21. CABLES

Pos- No.	Part-No.	Description	Required No.
1	302.1.62.000.0	CLUTCH CABLE compl. (cable 1175/sleeve 1060)	1
2	050.1.3208	NIPPLE HOLDER	2
3	250.6208	NIPPLE HOLDER	1
21	367.1.63.200.0	BRAKE CABLE compl. for front wheel (cable 1125/sleeve 995)	1
31	360.1.65.500.0	CARBURETTOR CABLE (cable 890/sleeve 760)	1
41	368.1.66.300.2	CABLE CONTROL (cable 2575/sleeve 2x1150) GEAR	1
51	360.7.25.000.2	BRAKE CABLE for rear wheel (cable 570/sleeve 380)	1

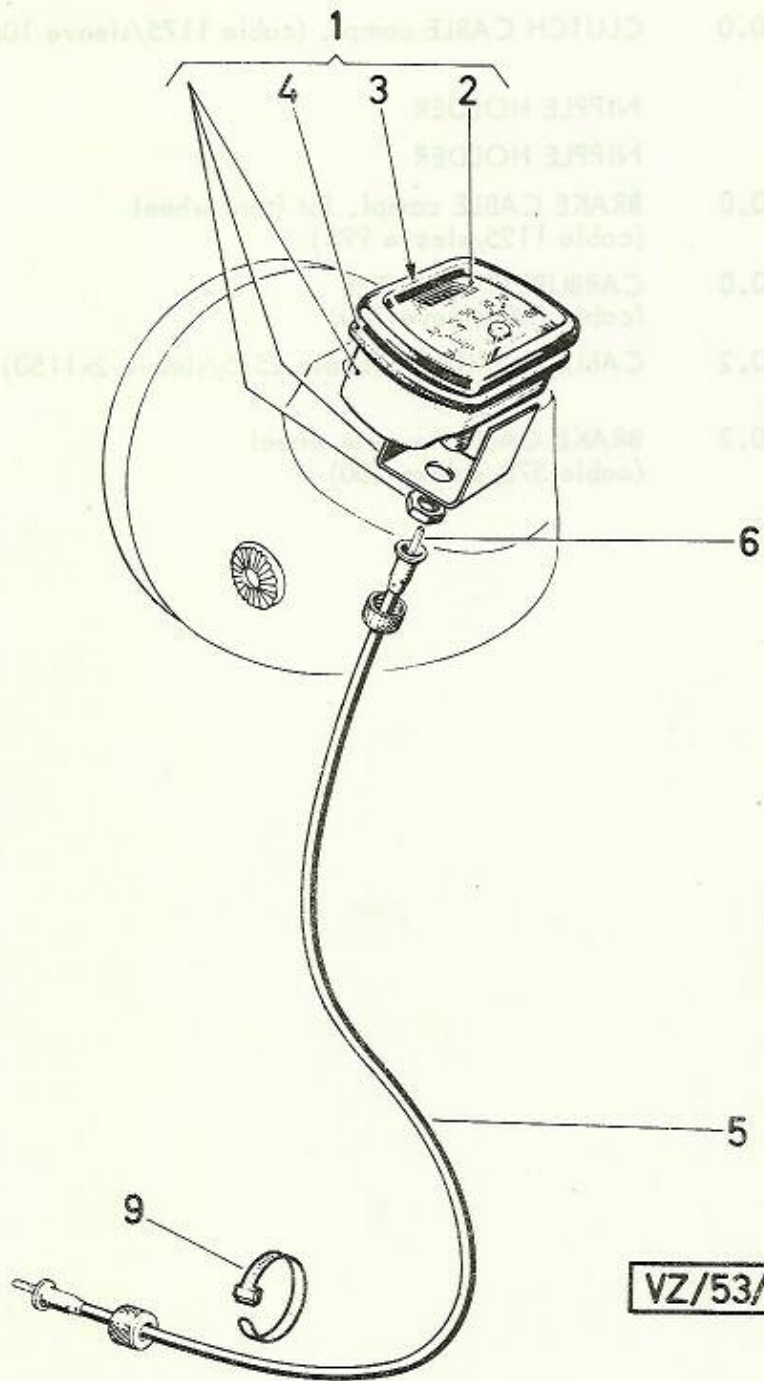

VZ/53/2/E

31. CABLES

Description

No.	Part-No.	Description	Qty.
1	302.1.62.000.0	CLUTCH CABLE (cable 1152/leave 1060)	1
2	050.1.3308	MIRPLE HOLDER	2
3	250.6308	MIRPLE HOLDER	2
4	307.1.43.200.0	BRAKE CABLE (cable 1152/leave 1060)	1
5	300.1.62.200.0	CABLE	1
6	308.1.66.300.2	CABLE	1
7	300.7.22.000.1	BRACKET (cable 1152/leave 1060)	1

22. SPEEDOMETER AND DRIVING SHAFT

Pos- No.	Part-No.	Description	Required No.
1	330.2.53.024.0	SPEEDOMETER compl. mph	1
2	330.2.53.022.1	GLASS	1
3	330.2.53.023.2	FRONT RING (with sprayed on rubber)	1
4	330.2.53.027.1	RUBBER GASKET for speedometer outside	1
5	367.1.53.025.0	DRIVING COIL compl. 975 long	1
6	360.1.53.025.2	DRIVING SHAFT (core only)	1
9	364.1.53.227.1	CABLE BINDER 120 long	1

33. SPEEDOMETER AND DRIVING SHAFT

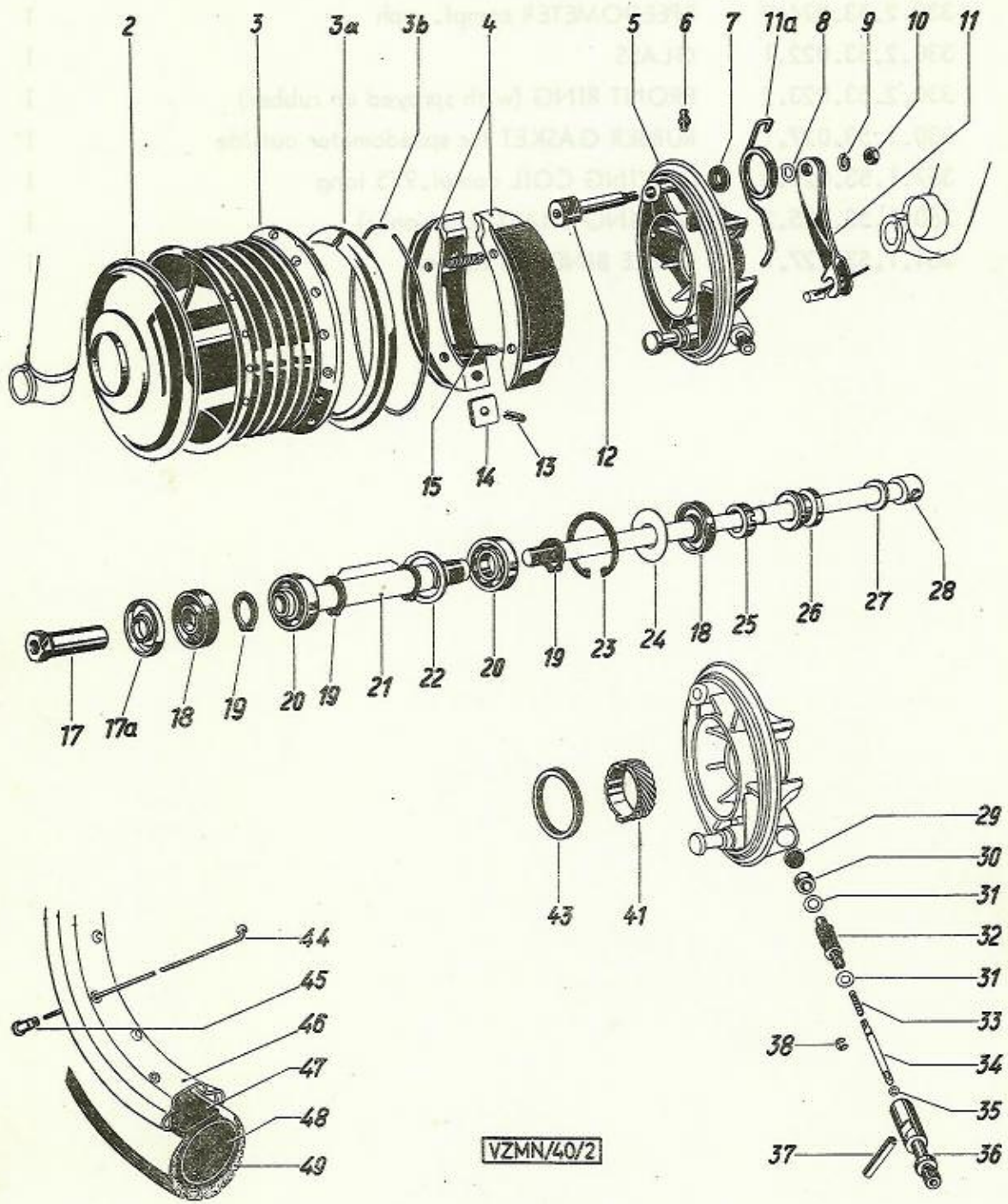

VZMN/40/2

23. FRONT WHEEL WITH SPEEDOMETER DRIVE

Pos- No.	Part-No.	Description	Required No.
--	357.3.40.000.0	FRONT WHEEL compl. (without tyre)	1
--	357.3.40.002.0	FRONT WHEEL HUB compl. (with fitting parts)	1
2	350.1.40.040.1	COVER	1
3	357.1.40.004.1	FRONT WHEEL-BRAKE HUB	1
3a	350.1.41.042.1	PROTECTION RING dia. 129,5	} for brake hub
3b	050.10.1074	CLIP RING	
4	050.4.4015.0 ^x	PAIR OF BRAKE SHOES with glued-on lining up to ma...	1
4	360.1.40.515.0 ^{xx}	PAIR OF BRAKE SHOES with glued-on lining from ma...	1
--	357.2.40.007.0	BRAKE PLATE compl. with speedometer drive	1
5	360.2.40.007.2	BRAKE PLATE without speedometer drive	1
6	900.6177	LUBRICATION NIPPLE A6 DIN 71412 (for brake plate with threading)	N 1
(6)	360.1.40.011.0	LUBRICATION NIPPLE (plastic) (for brake plate without threading)	1
7	128.2504	RUBBER SEAL RING 20/12/3	} for brake lever fixing
8	900.3219	SPRING WASHER 21/12,5/0,2	
9	26819	SPRING RING B8 DIN 127	
10	26820	HEXAGON NUT M8x1 DIN 934	
11	050.5.4013.2	BRAKE LEVER, 78 long	1
11a	350.4.41.015.1	RETURN SPRING	1
12	360.2.40.009.2 ^x	BRAKE CAM 66 long	up to ma... 1
12	360.1.40.509.1 ^{xx}	BRAKE CAM 65 long	from ma... 1
13	900.4812	TENSION SLEEVE 4x10 DIN 1481	N 2
14	050.4.4016 ^x	SLIDE PLATE 3,5 thick	up to ma.... 2
14	360.1.40.516.1 ^{xx}	SLIDE PLATE 2,5 thick	from ma... 2
14	050.4.4016.3 ^x	SLIDE PLATE 4 thick (for repair)	up to ma... -
14	360.2.40.516.1 ^{xx}	SLIDE PLATE 3 thick (for repair)	from ma... -
15	050.4.4019	BRAKE SHOE SPRING, 50 long	2
17	357.1.40.027.1	SPINDLE (M10x1)	1
17a	360.1.40.046.1	COVER DISC	1
18	050.4.4025.0	SEALING RING 32/15/5,5	2
19	900.4619	CLIP RING Sg 15x1 DIN 471	N 4
20	900.6002	BALL BEARING 32/15/9 D 6002 DIN 625	(N)2

^xOnly the parts up to ma... can be used another

^{xx}Only the parts from ma... can be used another

23. FRONT WHEEL WITH SPEEDOMETER DRIVE (cont.)

Pos- No.	Part-No.	Description	Required No.
21	360.1.40.023.1	SPACER TUBE (threaded and turned down for press ring)	1
22	050.4.4022	THRUST WASHER 32/25/1,5	1
23	900.4732	CLIP RING Sg 32x1,2 DIN 472	N 1
24	050.4.4039	WASHER 32/15,5/0,5	1
25	050.4.4041	SLOTTED NUT M14x1 (inside)	1
26	357.1.40.043.1	PRESS RING 20/12,5/17,5	1
27	050.1.4029	WASHER 18/10,5/2,5	1
28	357.1.40.026.1	FRONT WHEEL AXLE, 182long	1
29	050.4.4067	WASHER dia. 13,5 (plastic)	1
30	050.4.4066	BUSH 14/8/7	1
31	050.4.4065	WASHER 13/8/0,3	2
32	050.4.4061	SPEEDOMETER DRIVING GEAR (teeth = 12) dia.13,1	1
33	050.4.4068	TENSION SPRING, 14 long	1
34	050.4.4058	DRIVING SHAFT, 40 long	1
35	900.3961	THRUST WASHER 7,5/4/0,3	1
36	050.4.4063	CONNECTING PIECE	1
37	900.4815	SLOTTED HOLLOW PIN 5x25 DIN 1481	N 1
38	900.4603	BZ-WASHER 3,2 DIN 6799	N 1
41	357.2.40.060.1	SPEEDOMETER DRIVING GEAR (teeth = 17)	1
43	050.4.4042	SEAL RING 48/37/4,5	1
44	357.2.40.030.1	SPOKE dia.3, 166 long	36
45	328.1.40.031.1	NIPPLE M3,5	36
46	367.2.40.033.1	RIM 1,5Ax17"	1
47	901.0867	RIM LINING 17"	1
48	901.0820	INNER TUBE 21" - 2,75"	1
49	901.0819	TYRE 21"-2,75" (black or white)	1



СІМВІЛІ

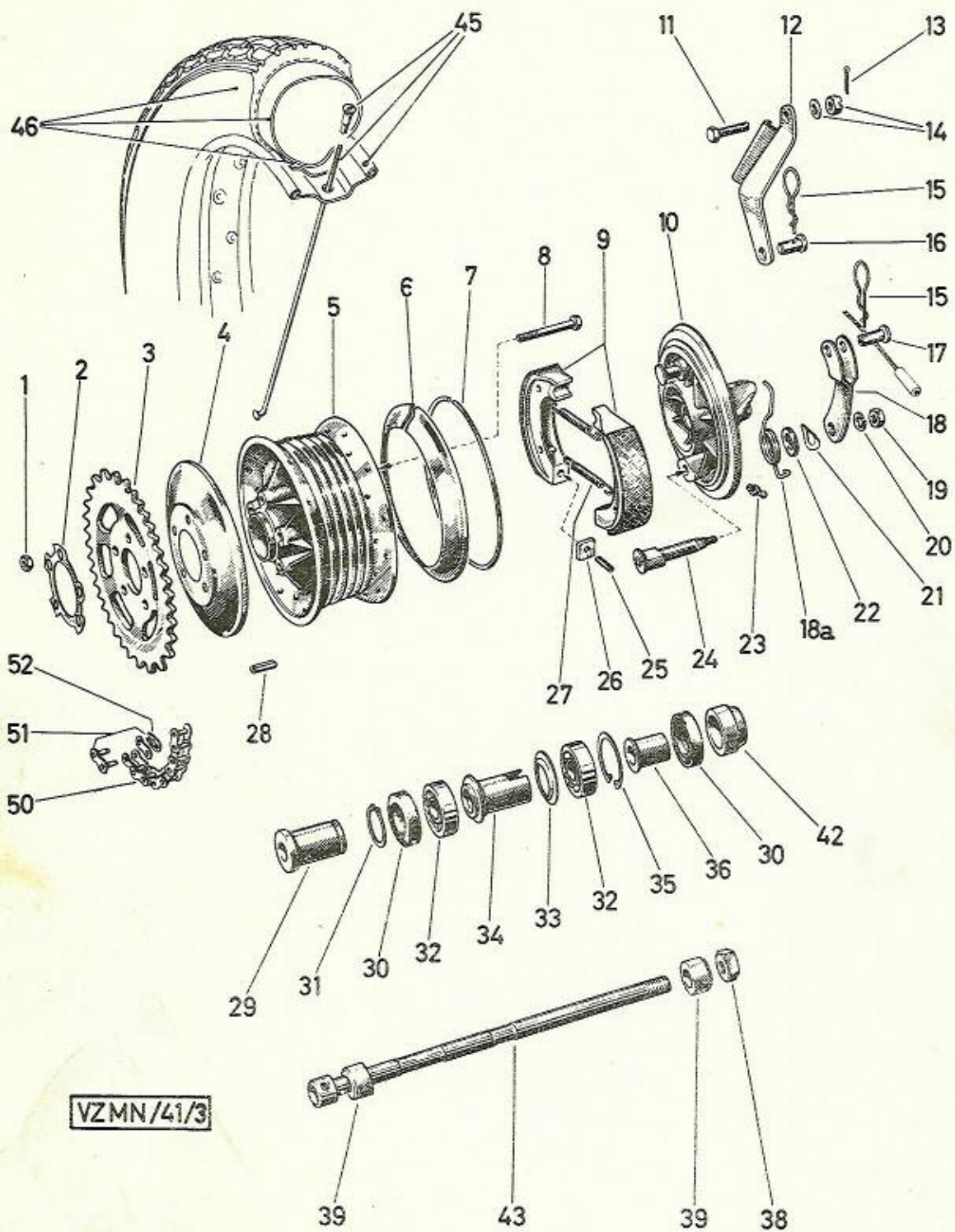

VZMN/41/3

24. REAR WHEEL, CHAIN

Pos- No.	Part-No.	Description	Required No.
--	357.1.41.100.9	REAR WHEEL compl. (21") (without tyre)	1
--	357.6.41.102.9	REAR WHEEL HUB compl. (with fitting parts)	1
1	24774	HEXAGON NUT M7 DIN 934	N 5
2	350.1.41.010.1	LOCKING PLATE	1
3	364.1.41.135.1	SPROCKET (35 teeth) (21mm high)	1
4	050.5.4040	COVER	1
5	357.3.41.004.1	REAR WHEEL - BRAKE HUB	1
6	350.1.41.042.1	PROTECTION RING dia.129,5	1
7	050.10.1074	CLIP RING	1
8	28972	HEXAGON SCREW M7x50DIN 931-8G	N 5
9	050.4.4015.0 ^x	PAIR OF BRAKE SHOES with glued-on lining up to ma...	1
9	360.1.40.515.0 ^{xx}	PAIR OF BRAKE SHOES with glued-on lining from ma...	1
10	357.2.41.007.1	BRAKE PLATE	1
11	901.1091	HEXAGON SCREW M8x20 DIN 931-8G	N 1
12	357.1.41.028.2	ANCHOR BRACKET	1
13	22764	SPLIT PIN 2x20 DIN 94	N 1
14	900.2924	NARROW CASTELLATED NUT M8 DIN 937	N 1
14	24806	WASHER 8,4 DIN 433	N 1
15	101.1.4113	SECURING CLIP	2
16	050.4.4129	CONNECTING BOLT for anchor bracket	1
17	101.1.4112	CONNECTING BOLT for anchor bracket (slotted)	1
18	050.7.4113.2	BRAKE LEVER	1
18a	350.4.41.015.1	RETURN SPRING	1
19	26820	HEXAGON NUT M8x1 DIN 934	N 1
20	26819	SPRING RING B8 DIN 127	N 1
21	900.3219	SPRING WASHER 21/12,5/0,2	1
22	128.2504	RUBBER SEAL RING 20/12/3	1
23	900.6177	LUBRICATION NIPPLE A6 DIN 71412 (for plate with thread)	up to ma... 1
(23)	360.1.40.011.0	LUBRICATION NIPPLE compl. (for plate without thread)	from ma... 1
24	360.2.40.009.2 ^x	BRAKE CAM 66 long	up to ma... 1
24	360.1.40.509.1 ^{xx}	BRAKE CAM 65 long	from ma... 1

^x Only the parts up to ma... can be used together
^{xx} Only the parts from ma... can be used together

24. REAR WHEEL, CHAIN (cont.)

Pos- No.	Part-No.	Description	Required No.
25	900.4812	SLOTTED HOLLOW PIN 4x10 DIN 1481	N 2
26	050.4.4016 ^x	SLIDING PLATE 3,5 thick	up to ma... 2
26	360.1.40.516.1 ^{xx}	SLIDING PLATE 2,5 thick	from ma... 2
26	050.4.4016.3 ^x	SLIDING PLATE 4 thick (for repair)	up to ma... -
26	360.2.40.516.1 ^{xx}	SLIDING PLATE 3 thick (for repair)	from ma... -
27	050.4.4019	BRAKE SHOE SPRING, 50 long	2
28	901.4857	PIN N8x20 for sprocket	1
29	357.1.41.025.1	DISTANCE BUSH, 40 long	1
30	900.3837	SIMMER RING 32x18x8	2
31	900.4618	CLIP RING Sg 18x1 DIN 471	N 1
32	23836	BALL BEARING 32/12/10 6201 DIN 625	N 2
33	357.1.41.022.1	CENTERING DISC	1
34	357.2.41.023.2	DISTANCE TUBE, 35,5 long	1
35	900.4732	CLIP RING Sg 32x1,2 DIN 472	N 1
36	357.1.41.024.1	PRESSER BUSH, 21 long	1
38	25015	HEXAGON NUT M12x1 DIN 934-8G	N 1
39	357.1.41.051.1	SPACER, 12,5 long	2
42	357.1.41.030.1	PRESS RING, 15 long	1
43	357.1.41.026.1	SPINDLE, 238 long	1
45	357.2.40.030.1	SPOKE dia.3, 166 long	36
45	328.1.40.031.1	NIPPLE M3,5	36
45	367.2.40.033.1	WHEEL RIM 1,5Ax17	1
46	901.0867	WHEEL RIM LINING 17"	1
46	901.0820	INNER TUBE 21"-2,75"	1
46	901.0819	TYRE 21"-2,75" (black or white)	1
50	907.1.28.096.0	CHAIN (1/2"x3/16"x7,75) 96 rollers	1
51	907.1.28.001.0	CHAIN CONNECTOR compl.	1
52	-----	NO SPARE-PART	

^xOnly the parts up to ma... can be used to another

^{xx}Only the parts from ma... can be used to another



123456

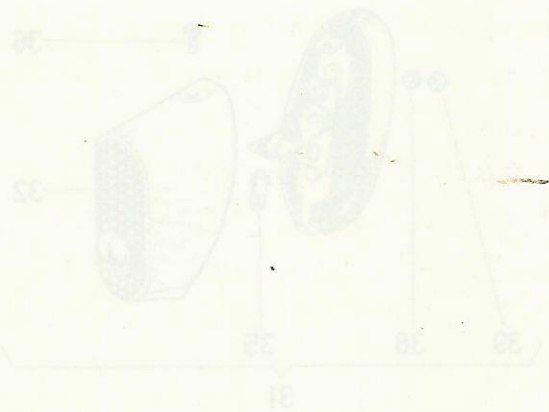

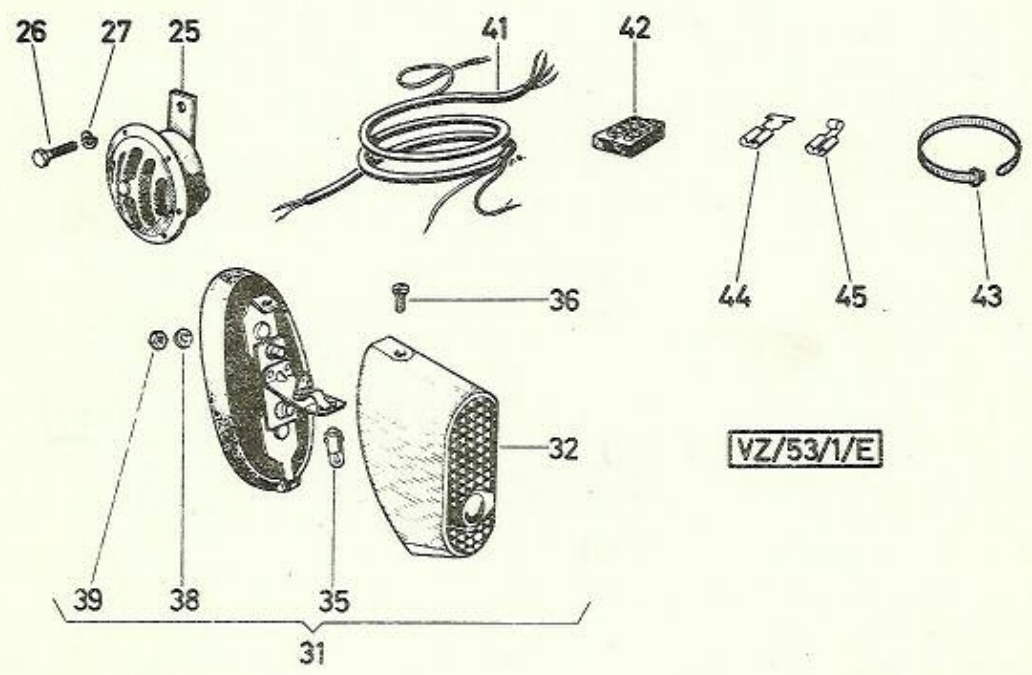
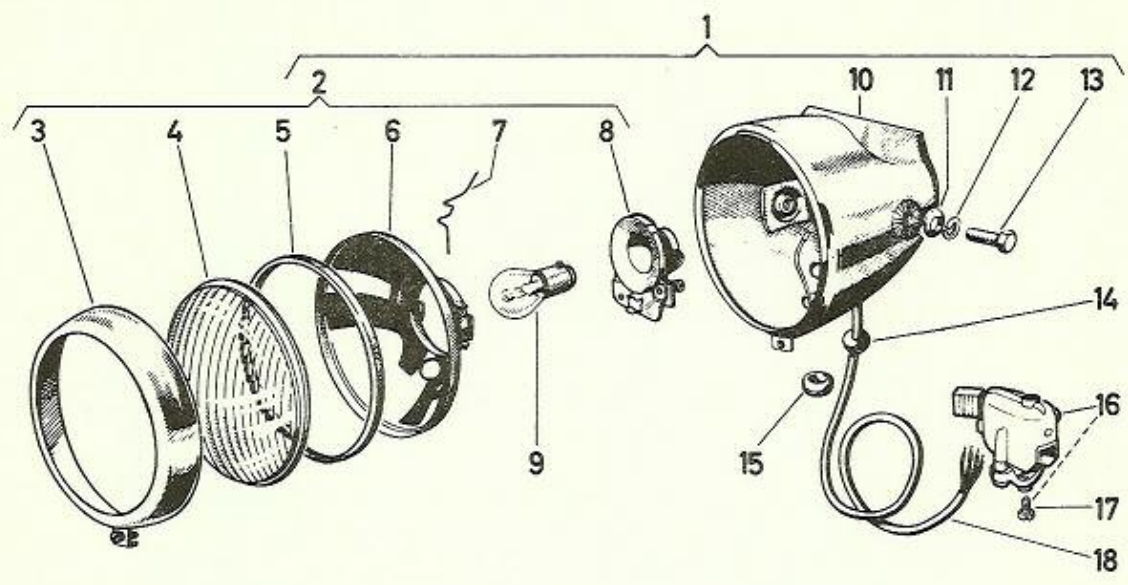

VZ/53/1/E

25. HEADLAMP, DIP SWITCH, BUZZER, TAIL-STOP-LIGHT

Pos- No.	Part-No.	Description	Required No.
1	367.2.53.100.0	HEADLAMP compl.	1
2	367.1.53.003.0	REFLECTOR compl. dia.120 (Wachter W 120 M) (with bulb holder, without bulb)	1
3	367.1.53.003.2	HEADLAMP RIM	1
4	330.1.53.004.1	HEADLAMP GLASS	1
5	330.1.53.006.1	SEAL RING (U-profile, dia.120)	1
6	330.1.53.008.2	REFLECTOR	1
7	28500	SPRING for reflector	6-8
8	330.1.53.019.0	BULB HOLDER compl.	1
9	903.0761	BULB BILUX 6V/18/18W lamp holder BA 20d	1
10	367.2.53.101.2	HEADLAMP HOUSING	1
11	126.3048	SPACING RING for headlamp-fixing	2
12	26819	SPRING RING B8 DIN 127	N 2
13	900.1104	HEXAGON SCREW M8x25 DIN 933	N 2
14	367.1.30.009.1	CABLE SLEEVE	2
15	101.1.5041	CABLE SLEEVE	1
16	357.3.53.117.0	SWITCH combined compl.	1
17	28881	CHEESE HEAD SCREW M4x10 DIN 84	N 1
18	902.0750/07	CONNECTING CABLE (ladder six-fold) 850 long	p.m.
25	902.0772	BUZZER (Hella with faston plug connector)	1
26	25399	HEXAGON HEAD SCREW M6x10 DIN 933	N 1
27	900.3212	CURVED WASHER A6 DIN 137	N 1
31	350.3.55.000.0	TAIL-STOP-LIGHT compl. (ZKW M 1378 M/1)	1
32	349.3.55.000.2	HOUSING for tail-stop-light	1
35	902.0712	BULB 6V 3W BA 9s	1
36	349.3.55.003.1	RETAINING BOLT (M4x12)	1
38	900.3255	SERRATED LOCK WASHER A5,3 DIN 6798	N 2
39	24772	HEXAGON NUT M5 DIN 934	N 2
41	357.1.57.500.0	CABLE compl.	1
42	364.1.57.001.0	SOFT RUBBER TERMINAL (4 rows)	1
43	364.1.53.227.1	CABLE BAND	1
44	501.1.85.083.1	FASTON PLUG TUBE	4
45	902.0771	FASTON PLUG TUBE	2

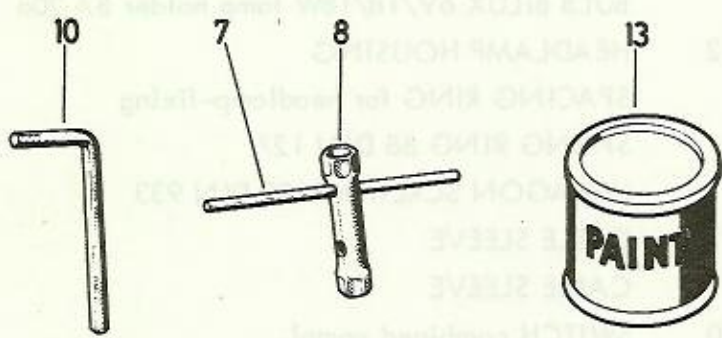
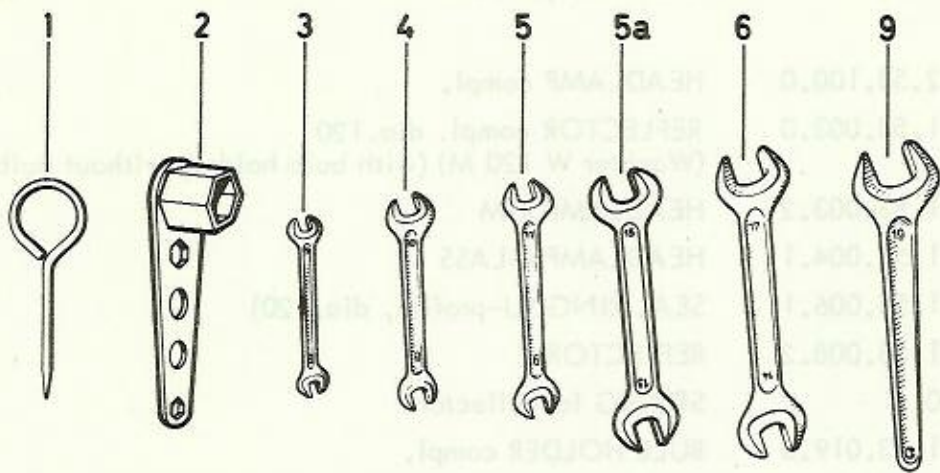

VZ/70/1/E

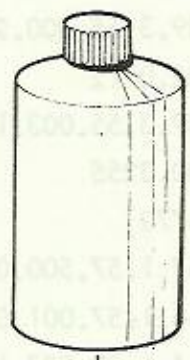
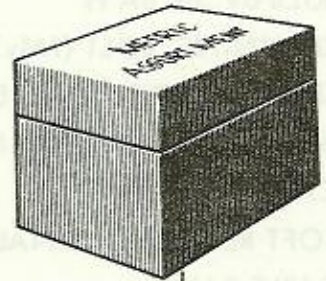
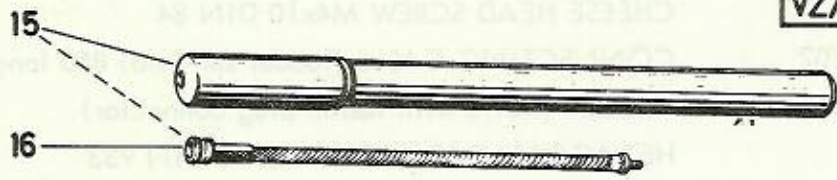

25

40

50

26. TOOLS

Pos- No.	Part-No.	Description	Required No.
--	357.2.70.000.0	SET OF TOOLS compl.	1
1	050.2.7021	SCREW DRIVER	1
(2)	175.7001.2	SOCKET SPANNER for plug	1
3	19599	OPEN ENDED SPANNER 6/7 DIN 895	(N)1
4	10181	OPEN ENDED SPANNER 8/10 DIN 895	(N)1
5	24324	OPEN ENDED SPANNER 9/11 DIN 895	(N)1
5a	900.7011	OPEN ENDED SPANNER 13/15 DIN 895	(N)1
6	24323	OPEN ENDED SPANNER 14/17 DIN 895	(N)1
7	050.7022	PIN dia.6, 115 long	1
8	350.1.70.008.1	SOCKET SPANNER 10/11	1
9	900.7010	OPEN ENDED SPANNER 19 DIN 894	(N)1
10	900.7014	SOCKET WRENCH 5 DIN 911	N 1
13	900.0280/10	VARNISH FOR MEND, yellow (P1060) 1/4 kg	as req.
15	050.7024.0	PUMP	1
16	050.7023.2	PUMP CONNECTOR, 200 long	1
25	366.1.70.003.1	TOOL BAG (plastic)	1
40	810.000	METRIC ASSORTIMENT (nut, bolt and screw assortment)	as req.
50	900.0137	"PUCH" SHOCK ABSORBER 1 litre	as req.

26. TOOLS

Quantity	Description	Part No.	Price
1	SET OF TOOLS compl.	357.2.70.000.0	—
1	SCREW DRIVER	020.2.7021	1
1	SOCKET SPANNER for plug	125.7001.2	(2)
(10)	OPEN ENDED SPANNER 2 1/2 DIN 892	19299	3
(10)	OPEN ENDED SPANNER 3/16 DIN 892	10181	4
(10)	OPEN ENDED SPANNER 7/16 DIN 892	21324	2
(10)	OPEN ENDED SPANNER 1 1/2 DIN 892	900.7011	20
(10)	OPEN ENDED SPANNER 1 1/2 DIN 892	24323	6
1	BIT dia. 6, 112 long	050.7022	2
1	SOCKET SPANNER 10/11	320.1.70.008.1	8
(10)	OPEN ENDED SPANNER 12 DIN 894	900.7010	8
1	SOCKET WRENCH 2 DIN 911	900.7014	10
or eq.	VARNISH FOR WELD, Yellow (M660) 1/4 kg	200.0280/10	13
1	PUMP	050.7024.9	12
1	PUMP CONNECTOR, 300 long	050.7022.2	14
1	TOOL BAG (plastic)	365.1.70.002.1	25
or eq.	METRIC ASSORTMENT (nut, bolt and screw assortment)	810.000	40
or eq.	"PUNCH" SHOCK ABSORBER 1 liter	900.0132	20

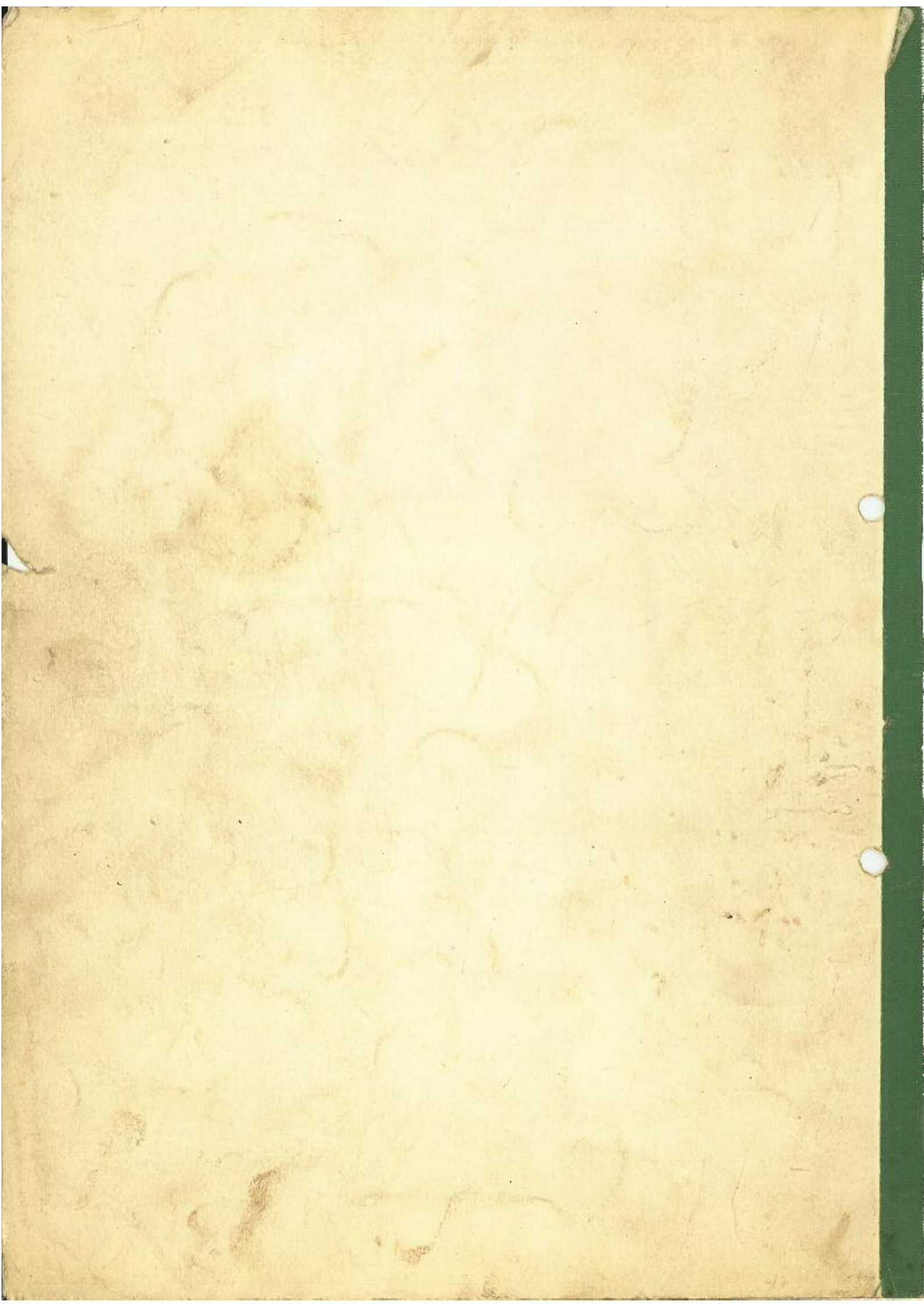



Spare parts - Modification notice



Service Graz

Order No. 2.60.45/009

DISTRIBUTOR

DATE July 1972

PAGE 1

Spare parts catalogue (model)

++ VS50 Sport England Edition May 1972

+ VZ50MN Edition July 1969

Re: New frame casing

Line	Page Group	Ref. No. Pos.	Old spare part No.	O X	New spare part No.	Remarks As from	M	Designation
1	+ 47	13	367.1.20.042.2					Frame casing left
	++ 37	8						
2	+ 47	14	367.1.20.046.2			→ 9254883		Frame casing right
	++ 37	14						
3	+ 48	32	331.1.15.074.1					Distance bush 60 long
	++ 37	16a						
4			367.2.20.042.2		9254884	→		1 Frame casing left
5			367.2.20.046.2					
6			367.1.15.074.1					
								1 Distance bush 76 long

* Interchange ability of the frame covering is feasible in pairs for either type the old or only the new one.

With regard to spare-parts, this change applies also to models VZ50MN already out of production.

O = Old part to be used up, new part applicable to both types.

X = Part omitted, must no longer be used.

→ 5007 up to Engine-No.

5008 → from Engine-No.

→ 2480 up to Chassis-No.

2481 → from Chassis-No.

M = Motive of Modification: 1) New feature / New part 2) Change in dimension
3) Change in quality 4) Change in shape 5) Change in part No. only

Signature

in spare parts catalogue

in spare parts index

in spare parts store



Spare parts - Modification notice

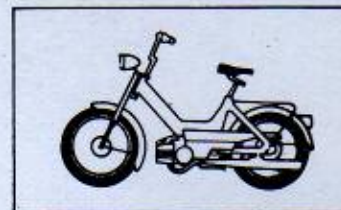

Service Graz

Order No. 2.60.45/010

DISTRIBUTOR

DATE July 1972

PAGE 1

Spare parts catalogue (model) England
MS50D, MS50V

Re: Combined switch alteration

Edition April 1968

Line	Page Group	Ref.No. Pos.	Old spare part No.	O X	New spare part No.	Remarks As from	M	Designation
1	81	22	357.1.53.017.0		MS50D MS50V	→ 7818451 → 5500632		Combined switch compl.
2				O	357.3.53.117.0	7818452 → 5500633 →	1	Combined switch compl.

Spare parts catalogue (model)

Re: Carburettor-alteration

MS50D England
Edition March 1971

3	8	—	360.6.15.500.0/54			→ 7820741		Carburettor HD 54
4	8	—	050.1509/54					Main Jet No.54
5				O	360.2.15.500.0/50			Carburettor HD 50
6					050.1509/50	7820742 →		Main Jet No.50
7					05011509/48			Main Jet No.48 as req.

Spare parts catalogue (model)

Re: Nomenclature plate alteration

Maxi England
Edition Juni 1971

8	30	54	349.2.20.533.1			→ 5228249		Nomenclature plate Maxi-S
9				O	349.3.20.533.1	5228250 →		Nomenclature plate Maxi-S year of construction - 19.. Model

Spare parts catalogue (model)

Re: New Ring Valve for suspension unit

VS 50 Sport
Edition May 1972

10	47	11	367.1.30.151.1			→ 9254937		Ring valve 0,3 strong for each suspension unit 2 pieces
11				O	367.2.30.151.1	9254938 →	1	Ring valve 0,5 strong for each suspension unit 1 pieces

O = Old part to be used up, new part applicable to both types.
X = Part omitted, must no longer be used.
→ 5007 up to Engine-No.
5008 → from Engine-No.
→ 2480 up to Chassis-No.
2481 → from Chassis-No.

M = Motive of Modification: 1) New feature, New part 2) Change in dimension
3) Change in quality 4) Change in shape 5) Change in part No. only

Signature in spare parts catalogue in spare parts index in spare parts store



Spare parts - Modification notice



Service Graz

Order No. 2.60.45/015

DISTRIBUTOR

DATE January 1973

PAGE 1

Spare parts catalogue (model)

Re: New spare parts for model VS 50 Sport/1973 (VZ50-3P) New Model-No. 62.23.45.1

Line	Page Group	Ref. No. Pos.	Old spare part No.	O X	New spare part No.	Remarks As from.....	M	Designation
1		328.4.10.501.1				Cylinder head cover (painted dull black)		
2		328.8.10.505.2				Cylinder normal dia. 38 (painted dull black)		
3		328.8.10.505.3				Cylinder oversize dia. 38,5 (painted dull black)		
4		328.1.10.605.0				Cylinder with piston compl. 350.1.10.006.0 dia. 38 with gudgeon pin and wire spring ring (painted dull black)		
5		328.1.10.605.6				Cylinder with piston compl. 350.1.10.006.4 dia. 38,5 with gudgeon pin and wire spring ring (painted dull black)		
6		357.1.15.070.0/30				Intake silencer compl. with air filter (painted dull black)		
7		328.1.32.105.0				Throttle grip unit compl.	} Type with spherical ends	
8		328.1.32.028.1			Brake lever			
9		360.9.32.104.0			Gearshift twist grip compl. (3rd speed circular pull)			
10		350.4.32.117.2				Clutch lever		
11		364.2.53.025.0				Driving coil compl. 790 long	} Illustration please see on the next side	
12		364.1.53.025.1				Driving shaft (core only)		
13		328.5.53.520.0				Speedometer with mounting		
14		367.3.53.024.0				Speedometer compl. (60mph)		
15		900.3795				O-Ring 49, 2-3		
16		328.2.53.530.0				Damping holder compl.		
17		328.2.53.523.1				Speedometer housing upper part		
18		328.2.53.522.1				Speedometer housing lower part		
19		900.9502				Cheese head screw BZ3, 9x9, 5 DIN 7971		
20		328.1.53.527.1				Speedo bracket		

O = Old part to be used up, new part applicable to both types.

X = Part omitted, must no longer be used.

→ 5007 up to Engine-No.

5008 → from Engine-No.

→ 2480 up to Chassis-No.

2481 → from Chassis-No.

M = Motive of Modification: 1) New feature/New part 2) Change in dimension

3) Change in quality 4) Change in shape 5) Change in part No. only

Signature

in spare parts catalogue

in spare parts index

in spare parts store

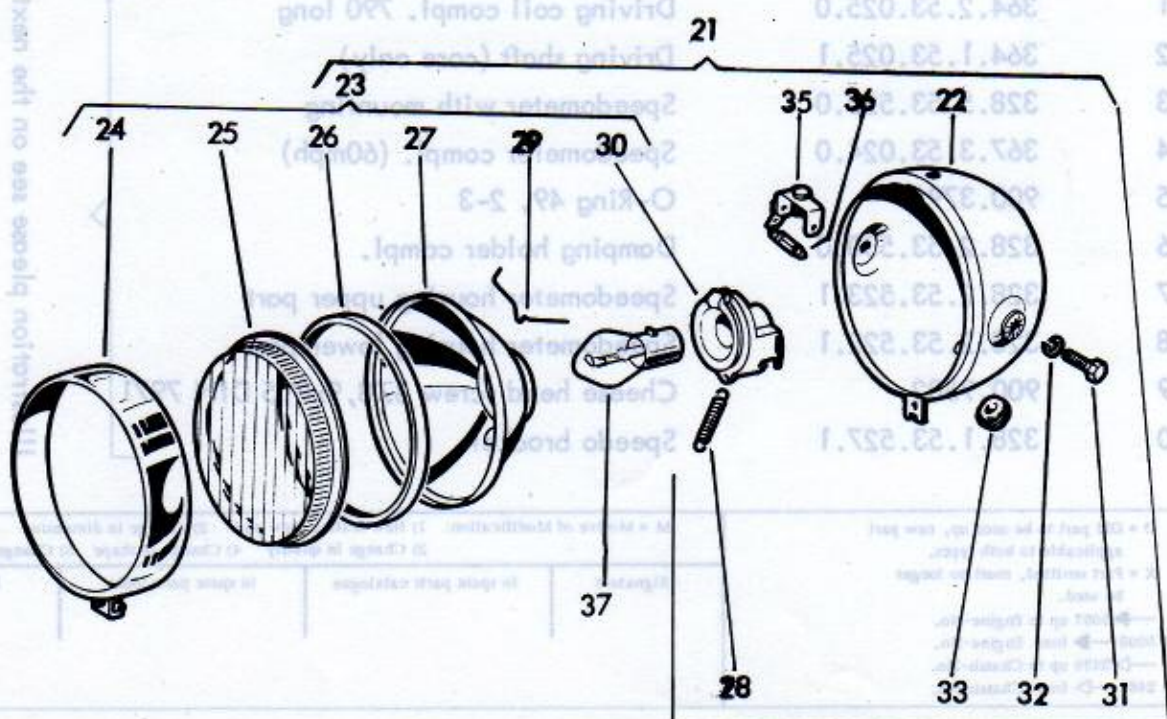
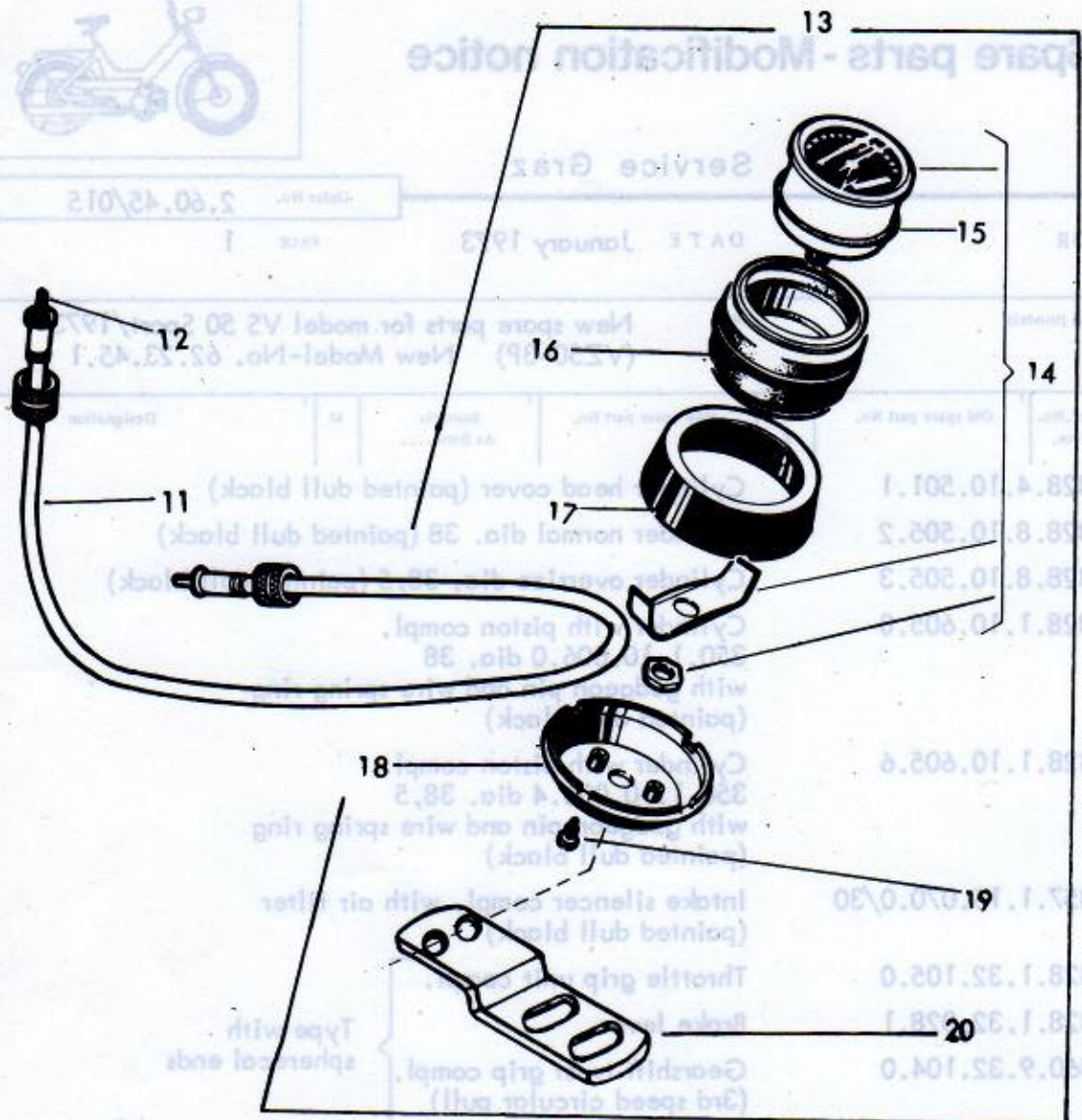



Spare parts - Modification notice



Service Graz

Order No. 2.60.45/015

DISTRIBUTOR

DATE January 1973

PAGE 2

Spare parts catalogue (model)

Re:

New spare parts for model VS 50 Sport/1973
(VZ50-3P) New Model-No.62.23.45.1 (cont.)

Line	Page Group	Ref.No. Pos.	Old spare part No.	O X	New spare part No.	Remarks As from	M	Designation
21		328.2.53.500.0				Headlamp compl. (ZKW dia. 130 M 1339m)		Illustration please see on the l.h.s.
22		328.2.53.501.2				Headlamp housing		
23		328.2.53.502.0				Headlamp unit compl. (with bulb holder, without bulb)		
24		328.2.53.503.2				Headlamp rim		
25		328.2.53.504.1				Headlamp glass		
26		328.2.53.505.1				Gasket		
27		328.2.53.508.1				Reflector		
28		328.2.53.509.1				Spring for bulb holder		
29		28500				Spring for reflector		
30		328.2.53.519.2				Bulb holder compl.		
31		22834				Hexagon screw M8x20 DIN 933		
32		26819				Spring ring B8 DIN 127		
33		24806				Washer 8,4 DIN 433		
34		328.1.53.013.1				Cable sleeve		
35		364.1.53.130.0				Full headlight control compl.		
36		902.0746				Tubular lamp M6V 0,6W lamp holder S7 (for full headlight control)		
37		903.0761				Bulb Bilux 6V/18/18W - equal as till now		

These changes are valid as from 20th January 1973 from ma.6137873
Referring old parts see spare parts catalogue VS 50 Sport, Edition May 1972

Rectification:

In our spare-parts-modification-notice Order-No. 2.60.45/005, line 9 and
Order-No. 2.60.45/006, line 7
a regrettable mistake has crept in, that is why line 9 and 7 must be cancelled.

O = Old part to be used up, new part applicable to both types.

X = Part omitted, must no longer be used.

→ 5007 up to Engine-No.
5008 → from Engine-No.

→ 2480 up to Chassis-No.
2481 → from Chassis-No.

M = Motive of Modification: 1) New feature New part 2) Change in dimension
3) Change in quality 4) Change in shape 5) Change in part No. only

Signature in spare parts catalogue in spare parts index in spare parts store



Spare parts - Modification notice

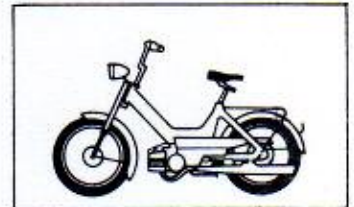

Service Graz

Order No. 2.60.45/017

DISTRIBUTOR ENGLAND

DATE Februar 1973

PAGE 1

Spare parts catalogue (model)		Re:						
VS50 Sport England		Change in material of layshaft						
Edition May 1972								
Line	Page Group	Ref.No. Pos.	Old spare part No.	O X	New spare part No.	Remarks As from	M	Designation
1	19	22 } 23 } 24 }	360.2.13.001.2			→ 6138397		Layshaft z= 11/17/19
2				O	360.7.13.001.2	6138398 →	3	Layshaft * z= 11/17/19
* Marked with an identification groove next to the gear having 11 teeth								

Spare parts catalogue (model)		Re:						
VS50 Sport England		New thrust washer						
Edition May 1972								
Line	Page Group	Ref.No. Pos.	Old spare part No.	O X	New spare part No.	Remarks As from	M	Designation
3	19	16	329.1.13.066.1			→ 6138397		Bearing washer 31,7/20/1,5 Gear 3rd speed (24 teeth)
4	19	28	360.1.13.013.1					
5				O	329.3.13.066.1	6138398 →	3	Bearing washer (tempered) 31,7/20/1,5 Gear 3rd speed (24 teeth) Thrust washer 32/21,1/2,2 } *
6				O	368.1.13.013.1		1	
7					368.1.13.066.1		1	
* The new parts used jointly replace the previous ones.								

Spare parts catalogue (model)		Re:						
VS50 Sport England		New exhaust flange gasket to compensate displaced flanges						
Edition May 1972								
Line	Page Group	Ref.No. Pos.	Old spare part No.	O X	New spare part No.	Remarks As from	M	Designation
8	29	32	050.1615			→ 6138477		Exhaust-flange-gasket
9				O	368.1.16.815.1	6138478 →	1	Exhaust-flange-gasket *
* Interchangeability not applicable to model VS 50 Sport								

*MS50V de luxe Edition Sept. 1972		New Bearing Washer (tempered)						
**MS50D Edition March 1971								
Line	Page Group	Ref.No. Pos.	Old spare part No.	O X	New spare part No.	Remarks As from	M	Designation
10	*21**7	*15a**15b	329.1.13.066.1		MS50V	→ 5511979		Bearing Washer
					MS50D	→ 7827074		31,7/20/1,5
11				O	329.3.13.066.1	5511980 → 7827075 →	3	Bearing washer 31,7/20/1,5 (tempered)

O = Old part to be used up, new part applicable to both types. X = Part omitted, must no longer be used. → 5007 up to Engine-No. 5008 → from Engine-No. → 2480 up to Chassis-No. 2481 → from Chassis-No.	M = Motive of Modification: 1) New feature New part 2) Change in dimension 3) Change in quality 4) Change in shape 5) Change in part No., only			
	Signature	in spare parts catalogue	in spare parts index	in spare parts store



Spare parts - Modification notice



Service Graz

Order No. 2.60.45/018

DISTRIBUTOR ENGLAND

DATE April 1973

PAGE 1

Line	Page Group	Ref. No. Pos.	Old spare part No.	O X	New spare part No.	Remarks As from	M	Designation
Spare parts catalogue (model) + MS50V/VKH England Edition April 1968 Re: Brake shoe with glued and rivetted lining ++ MV50 Deluxe England Edition Sept. 1972								
1	+67	1	050.4015.0					Brake shoe with glued lining
2	++63	9						
3				O	350.1.40.115.0		3	Brake shoe with glued and rivetted lining
4								
5			Brake shoes used as spare parts for models MS50D, MS50V / VKH, MV50 de Luxe					
6			are now glued and rivetted. (brake shoes for model MS50D are shown in the parts catalogue MS50V/VKH.)					

Line	Page Group	Ref. No. Pos.	Old spare part No.	O X	New spare part No.	Remarks As from	M	Designation
Spare parts catalogue (model) VS50 Sport England Re: Better laid gear control cable and clutch control cable Edition May 1972								
7	35	8	901.1978			→ 6138897		Threaded bolt M6x85 DIN 938
8				O	901.1972		1	Threaded bolt M6x90 DIN 938
9					901.9819	6138898 →	1	Cable clip for gear and clutch control cables (RS 1100-12/15) *
10								
11			* The new parts used jointly replace the previous ones.					

Line	Page Group	Ref. No. Pos.	Old spare part No.	O X	New spare part No.	Remarks As from	M	Designation
Spare parts catalogue (model) Maxi England Re: New part number due to method of manufacture Edition June 1971								
12	12	53	349.3.10.015.0					Crankshaft compl.
13				O	349.1.10.115.0		5	Crankshaft compl.

Line	Page Group	Ref. No. Pos.	Old spare part No.	O X	New spare part No.	Remarks As from	M	Designation
Spare parts catalogue (model) + VS50 Sport Edition May 1972 England Re: Threads on clutch side of crankshaft changed from ++ VS50D/DKH Edition April 1968 England M8x1 to M10x1								
14	+14	24	360.3.10.115.0					Crankshaft compl.
15	++17	14						
16	+17	15	26820			VS50 Sport → 6139297		Hexagon nut M8x1 DIN 934
17	++19	15				VS50D/DKH → 7828956		Serrated lock washer Ø8,4 DIN 6798
18	+17	16	900.3265					Crankshaft compl.
19	++19	16						Hexagon nut M10x1 DIN 934
20					329.2.10.015.0	6139298 →	1	Serrated lock washer Ø10,5 DIN 6778
21					900.2320	7828957 →	1	Hexagon nut M10x1 DIN 934
22					900.3262		1	Serrated lock washer Ø10,5 DIN 6778
23								
24			* The new parts used jointly replace the previous ones.					

O = Old part to be used up, new part applicable to both types.
X = Part omitted, must no longer be used.
→ 5007 up to Engine-No.
5008 → from Engine-No.
→ 2480 up to Chassis-No.
2481 → from Chassis-No.

M = Motive of Modification: 1) New feature / New part 2) Change in dimension
3) Change in quality 4) Change in shape 5) Change in part No., only

Signature	in spare parts catalogue	in spare parts index	in spare parts store
-----------	--------------------------	----------------------	----------------------



Spare parts - Modification notice



Service Graz

Order No. 2.60.45/022

DISTRIBUTOR ENGLAND

DATE SEPTEMBER 1973

PAGE 1

Spare parts catalogue (m-r-1e)				Re: NEW TYRE - SPECIAL SEMPERIT				
VS50 Sport ENGLAND EDITION MAY 1972								
Line	Page Group	Ref.No. Pos.	Old spare part No.	O X	New spare part No.	Remarks As from	M	Designation
1	60	49	901.0819	}	→	6140992		Tyre 21" - 2,75" for front wheel (extra reinforced semperit)
2	64	46	901.0819					Tyre 21" -2,75" for rear wheel (extra reinforced semperit)
3					901.0822	6140993 →	1	Tyre 21"-2,75" for front wheel and rear wheel (special semperit)

O = Old part to be used up, new part applicable to both types. X = Part omitted, must no longer be used. → 5007 up to Engine-No. 5008 → from Engine-No. → 2480 up to Chassis-No. 2481 → from Chassis-No.	M = Motive of Modification: 1) New feature New part 2) Change in dimension 3) Change in quality 4) Change in shape 5) Change in part No. only			
	Signature	in spare parts catalogue	in spare parts index	in spare parts store



Spare parts - Modification notice

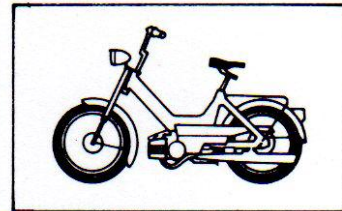

Service Graz

Order No. 2.60.45/041

DISTRIBUTOR ENGLAND

DATE December 1974

PAGE 1

Spare parts catalogue (model) VS50 Sport Edition Mav 1972
 MV50 de luxe Edition September 1972
 M.3.Sport Edition January 1974

Re. NEW PAIR OF BRAKE SHOES AND BRAKE CAM

Line	Page Group	Ref.No. Pos.	Old spare part No.	O X	New spare part No.	Remarks up to ... as from ...	M	Designation		
1	57/63	4/9	050.4.4015.0	}	MV50 de luxe ->	5534987		Pair of brake shoes		
2	57/64	12/24	360.2.40.009.2					Brake cam		
3	69/75	4/9	050.4.4015.0	}	M.3.Sport ->	7836714		Pair of brake shoes		
4	69/75	12/24	360.2.40.009.2					Brake cam		
5	59/63	4/9	050.4.4015.0	}	VS50 Sport ->	6143541		Pair of brake shoes		
6	59/63	12/24	360.2.40.009.2					Brake cam		
7	For model MV50 de luxe, M.3.Sport and VS50 Sport			}	[360.1.40.815.0]	5534988	▶	1	Pair of brake shoes	
8					[360.1.40.809.2]	7836715	▶			
9					[360.1.40.809.2]	6143542	▶	1	Brake cam	

10 The new parts used jointly replace the previous ones.

11 Further details with reference to fitting and interchange ability see service bulletin No. 29-26000/1002.

O = Old part to be used up, new part applicable to both types.
 X = Part omitted, must no longer be used.
 No symbol : Applicable to numbers quoted under remarks
 SPE = Spare part engine
 → 5007 up to Engine-No.
 5008 → from Engine-No.
 → 2480 up to Chassis-No.
 2481 → from Chassis-No.

M = Motive of Modification: 1) New feature/New part 2) Change in dimension
 3) Change in quality 4) Change in shape 5) Change in part No only

Signature	in spare parts catalogue	in spare parts index	in spare parts store
-----------	--------------------------	----------------------	----------------------