

IceniCAM Information Service

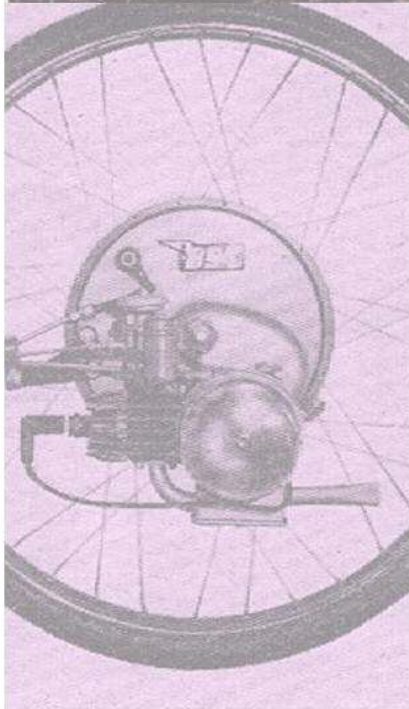

www.icenicam.org.uk

Steyr-Daimler-Puch (Great Britain) Ltd.

Steyr-Puch House
211 Lower Parliament Street
Nottingham NG1 1FZ
ENGLAND

Telephone: Nottingham (0 6 02) 56 5 21
Telex 37197



England

MS 50V - Deluxe Spare-Parts Catalogue

Edition September 1972

C O N T E N T S

ENGINE	1. CRANKCASE
	2. BLOWER
	3. CYLINDER
	4. ENGINE PARTS
	5. CLUTCH
	6. GEARBOX
	7. STARTER MECHANISM, CRANKS, PEDALS
	9. GEARSHIFT (manual shifting)
	10. CARBURETTOR
	11. INTAKE SILENCER
	12. EXHAUST
CHASSIS	13. FUEL TANK
	14. FRAME, MUDGUARDS
	16. SADDLE, LUGGAGE CARRIER, WEATHER SHIELD
	17. PIVOTED FORK, PROP STAND
	18. SHOCK ABSORBER
FRONT FORK	19. FRONT FORK AND STEERING
	20. HANDLEBAR, GEARSHIFT and THROTTLE TWIST GRIPS (Magura, new version)
	21. BOWDEN CABLES for new handlebar armatures
ROAD WHEELS	22. FRONT WHEEL
	23. SPEEDOMETER WITH DRIVE
	25. REAR WHEEL DRIVING CHAIN
ELECTRICAL EQUIPM.	26. GENERATOR
	27. HEADLAMP, TAIL STOP LIGHT, HORN, ELECTRICAL EQUIPMENT
ACCESSORIES	28. TOOLS, PUMP

To convert millimeters to inches, multiply by 0,03937

PUCH MS50V-Deluxe

ENGLAND

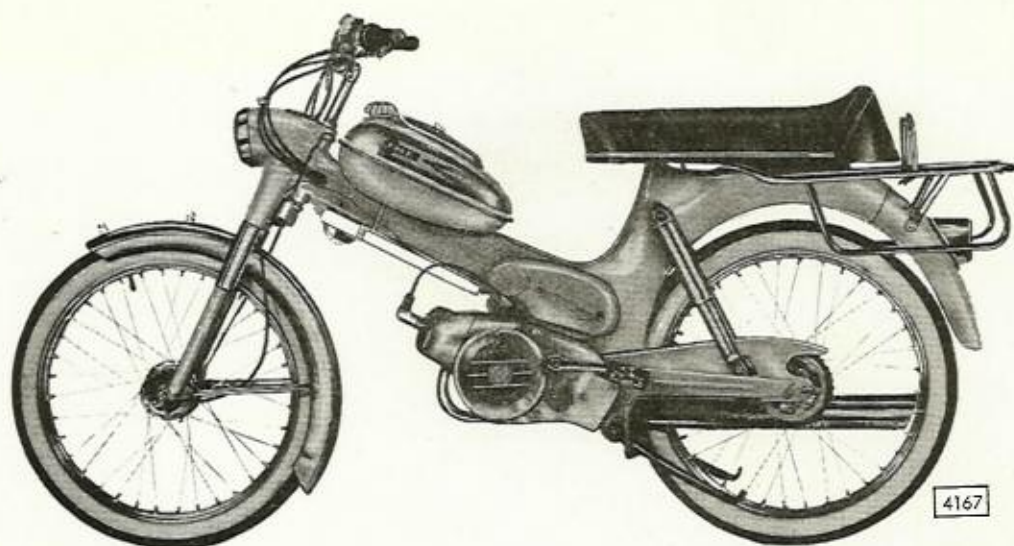

MS50V - Deluxe / 1972

VIEW l.h.s.

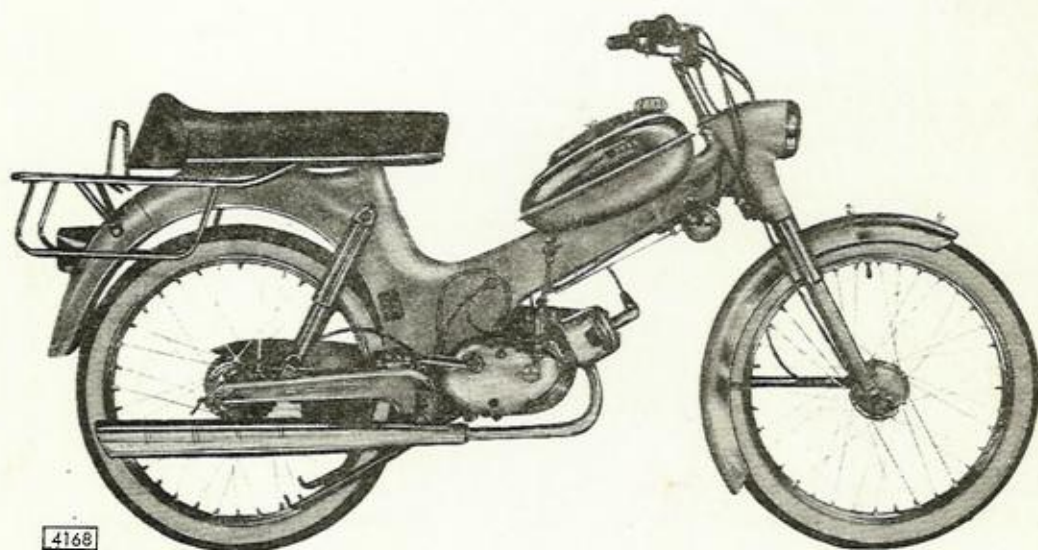

MS50V - Deluxe / 1972

VIEW r.h.s.

IMPORTANT I

To get a quick and correct settlement of your spare parts orders following statements are necessary:

1. Exact statement of vehicle
2. Engine no.
3. Spare parts no.
4. Description
5. Colour
6. Required quantity
7. Wanted way of delivery

Beside this our general terms of sale and delivery are valuable.

Please direct your orders to:

place for stamp

GENERAL EXPLANATIONS

Statements as "left", "right", "front", "rear" at the description of spare parts are referring to the moving direction of vehicle. The given dimensions (in mm) for particular parts have to be considered as standards. (To convert millimeters to inches, multiply by 0,03937).

A ref.no. within brackets before a spare part means, that the said part is only similar to the illustration.

A "N" before the statement of requd. quantity is marking a standard part. The abbreviation "as requd." means "as required"; the abbreviation "p.m." means "per meter".

The content of the present manual is not obliging for delivery and equipment of vehicle.

IMPORTANT!

To get a quick and correct refitment of your spare parts order following statements are necessary:

1. Exact statement of vehicle

2. Engine no.

3. Part no.

4. Quantity

5. Parted quantity

6. Parted quantity

7. Parted quantity

8. Parted quantity

9. Parted quantity

10. Parted quantity

11. Parted quantity

12. Parted quantity

13. Parted quantity

14. Parted quantity

15. Parted quantity

16. Parted quantity

17. Parted quantity

18. Parted quantity

19. Parted quantity

20. Parted quantity

21. Parted quantity

22. Parted quantity

23. Parted quantity

24. Parted quantity

25. Parted quantity

26. Parted quantity

27. Parted quantity

28. Parted quantity

29. Parted quantity

30. Parted quantity

31. Parted quantity

32. Parted quantity

33. Parted quantity

34. Parted quantity

35. Parted quantity

36. Parted quantity

37. Parted quantity

38. Parted quantity

39. Parted quantity

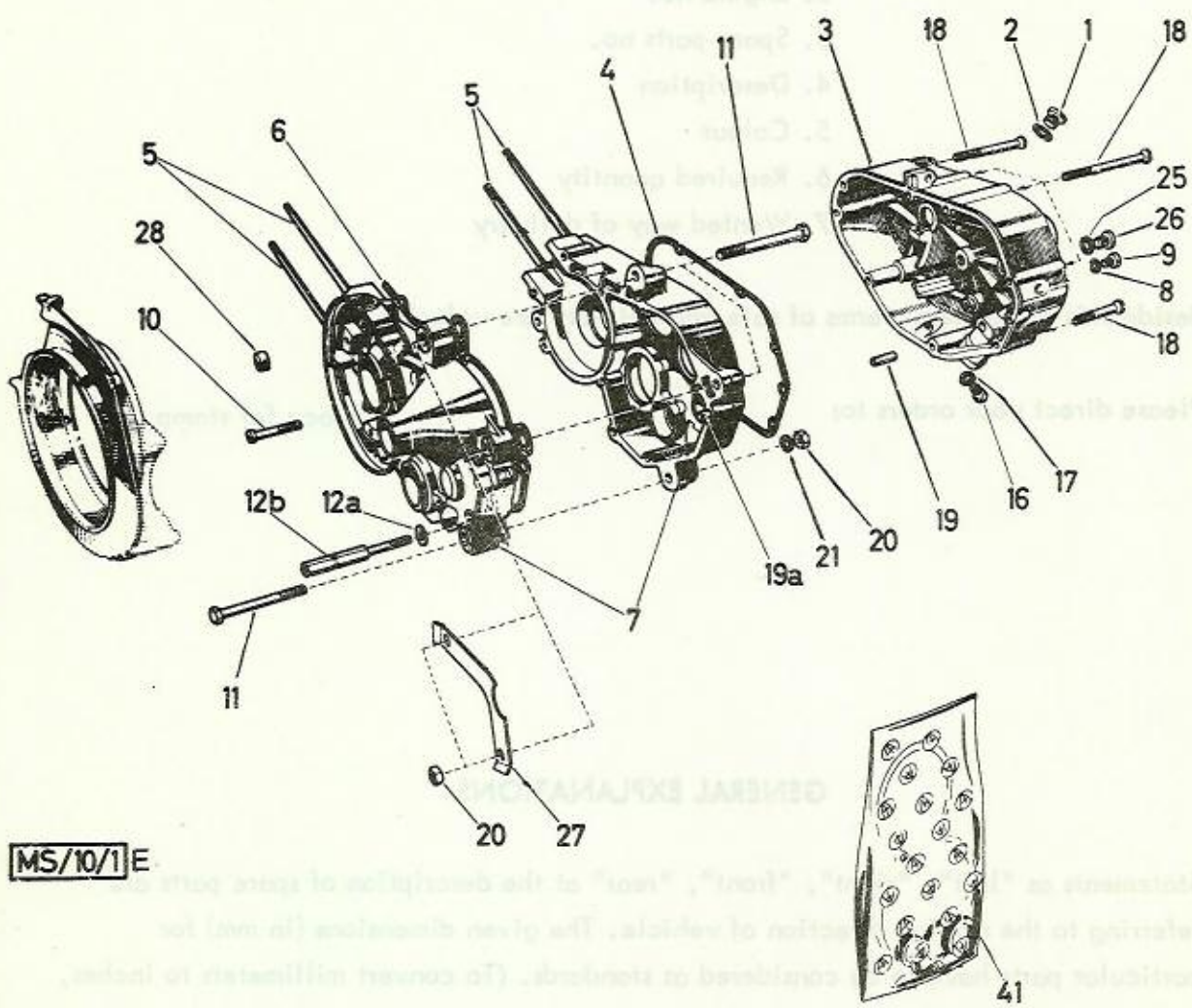

MS/10/1 E



GENERAL EXPLANATION OF THE ILLUSTRATION

Statements as "part", "quantity", "ref", "part", "quantity" or "ref" at the description of your parts referring to the ref. no. of the description of your parts. The given dimension (in mm) for particular parts is considered as standard. (To convert millimeter to inches, multiply by 0.03937).

A ref. no. within brackets before a spare part means that the said part is only similar to the illustration.

A "ref" before the statement of ref. no. quantity is making a standard part. The abbreviation "or ref." means "or ref.", the abbreviation "p.m." means "per meter".

The content of the present manual is not obliging for delivery and equipment of vehicles.

Ref. No.	Part No.	Description	Required-No.
1	364.1.10.660.1	Oil filler plug	1
2	27071	Seal washer A10x14 DIN 7603 N	1
3	350.6.10.035.0	Crankcase cover right	1
4	050.1.1049	Crankcase cover gasket	1
5	360.1.10.034.1	Stud bolt M6, 103 long	4
6	328.1.10.731.1	Crankcase gasket	1
7	350.2.10.032.0	Crankcase complete	1
8	24365	Seal washer A6x12 DIN 7603 N	1
9	900.1305	Fillister head screw M6x8 DIN 84 for oil control	N 1
10	900.1319	Fillister head screw M6x35 DIN 84 for crank- case assembly	N 8 ⁹
11	900.1136	Hexagon head screw M8x1x65 DIN 960-8 G	N 3
12a	24804	Washer 6,4 DIN 433	as req.
12	350.2.10.076.1	Screw (M6, 50 long)	
12b	350.2.10.030.1	Screw (M6, 90 long)	1
16	901.1053	Hexagon head screw M8x10 Sz DIN 933 for oil drain plug	N 1
17	26482	Seal washer A8x14 DIN 7603	N 1

Ref. No.	Part No.	Description	Required No.
18	900.1637	Fillister head screw CM6x70 DIN 91	N 3
18	900.1653	Fillister head screw M6x50 DIN 91	N 3
18	900.1617	Fillister head screw M6x65 DIN 91	N 1
19	900.4810	Cylindrical pin 6h8x18 DIN 7	N 2
19a	050.10.1054	Spacer	2
20	900.2021	Hexagon nut M8x1 DIN 934 - 6S	N 3
21	26819	Spring ring B8 DIN 127	N 1
25	26482	Seal washer A8x14 DIN 7603	N 1
26	900.1512	Lens head screw AM8x10 DIN 85	N 1
27	050.1.1096	Locking plate for nuts	1
28	050.10.1088	Rubber plug for crank- case 12,5 mm dia., 10,5 long	2
41	302.2.10.210.0	Set of gasket	1

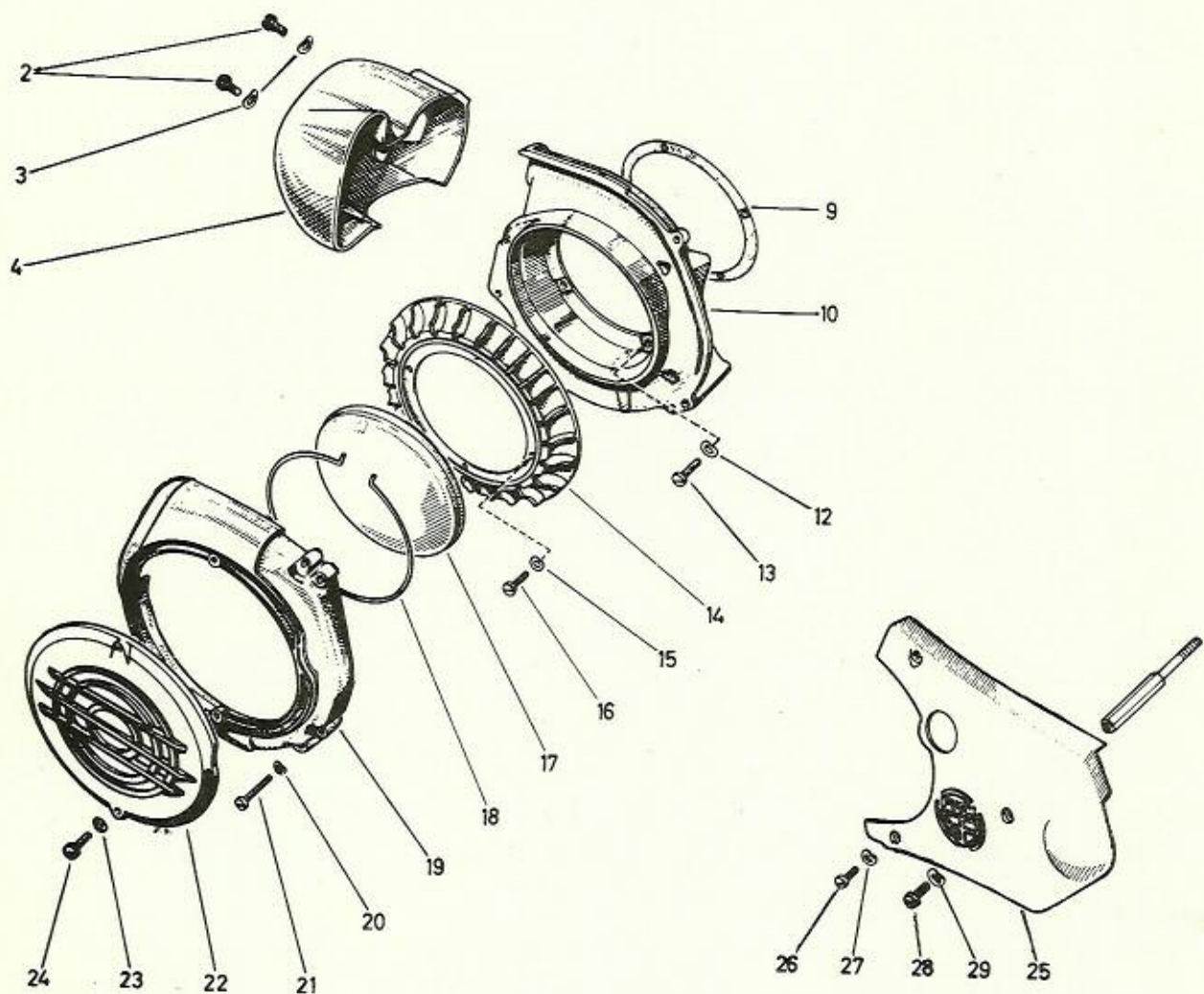

MS/10/2 E

Ref. No.	Part No.	Description	Requd.No.	Note
2	900.1514	Lens head screw M 6x10 DIN 85	N 2	
3	900.3213	Spring washer B6 DIN 137	N 2	
4	364.1.10.065.1	Blower hood (replacement for 52.1.1065.1)	1	
9	050.10.1036	Gasket 122,5 mm dia (paper)	1	
10	350.5.10.061.1	Blower base plate	1	
12	900.3218	Spring washer 9/5, 2/1	4	
13	23099	Fillister head screw AM 5x12 DIN 84	N 4	
14	350.5.10.072.1	Blower fan wheel	1	
15	900.3205	Spring washer A 5 DIN 137	N 4	
16	1426	Fillister head screw AM 5x8 DIN 84	N 4	
17	050.10.1073	Cover plate	1	
18	350.1.10.074.1	Spring ring (securing ring)	1	
19	050.10.1062	Blower housing	1	
20	900.3202	Spring washer A 4 DIN 137	N 3	
21	900.1520	Lens head screw M 4x20 DIN 85	N 3	
22	368.1.10.068.1	Blower lower cover	1	
23	900.3964	Clamp disc 4	2	
24	900.1543	Lens head screw AM 4x8 DIN 85	N 2	
25	350.2.10.164.1	Fairing plate	1	
26	900.1506	Lens head screw M 4x12 DIN 85	N 2	
27	900.3202	Spring washer A 4 DIN 137	N 2	
28	27157	Lens head screw M 5x20 DIN 85	N 1	
29	900.3205	Spring washer A 5 DIN 137	N 1	

Part No.	Description	QTY
----------	-------------	-----

2	900.1514	1	Head screw M 4x10 DIN 913
3	900.3213	1	Spring washer 25 DIN 127
4	354.1.10.082.1	1	Blower hood (replacement for 354.1.10.082.1)
5	050.10.1074	1	Blower hood (replacement for 050.10.1074)
10	350.1.10.081.1	1	Blower hood plate
12	900.1518	1	Head screw M 4x10 DIN 913
13	900.3205	1	Spring washer 4 DIN 127
14	350.1.10.075.1	1	Blower hood (replacement for 350.1.10.075.1)
15	900.3205	1	Spring washer 4 DIN 127
16	143.1	1	Blower hood (replacement for 143.1)
17	050.10.1071	1	Blower hood (replacement for 050.10.1071)
18	350.1.10.074.1	1	Blower hood (replacement for 350.1.10.074.1)
19	050.10.1082	1	Blower hood (replacement for 050.10.1082)
20	900.3205	1	Spring washer 4 DIN 127
21	900.1520	1	Head screw M 4x10 DIN 913
22	354.1.10.081.1	1	Blower hood (replacement for 354.1.10.081.1)
23	900.3964	1	Blower hood (replacement for 900.3964)
24	900.1543	1	Head screw M 4x8 DIN 913
25	350.1.10.184.1	1	Blower hood (replacement for 350.1.10.184.1)
26	900.1508	1	Head screw M 4x12 DIN 913
27	900.3205	1	Spring washer 4 DIN 127
28	27157	1	Head screw M 5x20 DIN 913
29	900.3202	1	Spring washer 5 DIN 127

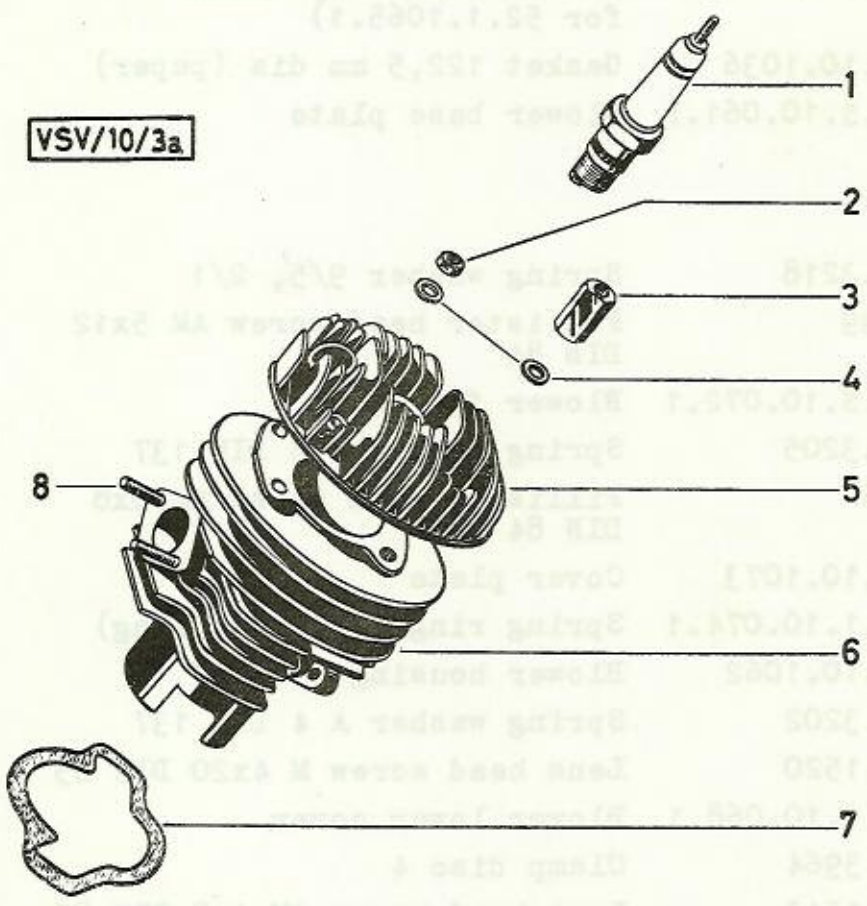

VSV/10/3a



Ref. No.	Part No.	Description	Requd.No.	Note
1	23733	Spark plug	1	
2	24773	Hexagon nut M6 DIN 934	N 2	
3	050.1.1003	Round neck nut (M6) for cylinder head	2	
4	24795	Washer 6,4 DIN 125	N 4	
5	350.3.10.201.1	Cylinder head	1	
6	350.1.10.205.2	Cylinder normal, 38 mm dia.	1	} x
6	350.1.10.205.3	Cylinder, 38,5 mm dia.	1	
6	350.1.10.305.0	Cylinder with compl. piston 38 mm dia.	1	
6	350.1.10.305.6	Cylinder with compl. piston 38,5 mm dia.(new part for exchange)	1	} xx
7	050.1.1013	Cylinder base flange gasket	1	
8	050.1.1014	Stud bolt M6x16	2	

)x We suggest to store only cylinders with compl. pistons.

xx If you exchange parts the cylinder must not have damages, for instance rupturing ribs.

Ref. No.	Part No.	Description	Requd.No.	Note
1	900.4855	Notched locking pin 2x6 DIN 1473	N 2	
2	320.1.10.060.1	Piston ring AZ 38x2ac DIN 73102	N 2	
2	320.1.10.060.3	Piston ring, oversize I, AZ 38, 5x2ac DIN 73102	N -	
3	350.1.10.006.0/03 ^x	Piston compl., normal, dia.38, sort.1	1	
3	350.1.10.006.0/04 ^x	Piston compl., normal, dia.38, sort.2	2	
3	350.1.10.006.4/03 ^x	Piston compl., oversize dia.38,5, sort.1	1	
3	350.1.10.006.4/04 ^x	Piston compl., oversize dia.38,5, sort.2	1	
4	901.4701	Wire spring ring B12 DIN 73123	N 2	
5	331.1.10.011.1/12 ^x	Gudgeon pin dia.12, 31 long, sort.2 (white)	1	as required
5	331.1.10.011.1/13 ^x	Gudgeon pin dia.12, 31 long, sort.3 (blue)	1	as required
6	349.1.10.021.1 ^x	Bush for connecting rod 14/11,6/12	1	
6	349.1.10.021.3	Bush for connecting rod (for repair)		as req.
				
11	900.3807	Seal ring BA 35/17/7	2	
12	900.2.6007	Ball bearing L 17a 40/17/10 DIN 615	N 2	
13	900.3922	Spacer shim 24/18,1/0,1	-	
13	900.3923	Spacer shim 24/18,1/0,2	-	} as } requd.-
13	900.3992	Spacer shim 24/18,1/0,05	-	
14	350.3.10.215.0	Crankshaft complete with connecting rod (replacement for 350.3.10.115.0)	1	

^xOrdering pistons or gudgeon pins we ask to state the required piston assortment 1 or 2.
(Pressed-on no.1 or 2 on piston ground, choose piston as recommended in our
Service Bulletins).

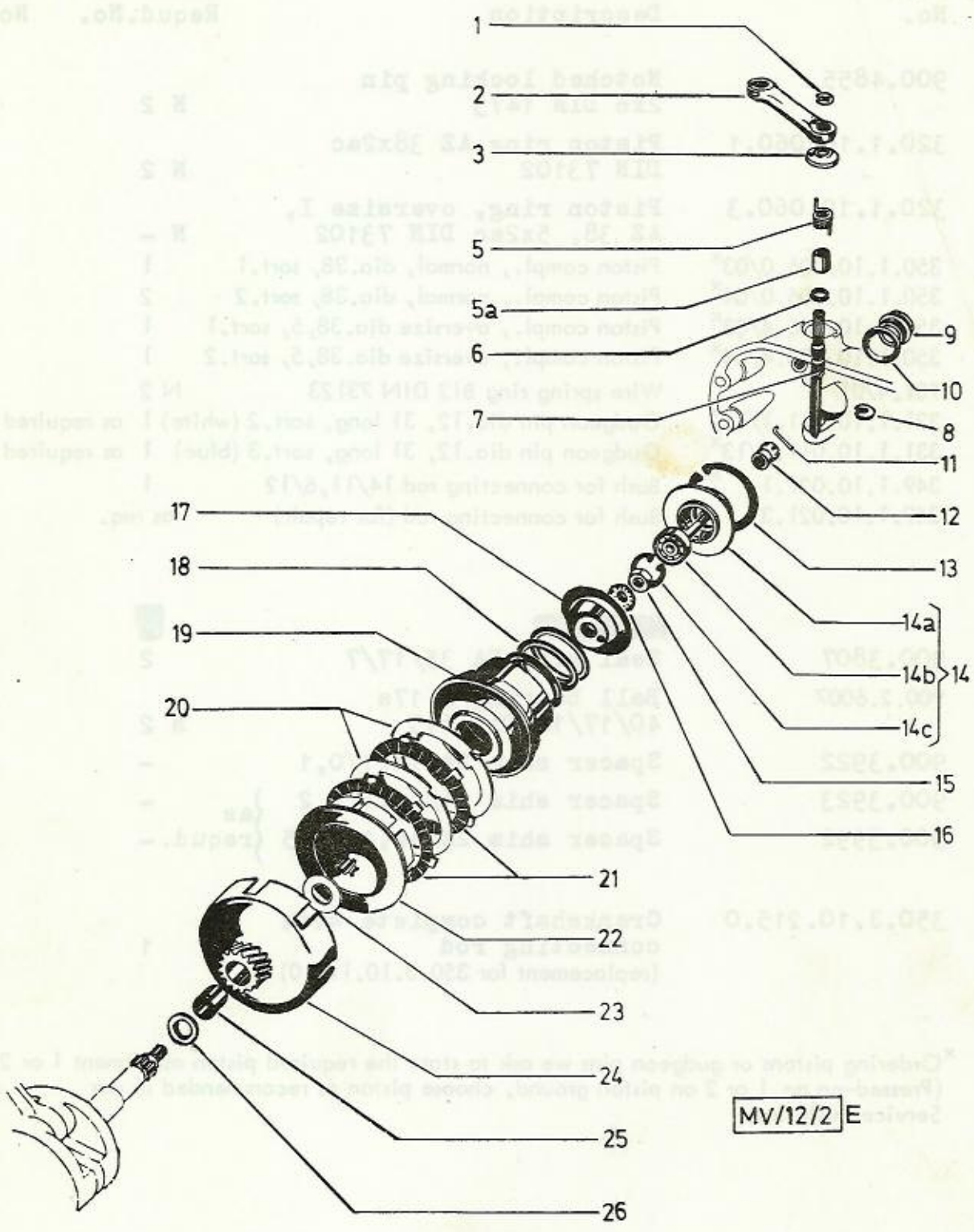

MV/12/2 E

5. CLUTCH

Ref. No.	Part No.	Description	Requd. No.	Note
1	900.4606	Circlip 6 DIN 6799	N 1	
2	050.2.1231	Declutching lever	1	
3	350.1.12.019.1	Covering plate (plastic)	1	
5	350.2.12.022.1	Torsion spring	1	
5a	350.1.12.029.1	Spring guide	1	
6	900.3883	Oil seal Rs 6-9-1,5	1	
7	350.3.12.028.1	Declutching shaft	1	
8	900.4693	Seeger-O-Ring H10x1	1	
9	050.1.1233	Centering screw	1	
10	900.3718	Fibre seal washer 26,5/22/1	1	
11	050.1237	Wire pin 1,4 mm dia.	1	
12	050.1234	Ball nut	1	
13	900.4745	Snap ring Sg 45x1,75 DIN 472	N 1	
14	050.2.1230.0	Set bolt (compl.w.ball bearing, bearing shell and snap ring)	1	
14a	350.2.12.010.1	Bearing shell	1	
14b	050.1240.2	Set bolt (compl.w.ball bearing, without bearing shell)	1	
14c	900.4721	Snap ring Sg21x1 DIN 472	N 1	
15	26820	Hexagon nut M8x1 DIN 934	N 1	
16	900.3265	Serrated lock washer J 5,3 DIN 6798	1	
17	050.1207	Spring collar	1	
18	050.1206	Clutch spring	1	
19	050.1205	Spring cage	1	
20	050.1212	Interior clutch disc	2	
21	050.1224.2	Exterior clutch disc (with friction lining)	2	
22	050.1204	Clutch hub	1	
23	050.1215	Thrust washer 26/15/1	1	
24	350.1.12.002.2	Clutch housing (19 teeth)	1	
25	050.1211	Bearing bushing 17/15/16,3	1	
26	050.1213	Thrust washer 22/15/1,7	1	

CLUTCH

No.	Description	Part No.
-----	-------------	----------

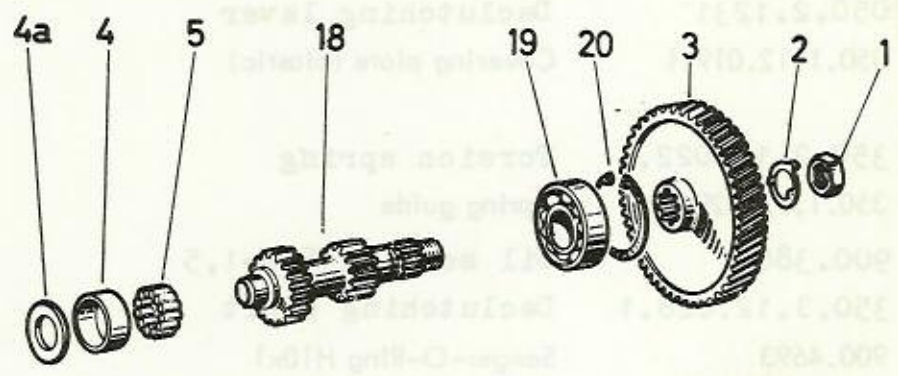

1	Nut	050.1513
2	Washer	050.1514
3	Gear	050.1515
4	Sleeve	050.1516
4a	Washer	050.1517
5	Gear	050.1518
6	Gear	050.1519
6a	Washer	050.1520
7	Shaft	050.1521
8	Gear	050.1522
10	Washer	050.1523
11	Washer	050.1524
12	Washer	050.1525
14	Washer	050.1526
15	Washer	050.1527
15a	Washer	050.1528
16	Washer	050.1529
18	Shaft	050.1530
19	Bearing	050.1531
20	Sleeve	050.1532

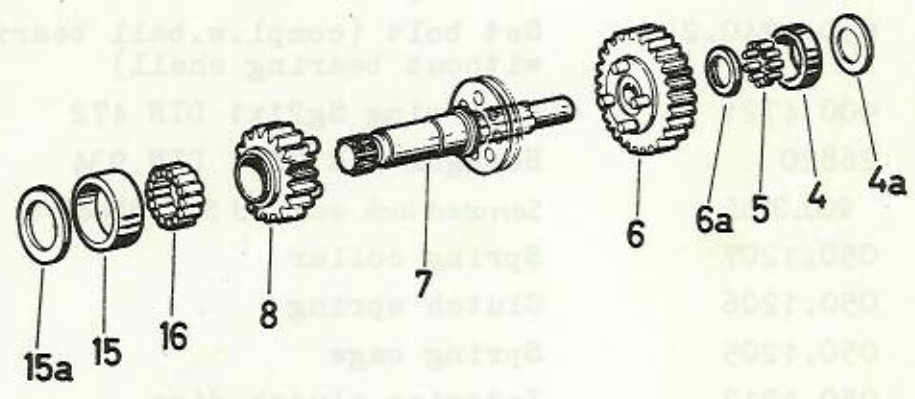
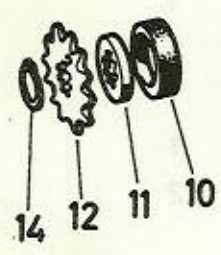

MS 25/14 E

Ref. No.	Part No.	Description	Requd. No.	Note
(1)	24787	Hexagon nut M12x1	1	
(2)	360.1.13.004.1	Locking plate 22/12,5 mm dia. (flaps outwards)	1	
3	350.1.13.000.1	Driving pinion (helical gear 69 teeth)	1	
4	329.1.13.010.1	Roller race dia.28	2	
4a	329.1.13.009.1	Bearing washer 27,8x16x1	2	
5	900.6104	Roller 3,5x7,5 (14 rollers to each race)	28	
6	350.1.13.011.1	First-speed gear (28 teeth) without collar	1	
6a	350.1.13.075.1	Disc 18/12,5/1,6	-	} as required, for first- speed gear without collar
6a	350.1.13.078.1	Disc 18/12,5/1,8	-	
6a	350.1.13.076.1	Disc 18/12,5/2	-	
6a	350.1.13.079.1	Disc 18/12,5/2,25	-	
6a	350.1.13.077.1	Disc 18/12,5/2,5	-	
6a	350.1.13.080.1	Disc 18/12,5/2,75	-	
7	350.2.13.020.1	Main shaft 90,5 long	1	
8	350.1.13.112.1	Second-speed gear (23 teeth)	1	
10	050.1321	Seal washer BA28/17/7	1	
11	050.1.1319	Intermediate disc	1	
12	050.1317	Gearbox chain sprocket (12 teeth) standard equipment	1	
14	900.4616	Snap-ring 16x1 DIN 471	1	
15	329.1.13.065.1	Outer race dia.32	1	
15a	329.1.13.066.1	Bearing washer 31,7x20x1,5	1	
16	900.6104	Roller 3,5 mm dia.x7,5	18	
18	350.1.13.101.1	Counter shaft 10/16 teeth, 102,5 long	1	
19	900.6202	Deep-row ball bearing 6202 C3 35/15/11 DIN 625 (replaceable by 900.4.6202)	N 1	
20	900.4735	Snap ring Sg35x1,5 DIN 472	N 1	

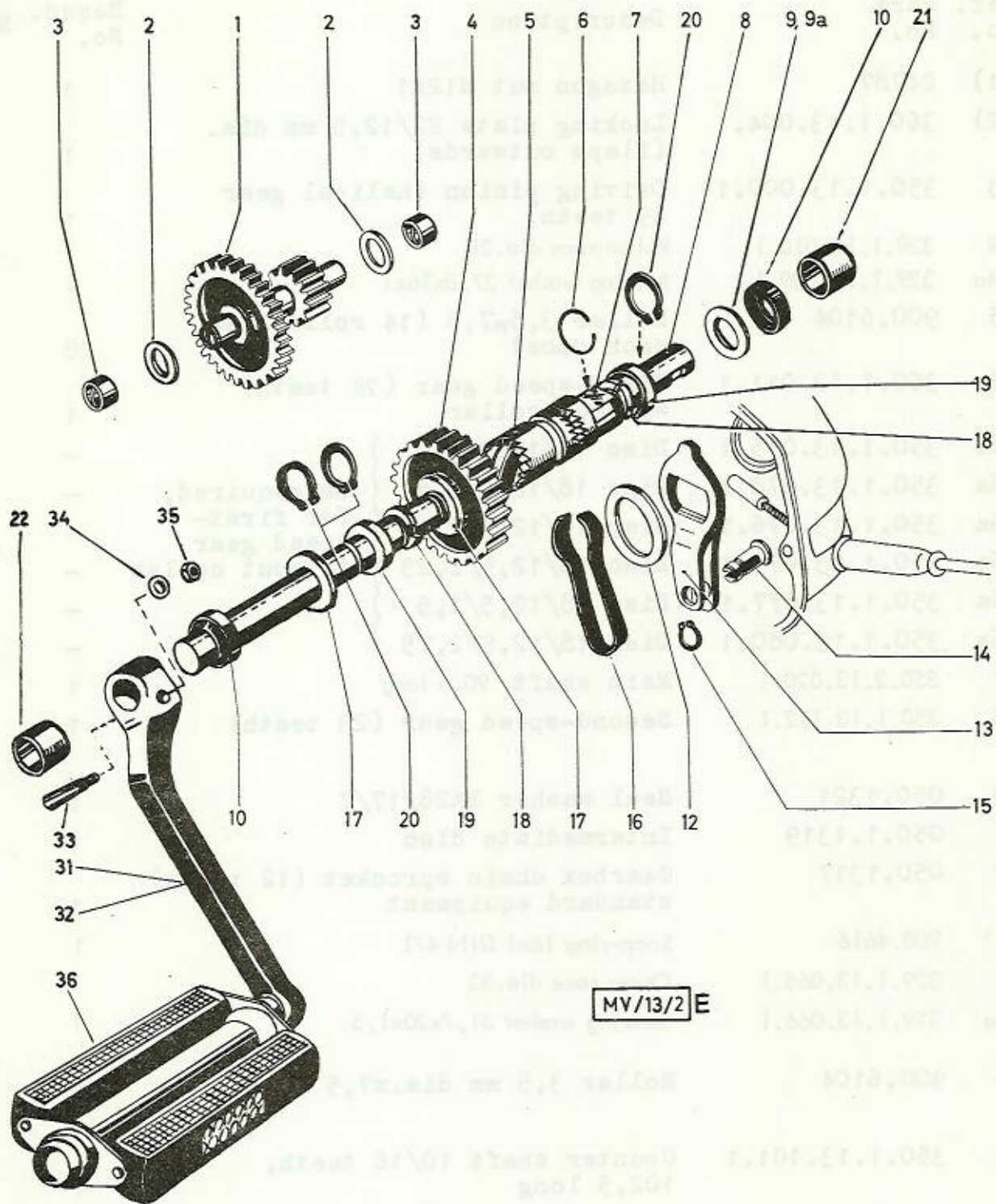

MV/13/2 E

Ref. No.	Part No.	Description	Requd. No.	Note
1	350.2.13.030.2	Starter intermediate shaft (33 and 15 teeth)	1	
2	050.1329	Thrust washer 20,5/14/1,9	2	
2	050.1329.2	Thrust washer 20,5/14/2	2	
2	050.1329.3	Thrust washer 20,5/14/2,1	2	as required
2	050.1329.4	Thrust washer 20,5/14/2,4	2	
3	360.1.13.033.1	Bearing bushing 19/14/9,5	2	
4	364.1.13.031.1	Starter gear (31/20 teeth)	1	
5	050.4.1327	Driver (20 teeth)	1	
6	900.3221	Spring ring 2 mm dia.x 30 mm dia. for claw collar	1	
7	050.4.1337	Claw collar (20 teeth)	1	
8	350.4.13.032.1	Pedal shaft, 290 long	1	
9	050.4.1353	Thrust washer 26/16,2/1	1	
9a	(900.3922	Spacer shim 24/18,1/0,1 } as requd.	-	
	(900.3923		-	
	(900.3924		-	
10	050.1335	Rubber seal ring BAOF 24/16/7	2	
12	900.3987	Washer 38/27/2,5	1	
13	350.2.13.038.2	Brake lever	1	
14	350.2.13.047.1	Clevis bolt	1	
15	900.4610	Snap ring Sg10x1 DIN 471	N 1	
16	050.1.1334	Brake spring for driver	1	
17	050.1343	Thrust washer 26/16/2	2	
18	350.3.13.051.1	Spring ring	2	
19	350.3.13.052.1	Catching ring	2	
20	900.4616	Snap ring Sg16x1 DIN 471	N 3	
21	357.1.13.055.1	Protection sleeve	1	
22	357.1.13.054.1	Protection sleeve	1	./.

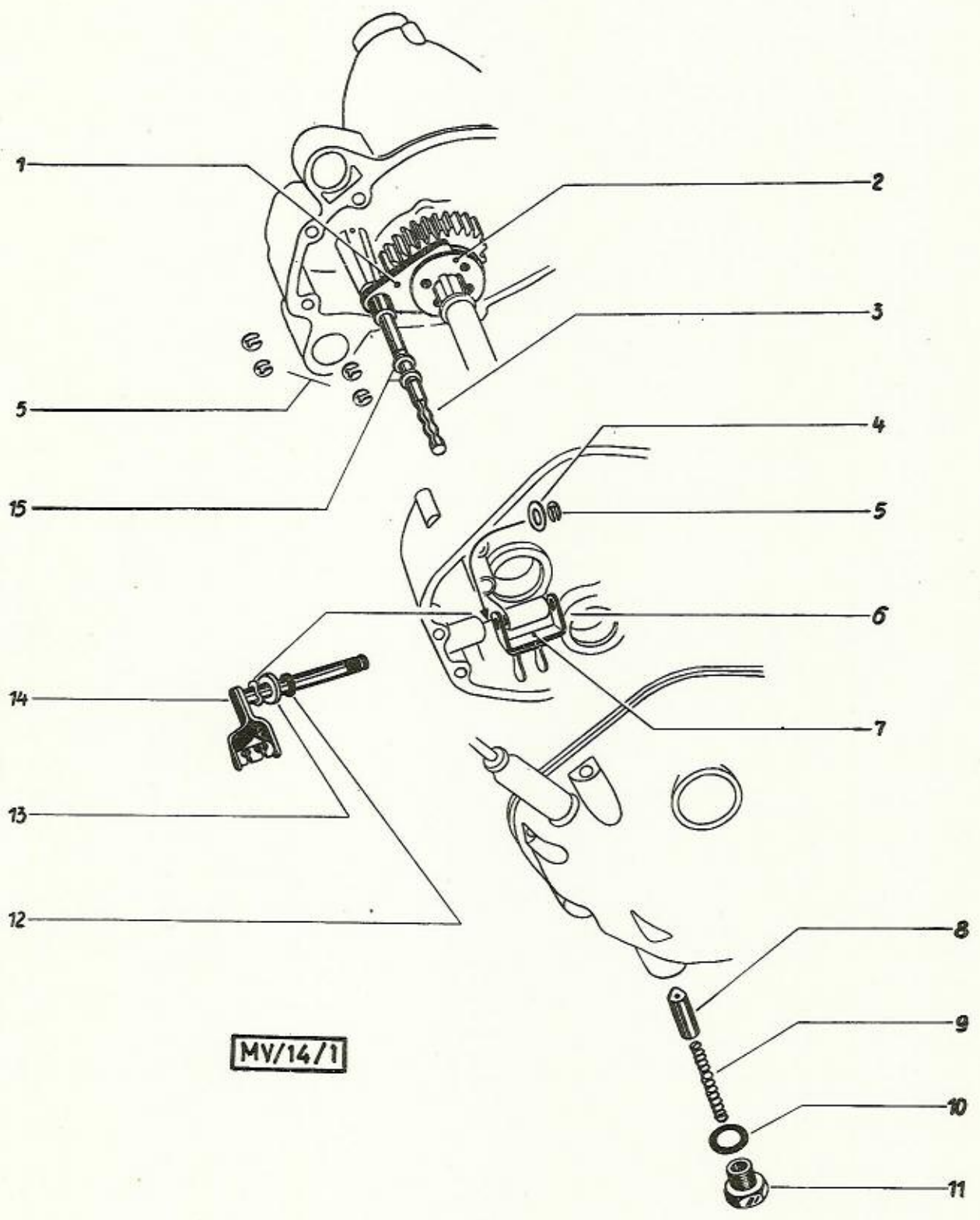

MV/14/1

9. G E A R S H I F T
(manual shifting)

Ref. No.	Part No.	Description	Requd. No.	Note
1	050.1.1425.2	Gearshift fork	1	
2	050.1.1410	Gearshift socket	1	
3	050.1.1424	Gearshift rail	1	
4	900.3949	Washer 15/8, 5/0,75 for gearshift shaft	1	
5	900.4606	Circlip 6 DIN 6799	N 6	
6	050.1.1426	Spring washer	1	
7	050.2.1403.2	Interior gearshift lever	1	
8	050.1.1421	Catch	1	
9	100.1423	Catch spring	1	
10	900.4212	Fibre seal washer 18/12/1	1	
11	050.1.1422	Catch guide screw	1	
12	050.1.1406	Rubber seal washer 12/8 mm dia.	1	
13	24806	Washer 8,4 DIN 433	N 2	
14	050.2.1402.2	Gearshift shaft	1	
15	050.1.1416	Supporting disc 12/7,2/2	2	

Part No.	Description	Part No.
----------	-------------	----------

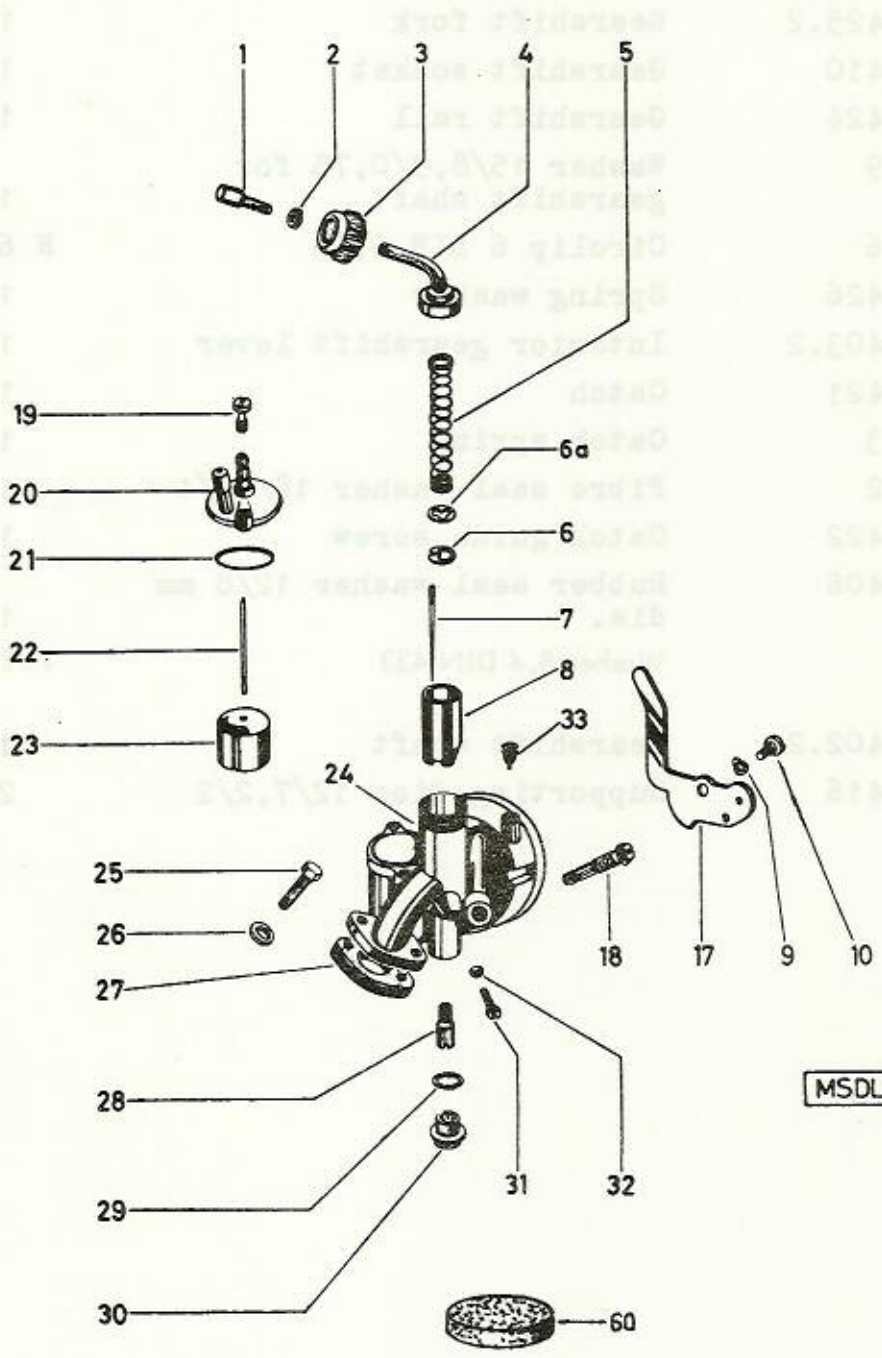

MSDL/15/4 E

Ref. No.	Part No.	Description	Requd. No.	Note
--	360.6.15.500.0/54	Carburettor compl. with tickler without air filter BING 1/12/198, jet no. 54	1	
1	050.1520	Bowdencable adjusting screw (M5)	1	
2	050.1517	Nut for bowden cable adjusting screw	1	
3	050.1519	Screw cover	1	
4	050.1518	Head with tube band	1	
5	050.1531	Thrust spring for throttle	1	
6	050.1513	Clamp spring	1	
6a	350.1.15.014.1	Disc 11 mm dia., 0,5 strong	1	
7	050.1516	Jet needle	1	
8	050.1515	Throttle slide	1	
9	900.3218	Spring washer A5	1	
10	360.1.15.552.1	Neck screw	1	
17	360.1.15.553.1	Choke valve	1	
18	050.1509/54	Main jet no. 54	1	
18	050.1509/.. ^x	Main jet no... ^x as requd.	--	
19	050.1535	Cap screw	2	
20	364.1.15.032.2	Float chamber cover with tickler	1	
21	050.1536	Float chamber cover gasket	1	
22	050.1530	Float needle	1	
23	050.1525	Float	1	
24	360.1.15.501.2	Carburettor body (outside ventilation)	1	
25	900.1107	Hexagon head screw M6x25 DIN 933	N 2	
26	24804	Washer 6,4 DIN 433	N 2	
27	350.1.15.021.2	Carburettor flange gasket	1	
28	050.1508	Needle jet	1	
29	27071	Seal washer A10x14 DIN 7603	N 1	

^xPlease state jet no!

./.

10. CARBURETTOR (cont'ed)

Ref. No.	Part No.	Description	Requd. No.	Note
30	050.1523	Screw plug	1	
31	050.1511	Throttle slide stop screw	1	
32	24771	Hexagon nut M4 DIN 934	N 1	
33	501.1.7179	Rubber plug as required	1	
60	350.1.15.016.1	Dirt splash guard	1	
		Head with tube band	4	
		Throttle spring for throttle	2	
		Clamp spring	6	
		Idle jet no. 54	6	
		Jet needle	7	
		Throttle slide	8	
		Spring washer A5	9	
		Hook screw	10	
		Choke valve	17	
		Main jet no. 54	18	
		Main jet no. 54 as reqd.	18	
		Gap screw	19	
		Floot chamber cover with sticker	20	
		Floot chamber cover gasket	21	
		Floot needle	22	
		Floot	23	
		Carburettor body (outside ventilation)	24	
		Hexagon head screw M4x25 DIN 933 N 2	25	
		Washer 6.4 DIN 433	26	
		Carburettor clamp gasket	27	
		Needle jet	28	
		Jet washer 6.4x1.4 DIN 7803	29	

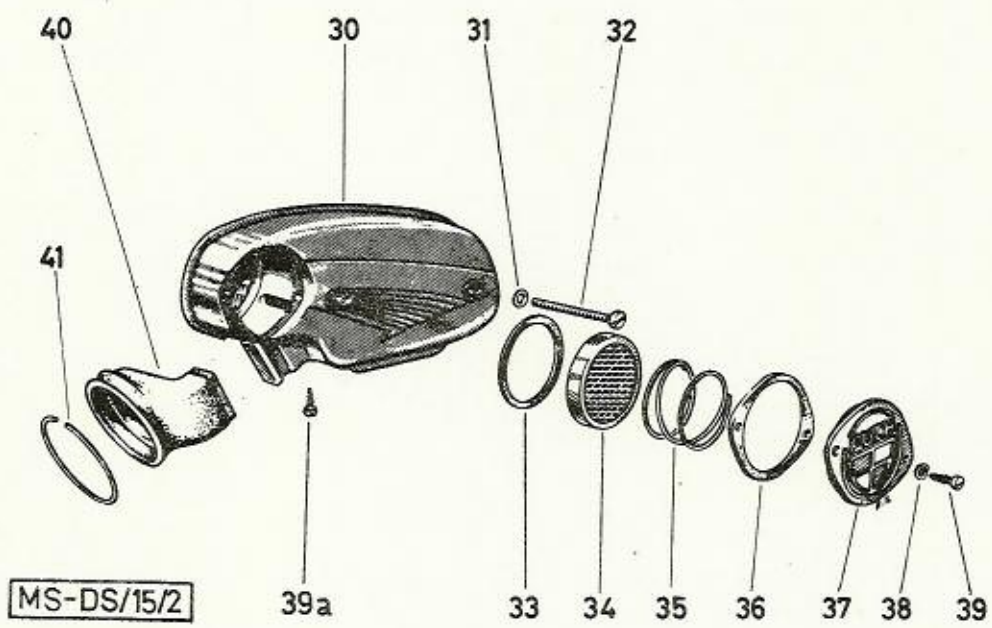

Ref. No.	Part No.	Description	Requd. No.	Note
30	357.1.15.070.0	Intake silencer compl. (with air filter) (with parts 30 and 33 to 39a)	1	
31	24794	Plain washer 5,3 DIN 125	N 2	
32	900.1336	Cheese head screw AM5x55 DIN 84N	2	
33	050.1576	Seal ring 52/45/2	1	
34	050.1540.2	Air filter	1	
35	250.1327	Thrust spring	1	
36	357.1.15.079.1	Gasket for cover	1	
37	357.1.15.078.1	Cover	1	
38	900.3202	Curved washer A4 DIN 137	N 2	
39	900.9516	Cheese head tapping screw A4x13 DIN 7971	N 2	
39a	900.9513	Cheese head tapping screw A4x9,5 DIN 7971	N 1	
40	050.10.1577	Connecting sleeve	1	
41	364.1.15.081.1	Spring ring for connecting sleeve	1	

Part No.	Description	Ref. Part No.
----------	-------------	---------------

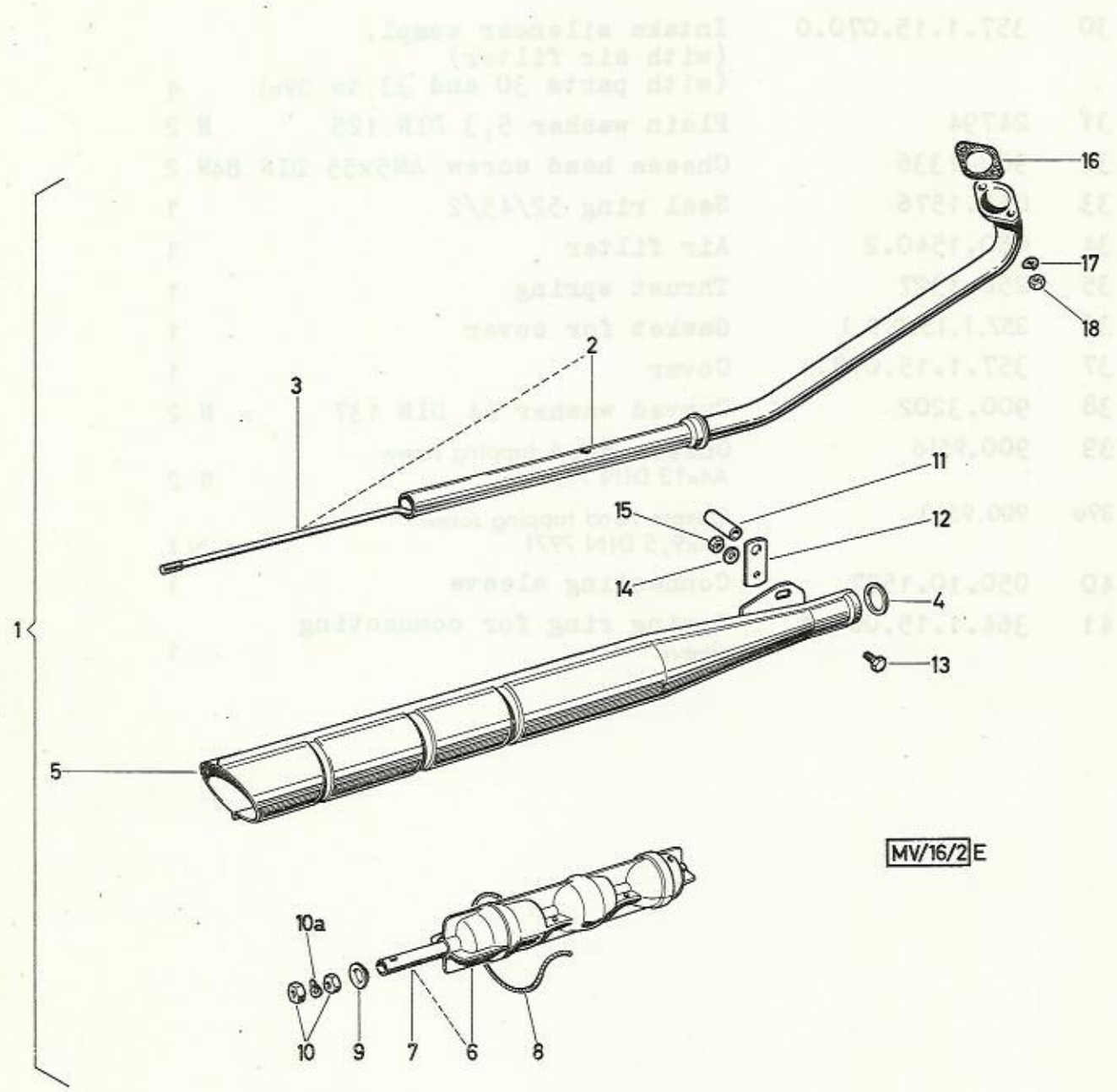

MV/16/2E

Ref. No.	Part No.	Description	Requd. No.
1	356.3.16.200.0	Exhaust silencer compl.	1
2	356.3.16.201.2	Exhaust pipe	1
3	349.3.16.014.1	Pull rod (M7, 295 long)	as req.
4	349.1.16.019.1	Gasket 34/26/2	1
5	356.3.16.200.2	Exhaust cover	1
6	349.1.16.011.0	Damper-insert compl. (with part 7)	1
7	349.1.16.013.1	End pipe	1
8	253.1635/07	Asbest-cord, dia. 3x165 long	pM
9	349.1.16.018.1	Washer 16/7,5/3	1
10	24774	Hexagon nut M7 DIN 934	N 2
10a	900.3266	Spring washer B7 DIN 137	N 1
11	350.1.16.909.1	Spacer 14/10,3/43	1
12	350.1.16.408.1	Exhaust Carrier	1
13	25399	Hexagon head screw M6x10 DIN 933	N 1
14	24804	Washer 6,4 DIN 433	N 1
15	24733	Hexagon nut M6 DIN 934	N 1
16	050.1615	Exhaust flange gasket	1
17	26834	Spring washer B6 DIN 127	N 2
18	24773	Hexagon nut M6 DIN 934	N 2

Part No.	Description	Ref. No.
----------	-------------	----------

1	Exhaust silencer cover	326.2.16.200.0
2	Exhaust pipe	326.2.16.201.2
3	Full nut (M7, 29.5 long)	346.2.16.014.1
4	Conical cap	346.1.16.019.1
5
6
7
8
9
10
11
12
13
14
15
19
20
21
29

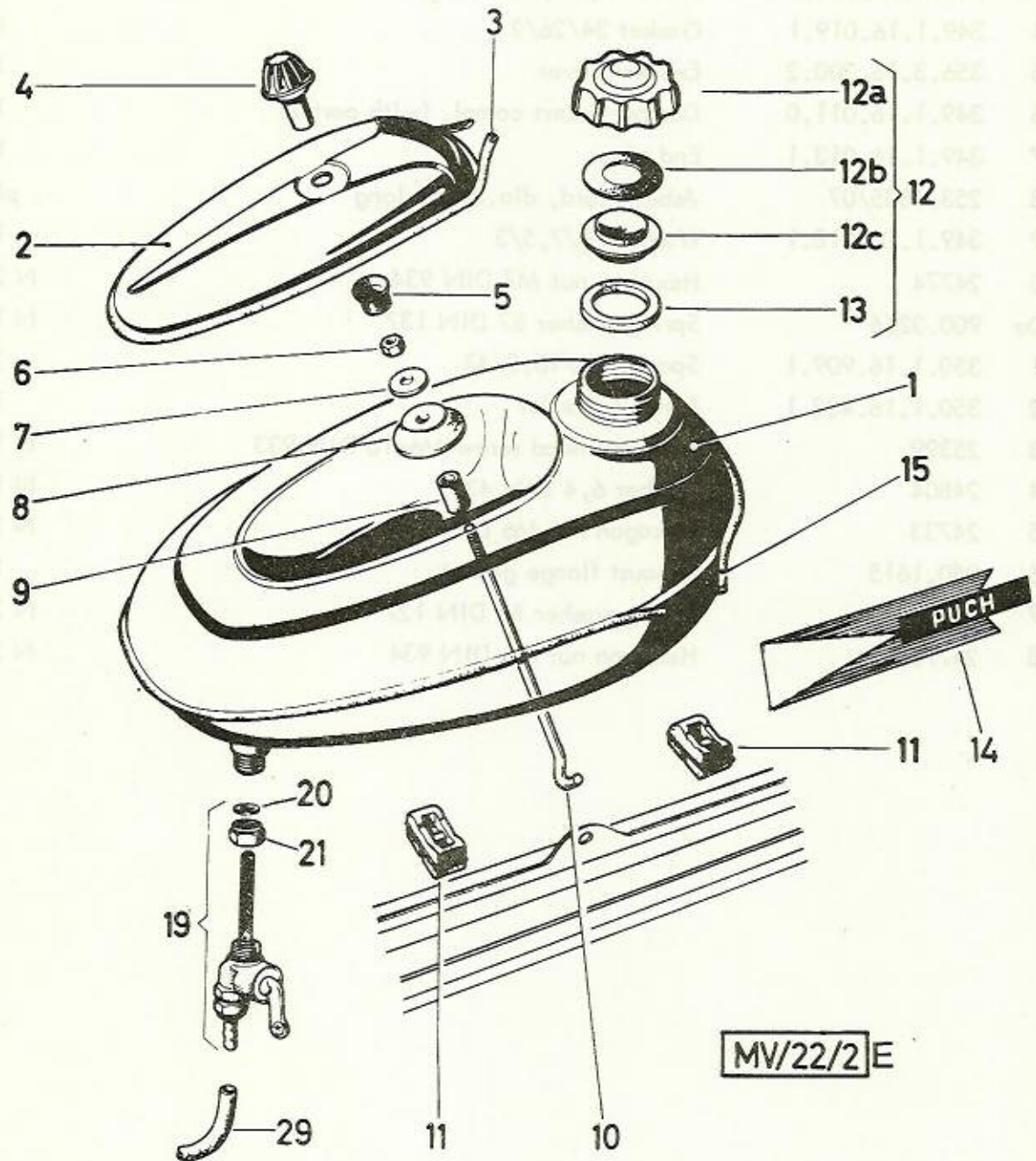

Ref. No.	Part No.	Description	Requd. No.	Note
1	050.10.2200.0	Fuel tank compl. (with cover and linings), laquered and chromed	1	
1	050.10.2200.2	Fuel tank (separate)	1	
2	050.10.2216	Tool box lid (separate), chromed	1	
3	050.2217	Bordering for tool box lid (endless)	1	
4	050.10.2210.2	Lock nut (M6)	1	
5	050.10.2224	Fixing ring (plastic) for lock nut	1	
6	900.2106	Hexagon nut M6 DIN 555	N 1	
7	900.3904	Washer 22/6,5/2	1	
8	350.2.22.033.1	Thrust piece	1	
9	050.10.2206	Rubber intermediate ring 11/6,5/12	1	
10	350.2.22.007.1	Bracing wire, 112 long	1	
11	350.2.22.014.1	Rubber support	2	
12	050.8.2220.0	Filler cap compl. (with ventilation)	1	
12a	350.3.22.020.1	Filler cap (separate) (replacement for 050.7.2220)	1	
12b	050.1.2248	Seal ring (rubber 42,5/18/1)	1	
12c	050.3.2249.0	Filler element compl.	1	
13	050.1.2223	Cork gasket (42,5/30/3)	1	
14	350.6.22.026.0	Transfer picture l.h.s./r.h.s. neutral pro pair	1	
15	050.2.2225	Bordering for 5,5 l - fuel tank, endless	1	
19	350.5.22.030.0	Fuel tab compl. (model "Karco")	1	
20	16636	Seal ring 14/10,5/1,5 (for "Karco" - tab)	1	
21	27634	Union nut M16x1	1	
29	900.0902/07	Fuel hose 9/5 mm dia. (150 long)	p.m.	

Ref. No.	Part No.	Description	Requd. No.	Note
1	350.2.20.200.0	Frame compl. (with pressed in bearing bushes)	1	
2	364.1.30.052.1	Cable socket	3	
3	050.2050.2	Carrying handle	1	
4	25399	Hexagon head screw M6x10 DIN 933	N 2	
5	900.3212	Curved washer A6 DIN 137	N 2	
6	050.1429	Setting angle	2	
7	360.1.20.029.2	Ground plate	1	
8	350.1.20.033.1	Nomenclature plate	1	
9	900.4027	Rivet Al2,6x5 DIN 660	N 2	
10	364.1.53.226.1	Cable band (200mm long)	1	
12	050.3.2020.2	Frame end piece (not laquered, as required, for repairs)	as required	
13	352.2.20.325.1	Transfer picture	1	
15	350.3.27.100.2	Front mudguard (tender)	1	
16	1426	Cheese head screw AM5x8 DIN 84	N 6	
17	24803	Plain washer 5,3 DIN 433	N 6	
18	900.2105	Hexagon nut M5 DIN 555	N 6	
19	350.1.27.102.1	Mudguard holder	N 2	
20	900.2106	Hexagon nut M6 DIN 555	N 2	
20a	24774	Hexagon nut M7 DIN 934	N 4	
21	26834	Spring washer B6 DIN 127	N 2	
21a	29189	Spring washer B7 DIN 127	N 4	
22	900.1321	Cheese head screw AM6x12 DIN 84	N 2	
23	050.2.2712.2	Mudguard(tender)stay	1	
24	350.1.27.003.1	Bowden cable guide	2	
30	050.1.2705	License plate front	1	
31	050.1.2707.2	License plate bracket front	2	
32	28909	Washer (6,5/14/1)	2	
33	22804	Internal toothed washer J6,4 DIN 6797	N 2	
34	900.2106	Hexagon nut M6 DIN 555	N 4	
35	364.1.27.744.1	License plate rear	1	
36	900.1321	Cheese head screw AM6x12 DIN 84	N 2	
37	900.3212	Curved washer A6 DIN 137	N 2	

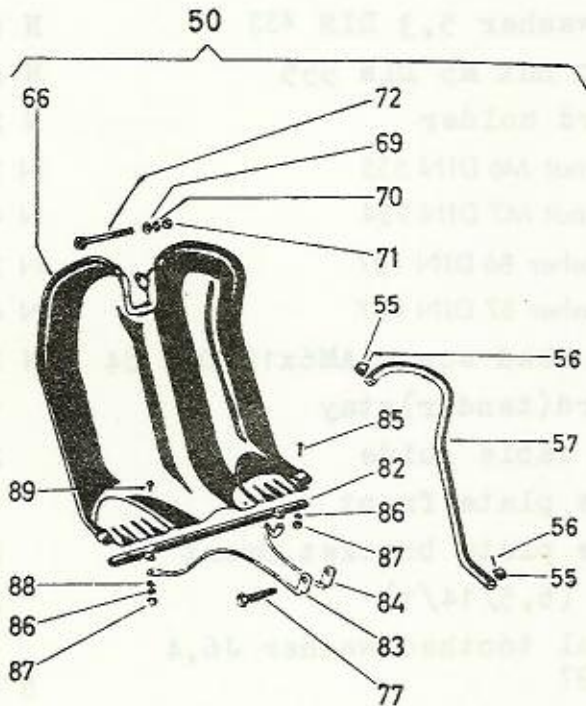
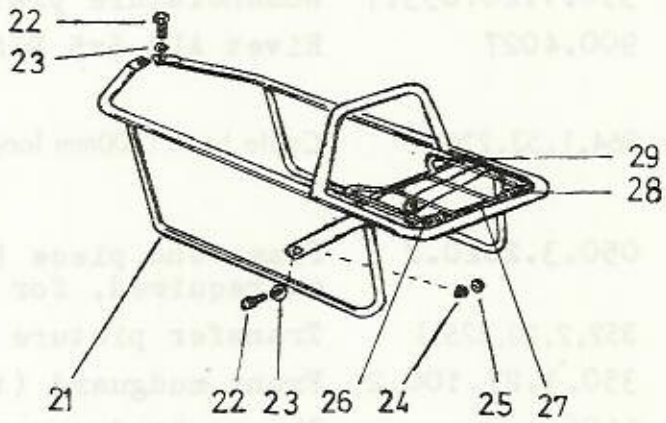
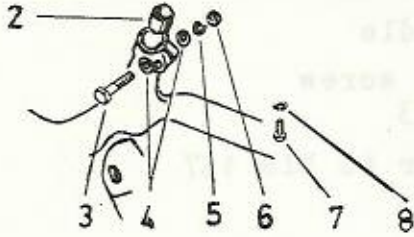
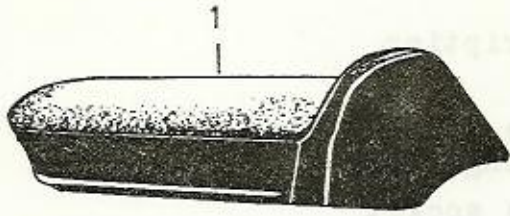

MV/24/2 E

16. SADDLE, LUGGAGE CARRIER^x, LEGSHIELD^x (not serial)

Ref. No.	Part No.	Description	Requid. No.
1	360.1.33.000.0	Single seat compl.	1
2	53.1.2255	Spacer 40mm long	1
3	24858	Hexagon head screw M8x55 DIN 931	N 1
4	24806	Washer 8,4 DIN 433	N 2
5	26819	Spring ring B8 DIN 127	N 1
6	900.2108	Hexagon nut M8 DIN 555	N 1
7	24928	Hexagon head screw M6x15 DIN 933	N 2
8	26834	Spring ring B6 DIN 127	N 2
21	360.2.29.220.0	Luggage Carrier compl. with spring clip chrome	1
22	24928	Hexagon head screw M6x15 DIN 933	4
23	24804	Washer 6,4 DIN 127	N 2
24	26834	Spring ring B6 DIN 127	N 4
25	900.2106	Hexagon nut M6 DIN 555	N 2
26	51.1.2925	Torsion spring, left	1
27	356.2.29.224.1	Spring cross bar	1
28	51.1.2926	Torsion spring, right	1
29	356.2.29.227.1	Spring clip	1
50	350.3.26.010.9	Legshield equipment compl. for later installation, without foot board (with parts 55-89)	1
55	364.2.26.006.1	End piece	4
56	364.1.26.007.1	Tube rivet B3x0,5x14	4
57	364.2.26.005.8	Edging (1550 long)	p.m.
66	350.2.26.010.2	Legshield (with parts 55-57)	1
69	24804	Washer 6,4 DIN 433	N 2
70	26834	Spring ring B6 DIN 127	N 1
71	24773	Hexagon nut M6 DIN 934	N 1
72	900.1511	Raised cheese head screw (M6x90)	1
77	900.1039	Hexagon head screw M8x1x70 DIN 960 - 8G	N 1
82	350.1.26.028.2	Cross tube	1
83	350.1.26.021.1	Brace l.h.s.	1
84	350.1.26.022.1	Brace r.h.s.	1
85	27157	Raised cheese head screw M5x20 DIN 85	N 6

16. SADDLE, LUGGAGE CARRIER^x, LEGSHIELD^x
^x(not serial) (cont.)

Ref. No.	Part- No.	Description	Reqd. No.
86	29190	Spring ring B5 DIN 127	N 8
87	24772	Hexagon nut M5 DIN 934	N 8
88	24803	Washer 5,3 DIN 433	N 8
89	25429	Raised cheese head screw M5x12 DIN 85	N 2
		Spring ring B5 DIN 127	8
		Hexagon nut M5 DIN 934	8
		Hexagon head screw M5x12 DIN 85	2
		Spring ring B5 DIN 127	8
		Luggage Carrier compl. with spring oil shrouns	1
		Hexagon head screw M5x12 DIN 85	2
		Washer 5,3 DIN 433	2
		Spring ring B5 DIN 127	2
		Hexagon nut M5 DIN 934	2
		Location spring, left	2
		Spring cross bar	1
		Location spring, right	2
		Spring clip	2
		Legshield equipment compl. for later installation without foot board (with parts 82-89)	1
		End piece	2
		Tube rivet 2,5x2,5x14	2
		Edging (1250 long)	1
		Legshield left part 22-27	1
		Washer 5,3 DIN 433	2
		Spring ring B5 DIN 127	2
		Hexagon nut M5 DIN 934	2
		Raised cheese head screw (M5x12)	2
		Hexagon head screw M5x12 DIN 85 - 80	2
		Cross tube	1
		Brace (L.H.)	1
		Brace (R.H.)	1
		Raised cheese head screw M5x12 DIN 85	2

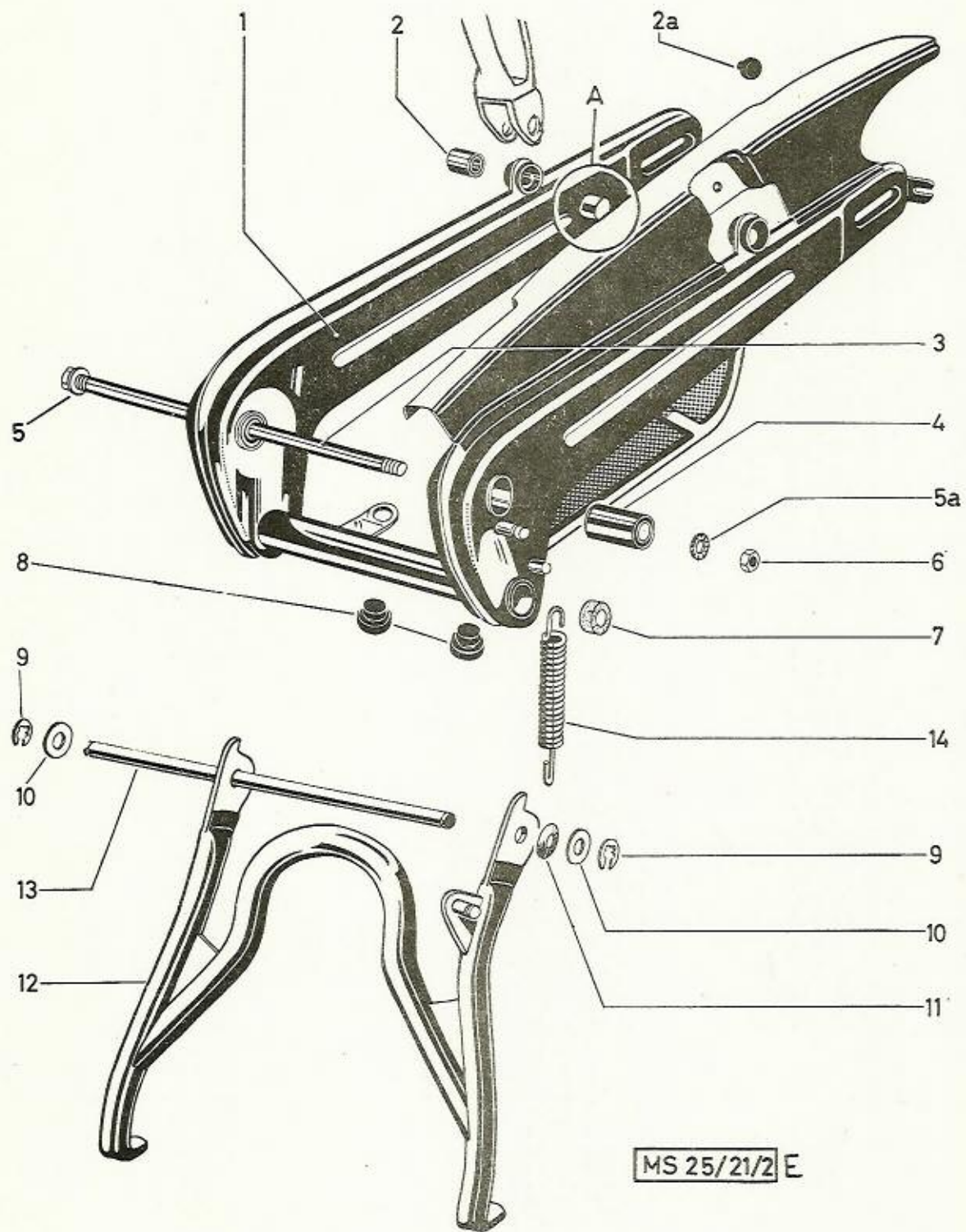

MS 25/21/2 E

Ref. No.	Part No.	Description	Requd. No.	Note
1	350.5.21.000.0	Pivoted fork compl. (with pressed-in silent blocks) (with pin for spring sticking l.h.s. and r.h.s.)(with part A)	1	
2	128.2315	Silent bloc (for shock absorber) 16/8/17	2	
2a	050.1.2122	Rubber base for chain guard	1	
3	350.1.21.910.2	Pivoted fork spindle, 251 long	1	
4	050.2111.2	Silent bloc (for pivoted fork bearing) 22/10/33	2	
5	24807	Washer 10,5 DIN 433	N 1	
5a	900.3262	Serrated lock washer A10,5 DIN 6798	N 1	
6	24789	Hexagon nut M10x1 DIN 934	N 1	
7	350.2.21.014.1	Prop stand bearing bushing 17,2/10,2/10	2	
8	050.1.2123	Rubber buffer for prop stand stop	2	
9	900.4609	Circlip 9 DIN 6799	N 2	
10	14778	Washer 21/10,5/1	2	
11	100.1.1235	Spring washer	1	
12	350.4.24.000.2	Center prop stand (with pin for spring sticking l.h.s.)	1	
13	350.1.24.013.1	Prop stand bearing axle 10 mm dia., 199 long	1	
14	050.1.2410	Prop stand spring	1	

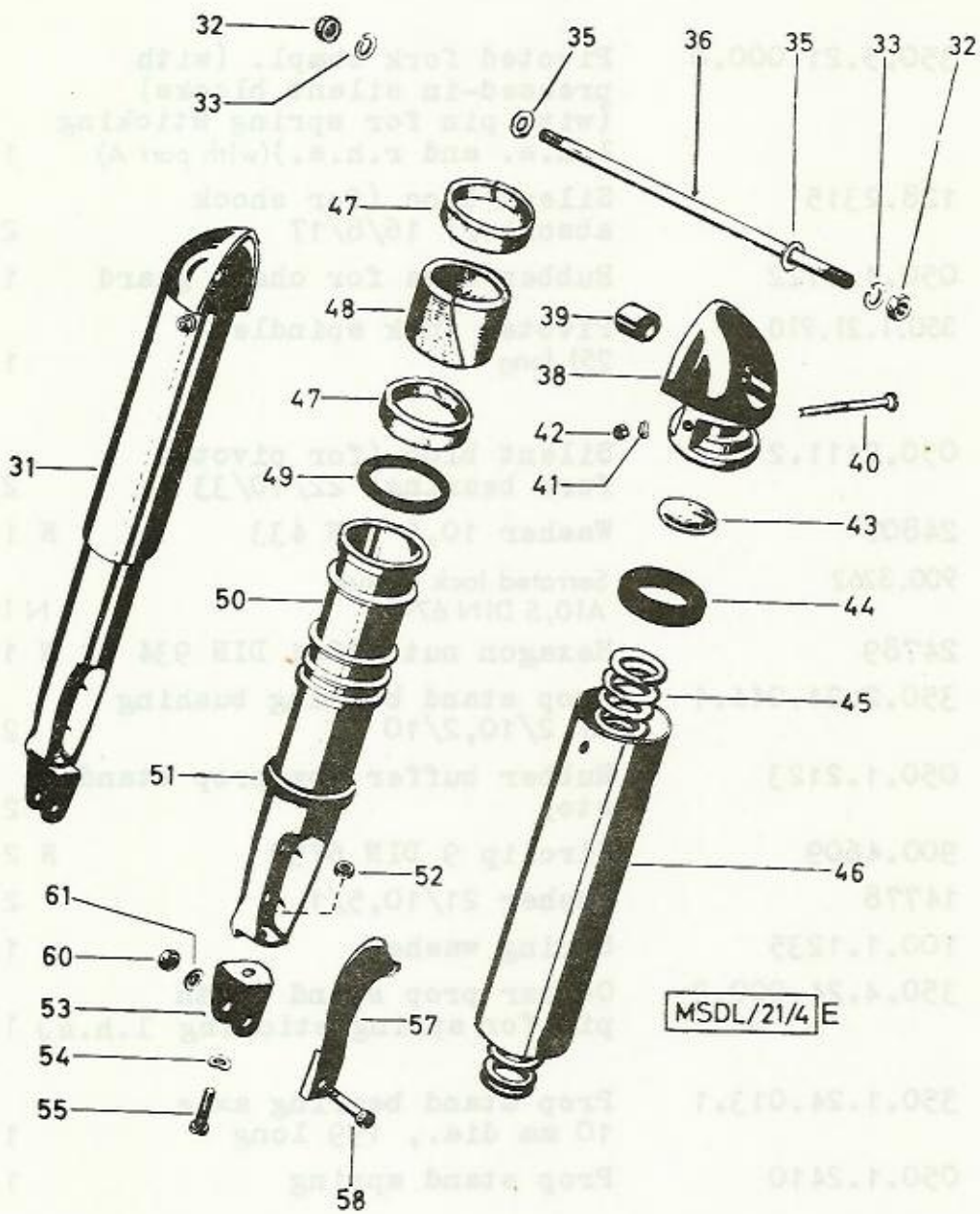

Ref. No.	Part No.	Description	Requd. No.	Note
31	050.5.2129.0	Shock absorber left, compl. (with the parts 38 - 55)	1	
31	050.5.2130.0	Shock absorber right, compl. (with the parts 38 - 55)	1	
32	24775	Hexagon nut M8 DIN 934	N 2	
33	26819	Spring ring B8 DIN 127	N 2	
35	24806	Washer 8,4 DIN 433	N 2	
36	050.2.2113	Bolt (M8, 172 long)	1	
38	364.1.21.032.1	Strut head	2	
39	128.2315	Silent bloc 16 mm dia., 17 long	2	
40	900.1522	Lens head screw M5x50 DIN 85	N 2	
41	900.3205	Spring washer A5 DIN 137	N 2	
42	24772	Hexagon nut M5 DIN 934	N 2	
43	050.5.2136	Closure washer 27 mm dia.	2	
44	050.5.2133	Buffer ring (rubber 43/29,5/8)	2	
45	050.5.2134	Thrust spring, 200 long, size of wire 5 mm dia.	2	
46	050.5.2131	Sliding tube (45 mm dia., 145 long)	2	
47	050.5.2141	Guide bushing (plastic 43/37,5/9)	4	
48	050.5.2139	Grease felt 126,5x27x3	2	
49	050.5.2143	Felt washer, 112 long	2	
50	050.5.2140	Lower sliding tube	2	
51	050.5.2138	Stop ring 41/34/6	2	
52	24773	Hexagon nut M6 DIN 934	N 2	

./°

Ref. No.	Part No.	Description	Requd. No.	Note
53	050.5.2137	Supporting bracket	2	
54	900.3213	Spring washer B6 DIN 137	N 2	
or	22804	Toothed Lock washer J6,4 DIN 6797	N 2	
55	900.1309	Fillister head screw M6x15 DIN 84	N 2	
or	24928	Hexagon head screw M6x15 DIN 933	N 2	
57	350.1.25.017.1	Holder for brake control cable	1	
58	24477	Hexagon head screw M8x32 DIN 931	N 2	
60	900.2016	Hexagon nut M8 DIN 934	N 2	
61	900.3211	Spring washer B8 DIN 137	N 2	

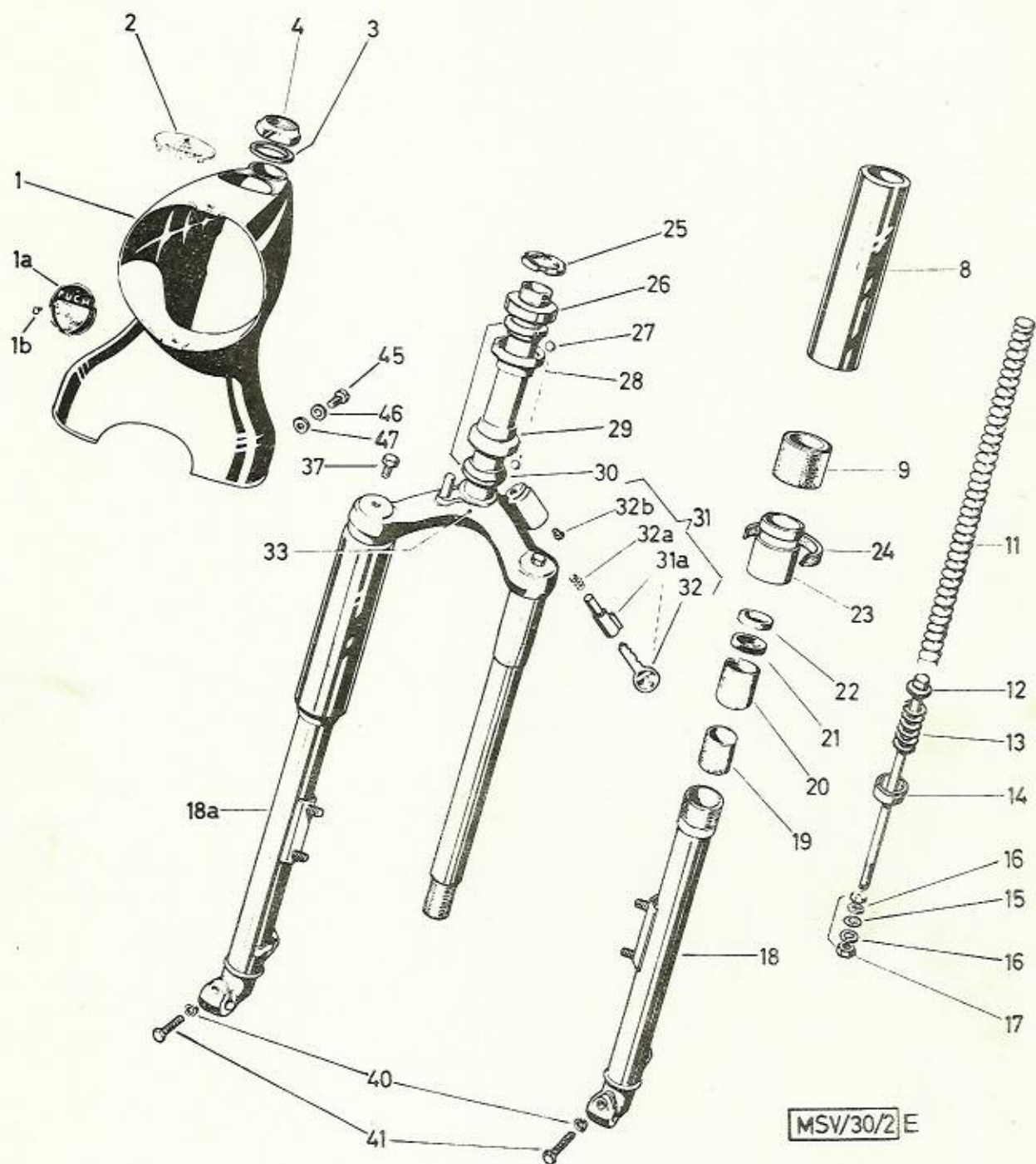

MSV/30/2 E

19. FRONT FORK WITH STEERING

Ref. No.	Part-No.	Description	Required No.
--	350.1.30.100.0	Front Fork compl.	1
1	350.5.30.043.2	Head-Lamp Carrier	1
1a	050.5.3046	Name Plate "Puch" - neutral	1
1b	900.4027	Al-Round Head Rivet $\varnothing 2,6 \times 5$ DIN 660	N 2
2	050.3045	Handlebar for opening the tacho	as req.
3	050.3033	Connecting Washer	1
4	3759	Fork Tube Nut	1
8	050.3037	Outer Tube	2
9	050.3036	Rubber Buffer 35,5/24,5/32	2
11	350.1.30.134.1	Spring ($\varnothing 14 \times 263$ long)	2
12	350.2.30.130.1	Spring Rod (134 long)	2
13	350.1.30.131.1	Thrust spring	2
14	350.1.30.110.1	Lower Cap	2
15	900.3883	Gasket RS 6-9-1,5	2
16	24804	Washer 6,4 DIN 433	N 4
17	900.2106	Hexagon Nut M6 DIN 555	N 4
18	350.1.30.115.2	Fork Slider l.h.s., $\varnothing 28 \times 244$ long	1
18a	350.1.30.116.2	Fork Slider r.h.s., $\varnothing 28 \times 244$ long	1
19	050.3009	Lower Guide Bush 25,7/20,5/26	2
20	050.3026	Top Guide Bush 27,6/22/26	2
21	050.3029	Rubber Sleeve (average dia. 29mm)	2
22	050.3049	Felt Ring 29/22/6	2
23	350.1.30.127.1	Grooved Bush	2
24	350.1.30.139.1	Felt Strip 9x3, 2x102 long	2
25	250.3104	Slotted Circular Nut	2
26	25222	Dust Protector	1
27	25226	Ball 5mm dia.	42
28 } 29 }	25221	Ball Sleeve	2
30	25220	Tapered Ring	2
31	330.1.20.052.0/10	Lock compl. (Neiman II) with tension spring and All-notched rivet	as req.
31a	330.1.20.052.0	Lock compl. (Neiman II) (with 2 keys)	as req.
32	350.2.30.023.1	Spare Key (please quote key-number!)	-

19. FRONT FORK WITH STEERING (cont.)

Ref. No.	Part-No.	Description	Required No.
32a	330.1.20.059.1	Tension Spring	1
32b	330.1.20.060.1	Al-Notched Rivet	1
33	350.1.30.106.2	Fork Yoke	1
37	900.1122	Hexagon Screw M6x6 DIN 933	N 2
40	29189	Spring Ring B7 DIN 127	N 2
41	900.1128	Hexagon Screw M7x20 DIN 933	N 2
45	900.1513	Lens Head Screw M5x10 DIN 85	N 2
46	24803	Washer 5,3 DIN 433	N 2
47	21526	Fibre Gasket 9/5,3/1	2
		Spring (B7x20 long)	11
		Spring Rod (134 long)	12
		Thrust spring	13
		Lower Cap	14
		Gasket 52 5-4-1-2	15
		Washer 5,3 DIN 433	16
		Hexagon Nut M6 DIN 933	17
		Fork Slider L.H. (52x24 long)	18
		Fork Slider R.H. (52x24 long)	18
		Lower Guide Bush 52,5/20,5/28	19
		Top Guide Bush 52,5/22,5	20
		Rubber Sleeve (average dia. 29mm)	21
		Felt Ring 52,5/22,5	22
		Grooved Bush	23
		Felt Ring 52,5/20,5 long	24
		Slotted Chrome Plated Pin	25
		Dust Protector	26
		Ball Seat dia.	27
		Ball Sleeve	28
		Top Ring	29
		Lower Ring	30
		Lock Compl. (Reimion II) with tension spring and all-notched rivet	31
		Lock Compl. (Reimion II) (with 2 keys)	31a
		Spare Key (please quote key-number)	32

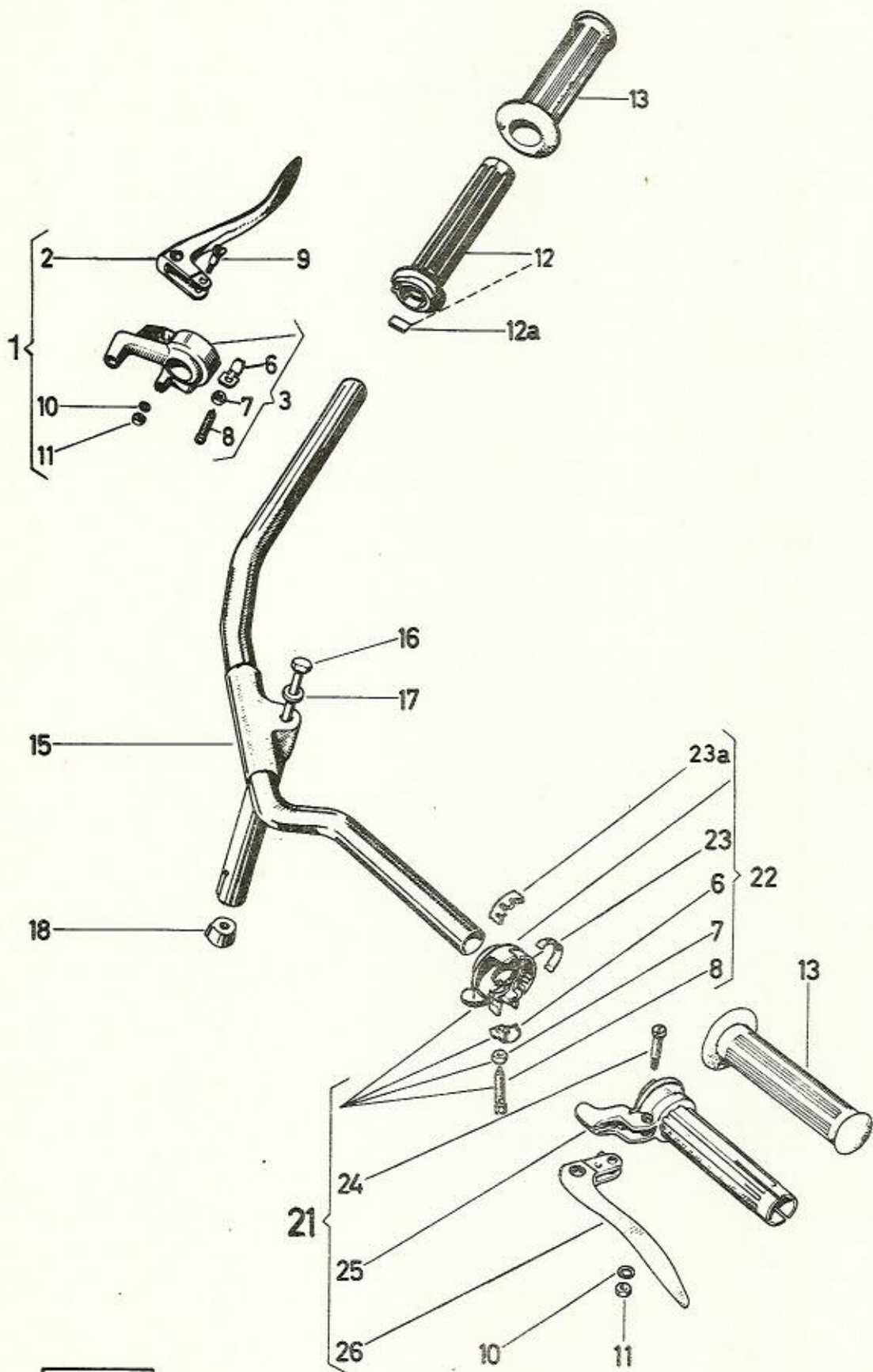

MV/32/3 E

20. HANDLEBAR, GEARSHIFT and
THROTTLE TWIST GRIPS
(Magura, new Version)

Ref. No.	Part No.	Description	Requd. No.	Note
1	350.1.32.105.0	Throttle twist grip compl. (with parts 2 to 12a)	1	
2	050.2.3228	Brake lever	1	
3	350.2.32.121.0	Housing for throttle twist grip compl. (with parts 6 - to 8)	1	
6	350.1.32.113.1	Retaining angle	2	
7	350.1.32.112.1	Hexagon nut (M6)	2	
8	350.2.32.111.1	Hexagon pin (M6)	1	
9	050.3227	Lever bolt (M5)	1	
10	22803	Toothed lock washer J5,3 DIN 6797	N 2	
11	24772	Hexagon nut M5 DIN 934	N 2	
12	350.2.32.126.1	Throttle twist grip rotor sleeve	1	
12a	349.1.32.009.1	Tension spring	1	
13	360.2.32.016.1	Twist grip cover (black)	2	
15	050.4.3200.2	Handlebar	1	
16	050.1.3251	Clamping spindle (M8x1) 200 long	1	
17	186	Washer 20/8,4/3,5	1	
18	600.1.32.022.1	Clamp wedge	1	
21	350.7.32.004.0	Gearshift twist grip compl. (2-speed circular pull) (with parts 6-8, 10, 11 and 22 to 26)	1	
22	350.1.32.110.0	Gearshift twist grip housing compl. with parts 6 to 8 and 23)	1	
23	350.1.32.120.1	Shield for scale	1	
23a	350.1.32.116.1	Gearshifting quadrant	1	
24	350.1.32.114.1	Lever bolt (M5)	1	
25	350.1.32.115.2	Gear shift twist grip tube	1	
26	350.1.32.117.2	Clutch lever	1	

SC. HANDEBAR, BEANSHIPT 204
THROTTLE TWIST DRIVE
(Makura, new Version)

Hand-Motor - Japan England

Part No. Description
No. No.

350.1.35.107.0 Throttle twist grip comp.
(with parts 2 to 12)

MV25/60/1E

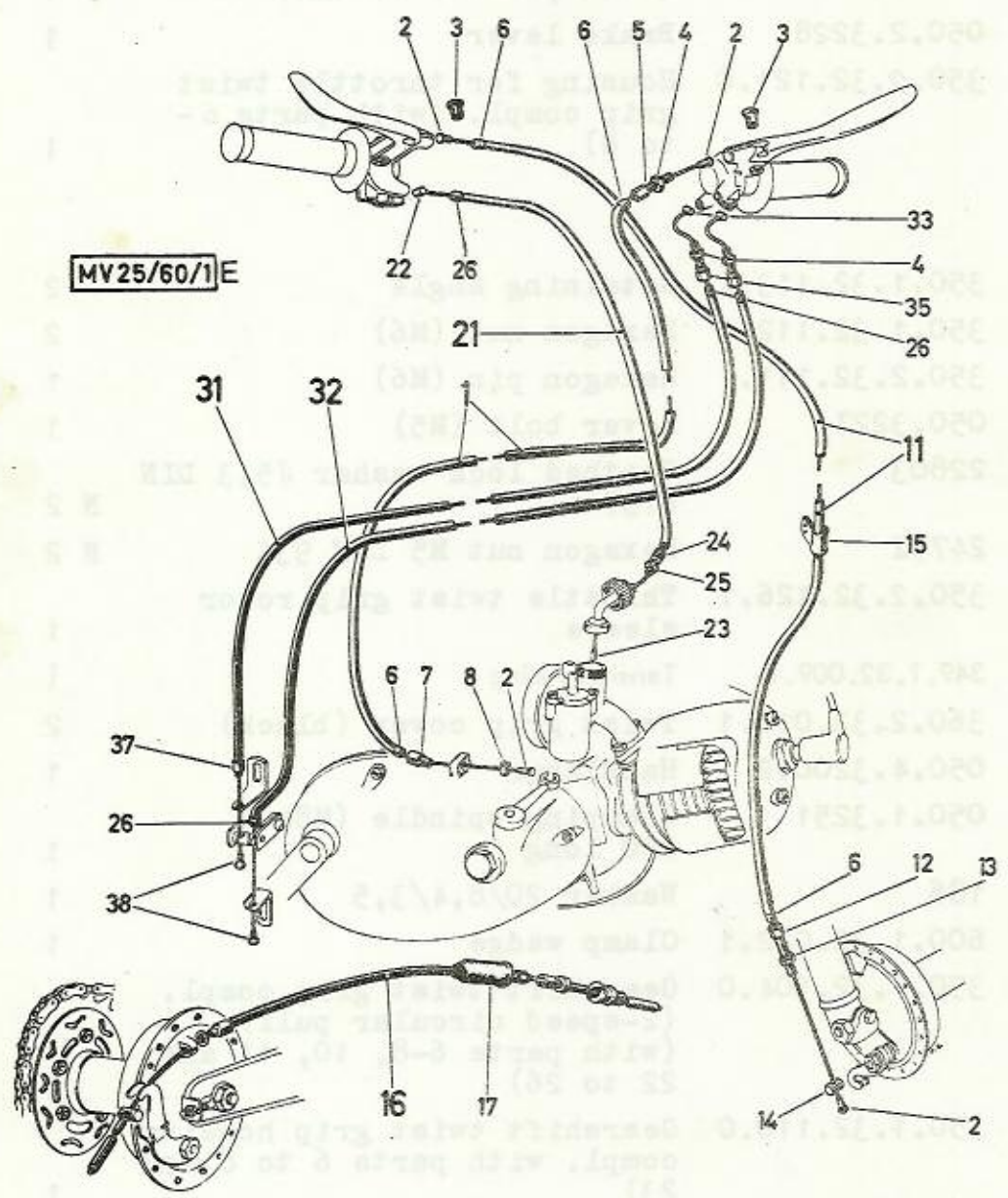

21. BOWDEN CABLES FOR NEW
MAGURA HANDLEBAR ARMATURES

Ref. No.	Part No.	Description	Requd. No.	Note
1	302.1.62.000.0	Clutch control cable compl. (wire 1175/ cover 1060)	1	
2	360.1.62.015.1	Soldering nipple	4	
3	050.1.3208	Nipple holder	2	
4	900.2311	Hexagon lock nut BM6 DIN 439	N 3	
5	350.1.32.119.1	Adjusting screw (M6)	1	
6	25483	Shell	4	
7	250.6204	Supporting shell	1	
8	250.6208	Nipple holder, slotted	1	
11	360.1.63.500.2	Brake control cable for front wheel (wire 890 / cover 765)	1	
12	250.6010	Adjusting screw (M7)	1	
13	24774	Hexagon nut M7 DIN 934	N 1	
14	24384	Nipple holder	1	
15	128.6305	Shell	1	
16	302.2.25.000.2	Brake control cable for rear wheel (wire 575/ cover 380)	1	
17	250.6103	Cable socket	1	
21	360.1.65.500.2	Carburettor control cable compl. (wire 890/ cover 760)	1	
22	360.1.32.007.1	Soldering nipple	1	
23	050.2.6505	Soldering nipple	1	
24	050.1520	Cable adjusting screw (M5)	1	
25	900.2115	Flat Hexagon lock nut BM5 DIN 439	N 1	
26	050.2.6203	Shell	5	
31	302.1.66.002.2	Gearshift control cable (wire 1182/ cover 1075)	1	
32	302.1.66.001.2	Gearshift control cable (wire 1205/ cover 1075)	1	
33	360.1.66.008.1	Soldering nipple	2	
35	350.1.32.118.1	Adjusting screw (M6)	2	
37	050.1.1428	Supporting shell	1	
38	050.1419	Soldering nipple	2	

MS/VA/40/2

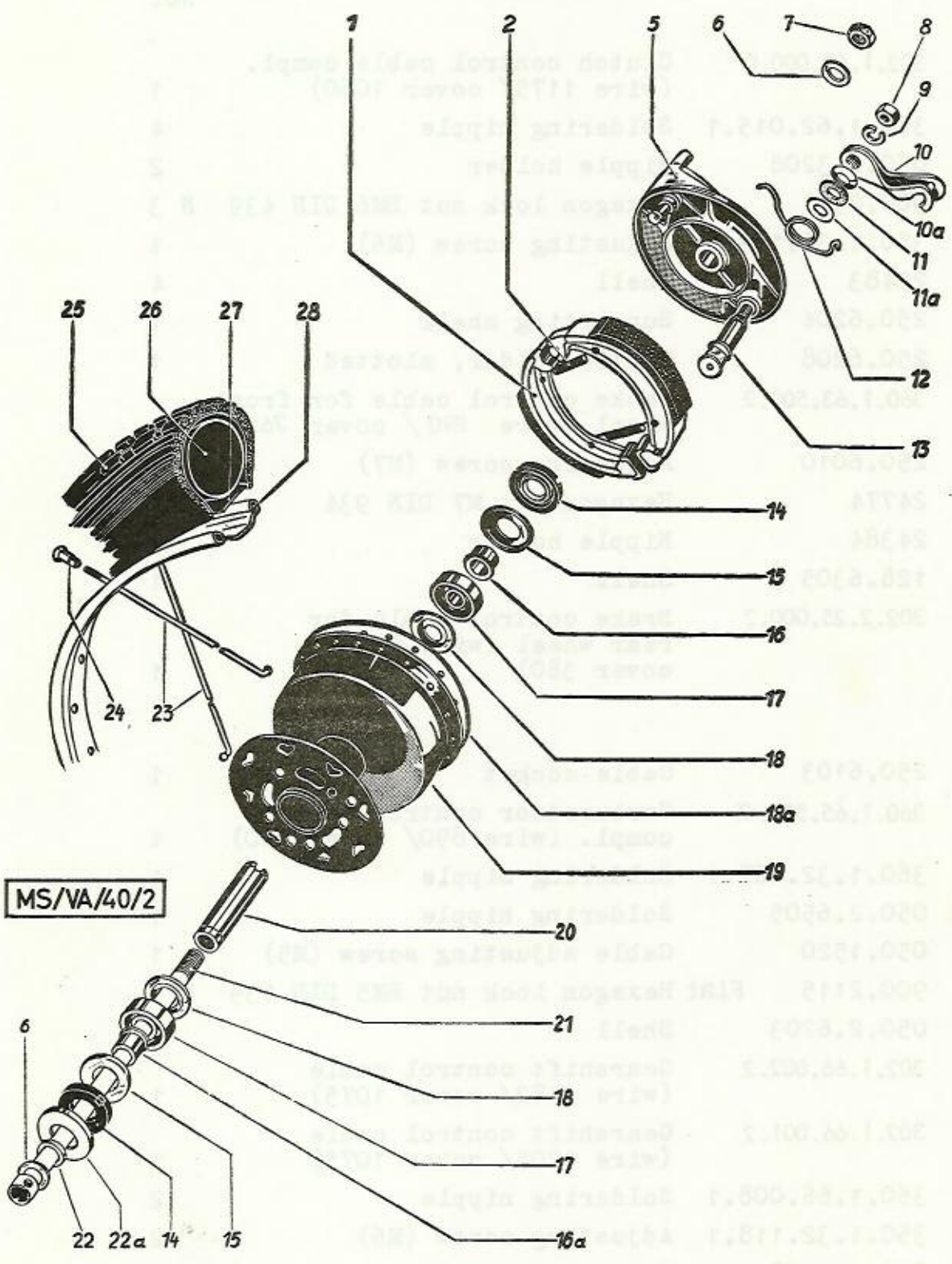

MS/VA/40/2

Ref. No.	Part- No.	Description	Requd. No.	Note
-	350.1.40.100.0	Front wheel compl. (without tire)	1	
-	350.6.40.002.0	Front wheel hub compl. (with interior parts)	1	
1	050.4015.0	Pair of brake shoes with glued lining	1	
2	050.4019	Brake shoe spring	2	
5	350.4.40.007.1	Brake cover plate	1	
6	050.1.4029	Washer 18/10,5/2,5	2	
7	900.2011	Hexagon nut M10x1 DIN 934-8G	N 1	
8	26820	Hexagon nut M8x1 DIN 934	N 1	
9	26819	Spring ring B8 DIN 127	N 1	
10	350.4.40.013.2	Brake lever	1	
10a	900.3219	Curved washer 12,5 mm dia.	1	
11	128.2504	Rubber washer 20/12/3	1	
11a	900.3938	Washer 18/12,3/1	2	
12	050.2.4115	Restoring spring	1	
13	350.4.40.009.2	Brake cam	1	
14	050.2.4025	Packing ring 30/16/5	2	
15	050.1.4021	Cover 30/16 mm dia.	2	
16	050.1.4024	Intermediate ring, 9 mm high (right)	1	
16a	050.2.4034	Intermediate ring, 17,5 high (left)	1	
17	900.6200	Deep-row ball bearing 6200 30/10/9 DIN 625	N 2	
18	350.1.40.022.1	Supporting disc 30/16 mm dia.	2	
18a	050.1.4008	Cover for hub	1	
19	050.1.4003.2	Hub body	1	
20	350.1.40.023.1	Spacer tube, 37 mm long	1	
21 22 22a	364.4.40.026.1	Front wheel axle (knock-out-axle) only used, if no speedometer is mounted	1	
23	350.5.40.030.1	Spoke, long 2,65mm dia.x204	18	
23	350.3.40.031.1	Spoke, short 2,65mm dia.x196	18	
24	365.1.40.031.1	Nipple M3 DIN 74371	N 36	
25	900.0841	Tire 23" - 2,25	1	
26	900.0843	Inner Tube 23" - 2,25	1	
27	901.0866	Chafing strip 14"	1	
28	350.6.40.033.1	Rim for tires 23"x2,25	1	

Ref. No.	Part No.	Description	Requd. No.	Note
1	050.2.5324	Speedometer ready for fitting 48/45	1	
2	050.5327	Rubber ring 49/44/1,5	1	
2a	050.1.5322	Speedometer glass 51 mm dia.	1	
2b	050.1.5323	Rubber ring 1,3 \square x40 mm dia. for inside of speedometer glass	1	
3	050.1.5325.0	Driving shaft, 600 mm long	1	
3a	050.1.5325	Driving shaft (core)	1	
4	050.3.4050.0	Speedometer drive compl.	1	
5	26821	Grease nipple	1	
6	050.3.4051	Soft rubber packing 36/18/5 for speedometer drive	1	
7	501.1.8506	Rubber socket	1	
8	350.2.30.159.1	Holder for driving shaft (replacement for 350.1.30.059.1)	1	
9	900.3207	Spring ring A7 DIN 137	N 1	
10	900.1130	Hexagon head screw M7x15 DIN 933	N 1	

MSV/41/2

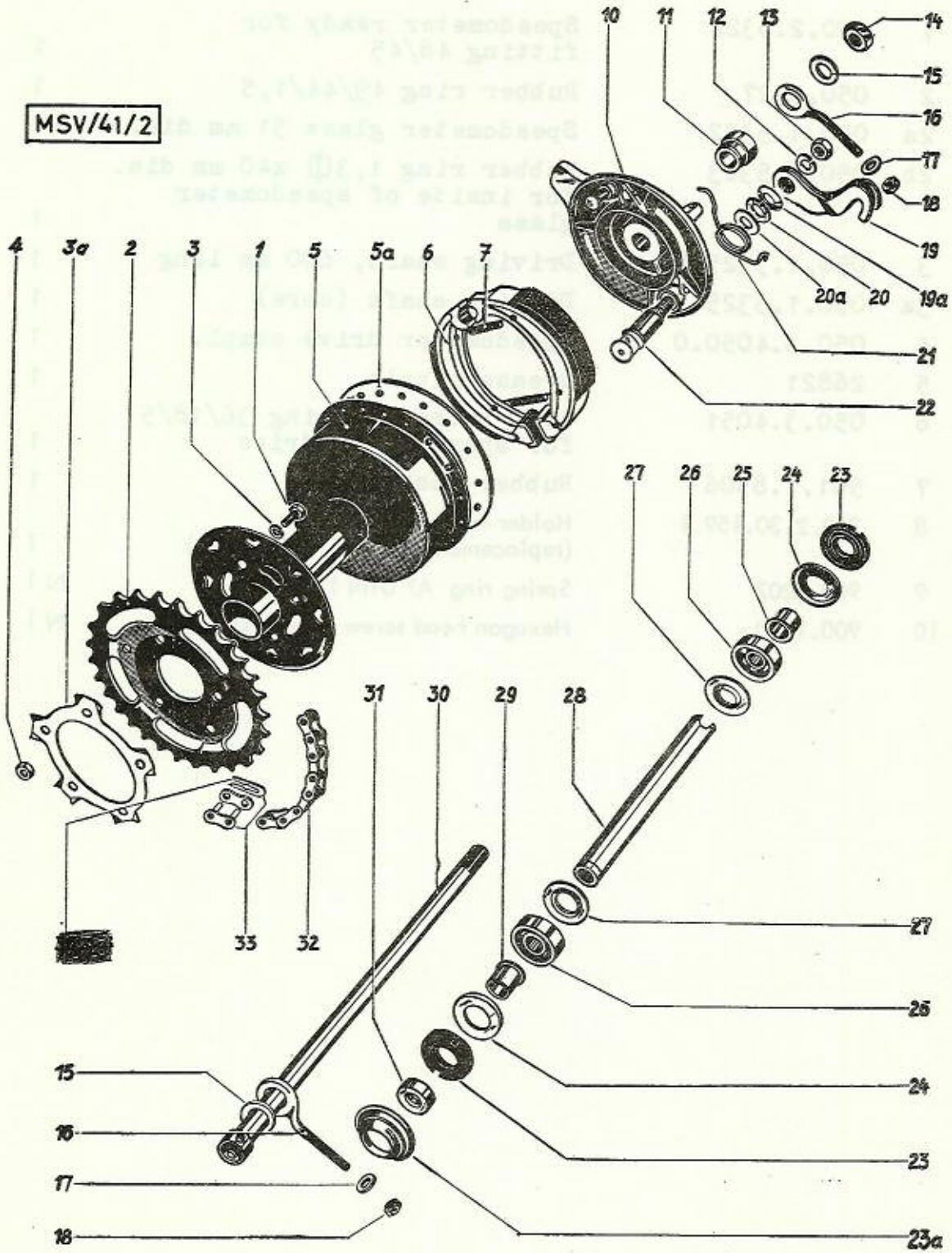

25. REAR WHEEL, DRIVING CHAIN

Ref. No.	Part No.	Description	Requid. No.	Note
-	350.1.41.100.0	Rear wheel compl. (without tire)	1	
-	350.4.41.002.0	Rear wheel hub compl. with interior parts	1	
1	26422	Hexagon head screw M7x15 DIN 933 - 8G	N 5	
2	050.4.4109	Chain sprocket (34 teeth)	1	
3	29189	Spring ring B7 DIN 127	N 5	
3a	350.1.41.010.1	Securing plate	1	
4	24774	Hexagon nut M7 DIN 934	N 5	
5	050.1.4103.2	Hub body	1	
5a	050.1.4008	Cover for hub	1	
6	050.4015.0	Pair of brake shoes with glued lining	1	
7	050.4019	Brake shoe spring	1	
10	350.4.41.007.2	Brake cover plate	1	
11	050.1.4106	Hub core	1	
12	26819	Spring ring B8 DIN 127	N 1	
13	26820	Hexagon nut M8x1 DIN 934	N 1	
14	900.2011	Hexagon nut M10x1 DIN 934-8G	N 1	
15	050.1.4029	Washer 18/10,5/2,5	2	
16	350.1.41.018.0	Chain tension adjuster	2	
17	24804	Washer 6,4 DIN 433	N 4	
18	900.2106	Hexagon nut M6 DIN 555	N 4	
19	350.4.41.013.2	Brake lever	1	
19a	900.3219	Curved washer 12,5 mm dia.	1	
20	128.2504	Rubber washer 20/12/3	1	
20a	900.3938	Washer 18/12,3/1	2	
21	050.2.4115	Restoring spring	1	
22	350.4.40.009.2	Brake cam	1	
23	050.2.4025	Packing ring 30/16/5	2	
23a	050.4122	Dust cap	1	
24	050.1.4021	Cover 30/16 mm dia.	2	
25	050.1.4024	Intermediate ring (9 mm high)	1	
26	900.6200	Deep row ball bearing 6200 30/10/9 DIN 625	N 2	

Ref. No.	Part No.	Description	Requd. No.
27	350.1.40.022.1	Supporting disc 30/16	2
28	350.1.41.023.1	Spacer tube, 80mm long	1
29	050.1.4124	Intermediate ring (13mm high)	1
30	350.1.41.026.1	Rear wheel axle (knock-out-axle)	1
31	050.1.4125	Thrust washer	1
--	350.5.40.030.1	Spoke, long, $\emptyset 2,65 \times 204$	18
--	350.2.41.031.1	Spoke, short, $\emptyset 2,65 \times 198$	18
--	365.1.40.031.1	Nipple M3 DIN 74371	36
--	900.0841	Tire 23" - 2,25	1
--	900.0843	Inner tube 23" - 2,25	1
--	901.0866	Chafing strip 19"	1
--	350.6.40.033.1	Rim 19" for tire 23" - 2,25	1
32	907.1.28.094.0	Driving chain $1/2 \times 3/16" \times 7,75$ 94 rollers (replacement for 050.4.2810.0)	1
33	907.1.28.001.0	Filler link compl. (for driving chain 907.1.28.094.0)	1
36	1150	Chain master link spring	1

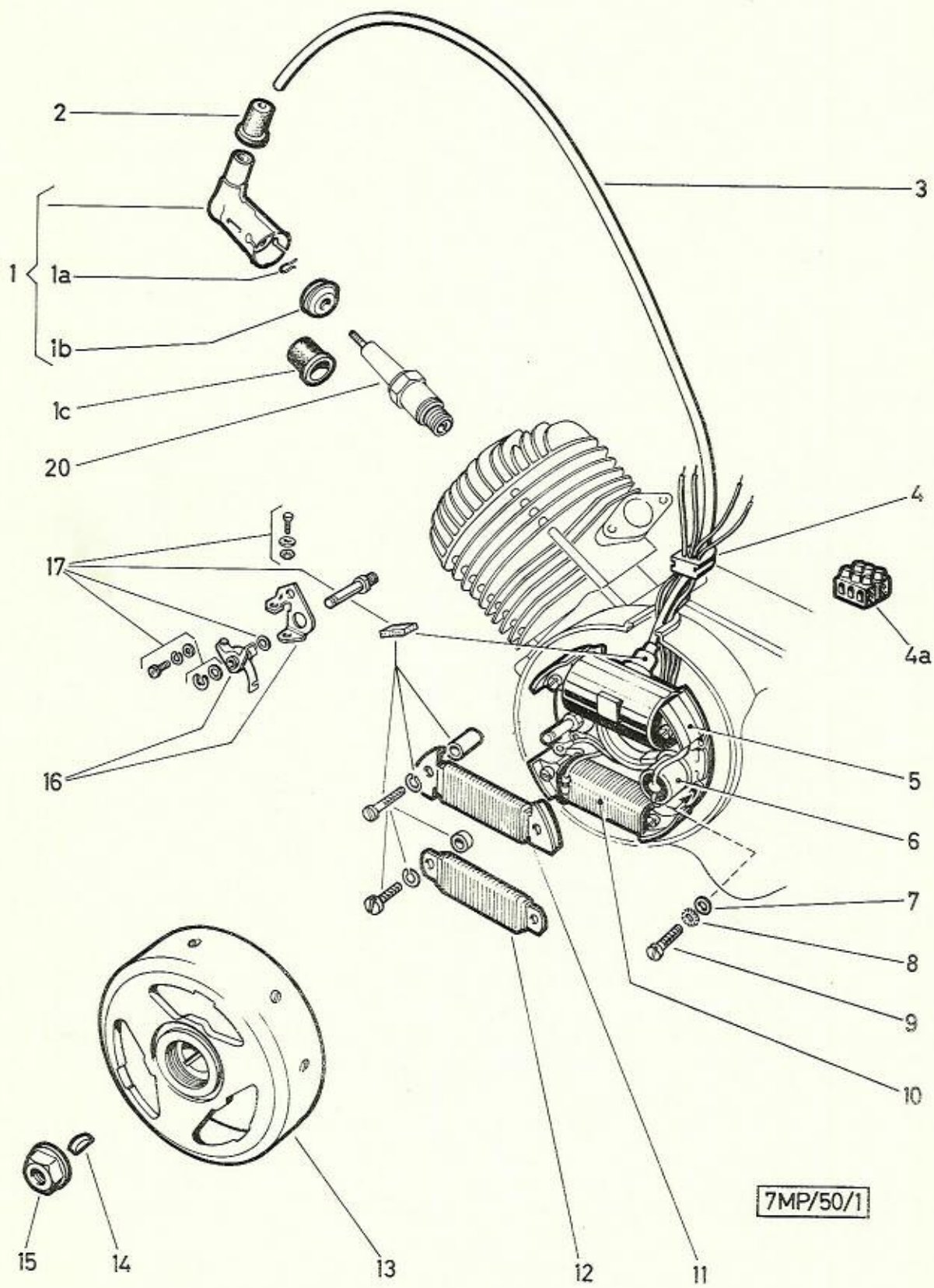

26. GENERATOR

Pos- No.	Part-No.	Description	Required-No.
--	360.5.50.000.0	MAGNETO GENERATOR compl. (Bosch 0 212 122 027) RB1 (L) 6V 17/5W	1
1	350.7.52.005.0	SUPPRESSOR PLUG (cable plug) Bosch	1
1a	050.5206	LOCK SPRING (inside of the cable plug)	1
1b	350.7.52.006.1	SEAL RING	1
1c	-----	not for this model	1
2	350.1.52.007.1	CAP for ignition cable gasket outside	1
3	050.5207	IGNITION CABLE dia.5 (530mm long)	p.m.
4	352.2.10.010.1	RUBBER SOCKET	1
4a	51.1.5703	SOFT-RUBBER CLAMPING (two rows)	1
5	364.4.50.512.2	IGNITION ARMATURE (Bosch 2 204 211 030)	1
6	500.2.50.013.2	CONDENSER (Bosch 1 237 330 037)	1
7	901.3941	WASHER 8/4, 2/1	3
8	900.3253	SERRATED LOCK WASHER J4,3 DIN 6798	N 3
9	27458	LENS HEAD SCREW AM4x15 DIN 85	N 3
10	360.2.50.011.2	GENERATOR ARMATURE (Bosch 1 214 210 042)	1
11	360.5.50.014.2	GENERATOR ARMATURE (Bosch 1 214 210 153)	1
12	-----	not for this model	
13	364.4.50.510.2	FLYWHEEL (Bosch 1 215 254 089)	1
14	900.4503	WOODRUFF-KEY 3x3,7 DIN 6888	N 1
15	901.2943	HEXAGON NUT with band M10x1-8G	1
16	302.2.50.015.0	CONTACT-SET (Bosch 1 217 013 015)	1
17	360.5.50.017.0	SET FOR PARTS compl. (Bosch 1 217 010 007)	1
20	-----	PLUG please see group cylinder, engine parts	

Parts not identified by a number are not available singly from Messrs. Bosch



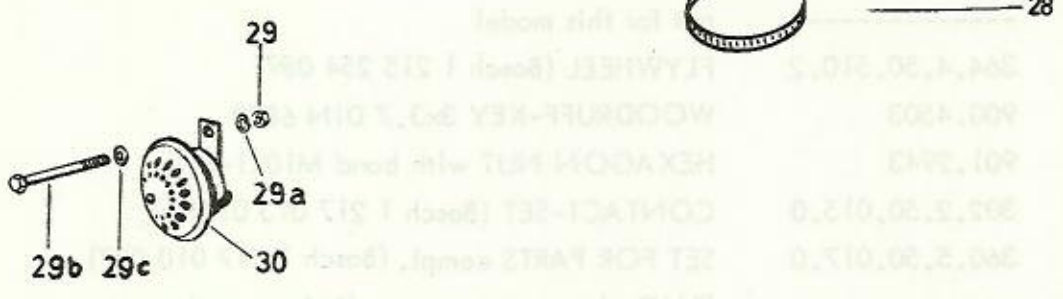
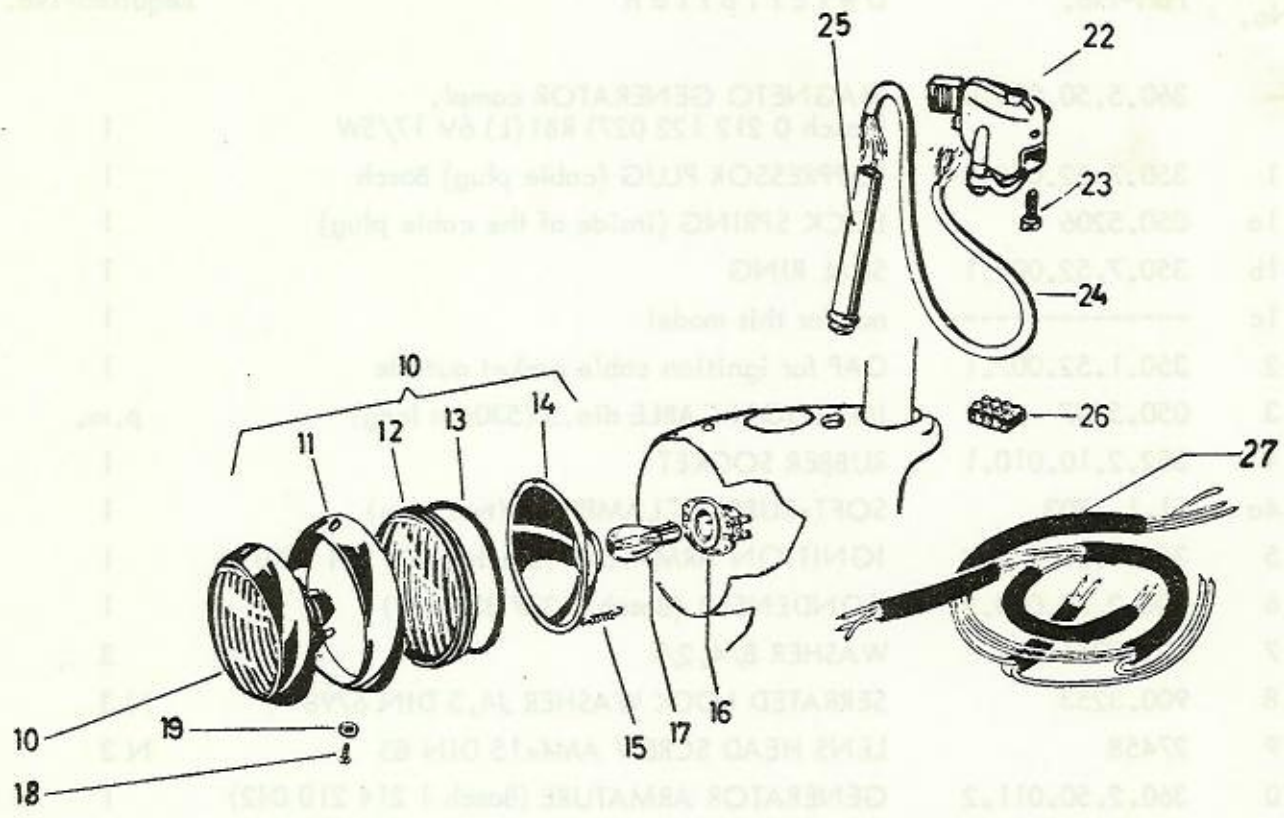

MV/53/1 E

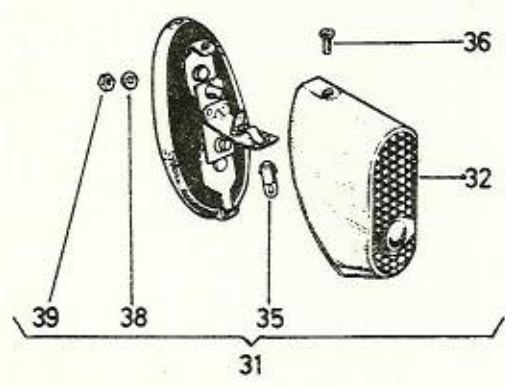

Ref. No.	Part No.	Description	Requd. No.
10	050.4.5300.0	Headlamp interior parts compl. dia.85mm (ZKW, with lamp holder, without bulb)	1
11	050.4.5303.1	Headlamp rim	1
12	050.4.5304	Headlamp glass	1
13	050.5306	Rubber-ring	1
14	050.4.5308	Reflector	1
15	050.5309	Retaining spring	1
16	050.4.5319.0	Lamp holder	1
17	903.0751	Bulb Bilux 6V 18/18W	1
18	28721	Oval Head screw M4x8 DIN 91	N 1
19	100.5311	Washer for fastening headlamp	1
22	357.3.53.117.0	Combined switch compl. / ZKW	1
23	28881	Fillister head screw M4x10 DIN 84	1
24	902.0750	Connecting cable (6 rows, 500 long)	p.m.
25	350.1.30.009.1	Grommet	1
26	364.1.57.001.0	Soft Rubber terminal (four rows)	1
27	350.6.57.100.0	Cable compl.	1
28	364.1.53.227.1	Cable band (120mm long)	1
29	24773	Hexagon nut M6 DIN 934	N 1
29a	26834	Spring ring B6 DIN 127	N 1
29b	900.1040	Hexagon bolt M6x80 DIN 931	N 1
29c	24804	Plain washer 6,4 DIN 433	N 1
30	902.0772	A.C. Horn (Hella with faston plug connector)	1
31	350.3.55.000.0	Tail-stop-light compl. (ZKW M 1378 M/LK)	1
32	349.3.55.000.2	Housing for tail-stop-light	1
35	902.0712	Bulb HL 6V 3W BA 9S	1
36	349.3.55.003.1	Retaining Bolt, (M4x12)	1
38	900.3255	Serrated lock washer A5,3 DIN 6798	N 2
39	24772	Hexagon nut M5 DIN 934	N 2

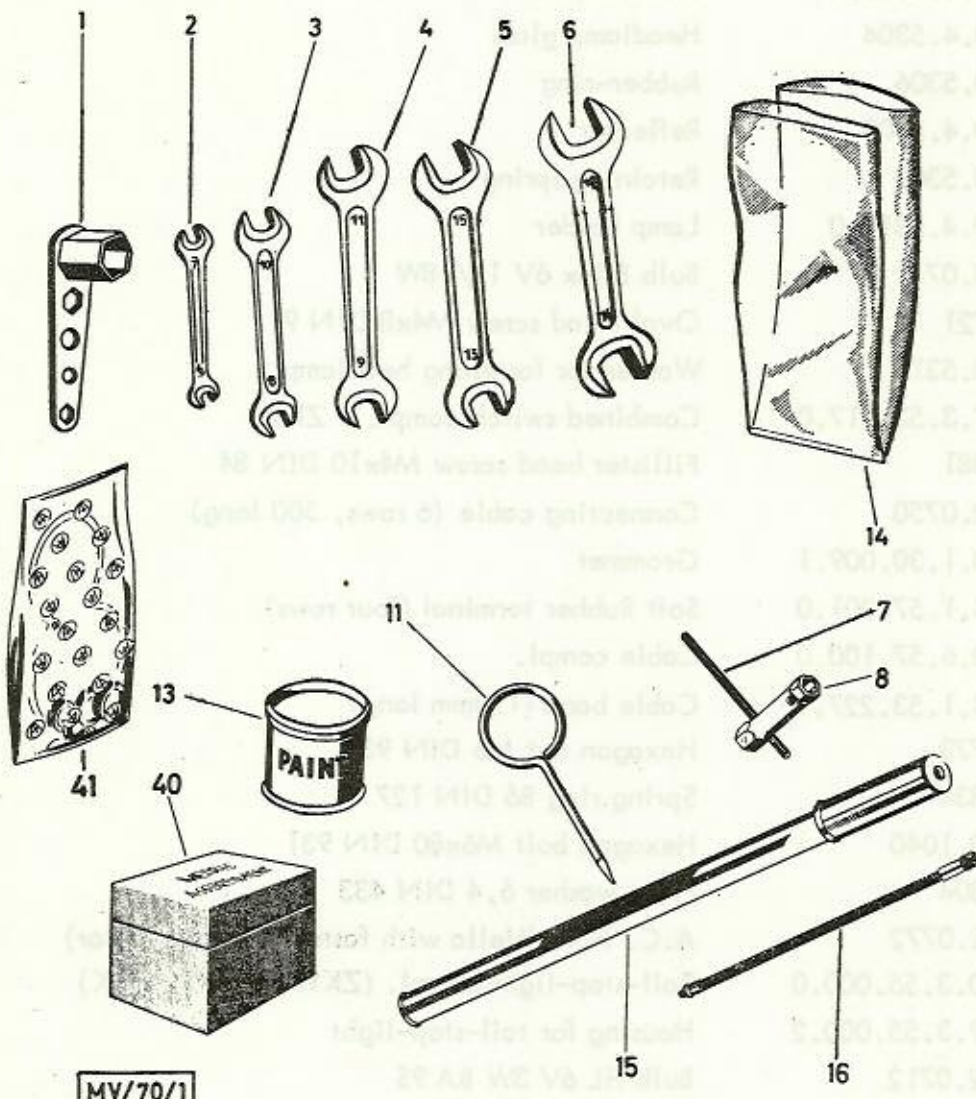

MV/70/1

Ref. No.	Part No.	Description	Requd. No.	Note
-	050.2.7010.0	Set of tools complete	1	
1	050.7001.2	Socket wrench for spark plug	1	
2	19599	wrench 6/7 DIN 895	(N) 1	as requd.
3	10181	wrench 8/10 DIN 895	(N) 1	
4	24324	wrench 9/11 DIN 895	(N) 1	
5	900.7011	wrench 13/15 DIN 895	1	
6	24323	wrench 14/17 DIN 895	(N) 1	
7	050.7022	Pin 6 mm dia., 115 long	1	
8	250.7008	Socket wrench for MS-models as requd.	1	
(8)	350.1.70.008.1	Socket wrench 10/11	1	
11	050.2.7021	Screw driver	1	
13	900.0280/10	Varnish for mend, yellow (P1060) 1/4 kg	as req.	x
14	330.1.70.003.1	Tool bag	1	
15	050.7024.0	Tire pump	1 ^x	
16	050.7023.2	Tire pump tube for 050.7024.0 200 long	1 ^x	
40	810.000	Metric assortment (nut, bolt and screw assortment)	as requd.	x
41	302.2.10.210.0	Set of gasket compl.	as requd.	x

x not included

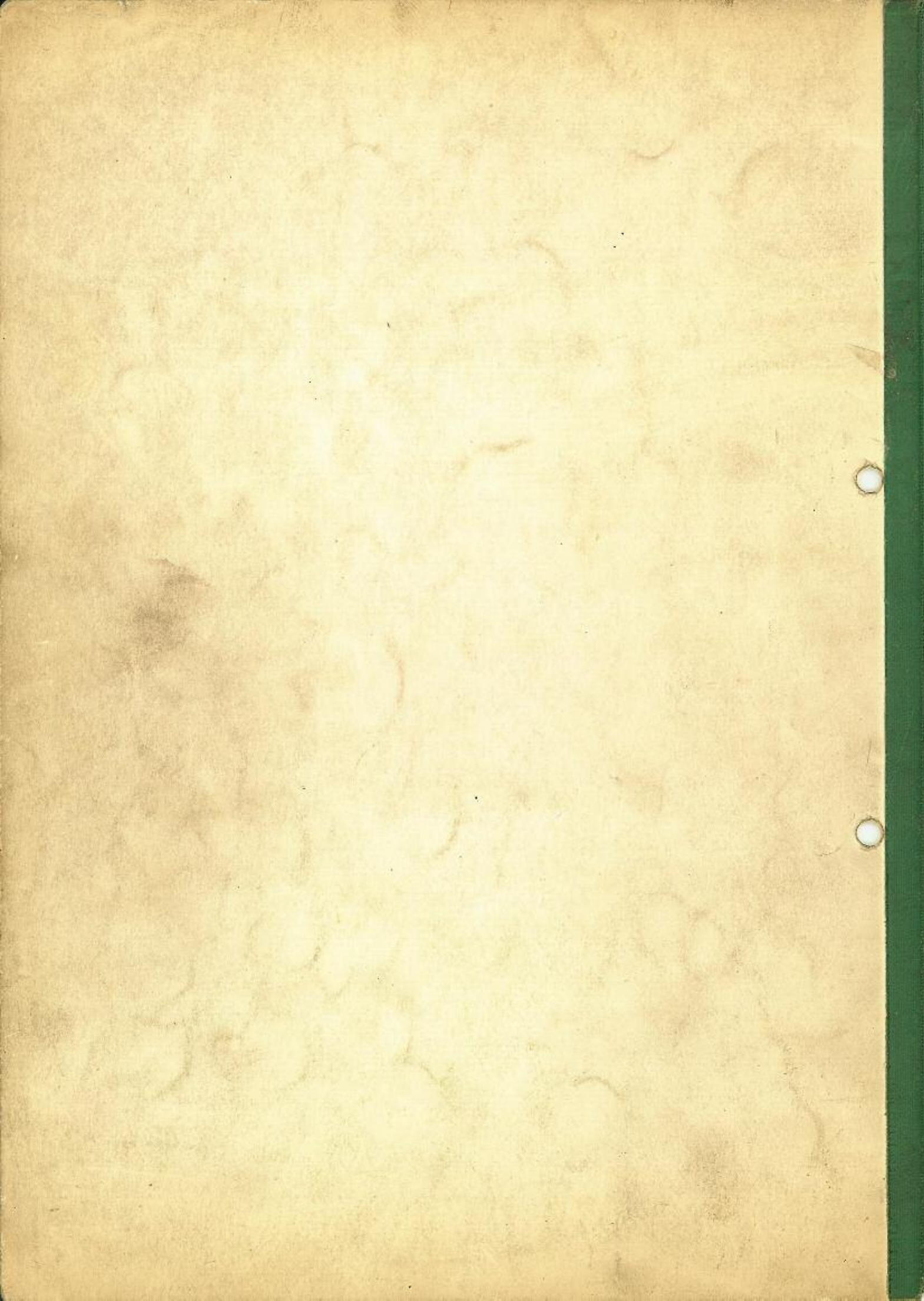



Spare parts - Modification notice



Service Graz

Order No. 2.60.45/016

DISTRIBUTOR

DATE January 1973

PAGE 1

Spare parts catalogue (model)
MS50V de luxe England
Edition Sept. 1972

Re: New pedal shaft-unification

Line	Page Group	Ref. No. Pre.	Old spare part No.	O X	New spare part No.	Remarks As from	M	Designation
1	23	8	350.4.13.032.1			→ 5510023		Pedal shaft 290mm long
2				O	350.5.13.032.1	5510024 →	1	Pedal shaft 296mm long

Ersatzteilkatalog (Type)VS50D
MV50-3 Edition April 1968**Betreff:** Change in material of layshaft

3	21	22 23 24	360.2.13.001.2		VS50D	→ 9120892		Layshaft
					MV50-3	→ 7827145		z=11/17/19
4				O	360.7.13.001.2	9120893 → 7827146 →		Layshaft *
							3	z=11/17/19

* Marked with an identification groove next to the gear having 11 teeth.

O = Old part to be used up, new part applicable to both types.

X = Part omitted, must no longer be used.

→ 5007 up to Engine-No.

5008 → from Engine-No.

→ 2480 up to Chassis-No.

2481 → from Chassis-No.

M = Motive of Modification: 1) New feature New part 2) Change in dimension
3) Change in quality 4) Change in shape 5) Change in part No. only

Signature

in spare parts catalogue

in spare parts index

in spare parts store



Spare parts - Modification notice



Service Graz

Order No. 2.60.45/017

DISTRIBUTOR ENGLAND

DATE Februar 1973

PAGE 1

Spare parts catalogue (model)			Re:							
VS50 Sport England			Change in material of layshaft							
Edition May 1972										
Line	Page Group	Ref.No. Pos.	Old spare part No.	O X	New spare part No.	Remarks As from ...	M	Designation		
1	19	22 23 24	360.2.13.001.2			→ 6138397		Layshaft z= 11/17/19		
2				O	360.7.13.001.2		6138398 →		3	Layshaft * z= 11/17/19
* Marked with an identification groove next to the gear having 11 teeth										

Spare parts catalogue (model)			Re:					
VS50 Sport England			New thrust washer					
Edition May 1972								
Line	Page Group	Ref.No. Pos.	Old spare part No.	O X	New spare part No.	Remarks As from ...	M	Designation
3	19	16	329.1.13.066.1			→ 6138397		Bearing washer 31, 7/20/1, 5 Gear 3rd speed (24 teeth)
4	19	28		360.1.13.013.1				
5				O	329.3.13.066.1	6138398 →	3	Bearing washer (tempered) 31, 7/20/1, 5 Gear 3rd speed (24 teeth) Thrust washer 32/21, 1/2, 2 (bronze) *
6				O	368.1.13.013.1		1	
7					368.1.13.066.1		1	
* The new parts used jointly replace the previous ones.								

Spare parts catalogue (model)			Re:					
VS50 Sport England			New exhaust flange gasket to compensate displaced flanges					
Edition May 1972								
Line	Page Group	Ref.No. Pos.	Old spare part No.	O X	New spare part No.	Remarks As from ...	M	Designation
8	29	32	050.1615			→ 6138477		Exhaust-flange-gasket
9				O	368.1.16.815.1	6138478 →	1	Exhaust-flange-gasket *
* Interchangeability not applicable to model VS 50 Sport								

*MS50V de luxe Edition Sept. 1972			New Bearing Washer (tempered)					
**MS50D Edition March 1971								
Line	Page Group	Ref.No. Pos.	Old spare part No.	O X	New spare part No.	Remarks As from ...	M	Designation
10	*21**7	*15a**15b	329.1.13.066.1		MS50V	→ 5511979		Bearing Washer
					MS50D	→ 7827074		31, 7/20/1, 5
11				O	329.3.13.066.1	5511980 →	3	Bearing washer
						7827075 →		31, 7/20/1, 5 (tempered)

O = Old part to be used up, new part applicable to both types. X = Part omitted, must no longer be used. → 5007 up to Engine-No. 5008 → from Engine-No. → 2480 up to Chassis-No. 2481 → from Chassis-No.	M = Motive of Modification: 1) New feature New part 2) Change in dimension 3) Change in quality 4) Change in shape 5) Change in part No. only			
	Signature	in spare parts catalogue	in spare parts index	in spare parts store



Spare parts - Modification notice



Service Graz

Order No. 2.60.45/018

DISTRIBUTOR ENGLAND

DATE April 1973

PAGE 1

Line	Page Group	Ref. No. Pos.	Old spare part No.	O X	New spare part No.	Remarks As from	M	Designation	
Spare parts catalogue (model) + MS50V/VKH England Edition April 1968 Re: Brake shoe with glued and rivetted lining ++ MV50 Deluxe England Edition Sept. 1972									
1	+67	1	050.4015.0					Brake shoe	
2	++63	9						with glued lining	
3				O	350.1.40.115.0		3	Brake shoe with glued and rivetted lining	
4									
5			Brake shoes used as spare parts for models MS50D, MS50V / VKH, MV50 de Luxe						
6			are now glued and rivetted, (brake shoes for model MS50D are shown in the parts catalogue MS50V/VKH.)						
Spare parts catalogue (model) VS50 Sport England Re: Better laid gear control cable and clutch control cable Edition May 1972									
7	35	8	901.1978			→ 6138897		Threaded bolt M6x85 DIN 938	
8				O	901.1972	6138898 →	1	Threaded bolt M6x90 DIN 938	
9					901.9819		1	Cable clip for gear and clutch control cables (RS 1100-12/15) *	
10									
11			* The new parts used jointly replace the previous ones.						
Spare parts catalogue (model) Maxi England Re: New part number due to method of manufacture Edition June 1971									
12	12	53	349.3.10.015.0					Crankshaft compl.	
13				O	349.1.10.115.0		5	Crankshaft compl.	
Spare parts catalogue (model) + VS50 Sport Edition May 1972 England Re: Threads on clutch side of crankshaft changed from ++ VS50D/DKH Edition April 1968 England M8x1 to M10x1									
14	+14	24	360.3.10.115.0					Crankshaft compl.	
15	++17	14							
16	+17	15		26820		VS50 Sport	→ 6139297		Hexagon nut M8x1 DIN 934
17	++19	15					VS50D/DKH	→ 7828956	
18	+17	16	900.3265					Serrated lock washer øA8,4 DIN 6798	
19	++19	16							
20					329.2.10.015.0	6139298 → 7828957 →	1	Crankshaft compl.	
21					900.2320		1	Hexagon nut M10x1 DIN 934	
22					900.3262		1	Serrated lock washer ø10,5 DIN 6778	
23									
24			* The new parts used jointly replace the previous ones.						
O = Old part to be used up, new part applicable to both types. X = Part omitted, must no longer be used. → 5007 up to Engine-No., 5008 → from Engine-No., → 2480 up to Chassis-No., 2481 → from Chassis-No.				M = Motive of Modification: 1) New feature / New part 2) Change in dimension 3) Change in quality 4) Change in shape 5) Change in part No., only					
Signature		in spare parts catalogue		in spare parts index		in spare parts store			