

P0616Q

Steyr-Daimler-Puch (Great Britain) Ltd.

Steyr-Puch House
211 Lower Parliament Street
Nottingham NG 1 1FZ
ENGLAND

Telephone: Nottingham (06 02) 56 5 21
Telex 37197



England

M.2.Sport M.3.Sport

Spare-Parts Catalogue

Edition January 1974

C O N T E N T S

ENGINE

1. CRANKCASE
2. BLOWER
3. CYLINDER
4. ENGINE PARTS
5. CLUTCH
6. GEARBOX 2-SPEED - for M2-Sport
- 6a. GEARBOX 3-SPEED - for M3-Sport
7. STARTER MECHANISM, CRANKS, PEDALS
8. 2-SPEED FOOT CONTROL - for M2 - Sport
- 8a. 3-SPEED FOOT CONTROL - for M3 - Sport
9. CARBURETTOR
10. INTAKE SILENCER

CHASSIS

11. EXHAUST
12. GENERATOR
13. FUEL TANK
14. FRAME, MUDGUARDS
15. SINGLE SEAT, CARRIER,
LEGSHIELD EQUIPMENT
FOR LATER INSTALLATION
16. BRAKE LEVER SUPPORT, BRAKE PEDAL
17. PIVOTED FORK, PROP STAND
18. SHOCK ABSORBER

FRONT FORK

19. FRONT FORK WITH STEERING
20. HANDLEBAR, CLUTCH LEVER and
THROTTLE TWIST GRIPS

ROAD WHEELS

21. BOWDEN CABLES
22. FRONT WHEEL WITH SPEEDOMETER DRIVE
23. SPEEDOMETER AND DRIVING SHAFT
24. REAR WHEEL, DRIVING CHAIN

ELECTRICAL EQUIPMENT

25. HEADLAMP, TAIL-STOP-LIGHT, BUZZER,
ELECTRICAL EQUIPMENT

ACCESSORIES

26. TOOLS, PUMP

To convert millimeters to inches,
multiply by 0,03937.

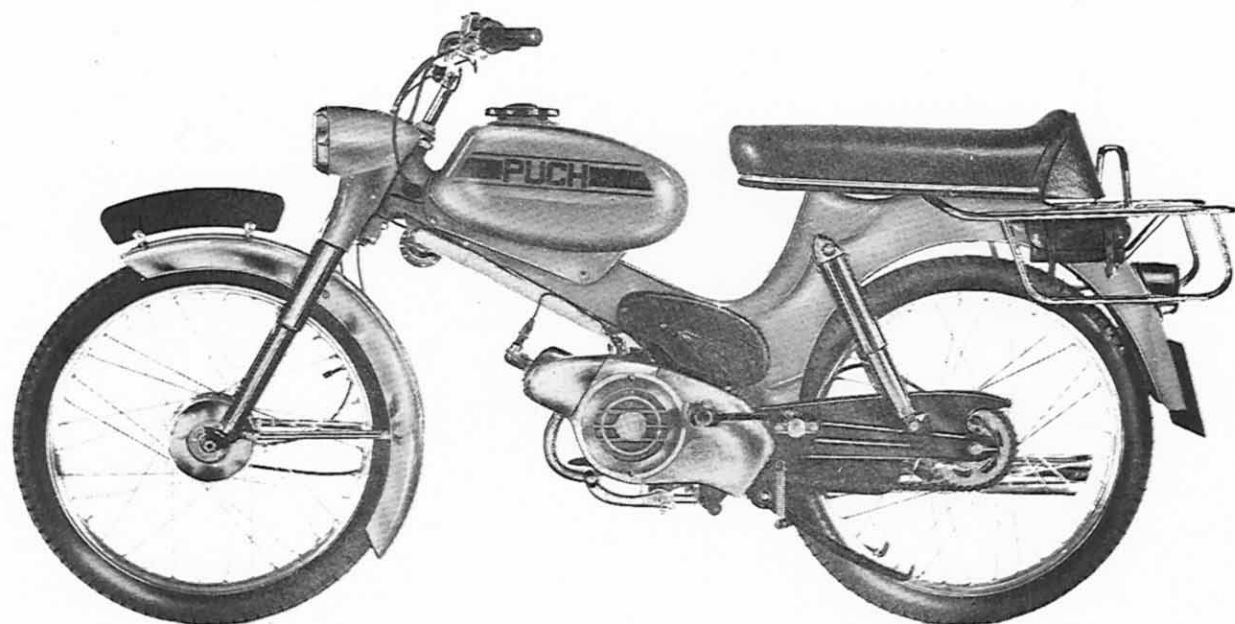

M.2.SPORT / M.3.SPORT - 1974, VIEW l.h.s.

M.2.SPORT is available in the following colours:

orange	RAL 2004	colour code number	39
mat black		colour code number	31

M.3.SPORT is available in the following colours:

sulphur yellow	RAL 1016M	colour code number	68
mat black		colour code number	31

In ordering laquered parts, please do not forget to state the matching colour code number along with the spare-part-number.

e.g. 350.4.20.200.0/ **39**

(Frame for M.2.SPORT)

IMPORTANT I

To get a quick and correct settlement of your spare parts orders following statements are necessary:

1. Exact statement of vehicle
2. Engine no.
3. Spare parts no.
4. Description
5. Colour
6. Required quantity
7. Wanted way of delivery

Beside this our general terms of sale and delivery are valuable.

Please direct your orders to:

place for stamp

GENERAL EXPLANATIONS

Statements as "left", "right", "front", "rear" at the description of spare parts are referring to the moving direction of vehicle. The given dimensions (in mm) for particular parts have to be considered as standards. (To convert millimeters to inches, multiply by 0,03937).

A ref.no. within brackets before a spare part means, that the said part is only similar to the illustration.

A "N" before the statement of reqd. quantity is marking a standard part. The abbreviation "as reqd." means "as required"; the abbreviation "p.m." means "per meter".

The content of the present manual is not obliging for delivery and equipment of vehicle.



ENGINE

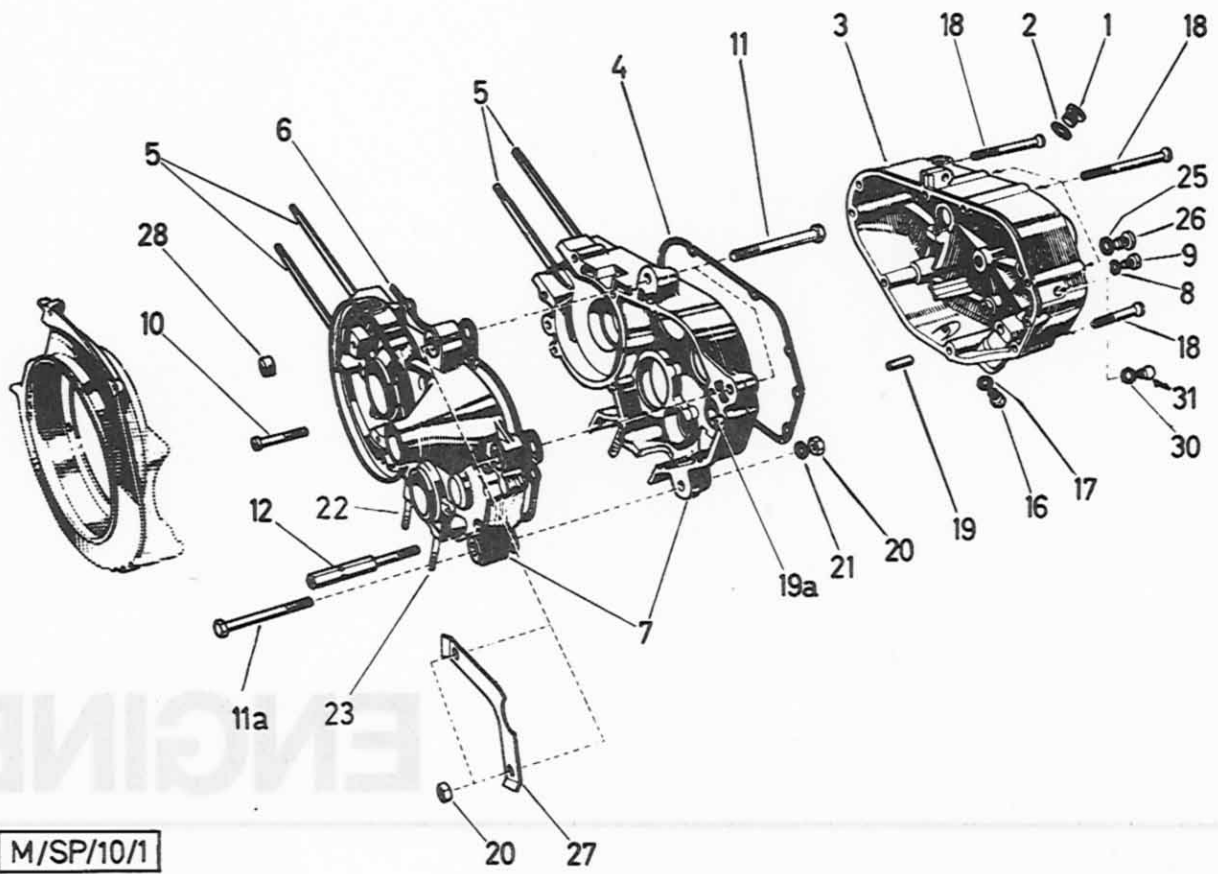

M/SP/10/1

1. CRANKCASE

Ref. No.	Part-No.	Description	Required-No. M2 M3 Sport
1	364.1.10.660.1	OIL FILLER PLUG	1 1
2	27071	SEAL WASHER A10x14 DIN 7603	N 1 1
3	350.6.10.035.0	CRANKCASE COVER, right	1 -
3	360.6.10.035.0	CRANKCASE COVER, right	- 1
4	050.1.1049	CRANKCASE COVER GASKET	1 1
5	360.1.10.034.1	STUD BOLT M6, 103 long	4 4
6	352.1.10.431.1	CRANKCASE GASKET	1 1
7	352.1.10.432.0	CRANKCASE compl.	1 -
7	357.3.10.132.0	CRANKCASE compl.	- 1
8	24365	SEAL WASHER A6x12 DIN 7603	N 1 1
9	900.1305	FILLISTER HEAD SCREW M6x8 DIN 84 for oil control	N 1 1
10	900.1319	FILLISTER HEAD SCREW M6x35 DIN 84 for crankcase assembly	N 9 9
11	900.1136	HEXAGON HEAD SCREW M8x1x65 DIN 960-8G	N 2 2
11a	901.1001	HEXAGON HEAD SCREW M8x1x75 DIN 960-8G	N 1 1
12	350.2.10.030.1	SCREW (M6, 90 long)	1 1
16	901.1053	HEXAGON HEAD SCREW M8x10 Sz DIN 933 for oil drain plug	N 1 1
17	26482	SEAL WASHER A8x14 DIN 7603	N 1 1
18	900.1687	COUNTERSUNK SCREW CM6x70 DIN 964	N 3 4
18	900.1683	COUNTERSUNK SCREW M6x50 DIN 964	N 3 2
18	900.1686	COUNTERSUNK SCREW M6x65 DIN 964	N 1 -
18	900.1682	COUNTERSUNK SCREW M6x45 DIN 964	N - 1
19	900.4810	CYLINDRICAL PIN 6h8x18 DIN 7	N 2 2
19a	050.10.1054	SPACER	2 2

1. CRANKCASE (cont.)

Ref. No.	Part-No.	Description	Required-No.	
			M2	M3 Sport
20	900.2021	HEXAGON NUT M8x1 DIN 934-65	N 3	3
21	26819	SPRING RING B8 DIN 127	N 1	1
22	900.1935	FIXING STUD M6x40 DIN 835	N 2	2
23	900.1901	FIXING STUD M6x25 DIN 835	N 2	2
25	26482	SEAL WASHER A8x14 DIN 7603	N 1	1
26	900.1512	LENS HEAD SCREW AM8x10 DIN 85	N 1	1
27	050.1.1096	LOCKING PLATE for nuts	1	1
28	050.10.1088	RUBBER PLUG for crankcase 12,5mm dia., 10,5 long	2	2
30	27071	SEAL WASHER A10x14 DIN 7603	N 1	1
31	350.1.13.048.1	UNION	1	1

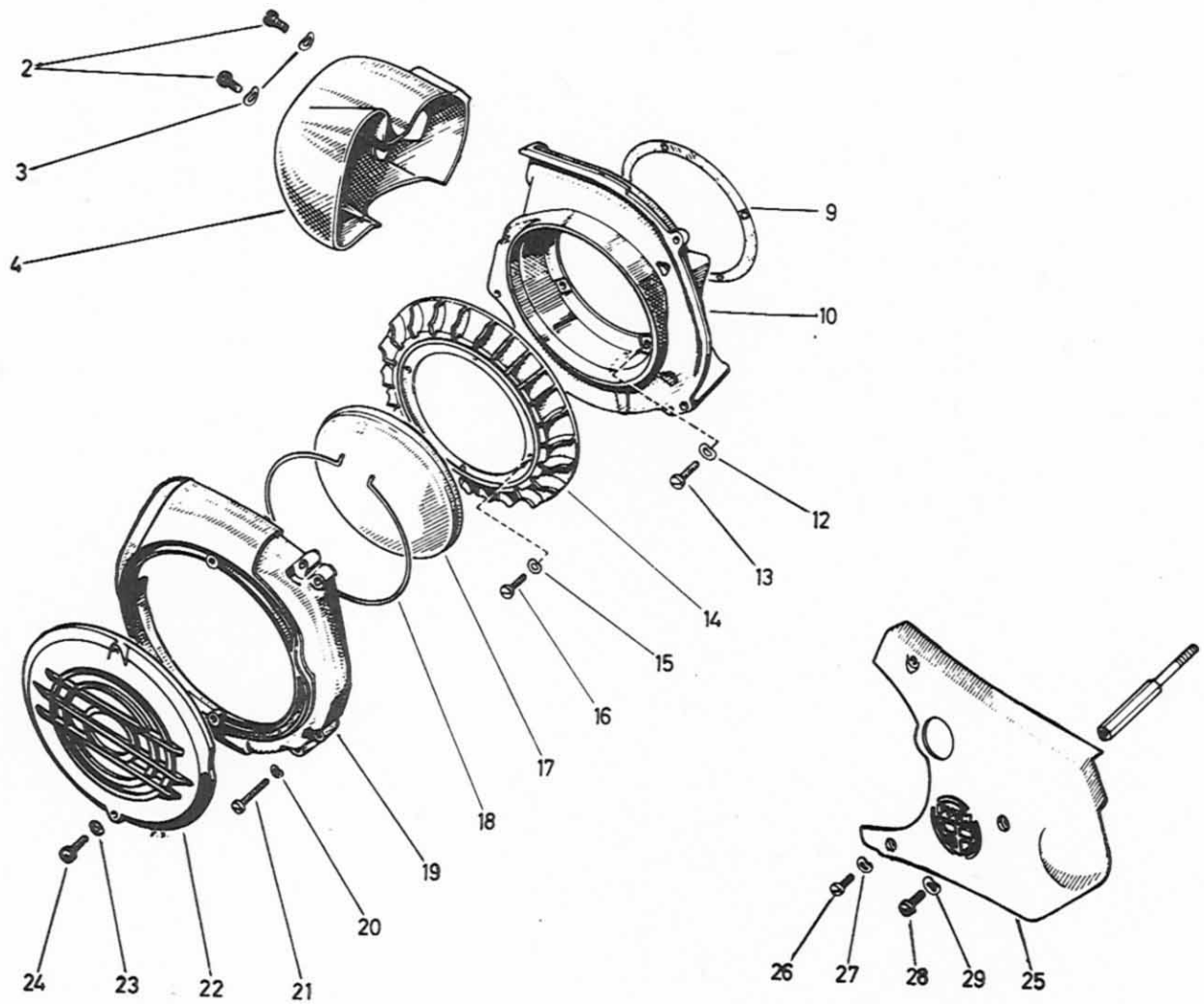

MS/10/2 E

2. BLOWER

Ref. No.	Part-No.	Description	Required-No.	
			M2	M3 Sport
2	900.1514	LENS HEAD SCREW M6x10 DIN 85	N	2
3	900.3213	SPRING WASHER B6 DIN 137	N	2
4	364.1.10.065.1	BLOWER HOOD		1
9	050.10.1036	GASKET dia.122,5mm (paper)		1
10	350.5.10.061.1	BLOWER BASE PLATE		1
12	900.3218	SPRING WASHER 9/5, 2/1		4
13	23099	FILLISTER HEAD SCREW AM5x12 DIN 84	N	4
14	350.5.10.072.1	BLOWER FAN WHEEL		1
15	900.3205	SPRING WASHER A5 DIN 137	N	4
16	1426	FILLISTER HEAD SCREW AM5x8 DIN 84	N	4
17	050.10.1073	COVER PLATE		1
18	350.1.10.074.1	SPRING RING (securing ring)		1
19	050.10.1062	BLOWER HOUSING		1
20	900.3202	SPRING WASHER A4 DIN 137	N	3
21	900.1520	LENS HEAD SCREW M4x20 DIN 85	N	3
22	368.1.10.068.1	BLOWER LOWER COVER		1
23	900.3964	CLAMP DISC 4		2
24	900.1543	LENS HEAD SCREW AM4x8 DIN 85	N	2
25	350.2.10.164.1	FAIRING PLATE		1
26	900.1506	LENS HEAD SCREW M4x12 DIN 85	N	2
27	900.3202	SPRING WASHER A4 DIN 137	N	2
28	27157	LENS HEAD SCREW M5x20 DIN 85	N	1
29	900.3205	SPRING WASHER A5 DIN 137	N	1

3. BLOWER

Part No. / Qty

M2 M3 Sport

M2

M2

1

1

1

4

M4

1

M4

M4

1

1

1

M3

M3

1

2

M2

1

M3

M3

M1

M1

VSV/10/3a

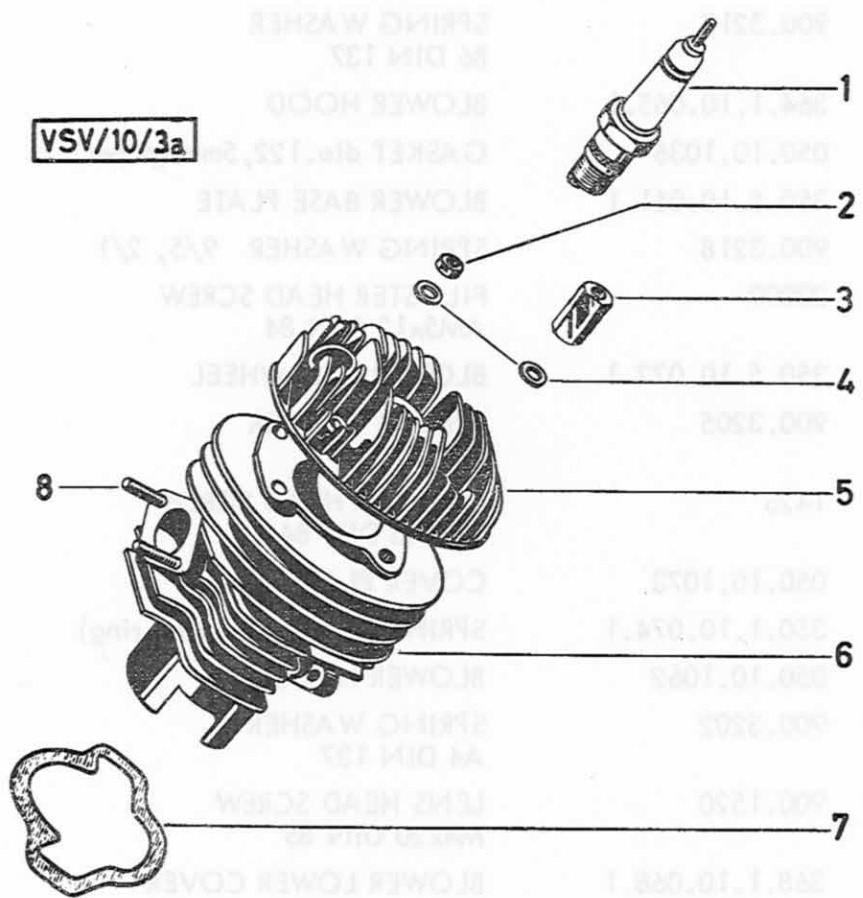

3. CYLINDER

Ref. No.	Part-No.	Description	Required-No.	
			M2	M3 Sport
1	23733	SPARK PLUG (Bosch W225 T1)	1	1
2	24773	HEXAGON NUT M6 DIN 934	N 2	2
3	050.1.1003	ROUND NECK NUT (M6) for cylinder head	2	2
4	24795	WASHER 6,4 DIN 125	N 4	4
5	350.3.10.201.1	CYLINDER HEAD	1	-
5	350.1.10.201.1	CYLINDER HEAD	-	1
6	350.1.10.205.2	CYLINDER normal, dia.38mm	} x	1
6	350.1.10.205.3	CYLINDER, dia.38,5mm		1
6	350.1.10.305.0	CYLINDER with compl. piston dia.38mm		1
6	350.1.10.305.6	CYLINDER with compl. piston dia.38,5mm (new part for exchange)	} xx	1
7	050.1.1013	CYLINDER BASE FLANGE GASKET	1	1
8	050.1.1014	STUD BOLT M6x16	2	2

^xWe suggest to store only cylinders with compl. pistons

^{xx}If you return worn cylinders in order to receive oversize cylinders, the returned cylinders must not be damaged, e.g. leave broken ribs.

3. CYLINDER

Description

Part No.

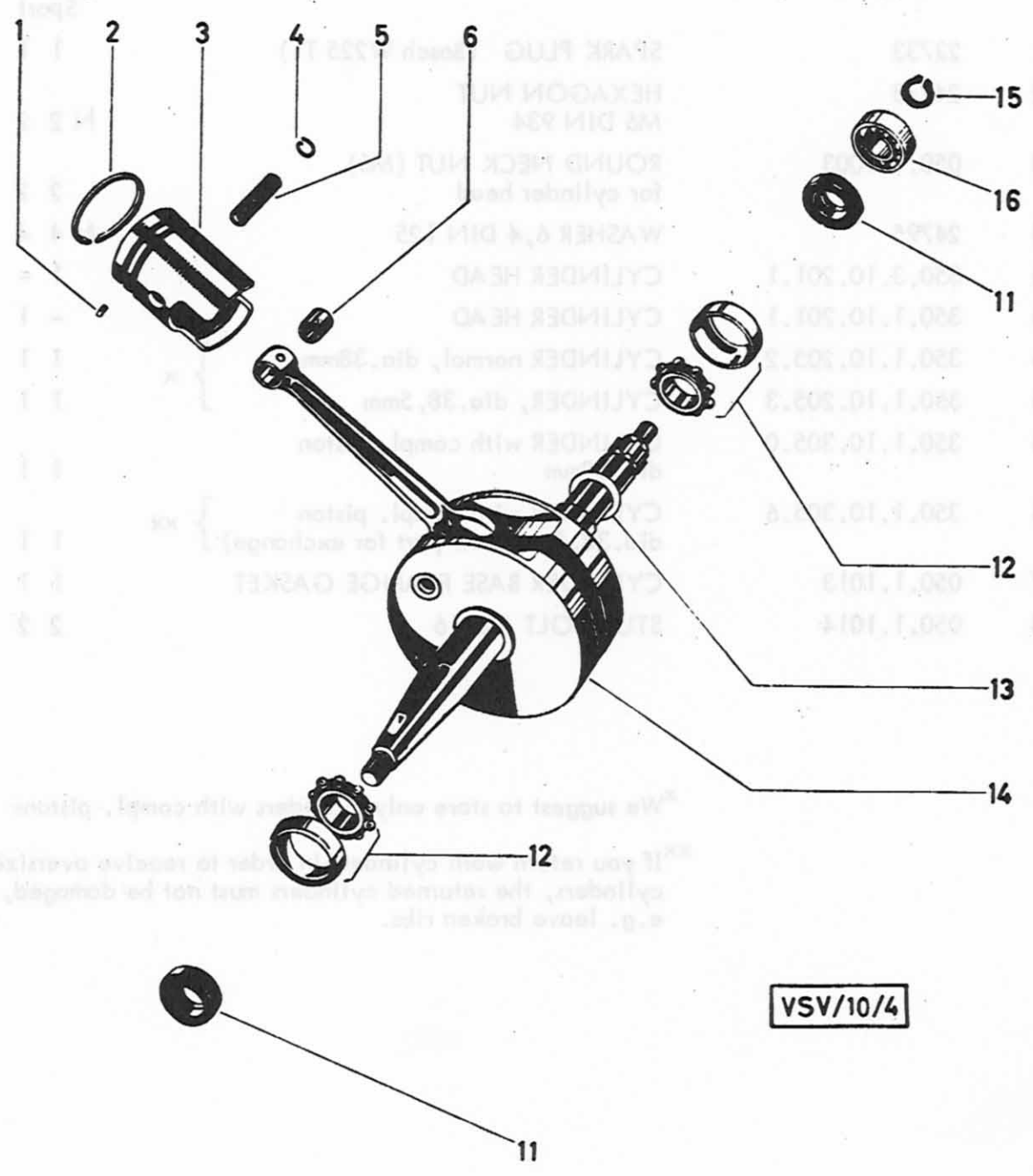

VSV/10/4

4. ENGINE PARTS

Ref. No.	Part-No.	Description	Required-No.	
			M2	M3 Sport
1	900.4855	NOTCHED LOCKING PIN 2x6 DIN 1473	N 2	2
2	320.1.10.060.1	PISTON RING AZ 38x2ac DIN 73102	N 2	2
2	320.1.10.060.3	PISTON RING oversize 1, AZ 38,5x2ac DIN 73102	N -	-
3	350.1.10.006.0/03 ^x	PISTON compl., normal, dia.38, sort.1	1	1
3	350.1.10.006.0/04 ^x	PISTON compl., normal, dia.38, sort.2	1	1
3	350.1.10.006.4/03 ^x	PISTON compl., oversize, dia.38,5, sort. 1	1	1
3	350.1.10.006.4/04 ^x	PISTON compl., oversize, dia.38,5, sort. 2	1	1
4	901.4701	WIRE SPRING RING B12 DIN 73123	N 2	2
5	331.1.10.011.1/12 ^x	GUDGEON PIN dia.12x31 long, sort.2 (white)	1	1
5	331.1.10.011.1/13 ^x	GUDGEON PIN dia.12x31 long, sort.3 (blue)	1	1
6	349.1.10.021.1 ^x	BUSH for connecting rod 14/11,6/12	1	1
6	349.1.10.021.3	BUSH for connecting rod (for repair)	as requd.	
11	900.3807	SEAL RING BA 35/17/7	2	2
12	900.2.6007	BALL BEARING L17a 40/17/10 DIN 615	N 2	2
13	900.3922	SPACER SHIM 24/18,1/0,1	-	-
13	900.3923	SPACER SHIM 24/18,1/0,2	} as requd. - -	
13	900.3992	SPACER SHIM 24/18,1/0,05	} - -	
14	350.3.10.215.0	CRANKSHAFT compl. with connecting rod	1	-
(14)	329.2.10.015.0	CRANKSHAFT compl. with connecting rod	-	1
15	900.4619	CIRCLIP Sg 15x1 DIN 471	N -	1
16	900.4.6202	BALL RACE 6202 35/15/11 DIN 625	N -	1

^xOrdering pistons or gudgeon pins we ask to state the required piston assortment 1 or 2.
(Pressed-on no. 1 or 2 on piston ground, choose piston as recommended in our
Service Bulletins).

4. ENGINE PARTS

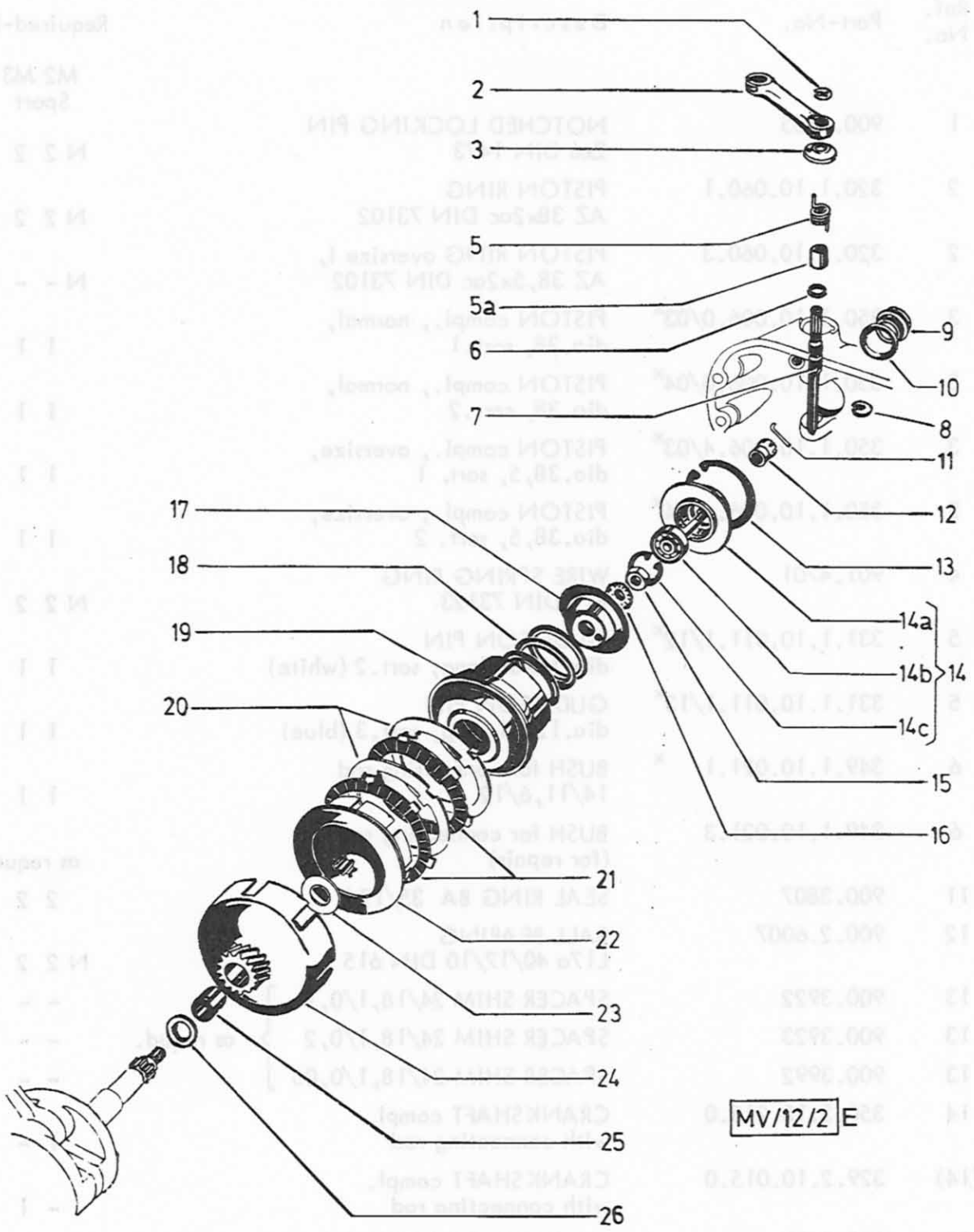

MV/12/2 E

*Ordering pistons or gudgeon pins we ask to state the required piston assortment 1 or 2.
 (Based on nos. 1 or 2 on piston ground, choose piston or recommended in our
 Service Bulletin).

5. CLUTCH

Ref. No.	Part-No.	Description	Required-No.	
			M2	M3 Sport
1	900.4606	CIRCLIP 6 DIN 6799	N 1	1
2	050.2.1231	DECLUTCHING LEVER	1	1
3	350.1.12.019.1	COVERING PLATE (plastic)	1	1
5	350.2.12.022.1	TORSION SPRING	1	1
5a	350.1.12.029.1	SPRING GUIDE	1	1
6	900.3883	OIL SEAL Rs 6-9-1,5	1	1
7	350.3.12.028.1	DECLUTCHING SHAFT	1	1
8	900.4693	SEEGER-C-Ring H10x1	1	1
9	050.1.1233	CENTERING SCREW	1	1
10	900.3718	FIBRE SEAL WASHER 26,5/22/1	1	1
11	050.1237	WIRE PIN dia.1,4mm	1	1
12	050.1234	BALL NUT	1	1
13	900.4745	SNAP RING Sg 45x1,75 DIN 472	N 1	1
14	050.2.1230.0	SET BOLT (compl. with ball bearing, bearing shell and snap ring)	1	1
14a	350.2.12.010.1	BEARING SHELL	1	1
14b	050.1240.2	SET BOLT (compl. with ball bearing, without bearing shell)	1	1
14c	900.4721	SNAP RING Sg21x1 DIN 472	N 1	1
15	900.2320	HEXAGON NUT M10x1 DIN 934	N 1	1
16	900.3262	SERRATED LOCK WASHER A10,5 DIN 6798	N 1	1
17	050.1207	SPRING COLLAR	1	1
18	050.1206	CLUTCH SPRING	1	1
19	050.1205	SPRING CAGE	1	1
20	050.1212	INTERIOR CLUTCH DISC	2	2
21	050.1224.2	EXTERIOR CLUTCH DISC (with friction lining)	2	2
22	050.1204	CLUTCH HUB	1	1
23	050.1215	THRUST WASHER 26/15/1	1	1
24	350.1.12.002.2	CLUTCH HOUSING (19 teeth)	1	-
24	360.1.12.002.2	CLUTCH HOUSING (18 teeth)	-	1
25	050.1211	BEARING BUSHING 17/15/16,3	1	1
26	050.1213	THRUST WASHER 22/15/1,7	1	1

CLUTCH

Reference No.

Description

Part No.

MS 25/14
Sport

14 1

13 1

12 1

11 1

10 1

9 1

8 1

7 1

6 1

5 1

4 1

3 1

2 1

1 1

14 1

13 1

12 1

11 1

10 1

9 1

8 1

7 1

6 1

5 1

4 1

3 1

2 1

1 1

14 1

13 1

12 1

11 1

10 1

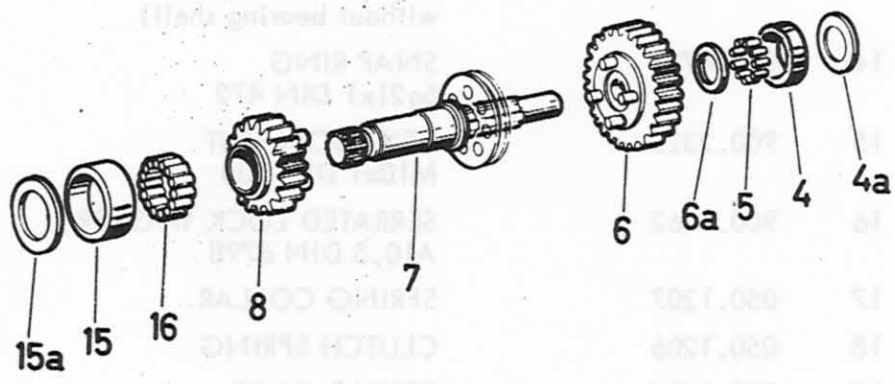
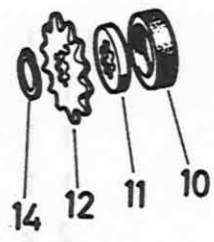
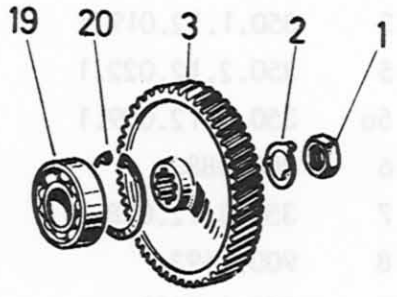
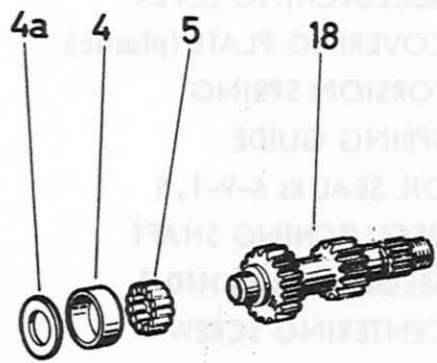

MS 25/14 E

6. GEARBOX 2-SPEED

Ref. No.	Part-No.	Description	Required-No.
1	24787	HEXAGON NUT M12x1	M2 Sport 1
2	360.1.13.004.1	LOCKING PLATE dia.22/12,5mm (flaps outwards)	1
3	350.1.13.000.1	DRIVING PINION (helical gear, 69 teeth)	1
4	329.1.13.010.1	ROLLER RACE dia.28mm	2
4a	329.1.13.009.1	BEARING WASHER 27,8x16x1	2
5	900.6104	ROLLER 3,5x7,5 (14 rollers to each race)	28
6	350.1.13.011.1	FIRST-SPEED GEAR (28 teeth) without collar	1
6a	350.1.13.075.1	DISC 18/12,5/1,6	-
6a	350.1.13.078.1	DISC 18/12,5/1,8	-
6a	350.1.13.076.1	DISC 18/12,5/2	-
6a	350.1.13.079.1	DISC 18/12,5/2,25	-
6a	350.1.13.077.1	DISC 18/12,5/2,5	-
6a	350.1.13.080.1	DISC 18/12,5/2,75	-
		} as required, for first-speed gear without collar	
7	350.2.13.020.1	MAIN SHAFT 90,5 long	1
8	350.1.13.112.1	SECOND-SPEED GEAR (23 teeth)	1
10	050.1321	SEAL WASHER BA 28/17/7	1
11	050.1.1319	INTERMEDIATE DISC	1
12	050.1317	GEARBOX CHAIN SPROCKET (12 teeth)	1
14	900.4616	SNAP-RING 16x1 DIN 471	N 1
15	329.1.13.065.1	OUTER RACE dia.32	1
15a	329.3.13.066.1	BEARING WASHER 31,7x20x1,5	1
16	900.6104	ROLLER dia.3,5mmx7,5mm	18
18	350.1.13.101.1	COUNTER SHAFT 10/16 teeth, 102,5 long	1
19	900.4.6202	DEEP-ROW BALL BEARING 6202 35/15/11 DIN 625	N 1
20	900.4735	SNAP RING Sg 35x1,5 DIN 472	N 1

4. GEARBOX 2-SPEED

Part No.	Description	Qty.
----------	-------------	------

1	HEXAGON NUT M12x1	1
2	LOCKING PLATE dia. 32x1,5mm (Flange outwards)	1
3	DRIVING PINION (Internal gear, 59 teeth)	1
4	ROLLER RACE dia. 28mm	2
5	BEARING WASHER 37, 5x26x1,5	2
6	ROLLER RACE dia. 28mm	2
7	DRIVING PINION (Internal gear, 59 teeth)	1
8	DRIVING PINION (Internal gear, 59 teeth)	1
9	DRIVING PINION (Internal gear, 59 teeth)	1
10	DRIVING PINION (Internal gear, 59 teeth)	1
11	DRIVING PINION (Internal gear, 59 teeth)	1
12	DRIVING PINION (Internal gear, 59 teeth)	1
12a	DRIVING PINION (Internal gear, 59 teeth)	1
13	DRIVING PINION (Internal gear, 59 teeth)	1
14	DRIVING PINION (Internal gear, 59 teeth)	1
15	DRIVING PINION (Internal gear, 59 teeth)	1
16	DRIVING PINION (Internal gear, 59 teeth)	1
17	DRIVING PINION (Internal gear, 59 teeth)	1
18	DRIVING PINION (Internal gear, 59 teeth)	1
19	DRIVING PINION (Internal gear, 59 teeth)	1
20	DRIVING PINION (Internal gear, 59 teeth)	1
21	DRIVING PINION (Internal gear, 59 teeth)	1
22	DRIVING PINION (Internal gear, 59 teeth)	1
23	DRIVING PINION (Internal gear, 59 teeth)	1
24	DRIVING PINION (Internal gear, 59 teeth)	1
25	DRIVING PINION (Internal gear, 59 teeth)	1
26	DRIVING PINION (Internal gear, 59 teeth)	1
27	DRIVING PINION (Internal gear, 59 teeth)	1
28	DRIVING PINION (Internal gear, 59 teeth)	1

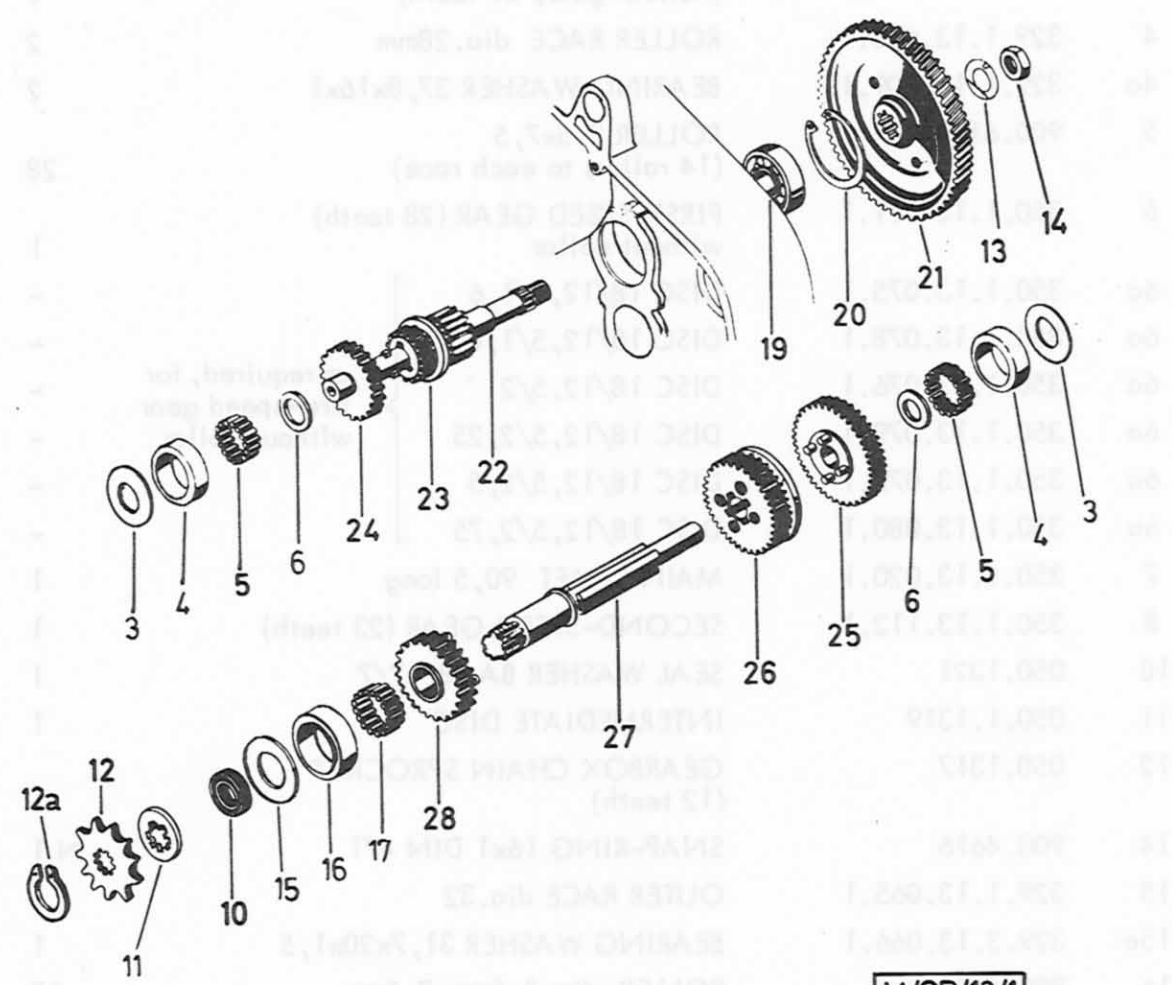

M/SP/13/1

6a. GEARBOX 3-SPEED

Ref. No.	Part-No.	Description	Required No.
			M3 Sport
3	329.1.13.009.1	BEARING WASHER 27,8x16x1	2
4	329.1.13.010.1	ROLLER RACE dia.28	2
5	900.6104	ROLLER dia.3,5x7,5 (14 rollers to each race)	28
6	350.1.13.075.1	THRUST WASHER 18/12,5/1,6	-
	350.1.13.078.1	THRUST WASHER 18/12,5/1,8	-
	350.1.13.076.1	THRUST WASHER 18/12,5/2	-
	350.1.13.079.1	THRUST WASHER 18/12,5/2,25	-
	350.1.13.077.1	THRUST WASHER 18/12,5/2,5	-
	350.1.13.080.1	THRUST WASHER 18/12,5/2,75	-
		as required	
10	050.1321	SEAL WASHER BA 28/17/7	1
11	050.1.1319	INTERMEDIATE DISC	1
12	050.1317	GEARBOX CHAIN SPROCKET (12 teeth)	1
12a	900.4616	LOCKING RING 16x1 DIN 471	N 1
13	360.1.13.004.1	LOCKING PLATE 22/12,5/1 for countershaft	1
14	24787	HEXAGON NUT M12x1 for countershaft	1
15	329.3.13.066.1	BEARING WASHER 31,7x20x1,5	1
16	329.1.13.065.1	OUTER RACE dia.32	1
17	900.6104	ROLLER dia.3,5x7,5	18
19	900.4.6202	RADIAL BALL BEARING 6202 35/15/11 DIN 625	N 1
20	900.4735	SNAP RING Sg 35x1,5 DIN 472	N 1
21	360.1.13.000.1	DRIVING GEAR (helical gear) 72 teeth	1
22	360.7.13.001.2	COUNTERSHAFT (11/17/19 teeth)	1
23			
24			
25	360.3.13.011.1	GEAR 1st speed (39 teeth) with groove	1
26	360.1.13.012.1	GEAR 2nd speed (34 teeth)	1
27	360.2.13.020.1	MAIN SHAFT 108 long	1
28	360.1.13.013.1	GEAR 3rd speed (24 teeth)	1

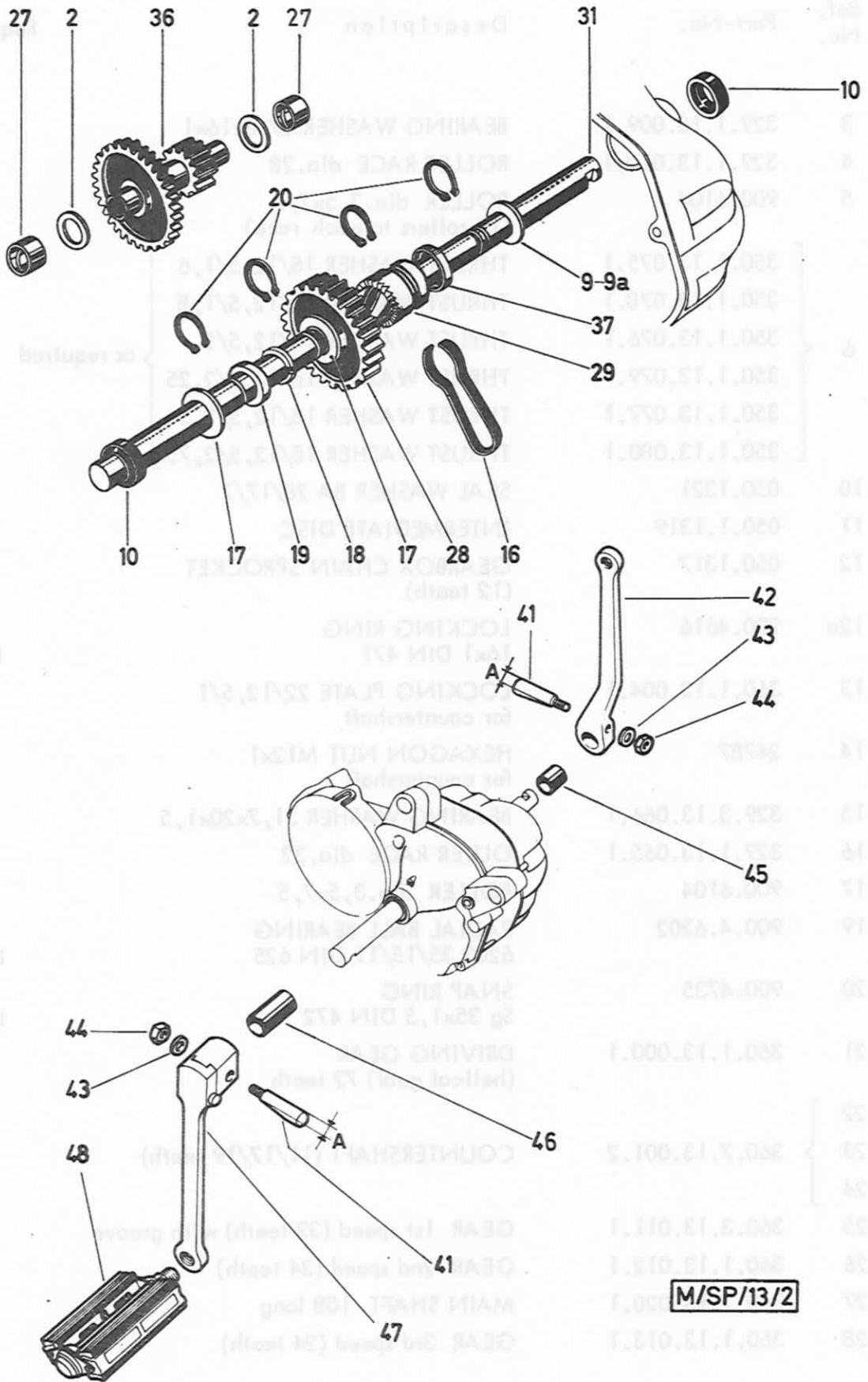

M/SP/13/2

7. STARTER MECHANISM, CRANKS, PEDALS

Ref. No.	Part-No.	Description	Required-No.	
			M2	M3 Sport
2	050.1329	THRUST WASHER 20,5/14/1,9	-	-
2	050.1329.2	THRUST WASHER 20,5/14/2	-	-
2	050.1329.3	THRUST WASHER 20,5/14/2,1	-	-
2	050.1329.4	THRUST WASHER 20,5/14/2,4	-	-
9	050.4.1353	THRUST WASHER 26/16,2/1	1	1
9a	900.3922	THRUST WASHER 24/18,1/0,1	-	-
9a	900.3923	THRUST WASHER 24/18,1/0,2	-	-
9a	900.3924	THRUST WASHER 24/17,1/0,5	-	-
10	050.1335	RUBBER SEAL RING BAOF 24/16/7	2	2
16	050.1.1334	BRAKE SPRING for driver	1	1
17	050.1343	THRUST WASHER 26/16/2	2	2
18	350.3.13.051.1	RETAINING RING	1	1
19	350.3.13.052.1	LOCKING RING	1	1
20	900.4616	CIRCLIP Sg 16x1 DIN 471	N 4	4
27	360.1.13.033.1	BUSH 17/14/10 for countershaft	2	2
28	352.1.13.031.1	STARTER GEAR (26/20 teeth)	1	-
28	364.1.13.031.1	STARTER GEAR (31/20 teeth)	-	1
29	352.1.13.027.1	DRIVER (20 teeth) 32 long	1	-
29	361.1.13.027.1	DRIVER (20 teeth) 24 long	-	1
31	350.5.13.032.1	PEDAL SHAFT 296 long	1	-
31	357.3.13.032.1	PEDAL SHAFT 296 long	-	1
36	352.1.13.030.2	COUNTERSHAFT (33 and 20 teeth)	1	-
36	364.1.13.030.2	COUNTERSHAFT (32 and 15 teeth)	-	1
37	364.1.13.023.1	CAP dia.26mm, for driver	1	1
41	605.1313	COTTER measure a7,4	1	1
	600.1.12.011.1	COTTER measure a6,9	1	1
	600.2.12.011.1	COTTER measure a7,2	1	1
	600.3.12.011.1	COTTER measure a6,7	1	1
	600.4.12.011.1	COTTER measure a7,6	1	1
	364.2.13.342.1	COTTER measure a7,5	1	1
42	050.1340	CRANK r.h.s.	1	1
43	900.3926	WASHER for crank 14/6,5/2	2	2
44	900.2909	HEXAGON NUT 1/4" 26 gear/inch	2	2

7. STARTER MECHANISM, CRANKS, PEDALS (cont.)

Ref. No.	Part-No.	Description	Required-No.	
			M2	M3 Sport
45	357.1.13.055.1	PROTECTION SLEEVE 18/16/25 (for pedal shaft r.h.s.)	1	1
46	357.1.13.054.1	PROTECTION SLEEVE 18/16/38 (for pedal shaft l.h.s.)	1	1
47	352.1.13.141.0	SPECIAL CRANK compl. l.h.s.	1	1
48	600.3.18.035.0	PEDAL l.h.s. and r.h.s. compl. (with rear reflector black) per pair	1	1
-	-	THRUST WASHER 24/10, 1/0, 2		
-	-	THRUST WASHER 24/17, 1/0, 3		
2	2	RUBBER SEAL RING BACK 24/10, 2		
1	1	BRAKE SPRING for driver		
2	2	THRUST WASHER 24/10, 2		
1	1	RETAINING RING		
1	1	LOCKING RING		
4	4	CIRCLIP 26 1/4" DIA 437		
2	2	BUSH 17/14/10 for countershaft		
1	1	STARTER GEAR (26/20 teeth)		
1	1	STARTER GEAR (31/20 teeth)		
1	1	DRIVER (20 teeth) 32 long		
1	1	DRIVER (20 teeth) 24 long		
1	1	PEDAL SHAFT 295 long		
1	1	PEDAL SHAFT 295 long		
1	1	COUNTERSHAFT (33 and 20 teeth)		
1	1	COUNTERSHAFT (33 and 12 teeth)		
1	1	CRP dia. 28mm, for driver		
1	1	COTTER measure 0,4		
1	1	COTTER measure 0,8		
1	1	COTTER measure 0,2		
1	1	COTTER measure 0,3		
1	1	COTTER measure 0,6		
1	1	COTTER measure 0,2		
1	1	CRANK r.h.s.		
2	2	WASHER for crank 14/6, 2/2		
2	2	HEXAGON NUT 1/4" 26 gear/inch		

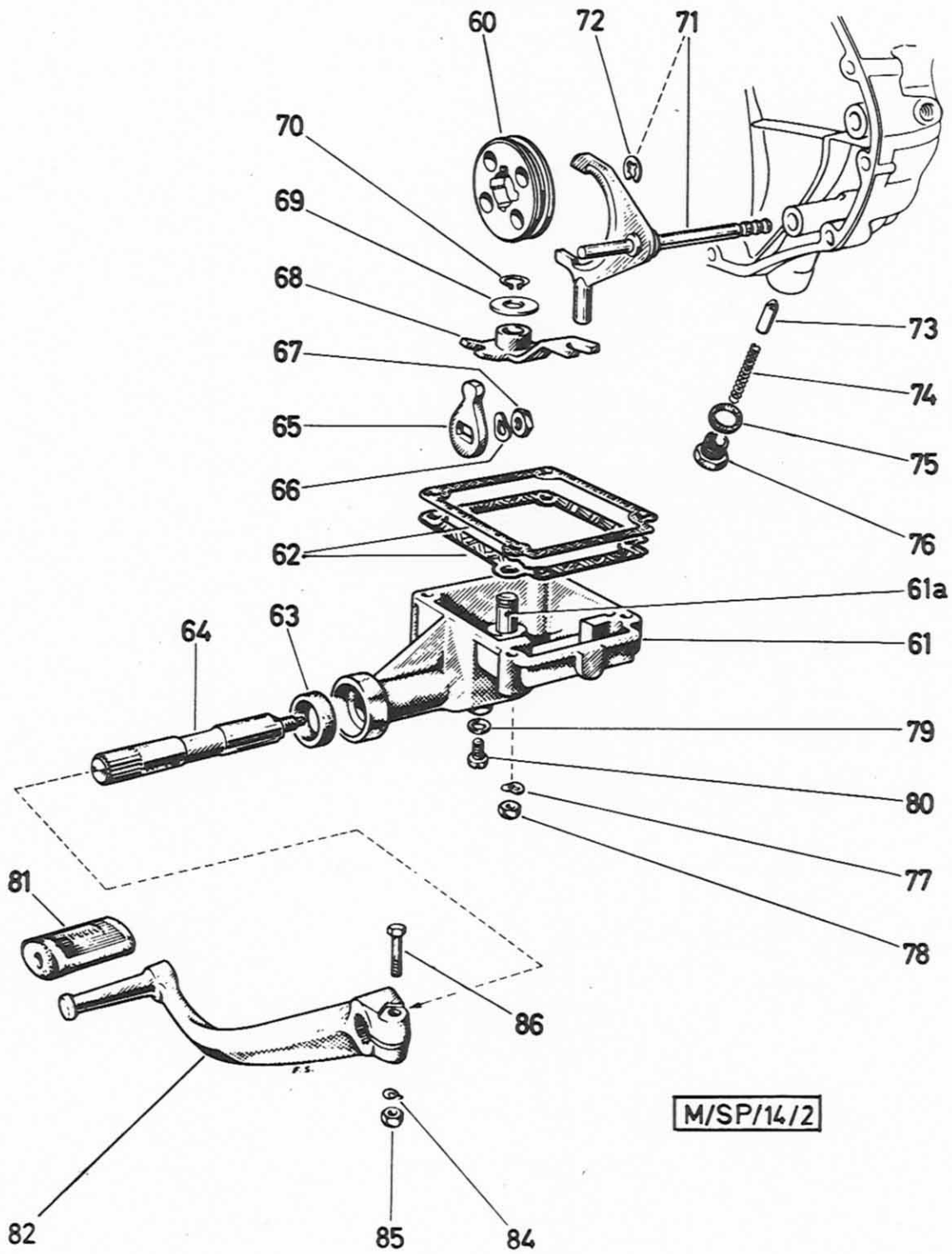

8. 2-SPEED FOOT CONTROL

Ref. No.	Part-No.	Description	Required-No.
			M2 Sport
--	352.1.14.402.0	2-SPEED FOOT CONTROL compl. (with parts 61÷70 and 77÷80)	1
60	050.1.1410	CONTROL SOCKET	1
61	352.1.14.402.2	CONTROL CASING (with bearing bolt, spring washer and hexagon nut)	1
61a	352.1.14.409.1	BEARING BOLT	1
62	357.1.14.101.1	GASKET	2
63	51.1.1345	SEAL RING BA 24/14/7	1
64	357.1.14.106.1	CONTROL SHAFT	1
65	357.2.14.107.1	BALL LEVER	1
66	900.3211	SPRING WASHER B8 DIN 137	N 1
67	900.2307	FLAT HEXAGON NUT M8x1 DIN 439	N 1
68	352.2.14.405.2	INSIDE CONTROL LEVER	1
69	14778	WASHER 21/10,5/1	1
70	900.4610	SNAP RING Sg 10x1 DIN 471	N 1
71	352.1.14.425.0	SELECTOR FORK compl.	1
72	900.4606	BZ-WASHER 6 DIN 6799	N 2
73	352.1.14.421.1	CATCH	1
74	100.1423	CATCH SPRING	1
75	900.4212	SEAL RING 18/12,3/1	1
76	050.1.1422	PLUG	1
77	900.3213	SPRING WASHER B6 DIN 137	N 5
78	900.2106	HEXAGON NUT M6 DIN 555	N 5
79	24365	SEAL RING A6x12 DIN 7603	N 1
80	900.1305	CHEESE HEAD SCREW M6x8 DIN 84	N 1
81	253.1436	PEDAL RUBBER	1
82	352.2.14.401.1	CONTROL PEDAL	1
84	900.3207	SPRING WASHER A7 DIN 137	N 1
85	900.2015	HEXAGON NUT M7 DIN 934	N 1
86	901.1056	HEXAGON SCREW M7x32 DIN 931-8G	N 1

8. 2-SPEED FOOT CONTROL

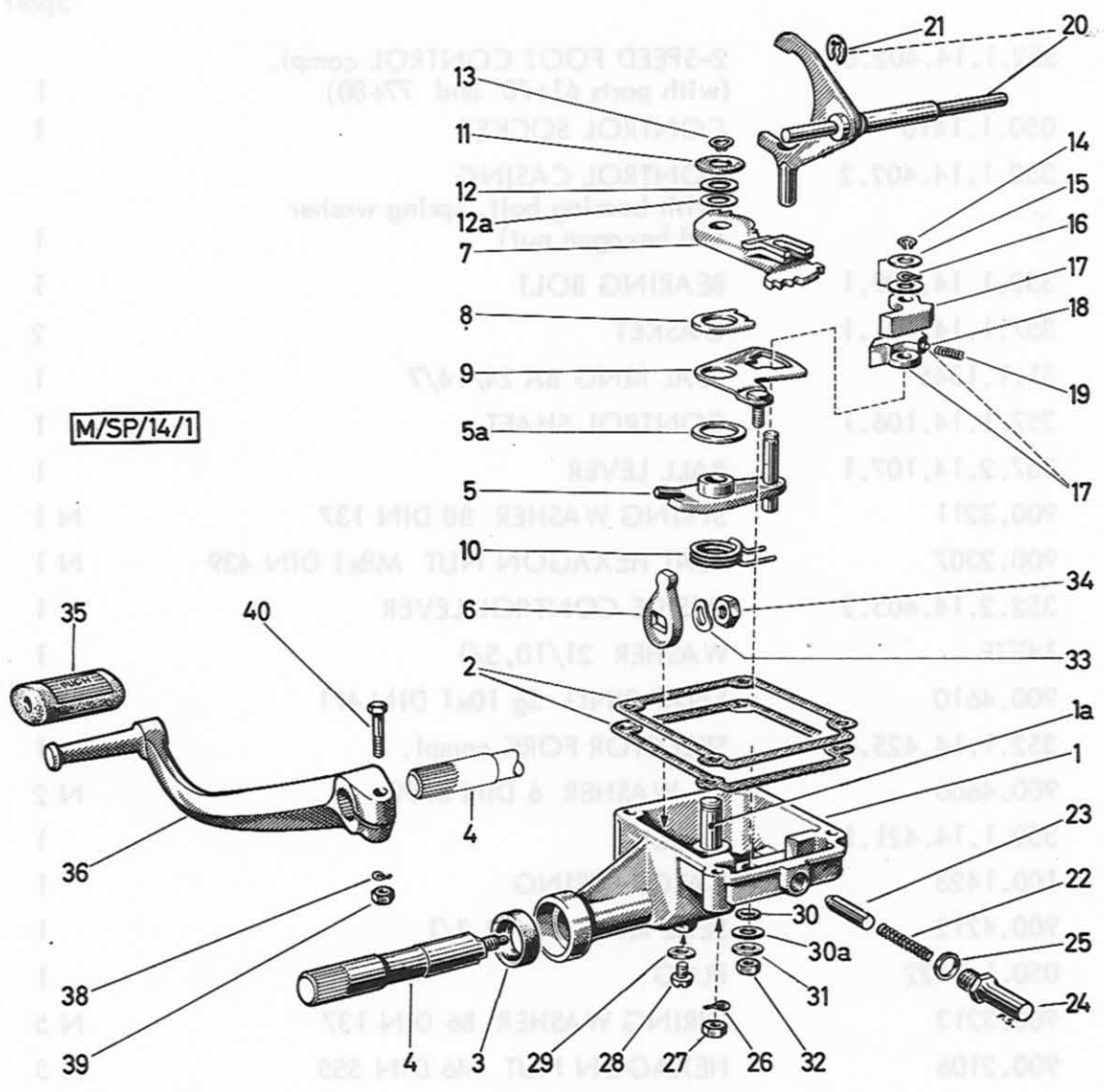

8a. 3-SPEED FOOT CONTROL

Ref. No.	Part-No.	Description	Required-No. M3 Sport
--	357.3.14.102.0	3-SPEED FOOT CONTROL compl. (with parts 1-34, without part 20 and 21)	1
1	357.2.14.102.2	CONTROL CASING (with bearing bolt, spring washer and hexagon nut)	1
1a	357.2.14.109.1	BEARING BOLT	1
2	357.1.14.101.1	GASKET	2
3	51.1.1345	SEAL RING BA 24/14/7	1
4	357.1.14.106.1	CONTROL SHAFT	1
5	357.2.14.105.2	INSIDE CONTROL LEVER	1
5a	050.4.1353	WASHER 26/16/1	1
6	357.2.14.107.1	BALL LEVER	1
7	357.3.14.110.2	CONTROL QUADRANT	1
8	360.1.14.311.1	LIFTING PLATE	1
9	357.1.14.103.2	PLATE	1
10	360.1.14.316.1	CONTROL SPRING	1
11	14778	WASHER 21/10,5/1	1
12	901.3914	WASHER 18/10,1/0,5	1
12a	900.3929	WASHER 18/10,1/0,2	as req.
12a	900.3930	WASHER 18/10,1/0,3	as req.
12a	901.3913	WASHER 18/10,3/0,8	as req.
13	900.4610	SNAP RING Sg 10x1 DIN 471	N 1
14	900.4608	SNAP RING Sg 8x0,8 DIN 471	N 1
15	900.3949	WASHER 15/8,5/0,75	2
16	050.1.1426	SPRING WASHER	1
17	357.1.14.117.2	CLICK (with slotted hollow pin)	2
18	900.4847	SLOTTED HOLLOW PIN 2,5x8 DIN 1481	N 2
19	128.1427	THRUST SPRING	1
20	357.1.14.125.0	SELECTOR FORK compl.	1
21	900.4606	BZ-WASHER 6 DIN 6799	N 1
22	357.2.14.123.1	CATCH SPRING	1
23	357.2.14.121.1	CATCH	1
24	357.2.14.122.1	CATCH GUIDE	1
25	27633	SEAL RING 14,5/11,2	1
26	900.3213	SPRING WASHER B6 DIN 137	N 5

8a. 3-SPEED FOOT CONTROL (cont.)

Ref. No.	Part-No.	Description	Required-No.
			M3 Sport
27	900.2106	HEXAGON NUT M6 DIN 555	N 5
28	900.1305	CHEESE HEAD SCREW AM6x8 DIN 84	N 1
29	24365	SEAL RING A6x12 DIN 7603	N 1
30	900.3883	RUBBER RING RS 6-9-1,5	1
30a	900.3913	WASHER AL 11/6/1	1
31	24804	WASHER 6,4 DIN 433	N 1
32	900.2106	HEXAGON NUT M6 DIN 555	N 1
33	900.3211	SPRING WASHER B8 DIN 137	N 1
34	900.2307	FLAT HEXAGON NUT M8x1 DIN 439	N 1
35	253.1436	PEDAL RUBBER	1
36	352.2.14.401.1	CONTROL PEDAL	1
38	900.3207	SPRING WASHER A7 DIN 137	N 1
39	900.2015	HEXAGON NUT M7 DIN 934	N 1
40	901.1056	HEXAGON SCREW M7x32	N 1

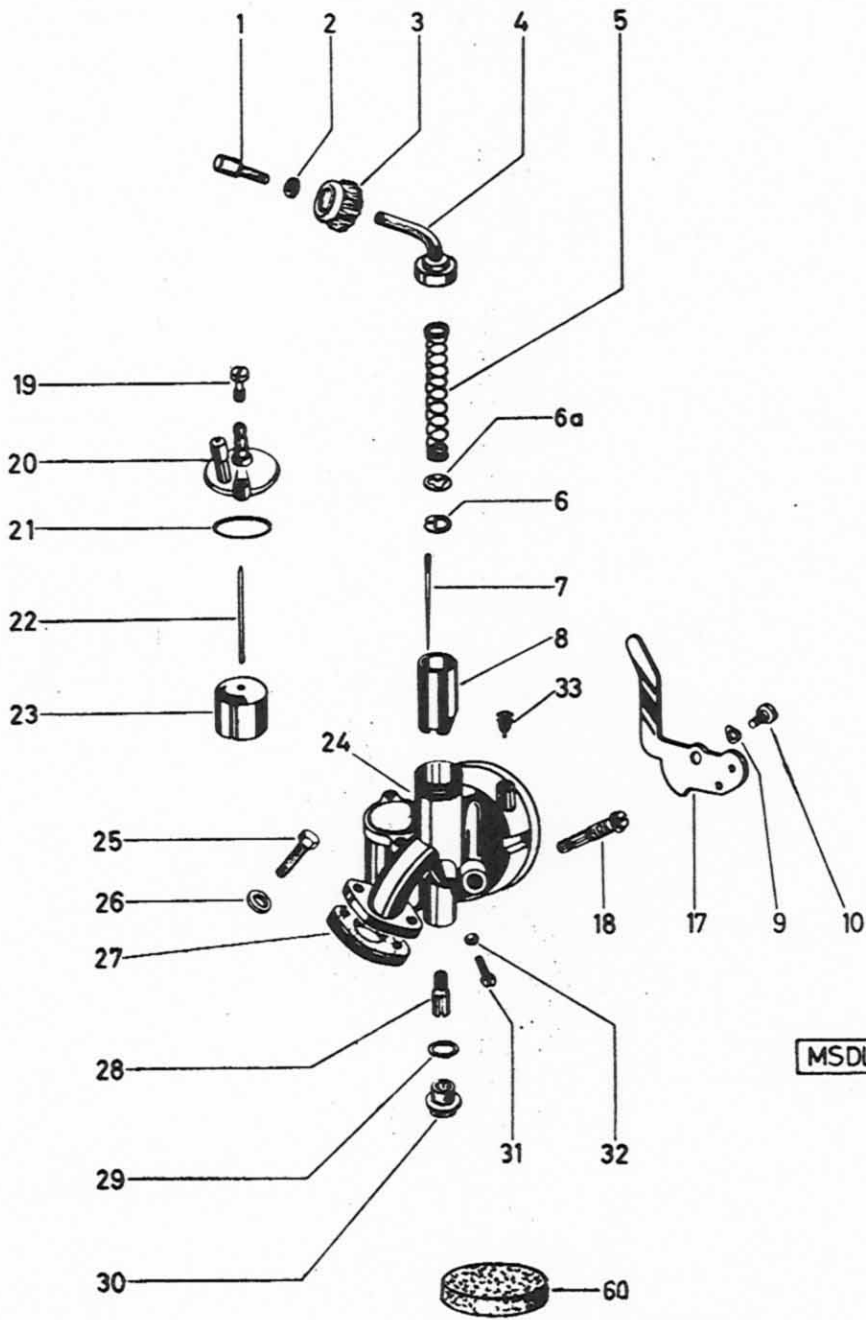

MSDL/15/4 E

9. CARBURETTOR

Ref. No.	Part-No.	Description	Required-No.		
			M2	M3	Sport
--	360.5.15.500.0/52	CARBURETTOR compl. with tickler without air filter BING 1/12/197, jet no.52			1
1	050.1520	BOWDENCABLE ADJUSTING SCREW (M5)			1
2	050.1517	NUT for bowden cable adjusting screw			1
3	050.1519	SCREW COVER			1
4	050.1518	HEAD with tube band			1
5	050.1531	THRUST SPRING for throttle			1
6	050.1513	CLAMP SPRING			1
6a	350.1.15.014.1	DISC dia.11m, 0,5 strong			1
7	050.1516	JET NEEDLE			1
8	050.1515	THROTTLE SLIDE			1
9	900.3218	SPRING WASHER A5			1
10	360.1.15.552.1	NECK SCREW			1
17	360.1.15.553.1	CHOKE VALVE			1
18	050.1509/52	MAIN JET No. 52			1
18	050.1509/.. ^x	MAIN JET No. .. ^x as required			-
19	050.1535	CAP SCREW			2
20	364.1.15.032.2	FLOAT CHAMBER COVER with tickler			1
21	050.1536	FLOAT CHAMBER COVER GASKET			1
22	050.1530	FLOAT NEEDLE			1
23	050.1525	FLOAT			1
24	360.1.15.501.2	CARBURETTOR BODY (outside ventilation)			1
25	900.1107	HEXAGON HEAD SCREW M6x25 DIN 933			N 2
26	24804	WASHER 6,4 DIN 433			N 2
27	350.1.15.021.2	CARBURETTOR FLANGE GASKET			1
28	050.1508	NEEDLE JET			1
29	27071	SEAL WASHER A10x14 DIN 7603			N 1
30	050.1523	SCREW PLUG			1
31	050.1511	THROTTLE SLIDE STOP SCREW			1
32	24771	HEXAGON NUT M4 DIN 934			N 1
33	501.1.7179	RUBBER PLUG as required			1
60	350.1.15.016.1	DIRT SPLASH GUARD			1

^xPlease state jet-no.

V. CARBURETTOR

Part No. 15201-1

Description

Part No.

Qty.

MS-DS

CARBURETTOR compl. with filter

without oil filter

with 1/2" x 1/2" x 1/2" filter

ADJUSTABLE ADJUSTING SCREW (MS)

nut for bottom cable adjusting screw

SCREW COVER

HEAD with nuts and

THRUST SPRING for throttle

THRUST SPRING for throttle

THRUST SPRING for throttle

THRUST SPRING for throttle

THRUST SPRING for throttle

THRUST SPRING for throttle

THRUST SPRING for throttle

THRUST SPRING for throttle

THRUST SPRING for throttle

THRUST SPRING for throttle

THRUST SPRING for throttle

THRUST SPRING for throttle

THRUST SPRING for throttle

THRUST SPRING for throttle

THRUST SPRING for throttle

THRUST SPRING for throttle

THRUST SPRING for throttle

THRUST SPRING for throttle

THRUST SPRING for throttle

THRUST SPRING for throttle

THRUST SPRING for throttle

THRUST SPRING for throttle

THRUST SPRING for throttle

THRUST SPRING for throttle

THRUST SPRING for throttle

THRUST SPRING for throttle

THRUST SPRING for throttle

THRUST SPRING for throttle

THRUST SPRING for throttle

THRUST SPRING for throttle

THRUST SPRING for throttle

THRUST SPRING for throttle

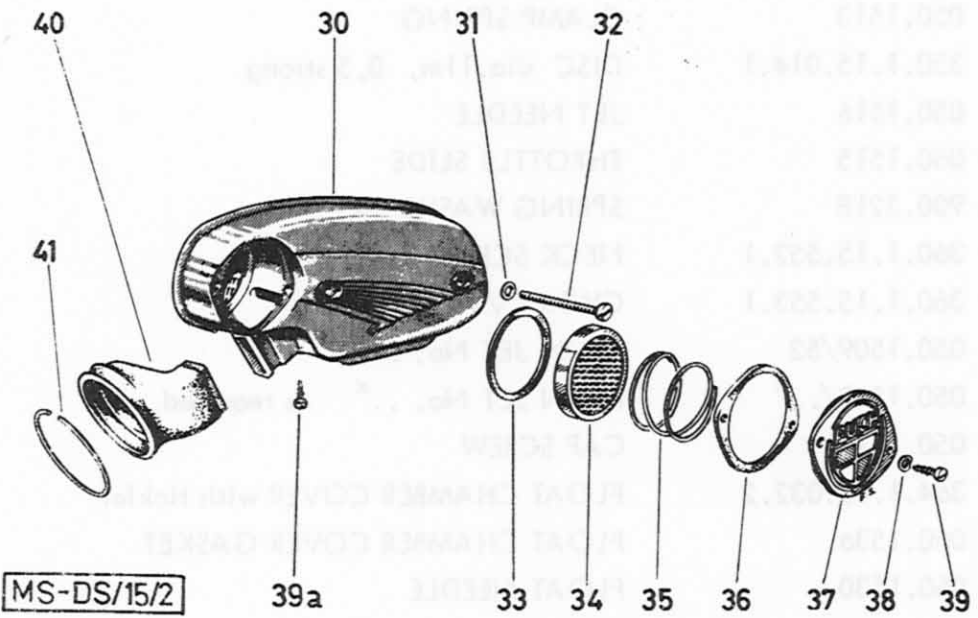

MS-DS/15/2

10. INTAKE SILENCER

Ref. No.	Part-No.	Description	Required-No.	
			M2	M3 Sport
30	357.1.15.070.0	INTAKE SILENCER compl. (with air filter) (with parts 30 and 33 ÷ 39a)		1
31	24794	PLAIN WASHER 5,3 DIN 125	N	2
32	900.1336	CHEESE HEAD SCREW AM5x55 DIN 84	N	2
33	050.1576	SEAL RING 52/45/2		1
34	050.1540.2	AIR FILTER		1
35	250.1327	THRUST SPRING		1
36	357.1.15.079.1	GASKET for cover		1
37	357.1.15.078.1	COVER		1
38	900.3202	CURVED WASHER A4 DIN 137	N	2
39	900.9516	CHEESE HEAD TAPPING SCREW A4x13 DIN 7971	N	2
39a	900.9513	CHEESE HEAD TAPPING SCREW A4x9,5 DIN 7971	N	1
40	050.10.1577	CONNECTING SLEEVE		1
41	364.1.15.081.1	SPRING RING for connecting sleeve		1

10. INTAKE SILENCER

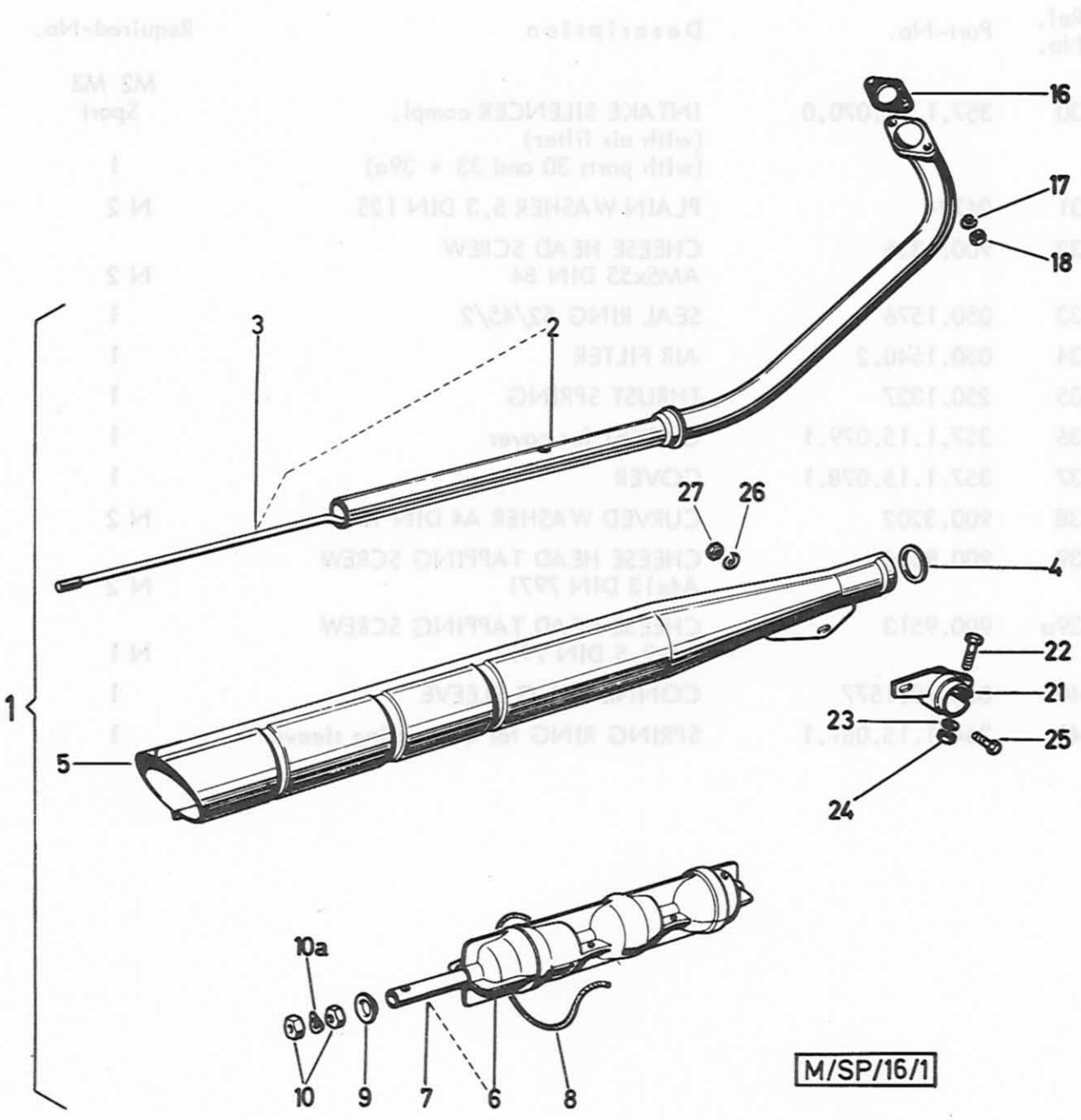

M/SP/16/1

Part No. - 1000

Required No.

Description

Part No.

M/SP/16/1

INTAKE SILENCER compl.

1000

1

(with air filter)

M/2

(with part 30 and 38 + 39a)

M/2

PLAIN WASHER 2.3 DIN 122

1

CHEESE HEAD SCREW

1

AM522 DIN 94

1

SEAL RING

1

AIR FILTER

1

EXHAUST SPRING

1

CHEESE HEAD TAPPING SCREW

1

M/2 DIN 913

1

CHEESE HEAD TAPPING SCREW

1

M/2 DIN 913

1

PLAIN WASHER 2.3 DIN 122

1

CHEESE HEAD TAPPING SCREW

1

M/2 DIN 913

1

CHEESE HEAD TAPPING SCREW

1

M/2 DIN 913

1

CHEESE HEAD TAPPING SCREW

1

M/2 DIN 913

1

CHEESE HEAD TAPPING SCREW

1

M/2 DIN 913

1

CHEESE HEAD TAPPING SCREW

1

M/2 DIN 913

1

CHEESE HEAD TAPPING SCREW

1

M/2 DIN 913

1

CHEESE HEAD TAPPING SCREW

1

M/2 DIN 913

1

CHEESE HEAD TAPPING SCREW

11. EXHAUST

Ref. No.	Part-No.	Description	Required-No.	
			M2	M3 Sport
1	356.1.16.200.0	EXHAUST SILENCER compl.	1	
2	356.1.16.201.2	EXHAUST PIPE	1	
3	349.3.16.014.1	PULL ROD (M7, 295 long)		as req.
4	349.1.16.019.1	GASKET 34/26/2	1	
5	356.1.16.200.2	EXHAUST COVER	1	
6	349.1.16.011.0	DAMPER-INSERT compl. (with part 7)	1	
7	349.1.16.013.1	END PIPE	1	
8	253.1635/07	ASBEST-CORD dia.3x165 long		p.m.
9	349.1.16.018.1	WASHER 16/7,5/3	1	
10	24774	HEXAGON NUT M7 DIN 934	N 2	
10a	900.3266	SPRING WASHER B7 DIN 137	N 1	
16	050.1615	EXHAUST FLANGE GASKET	1	
17	26834	SPRING WASHER B6 DIN 127	N 2	
18	24773	HEXAGON NUT M6 DIN 934	N 2	
21	357.1.16.008.2	EXHAUST BRACKET	1	
22	900.1048	HEXAGON BOLT M8x35 DIN 931-8.8	N 1	
23	26819	SPRING WASHER B8 DIN 127	N 1	
24	900.2108	HEXAGON NUT M8 DIN 934	N 1	
25	24928	HEXAGON HEAD SCREW M6x16 DIN 933	N 1	
26	26834	SPRING WASHER B6 DIN 127	N 1	
27	24773	HEXAGON NUT M6 DIN 934	N 1	

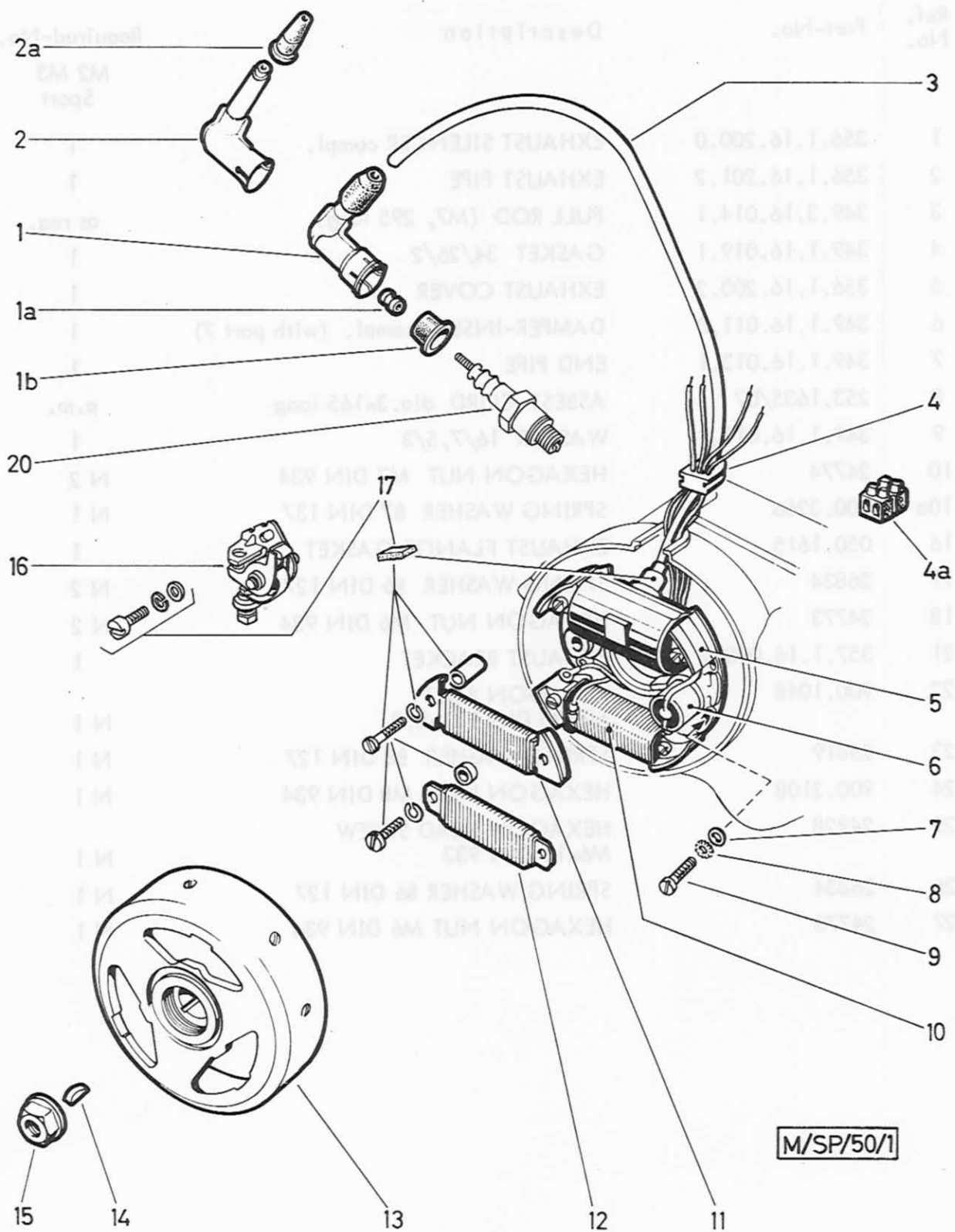

Part M/SP/50/1 - SPORT

11. EXHAUST

Description

Part-No.

Ref.

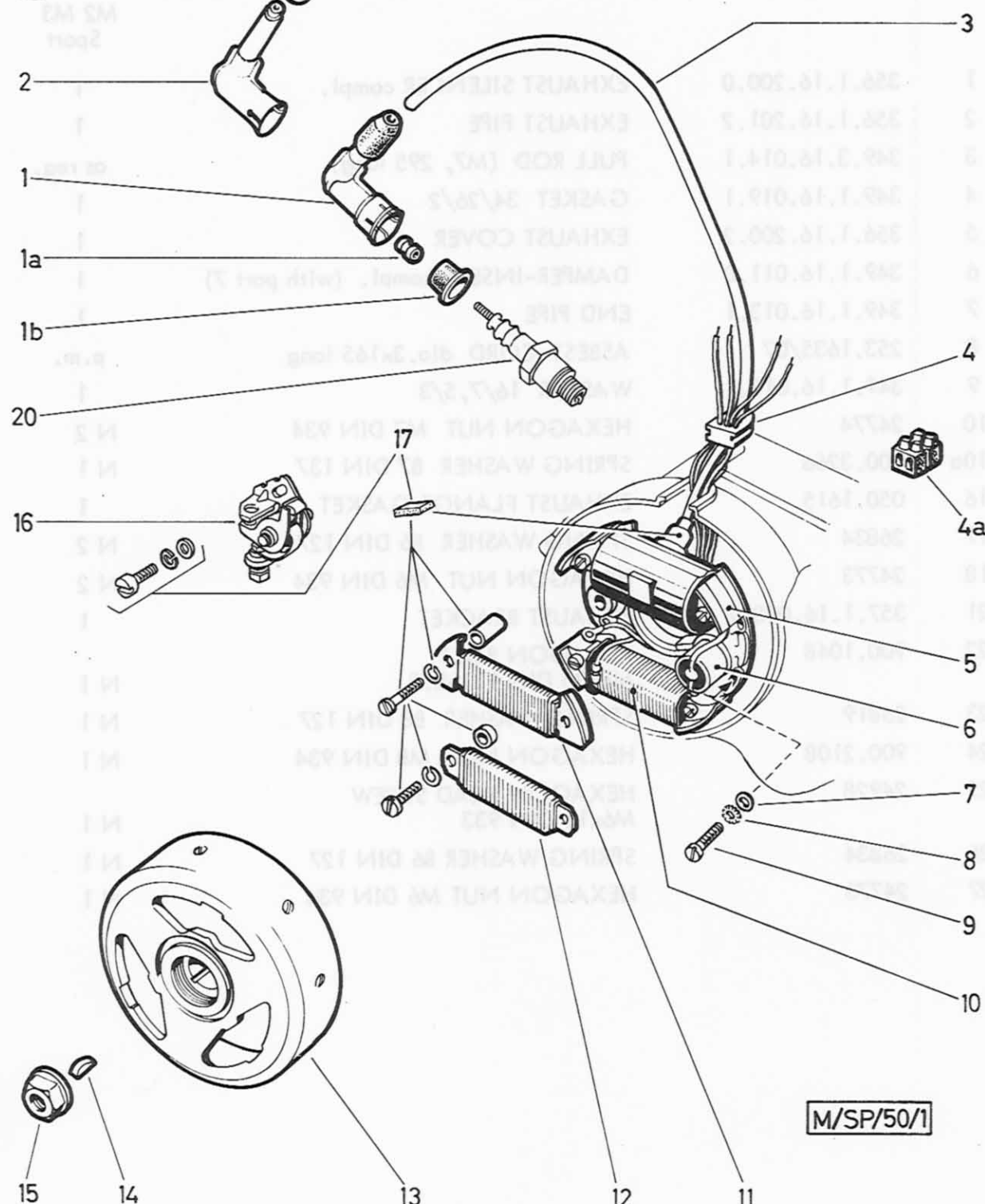

M/SP/50/1

12. GENERATOR

Ref. No.	Part-No.	Description	Required-No.	
			M2	M3 Sport
--	360.5.50.000.0	MAGNETO GENERATOR compl. (Bosch 0 212 122 027) RB1 (L) 6V 17/5W	1	
1	350.8.52.005.0	SUPPRESSOR PLUG (cable plug) Ets. Gabriel		as req.
1a	901.2932	SCREW (M4) (for suppressor plug 350.8.52.005.0)	1	
1b	350.1.52.006.1	SEAL RING	1	
2	350.6.52.005.0	SUPPRESSOR PLUG (cable plug) Ets. Merit		as req.
2a	350.2.52.007.1	CAP for ignition cable gasket outside (for suppressor plug 350.6.52.005.0)	1	
3	050.5207	IGNITION CABLE dia.5 (530mm long)		p.m.
4	352.2.10.010.1	RUBBER SOCKET	1	
4a	51.1.5703	SOFT-RUBBER CLAMPING (two rows)	1	
5	364.4.50.512.2	IGNITION ARMATURE (Bosch 2 204 211 030)	1	
6	500.2.50.013.2	CONDENSER (Bosch 1 237 330 037)	1	
7	901.3941	WASHER 8/4, 2/1	3	
8	900.3253	SERRATED LOCK WASHER J4,3 DIN 6798	N 3	
9	27458	LENS HEAD SCREW AM4x15 DIN 85	N 3	
10	360.2.50.011.2	GENERATOR ARMATURE (Bosch 1 214 210 042)	1	
11	360.5.50.014.2	GENERATOR ARMATURE (Bosch 1 214 210 153)	1	
12	-----	NOT FOR THIS MODEL	-	
13	364.4.50.510.2	FLYWHEEL (Bosch 1 215 254 089)	1	
14	900.4503	WOODRUFF-KEY 3x3,7 DIN 6888	N 1	
15	901.2943	HEXAGON NUT with band M10x1-8G	1	
16	302.3.50.015.0	CONTACT-SET (Bosch 1 217 013 021)	1	
17	360.5.50.017.0	SET OF PARTS compl. (Bosch 1 217 010 007)	1	
20	-----	PLUG please see group cylinder	-	

Parts not identified by a number are not available singly from Messrs. Bosch



CHASSIS

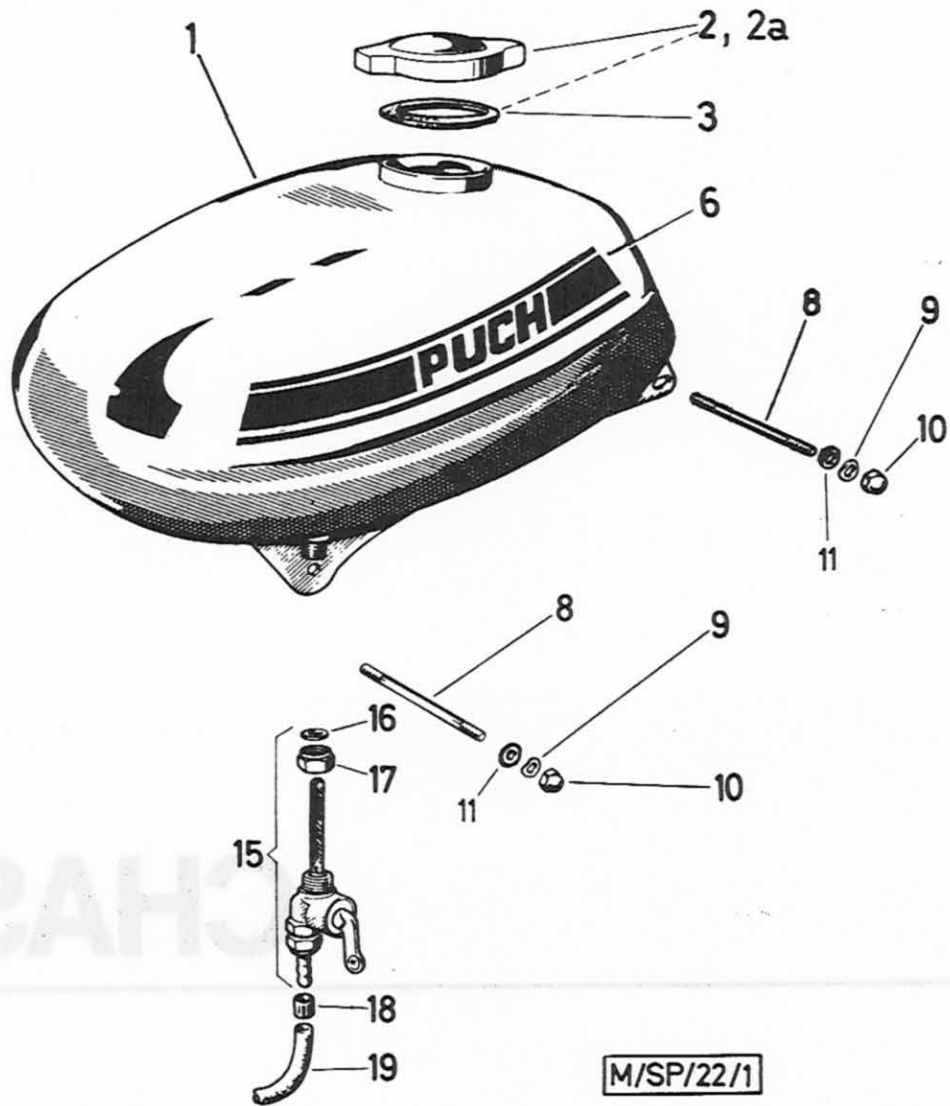

CHASSIS

M/SP/22/1

13. FUEL TANK

Ref. No.	Part-No.	Description	Required-No.	
			M2 M3 Sport	
1	367.7.22.000.2	FUEL TANK	1	
2	170.2220.0	TANK CAP compl. (with oil measure)	as req.	
2a	270.2220.0	TANK CAP compl. (without oil measure)	as req.	
3	27642	SEAL RING (84/60/3,5)	1	
(6)	367.1.22.015.1	NAME-PLATE "PUCH" left	1	
6	367.1.22.016.1	NAME-PLATE "PUCH" right	1	
8	901.1978	THREADED BOLT M6x85 DIN 938	N 2	
9	900.3213	SPRING WASHER B6 DIN 137	N 4	
10	900.2933	DOMED NUT M6 DIN 1587	N 4	
11	28909	WASHER 6,5/14/1	4	
15	350.5.22.030.0	PETROL TAP compl. (Type "KARCO")	1	
16	16636	SEAL RING 14/10,5/1,5	1	
17	27634	CONNECTING NUT M16x1	1	
18	24456	HOSE BUSH	2	
19	900.0902/07	FUEL HOSE dia.9/5, (150 long)	p.m.	

13. FUEL TANK

Required No.

Description

MS M3
Sport

1

as req.

as req.

1

1

1

M 2

M 4

M 4

1

1

1

1

1

1

1

1

1

1

1

1

1

1

1

1

1

1

1

1

1

1

1

1

1

1

1

1

1

1

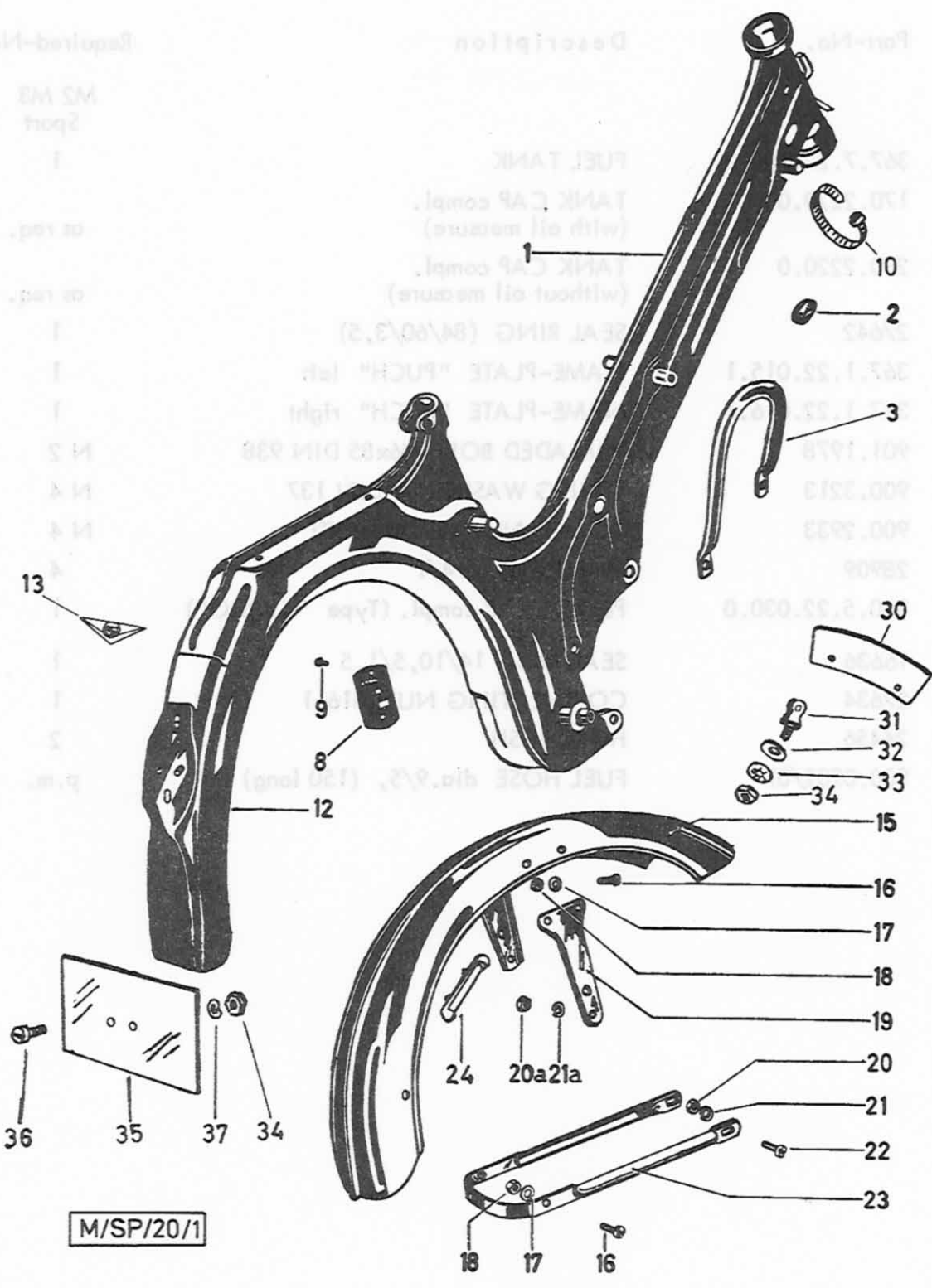

M/SP/20/1

14. FRAME, MUDGUARDS

Ref. No.	Part-No.	Description	Required-No.	
			M2	M3 Sport
1	350.4.20.200.0	FRAME compl. (with pressed in bearing bushes)		1
2	364.2.30.052.1	CABLE SOCKET (black)		3
3	050.2050.2	CARRYING HANDLE		1
8	350.9.20.033.1	NOMENCLATURE PLATE		1
9	900.4052	RIVET A12,6x6 DIN 660	N	2
10	364.1.53.226.1	CABLE BAND (200mm long)		1
12	050.3.2020.2	FRAME END PIECE (not laquered, as required, for repairs)		as req.
13	350.1.20.126.1	TRANSFER PICTURE		1
15	350.3.27.100.2/23	FRONT MUDGUARD (fender) chrome		1
16	1426	CHEESE HEAD SCREW AM5x8 DIN 84	N	6
17	24803	PLAIN WASHER 5,3 DIN 433	N	6
18	900.2105	HEXAGON NUT M5 DIN 555	N	6
19	350.2.27.102.1/23	MUDGUARD HOLDER (chrome)	N	2
20	900.2106	HEXAGON NUT M6 DIN 555	N	2
20a	24774	HEXAGON NUT M7 DIN 934	N	4
21	26834	SPRING WASHER B6 DIN 127	N	2
21a	29189	SPRING WASHER B7 DIN 127	N	4
22	900.1321	CHEESE HEAD SCREW AM6x12 DIN 84	N	2
23	050.2.2712.2/23	MUDGUARD (fender) stay (chrome)		1
24	350.1.27.003.1	BOWDEN CABLE GUIDE		2
30	050.1.2705	LICENSE PLATE front		1
31	050.1.2707.2	LICENSE PLATE BRACKET front		2
32	28909	WASHER (6,5/14/1)		2
33	22804	INTERNAL TOOTHED WASHER J6,4 DIN 6797	N	2
34	900.2106	HEXAGON NUT M6 DIN 555	N	4
35	364.1.27.744.1	LICENSE PLATE rear		1
36	900.1321	CHEESE HEAD SCREW AM6x12 DIN 84	N	2
37	900.3212	CURVED WASHER A6 DIN 137	N	2

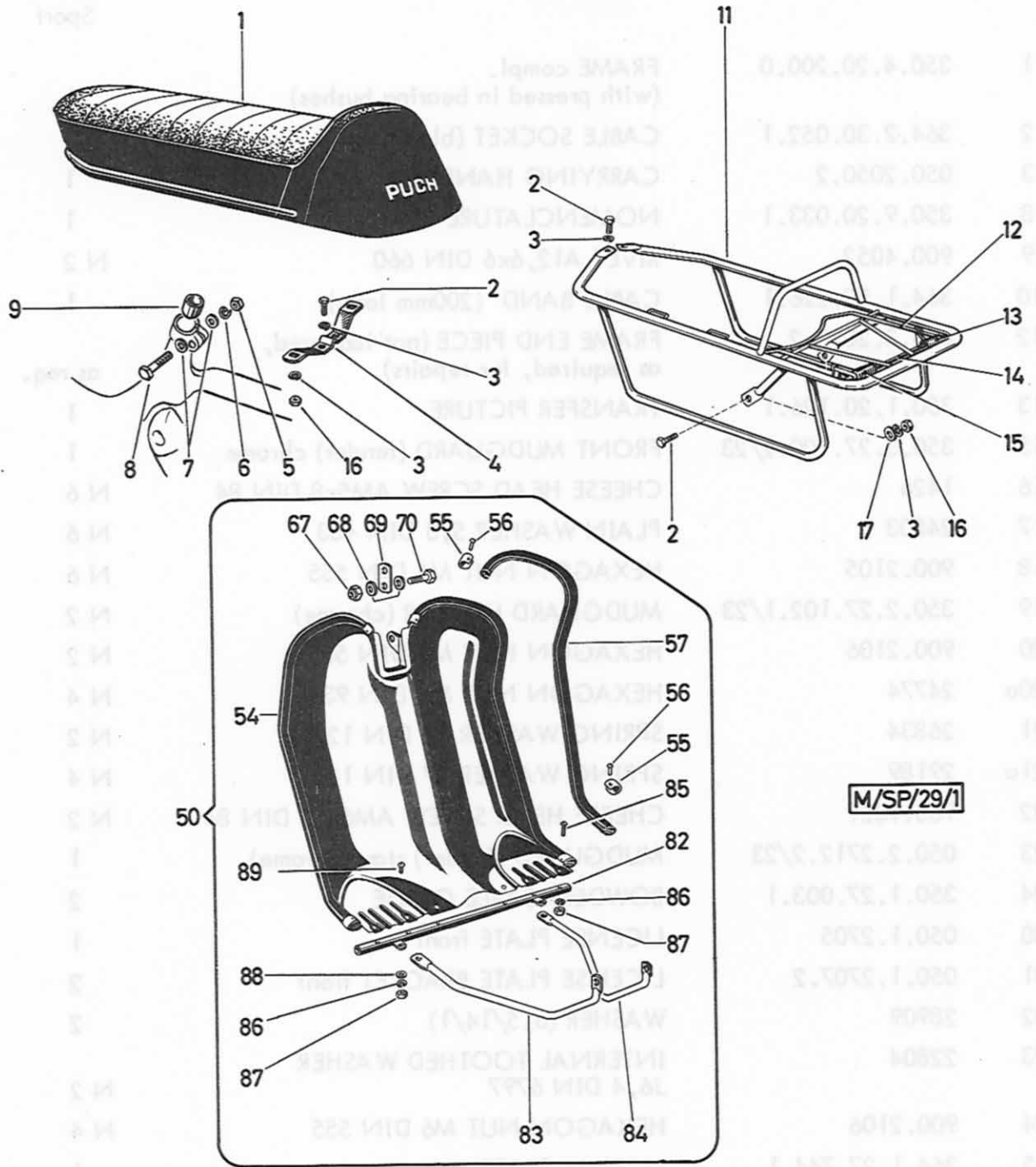

M/SP/29/1

15. SINGLE SEAT, CARRIER, LEGSHIELD,
EQUIPMENT FOR LATER INSTALLATION

Ref. No.	Part-No.	Description	Required-No.	
			M2	M3 Sport
1	360.1.33.000.0	SINGLE SEAT		1
2	24928	HEXAGON SCREW M6x15 DIN 933	N	8
3	26834	SPRING RING B6 DIN 127	N	8
4	367.1.33.001.1	BRACKET for single seat		1
5	900.2108	HEXAGON NUT M8 DIN 555	N	1
6	26819	SPRING RING B8 DIN 127	N	1
7	24806	WASHER 8,4 DIN 433	N	2
8	24858	HEXAGON HEAD SCREW M8x55 DIN 931	N	1
9	53.1.2255	SPACER 40mm long		1
11	360.3.29.220.0	CARRIER compl.		1
12	356.2.29.227.1	SPRING CLIP		1
13	51.1.2926	TORSION SPRING right		1
14	356.2.29.224.1	SPRING CROSS BAR dia.6mmx195 long		1
15	51.1.2925	TORSION SPRING left		1
16	900.2106	HEXAGON NUT M6 DIN 555	N	2
17	24804	WASHER 6,4 DIN 433	N	2
50	350.4.26.010.9	LEGSHIELD EQUIPMENT compl. for later installation, (with parts 54-89)		1
54	350.2.26.010.2	LEGSHIELD (with parts 55-57)		1
55	364.2.26.006.1	END PIECE		4
56	364.1.26.007.1	TUBE RIVET B3x0,5x14		4
57	364.2.26.005.8	EDGING (1550 long)		p.m.
67	900.2966	HEXAGON NUT M6 DIN 985	N	2
68	24795	WASHER 6,4 DIN 125	N	4
69	350.1.26.017.1	STRAP		2
70	24928	HEXAGON HEAD SCREW M6x16 DIN 933	N	2
82	350.1.26.028.2	CROSS TUBE		1
83	350.2.26.021.1	BRACE l.h.s.		1
84	350.2.26.022.1	BRACE r.h.s.		1
85	27157	RAISED CHEESE HEAD SCREW M5x20 DIN 85	N	6
86	29190	SPRING RING B5 DIN 127	N	8
87	24772	HEXAGON NUT M5 DIN 934	N	8
88	24803	WASHER 5,3 DIN 433	N	2
89	25429	RAISED CHEESE HEAD SCREW M5x12 DIN 85	N	2

18. SINGLE SEAT CARRIER LEGSHIELD EQUIPMENT FOR LATER INSTALLATION

Part No.	Description	Qty.
----------	-------------	------

Part No.	Description	Qty.
1	SINGLE SEAT	1
2	HEXAGON SCREW M6x15 DIN 933	2
3	SPRING RING 85 DIN 137	2
4	BRACKET	1
5	HEXAGON NUT M6 DIN 934	2
6	SPRING	2
7	WASHER 2,3 DIN 433	2
8	HEXAGON HEAD SCREW M8x55 DIN 913	1
9	SPACER	1
10	CARTRIDGE	1
11	SPRING CLIP	1
12	SPRING RING	1
13	SPRING CLIP	1
14	SPRING RING	1
15	SPRING RING	1
16	SPRING RING	1
17	SPRING RING	1
18	SPRING RING	1
19	SPRING RING	1
20	SPRING RING	1
21	SPRING RING	1
22	SPRING RING	1
23	SPRING RING	1
24	SPRING RING	1
25	SPRING RING	1
26	SPRING RING	1
27	SPRING RING	1
28	SPRING RING	1
29	SPRING RING	1
30	SPRING RING	1
31	SPRING RING	1
32	SPRING RING	1
33	SPRING RING	1
34	SPRING RING	1
35	SPRING RING	1
36	SPRING RING	1
37	SPRING RING	1
38	SPRING RING	1
39	SPRING RING	1
40	SPRING RING	1
41	SPRING RING	1
42	SPRING RING	1
43	SPRING RING	1
44	SPRING RING	1
45	SPRING RING	1
46	SPRING RING	1
47	SPRING RING	1
48	SPRING RING	1
49	SPRING RING	1
50	SPRING RING	1
51	SPRING RING	1
52	SPRING RING	1
53	SPRING RING	1
54	SPRING RING	1
55	SPRING RING	1
56	SPRING RING	1
57	SPRING RING	1
58	SPRING RING	1
59	SPRING RING	1
60	SPRING RING	1
61	SPRING RING	1
62	SPRING RING	1
63	SPRING RING	1
64	SPRING RING	1
65	SPRING RING	1
66	SPRING RING	1
67	SPRING RING	1
68	SPRING RING	1
69	SPRING RING	1
70	SPRING RING	1
71	SPRING RING	1
72	SPRING RING	1
73	SPRING RING	1
74	SPRING RING	1
75	SPRING RING	1
76	SPRING RING	1
77	SPRING RING	1
78	SPRING RING	1
79	SPRING RING	1
80	SPRING RING	1
81	SPRING RING	1
82	SPRING RING	1
83	SPRING RING	1
84	SPRING RING	1
85	SPRING RING	1
86	SPRING RING	1
87	SPRING RING	1
88	SPRING RING	1
89	SPRING RING	1
90	SPRING RING	1
91	SPRING RING	1
92	SPRING RING	1
93	SPRING RING	1
94	SPRING RING	1
95	SPRING RING	1
96	SPRING RING	1
97	SPRING RING	1
98	SPRING RING	1
99	SPRING RING	1
100	SPRING RING	1

M/SP/25/1

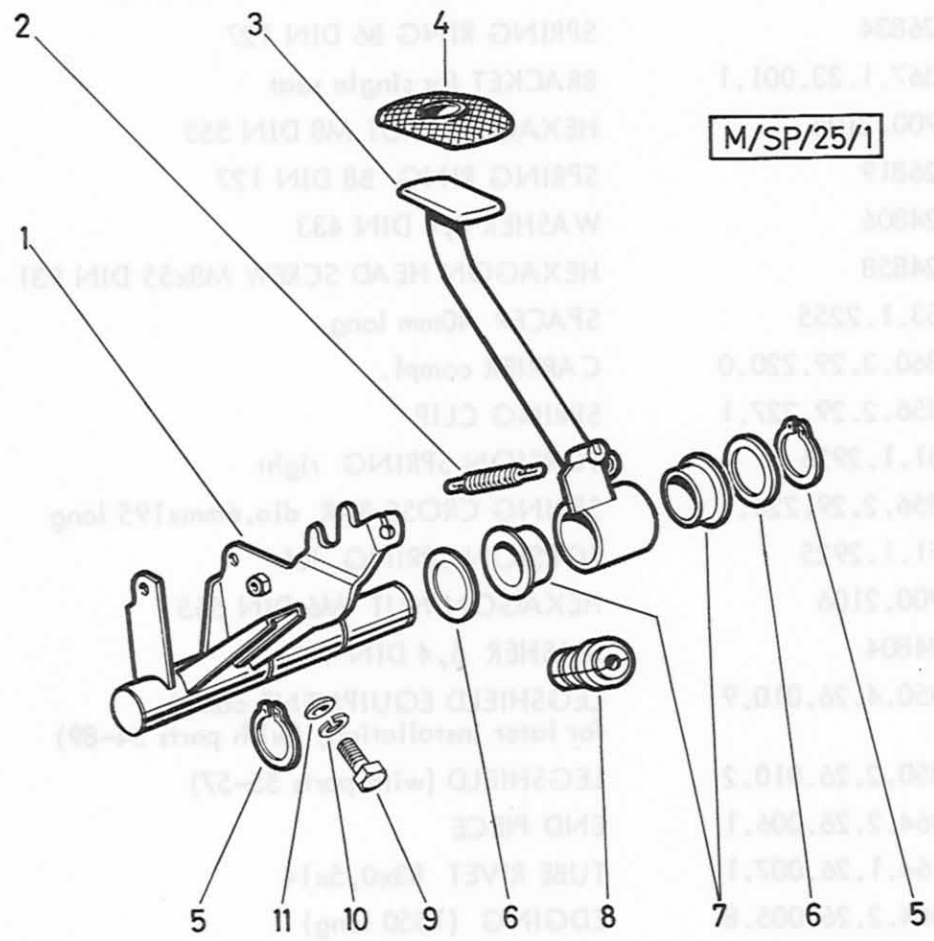

16. BRAKE LEVER SUPPORT, BRAKE PEDAL

Ref. No.	Part-No.	Description	Required-No.	
			M2	M3 Sport
1	352.1.26.230.2	BRAKE LEVER SUPPORT	1	
2	357.1.25.009.1	BRAKE SPRING	1	
3	352.2.25.201.0	BRAKE PEDAL LEVER compl. (with part 4 and 7)	1	
4	101.1.2512	PEDAL RUBBER	1	
5	900.4625	CIRCLIP Sg 25x1,2 DIN 471	N 2	
6	368.1.14.008.1	THRUST WASHER 34/25/1,5	2	
7	368.1.14.009.1	BEARING BUSH	2	
8	357.1.55.020.1	BRAKE STOP	2	
9	900.1144	HEXAGON HEAD SCREW M8x15 DIN 933-8G	N 1	
10	26819	SPRING RING B8 DIN 127	N 1	
11	24806	WASHER 8,4 DIN 433	N 1	

16. BRAKE LEVER SUPPORT, BRAKE PEDAL

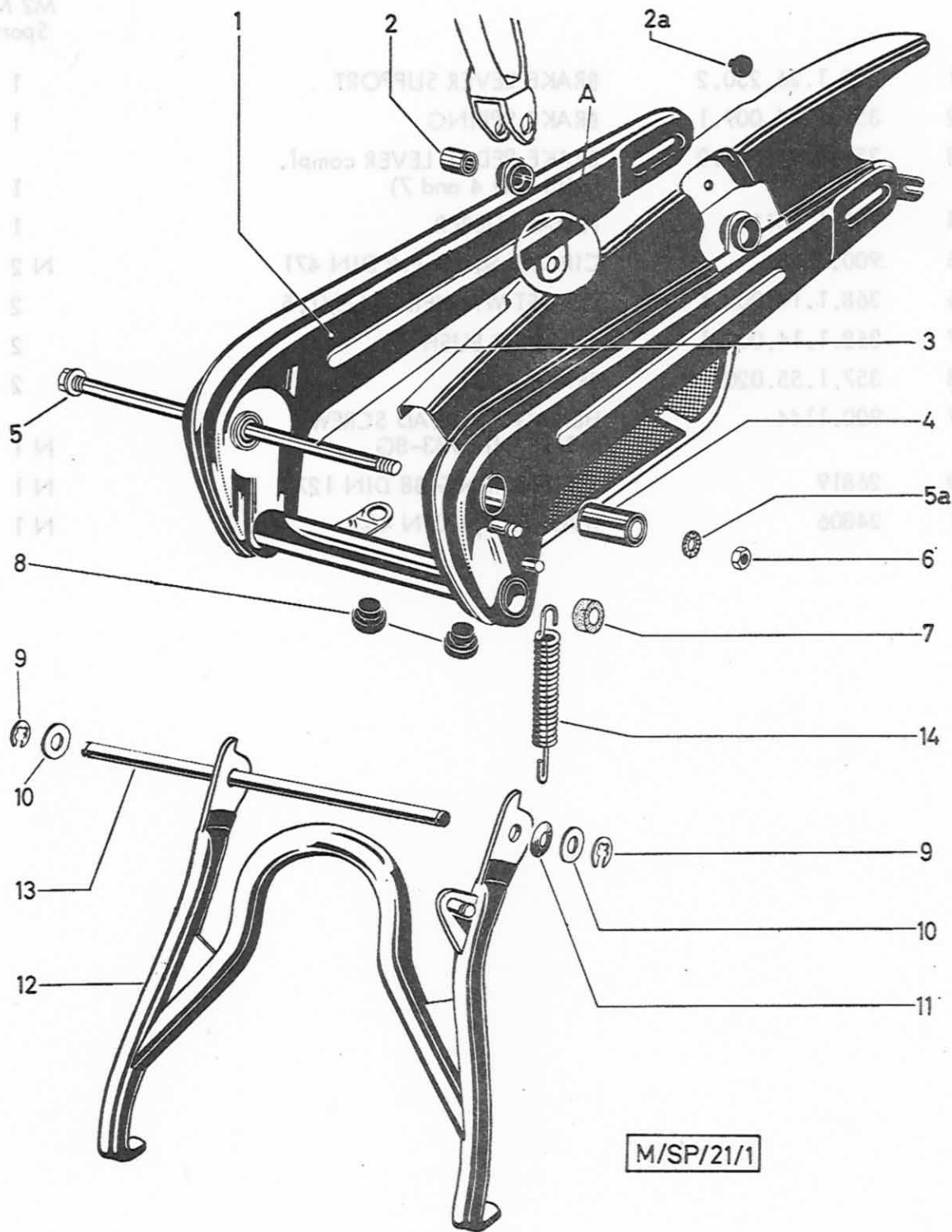

17. PIVOTED FORK, PROP STAND

Ref. No.	Part-No.	Description	Required-No.		
			M2	M3	Sport
1	050.3.2100.0	PIVOTED FORK compl. (with pressed-in silent blocks) (with pin for spring sticking l.h.s.) (with part A)			1
2	128.2315	SILENT BLOCK (for shock absorber) 16/8/17			2
2a	050.1.2122	RUBBER BASE for chain guard			1
3	050.2.2110.2	PIVOTED FORK SPINDLE, 200 long			1
4	050.2111.2	SILENT BLOCK (for pivoted fork bearing) 22/10/33			2
5	24807	WASHER 10,5 DIN 433	N		1
5a	900.3262	SERRATED LOCK WASHER A10,5 DIN 6798		N	1
6	24789	HEXAGON NUT M10x1 DIN 934	N		1
7	350.2.21.014.1	PROP STAND BEARING BUSHING 17,2/10,2/10			2
8	050.1.2123	RUBBER BUFFER for prop stand stop			2
9	900.4609	CIRCLIP 9 DIN 6799		N	2
10	14778	WASHER 21/10,5/1			2
11	100.1.1235	SPRING WASHER			1
12	350.4.24.000.2	CENTER PROP STAND (with pin for spring sticking l.h.s.)			1
13	350.1.24.013.1	PROP STAND BEARING AXLE dia.10mm, 199 long			1
14	050.1.2410	PROP STAND SPRING			1

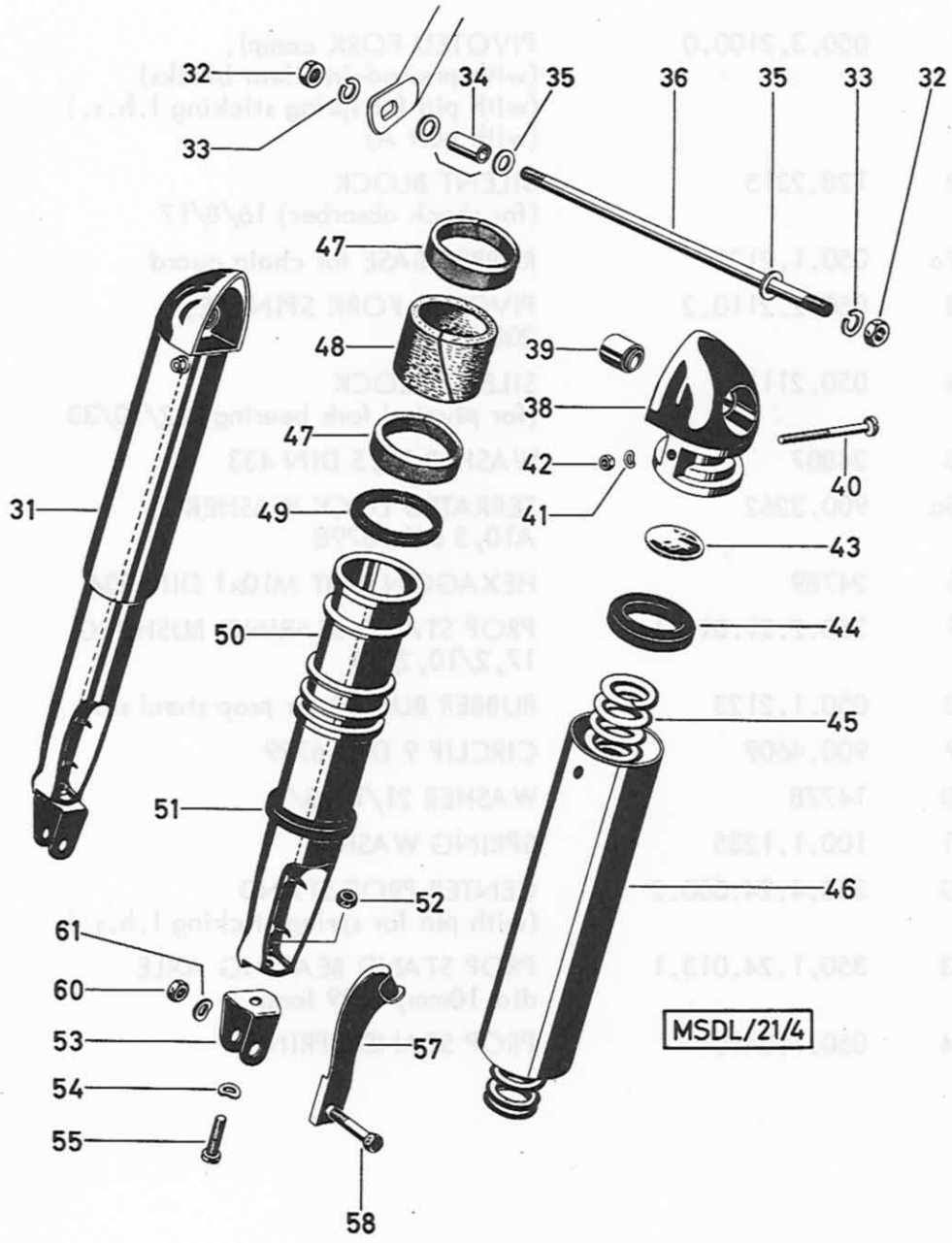

17. PIVOTED FORK, PROP STAND

Part No. - SPORT

Part No.

Description

Part No.

Part No.

MS M3

18. SHOCK ABSORBER

Ref. No.	Part-No.	Description	Required-No.	
			M2	M3 Sport
31	050.5.2129.0	SHOCK ABSORBER left, compl. (with parts 38÷55)	1	
31	050.5.2130.0	SHOCK ABSORBER right, compl. (with parts 38÷55)	1	
32	24775	HEXAGON NUT M8 DIN 934	N 2	
33	26819	SPRING RING B8 DIN 127	N 2	
35	24806	WASHER 8,4 DIN 433	N 2	
36	050.2.2113	BOLT (M8, 172 long)	1	
38	364.1.21.032.1	STRUT HEAD	2	
39	128.2315	SILENT BLOCK dia.16mm, 17 long	2	
40	900.1522	LENS HEAD SCREW M5x50 DIN 85	N 2	
41	900.3205	SPRING WASHER A5 DIN 137	N 2	
42	24772	HEXAGON NUT M5 DIN 934	N 2	
43	050.5.2136	CLOSURE WASHER dia.27mm	2	
44	050.5.2133	BUFFER RING (rubber 43/29, 5/8)	2	
45	050.5.2134	THRUST SPRING, 200 long, size of wire dia.5mm	2	
46	050.5.2131	SLIDING TUBE (dia.45mm, 145 long)	2	
47	050.5.2141	GUIDE BUSHING (plastic 43/37, 5/9)	4	
48	050.5.2139	GREASE FELT 126, 5x27x3	2	
49	050.5.2143	FELT WASHER 112 long	2	
50	050.5.2140	LOWER SLIDING TUBE	2	
51	050.5.2138	STOP RING 41/34/6	2	
52	24773	HEXAGON NUT M6 DIN 934	N 2	
53	050.5.2137	SUPPORTING BRACKET	2	
54	900.3213	SPRING WASHER B6 DIN 137	N 2	
or	22804	TOOTHED LOCK WASHER J6,4 DIN 6797	N 2	
55	900.1309	FILLISTER HEAD SCREW M6x15 DIN 84	N 2	
or	24928	HEXAGON HEAD SCREW M6x15 DIN 933	N 2	

18. SHOCK ABSORBER (cont.)

Ref. No.	Part-No.	Description	Required-No.	
			M2	M3 Sport
57	350.1.25.017.1	HOLDER for brake control cable	1	
58	24477	HEXAGON HEAD SCREW M8x32 DIN 931	N 2	
60	900.2016	HEXAGON NUT M8 DIN 934	N 2	
61	900.3211	SPRING WASHER B8 DIN 137	N 2	
		SPRING RING B8 DIN 137		
		WASHER B 4 DIN 433		
		BOLT (M8, 175 long)		
		STRUT HEAD		
		SILENT BLOCK		
		dia. 16mm, 17 long		
		LENS HEAD SCREW		
		M2x50 DIN 82		
		SPRING WASHER A8 DIN 137		
		HEXAGON NUT M8 DIN 934		
		CLOSURE WASHER dia. 27mm		
		RUBBER RING		
		(rubber 43,29, 2,8)		
		THRUST SPRING, 200 long, size of wire dia. 2mm		
		SLIDING TUBE		
		(dia. 42mm, 142 long)		
		GUIDE BUSHING		
		(plastic 43,37, 2,9)		
		GREASE FELT 138, 2x37x3		
		FELT WASHER 112 long		
		LOWER SLIDING TUBE		
		STOP RING 41,24x2		
		HEXAGON NUT M8 DIN 934		
		SUPPORTING BRACKET		
		SPRING WASHER B8 DIN 137		
		TOOTHED LOCK WASHER		
		J6, 4 DIN 6797		
		FILISTER HEAD SCREW		
		M6x12 DIN 84		
		HEXAGON HEAD SCREW		
		M6x12 DIN 931		

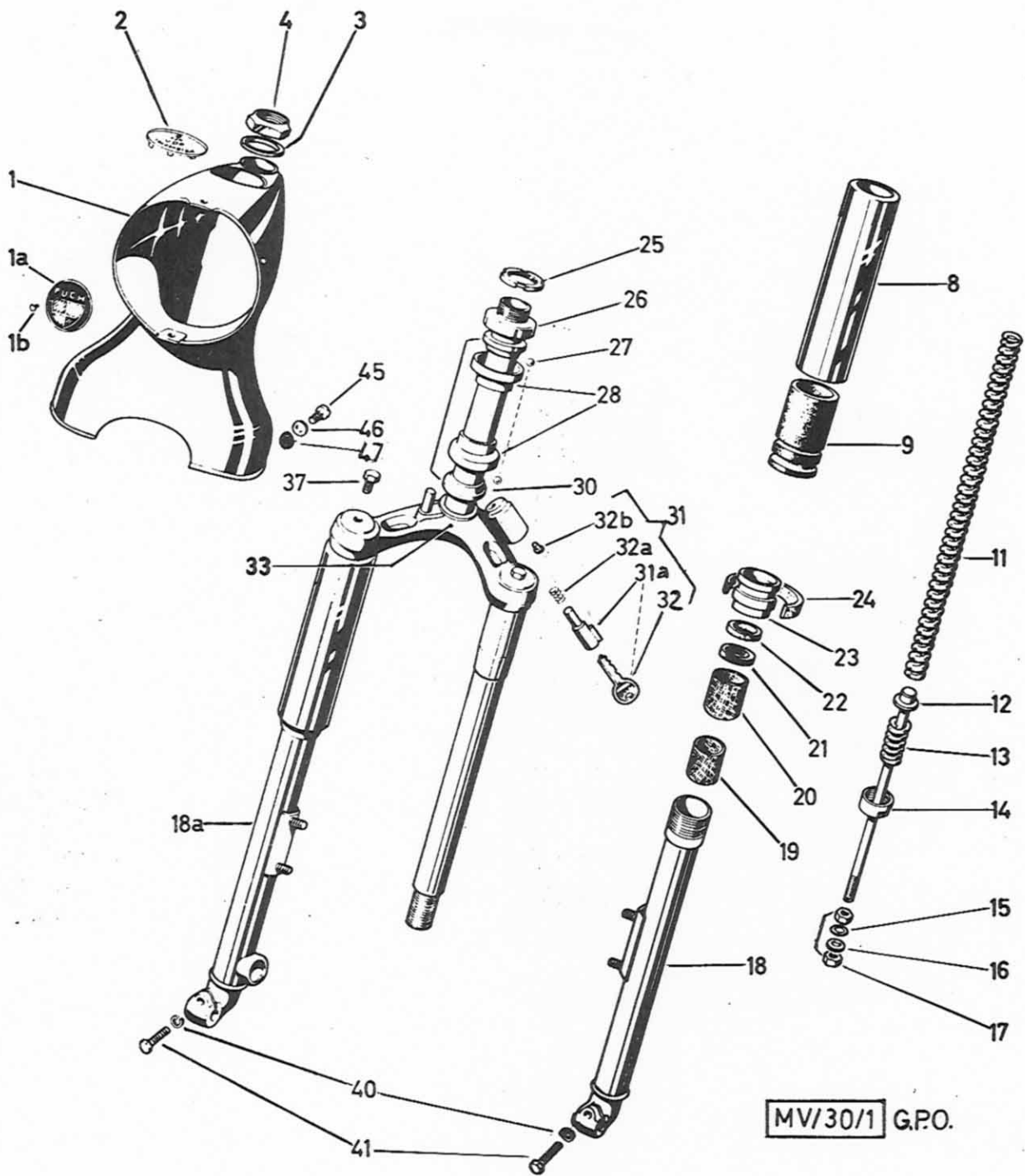

MV/30/1 G.P.O.

19. FRONT FORK WITH STEERING

Ref. No.	Part-No.	Description	Required-No.	
			M2	M3 Sport
--	352.3.30.300.0	FRONT FORK compl.		1
1	350.6.30.043.2	HEAD-LAMP CARRIER		1
1a	050.5.3046	NAME PLATE "PUCH" - neutral		1
1b	900.4027	Al-ROUND HEAD RIVET Ø2,6x5 DIN 660	N 2	
2	050.3045	HANDLEBAR for opening the tacho		as req.
3	050.3033	CONNECTING WASHER		1
4	3759	FORK TUBE NUT		1
8	050.4.3037	OUTER TUBE		2
9	050.4.3036	RUBBER BUFFER 40,5/28,5/55		2
11	350.1.30.134.1	SPRING (Ø14x263 long)		2
12	350.2.30.130.1	SPRING ROD (134 long)		2
13	350.1.30.131.1	THRUST SPRING		2
14	360.1.30.110.1	LOWER CAP		2
15	900.3883	GASKET RS 6-9-1,5		2
16	24804	WASHER 6,4 DIN 433	N 4	
17	900.2106	HEXAGON NUT M6 DIN 555	N 4	
18	050.4.3015.2	FORK SLIDER l.h.s., Ø30x240		1
18a	050.4.3016.2	FORK SLIDER r.h.s., Ø30x240		1
19	050.4.3009	LOWER GUIDE BUSH 28/23/26		2
20	050.4.3026	TOP GUIDE BUSH 29,5/25/26		2
21	050.4.3029	RUBBER SLEEVE (average dia. 29mm)		2
22	050.4.3049	FELT RING 32,5/25/6		2
23	360.1.30.127.1	GROOVED BUSH		2
24	050.4.3039	FELT STRIP 12x2,5x122		2
25	250.3104	SLOTTED CIRCULAR NUT		2
26	25222	DUST PROTECTOR		1
27	25226	BALL Ø5		42
28	25221	BALL SLEEVE		2
30	25220	TAPERED RING		2
31	330.1.20.052.0/10	LOCK compl. (Neiman II) with tension spring and Al-notched rivet		as req.
31a	330.1.20.052.0	LOCK compl. (Neiman II) (with 2 keys)		as req.
32	350.2.30.023.1	SPARE KEY (please quote key-number !)		-
32a	330.1.20.059.1	TENSION SPRING		1

19. FRONT FORK WITH STEERING (cont.)

Ref. No.	Part-No.	Description	Required-No.		
			M2	M3	Sport
32b	330.1.20.060.1	AL-NOTCHED RIVET		1	
33	360.1.30.106.2	FORK YOKE		1	
37	901.1097	HEXAGON SCREW M6x8 DIN 933-8G		N 2	
40	29189	SPRING RING B7 DIN 127		N 2	
41	900.1128	HEXAGON SCREW M7x20 DIN 933		N 2	
45	900.1513	LENS HEAD SCREW M5x10 DIN 85		N 2	
46	24803	WASHER 5,3 DIN 433		N 2	
47	21526	FIBRE GASKET 9/5,3/1		2	
		RUBBER BUFFER 40,5/28,5/25		9	
		SPRING (B14x203 long)		11	
		SPRING ROD (104 long)		12	
		THRUST SPRING		13	
		LOWER CAP		14	
		GASKET RS 4-9-1,5		15	
		WASHER 6,4 DIN 433		16	
		HEXAGON NUT M6 DIN 933		17	
		FORK SLIDER L.R., 830x240		18	
		FORK SLIDER R.R., 830x240		18	
		LOWER GUIDE BUSH 28x32x26		19	
		TOP GUIDE BUSH 27,5x25x26		20	
		RUBBER SLEEVE (average dia. 29mm)		21	
		FELT RING 32,5x25x6		22	
		GROOVED BUSH		23	
		FELT STRIP 12x2,5x122		24	
		SLOTTED CIRCULAR NUT		25	
		DUST PROTECTOR		26	
		BALL RS		27	
		BALL SLEEVE		28	
		TAPERED RING		29	
		LOCK COMPL. (Nelson II) with tension spring and Al-notched rivet		30	
		LOCK COMPL. (Nelson II) (with 2 keys)		31	
		SPARE KEY (please quote key-number !)		32	
		TENSION SPRING		33	

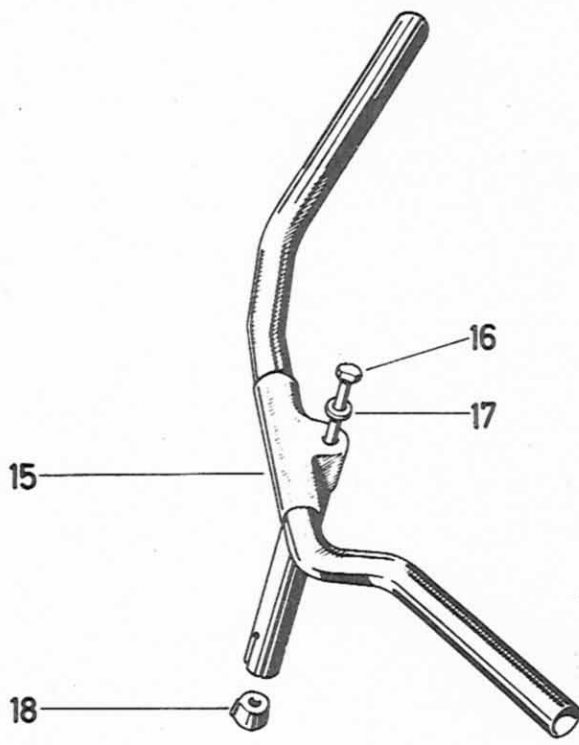
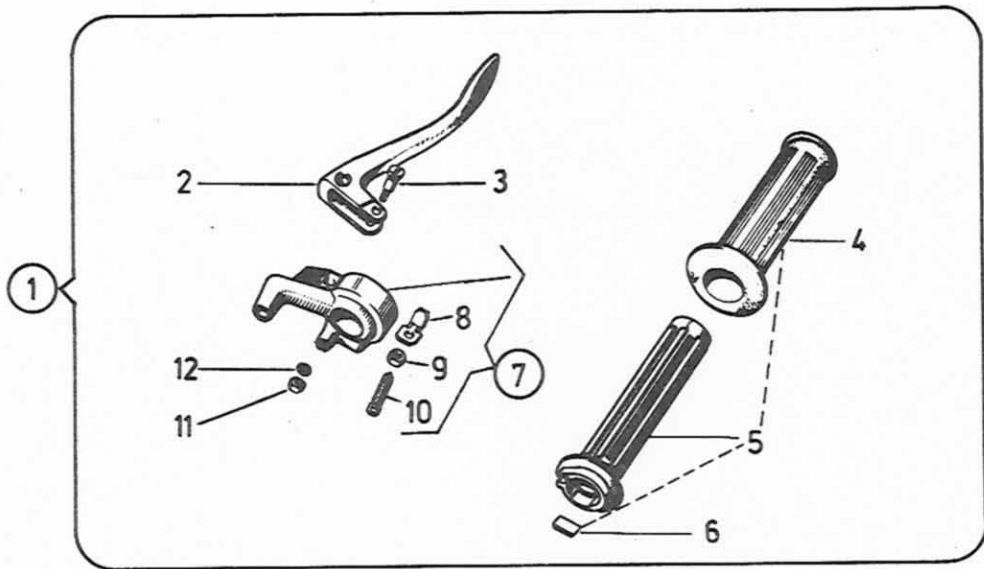

M/SP/32/1

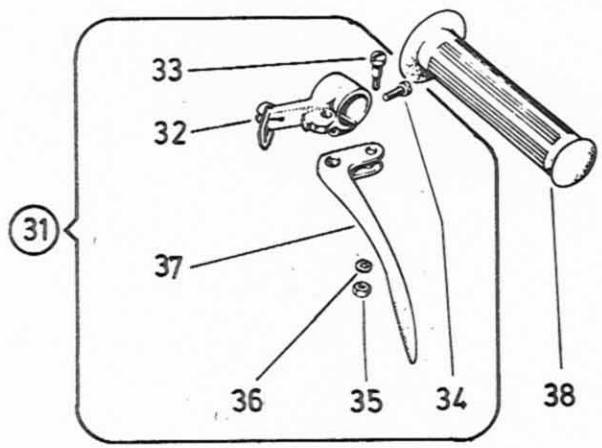

20. HANDLEBAR, CLUTCH LEVER,
THROTTLE TWIST GRIPS

Ref. No.	Part-No.	Description	Required-No.	
			M2	M3
1	350.2.32.005.0	THROTTLE TWIST GRIP compl. (with parts 2 ÷ 12)	Sport	1
2	050.2.3228	BRAKE LEVER		1
3	050.3227	LEVER BOLT (M5)		1
4	360.2.32.016.1	TWIST GRIP COVER (black)		2
5	350.2.32.126.0	THROTTLE TWIST GRIP ROTOR SLEEVE compl. (with part 4 and 6)		1
6	349.1.32.009.1	TENSION SPRING		1
7	350.2.32.121.0	HOUSING FOR THROTTLE TWIST GRIP compl. (with parts 8 ÷ 10)		1
8	350.1.32.113.1	RETAINING ANGLE		2
9	350.1.32.112.1	HEXAGON NUT (M6)		2
10	350.2.32.111.1	HEXAGON PIN (M6)		1
11	24772	HEXAGON NUT M5 DIN 934	N	2
12	22803	TOOTHED LOCK WASHER J5,3 DIN 6797	N	2
15	350.1.32.100.2	HANDLEBAR		1
16	050.1.3251	CLAMPING SPINDLE (M8x1) 200 long		1
17	186	WASHER 20/8,4/3,5		1
18	600.1.32.022.1	CLAMP WEDGE		1
31	350.3.32.017.0	CLUTCH LEVER compl. (with clip) (with parts 32 - 37)		1
32	357.3.32.018.2	PIVOT BRACKET (with clip)		1
33	050.3227	LEVER SCREW (M5)		1
34	050.3222	LENS HEAD SCREW (M6x15)		1
35	24772	HEXAGON NUT M5 DIN 934	N	1
36	22803	TOOTHED WASHER J5,3 DIN 6797	N	1
37	357.1.32.017.1	HAND LEVER for clutch		1
38	350.3.32.016.1	DUMMY RUBBER dia.22mm, black		1

30, HANDLEBAR, CLUTCH LEVER,
THROTTLE TWIST GRIP

Part No.

Description

Qty

M/S MS

Sport

THROTTLE TWIST GRIP, compl. (with part 2 + 13)

BRAKE LEVER

LEVER BOLT (M6)

THROTTLE TWIST GRIP COVER (M6)

THROTTLE TWIST GRIP COVER (M6)

INSIDE SPRING FOR THROTTLE TWIST GRIP

INSIDE SPRING FOR THROTTLE TWIST GRIP

INSIDE SPRING FOR THROTTLE TWIST GRIP

INSIDE SPRING FOR THROTTLE TWIST GRIP

INSIDE SPRING FOR THROTTLE TWIST GRIP

INSIDE SPRING FOR THROTTLE TWIST GRIP

INSIDE SPRING FOR THROTTLE TWIST GRIP

INSIDE SPRING FOR THROTTLE TWIST GRIP

INSIDE SPRING FOR THROTTLE TWIST GRIP

INSIDE SPRING FOR THROTTLE TWIST GRIP

INSIDE SPRING FOR THROTTLE TWIST GRIP

INSIDE SPRING FOR THROTTLE TWIST GRIP

INSIDE SPRING FOR THROTTLE TWIST GRIP

INSIDE SPRING FOR THROTTLE TWIST GRIP

INSIDE SPRING FOR THROTTLE TWIST GRIP

INSIDE SPRING FOR THROTTLE TWIST GRIP

INSIDE SPRING FOR THROTTLE TWIST GRIP

INSIDE SPRING FOR THROTTLE TWIST GRIP

INSIDE SPRING FOR THROTTLE TWIST GRIP

INSIDE SPRING FOR THROTTLE TWIST GRIP

INSIDE SPRING FOR THROTTLE TWIST GRIP

INSIDE SPRING FOR THROTTLE TWIST GRIP

INSIDE SPRING FOR THROTTLE TWIST GRIP

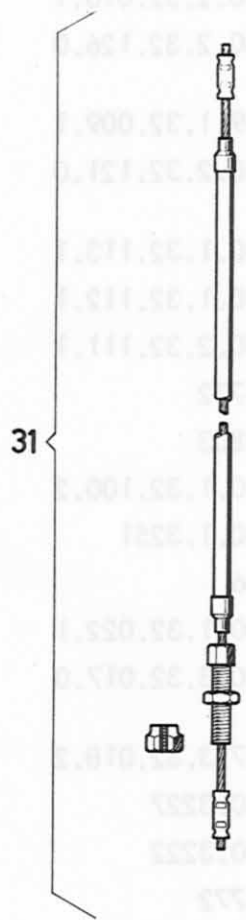
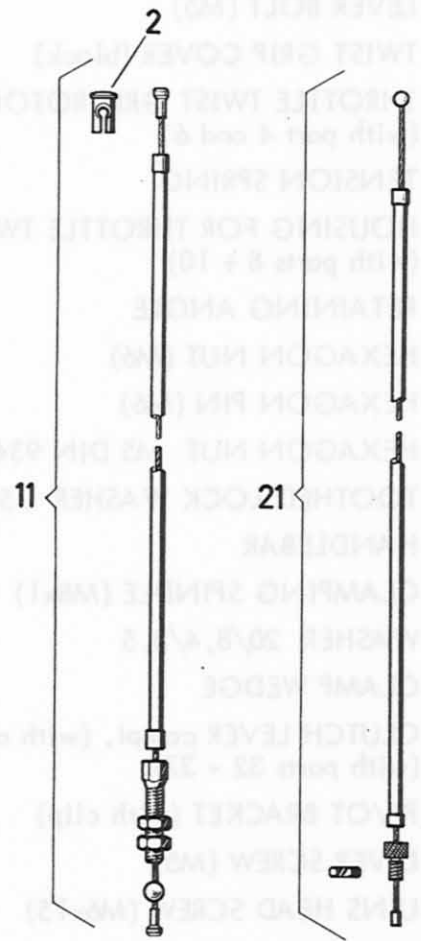
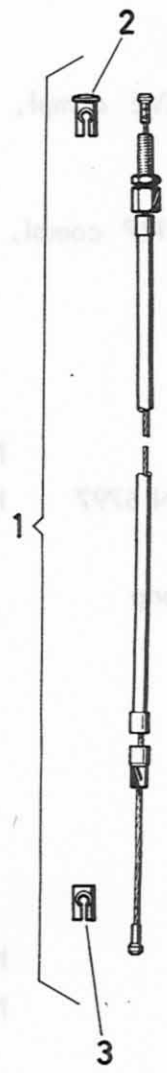

M/SP/60/1

21. BOWDEN CABLES

Ref. No.	Part-No.	Description	Required-No.		
			M2	M3	Sport
1	350.5.62.100.0	CLUTCH CONTROL CABLE compl. (wire 1170/cover 1070) (replaceable by 910.2.03.001.0)		1	
2	050.1.3208	NIPPLE HOLDER		2	
3	250.6208	NIPPLE HOLDER slotted		1	
11	364.4.63.100.0	BRAKE CONTROL CABLE compl. for front wheel (wire 1120/cover 995) (replaceable by 910.3.09.002.0)		1	
21	360.1.65.500.0	CARBURETTOR CONTROL CABLE compl. (wire 890/cover 760) (replaceable by 910.5.07.002.2)		1	
31	367.1.25.200.0	BRAKE CONTROL CABLE compl. for rear wheel (wire 613/cover 335) (replaceable by 910.8.03.001.2)		1	

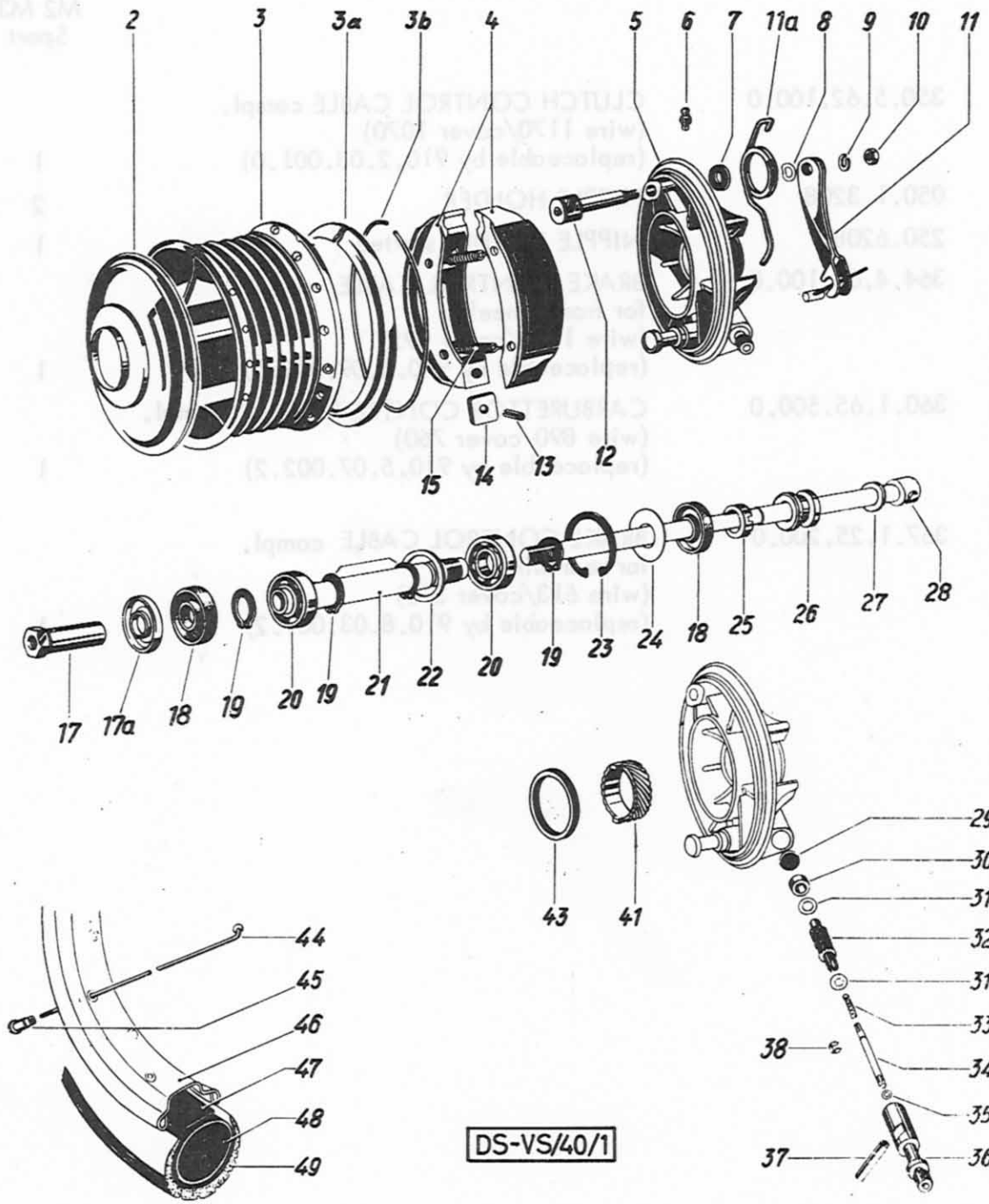

DS-VS/40/1

22. FRONT WHEEL WITH SPEEDOMETER DRIVE

Ref. No.	Part-No.	Description	Required-No.		
			M2	M3	Sport
--	360.3.40.000.0	FRONT WHEEL compl. (without tyre)		1	
--	050.4.4002.0	FRONT WHEEL HUB compl. (with fitting-parts)		1	
2	350.1.40.040.1	COVER		1	
3	050.4.4104	BRAKE HUB		1	
3a	350.1.41.042.1	PROTECTION RING dia.129,5mm		1	
3b	050.10.1074	CLIP RING		1	
4	050.4.4015.0	PAIR OF BRAKE SHOES with glued-on lining		1	
--	360.2.40.007.0	BRAKE PLATE compl. with speedometer drive		1	
5	360.2.40.007.2	BRAKE PLATE without speedometer drive		1	
(6)	360.1.40.011.1	LUBRICATION NIPPLE (plastic) (for brake plate without thread)		1	
7	128.2504	SEAL RING 20/12/3 (rubber)		1	
8	900.3219	SPRING WASHER 21/12,5/0,2		1	
9	26819	SPRING RING B8 DIN 127		N 1	
10	26820	HEXAGON NUT M8x1 DIN 934		N 1	
11	050.5.4013.2	BRAKE LEVER 78 long		1	
11a	350.4.41.015.1	RETURN SPRING		1	
12	360.2.40.009.2	BRAKE CAM 66 long		1	
13	900.4812	TENSION SLEEVE 4x10 DIN 1481		N 2	
14	050.4.4016	SLIDE PLATE 3,5 thick		2	
14	050.4.4016.3	SLIDE PLATE 4 thick (for repair)		-	
15	050.4.4019	BRAKE SHOE SPRING 50 long		2	
17	050.4.4027	AXLE NUT (M10x1)		1	
17a	360.1.40.046.1	COVER DISC		1	
18	050.4.4025.0	SEAL RING 32/15/5,5		2	
19	900.4619	CLIP RING Sg 15x1 DIN 471		N 4	
20	900.6002	BALL BEARING 32/15/9D 6002 DIN 625		N 2	
21	360.1.40.023.1	SPACER TUBE (threaded and turned down for press ring)		1	
22	050.4.4022	THRUST WASHER 32/25/1,5		1	
23	900.4732	CLIP RING Sg 32x1,2 DIN 472		N 1	
24	050.4.4039	WASHER 32/15,5/0,5		1	
25	050.4.4041	SLOTTED NUT M14x1		1	

22. FRONT WHEEL WITH SPEEDOMETER DRIVE (cont.)

Ref. No.	Part-No.	Description	Required-No.	
			M2	M3 Sport
26	050.5.4043	PRESSURE RING 20/12,5/9	1	
27	050.1.4029	WASHER 18/10,5/2,5	1	
28	364.4.40.026.1	FRONT WHEEL AXLE 173 long	1	

PARTS FOR SPEEDOMETER DRIVE

29	050.4.4067	WASHER dia.13,5mm (plastic)	1	
30	050.4.4066	BUSH 14/8/7	1	
31	050.4.4065	THRUST WASHER 13/8/0,3	2	
32	050.4.4061	SPEEDOMETER WHEEL driving (12 teeth) dia.13,1mm	1	
33	050.4.4068	TENSION SPRING 14 long	1	
34	050.4.4058	DRIVING SHAFT 40 long	1	
35	900.3961	THRUST WASHER 7,5/4/0,3	1	
36	050.4.4063	CONNECTING PIECE	1	
37	900.4815	SLOTTED HOLLOW PIN 5x25 DIN 1481	N	1
38	900.4603	BZ-WASHER 3,2 DIN 6799	N	1
41	360.2.40.060.1	SPEEDOMETER WHEEL driving (22 teeth)	1	
43	050.4.4042	SEAL RING 48/37/4,5	1	
44	365.1.40.030.1	SPOKE dia.2,65mmx208mm	36	
45	365.1.40.031.1	NIPPLE M3	36	
46	350.5.40.033.1	RIM 19"	1	
47	901.0866	RIM LINING 19"	1	
48	900.0843	AIR HOSE 23" - 2,25"	1	
49	900.0841/30	TYRE 23" - 2,25" black	1	

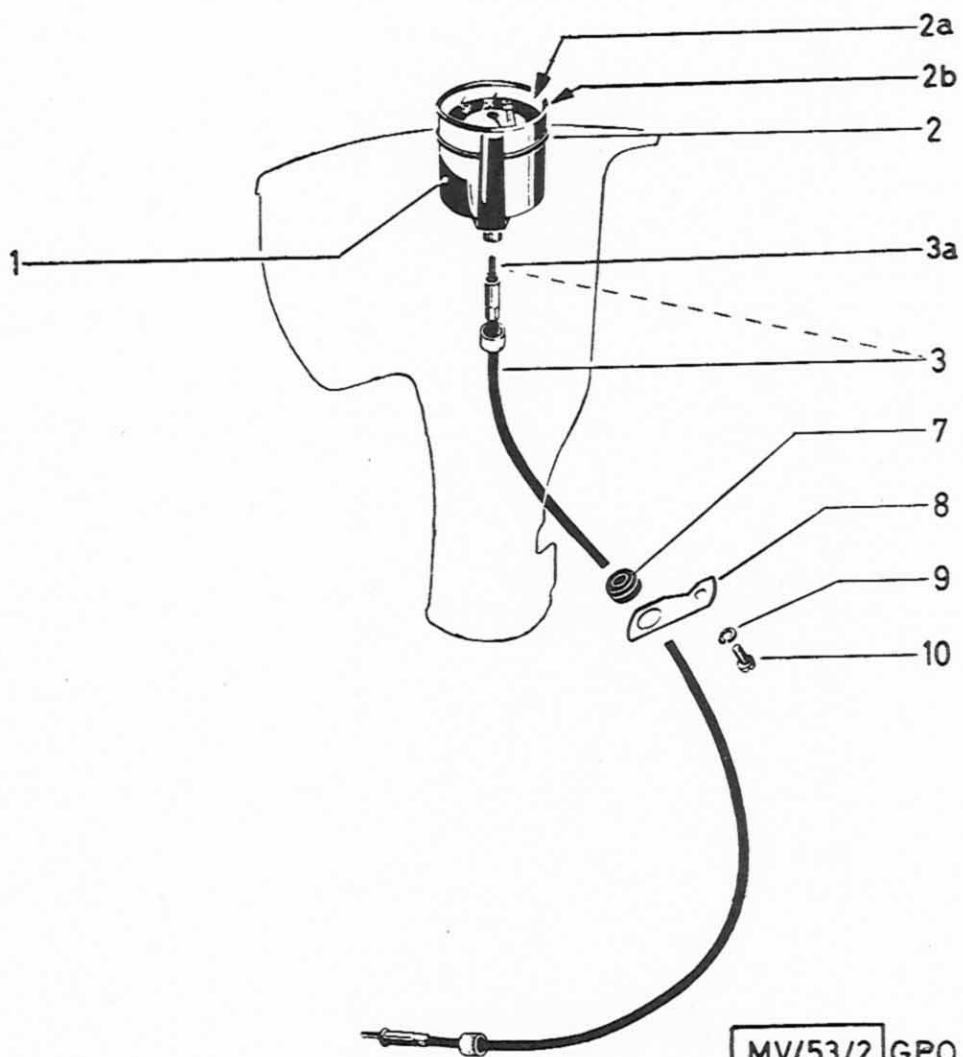

MV/53/2 G.P.O.

23. SPEEDOMETER AND DRIVING SHAFT

Ref. No.	Part-No.	Description	Required-No.	
			M2	M3 Sport
1	050.2.5324	SPEEDOMETER dia.48mm (45 miles)	1	
2	050.5327	RUBBER RING 49/44/1,5	1	
2a	050.1.5322	SPEEDOMETER GLASS dia.51mm	1	
2b	050.1.5323	RUBBER RING 1,3 ϕ x40mm dia. for inside of speedometer glass	1	
3	360.1.53.525.0	DRIVING SHAFT 600mm long (black)	1	
3a	050.1.5325	DRIVING SHAFT (core)	1	
7	501.1.8506	RUBBER SOCKET	1	
8	350.2.30.159.1	HOLDER for driving shaft	1	
9	900.3207	SPRING RING A7 DIN 137		N 1
10	900.1130	HEXAGON HEAD SCREW M7x15 DIN 933		N 1

22. SPEEDOMETER AND DRIVING SHAFT

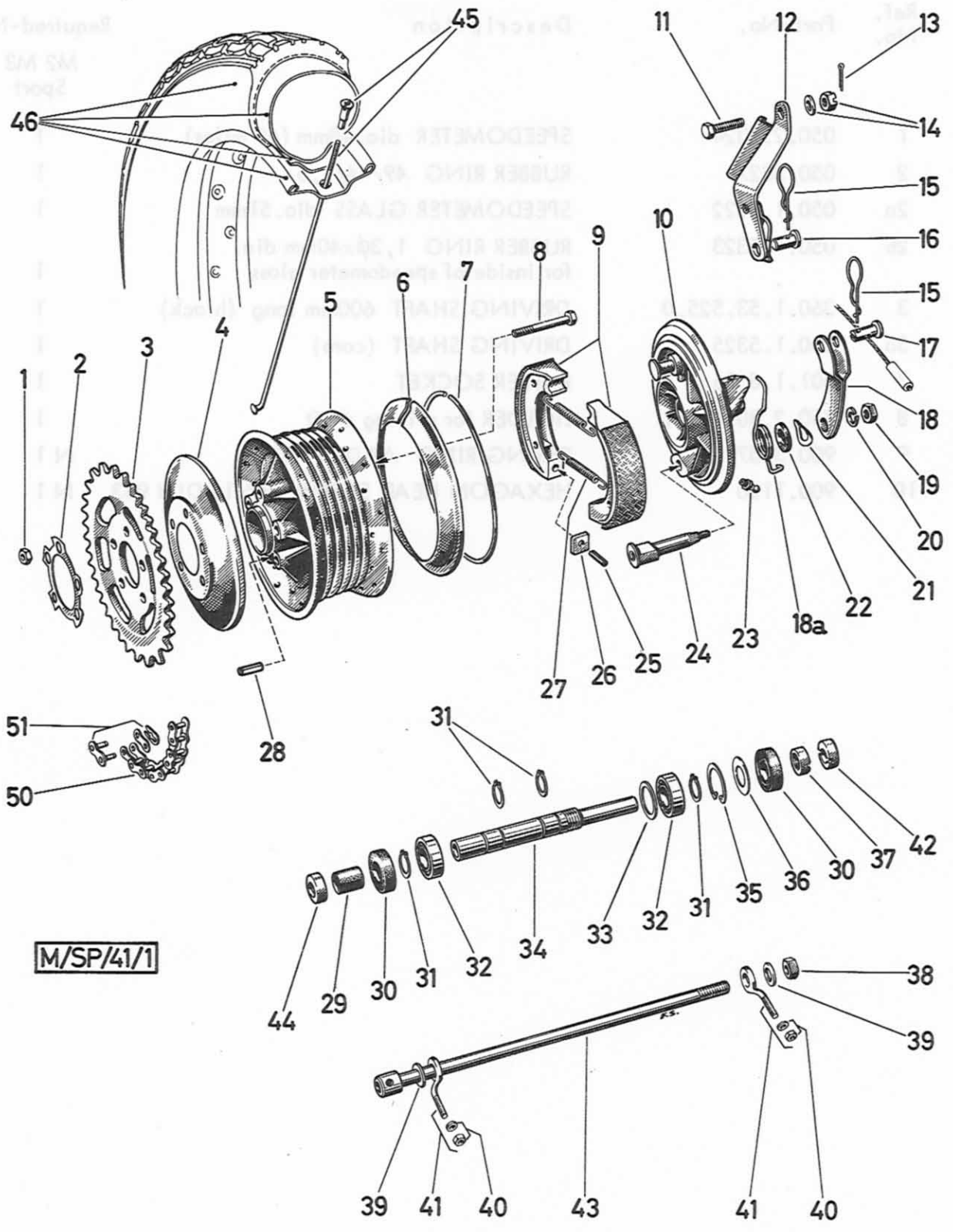

M/SP/41/1

24. REAR WHEEL, DRIVING CHAIN

Ref. No.	Part-No.	Description	Required-No.		
			M2	M3	Sport
--	360.3.41.100.0	REAR WHEEL compl. (23", 34 teeth) (without tyre)		1	
--	360.8.41.002.0	REAR WHEEL HUB compl. (34 teeth) (with fitting - parts)		1	
1	900.2012	HEXAGON NUT M7 - 8G		5	
2	350.1.41.010.1	LOCK PLATE		1	
3	050.4.4109	TOOTHED RIM (34 teeth) (high = 9mm)		1	
4	050.5.4040	COVER		1	
5	050.4.4104	BRAKE HUB		1	
6	350.1.41.042.1	PROTECTION RING dia.129,5mm		1	
7	050.10.1074	CLIP RING		1	
8	901.1105	HEXAGON SCREW M7x50 to DIN 931-8G	N 5		
9	050.4.4015.0	PAIR OF BRAKE SHOES with glued-on lining		1	
10	360.2.41.007.1	BRAKE PLATE		1	
11	901.1091	HEXAGON SCREW M8x20S DIN 931	N 1		
12	360.2.41.028.2	DRAWBAR		1	
13	22764	SPLIT PIN 2x20 DIN 94		N 1	
14	900.2924	FLAT CROWN NUT M8 DIN 937		N 1	
14	24806	WASHER 8,4 DIN 433		N 1	
15	101.1.4113	LOCK SPRING		2	
16	360.2.41.029.1	CONNECTING BOLT for drawbar		1	
17	101.1.4112	CONNECTING BOLT (slotted) for brake lever		1	
18	050.7.4113.2	BRAKE LEVER		1	
18a	350.4.41.015.1	RETURN SPRING		1	
19	26820	HEXAGON NUT M8x1 DIN 934		N 1	
20	26819	SPRING RING B8 DIN 127		N 1	
21	900.3219	SPRING WASHER 21/12,5/0,2		1	
22	128.2504	SEAL RING 20/12/3 (rubber)		1	
(23)	360.1.40.011.1	LUBRICATION NIPPLE (for plate without thread)		1	
24	360.2.40.009.2	BRAKE CAM 66 long		1	
25	900.4812	SLOTTED HOLLOW PIN 4x10 DIN 1481		N 2	
26	050.4.4016	SLIDING PLATE 3,5 thick		2	
26	050.4.4016.3	SLIDING PLATE 4 thick (for repair)		-	
27	050.4.4019	BRAKE SHOE SPRING 50 long		2	
28	901.4857	PIN FOR SPROCKET N8x20 toothed rim		1	
29	050.4.4146	PROTECTION TUBE dia.16x1x18		1	

24. REAR WHEEL, DRIVING CHAIN (cont.)

Ref. No.	Part-No.	Description	Required-No.	
			M2	M3 Sport
30	050.4.4025.0	SEAL RING 32/15/5,5		2
31	900.4619	CLIP RING Sg15x1 DIN 471	N 4	
32	900.6002	BALL BEARING 32/15/9 6002 DIN 625	N 2	
33	050.4.4022	THRUST WASHER 32/25/1,5		1
34	050.4.4123	DISTANCE TUBE 140 long		1
35	900.4732	CLIP RING Sg 32x1,2 DIN 472	N 1	
36	050.4.4039	WASHER 32/15,5/0,5		1
37	050.4.4041	SLOTTED NUT M14x1		1
38	900.2011	HEXAGON NUT M10x1 DIN 934	N 1	
39	050.1.4029	WASHER 18/10,5/2,5		2
40	24804	WASHER 6,4 DIN 433	N 2	
40	900.2106	HEXAGON NUT M6 DIN 555	N 2	
41	350.1.41.018.0	CHAIN TENSION ADJUSTER compl.		2
42	050.4.4130	THRUST RING right 22/12,5/6		1
43	350.1.41.026.1	REAR WHEEL AXLE 193 long		1
44	050.4.4125	THRUST RING left 20/11/6		1
45	365.1.40.030.1	SPOKE dia.2,65x208		36
	365.1.40.031.1	NIPPLE M3		36
	350.5.40.033.1	RIM 19"		1
46	900.0843	AIR HOSE 23"-2,25"		1
	901.0866	RIM BAND 19"		1
	900.0841/30	TYRE 23" - 2,25" black		1
50	907.1.28.094.0	DRIVING CHAIN compl. (1/2"x3/16"x7,75) 94 rollers		1
51	907.1.28.001.0	CHAIN CONNECTOR compl.		1

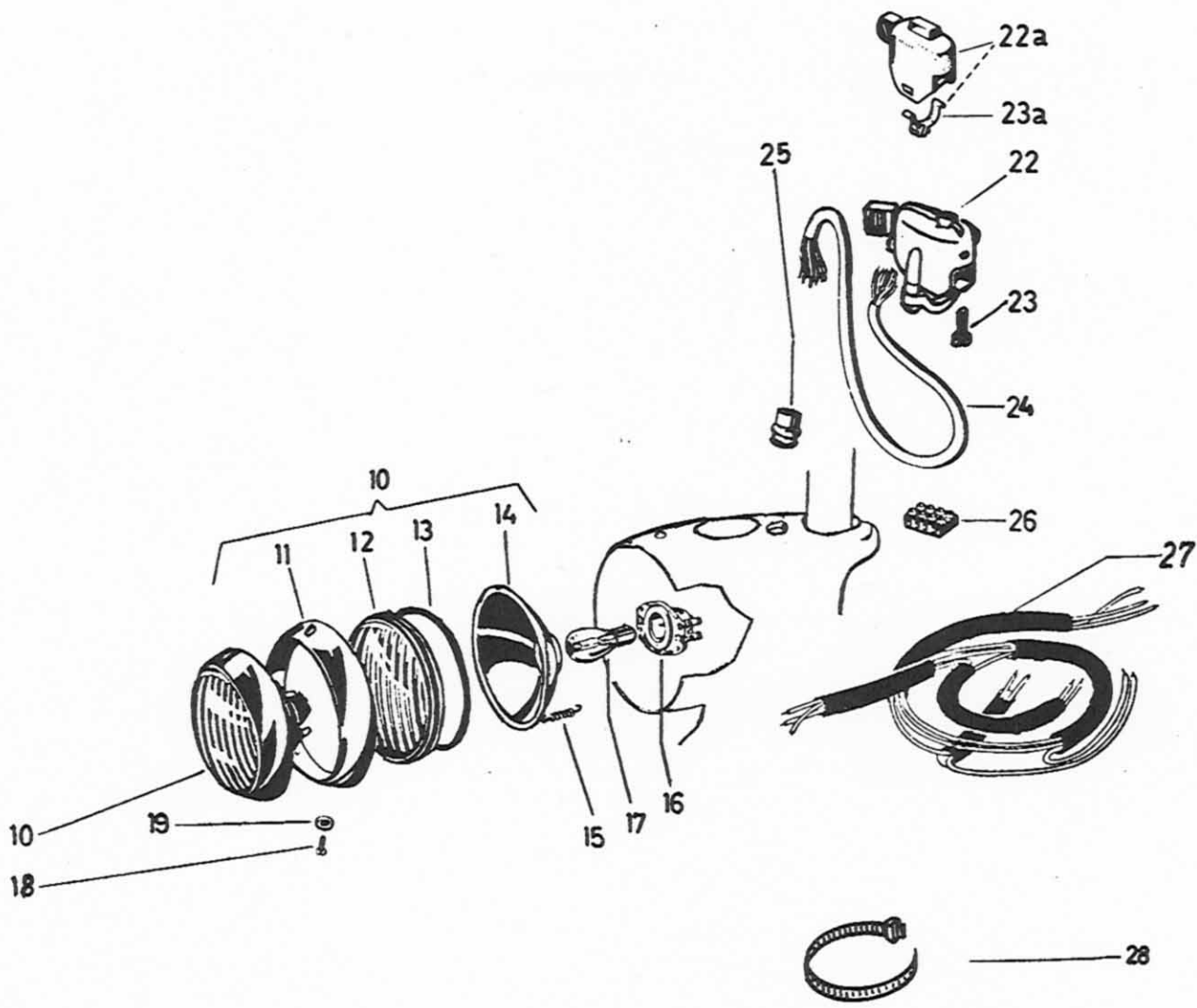

M/SP/53/1

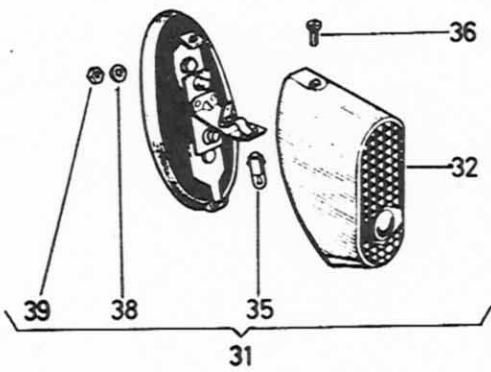

25. HEADLAMP, TAIL STOP LIGHT, BUZZER,
ELECTRICAL EQUIPMENT

Ref. No.	Part-No.	Description	Required-No.	
			M2	M3 Sport
10	350.5.53.000.0	HEADLAMP INTERIOR PARTS compl. dia. 85mm (Messrs. Wachter, with lamp holder, without bulb)	1	
11	050.5303	HEADLAMP RIM	1	
12	350.5.53.004.1	HEADLAMP GLASS	1	
13	350.4.53.006.1	RUBBER RING	1	
14	350.4.53.008.1	REFLECTOR	1	
15	350.4.53.009.1	RETAINING SPRING	1	
16	350.4.53.019.0	LAMP HOLDER compl.	1	
17	903.0751	BULB BILUX 6V 18/18W	1	
18	28721	OVAL HEAD SCREW M4x8 DIN 91	N 2	
19	100.5311	WASHER for fastening headlamp	2	
22	357.3.53.117.0	COMBINED SWITCH compl. (Messrs. ZKW)	1	
	or			
22a	357.1.53.017.0	COMBINED SWITCH compl. (Messrs. Merit)	1	
23	28881	FILLISTER HEAD SCREW M4x10 DIN 84	1	
23a	357.1.53.018.0	SHACKLE compl.	1	
24	902.0750	CONNECTING CABLE (6 rows, 500 long)	p.m.	
25	350.3.30.009.1	GROMMET	1	
26	364.1.57.001.0	SOFT RUBBER TERMINAL (four rows)	1	
27	350.6.57.100.0	CABLE compl.	1	
28	364.1.53.227.1	CABLE BAND (120mm long)	1	
30	902.0772	BUZZER (Hella with faston plug connector)	1	
31	350.3.55.000.0	TAIL-STOP-LIGHT compl. (ZKW M 1378 M/1K)	1	
32	349.3.55.000.2	HOUSING for tail-stop-light	1	
35	902.0712	BULB HL 6V 3W BA 9S	1	
36	349.3.55.003.1	RETAINING BOLT (M4x12)	1	
38	900.3255	SERRATED LOCK WASHER A5,3 DIN 6798	N 2	
39	24772	HEXAGON NUT M5 DIN 934	N 2	

28. HEADLAMP, TAIL STOP LIGHT, BUZZER,
ELECTRICAL EQUIPMENT

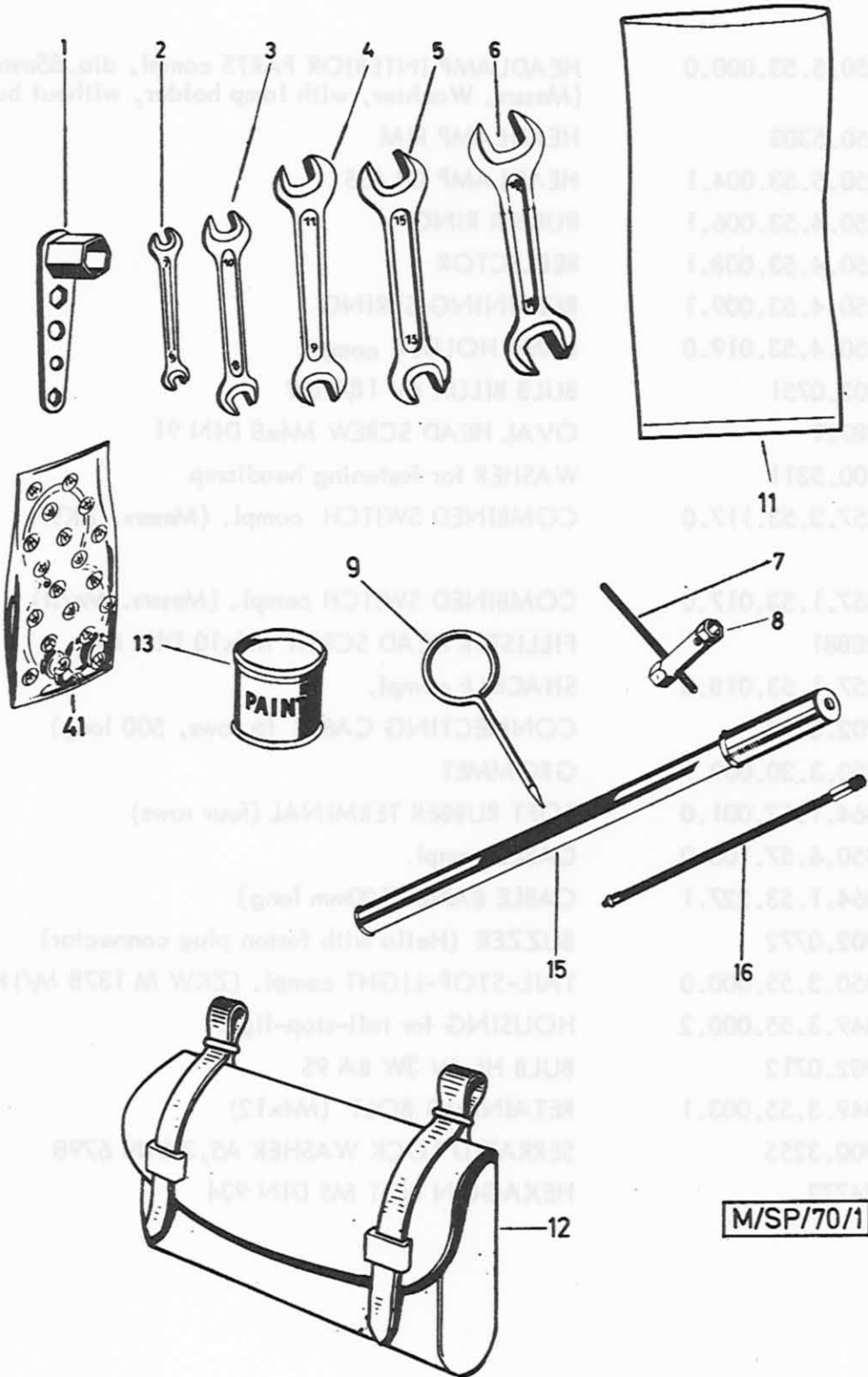

M/SP/70/1

26. TOOLS, PUMP

Ref. No.	Part-No.	Description	Required-No.	
			M2 M3 Sport	
--	050.2.7010.0	SET OF TOOLS compl.		1
1	050.7001.2	SOCKET WRENCH for spark plug		1
2	19599	WRENCH 6/7 DIN 895	(N)	as req.
3	10181	WRENCH 8/10 DIN 895	(N)	1
4	24324	WRENCH 9/11 DIN 895	(N)	1
5	900.7011	WRENCH 13/15 DIN 895	N	1
6	24323	WRENCH 14/17 DIN 895	(N)	1
7	050.7022	PIN dia.6x115 long		1
8	350.1.70.008.1	SOCKET WRENCH 10/11		1
9	050.2.7021	SCREW DRIVER		1
11	366.1.70.003.1	TOOL BAG (plastic)		1
12	600.4.64.004.0	TOOL BAG		1
13	900.0265/10	TOUCH-UP PAINT (orange RAL 2004) 0,276 lbs		as req.
13	900.0275/10	TOUCH-UP PAINT mat black 0,276 lbs		as req.
13	900.0289/10	TOUCH-UP PAINT sulphur yellow (RAL 1016M) 0,276 lbs		as req.
15	050.7024.0	TIRE PUMP		1
16	050.7023.2	TIRE PUMP TUBE for 050.7024.0, 200 long		1
41	302.3.10.210.0	SET OF GASKET		1

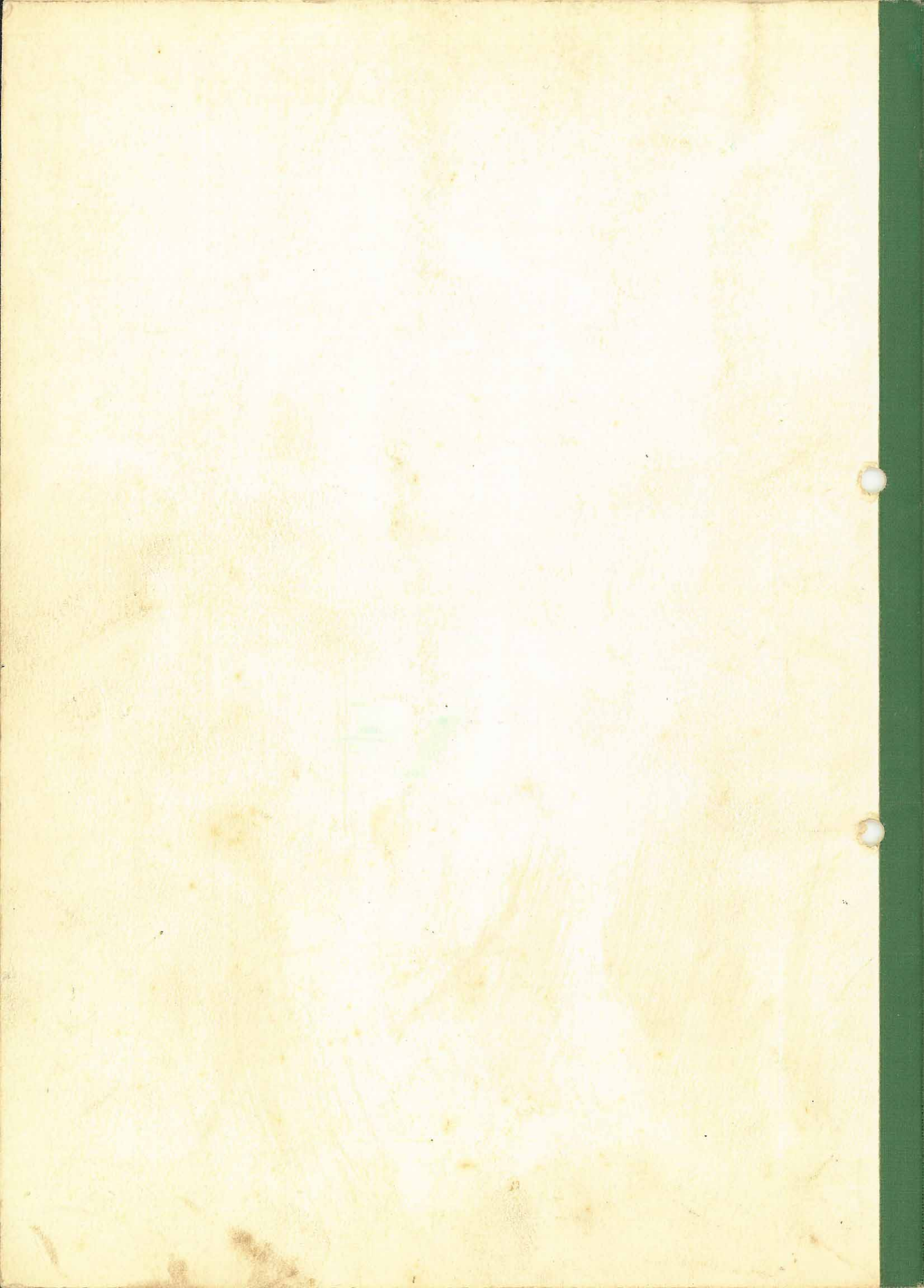



Spare parts - Modification notice

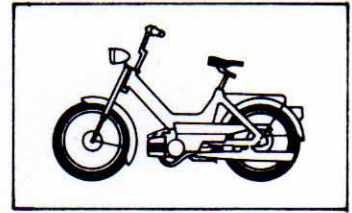

Service Graz

Order No. 2.60.45/041

DISTRIBUTOR ENGLAND

DATE December 1974

PAGE 1

Spare parts catalogue (model) VS50 Sport Edition May 1972
 MV50 de luxe Edition September 1972
 M.3.Sport Edition January 1974

Re: NEW PAIR OF BRAKE SHOES AND BRAKE CAM

England

Line	Page Group	Ref.No. Pos.	Old spare part No.	O X	New spare part No.	Remarks up to ... as from ...	M	Designation				
1	57/63	4/9	050.4.4015.0	}	MV50 de luxe	→ 5534987		Pair of brake shoes				
2	57/64	12/24	360.2.40.009.2					Brake cam				
3	69/75	4/9	050.4.4015.0	}	M.3.Sport	→ 7836714		Pair of brake shoes				
4	69/75	12/24	360.2.40.009.2					Brake cam				
5	59/63	4/9	050.4.4015.0	}	VS50 Sport	→ 6143541		Pair of brake shoes				
6	59/63	12/24	360.2.40.009.2					Brake cam				
7	For model MV50 de luxe, M.3.Sport and VS50 Sport			}	[360.1.40.815.0]	5534988 →	1	Pair of brake shoes				
8								}	[360.1.40.809.2]	7836715 →	1	Brake cam
9												}

10 The new parts used jointly replace the previous ones.

11 Further details with reference to fitting and interchange ability see service bulletin No. 29-26000/1002.

O = Old part to be used up, new part applicable to both types.
 X = Part omitted, must no longer be used.
 No symbol : Applicable to numbers quoted under remarks
 SPE = Spare part engine
 → 5007 up to Engine-No.
 5008 → from Engine-No.
 → 2480 up to Chassis-No.
 2481 → from Chassis-No.

M = Motive of Modification: 1) New feature/New part 2) Change in dimension
 3) Change in quality 4) Change in shape 5) Change in part No. only

Signature	in spare parts catalogue	in spare parts index	in spare parts store
-----------	--------------------------	----------------------	----------------------



Spare parts - Modification notice

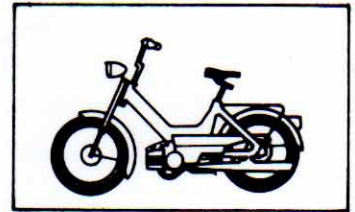

Service Graz

Order No. 2.60.45/042

DISTRIBUTOR ENGLAND

DATE FEBRUARY 1975

PAGE 1

Spare parts catalogue (model) M2/M3 Sport Edition January 1974				Re: Change of the Handlebar controls to levers of casting with spherical ends				
Page Group	Ref.No. Pos.	Old spare part No.	O X	New spare part No.	Remarks up to ... as from ...	M	Designation	
1	65	1	350.2.32.005.0	}			Throttle twist grip compl.	
2	65	2	050.2.3228		--▶	5528410	Brake lever	
3	65	31	350.3.32.017.0		--▶	7834236	Clutch lever compl.	
4	65	37	357.1.32.017.1				Hand lever for clutch	
5				O	350.3.32.005.0	1	Throttle twist grip compl.	
6							(Magura D 250.9 1c2/ksz)	
7					328.2.32.028.1	1	Hand lever for brake	
8							(Casting with spherical ends)	
9					349.3.32.028.1	5528411 → 7834237 →	Synthetic nut M5	
10				O	350.4.32.017.0	1	Clutch lever compl.	
							(Magura 213.9. 1.c)	
11					328.2.32.006.1	1	Hand lever for clutch	
12							(Casting with spherical ends)	
13	The new hand levers 328.2.32.028.1 and 328.2.32.006.1 (Casting) can be used							
14	only along with synthetic nuts 349.3.32.028.1.							

O = Old part to be used up, new part applicable to both types.
 X = Part omitted, must no longer be used.
 No symbol : Applicable to numbers quoted under remarks
 SPE = Spare part engine
 → 5007 up to Engine-No.
 5008 → from Engine-No.
 → 2480 up to Chassis-No.
 2481 → from Chassis-No.

M = Motive of Modification: 1) New feature/New part 2) Change in dimension
 3) Change in quality 4) Change in shape 5) Change in part No. only

Signature	in spare parts catalogue	in spare parts index	in spare parts store
-----------	--------------------------	----------------------	----------------------

IceniCAM Information Service

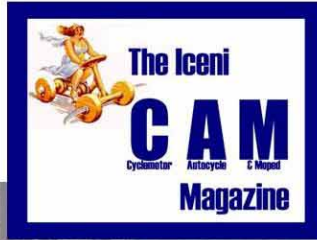

www.icenicam.org.uk