

IceniCAM Information Service

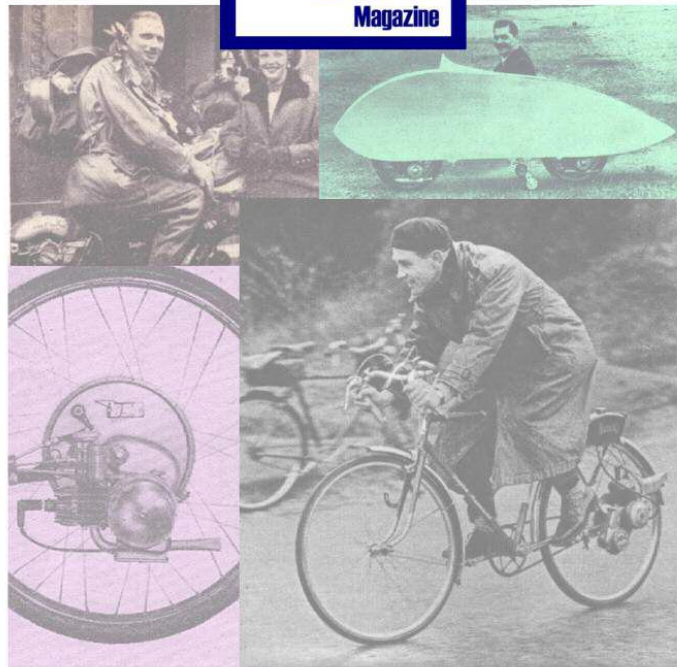

ADJUSTMENT

For maximum efficiency, the Hub must be adjusted correctly; do not, under any circumstances, adjust the Hub too tightly. Following is the procedure to be adopted (if adjustment is necessary) :—

1. Slacken off Locking Washer P.302.
2. Fit square in Spanner P.321 on the square at end of Spindle P.318.
3. Adjust spindle and Fixed Cone P.318 as may be required—either inward or outward—by means of the Spanner.
4. Lock up Locking Washer P.302 after adjustment is correct, holding the Spanner tightly whilst this is done. Remove Spanner and finally check adjustment by the following method.

Spin the wheel by hand; holding the pedals stationary the wheel should coast, whilst backward pressure on the pedals should bring the wheel to stop instantly. If it is found that the wheel does not spin freely with the pedals held stationary, it means that the fixed cone is adjusted too tightly, and in order to correct this, the spindle with the fixed cone should be slightly slackened off. Under no circumstances should undue slack be permitted, as we have found over a number of years, that more trouble results from incorrectly adjusted Hubs than any other cause, as excessive wear develops very quickly. This stresses the importance of adjustment; a little time spent on maintaining correct adjustment is more than repaid in better and longer service.

CLEANING AND LUBRICATION

The internal parts of the Hub should be kept clean and this can be done by washing out with petrol. The cycle should be lowered to the ground so that the Brake Arm of the Hub is underneath, and petrol should then be injected through the Lubricator. After this, it is imperative that adequate lubrication be supplied to the Hub, and oil must be injected whilst the cycle is on the ground, further supply being given when the machine is restored to its normal upright position.

The choice of a suitable oil is important, and we urge the use of a good quality mineral oil which should be entirely free from acid. A little trouble with correct and regular lubrication is amply repaid by the service given by the Hub. **LUBRICATE REGULARLY !!**

SPARES

A full range of spares for the Hub is shown on the attached illustration, and your local dealer will be glad to supply you from his stock. Insist on genuine "PERRY" spares.

A wide range of sprockets is available, and you can pick the one to give you the most suitable gear for your particular requirements.

SOUTH WALES FACTORY

The Spare Parts listed, and now available, are produced at our new Factory in South Wales which is built and equipped with an entirely new Plant of the latest type for Coaster Hub Brake production.

WITH THE COMPLIMENTS OF

PERRY CHAIN COMPANY LIMITED
TYSELEY, BIRMINGHAM, 11, ENGLAND

Telephone Acoc's Green 0606 (4 lines)
Telegrams "Perry" Phone, Acoc's Green

The
CARE AND MAINTENANCE
OF THE

PERRY

★ ★ **TWO STAR**

COASTER HUB BRAKE



LIST OF SPARES



Hints on

CARE & MAINTENANCE

The outstanding feature of the 'Perry Two Star Coaster Hub Brake' is its extreme simplicity, combined with the maximum braking efficiency, and if some slight attention, as indicated below, is given to it, years of satisfactory running should result.

FITTING

The Hub is correctly adjusted before being despatched from our works, and it is advisable to build it into the wheel as it is received. If, however, for any reason it is necessary to dismantle the Hub, great care must be taken to ensure that all parts are reassembled correctly, and the 'exploded drawing' shown in this leaflet should be followed closely.

SPARES

CLEANING AND LUBRICATION

ADJUSTMENT

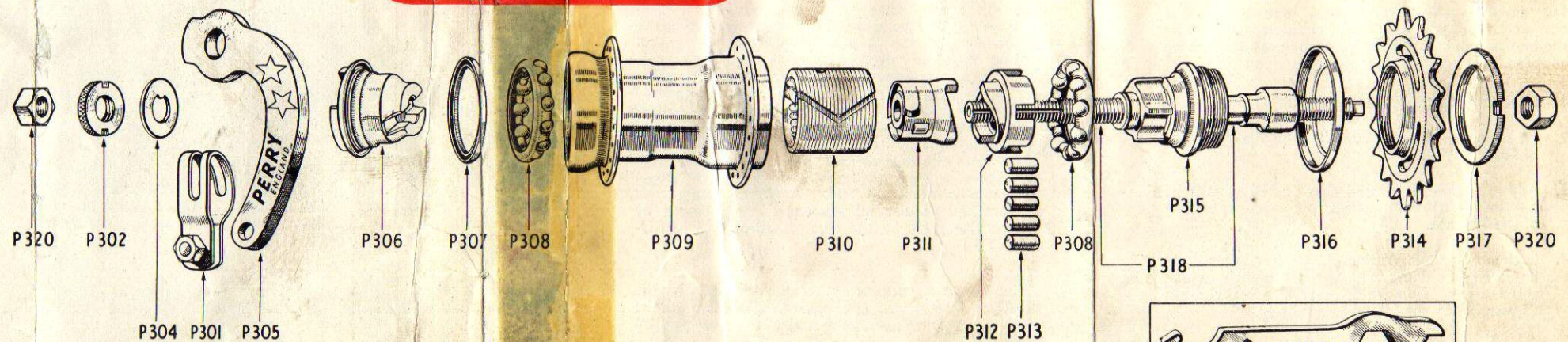
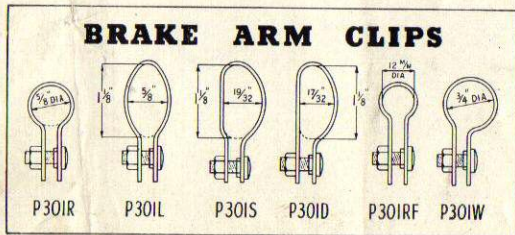

P.301 Brake Arm Clip complete.
P.302 Locking Washer.
P.304 Notched Washer.

P.305 Brake Arm.
P.306 Brake Cone.
P.307 Dust Cap.
P.308 Ball Ring and Balls.

P.309 Hub Shell and Lubricator.
P.310 Brake Cylinder.
P.311 Brake Actuator.

P.312 Roller Guide Ring.
P.313 Driving Rollers.
P.314 Sprockets— $\frac{1}{2}'' \times \frac{1}{8}''$ or $\frac{3}{16}''$ 14 to 22 T, and upwards.

P.315 Driving Sleeve.
P.316 Dust Cap.
P.317 Sprocket Lock Ring

P.318 Axle and Cone.
P.320 Axle Nut.
P.321 Spanner.

