

Mobylette

ENGLISH PUBLICATION

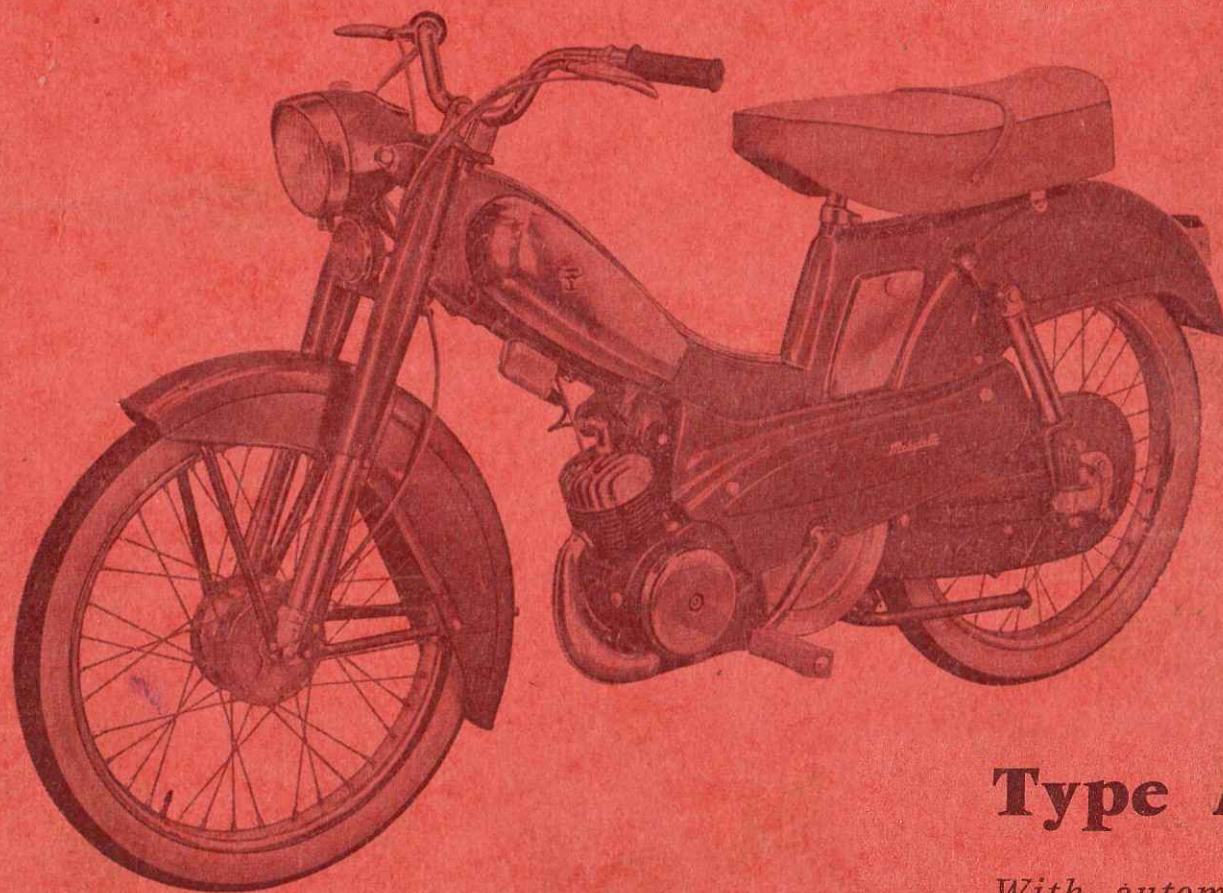

Type AV 89

With automatic clutch

DIMOBY

and automatic gear change

MOBYMATIC

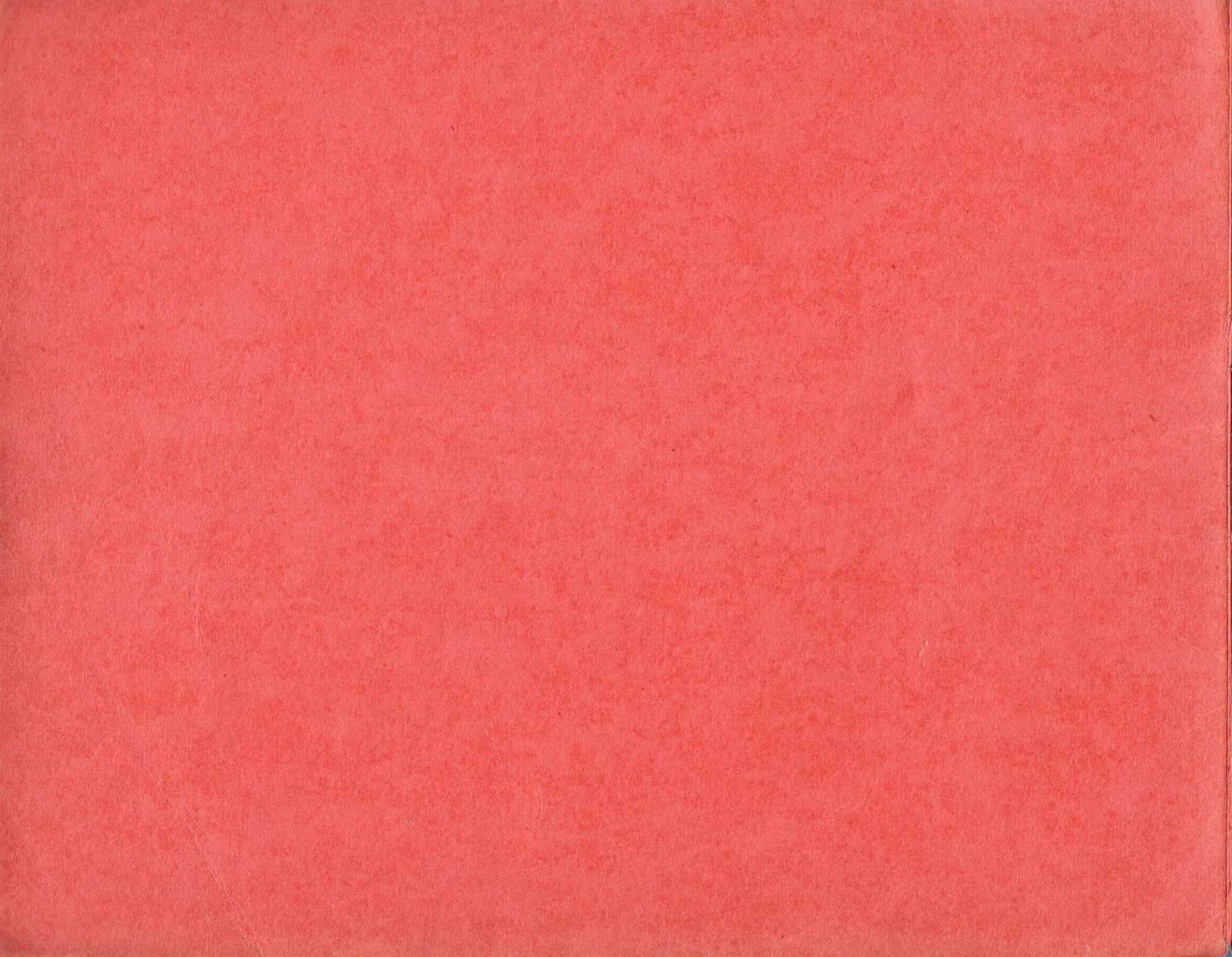

Mobylette

S U M M A R Y

Type **AV 89** or **AU 89**

DESCRIPTION	SHEET	DESCRIPTION	SHEET
Engine - Attachment - Exhaust	2 A	Pedal Unit - Chains - Chain tensioner.....	8 A
Gear change	3 A	Rear suspension shock absorbers.....	9 A
Carburettor - Petrol tap	4 A	Front wheel and hub "PRIOR".....	10 A
Flywheel magneto.....	5 A	Rear wheel and hub "PRIOR".....	11 A
Front fork - Head Races	6 A	Saddles (REYDEL, VIDAL) single spring....	12 A
Frame - Mudguards - Chainguards - Luggage carrier - Propstand - Rear swinging arm - Dual-Seat - Cycle bolt Attachment.....	7 A	Handlebars - Controls - Horn	13 A
		"LUXOR" Lighting Equipment - "HURET" speedometer 90 km.....	14 A

Numbers of mechanical units are not mentioned on the drawings. For your information every unit is preceded with the letters S.A. in thick print.

At the time of modification in parts or mechanical units, we shall issue a corresponding sheet to be slipped in the present catalogue. It will bear the same sheet number as the concerned part or unit but with a different letter, for instance 2 B, 2C, 2D, in case of three successive modifications.

Décompresseur complet: 14721

Piston complet: 14819

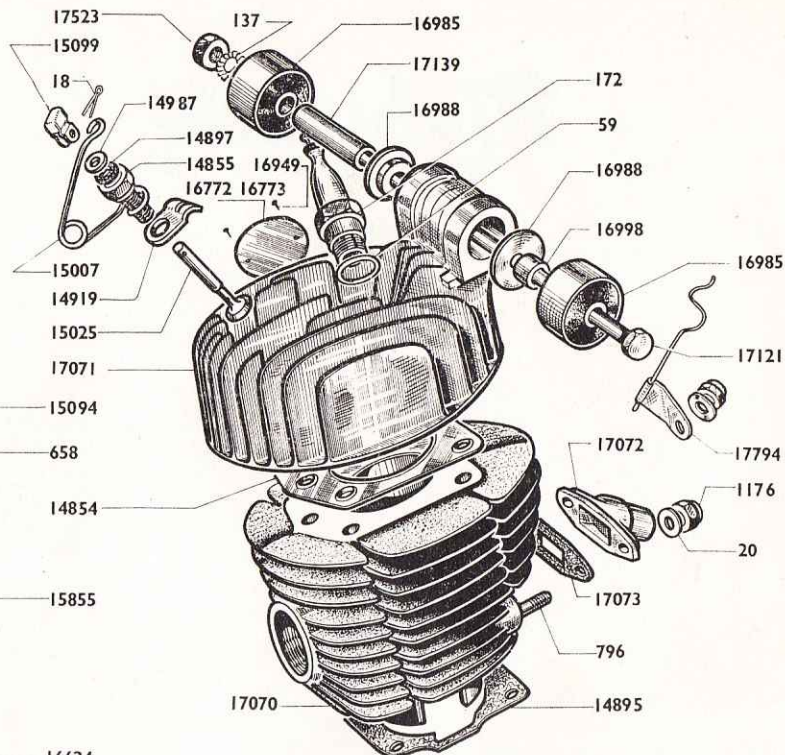
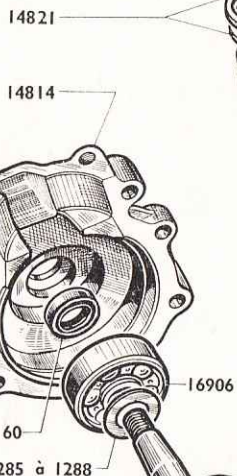
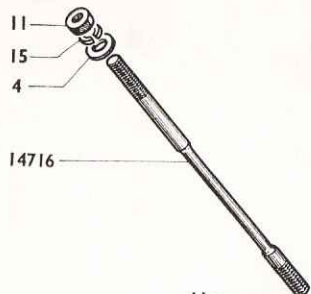

Vilebrequin complet: 17707

Embiellage complet: 16623

Carter moteur complet: 14814

Jeu de Vis Carter moteur: 15175

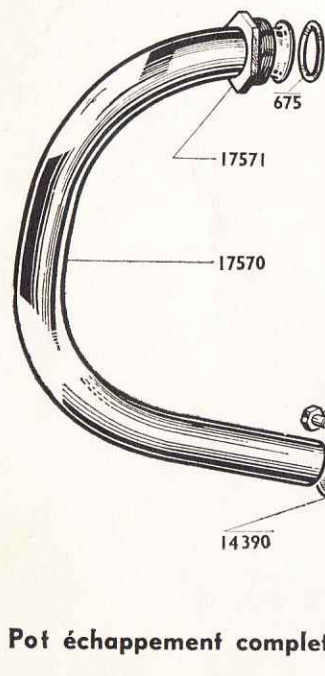

Culasse complète: 17196

Cylindre complet: 17070

Jeu de joints moteur: 16912

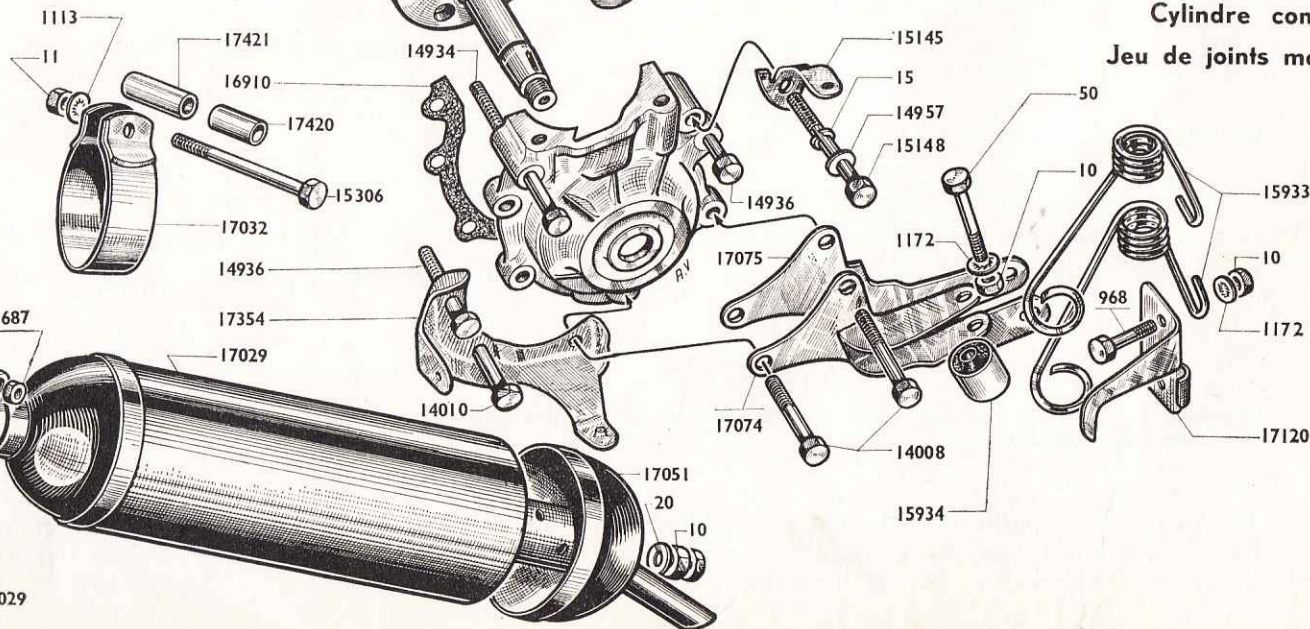

Pot échappement complet: 17029

Décompresseur complet = DECOMPRESSOR COMPLETE - Piston complet = PISTON COMPLETE - Vilebrequin complet = CRANKSHAFT COMPLETE
 Carter moteur complet = ENGINE CRANKCASE COMPLETE - Cylindre complet = CYLINDER COMPLETE - Culasse complète = CYLINDERHEAD
 COMPLETE - Jeu de joints moteur = SET OF ENGINE GASKETS.

ENGINE UNIT - SWIVELLING ATTACHMENT - EXHAUST

Part N°	Quantity per machine	DESCRIPTION	Part N°	Quantity per machine	DESCRIPTION
4	3	Flat washer $\varnothing 7 \frac{m}{m}$ (Cond.)	15934	1	Spring silentblock $6 \times 20 \times 22 \times 16$
10		Nut $6 \frac{m}{m} \times 100$ (Cond.)	16623	S.A.	Connecting rod assembly complete NOTE 2
11		Nut $7 \frac{m}{m} \times 100$ (Cond.)	16624	1	Big end roller cage
15		Grower washer $\varnothing 7 \frac{m}{m}$ (Cond.)	16772	1	MOTOBECANE engine number plate
18	1	Decompressor split pin..... (Cond.)	16773	1	MOTOCONFORT engine number plate
20	2	Flat washer $\varnothing 6 \frac{m}{m}$ (Cond.)	16906	2	Crankshaft bearing $16 \times 42 \times 13$
50	1	Axle bolt $\varnothing 6 \frac{m}{m} \times 100 \times 32$ for spring silentbloc (Cond.)	16910	1	Crankcase gasket (Cond.)
59	1	Sparkplug gasket (Cond.)	16912	S.A.	Set of engine gaskets.....
60	2	Leakproof gasket (engine crankcase)..... (Cond.)	16949	2	Grooved nail $\varnothing 2,5 \frac{m}{m}$ (Cond.)
137	1	Blocfor washer $\varnothing 8 \frac{m}{m}$ (Cond.)	16967		Cylinder aluminium wedge $2/10 \frac{m}{m}$ (Cond.)
172	1	Sparkplug size $14 \frac{m}{m}$ with gasket..... (Cond.)	16968		Cylinder aluminium wedge $4/10 \frac{m}{m}$ (Cond.)
655	2	Big end flange	16985	2	Upper articulation silentblock $8 \times 32 \times 23,2 \times 18$...
658	2	Gudgeon pin circlips..... (Cond.)	16988	2	Upper articulation shouldered washer
796	2	Inlet pipe stud (Cond.)	16998	1	Upper articulation L.H. distance piece $L = 4 \frac{m}{m}$..
968	2	Bolt securing the springs $6/100 \times 20 \frac{m}{m}$ (Cond.)	17070	1	Cylinder with piston complete matched.....
1172	3	Nomel washer $\varnothing 6 \frac{m}{m}$ (Cond.)	17071	1	Cylinderhead stripped with articul. embossment..
1176	2	Nylstop nut $\varnothing 6 \frac{m}{m} \times 100$ (Cond.)	17072	1	Inlet pipe inner $\varnothing 15 \frac{m}{m} - \varnothing 22 \frac{m}{m}$
1285		Crankshaft adjusting wedge $\varnothing 18,9 \times 24 \times 1/10$ (Cond.)	17073	1	Inlet pipe gasket..... (Cond.)
1286		Crankshaft adjusting wedge $\varnothing 18,9 \times 24 \times 2/10$ (Cond.)	17074	1	L.H. lower engine support
1287		Crankshaft adjusting wedge $\varnothing 18,9 \times 24 \times 3/10$ (Cond.)	17075	1	R.H. lower engine support
1288		Crankshaft adjusting wedge $\varnothing 18,9 \times 24 \times 5/10$ (Cond.)	17120	1	Tensioner springs stop lug.....
14008	2	Bolt $7 \times 100 \times 47 \frac{m}{m}$	17121	1	Engine upper articulation bolt $8 \times 100 \times 155 \frac{m}{m}$
14010	1	Bolt $7 \times 100 \times 41 \frac{m}{m}$	17139	1	Upper articulation R.H. distance piece $L = 41 \frac{m}{m}$..
14716	4	Stud holding cylinder and cylinderhead .. (Cond.)	17196	S.A.	Cylinderhead complete
14721	S.A.	Decompressor complete	17354	1	Double lug holding pulley guard.....
14814	1	Engine crankcase with leakproof gaskets.....	17523	1	Swivel axle nut $\varnothing 8 \frac{m}{m} \times 100 \times 14$ (Cond.)
14819	S.A.	Piston complete NOTE 1	17530	1	Crankshaft weights (set of).....
14821	2	Piston ring width $2 \frac{m}{m}$ (Cond.)	17707	S.A.	Crankshaft complete (shaft $\varnothing 16 \frac{m}{m}$).....
14854	1	Cylinderhead gasket..... (Cond.)	17794		High tension lead guide
14855	1	Decompressor body.....			
14895	1	Cylinder gasket (Cond.)			
14897	1	Decompressor valve gasket (Cond.)			
14919	1	Anchoring lug (decompressor cable).....	10	2	Nut $6 \frac{m}{m} \times 100$ (Cond.)
14934	1	Bolt $7 \frac{m}{m} \times 100 \times 70$	20	1	Flat washer $\varnothing 6 \frac{m}{m}$ (Cond.)
14936	2	Bolt $7 \frac{m}{m} \times 100 \times 30$	675	1	Exhaust gasket..... (Cond.)
14957	1	Flat washer $\varnothing 7 \frac{m}{m}$ (Cond.)	687	1	Clip bolt $7 \frac{m}{m} \times 100 \times 25$ (Cond.)
14987	1	Valve gasket washer..... (Cond.)	1113	2	Nomel washer $\varnothing 7 \frac{m}{m}$ (Cond.)
15007	1	Decompressor spring.....	14390	1	Silencer clip.....
15025	1	Decompressor valve (Cond.)	15306	2	Clip bolt $\varnothing 7 \frac{m}{m} \times 100 \times 68,5$
15094	1	Piston pin	17029	S.A.	Exhaust silencer complete
15099	1	Valve link..... (Cond.)	17032	2	Clip securing exhaust silencer on engine
15145	1	Crankcase upper lug.....	17051	2	Exhaust tail cover
15148	1	Screw $7 \frac{m}{m} \times 125 \times 45$	17420	2	Silencer clip distance piece $20,5 \frac{m}{m}$ long
15175	S.A.	Set of crankcase screws	17421	2	Silencer clip distance piece $25,5 \frac{m}{m}$ long
15855	1	Small end needle cartridge..... (Cond.)	17570	1	Exhaust pipe.....
15933	1	Set of 2 tensioner springs	17571	1	Exhaust nut.....

EXHAUST

NOTE 1. - PISTON. The Mobylette piston is supplied complete. For any order, please state the letter stamped on the upper part of the cylinder.

NOTE 2. - CONNECTING ROD ASSEMBLY. Owing to the precision mounting of the connecting rod assembly, the connecting rod stripped is not retailed. Please order the connecting rod assembly N° 16.623.

S.A. = Sub-assembly (not illustrated).

Reprinting forbidden

MOBYLETTE

Type AV 89 or AU 89

AUTOMATIC GEAR CHANGE "MOBYMATIC"

with "DIMOBY" CLUTCH

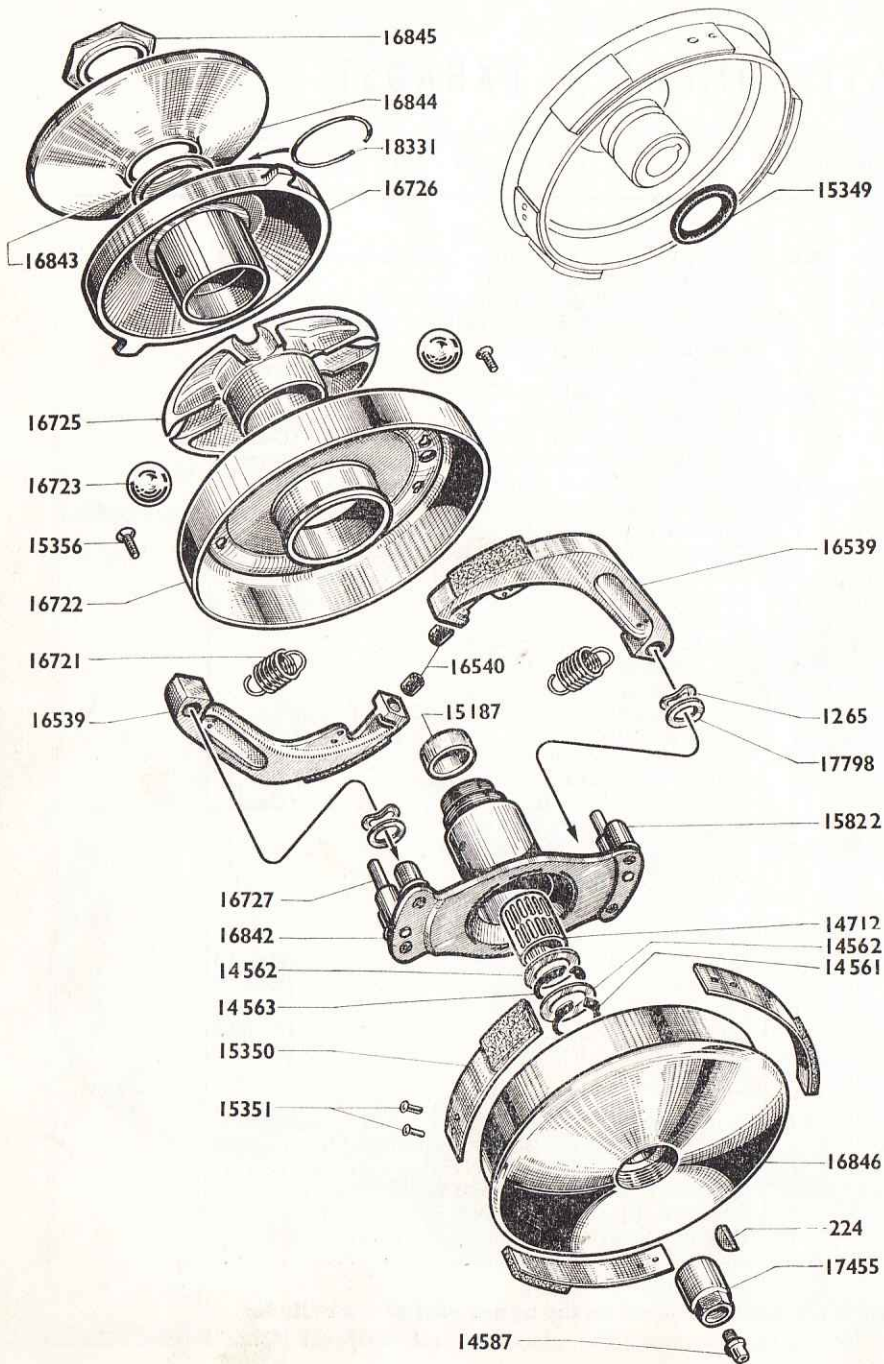

Part N°	Quantity per machine	DESCRIPTION
224	1	Clutch drum cotter pin(Cond.)
1265	2	Small column spring washer inner $\varnothing = 10 \frac{m}{m}$
14561	1	Outer circlips $\varnothing 15 \frac{m}{m}$(Cond.)
14562	2	Clutch lateral flange.....(Cond.)
14563	1	Inner circlips $\varnothing 22 \frac{m}{m}$(Cond.)
14587	1	Grease nipple.....(Cond.)
14712	1	Needle cartridge $15 \times 19 L = 22 \frac{m}{m}$
15187	1	Clutch hub plug
15349	1	Drum gasket
15350	3	Spring with ferodo.....
15351	6	Spring rivet(Cond.)
15356	4	Flange securing screw $4 \times 75 \times 14$
15822	4	Small column to be rivetted, length under flange $13,5 \frac{m}{m}$
16539	2	Clutch riser with lining
16540	2	Clutch riser stop(Cond.)
16721	2	Clutch riser spring.....(Cond.)
16722	1	Flange with drum and oil deflector
16723	4	Gear change ball $\varnothing 13,49 \frac{m}{m}$(Cond.)
16725	1	Cage for balls (nylon)
16726	1	Stripped pulley mobile flange
16727	2	Mobile flange stop $\varnothing 6 \frac{m}{m} L = 33 \frac{m}{m}$
16840	S.A.	Gear change complete
16842	1	Clutch hub
16843	1	Fixed flange washer.....
16844	1	Pulley fixed flange (screwed) 27×100 (right hand thread).....
16845	1	Fixed flange locknut $\varnothing 25 \times 100$ (left hand thread).
16846	1	Drum with springs
17455	1	Drum lock nut (new model).....
17798	2	Small column washer $\varnothing 10 \times 15 \times 2$(Cond.)
18331	1	Centering flange

S.A. = Sub-assembly (not illustrated).

MOBYLETTE

Type AV 89 or AU 89

Petrol tap 15550

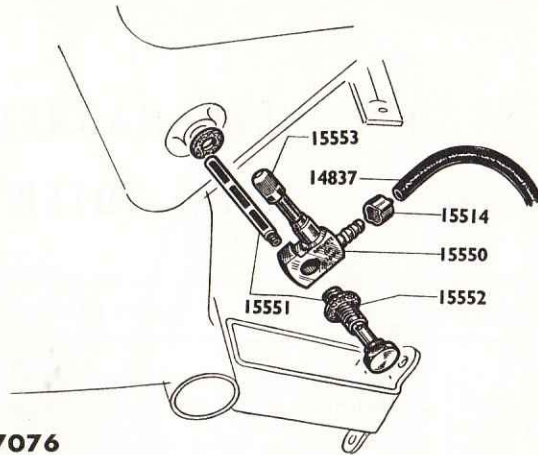

Carburettor complete 17076

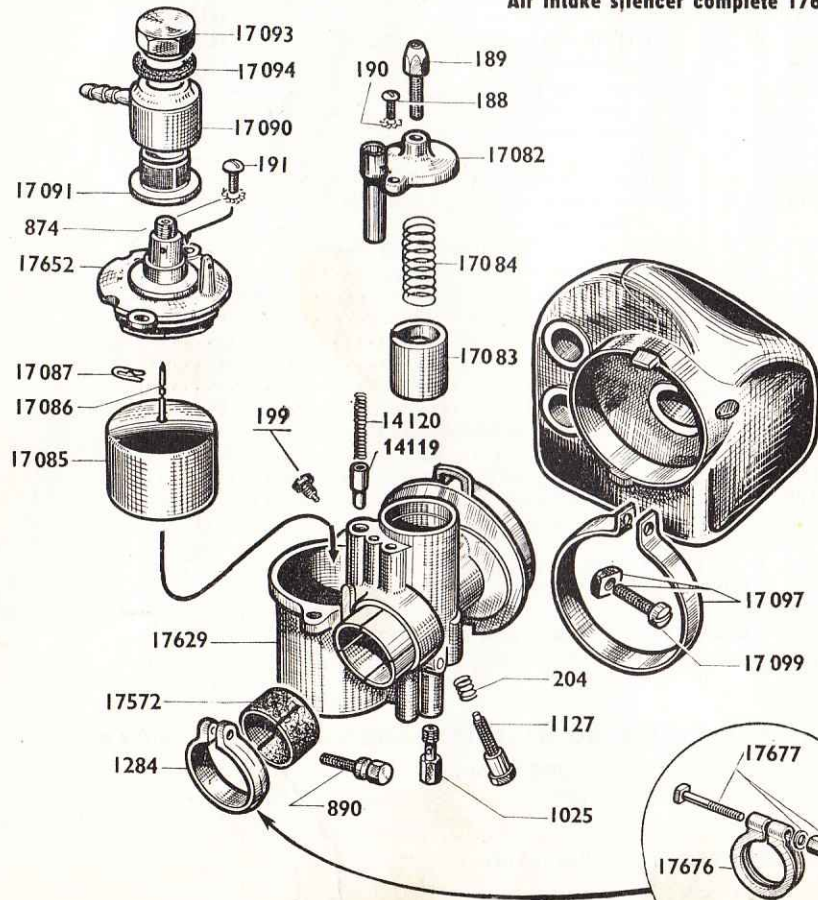

Air intake silencer complete 17651

CARBURETTOR H 14

(Adjustment 569)

Part N°	Quantity per machine	DESCRIPTION
PETROL TAP		
14837	1	Nylon petrol pipe
15497	1	Rubber petrol pipe.....
15514	2	Petrol pipe clip on tap.....
15550	S.A.	Petrol tap with fastening screw and pipe.. (Cond.)
15551	1	Screw with filter holding tap
15552	2	Fastening screw gasket.....
15553	1	Tap plastic knob
CARBURETTOR		
188	1	Chamber cover screw $\varnothing 4 \frac{m}{m}$ (Cond.)
189	1	Tensioner screw (on chamber cover) $\varnothing 6 \frac{m}{m} \times 75$..
190	1	Fan washer $\varnothing 4 \frac{m}{m}$ (Cond.)
191	2	Bowl cover screw $\varnothing 5 \frac{m}{m} \times 90 \times 11$
199	1	Throttle guide screw
204	1	Idle screw spring
874	2	Fan washer $\varnothing 5 \frac{m}{m}$
890	1	Carburettor clip screw
1025	1	Jet size 25
1127	1	Idle stop screw
1284	1	Carburettor clip
14119	1	Choke valve (length = $15,5 \frac{m}{m}$)
14120	1	Choke valve spring
17076	S.A.	Carburettor complete cliptype (adjustment 569) ..
17082	1	Float chamber cover
17083	1	Throttle (length = $20 \frac{m}{m}$)
17084	1	Throttle spring.....
17085	1	Float
17086	1	Float needle
17087	1	Needle pin.....
17090	1	Union screw
17091	1	Petrol filter
17093	1	Union screw cap
17094	1	Cap upper fiber washer
17097	1	Clip with air intake silencer bolt
17099	1	Silencer clip bolt.....
17572	1	Reduction fiber bush
17629	1	Carburettor body (float chamber)
17651	S.A.	Air intake silencer complete
17652	1	Bowl cover
17653	1	Bowl cover complete
17676	1	Carburettor clip..... NOTE
17677	1	Carburettor clip screw $\varnothing 6 \times 100 \times 36$

NOTE. - 2 different clips and bolt have been fitted. See the drawing.

MOBYLETTE

Type AV 89 or AU 89

FLYWHEEL MAGNETO 12 watts WITH OUTER COIL

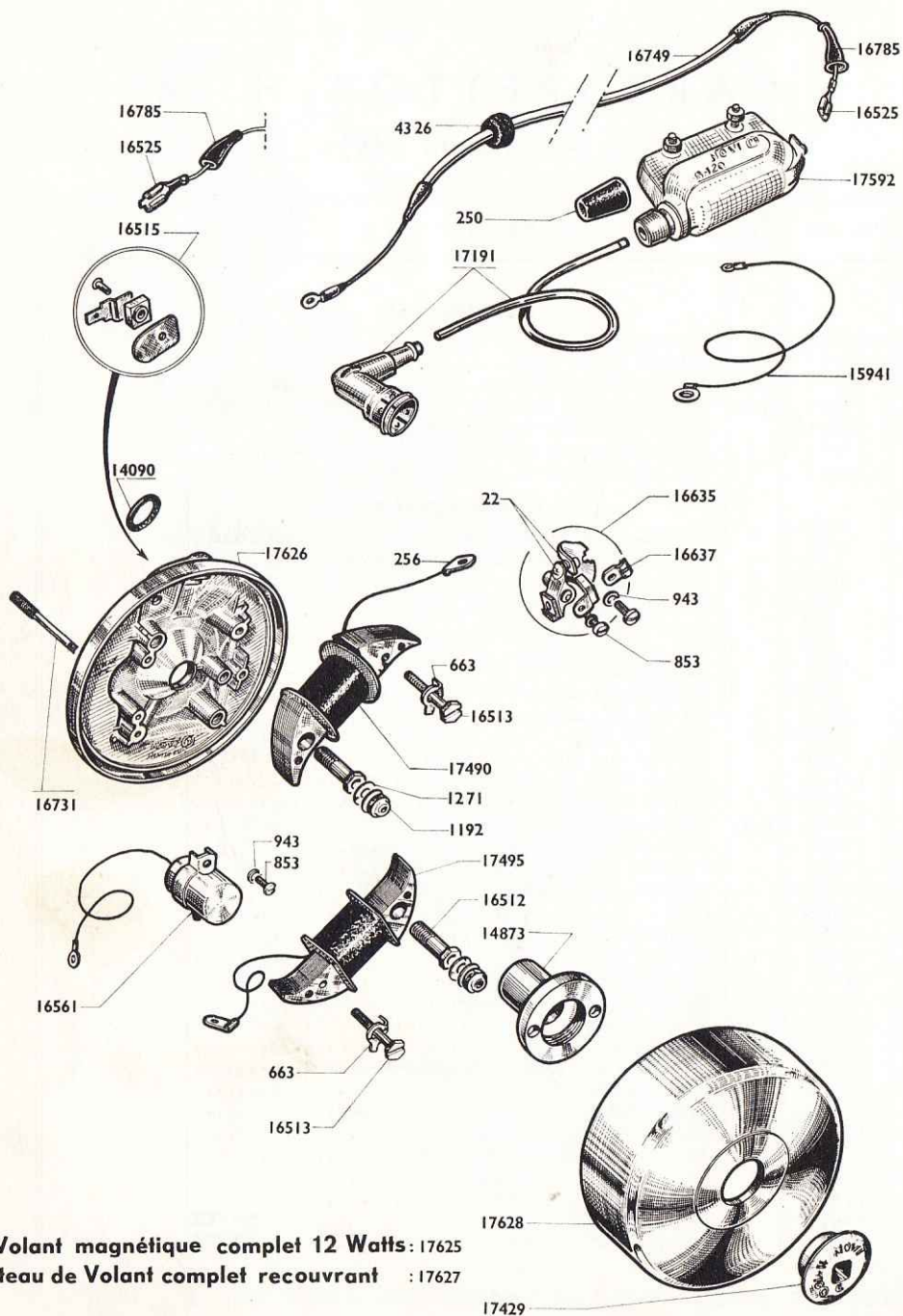

Volant magnétique complet 12 Watts : 17625
 Plateau de Volant complet recouvrant : 17627

Reprinting forbidden

Part N°	Quantity per machine	DESCRIPTION
22	2	Tungsten contact point to be rivetted (Cond.)
250	1	Wire socket cap (Cond.)
256	3	Coil shell (Cond.)
663	2	Locking tab of coil securing screw (Cond.)
853	4	Screw fixing condenser & breaker $4\frac{m}{m} \times 75 \times 10\frac{m}{m}$ long.
943	3	Grower washer $\varnothing 4\frac{m}{m}$ (Cond.)
1192	2	NYLSTOP nut $\varnothing 5\frac{m}{m} \times 75$ (Cond.)
1271	4	Belleville washer $\varnothing 5\frac{m}{m}$ (Cond.)
4326	1	Rubber ring for wire
9190	1	H.T. lead rubber tip
14090	1	Flywheel leakproof washer (Cond.)
14873	1	Cam
15941	1	Complete wiring for earth putting
16512	2	Hollow screw $\varnothing 7,5\frac{m}{m} \times 100 \times 24\frac{m}{m}$ long, securing the coil
16513	2	Screw $\varnothing 4 \times 75 \times 23$ securing the coil
16515	1	Lighting terminal complete
16516	1	Centring ring for coils SEE NOTE
16525	1	Sheel for lighting terminal (Cond.)
16561	1	Condenser
16635	1	Breaker complete
16637	1	Adjusting lever
16731	2	Stator securing stud (Cond.)
16749	1	Connecting wire breaker/coil
16785	2	Rubber tip
17191	1	Radio-suppressor with lead
17429	1	Flywheel lock nut $\varnothing 11 \times 100$
17490	1	Lighting coil
17495	1	Feeding coil
17592	1	Outer ignition coil complete B 120
17625	S.A.	Flywheel magneto complete
17626	1	Flywheel stator stripped (covering type)
17627	S.A.	12 W. flywheel stator complete
17628	1	Rotor complete thick = $40\frac{m}{m}$

NOTE. - **CENTRING RING N° 16.516.** Special tool indispensable for centring the coils when remounting the latter.

S.A. = Sub-assembly (not illustrated).

Reprinting forbidden

89 New Model (Fitting since September 1963) **NOTE**

Copper finish

TELESCOPIC FORK (with headlight \varnothing 130) STEERING HEAD RACES

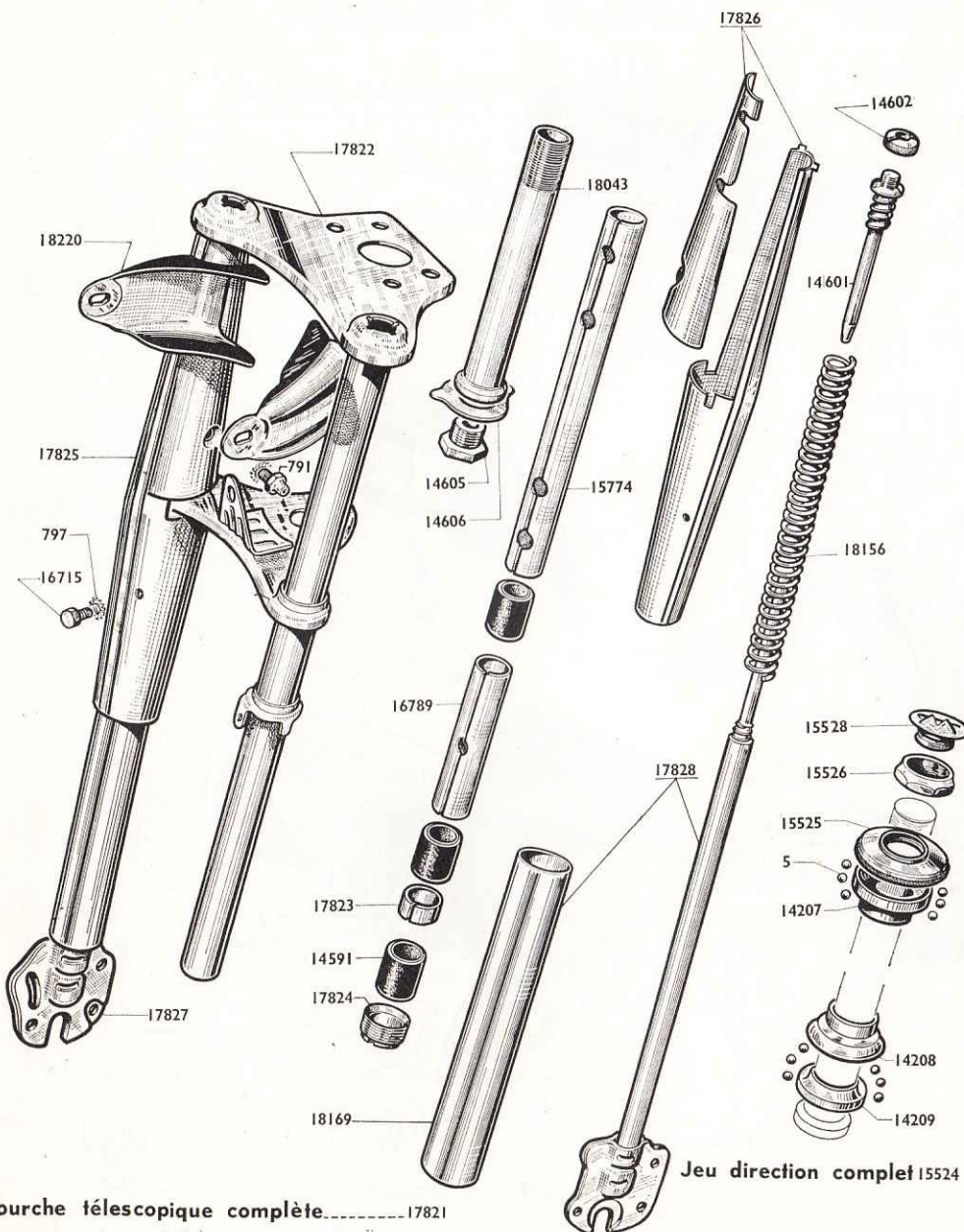

Fourche télescopique complète.....17821

Fourreau assemblé.....17822

Part N°	Quantity per machine	DESCRIPTION
FORK		
791	2	Grease nipple 6×100 (Cond.)
797	6	Washer Nomel \varnothing 6 (Cond.)
14591	6	Fork bush (Cond.)
14601	2	Spring top fastener
14602	2	Spring top nut (Cond.)
14605	1	Pivot screw
14606	1	Pivot screw tab
15528	1	Pivot upper nylon plug
15774	2	Upper distance piece (L = 243 $\frac{m}{m}$)
16715	4	Lower screw holding embellisher 6×100×6,5....
16789	2	Middle distance piece (L = 113 $\frac{m}{m}$).....
17821	S.A.	Telescopic fork complete
17822	1	Sheath assembly
17823	2	Lower distance piece (L = 10 $\frac{m}{m}$)
17825	S.A.	R.H. fork embellisher set
17826	S.A.	L.H. fork embellisher set
17827	1	R.H. plunger assembly with external tube
17828	1	L.H. plunger assembly with external tube
18043	1	Fork pivot (with cone)
18156	2	Sprinkle fork (L = 243 $\frac{m}{m}$)
18169	2	External tube
18220	2	Headlamp bracket (to be welded)
STEERING HEAD RACES		
5	48	Ball 3,96 $\frac{m}{m}$ (Cond.)
14207	1	Upper cone
14208	1	Lower cup.....
14209	1	Lower cone.....
15524	S.A.	Steering head races complete
15525	1	Upper cup.....
15526	1	Steering lock nut

NOTE. - This fork cannot be fitted instead of the former leading fork.

S.A. = Sub-assembly (not illustrated).

MOBYLETTE Type AV 89 or AU 89

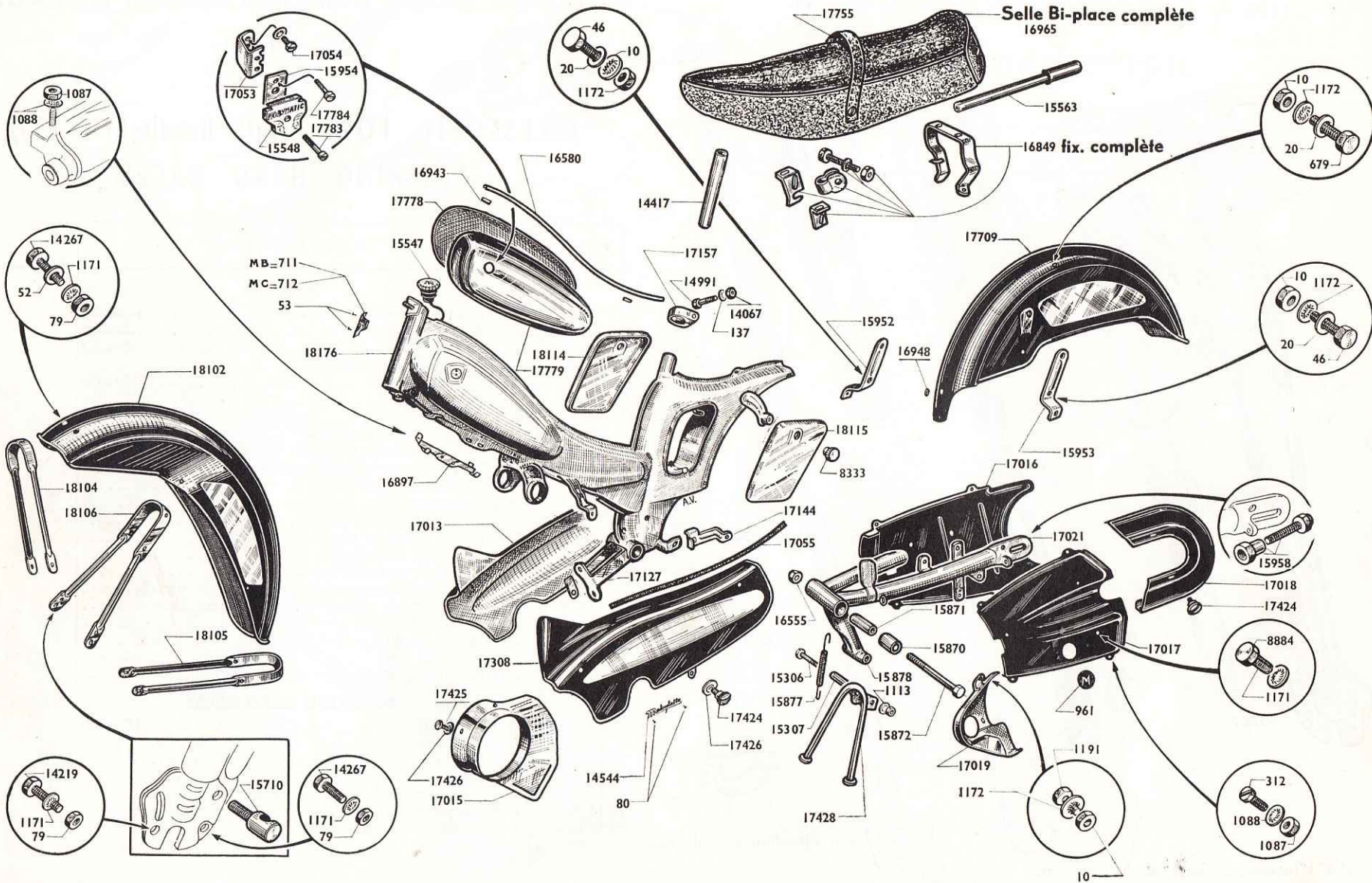

MOBYLETTE Type AV 89 or AU 89

FRAME - MUDGUARDS - CHAINGUARDS - PROPSTAND - FRONT HOOD - REAR SWINGING ARM DUAL SEAT - CYCLE BOLT ATTACHMENT

Part N°	Quantity per machine	DESCRIPTION	Part N°	Quantity per machine	DESCRIPTION
FRAME (copper finish)					
53	2	Grooved nail (Cond.)	17013	1	R.H. chainguard.....
711	1	MB nameplate	17015	1	"DIMOBY" clutch shield.....
712	1	MC nameplate	17016	1	Inside chainguard.....
8333	4	Tool box knob..... (Cond.)	17017	1	Outside chainguard.....
15547	1	Tank plug with dip line.....	17018	1	Lid of the motor chainguard.....
15548	2	"MOBYMATIC" tank badge..... (Cond.)	17019	1	Front chainguard.....
15563	1	Inflator 250 ^m / _m long.....	17055	2	Chainguard beading L = 520 ^m / _m
15954	2	Locating plate (for tank embellisher).....	17144	1	Lower lug for L.H. chainguard.....
16580	1	Tank beading L = 545 ^m / _m	17308	1	L.H. chainguard.....
16897	1	Lug.....	17424	6	Chainguard screw (Cond.)
16943	2	Clamp for tank beading..... (Cond.)	17425	3	Screw securing the "DIMOBY" clutch shield (Cond.)
17053	2	Locating plate for tank embellisher on frame.....	17426	9	Plastic washer for chainguard screw..... (Cond.)
17054	1	Plate securing screw \varnothing 3x60 L = 6 ^m / _m ... (Cond.)	REAR SWINGING ARM		
17127	1	Engine support (to be welded).....	15870	2	Silentblock for rear swinging arm.....
17157	1	Saddle tube clip.....	15871	1	Silentblock distance piece.....
17778	1	R.H. tank embellisher.....	15872	1	Articulation axle.....
17779	1	L.H. tank embellisher.....	15958	2	Rear wheel adjuster 5/90x30..... (Cond.)
17783	2	Screw securing the badge 3x60x17..... (Cond.)	16555	1	"NYLSTOP" nut \varnothing 10x100 (articulation axle).....
17784	2	Screw for locating plate (fixing embellisher) 3x60x15..... (Cond.)	17021	1	Rear swinging arm.....
18114	1	R.H. tool box lid.....	DUAL SEAT		
18115	1	L.H. tool box lid.....	14417	1	Saddle tube.....
18176	1	Frame tank.....	14991	1	Bolt securing the saddle tube clip 8x100x46. (Cond.)
PROPSTAND					
1113	1	"NOMEL" washer \varnothing 7 ^m / _m (Cond.)	16849	S.A.	Fastening complete for dual seat.....
15306	1	Propstand axle bolt with nut..... (Cond.)	16965	S.A.	Dual seat complete.....
15307	1	Bolt distance piece..... (Cond.)	17157	1	Saddle tube clip.....
15877	1	Propstand spring..... (Cond.)	17755	1	Dual seat handle.....
15878	1	Propstand support (to be welded).....	CYCLE BOLT ATTACHMENT		
17428	1	Propstand.....	10	20	Nut 6 ^m / _m x 100..... (Cond.)
MUDGUARDS					
16948	1	Rubber ring for wiring on rear mudguard (Cond.)	20	10	Flat washer \varnothing 6 ^m / _m (Cond.)
17709	1	Rear mudguard for dual seat.....	46	4	Bolt 6x100x11..... (Cond.)
18102	1	Front mudguard stripped.....	52	1	Flat washer \varnothing 5 ^m / _m (Cond.)
18103	1	Set of mudguard stays (front).....	79	1	Nut for bolt 5 ^m / _m x 90..... (Cond.)
18104	1	Front mudguard upper stay.....	137	1	"BLOCFOR" washer \varnothing 8.....
18105	1	Front mudguard lower stay.....	312	4	Screw of 4x75x6 fastening the chainguard.....
18106	1	Front mudguard bridge.....	679	10	Bolt 6x100x16..... (Cond.)
CHAINGUARDS					
80	4	Rivet for "MOBYLETTE" badge on chaing. (Cond.)	1087	4	Nut \varnothing 4x75..... (Cond.)
961	1	Rubber plug.....	1088	4	"NOMEL" washer \varnothing 4..... (Cond.)
14544	2	"MOBYLETTE" badge on chainguards.....	1171	5	"NOMEL" washer \varnothing 5..... (Cond.)
15952	1	Upper lug for R.H. chainguard.....	1172	16	"NOMEL" washer \varnothing 6..... (Cond.)
15953	1	Upper lug for L.H. chainguard.....	1191	6	Bolt 6x100x8..... (Cond.)
			8884	7	Screw of 5x90x8 fastening the engine chainguard.....
			14067	1	Nut 8x100..... (Cond.)
			14219	1	Bolt of 5 ^m / _m x 90 x 15 ^m / _m (Cond.)
			14267	1	Bolt of 5 ^m / _m x 90 x 10 ^m / _m (Cond.)
			14991	1	Bolt securing the saddle tube clip 8x100x46 (Cond.)
			15710	1	Adjuster bolt holding..... (Cond.)

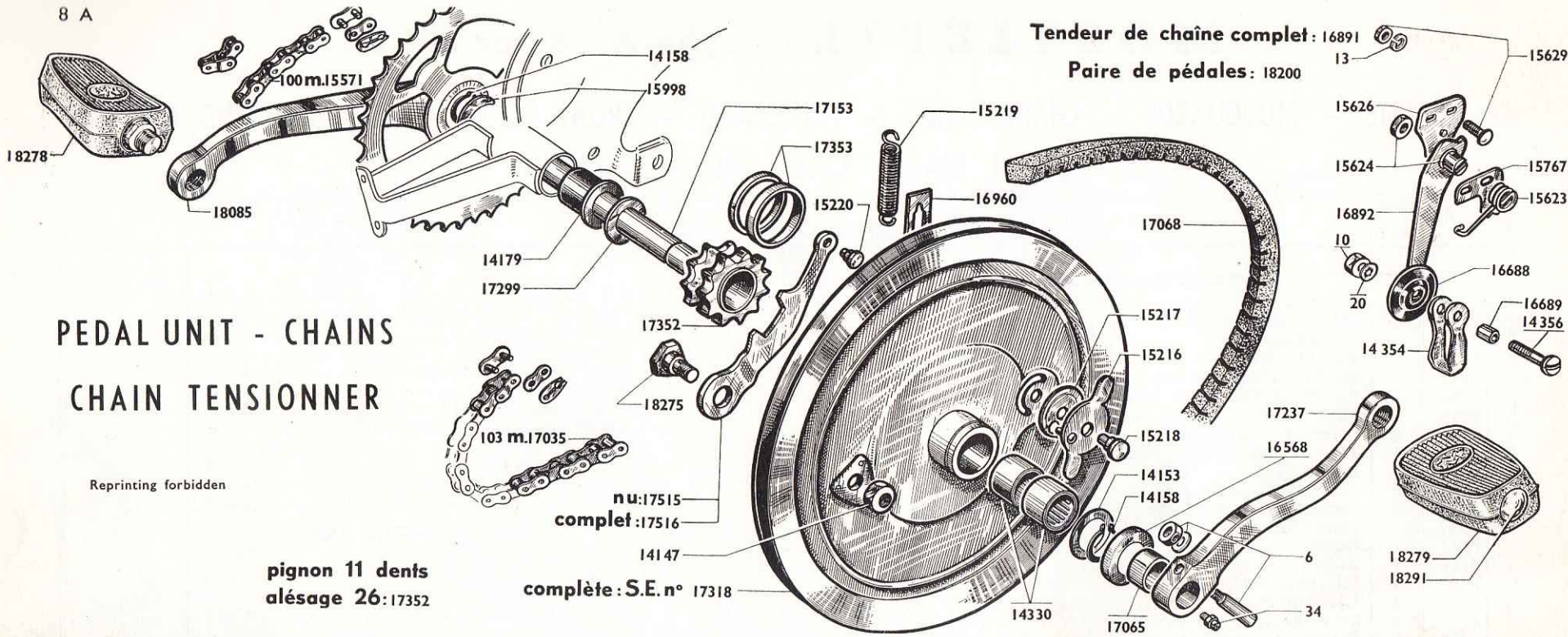

PEDAL UNIT - CHAINS
CHAIN TENSIONNER

Reprinting forbidden

pignon 11 dents
alésage 26:17352

complet: S.E. n° 17318

Part N°	Quantity per machine	DESCRIPTION	Part N°	Quantity per machine	DESCRIPTION
PEDAL UNIT					
6	2	Bracket cotter pin..... (Cond.)	18275	1	Axle with lock lever nut
34	1	Nipple..... (Cond.)	18278	1	R.H. pedal
14147	1	Lever screw nut	18279	1	L.H. pedal
14153	1	Outer bracket washer..... (Cond.)	18291	2	Pedal cap
14158	2	Bracket circlips..... (Cond.)	CHAIN TENSIONER (RILSAN)		
14179	2	Bracket bush.....	13	2	Grower washer \varnothing 5 ^m / _m (Cond.)
14330	2	Needle cartridge (Length 12 ^m / _m).....	20	1	Flat washer \varnothing 6 ^m / _m (Cond.)
15216	1	Lock button.....	14354	1	Roller bridge
15217	1	Button friction washer	14356	1	Roller axle with nut
15218	1	Button axle	15623	1	Chain tensioner spring
15219	1	Lock lever spring..... (Cond.)	15624	1	Tensioner axle with nut.....
15220	1	Lever spring axle	15626	1	Chain tensioner support
15998	1	Bracket thrust washer 16,5×25×10/10..... (Cond.)	15629	2	Bolt securing chain tensioner.....
16568	1	Bracket oil deflector	15767	1	Tensioner spring stop lug
16960	1	Limitator stroke	16688	1	Chain tensioner roller complete
17065	1	L.H. crank distance piece, 10 ^m / _m thick..... (Cond.)	16689	1	Roller distance piece \varnothing 8 ^m / _m - L. 10,5.....
17068	1	Notched belt 18×8	16891	S.A.	Chain tensioner complete
17153	1	Bracket axle	16892	1	Chain tensioner lever stripped
17237	1	L.H. crank arm.....	CHAINS (SEE NOTE)		
17299	1	Bracket thrust washer \varnothing 16,5×37×8/10	14364	1	Cranked link for transmission chain Yellow.....
17318	S.A.	Bracket pulley compl. with sprocket needle cartridge	14365	1	Cranked link for pedal chain
17352	1	Bracket sprocket not reversible 11 teeth \varnothing 26 ^m / _m	14367	1	Spring link for transmission chain Yellow
17353	S.A.	Set of rubber rings (2)	14368	1	Spring link for pedal chain.....
17515	1	Lock lever stripped	14565	1	Cranked link for engine transmis. chain Brampton.....
17516	S.A.	Lock lever complete	14875	1	Spring link for engine transmis. chain Brampton ..
18085	1	R.H. crank arm with sprocket set in, 32 teeth	15571	1	Pedal unit transmission chain (100 links)
18200	S.A.	Pair of pedals "profil"	17035	1	Engine transmission chain (103 links)

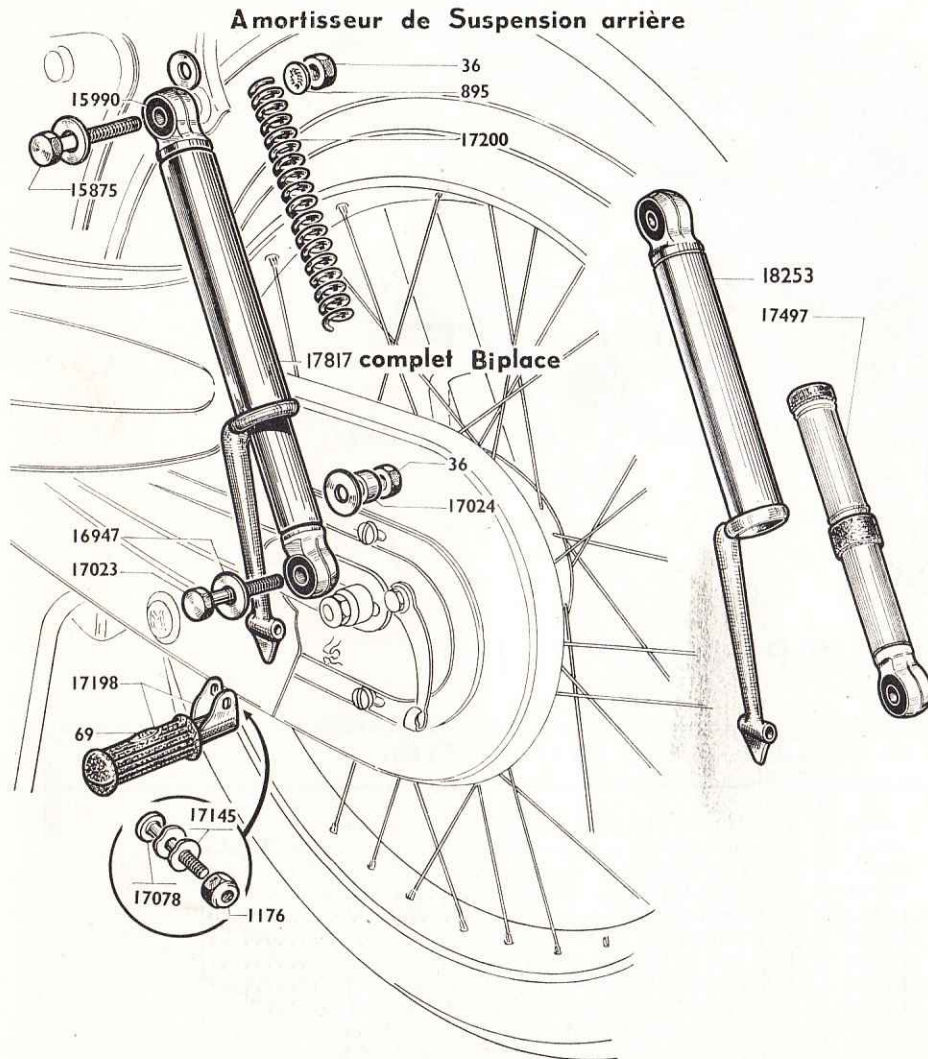

REAR SUSPENSION SHOCK ABSORBERS

Part N°	Quantity per machine	DESCRIPTION
REAR SUSPENSION SHOCK ABSORBERS		
36	4	Nut \varnothing 8/100
69	2	Rubber for footrest
895	2	BLOCFOR washer \varnothing 8
1176	2	NYLSTOP nut \varnothing 6 (Cond.)
15875	2	Shock absorber upper axle with nut \varnothing 8/100 \times 56
15990	4	Silentblock with distance piece
16947	8	Washer 8,5 \times 24 \times 1,5
17023	2	Shock absorber lower axle with nut 8 \times 100 \times 39 ..
17024	2	Lower axle distance piece \varnothing 8 \times 16, thick = 5 $\frac{m}{m}$..
17078	2	Footrest axle \varnothing 6 \times 100 \times 30
17145	4	ONDUFLEX washer \varnothing 6,4 \times 12 thicknes = 5/10 (Cond.)
17198	S.A.	Footrest complete (with rubber and axle)
17200	2	Shock absorber spring (twin seater type) 45/10 $\frac{m}{m}$..
17497		Lower element of shock absorber
17817	S.A.	Shock absorber complete dual seater type
18253		Upper element of shock absorber

REPAIR OF SHOCK ABSORBER

1° Unscrew both elements.

If the spring is broken, pull it with another spring screwed in.

2° Replace the new spring with the BP ENERGREASE C 3 G.

3° Screw the second part of the shock absorber on the spring.

S.A. = Sub-assembly (not illustrated).

MOBYLETTE Type AV 89 or AU 89

moyeu avant complet 17854

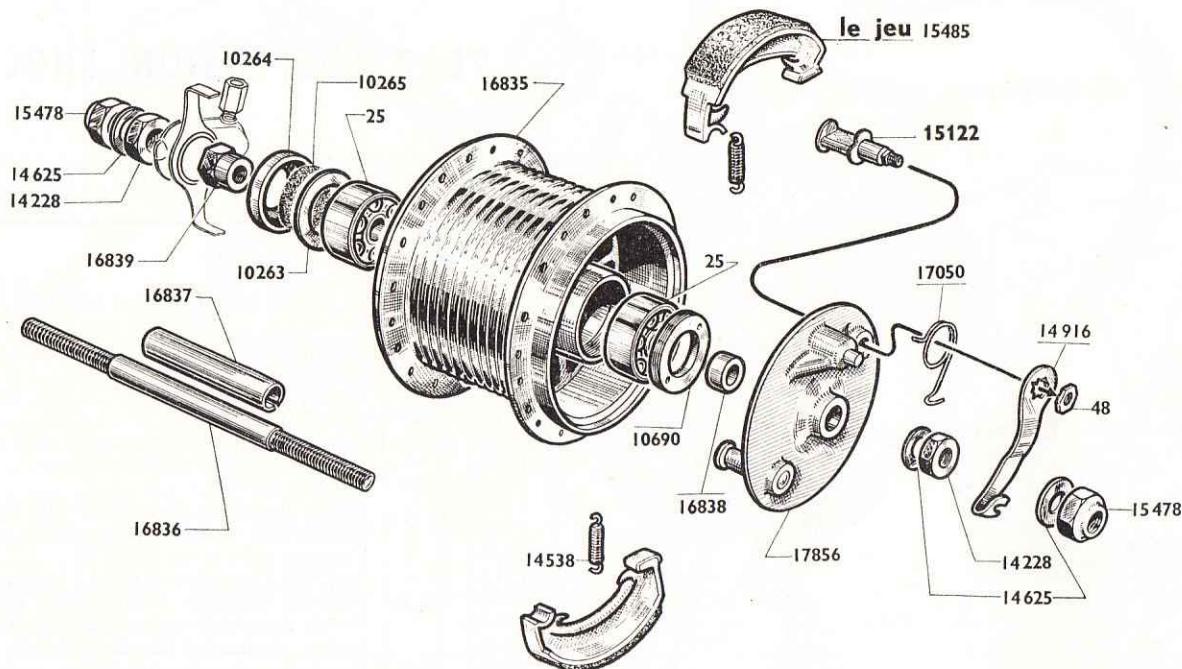

Reprinting forbidden

FRONT WHEEL AND HUB "PRIOR" Ø 100

Part N°	Quantity per machine	DESCRIPTION	Part N°	Quantity per machine	DESCRIPTION
FRONT WHEEL					
15897	1	Inner tube 22,5×2,25	14228	2	Nut Ø 11×100
15904	36	Spoke nipple, Fr. gauge 17	14538	2	Jaw spring
15977	36	Spoke 17×15×17 L = 180	14625	3	Flat washer
16841	1	Rim tape	14916	1	Cam lever
16975	1	Rim 18×1,42	15122	1	Cam with nut
17122	1	White wall tyre 18×2,25	15478	2	Wheel nut Ø 11 ^m / _m
18116	S.A.	Front wheel complete	15485	1	Pair of jaws Ø 100 ^m / _m
HUB					
25	2	Ball bearing 32×12×10	16835	1	Front hub body stripped
48	1	Cam securing screw 8×100	16836	1	Front hub axle stripped Ø 12 ^m / _m
10263	1	Ball bearing flange	16837	1	Ball bearing distance piece Ø 12,5 long 43 ^m / _m
10264	1	Dust deflector Ø 32	16838	1	Flange distance piece Ø 12×17 L = 6 ^m / _m
10265	1	Felt	16839	1	Hub locking nut Ø 11 ^m / _m
10690	1	Ball bearing lock nut (L.H. threaded)	17050	1	Cam lever spring
			17854	S.A.	Front hub complete Ø 100 ^m / _m
			17855	S.A.	Jaw flange complete
			17856	1	Jaw flange stripped

Reprinting forbidden

MOBYLETTE Type AV 89 or AU 89

moyeu arrière complet 17044

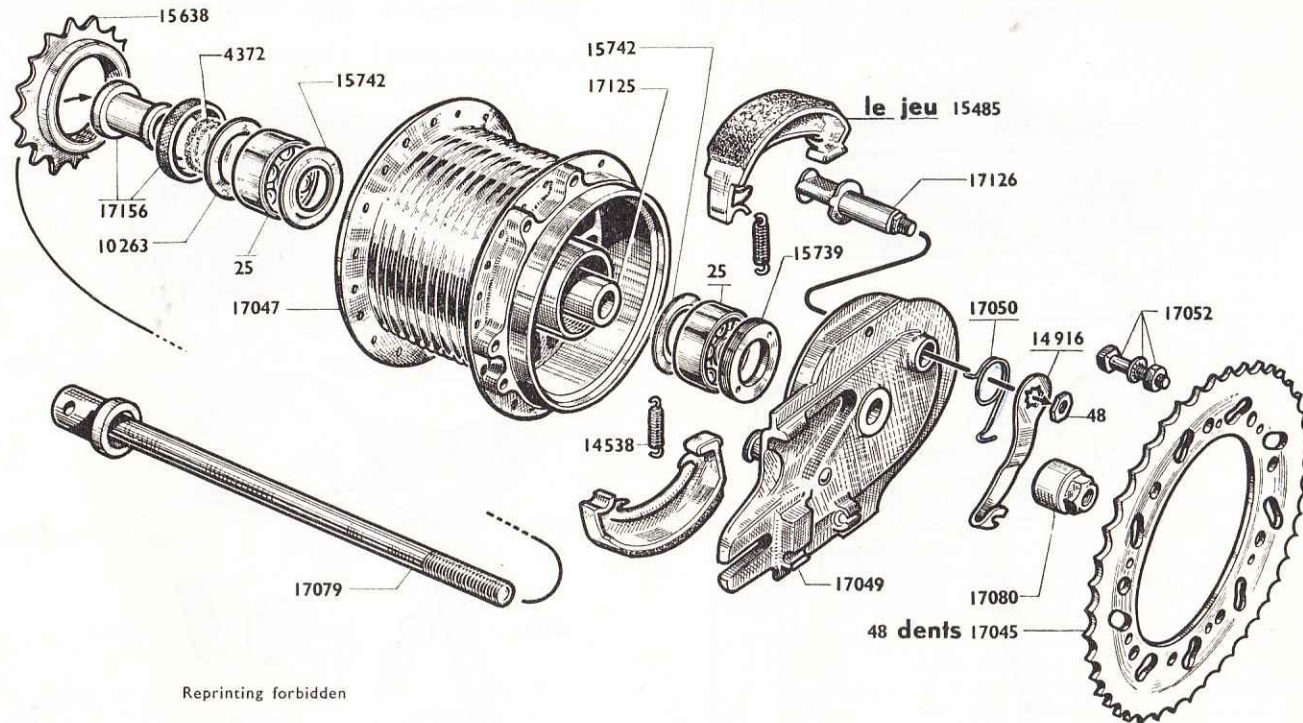

Reprinting forbidden

REAR WHEEL AND REAR HUB "PRIOR"

Part N°	Quantity per machine	DESCRIPTION	Part N°	Quantity per machine	DESCRIPTION
WHEEL					
15897	1	Inner tube 22,5×2,25	15485	1	Pair of jaws
15904	36	Spoke nipple, French gauge 17	15638	1	Free wheel 20 teeth \varnothing 36/100
15977	36	Spoke French gauge 17×15 - 180 $\frac{m}{m}$ long. (Cond.)	15739	1	Ball bearing lock nut (RH thread)
16841	1	Rim tape	15742	2	Washer securing the ball bearing distance piece
16975	1	Rim 18×1,42	17044	S.A.	Rear hub complete with sprocket 48 teeth
17043	S.A.	Rear wheel complete with 48 teeth sprocket bolted	17045	1	Rear transmission sprocket 48 teeth
17122	1	White wall tyre 18×2,25 (reinforced)	17046	S.A.	Rear hub body complete (without transmis. sproket)
HUB					
25	2	Ball bearing 32×12×10	17047	1	Rear hub body stripped
48	1	Cam nut 8 $\frac{m}{m}$ ×100	17048	S.A.	Rear hub flange complete
4372	1	Felt	17049	1	Rear hub flange stripped
10263	1	Washer securing the ball bearing	17050	1	Spring of cam lever
14538	2	Jaw spring	17052	6	Square head bolt secur. the trans. sprocket 6×100×27
14916	1	Cam lever	17079	1	Rear hub spindle \varnothing 12 L = 170 $\frac{m}{m}$
			17080	1	Spindle nut \varnothing 12
			17125	1	Bolt bearing distance piece inner \varnothing 12×16 L = 67
			17126	1	Cam rear brake
			17156	1	Knurled dust deflector with ball bearing

MOBYLETTE

Type AV 89 or AU 89

Selle complète 16798 Reydel

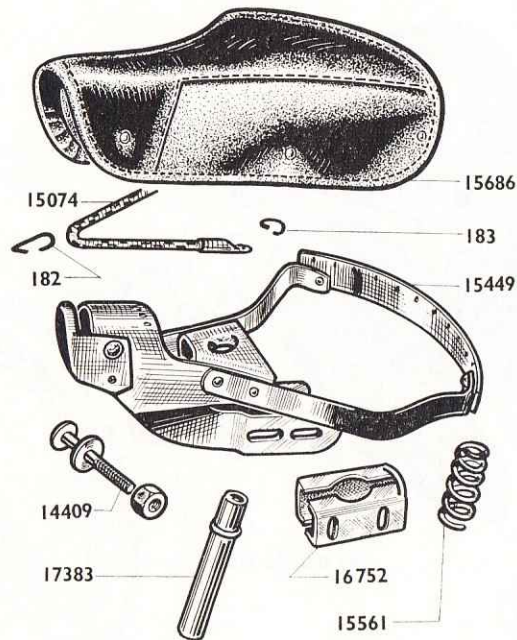

Selle complète 16798 Vidal

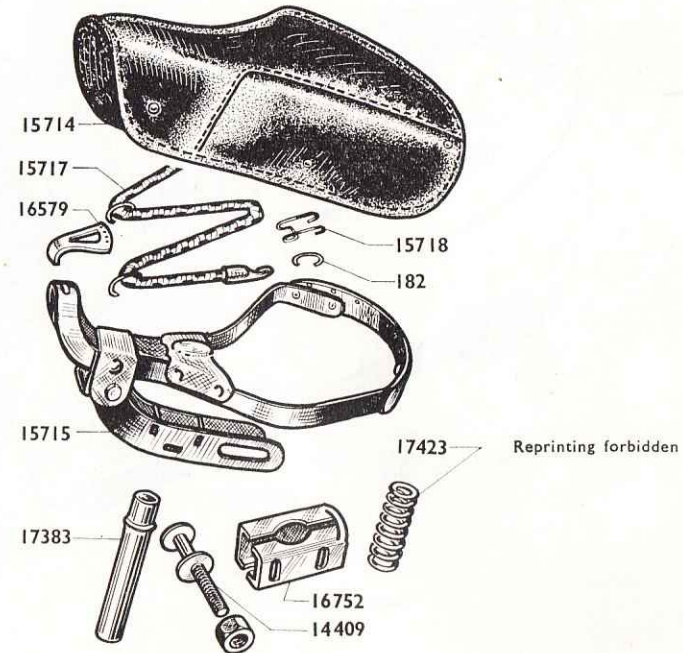

SADDLES (Vidal and Reydel)

Part N°	Quantity per machine	DESCRIPTION	Part N°	Quantity per machine	DESCRIPTION
SADDLE REYDEL					
182	4	Long hook for elastic piece	182	6	Long hook of elastic piece
183	8	Short hook for elastic piece	14409	2	Saddle clip bolt
14409	2	Saddle clip bolt	15714	1	Saddle cover (grey)
15074	1	Set of elastic pieces	15715	1	Saddle frame
15449	1	Saddle frame	15717	1	Elastic piece
15561	1	Saddle spring	15718	4	Rear hook for elastic piece
15686	1	Saddle cover (grey)	16579	1	Saddle nozzle distance piece
16752	1	Saddle clip	16752	1	Saddle clip \varnothing 25,8
16798	S.A.	Saddle complete Reydel (single spring)	16798	S.A.	Saddle complete Vidal (single spring)
17383	1	Saddle tube	17383	1	Saddle tube
			17423	1	Saddle spring \varnothing outer = 32 - Length complete 75 ^{mm} / _m

NOTE. - Saddle complete N° 16798 : it can be supplied a complete saddle either Reydel or Vidal, according to our supplies.

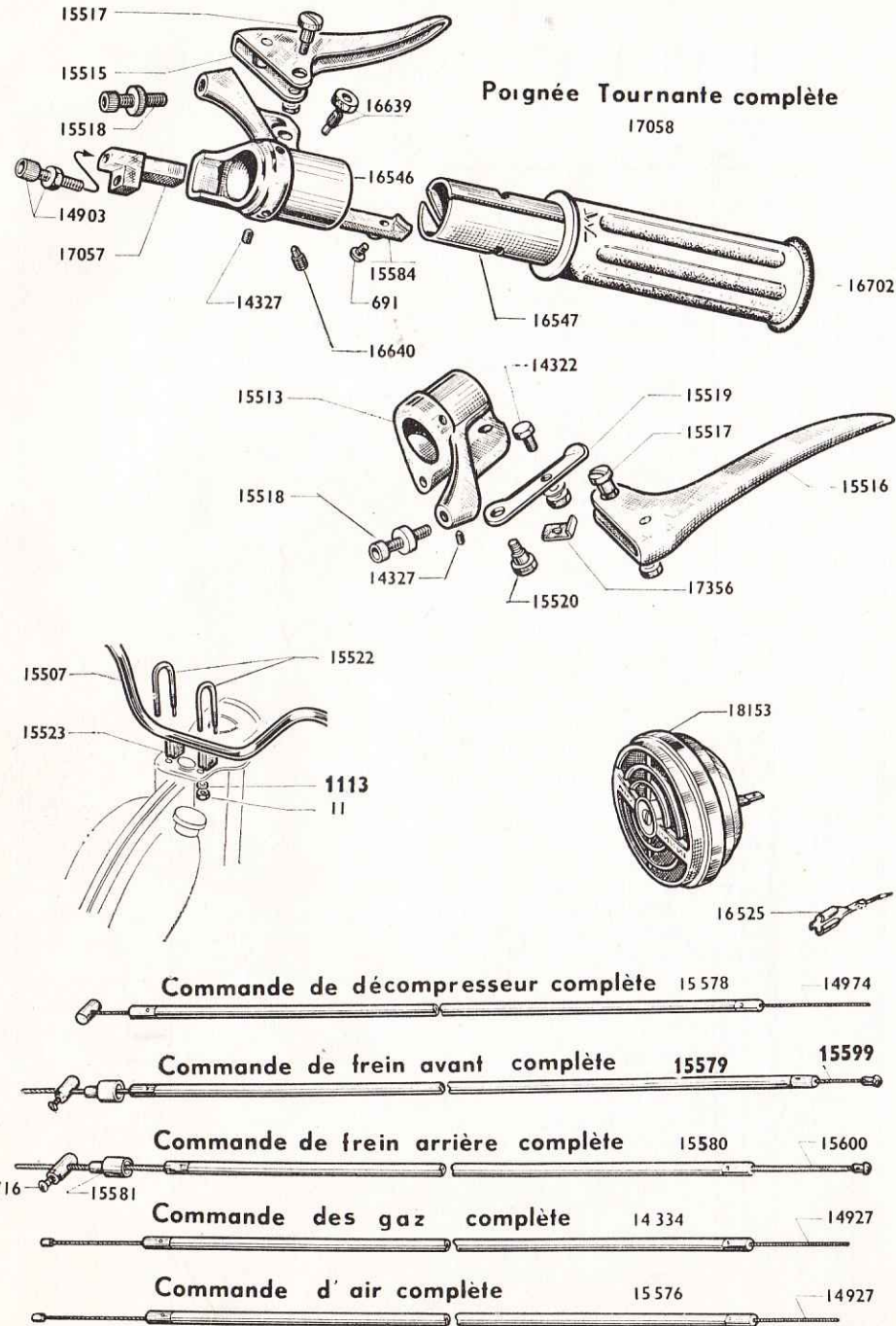

HANDLEBARS - CONTROLS - HORN

Part N°	Quantity per machine	DESCRIPTION
HANDLEBARS and TWIST GRIP		
11	3	Nut 7 ^m / _m × 100 holding handlebars U clamp (Cond.)
691	2	Slide screw ø 4 ^m / _m × 75 - 9 ^m / _m long (Cond.)
1113	2	NOMEL washer ø 7 (Cond.)
14322	1	Choke cable bolt (Cond.)
14327	5	Set screw for twist grip body ø 5 ^m / _m × 90 - 7 ^m / _m long (Cond.)
14903	1	Decompressor adjuster (Cond.)
15507	1	Handlebars stripped
15513	1	L.H. grip body
15515	1	R.H. brake lever
15516	1	L.H. brake lever
15517	2	Lever axle with nut (Cond.)
15518	2	Adjuster nipple for brake lever with nut (Cond.)
15519	1	Choke lever (Cond.)
15520	1	Choke lever pin (Cond.)
15521	S.A.	Complete fastening of handlebars on front fork ...
15522	2	U clamp holding handlebars
15523	2	U clamp wedge
15584	1	Throttle slide
15712	S.A.	Choke lever complete
15991	S.A.	L.H. grip body complete with brake and choke levers
16546	1	Twist grip body
16547	1	Twist grip sleeve
16639	1	Securing screw with nut ø 5 ^m / _m × 90, 12 ^m / _m 5 long (Cond.)
16640	1	Twist grip set screw ø 6 ^m / _m × 100, 11 ^m / _m long (Cond.)
16702	2	Rubber grip (grey)
17057	1	Decompressor slide
17058	S.A.	Twist grip complete (grey rubber)
17356	1	Protector of choke control (Cond.)
17589	1	Handlebar fittings
CONTROLS		
716	2	Front and rear brake cable clamp (Cond.)
14334	1	Throttle control complete
14762	3	Plastic outer casing
14927	1	Throttle cable (Cond.)
14927	1	Choke cable (Cond.)
14974	1	Decompressor cable (Cond.)
15576	1	Choke control complete
15578	1	Decompressor control complete
15579	1	Front brake control complete
15580	1	Rear brake control complete
15599	1	Front brake cable
15600	1	Rear brake cable
HORN		
16525	1	Wiring clip
18153	1	Horn "Transval"

S.A. = Sub-assembly (not illustrated).

20533

MOBYLETTE Type AV 89 or AU 89

LIGHTING - SPEEDOMETER

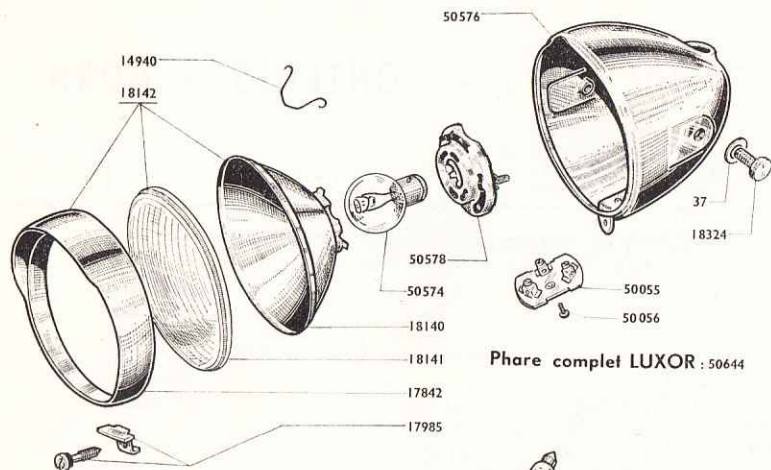

Phare complet LUXOR : 50644

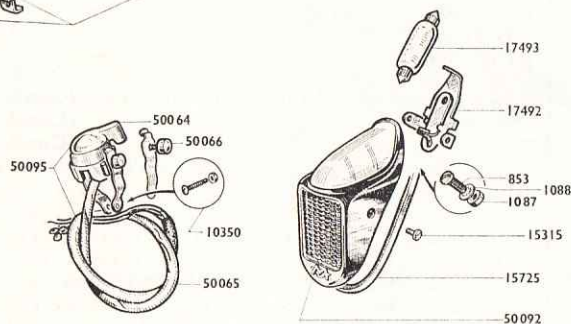

Lanterne arrière complète: 50138

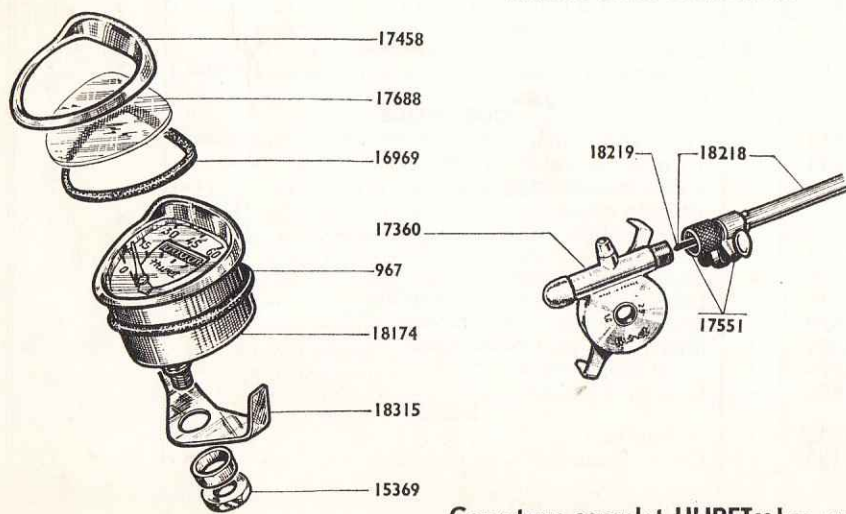

Compteur complet HURET 90 km: 18173

Reprinting forbidden

Part N°	Quantity per machine	DESCRIPTION
LUXOR HEADLAMP		
37	2	Flat washer \varnothing 8
10350	1	Switch securing screw
14940	6	Clip securing the head light reflector
17842	1	Headlamp rim
17985	1	Clip securing the head light rim
18140	1	Reflector
18141	1	Headlamp glass
18142	S.A.	Optical assembly (without bulb support)
18324	2	Side securing screw (\varnothing 8 \times 125 L = 12)
50055	1	Terminal plate
50056	1	Terminal plate screw
50064	1	Switch complete without wiring
50065	1	Wiring
50066	1	Switch button complete
50095	1	Switch complete with wiring
50574	1	Bulb 6 V. 1 A. dual filament
50576	1	Headlamp shell
50578	1	Bulb support
50644	S.A.	Headlamp complete \varnothing 130
TAIL LIGHT		
853	1	Screw fixing tail light socle 4 \times 75 \times 10 (Cond.)
1087	1	Nut fixing tail light socle \varnothing 4 \times 75
1088	1
15315	2	Cover screw \varnothing 3 \times 60 L = 8
15725	1	Rubber gasket
17492	1	Tail light socle
17493	1	Tail light bulb 12 V. 15 W.
50092	1	Tail light cover with gasket
15138	S.A.	Tail light complete
SPEEDOMETER 90 KM (HURET)		
967	1	Speedometer gasket
15369	1	Securing lug nut
16969	1	Speedometer glass gasket
17360	1	Front wheel drive
17458	1	Speedometer rim
17688	1	Speedometer glass
18173	1	Speedometer complete 90 km
18174	1	Speedometer head 90 km
18218	1	Speedometer control 0,572 long
18219	1	Speedometer cable 0,596 long
18315	1	Speedometer securing lug

S.A. = Sub-assembly (not illustrated).

Reprinting forbidden

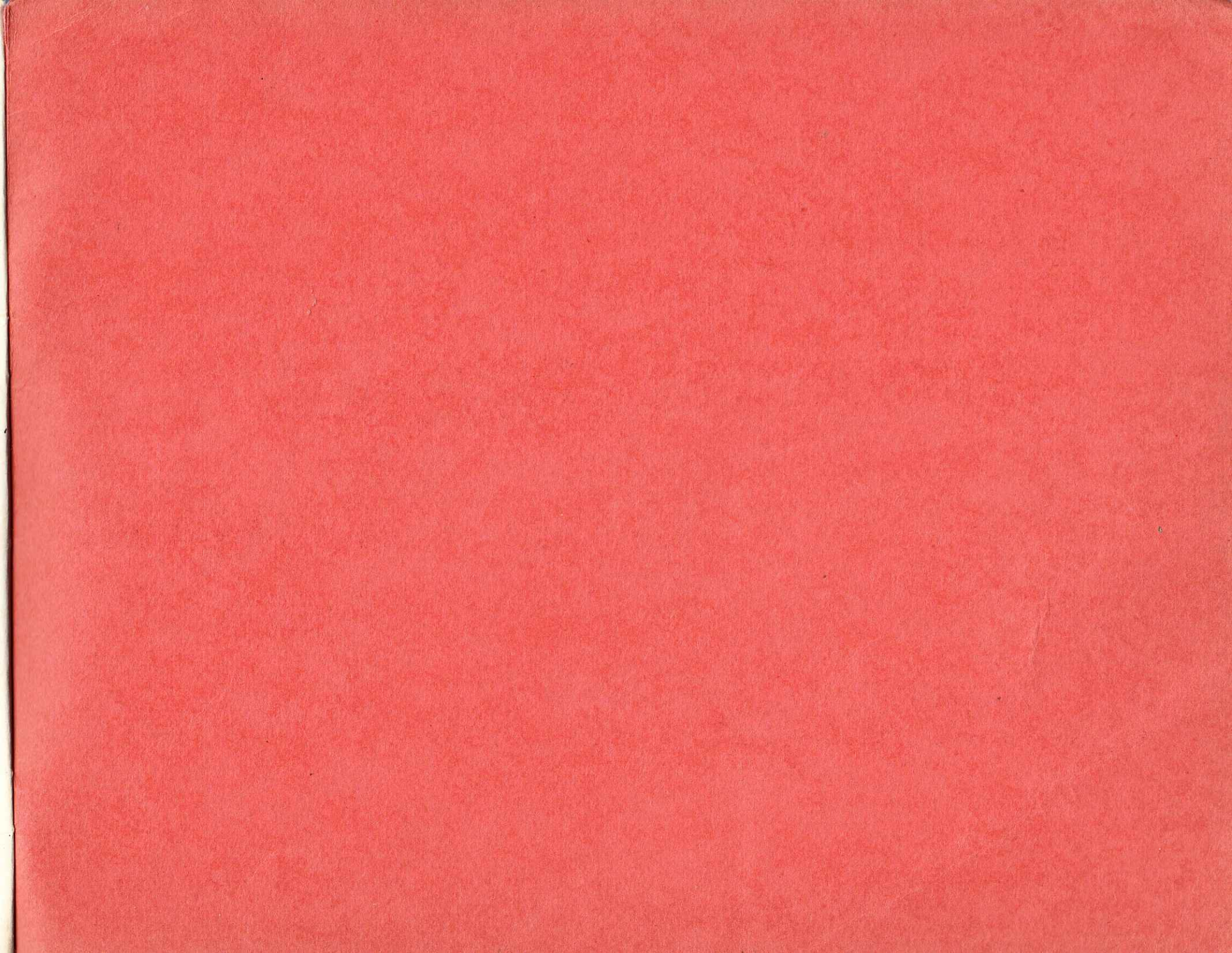



MORE MODELS OF MOBYLETTES AVAILABLE

More than

4.500.000 "Mobylette"

in the World

World's biggest production!

 Produced by MOTOBECANE-MOTOCONFORT, 16, Rue Lesault, PANTIN (Seine) FRANCE - P.O. Box 202 

IceniCAM On-Line Library

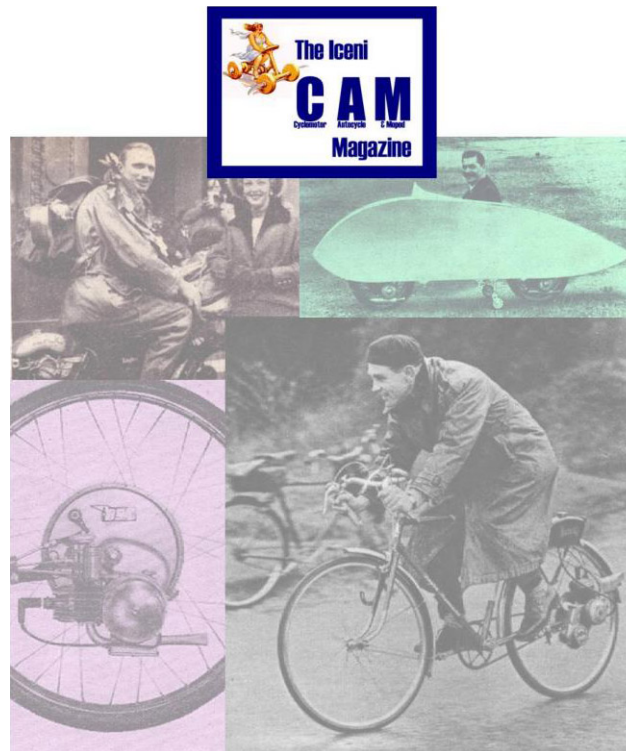

www.icenicam.org.uk