

Mobylette

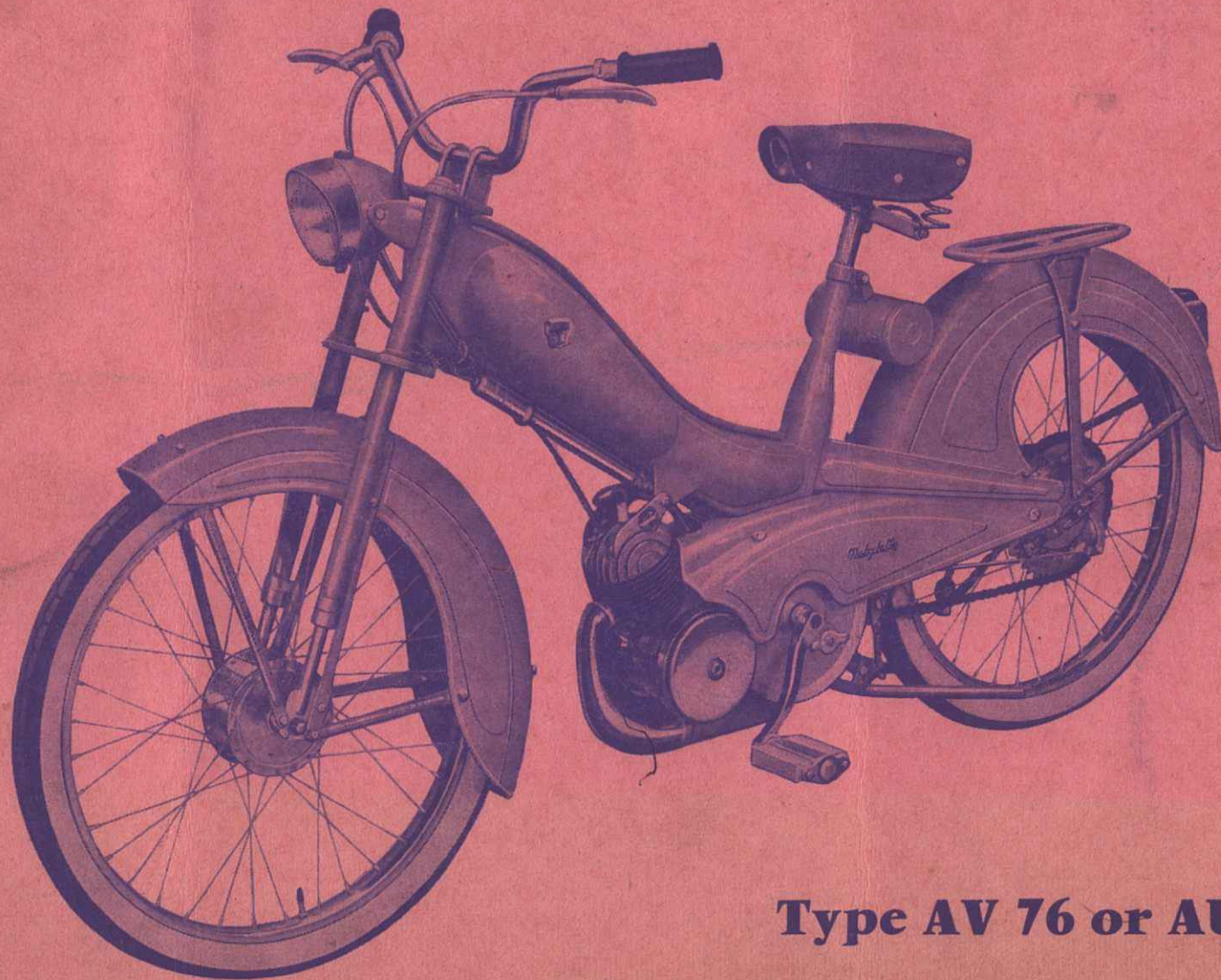

Type AV 76 or AU 76



Produced by MOTOBECANE · MOTOCONFORT, 16, Rue Lesault, PANTIN (Seine) FRANCE · P.O. Box ■ 59

Mobylette

TABLE OF CONTENTS

Type AV 76 or AU 76

DESCRIPTION	SHEET	DESCRIPTION	SHEET
Engine unit - Exhaust - Engine attachment...	2 A	Front wheel and hub ("IDEAL" former model).	13 A
" DIMOBY " clutch (Former model)	3 A	Rear wheel and hub ("IDEAL" former model).	14 A
" DIMOBY " clutch (Latest model)	4 A	Rear wheel and hub ("PRIOR" former model)	15 A
Carburettor (flange attachment) - Tap	5 A	Front wheel and hub ("IDEAL" Monobloc, new model)	16 A
Carburettor (clip attachment) - Tap	6 A	Rear wheel and hub ("IDEAL" Monobloc, new model)	17 A
Flywheel magneto (first model)	7 A	Front wheel and hub ("PRIOR" Monobloc, new model)	18 A
Flywheel magneto (second model).....	8 A	Rear wheel and hub ("PRIOR" Monobloc, new model)	19 A
Frame - Mudguards - Chainguards - Luggage carrier - Saddle - Attachment	9 A	Handlebars - Controls.....	20 A
Front fork - Head races	10 A	Lighting equipment.....	21 A
Pedal unit (former mounting).....	11 A		
Pedal unit (new mounting)	12 A		

The numbers of mechanical assemblies are not shown on the drawings. For your guidance, each assembly is quoted S.A. in the lists of spares.

At the time of modification in parts or mechanical units, we shall issue a corresponding sheet to be slipped in the present catalogue. It will bear the same sheet number as the concerned part or unit but with a different letter, for instance 2B, 2C, 2D in case of three successive modifications.

MOBYLETTE Type AV 76 or AU 76

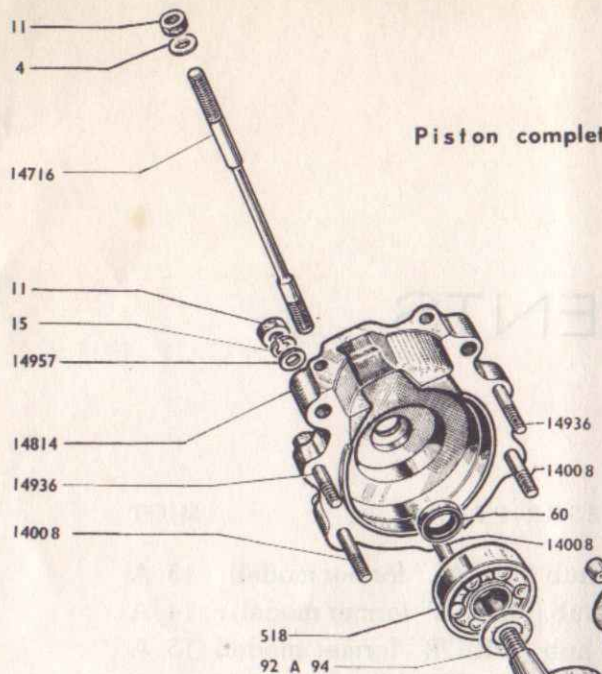

Piston complet 14819

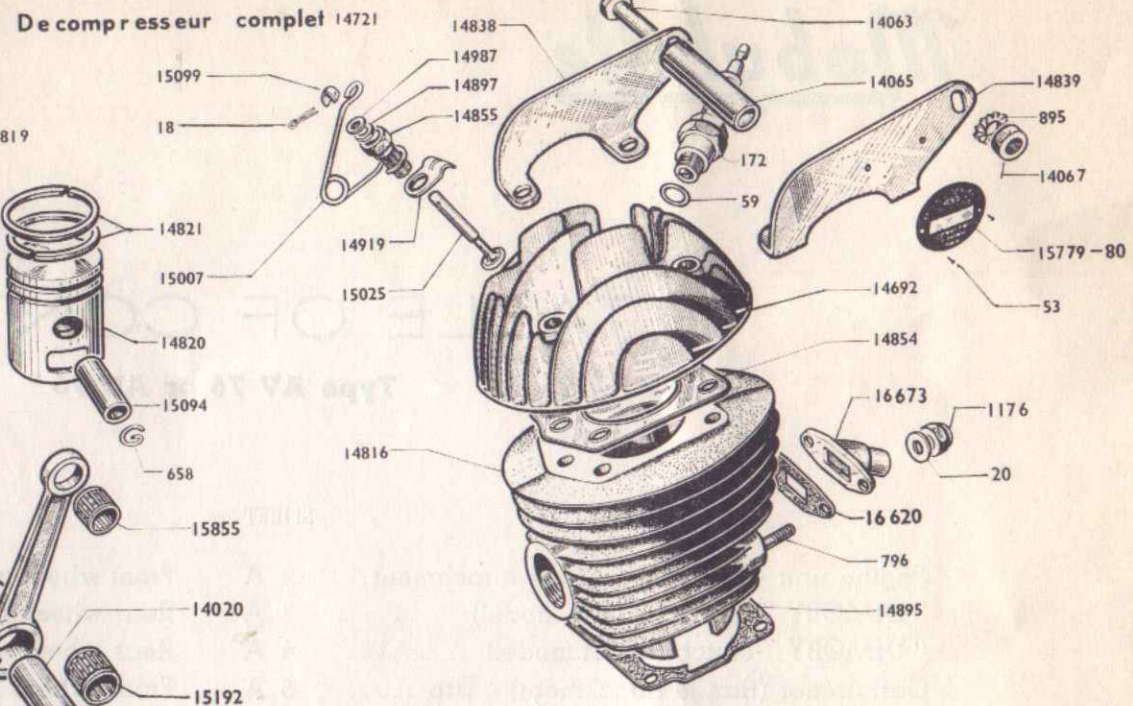

De compresseur complet 14721

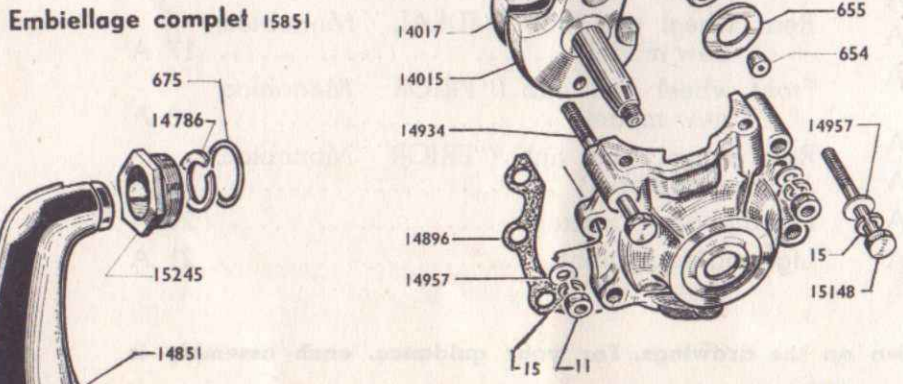

Embiellage complet 15851

échappement complet 15442

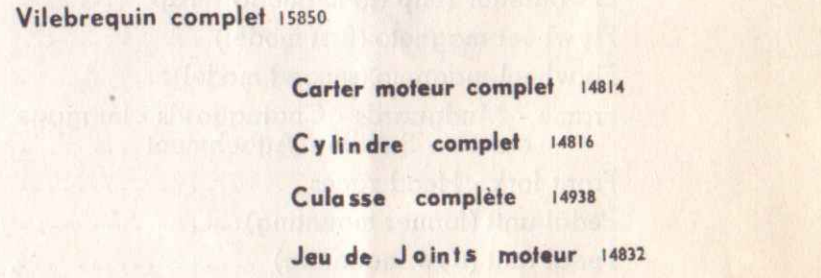
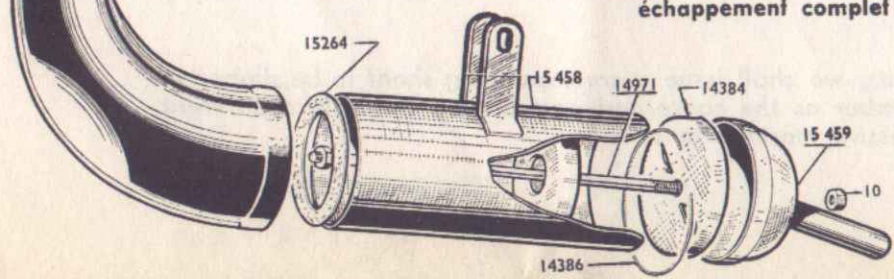

Vilebrequin complet 15850

- Carter moteur complet 14814**
- Cylindre complet 14816**
- Culasse complète 14938**
- Jeu de Joints moteur 14832**

MOBYLETTE Type AV 76 or AU 76

ENGINE UNIT - UPPER and LOWER SPRING ATTACHMENT - EXHAUST

SEPTEMBER 1959

Part N°	Group	Quantity per machine	DESCRIPTION	Part N°	Group	Quantity per machine	DESCRIPTION
4	5	4	Flat washer $\varnothing 7 \frac{m}{m}$	14839	5	1	L.H. cylinderhead lug
10	5	2	Nut of $6 \frac{m}{m} \times 100$	14854	5	1	Cylinderhead gasket
11	5	6	Nut of $7 \frac{m}{m} \times 100$	14855	5	1	Decompressor body
15	5	6	Grower washer $\varnothing 7 \frac{m}{m}$	14895	5	1	Cylinder gasket
18	5	1	Decompressor split pin $1,5 \frac{m}{m} \times 30 \frac{m}{m}$	14896	5	1	Crankcase gasket
20	5	2	Flat washer $\varnothing 6 \frac{m}{m}$	14897	5	1	Decompressor valve gasket
53	5	2	Grooved nail	14919	4	1	Anchoring lug
59	3	1	Spark-plug gasket	14934	5	1	Bolt of $7/100 \times 70 \frac{m}{m}$
60	5	2	Leakproof gasket for crankcase	14936	5	2	Bolt of $7/100 \times 30 \frac{m}{m}$
92	5	5	Thrust washer $1/10 \frac{m}{m}$	14938	3	S.A.	Cylinderhead with decompressor fitted
93	5	5	Thrust washer $2/10 \frac{m}{m}$	14957	5	7	Flat washer $\varnothing 7 \frac{m}{m}$ for crankcase bolt
94	5	5	Thrust washer $3/10 \frac{m}{m}$	14987	5	1	Washer for valve gasket
172	3	1	Sparkplug $14 \frac{m}{m}$ with gasket	15007	5	1	Decompressor spring
518	5	2	Crankshaft ball bearing	15025	5	1	Decompressor valve
654	5	2	Crankpin plug	15094	3	1	Piston pin original size
655	5	2	Crankpin washer	15099	5	1	Valve link
658	3	2	Gudgeon pin circlips	15148	5	1	Screw $7/125 \times 45 \frac{m}{m}$
796	5	2	Inlet pipe stud	15192	3	1	Big end needle cartridge
895	3	2	Blocfor washer $\varnothing 8 \frac{m}{m}$	15779	5	1	Motobecane number plate
1176	5	2	Nylstop nut $6 \frac{m}{m} \times 100$	15780	5	1	Motoconfort number plate
14007	5	2	Engine lower bracket	15850	3	S.A.	Crankshaft complete
14008	5	3	Bolt $7/100 \times 47 \frac{m}{m}$	15851	3	S.A.	Connecting rod complete
14015	3	1	Crankshaft weight clutch side	15855	3	1	Small end needle cartridge
14017	3	1	Crankshaft weight, flywheel side	16620	4	1	Inlet pipe gasket
14020	3	1	Crankpin	16673	2	1	Reinforced inlet pipe
14063	5	1	Upper axle holding engine, with nut				EXHAUST
14064	5	1	Lower axle holding engine, with nut	10	5	2	Nut of $6 \frac{m}{m}/100$
14065	5	1	Upper axle distance piece	675	5	1	Exhaust gasket
14066	5	1	Lower axle distance piece	14384	1	1	Baffling device plate
14067	5	2	Nut of axles holding engine	14386	1	1	Asbestos thread gasket for baffling device
14692	3	1	Cylinderhead stripped	14786	5	1	Nut thrust ring
14716	5	4	Stud holding cylinder and cylinderhead	14851	1	1	Exhaust pipe blunderbuss type
14721	5	S.A.	Decompressor complete	14971	5	1	Silencer central rod
14814	1	1	Crankcase with leakproof gasket	15245	5	1	Exhaust nut
14816	3	1	Cylinder with piston complete matched	15264	5	1	Blunderbuss exhaust pipe gasket
14819	3	S.A.	Flat piston complete	15442	1	S.A.	Exhaust complete (W. or T.)
14820	3	1	Piston stripped with pin	15457	1	S.A.	Silencer complete (W.)
14821	3	2	Piston ring	15458	1	1	Silencer body (W.)
14832	2	S.A.	Set of engine gaskets	15459	1	1	Exhaust tail cover with baffling device
14838	5	1	R.H. cylinderhead lug				

S.A. = Sub-assembly (not illustrated).

Reprinting forbidden

MOBYLETTE

Type AV 76 or AU 76

Embrayage complet Dimoby 15378

"DIMOBY" CLUTCH (former model)

SEPTEMBER 1959

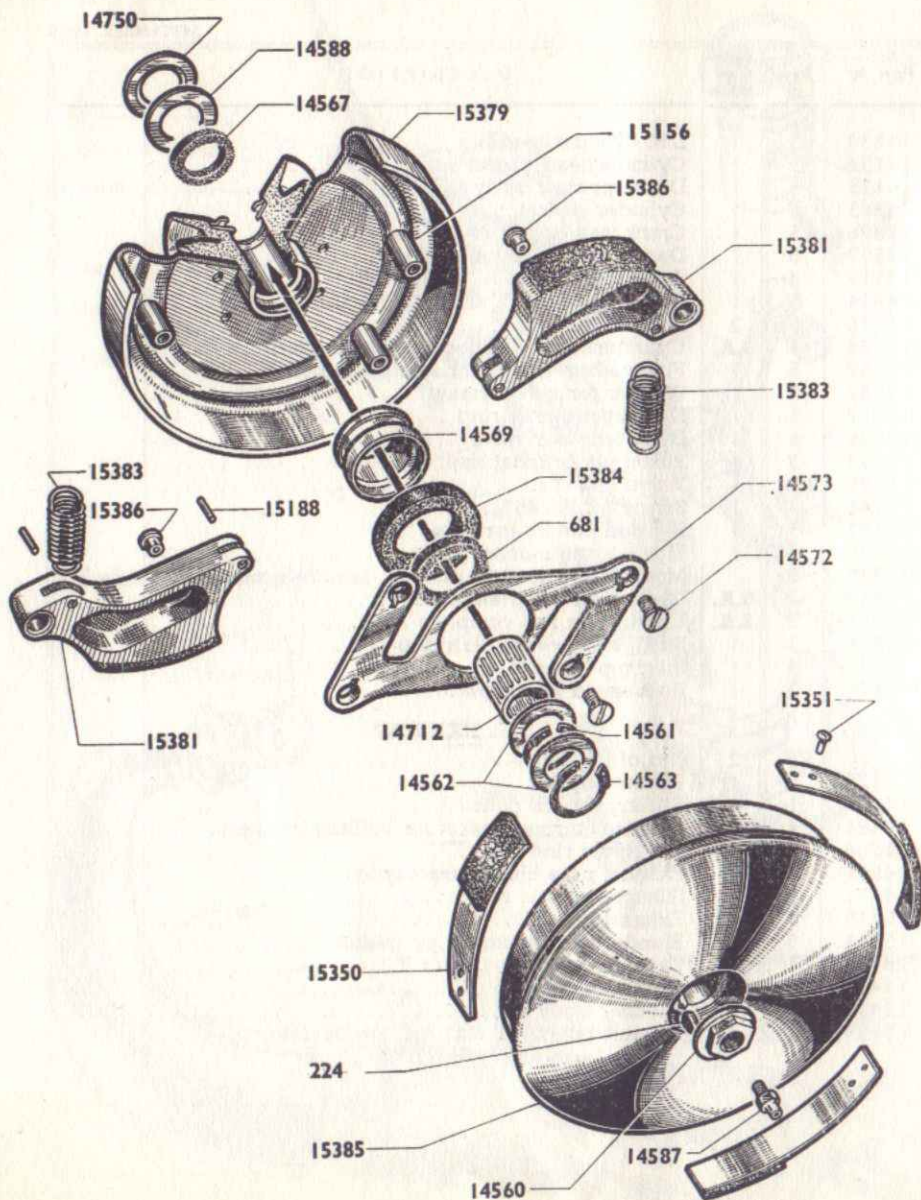

Part N°	Group	Quantity per machine	DESCRIPTION
224	5	1	Drum woodruff key
681	5	1	Clutch outer felt
14560	2	1	Clutch lock nut
14561	2	1	Outer circlips $\varnothing 15 \frac{m}{m}$
14562	5	2	Clutch side washer
14563	2	1	Inner circlips $\varnothing 22 \frac{m}{m}$
14567	5	1	Clutch inner felt
14569	2	1	Oil deflector
14572	5	4	Clutch counter-flange screw $4 \frac{m}{m} / 75$
14573	2	1	Counter flange
14587	5	1	Nipple
14588	5	1	Washer behind felt
14712	5	1	Needle cartridge $15 \times 19 \times 22 \frac{m}{m}$
14750	5	1	Clutch inner dust deflector $8/10 \frac{m}{m}$
14931	5	5	Clutch thrust washer $10/100 \frac{m}{m}$
14932	5	5	Clutch thrust washer $25/100 \frac{m}{m}$
14933	5	5	Clutch thrust washer $40/100 \frac{m}{m}$
15156	2	4	Small column to be rivetted, inner threading $4/75 \frac{m}{m}$
15188	2	4	Clutch riser spring axle
15350	2	3	Spring plate with Ferodo
15351	2	6	Spring rivet
15378	2	S.A.	Clutch complete "DIMOBY"
15379	2	1	Flange with hub, columns and pulley $\varnothing 63 \frac{m}{m}$
15381	2	2	Clutch riser with Ferodo
15383	2	2	Clutch riser spring
15384	2	1	Clutch riser inner stop
15385	2	1	Drum with hub and springs
15386	2	2	Clutch riser side stop

S. A. = Sub-assembly (not illustrated).

MOBYLETTE Type AV 76 or AU 76

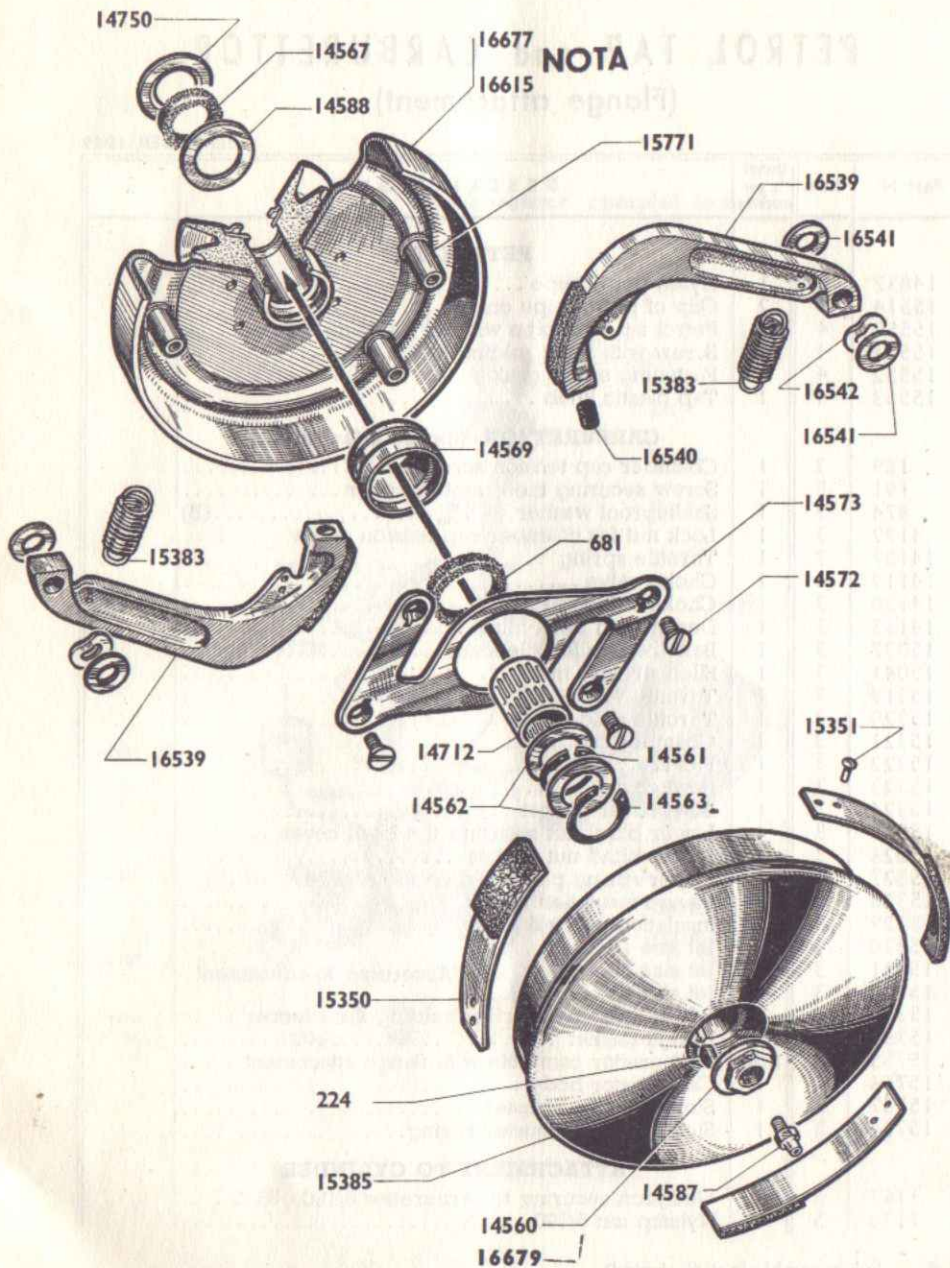

"DIMOBY" CLUTCH latest model (Quick operating risers)

Complete : With engine pulley for 13 × 8 belt N° 16538

Complete : With engine pulley for 14 × 7 belt N° 16613

SEPTEMBER 1959

Part N°	Group	Quantity per machine	DESCRIPTION
224	5	1	Drum woodruff key
681	5	1	Clutch outer felt
14560	2	1	Clutch lock nut
14561	2	1	Outer circlips \varnothing 15 $\frac{m}{m}$
14562	5	2	Clutch side washer
14563	2	1	Inner circlips \varnothing 22 $\frac{m}{m}$
14567	5	1	Clutch inner felt
14569	2	1	Oil deflector
14572	5	4	Clutch counter-flange screw 4 $\frac{m}{m}$ /75 × 10
14573	2	1	Counter-flange
14587	5	1	Nipple
14588	5	1	Washer behind felt
14712	5	1	Needle cartridge 15 × 19 × 22
14750	5	1	Clutch inner dust deflector 8/10 $\frac{m}{m}$
14931	5	1	Clutch thrust washer 10/100 $\frac{m}{m}$
14932	5	1	Clutch thrust washer 25/100 $\frac{m}{m}$
14933	5	1	Clutch thrust washer 40/100 $\frac{m}{m}$
15350	2	3	Spring with Ferodo
15351	2	6	Spring rivet
15383	2	2	Clutch riser spring
15385	2	1	Drum with hub and springs
15771	2	4	Small column to be rivetted, length under neck 15 $\frac{m}{m}$
16538	2	S.A.	Clutch complete (pulley for 13 × 8 belt)
16539	2	2	Riser with lining
16540	2	2	Riser stop
16541	2	4	Small column washer \varnothing 8 × 15 × 1
16542	2	2	Small column spring washer inner \varnothing 8 $\frac{m}{m}$
16613	2	S.A.	Clutch complete (pulley for 14 × 7 belt)
16614	2	S.A.	Mechanism complete (pulley for 14 × 7 belt)
16615	2	1	Flange with hub, columns and pulley \varnothing 63 $\frac{m}{m}$ (for 14 × 7 belt)
16677	2	1	Flange with hub, columns and pulley \varnothing 63 $\frac{m}{m}$ (for 13 × 8 belt)
16678	2	S.A.	Mechanism complete (pulley for 13 × 8 belt)
16679	2	2	Drum lock nut new model (reamed) SEE NOTE

NOTE. - Flange with hub, columns, \varnothing 63 $\frac{m}{m}$ N° 16615. At present, the engine pulley is designed to fit a 14 × 7 belt. This part makes the S.A. numbers change : Clutch complete and mechanism complete.

For further information, see sketch on belt documentation N° 113.

Since April 1959, the crankshaft taper bearing (clutch side) has been increased by 2 $\frac{m}{m}$; the total length of the crankshaft end is consequently lengthened. In this case it is necessary to fit the reamed nut N° 16679.

MOBYLETTE

Type AV 76 or AU 76

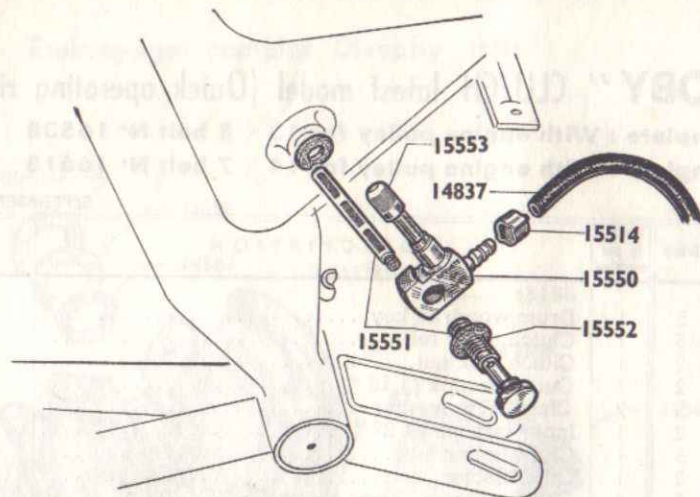

Robinet essence 15550

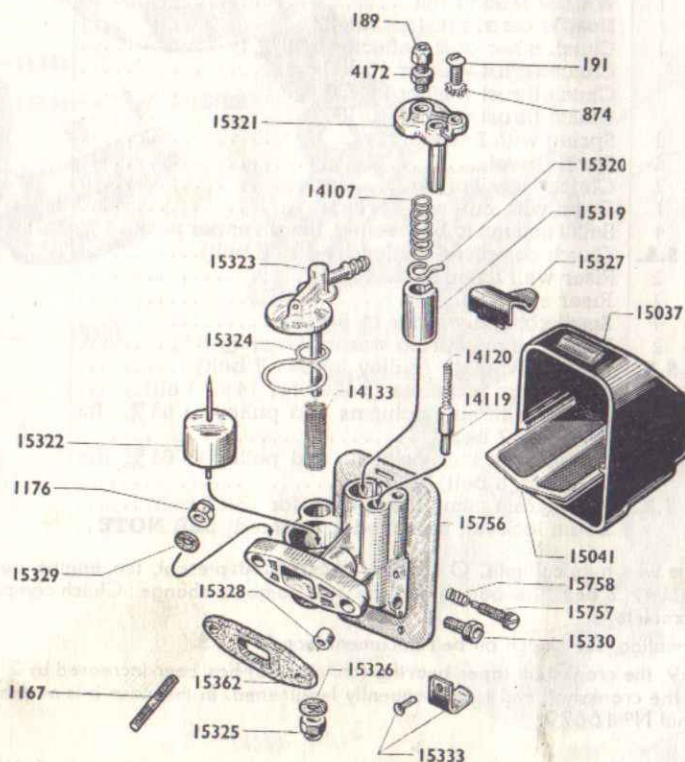

Reprinting forbidden.

PETROL TAP and CARBURETTOR (Flange attachment)

SEPTEMBER 1959

Part N°	Group	Quantity per machine	DESCRIPTION
PETROL TAP			
14837	5	1	Nylon petrol pipe
15514	4	2	Clip of petrol pipe on tap
15550	4	S.A.	Petrol tap with pipe without fastening screw
15551	4	1	Screw with filter holding tap
15552	4	2	Fastening screw gasket
15553	4	1	Tap plastic knob
CARBURETTOR (flange attachment)			
189	3	1	Chamber cap tension screw
191	3	1	Screw securing the chamber cover
874	3	1	Shakeproof washer $\varnothing 5 \frac{3}{4}$ (B)
4172	3	1	Lock nut for chamber cap tension screw
14107	3	1	Throttle spring
14119	3	1	Choke valve
14120	3	1	Choke valve spring
14133	3	1	Decantation bowl filter
15037	3	1	Bakelite cap for silencer
15041	3	1	Silencer wire mesh
15319	3	1	Throttle valve
15320	3	1	Throttle guide
15321	3	1	Chamber cap
15322	3	1	Float
15323	3	1	Bowl cover
15324	3	1	Bowl cover gasket
15325	3	1	Lower blind nut securing the bowl cover
15326	3	1	Lower blind nut gasket
15327	3	1	Upper spring plate holding the silencer
15328	3	2	Flange insulation ring
15329	3	2	Insulation washer
15330	3	1	Jet size 19
15331	3	1	Jet size 20
15332	3	1	Jet size 21
15333	3	1	Lower spring with rivet holding the silencer
15362	3	1	Flange gasket
15755	3	S.A.	Carburettor complete with flange attachment
15756	3	1	Carburettor body
15757	3	1	Slow running adjuster
15758	3	1	Slow running adjuster spring
ATTACHMENT TO CYLINDER			
1167	5	2	Gudgeon securing to carburettor $6/100 \times 33 \frac{m}{m}$
1176	5	2	Nylstop nut $6/100$

S.A. = Sub-assembly (not illustrated).

Reprinting forbidden

MOBYLETTE Type AV 76 or AU 76

CARBURETTOR (New model clip type)

SEPTEMBER 1959

carburateur complet 16685

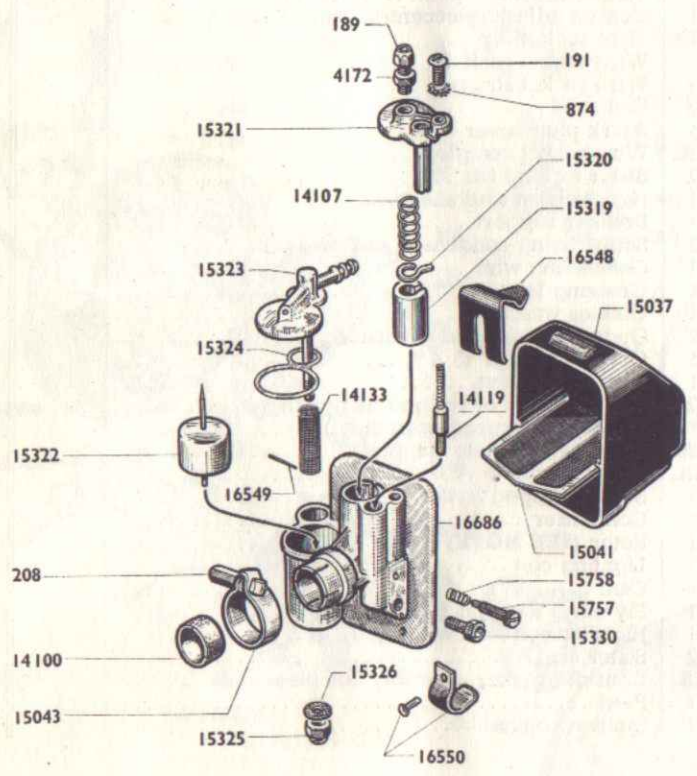

Part N°	Group	Quantity per machine	DESCRIPTION
PETROL TAP and PIPE			
14837	5		Nylon petrol pipe
15497	5	1	Rubber petrol pipe "Perbuna"
15514	4	2	Clip for nylon petrol pipe
15550	4	S.A.	Petrol tap with pipe without fastening screw
15551	4	1	Screw with filter holding tap
15552	4	2	Fastening screw gasket
15553	4	1	Tap plastic knob
CARBURETTOR (CLIP TYPE) NEW MODEL B.A. 10 (Adjustment 540)			
189	3	1	Chamber cap tension screw
191	3	1	Screw securing the chamber cover
208	3	1	Bolt of carburettor clip
874	3	1	Shakeproof washer $\varnothing 5\frac{m}{m}$
4172	3	1	Lock nut for chamber cap tension screw
14100	3	1	Insulation ring
14107	3	1	Throttle spring
14119	3	1	Choke valve
14120	3	1	Choke valve spring
14133	3	1	Decanting bowl filter
15037	3	1	Bakelite cap for silencer
15041	3	1	Silencer wire mesh
15043	3	1	Carburettor clip
15319	3	1	Throttle valve
15320	3	1	Throttle guide
15321	3	1	Chamber cap
15322	3	1	Float
15323	3	1	Bowl cover
15324	3	1	Bowl cover gasket
15325	3	1	Lower blind nut securing the bowl cover
15326	3	1	Lower blind nut gasket
15330	3	1	Jet size 19
15331	3	1	Jet size 20
15332	3	1	Jet size 21
15757	3	1	Slow running adjuster
15758	3	1	Slow running adjuster spring
16548	3	1	Upper spring plate holding the silencer
16549	3	1	Pin holding the upper spring
16550	3	1	Lower spring with rivet holding the silencer
16685	3	S.A.	Carburettor complete clip type new model B.A. 10
16686	3	1	Carburettor body

S.A. = Sub-assembly (not illustrated).

MOBYLETTE

Type AV 76 or AU 76

FLYWHEEL MAGNETO (First model)

SEPTEMBER 1959

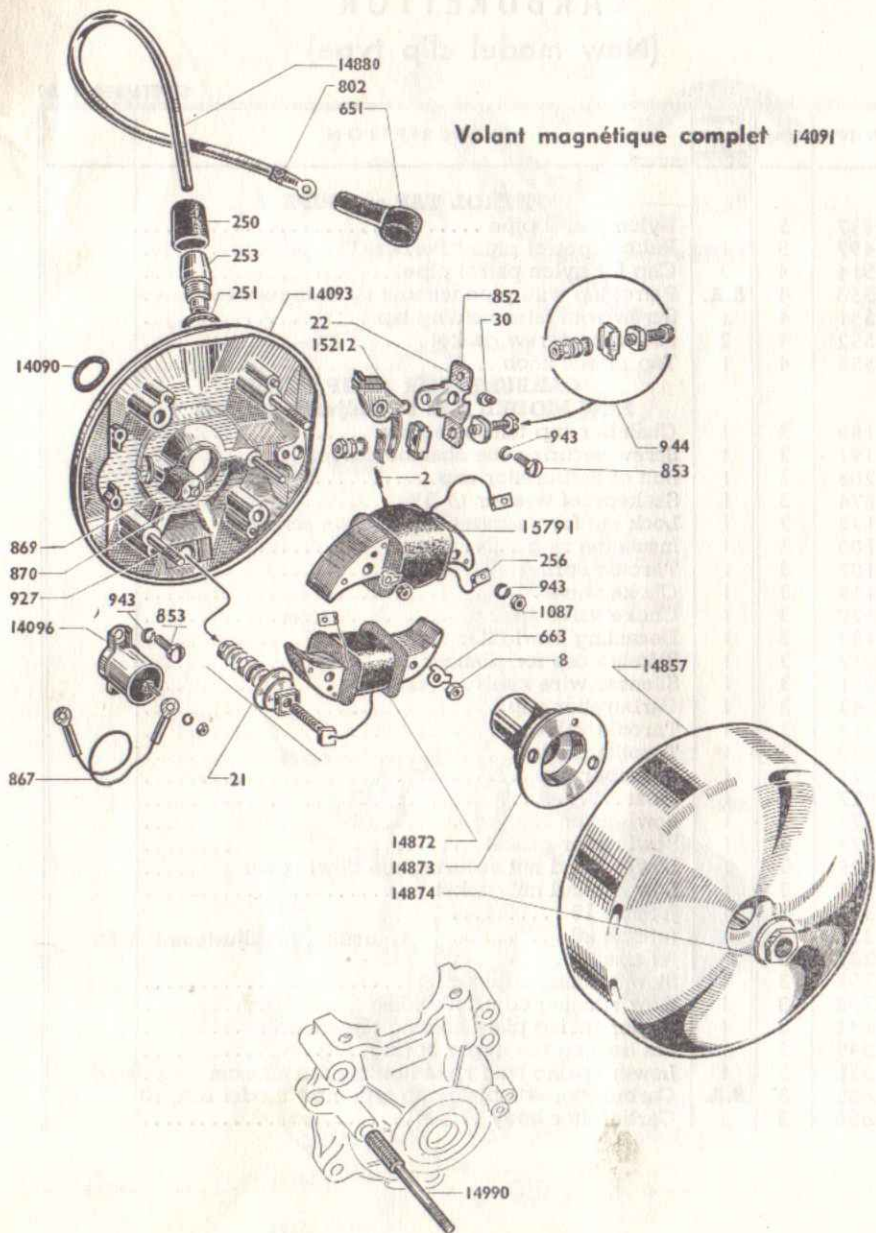

Part N°	Group	Quantity per machine	DESCRIPTION
2	3	1	Earth spring
8	3	2	Stator securing nut
21	3	1	Lighting terminal complete
22	3	2	Tungsten contact point to be rivetted
30	3	1	Contact adjusting eccentric cam
250	3	1	Wire socket cap
251	3	1	Wire socket gasket
253	3	1	Wire socket stripped
256	3	2	Coil shell
651	3	1	Spark plug cover
661	3	S.A.	Wire socket complete
663	3	2	Stator locking tab
802	3	1	High tension lead saeil
852	3	1	Breaker support
853	3	3	Screw fixing condenser and breaker
867	3	1	Connecting wire
869	3	1	Greasing felt
870	3	1	Quikies washer
927	3	2	Gudgeon fixing coil on stator
943	3	5	Grower washer $\varnothing 4 \frac{7}{8}$
944	3	1	Pawl attachment
1087	5	2	Nut of $4 \frac{7}{8}$ / 75 of the gudgeon fixing coil on stator
14090	5	1	Flywheel leakproof washer
14091	1	S.A.	Flywheel magneto complete
14092	1	S.A.	Stator complete
14093	1	1	Stator stripped
14096	3	1	Condenser
14857	1	1	Rotor (SEE NOTE)
14872	3	1	Lighting coil
14873	3	1	Cam
14874	3	1	Flywheel lock nut (SEE NOTE)
14880	3	1	High tension lead with shell
14990	3	2	Stator stud
15211	3	S.A.	Contact breaker assembly complete
15212	3	1	Pawl
15791	3	1	Ignition coil

NOTE. - Rotor N° 14857 and Flywheel lock nut N° 14874.

The flywheel lock nut N° 14874 is now replaced by the new model lock nut N° 15951 (page 8).

The rotor N° 14857 is now provided for fitting the new model lock nut.

S.A. = Sub-assembly (not illustrated).

MOBYLETTE

Type AV 76 or AU 76

Volant magnétique complet 16507

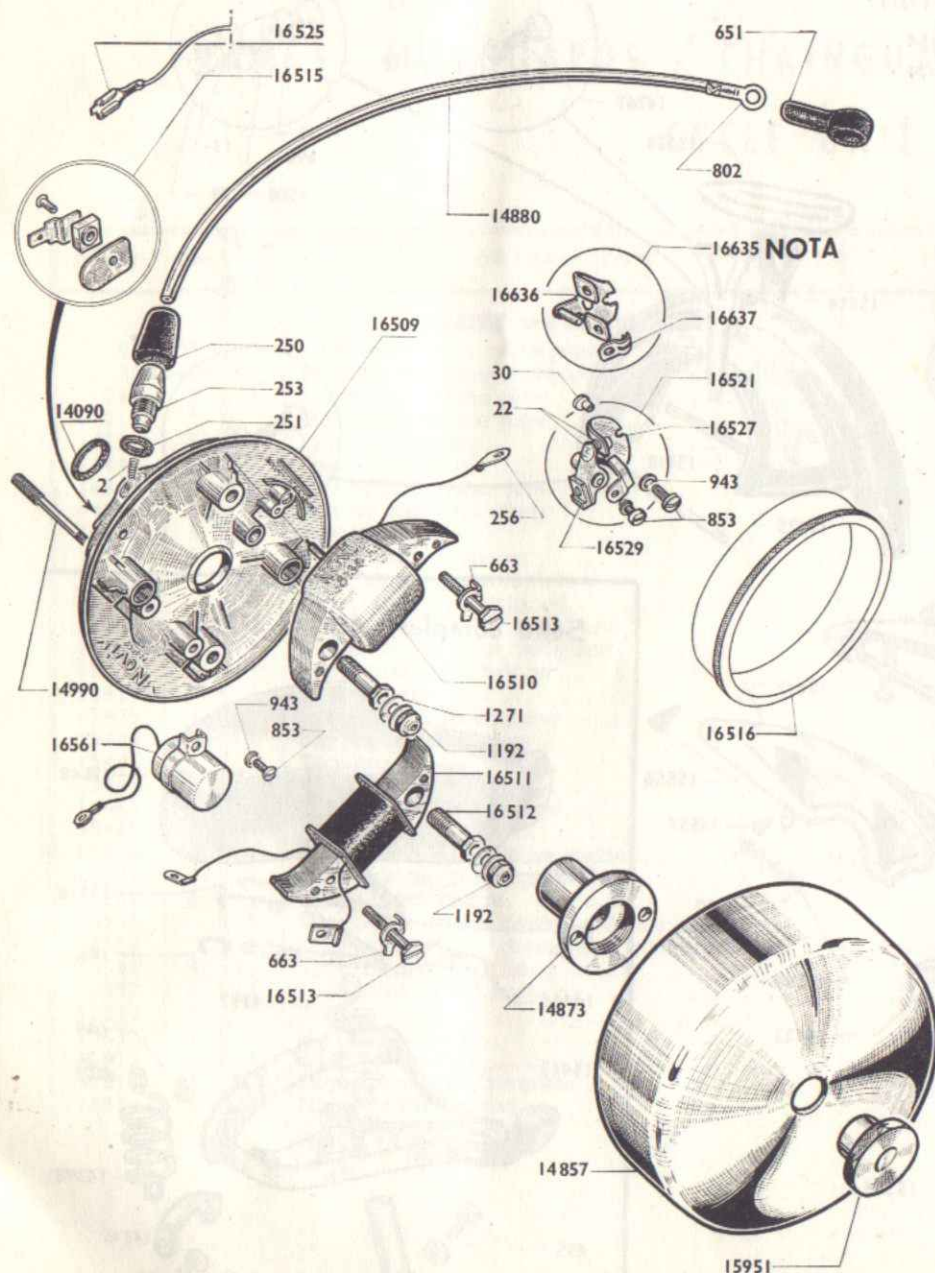

FLYWHEEL MAGNETO TYPE 120 x (second model) (Dual adjustment)

SEPTEMBER 1959

Part N°	Group	Quantity per machine	DESCRIPTION
2	3	1	Earth spring
22	3	2	Tungsten contact point to be rivetted.
30	3	1	Contact adjusting eccentric cam
250	3	1	Wire socket cap
251	3	1	Wire socket gasket
253	3	1	Wire socket stripped
256	3	3	Coil shell
651	3	1	Sparkplug cover
661	3	S.A.	Wire socket complete
663	3	2	Stator locking tab
802	3	1	High tension lead shell
853	3	4	Screw 4/76
943	3	3	Grower washer $\varnothing 4 \frac{m}{m}$
1192	5	2	Nylstop nut $\varnothing 5 \frac{m}{m} / 76$
1271	1	1	Belleville washer $\varnothing 5 \frac{m}{m}$
14090	5	1	Flywheel leakproof washer
14857	1	1	Rotor
14873	3	1	Cam
14880	3	1	High tension lead with shell
14990	3	2	Stator stud
15951	3	1	Flywheel lock nut
16507	3	S.A.	Flywheel magneto complete 120 X
16508	3	S.A.	Stator complete
16509	3	1	Stator stripped
16510	3	1	Ignition coil
16511	3	1	Lighting coil
16512	3	2	Hollow screw $\varnothing 7,5 \frac{m}{m} / 100 \times 24 \frac{m}{m}$ long securing the coil
16513	3	2	Screw $\varnothing 4 \frac{m}{m} / 76$ securing the coil
16515	3	1	Lighting terminal complete
16516	3	1	Centring ring for coils (SEE NOTE)
16521	3	1	Breaker complete (former model)
16525	3	1	Shell for lighting terminal (flywheel 120 X)
16527	3	1	Breaker support (former model)
16529	3	1	Pawl with terminal
16561	3	1	Condenser
16635	3	1	Breaker complete (new model)
16636	3	1	Breaker support (new model)
16637	3	1	Adjusting lever

SEE NOTE

NOTE. - 1) CENTRING RING N° 16516. - Special tool indispensable for centring the coils when remounting the latter.

2) BREAKER N° 16635. - The so called "dual adjustment" breaker will be fitted on flywheel magneto 120 X at a later date.

According to your needs, please order: former model or new model, quoting the relating reference.

S.A. = Sub-assembly (not illustrated).

IMPORTANT NOTICE. - The parts marked (B) are sold in small bags only.

MOBYLETTE Type AV 76 or AU 76

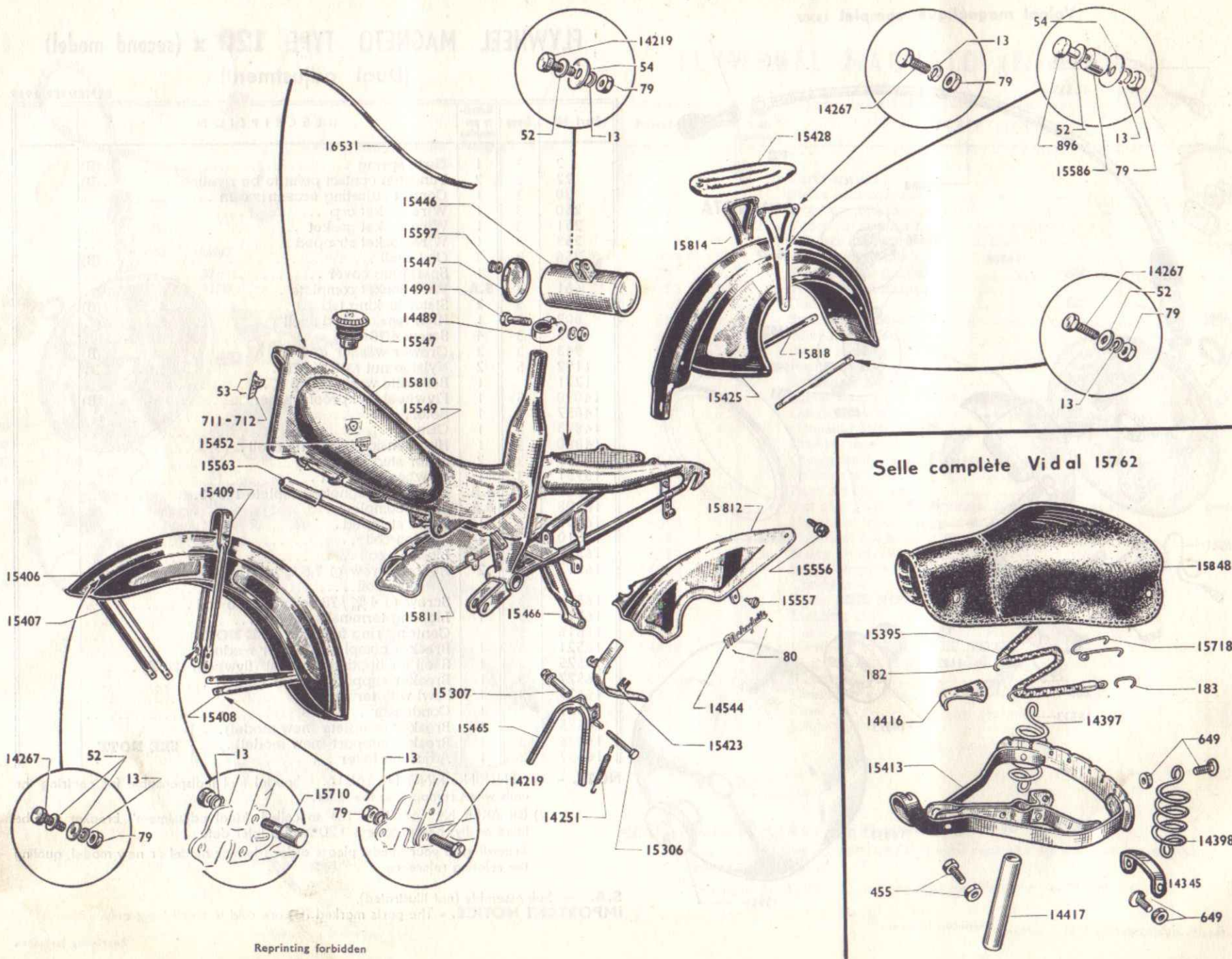

Selle complète Vidal 15762

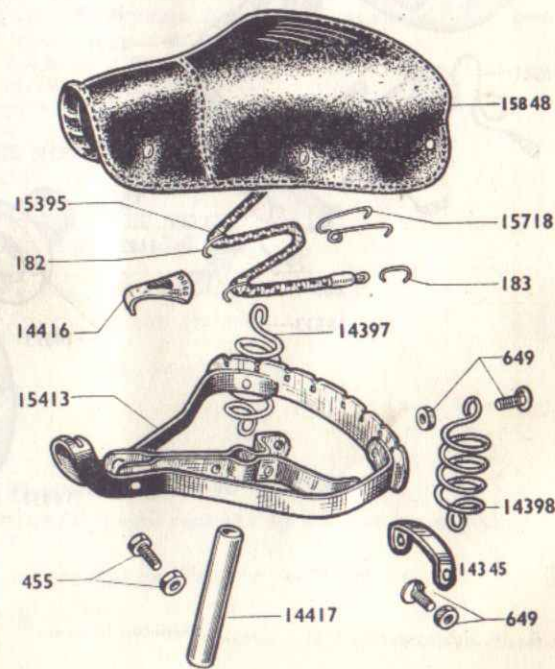

MOBYLETTE Type AV 76 or AU 76

FRAME - MUDGUARDS - CHAINGUARDS - LUGGAGE-CARRIER - SADDLE CYCLE UNIT ATTACHMENT

SEPTEMBER 1959

Part N°	Group	Quantity per machine	DESCRIPTION	Part N°	Group	Quantity per machine	DESCRIPTION
FRAME and MUDGUARD							
53	5	2	Grooved nail for name plate	15818	1	2	Rear mudguard stay
80	5	4	Rivet for the name Mobylette (on chainguard)	16531	1	1	Tank plastic beading
711	5	1	Motobecane name plate	VIDAL SADDLE			
712	5	1	Motoconfort name plate	182	5	4	Long hook of elastic piece
14251	5	1	Propstand spring	183	5	2	Short hook of elastic piece
14489	5	1	Seat tube clamp	455	5	1	Bolt securing the frame on saddle tube 8/125 × 25 ^m
14544	5	2	Chainguard "Mobylette" brand	649	5	4	Lower and upper bolt securing the saddle spring
14991	5	1	Bolt for seat tube clamp	14345	5	1	Saddle frame distance piece 80 ^m long
15306	5	1	Propstand bolt	14397	5	1	R.H. saddle spring
15307	5	1	Propstand bolt spacer	14398	5	1	L.H. saddle spring
15405	1	S.A.	Front mudguard complete	14416	5	1	Saddle nozzle distance plate
15406	1	1	Front mudguard stripped	14417	5	1	Non shouldered saddle tube Ø 25,5 ^m
15407	1	1	Upper stay of front mudguard	15395	5	1	Elastic piece
15408	1	1	Lower stay of front mudguard	15413	1	1	Clampless saddle frame
15409	1	1	Front mudguard bridge	15718	5	3	Rear hook for elastic piece
15423	1	1	Pulley guard	15762	1	S.A.	Vidal clampless saddle
15425	1	1	Rear mudguard stripped	15848	1	1	Saddle cover (grey)
15428	1	1	Luggage-carrier plate	CYCLE UNIT ATTACHMENT			
15446	1	1	Tool box	13	5	22	Grower washer Ø 5 ^m
15447	1	1	Tool box lid	52	5	22	Bolt flat washer Ø 5 ^m
15452	5	2	"Mobylette" tank badge	54	5	6	Flat washer 6 × 20
15465	1	1	Propstand	79	5	32	Nut for bolt 5 ^m /90
15466	1	1	Propstand support to be welded	896	5	2	Bolt of 5 ^m /90 × 25 ^m holding rear mudguard stay and distance piece
15547	4	1	Fuel tank cap with dip stick	14219	5	8	Bolt of 5 ^m × 90 × 15 ^m fixing mudguard stay to plunger lug
15549	4	2	Screw fixing badge	14267	5	22	Bolt of 5 ^m × 90 × 10 ^m fixing front and rear mudguard stays
15556	2	2	Knurled screw for chainguard rear attachment	15586	5	2	Distance piece between luggage-carrier stay and rear mudguard
15557	4	4	Knurled screw for chainguard front attachment	15710	5	1	Adjuster bolt holding front brake anchorage
15563	4	1	Tyre inflator 250 ^m long				
15597	5	1	Tool box knurled knob				
15810	1	1	Frame				
15811	1	1	R.H. chainguard				
15812	1	1	L.H. chainguard				
15813	1	S.A.	Luggage-carrier complete				
15814	1	2	Luggage-carrier stay				

S.A. = Sub-assembly (not illustrated).

Reprinting forbidden

MOBYLETTE

Type AV 76 or AU 76

FRONT FORK and HEAD RACES

SEPTEMBER 1959

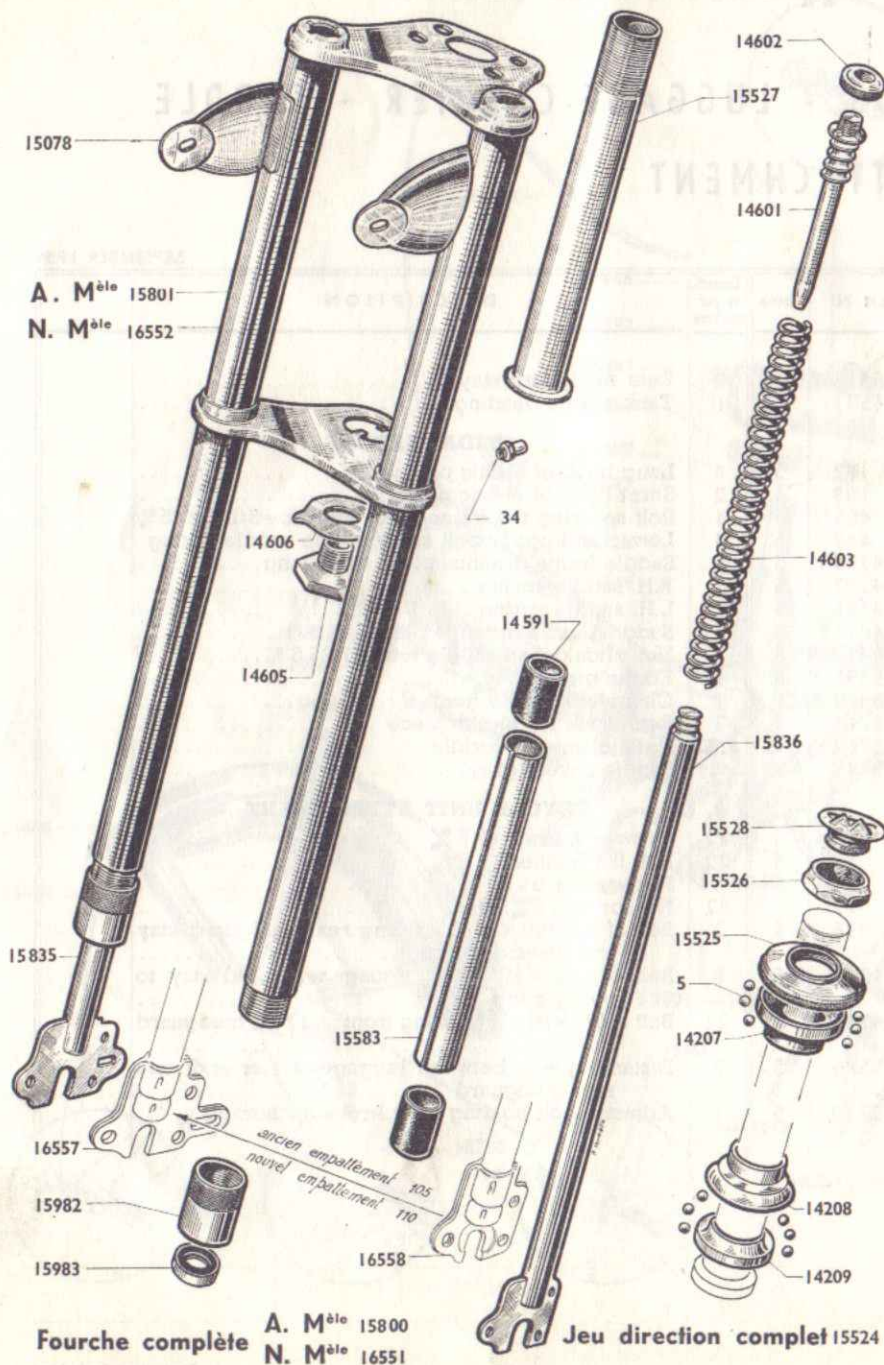

Part N°	Group	Quantity per machine	DESCRIPTION
FORK 105 ^m/_m wide, former model			
34	5	2	Nipple
14591	4	4	Fork bush
14601	4	2	Spring upper attachment
14602	4	2	Upper attachment nut
14603	5	2	Fork spring
14605	4	1	Steering tube screw
14606	4	1	Lock plate for steering tube screw
15078	5	2	Headlight support to be welded
15527	4	1	Fork pivot
15528	4	1	Steering tube nylon upper plug
15583	4	2	Lower distance piece in sheath
15800	1	S.A.	Telescopic fork complete
15801	1	1	Sheath assembly
15835	1	1	R.H. plunger (former model)
15836	1	1	L.H. plunger (former model)
15982	4	2	Sheath nut
15983	5	2	Leakproof gasket
FORK 110 ^m/_m wide, new model for wider hub (NOTE 1)			
16551	1	S.A.	Telescopic fork complete
16552	1	1	Sheath assembly
NEW MODEL PLUNGERS (grooved) WITH PRESSED ENDS (NOTE 2)			
16557	1	1	R.H. plunger (new model)
16558	1	1	L.H. plunger (new model)
HEAD RACES			
5	5	48	Ball Ø 3,96 ^m / _m
14207	4	1	Upper cone
14208	4	1	Lower cup
14209	4	1	Lower cone
15524	4	S.A.	Steering head races complete
15525	4	1	Upper cup
15526	4	1	Steering lock nut

NOTE 1. - FRONT FORK 16551. The mobylettes types AV 76 or AU 76 have been mounted with fork N° 16551 (110 ^m/_m wide for wider hub) as from January 15th 1959.

The same modification has been carried out on models AV 79 and AU 79 as from FEBRUARY 13th 1959.

NOTE 2. - NEW MODEL PLUNGERS N° 16557 and 16558. These plungers are not yet mounted on all AV 76 and AV 79 Mobylettes ; the generalization will be effective by end 1959. When ordering a R.H. or a L.H. plunger, quote "former" or "latest" model. When replacing both plungers, it is possible to install either the former or new models.

Fourche complète A. M^{éto} 15800
N. M^{éto} 16551

Jeu direction complet 15524

Reprinting forbidden

S.A. = Sub-assembly (not illustrated).

Reprinting forbidden

MOBYLETTE Type AV 76 or AU 76

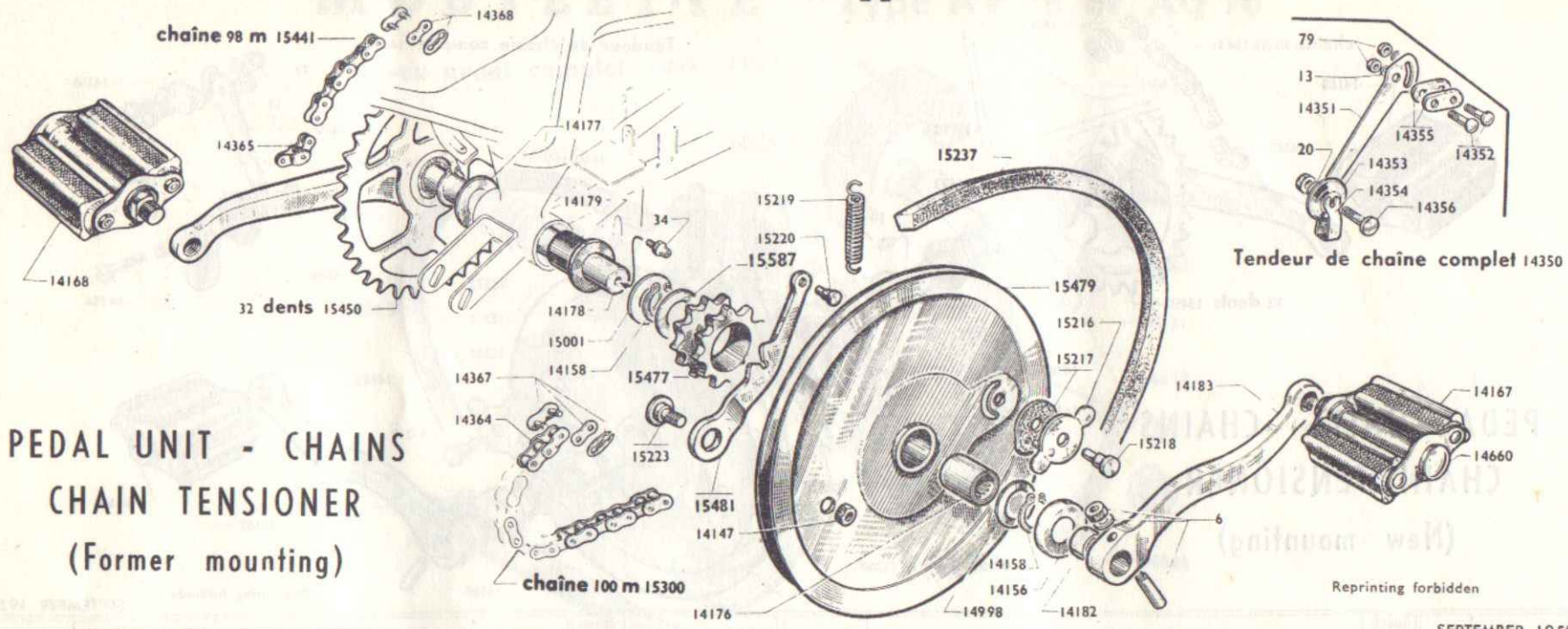

**PEDAL UNIT - CHAINS
CHAIN TENSIONER
(Former mounting)**

Tendeur de chaîne complet 14350

Reprinting forbidden

SEPTEMBER 1959

Part N°	Group	Quantity per machine	DESCRIPTION	Part N°	Group	Quantity per machine	DESCRIPTION
PEDAL UNIT							
6	5	2	Bracket cotter pin	15477	2	1	Transmission sprocket 12 teeth inner \varnothing 29 $\frac{m}{m}$
34	5	1	Bracket grease nipple	15479	2	1	Bracket pulley outer \varnothing 208 $\frac{m}{m}$, hub 29 $\frac{m}{m}$
14139	4	S.A.	Pair of pedals	15480	2	S.A.	Lock lever complete
14147	2	1	Lever screw nut	15481	2	1	Lock lever stripped
14156	4	1	Bracket oil deflector	15587	5	1	Bracket thrust washer 1,5 x 31 x 20/10 $\frac{m}{m}$
14158	5	3	Bracket circlips	16647	S.A.	1	Sub-assembly including : pulley, sprocket and needle cartridge
14167	4	1	L.H. pedal	CHAIN TENSIONER (Model with steel roller)			
14168	4	1	R.H. pedal	13	5	2	Grower washer \varnothing 5 $\frac{m}{m}$
14176	5	1	Needle cartridge	20	5	1	Flat washer \varnothing 6 $\frac{m}{m}$
14177	5	1	R.H. bracket thrust washer 10/10 $\frac{m}{m}$	79	5	2	Nut for tensioner bolt
14178	4	1	Plain bracket axle	14350	5	S.A.	Chain tensioner complete
14179	5	2	Bracket bush	14351	5	1	Tensioner arm
14182	5	1	Distance piece between pulley and crank arm	14352	5	2	Bolt securing chain tensioner
14183	4	1	L.H. crank arm	14353	5	1	Chain tensioner roller complete
14660	4	2	Pedal cap	14354	5	1	Tensioner roller bridge
14833	5	1	Oversized bracket bush	14355	5	2	Tensioner arm spacer
14998	5	1	Outer thrust washer front of pulley 16,5 x 27 x 10 10 $\frac{m}{m}$	14356	5	1	Chain tensioner axle with nut
15001	5	1	L.H. bracket thrust washer 8/10 $\frac{m}{m}$	CHAINS (SEE NOTE)			
15216	2	1	Lock button	14364	4	1	Cranked link for transmission chain, Yellow brand
15217	2	1	Button friction washer	14365	4	1	Cranked link for pedal chain
15218	2	1	Button axle	14367	4	1	Spring link for transmission chain, Yellow brand
15219	2	1	Lock lever spring	14368	4	1	Spring link for pedal chain
15220	2	1	Lever spring axle	14565	4	1	Cranked link for transmission chain, Brampton brand
15223	2	1	Axle with lock lever nut	14875	4	1	Spring link for transmission chain, Brampton brand
15237	4	1	Belt 13 x 8	15300	4	1	Transmission chain 100 links
15450	4	1	R.H. crank arm with sprocket set in, 32 teeth	15441	4	1	Pedal chain 98 links

NOTE - CHAINS : Our Mobylettes are equipped with two brands of chains, depending on our supplies, but only the number of links is to be considered. However, for spring links and cranked links, it is advisable to state the exact brand, either Yellow or Brampton.
IMPORTANT. - For further information regarding : Bracket pulleys - Bracket axles, belts, please refer to Documentations N° 111, 112 and 113.

Reprinting forbidden

MOBYLETTE

Type AV 76 or AU 76

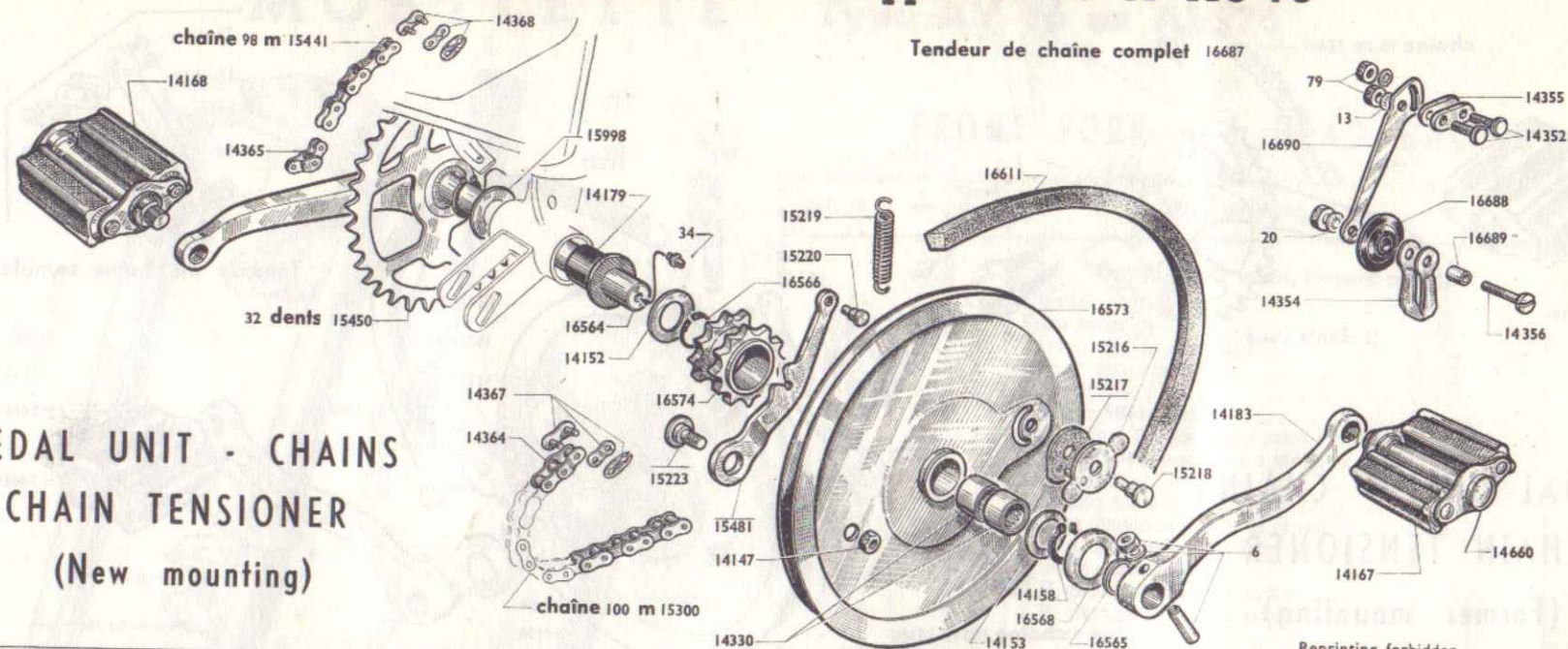

PEDAL UNIT - CHAINS
CHAIN TENSIONER
(New mounting)

Tendeur de chaîne complet 16687

Reprinting forbidden

SEPTEMBER 1959

Part N°	Group	Quantity per machine	DESCRIPTION	Part N°	Group	Quantity per machine	DESCRIPTION	
PEDAL UNIT (with reversible sprocket)								
6	5	2	Bracket cotter pin	16568	4	1	Bracket oil deflector	
34	5	1	Bracket grease nipple	16573	2	1	Bracket pulley outer $\varnothing 214 \frac{m}{m}$ - Hub $\varnothing 29 \frac{m}{m}$ for reversible sprocket 12 teeth	
14139	4	S.A.	Pair of pedals	16574	2	1	Reversible sprocket 12 teeth, inner $\varnothing 29 \frac{m}{m}$	
14147	2	1	Lever screw nut	16611	4	1	Belt $14 \frac{m}{m} \times 7 \frac{m}{m}$	
14152	5	1	Bracket thrust washer $16,5 \times 33 \times 8/10 \frac{m}{m}$	16651	S.A.		Sub-assembly including : pulley, sprocket and needle cartridge	
14153	5	1	Bracket thrust washer $16,5 \times 27 \times 20/10 \frac{m}{m}$					CHAIN TENSIONER (model with RILSAN roller)
14158	5	2	Bracket circlips	13	5	2	Grower washer $\varnothing 5 \frac{m}{m}$	
14167	4	1	L.H. pedal	20	5	1	Flat washer $\varnothing 6 \frac{m}{m}$	
14168	4	1	R.H. pedal	79	5	2	Nut for bolt securing chain tensioner	
14179	5	2	Bracket bush	14352	5	2	Bolt securing chain tensioner	
14183	4	1	L.H. crank arm	14354	5	1	Tensioner roller bridge	
14330	5	2	Needle cartridge $12 \frac{m}{m}$ wide	14355	5	2	Tensioner arm spacer	
14660	4	2	Pedal cap	14356	5	1	Tensioner roller axle with nut	
14833	5		Oversized bracket bush	16687	S.A.		Chain tensioner complete	
15216	2	1	Lock button	16688	1		Tensioner roller (RILSAN)	
15217	2	1	Button friction washer	16689	1		Roller spacer $\varnothing 8 \frac{m}{m}$ - Length $10,5 \frac{m}{m}$	
15218	2	1	Button axle	16690	1		Tensioner arm	
15219	2	1	Lock lever spring					CHAINS (SEE NOTE)
15220	2	1	Lever spring axle	14364	4	1	Cranked link for transmission chain, Yellow brand	
15223	2	1	Axle with lock lever nut	14365	4	1	Cranked link for pedal chain	
15450	4	1	R.H. crank arm with sprocket set in, 32 teeth	14367	4	1	Spring link for transmission chain, Yellow brand	
15480	2	S.A.	Lock lever complete	14368	4	1	Spring link for pedal chain	
15481	2	1	Lock lever stripped	14565	4		Cranked link for transmission chain, Brampton brand	
15998	5	1	Bracket washer $\varnothing 16,5 \frac{m}{m} \times 26 \frac{m}{m} \times 10/10 \frac{m}{m}$	14875	4		Spring link for transmission chain, Brampton brand	
16564	4	1	Bracket axle	15300	4	1	Transmission chain 100 links	
16565	4	1	L.H. crank spacer $3 \frac{m}{m}$ thick	15441	4	1	Pedal chain 98 links	
16566	5	1	Bracket circlips					

NOTE. - CHAINS : Our Mobylettes are equipped with two brands of chains, depending on our supplies, but only the number of links is to be considered. However, for spring links and cranked links, it is advisable to state the exact brand, either Yellow or Brampton.

IMPORTANT. - For further information regarding : bracket pulleys - bracket axles - belts - please refer to documentations 111, 112 and 113.

Reprinting forbidden

MOBYLETTE Type AV 76 or AU 76

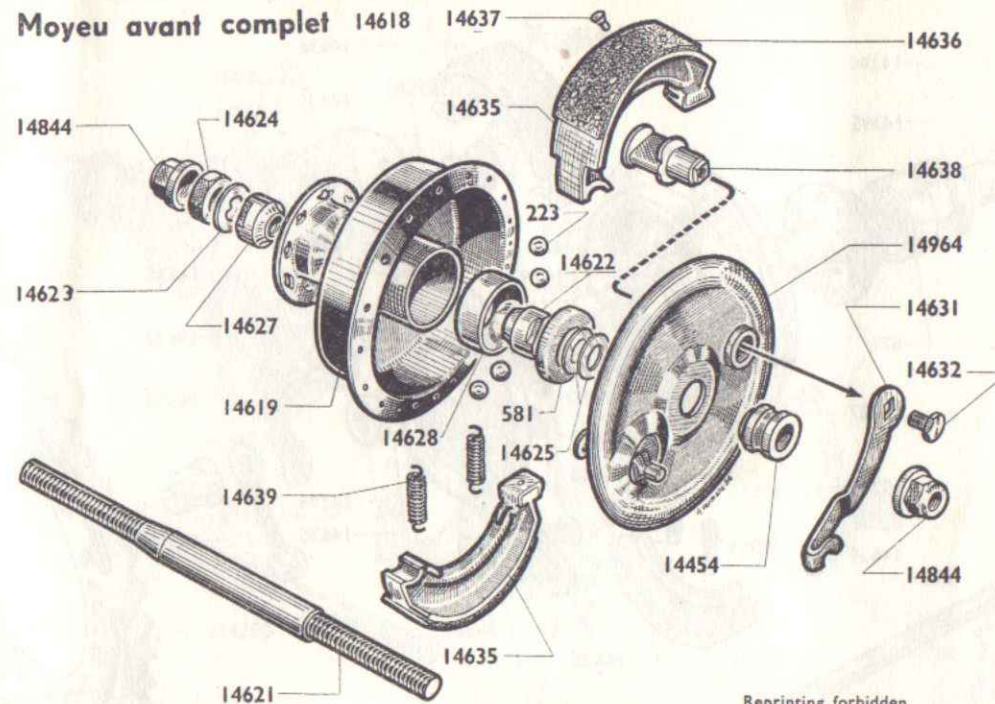

FRONT WHEEL and HUB "IDEAL" (former model)

Reprinting forbidden

SEPTEMBER 1959

Part N°	Group	Quantity per machine	DESCRIPTION	Part N°	Group	Quantity per machine	DESCRIPTION
WHEEL							
14989	4	36	Spoke nipple, French gauge 16.....	14620	4	S.A.	Front hub axle complete.....
15535	1	1	Rim 23"×2".....	14621	4	1	Front hub axle stripped.....
15536	1	1	Hutchinson two-coloured tyre 23"×2".....	14622	4	1	Fixed cone.....
15537	1	1	Hutchinson inner tube 23"×2" (French valve)....	14623	4	1	Snug washer.....
15538	4	1	Rim tape.....	14624	4	1	L.H. lock nut.....
15804	1	S.A.	Front wheel complete.....	14625	4	2	Flange distance washer.....
15805	4	18	Front wheel spoke 15×16 length 202 ^m with nipple	14627	4	1	Adjustable cone.....
15806	4	18	Front wheel spoke 15×16 length 227,5 ^m with nipple	14628	4	2	Frnt hub cup.....
15815	1	1	Hutchinson black tyre 23"×2".....	14631	4	1	Front brake cam lever.....
HUB							
223	5	20	Hub ball 6,35 ^m (¼ in.)..... (B)	14632	4	1	Screw securing the front brake cam lever.....
581	4	2	Dust deflector.....	14635	4	2	Jaw Ø 90 ^m
14454	4	1	Distance piece for flange truing, inner Ø 11 ^m ..	14636	4	2	Ferodo lining.....
14618	4	S.A.	Front hub complete.....	14637	5	8	Ferodo rivet..... (B)
14619	4	1	Front hub body stripped.....	14638	4	1	Jaw cam.....
				14639	5	2	Jaw spring.....
				14844	4	2	Wheel nut Ø 11 ^m
				14964	4	1	Jaw flange stripped.....
				15016	4	S.A.	Jaw flange complete.....

S.A. = Sub-assembly (not illustrated). **IMPORTANT NOTICE.**- The parts marked (B) are sold in small bags only.

Reprinting forbidden

MOBYLETTE Type AV 76 or AU 76

Moyeu complet avec pignon arrière 44 dents 15257

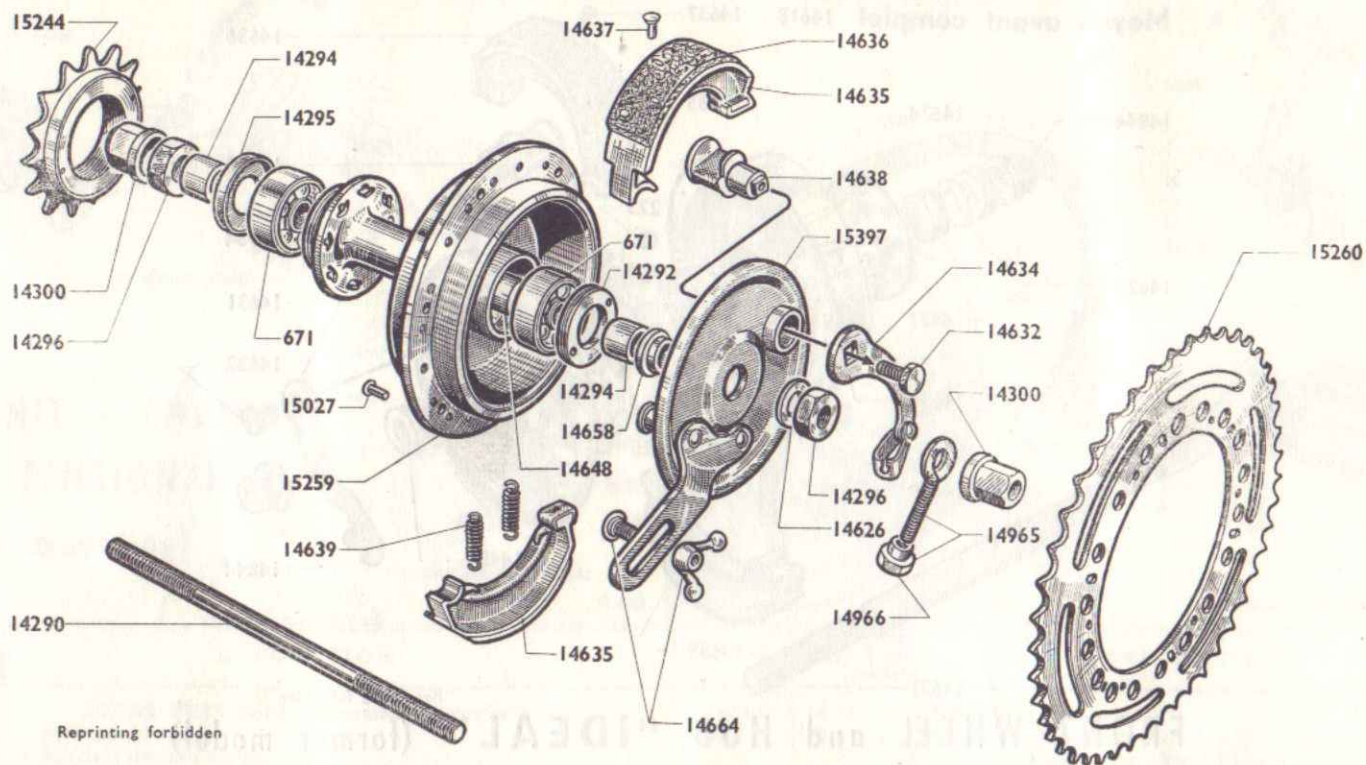

REAR WHEEL AND HUB "IDEAL" 44 TEETH (former model)

SEPTEMBER 1959

Part N°	Group	Quantity per machine	DESCRIPTION	Part N°	Group	Quantity per machine	DESCRIPTION
WHEEL							
14989	4	36	Spoke nipple French gauge 16	14632	4	1	Screw securing the cam lever
15535	1	1	Rim for tyre size 23" x 2"	14634	4	1	Rear hub cam lever
15536	1	1	Hutchinson tyre size 23" x 2" (white wall)	14635	4	2	Jaw \varnothing 90 $\frac{m}{m}$
15537	1	1	Hutchinson inner tube 23" x 2" (French valve)	14636	4	2	Ferodo lining
15538	4	1	Rim tape	14637	5	8	Ferodo rivet
15808	4	18	Spoke 16 x 15 x 16 - length : 227,5 $\frac{m}{m}$ (R.H. side) ..	14638	4	1	Jaw cam
15809	4	18	Spoke 16 x 15 x 16 - length : 197 $\frac{m}{m}$ (L.H. side)	14639	5	2	Jaw spring
15815	1	1	Hutchinson tyre 23" x 2" (black)	14648	4	1	Bearing distance piece 53 $\frac{m}{m}$ long
15819	1	S.A.	Rear wheel complete with cog wheel 44 teeth	14658	4	1	Distance piece for flange trueing inner \varnothing 10 $\frac{m}{m}$..
HUB							
671	5	2	Ball bearing 10 x 30 x 9 $\frac{m}{m}$	14664	4	1	Screw securing the flange, with wing nut
14290	4	1	Rear hub axle stripped \varnothing 10 $\frac{m}{m}$	14965	5	2	Wheel adjuster with nut
14292	4	1	Bearing lock nut, drum side	14966	5	2	Adjuster nut
14294	4	2	Hub distance piece, right and left, inner \varnothing 10 $\frac{m}{m}$ 11 $\frac{m}{m}$ long	15027	5	6	Rear cog wheel rivet \varnothing 4,5 x 11 $\frac{m}{m}$
14295	4	1	Dust deflector \varnothing 30 $\frac{m}{m}$	15244	4	1	Freewheel 18 teeth 34,7 x 100
14296	4	2	Hub nut	15257	4	S.A.	Rear hub complete with cog wheel 44 teeth
14300	4	2	Rear wheel nut \varnothing 10 $\frac{m}{m}$	15258	4	S.A.	Rear hub body complete with cog wheel 44 teeth ..
14626	4	1	Hub plain washer	15259	4	1	Rear hub body stripped with cog wheel 44 teeth ..
				15260	4	1	Rear cog wheel 44 teeth
				15396	4	S.A.	Jaw flange complete covering model
				15397	4	1	Jaw flange stripped covering model

MOBYLETTE Type AV 76 or AU 76

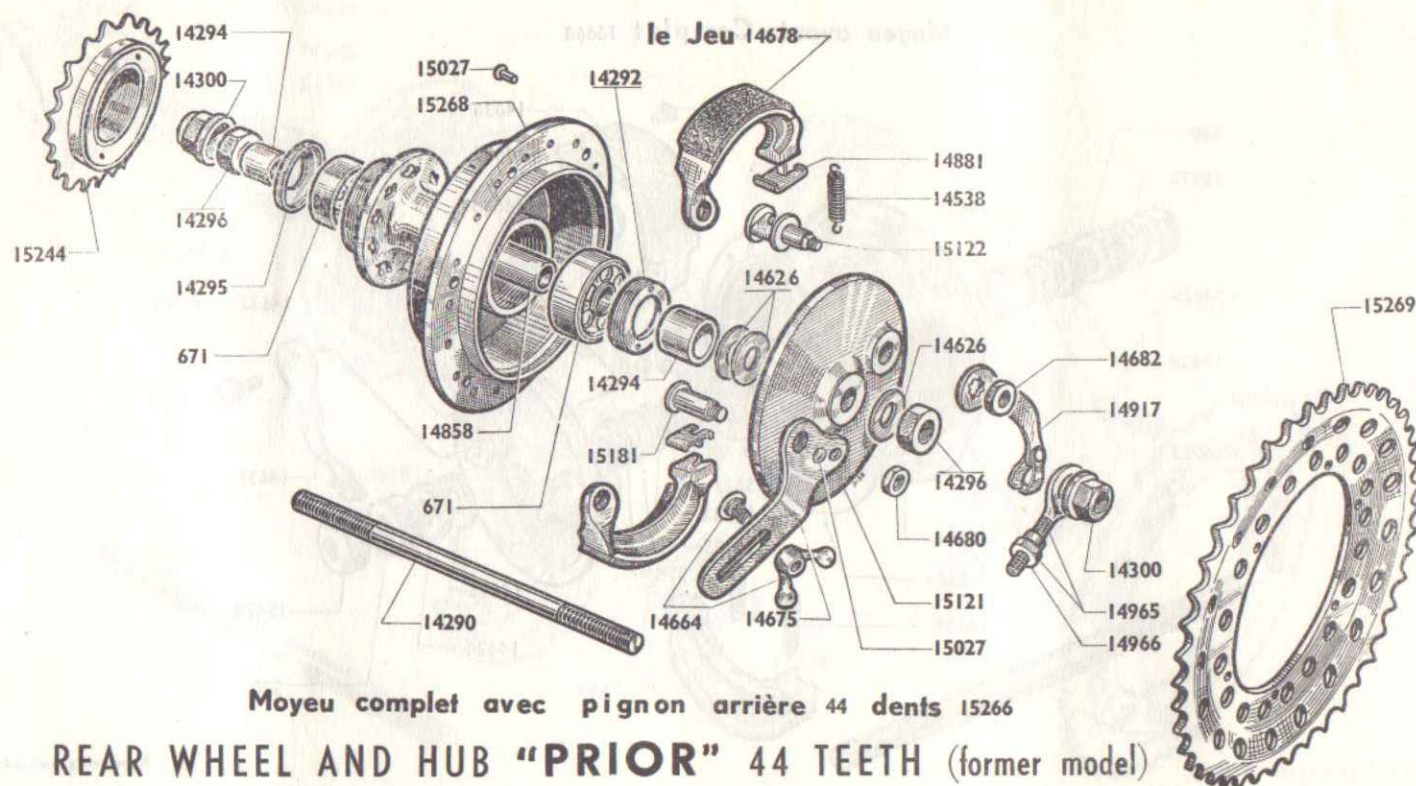

Moyeu complet avec pignon arrière 44 dents 15266

REAR WHEEL AND HUB "PRIOR" 44 TEETH (former model)

SEPTEMBER 1959

Part N°	Group	Quantity per machine	DESCRIPTION	Part N°	Group	Quantity per machine	DESCRIPTION
WHEEL							
14989	4	36	Spoke nipple French gauge 16	14538	5	1	Jaw spring
15535	1	1	Rim for tyre size 23" x 2"	14626	4	3	Hub plain washer
15536	1	1	Hutchinson tyre 23" x 2" (white wall)	14664	4	1	Screw securing the flange with wing nut
15537	1	1	Hutchinson inner tube 23" x 2" (French valve) ...	14664	4	1	Rear brake anchoring lug
15538	4	1	Rim tape	14675	4	1	Pair of jaws \varnothing 90 ^m / _m
15807	1	S.A.	Rear wheel complete with cog wheel 44 teeth ...	14678	4	1	Fixed pivot nut
15808	4	18	Spoke 16 x 15 x 16 - length : 227,5 ^m / _m (R.H. side) with nipple	14680	4	1	Cam nut
15809	4	18	Spoke 16 x 15 x 16 - length : 197 ^m / _m (L.H. side) with nipple	14682	4	1	Ball bearing distance piece 48,2 ^m / _m long
15815	1	1	Hutchinson tyre 23" x 2" (black)	14858	4	1	Jaw steel plate
HUB							
671	5	2	Ball bearing 10 x 30 x 9	14881	4	2	Rear cam lever
14290	4	1	Rear hub axle stripped \varnothing 10 ^m / _m	14917	4	1	Wheel adjuster with nut
14292	4	1	Bearing lock nut, drum side	14965	5	2	Adjuster nut
14294	4	2	Hub distance piece, right and left, inner \varnothing 10 ^m / _m 11 ^m / _m long	14966	5	2	Rivet for rear cog wheel and anchoring lug \varnothing 4,5 x 11 ^m / _m
14295	4	1	Dust deflector \varnothing 30 ^m / _m	15027	5	8	S.A. Jaw flange complete
14296	4	2	Hub nut	15120	4	4	Jaw flange stripped
14300	4	2	Rear wheel nut \varnothing 10 ^m / _m	15121	4	1	Jaw cam with nut
				15122	4	1	Fixed pivot
				15181	4	1	Freewheel 18 teeth 34,7 x 100
				15242	4	1	S.A. Rear hub complete with cog wheel 44 teeth
				15266	4	4	S.A. Rear hub body complete with cog wheel 44 teeth ..
				15267	4	1	Rear hub body stripped with cog wheel 44 teeth ..
				15268	4	1	Rear cog wheel 44 teeth
				15269	4	1	

MOBYLETTE Type AV 76 or AU 76

Moyeu avant Complet 16660

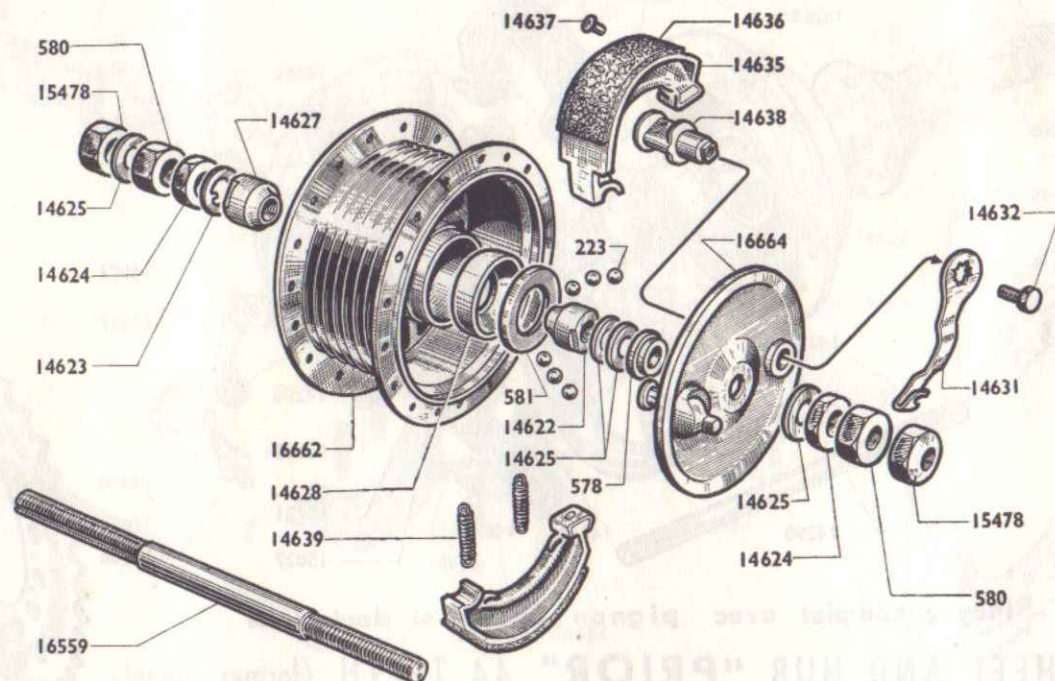

Reprinting forbidden

FRONT WHEEL and HUB ("IDEAL" MONOBLOC) $\varnothing 90 \frac{m}{m}$ (New model)

SEPTEMBER 1959

Part N°	Group	Quantity per machine	DESCRIPTION	Part N°	Group	Quantity per machine	DESCRIPTION
WHEEL							
14989	4	36	Spoke nipple French gauge 16	14624	4	2	Lock nut $\varnothing 11 \frac{m}{m} - 5 \frac{m}{m}$ thick
15535	1	1	Rim 23" x 2"	14625	4	4	Spacer
15536	1	1	Hutchinson tyre 23" x 2" (white wall)	14627	4	1	Adjustable cone
15537	1	1	Hutchinson inner tube 23" x 2" (French valve)	14628	4	2	Cup $\varnothing 31,10 \frac{m}{m}$
15538	4	1	Rim tape	14631	4	1	Cam lever
15542	4	36	Front wheel spoke 15 x 16-197 $\frac{m}{m}$ long, with nipple	14632	4	1	Cam lever securing screw
15815	1	1	Hutchinson tyre 23" x 2" (black)	14635	4	2	Jaw $\varnothing 90 \frac{m}{m}$
16659	1	S.A.	Front wheel complete	14636	4	2	Ferodo lining
HUB							
223	5	20	Front hub ball 6,35 $\frac{m}{m}$ ($\frac{1}{4}$ in.)	14637	5	8	Ferodo rivet
578	4	1	Flange centring spacer $\varnothing 11 \times 20 \times 14-4,8 \frac{m}{m}$ thick	14638	4	1	Jaw cam
580	4	2	Hub nut	14639	5	2	Jaw spring
581	4	2	Dust deflector	15478	4	2	Wheel nut $\varnothing 11 \frac{m}{m}$
14622	4	1	Fixed cone	16559	4	1	Front hub axle stripped $\varnothing 11 \frac{m}{m} - 143 \frac{m}{m}$ long
14623	4	1	Tongued washer	16660	4	S.A.	Front hub complete
				16662	4	1	Front hub body stripped
				16663	4	S.A.	Jaw flange complete
				16664	4	1	Jaw flange stripped

NOTE. - The hub illustrated here is designed for the wide front fork N° 16551 (110 $\frac{m}{m}$ wide).

MOBYLETTE Type AV 76 or AU 76

Moyeu complet avec pignon arrière 44 dents 16666

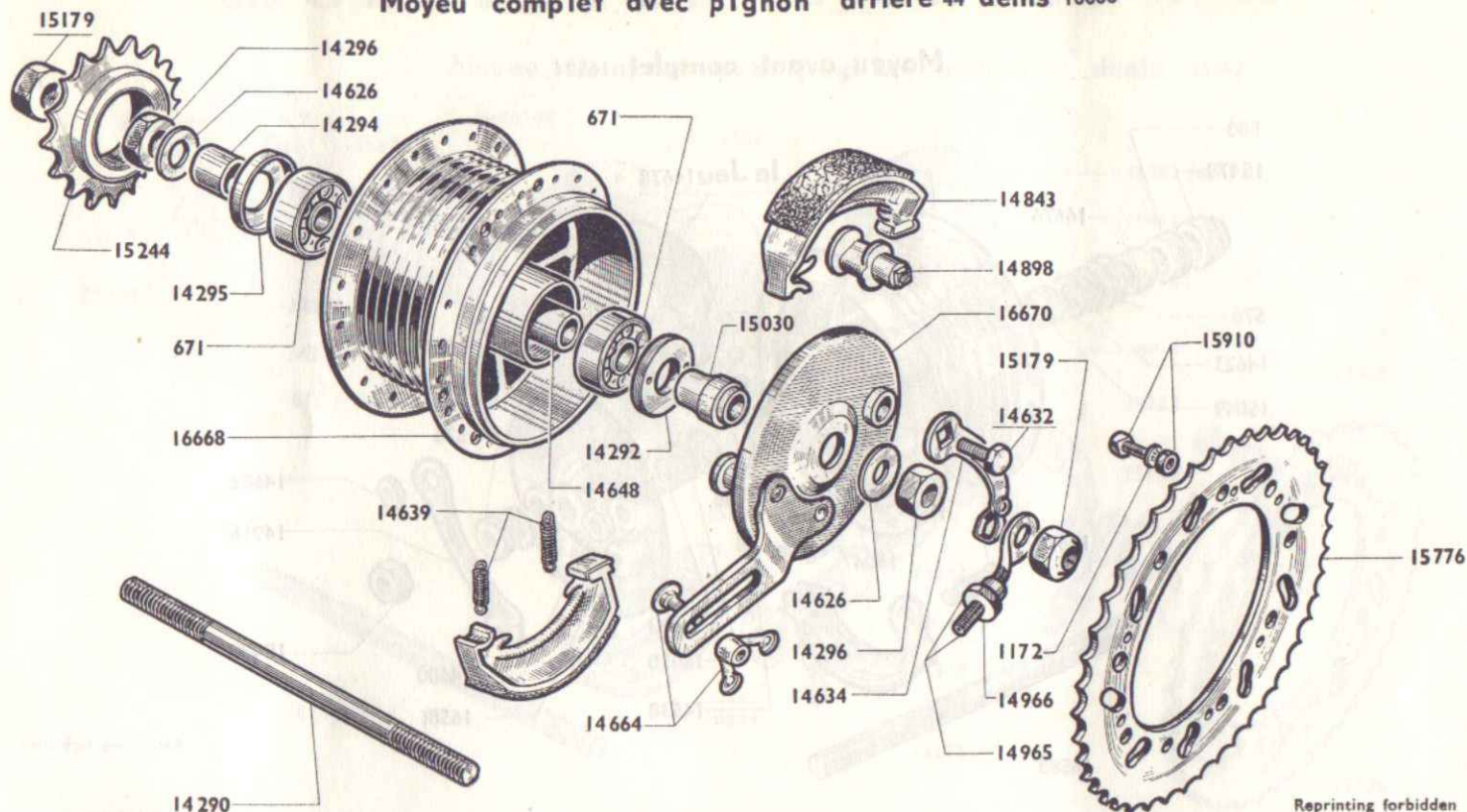

Reprinting forbidden

REAR WHEEL and HUB ("IDEAL" MONOBLOC) $\varnothing 100 \frac{m}{m}$ (New model)

SEPTEMBER 1959

Part N°	Group	Quantity per machine	DESCRIPTION	Part N°	Group	Quantity per machine	DESCRIPTION
WHEEL							
14989	4	36	Spoke nipple, French gauge 16.....	14632	4	1	Screw securing the cam lever.....
15535	1	1	Rim 23" x 2".....	14634	4	1	Rear hub cam lever.....
15536	1	1	Hutchinson tyre 23" x 2" (white wall).....	14639	5	2	Jaw spring.....
15537	1	1	Hutchinson inner tube 23" x 2" (French valve).....	14648	4	1	Bearing distance piece 53 $\frac{m}{m}$ long.....
15538	4	1	Rim tape.....	14664	4	1	Screw securing the flange, with wing nut.....
15815	1	1	Hutchinson tyre 23" x 2" (black).....	14843	4	2	Jaw $\varnothing 100 \frac{m}{m}$
16532	4	36	Spoke 16 x 16 x 16 L = 193 $\frac{m}{m}$ with nipple.....	14898	4	1	Jaw cam.....
16665	4	S.A.	Rear wheel complete with 44 teeth sprocket.....	14965	5	2	Wheel adjuster with nut.....
HUB							
671	5	2	Ball bearing 10 x 30 x 9 $\frac{m}{m}$	14966	5	2	Adjuster nut.....
1172	6	6	Nomel washer $\varnothing 6 \frac{m}{m}$	15030	4	1	Distance piece for flange truing.....
14290	4	1	Rear hub axle $\varnothing 10 \frac{m}{m}$	15179	4	2	Rear wheel nut $\varnothing 10 \frac{m}{m}$
14292	4	1	Bearing lock nut.....	15244	4	1	Freewheel 18 teeth - 34,7 x 100.....
14294	4	1	Hub distance piece, R.H. side, inner $\varnothing 10 \frac{m}{m}$ - 11 $\frac{m}{m}$ long.....	15776	1	1	Rear cog wheel 44 teeth (for 6 bolts setting).....
14295	4	1	Dust deflector, outer $\varnothing 30 \frac{m}{m}$	15910	4	6	Square head bolt securing rear cog wheel 6/100 x 14 $\frac{m}{m}$
14296	4	2	Hub nut.....	16666	4	S.A.	Rear hub with bolted cog wheel 44 teeth.....
14626	4	2	Hub plain washer.....	16667	4	S.A.	Rear hub body complete (without cog wheel).....
				16668	4	1	Rear hub body stripped (without cog wheel).....
				16669	4	S.A.	Jaw flange complete.....
				16670	4	1	Jaw flange stripped.....

S.A. = Sub-assembly (not illustrated).

Reprinting forbidden

MOBYLETTE Type AV 76 or AU 76

Moyeu avant complet 16584

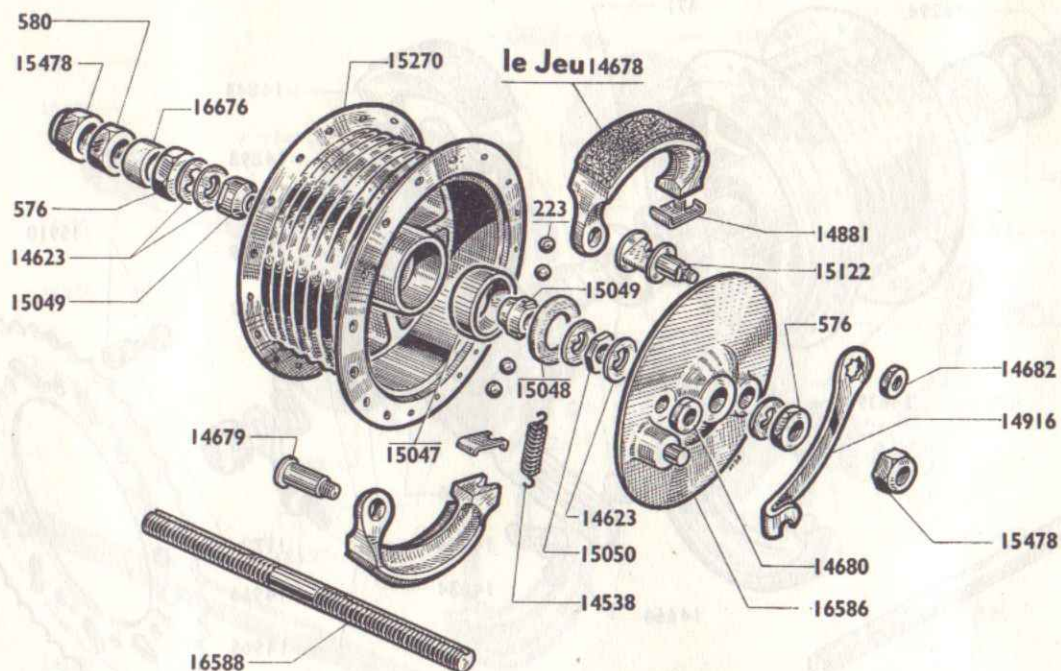

Reprinting forbidden

FRONT WHEEL and HUB ("PRIOR" MONOBLOC) New model

SEPTEMBER 1959

Part N°	Group	Quantity per machine	DESCRIPTION	Part N°	Group	Quantity per machine	DESCRIPTION
WHEEL							
14989	4	36	Spoke nipple, French gauge 16.....	14680	4	1	Fixed pivot nut.....
15535	1	1	Rim 23"×2".....	14682	4	1	Jaw cam nut.....
15536	1	1	Hutchinson tyre (white wall) 23"×2".....	14881	4	2	Jaw steel plate.....
15537	1	1	Hutchinson inner tube 23"×2 (French valve).....	14916	4	1	Front brake cam lever.....
15538	4	1	Rim tape.....	15047	4	2	Front hub cup.....
15542	4	36	Spoke 15×15×16 L = 197, with nipple.....	15048	4	2	Dust deflector Ø 31 ^m / _m
15815	1	1	Hutchinson inner tube 23"×2" (black).....	15049	4	2	Front wheel fixed or adjustable cone.....
16589	1	S.A.	Front wheel complete.....	15050	4	2	Cone lock nut.....
HUB							
223	5	20	Hub ball 6,35 ^m / _m	15122	4	1	Jaw cam with nut.....
576	4	2	Lock nut.....	15270	4	1	Hub body stripped.....
580	4	1	Hub nut.....	15478	4	2	Wheel nut.....
14538	5	1	Jaw spring.....	16584	4	S.A.	Front hub complete.....
14623	4	5	Tongued washer.....	16585	4	S.A.	Jaw flange complete.....
14678	4	1	Pair of jaws Ø 90 ^m / _m	16586	4	1	Jaw flange stripped.....
14679	4	1	Front brake fixed pivot.....	16587	4	S.A.	Front hub axle complete.....
				16588	4	1	Front hub axle stripped.....
				16676	4	1	Distance piece Ø 11×14 ^m / _m - 6,5 ^m / _m thick (cowel).....

NOTE. - The hub illustrated here is designed for the wide front fork N° 16551 (110 ^m/_m wide).

MOBYLETTE Type AV 76 or AU 76

Moyeu Complet avec pignon arrière 44 dents 16592

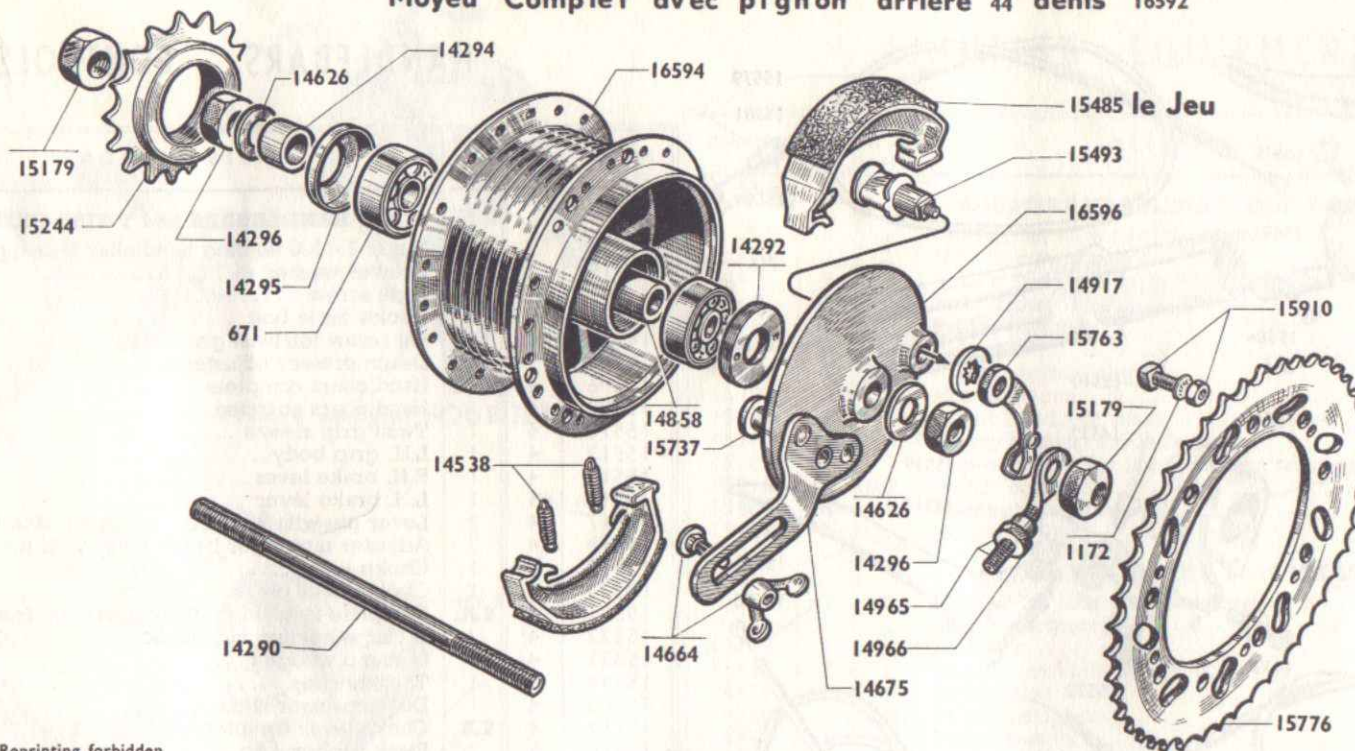

Reprinting forbidden

REAR WHEEL and HUB ("PRIOR" MONOBLOC) new model

SEPTEMBER 1959

Part N°	Group	Quantity per machine	DESCRIPTION	Part N°	Group	Quantity per machine	DESCRIPTION
WHEEL							
14989	4	36	Spoke nipple, French gauge 16.....	14664	4	1	Screw securing the flange with wing nut
15535	1	1	Rim 23" x 2"	14675	4	1	Rear brake anchoring lug
15536	1	1	Hutchinson tyre 23" x 2" (white wall)	14858	4	1	Ball bearing distance piece 48,2 $\frac{m}{m}$ long
15537	1	1	Hutchinson inner tube 23" x 2" (French valve).....	14917	4	1	Cam lever
15538	4	1	Rim tape	14965	5	2	Wheel adjuster with nut
15815	1	1	Hutchinson tyre 23" x 2" (black)	14966	5	2	Adjuster nut
16532	4	36	Spoke 16 x 15 x 16 - Length 193 $\frac{m}{m}$ - with nipple	15179	4	2	Rear wheel nut \varnothing 10 $\frac{m}{m}$
16597	1	S.A.	Rear wheel complete with cog wheel 44 teeth	15244	4	1	Freewheel 18 teeth 34,7 x 100
HUB							
671	5	2	Ball bearing 10 $\frac{m}{m}$ x 30 $\frac{m}{m}$ x 9 $\frac{m}{m}$	15485	4	1	Pair of jaws \varnothing 100 $\frac{m}{m}$
1172	6	6	Nomel washer \varnothing 6 $\frac{m}{m}$	15493	4	1	Cam with nut
14290	4	1	Rear hub axle stripped \varnothing 10 $\frac{m}{m}$	15737	4	1	Fixed pivot to be rivetted
14292	4	1	Bearing lock nut drum side	15763	4	1	Cam nut 8 x 100
14294	4	1	Hub distance piece, right and left, inner \varnothing 10 $\frac{m}{m}$..	15776	4	1	Rear cog wheel 44 teeth (for 6 bolts setting).....
14295	4	1	Dust deflector \varnothing 30 $\frac{m}{m}$	15910	4	6	Square head bolt securing rear cog wheel 6x100x14 $\frac{m}{m}$
14296	4	2	Hub nut	16592	4	S.A.	Rear hub with cog wheel 44 teeth bolted
14538	5	2	Jaw spring	16593	4	S.A.	Rear hub body complete (without cog wheel).....
14626	4	2	Hub plain washer	16594	4	1	Rear hub body stripped (without cog wheel)
				16595	4	S.A.	Jaw flange complete
				16596	4	1	Jaw flange stripped

MOBYLETTE

Type AV 76 or AU 76

HANDLEBARS - CONTROLS

SEPTEMBER 1959

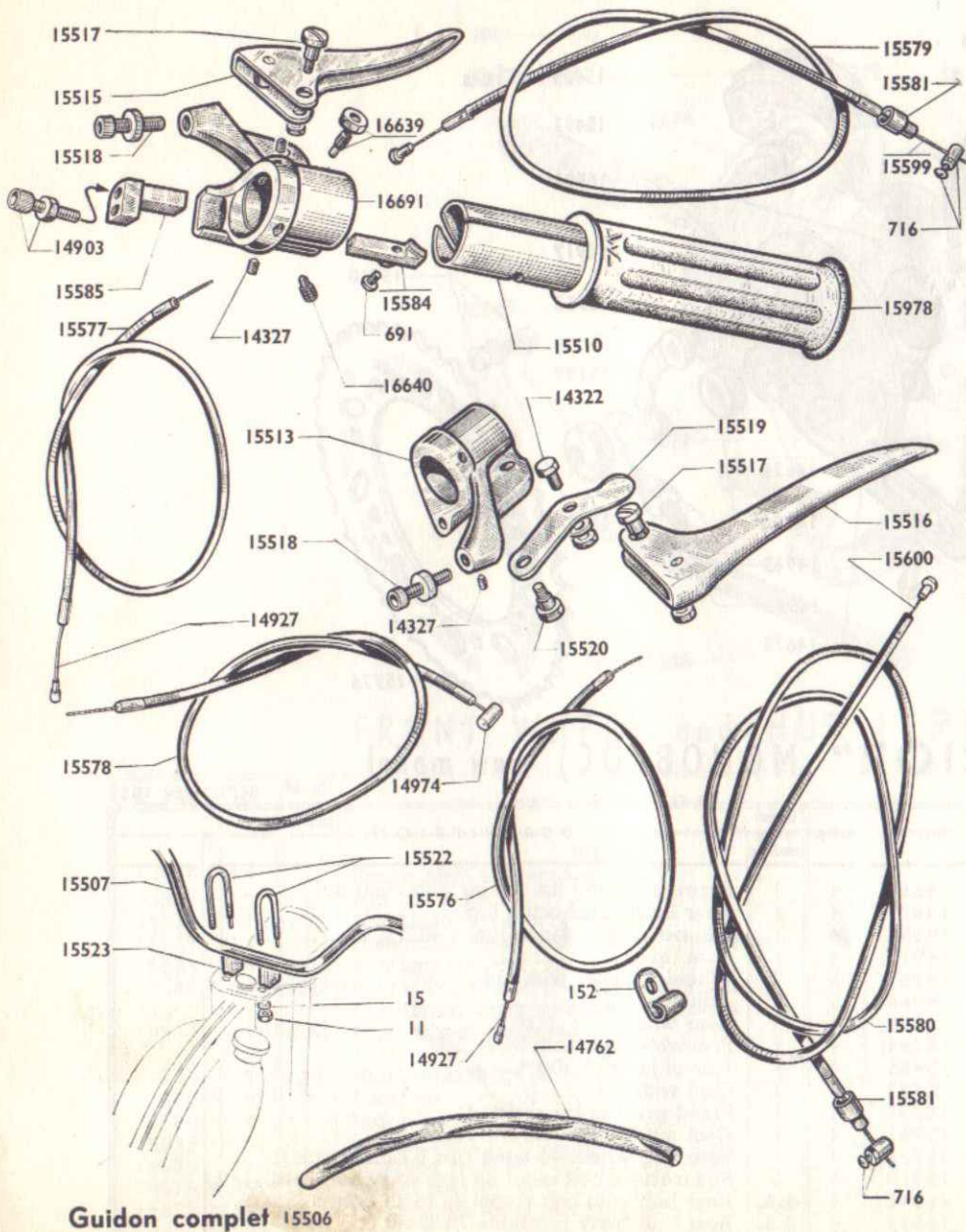

Part N°	Group	Quantity per machine	DESCRIPTION
HANDLEBARS and TWIST GRIP			
11	5	2	Nut of 7×100 holding handlebar U clamp
15	5	2	Grower washer $\varnothing 7\frac{m}{m}$
691	4	2	Slide screw.....
14322	4	1	Choke cable bolt
14327	4	5	Set screw for twist grip body
14903	5	1	Decompressor adjuster
15506	4	S.A.	Handlebars complete
15507	4	1	Handlebars stripped.....
15510	4	1	Twist grip sleeve
15513	4	1	L.H. grip body.....
15515	4	1	R.H. brake lever
15516	4	1	L.H. brake lever
15517	4	2	Lever pin with nut.....
15518	4	2	Adjuster nipple for brake lever with nut
15519	4	1	Choke lever
15520	4	1	Choke lever pin.....
15521	4	S.A.	Complete fastening of handlebars on front fork ...
15522	4	2	U clamp holding handlebars.....
15523	4	2	U clamp wedge
15584	4	1	Throttle slide
15585	4	1	Decompressor slide
15712	4	S.A.	Choke lever complete
15978	5	2	Black rubber grip
15991	4	S.A.	L.H. grip body
16639	4	1	Securing screw with nut $\varnothing 5\frac{m}{m} \times 90$ - Length : $12\frac{m}{m}$ 5
16640	4	1	Twist grip set screw $\varnothing 6\frac{m}{m} \times 100$ - Length : $11\frac{m}{m}$.
16691	4	1	Twist grip body
16696	4	S.A.	Twist grip complete (black rubber).....
CONTROLS			
152	5	1	Front brake cable clip
716	5	2	Front and rear brake cable clamp
14762	5	3	Plastic outer casing
14927	5	1	Throttle cable.....
14927	5	1	Choke cable
14974	4	1	Decompressor cable.....
15576	4	1	Choke control complete
15577	4	1	Throttle control complete
15578	4	1	Decompressor control complete
15579	4	1	Front brake control complete.....
15580	4	1	Rear brake control complete
15581	4	2	Outer casing shouldered end of front and rear brake
15599	5	1	Front brake cable
15600	5	1	Rear brake cable.....

S.A. = Sub-assembly (not illustrated).

MOBYLETTE

Type AV 76 or AU 76

LIGHTING EQUIPMENT

SEPTEMBER 1959

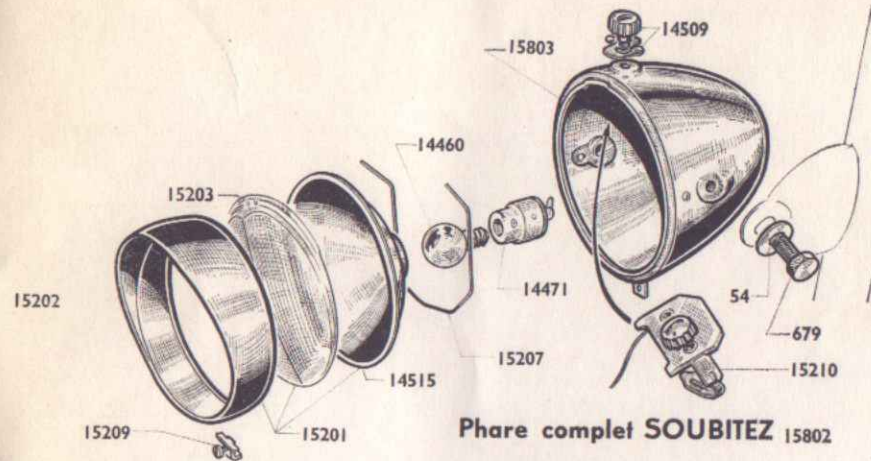

Phare complet SOUBITEZ 15802

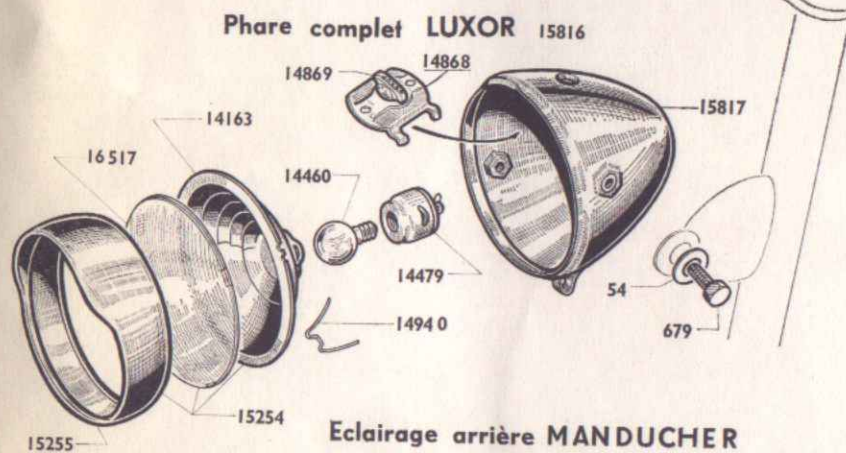

Phare complet LUXOR 15816

Eclairage arrière MANDUCHER complet 15312

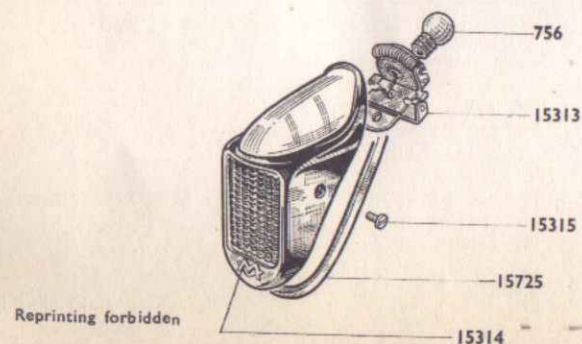

Reprinting forbidden

Part N°	Group	Quantity per machine	DESCRIPTION
SOUBITEZ HEADLIGHT, SIDE FIXATION			
54	3	2	Washer for side fixation screw (B)
679	3	2	Side fixation screw
14460	3	1	Yellow headlight bulb 6 V. 1 Amp.
14471	3	1	Bulb socket
14509	3	1	Switch button
14515	3	1	Reflector
15201	3	S.A.	Plastic optical assembly
15202	3	1	Headlight rim
15203	3	1	Plastic headlight glass
15207	3	1	Spring holding the reflector
15209	3	1	Clip securing the headlight rim with screw
15210	3	S.A.	Switch complete
15802	3	S.A.	Headlight complete
15803	3	1	Headlight shell
LUXOR HEADLIGHT, SIDE FIXATION			
54	3	2	Washer for side fixation screw (B)
679	3	2	Side fixation screw
14163	3	1	Reflector
14460	3	1	Yellow headlight bulb 6 V. 1 Amp.
14479	3	1	Bulb socket
14868	3	S.A.	Switch complete
14869	3	1	Switch button
14940	3	3	Spring holding the reflector
15254	3	S.A.	Optical assembly
15255	3	1	Headlight rim
15816	3	S.A.	Headlight complete
15817	3	1	Headlight shell
16517	3	1	Headlight glass Ø 108
MANDUCHER TAIL LIGHT			
756	3	1	Tail light bulb 12 V. 0,5 Amp.
15312	3	S.A.	Tail light complete
15313	3	1	Tail light support
15314	3	1	Tail light cover with gasket
15315	3	2	Tail light cover screw
15725	3	1	Tail light gasket

IMPORTANT NOTICE. - The parts marked (B) are sold in small bags only.

S.A. = Sub-assembly (not illustrated).

Reprinting forbidden

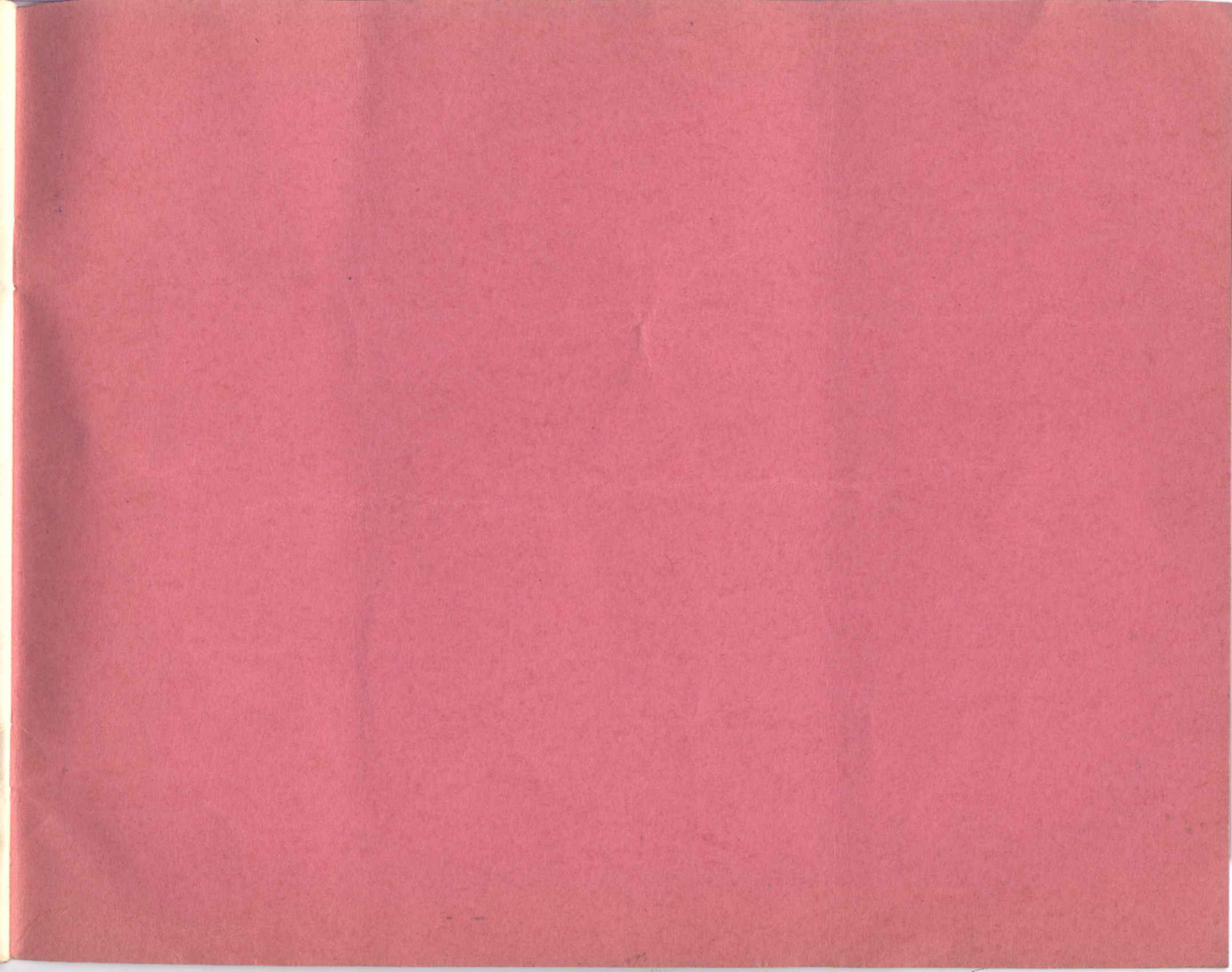

10 MORE MODELS OF MOBYLETTES AVAILABLE

More than

2.500.000 "Mobylette"

in the World

World's biggest production !

IceniCAM On-Line Library

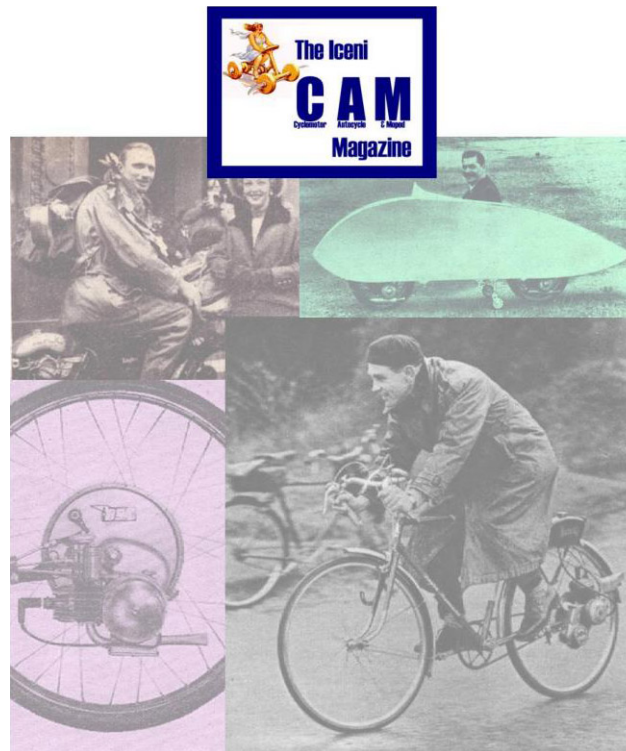

www.icenicam.org.uk