

MOTOBÉCANE



MOTOCONFORT



SPARE PARTS CATALOGUE

Mobylette

SERIES 50



Types 50 S
50 VS
50 L
50 VL

SERIES 50

FEBRUARY 1972

SUMMARY

PAGE	DESCRIPTION	TYPE
2	Engine unit - Swivelling attachment.....	Series 50
3	Exhaust.....	Series 50
4	Marking piston-cylinder.....	Series 50
5	Clutch "DIMOBY".....	Types 50 S - 50 L
6	Automatic gear change.....	Types 50 VS - 50 VL
7	Carburettor Typ AR 2-12 - Adj. 705 - Petrol pipe - Petrol tap.....	Series 50
8	Carburettor Typ AR 2-12 - Adj. 729c - Petrol pipe - Petrol tap.....	Types 50 S - 50 L
9	Flywheel magneto 8 watts with outer coil.....	Series 50
10	Handlebar - Twist gripp - Controls.....	Series 50
11	Frame - Mudguard - Chainguard - Centre stand - Rear suspension.....	Series 50
12	Telescopic fork - Steering head races.....	Series 50
13	Front wheel and hub "PRIOR" $\varnothing 80 \frac{m}{m}$	Series 50
14	Rear wheel and hub "PRIOR" $\varnothing 80 \frac{m}{m}$	Series 50
15	Pedal unit - Chains - chain tensioner.....	Series 50
16	Saddle.....	Series 50
17	Square Headlamp "LUXOR" - Horn.....	Types 50 L - 50 VL
18	Rectangular Headlamp "LUXOR" - Tail lamp.....	Types 50 S - 50 VS
19	Speedometer "HURET" 90 km.....	Types 50 L - 50 VL
20	Legshield.....	Series 50

MOBYLETTE Series 50

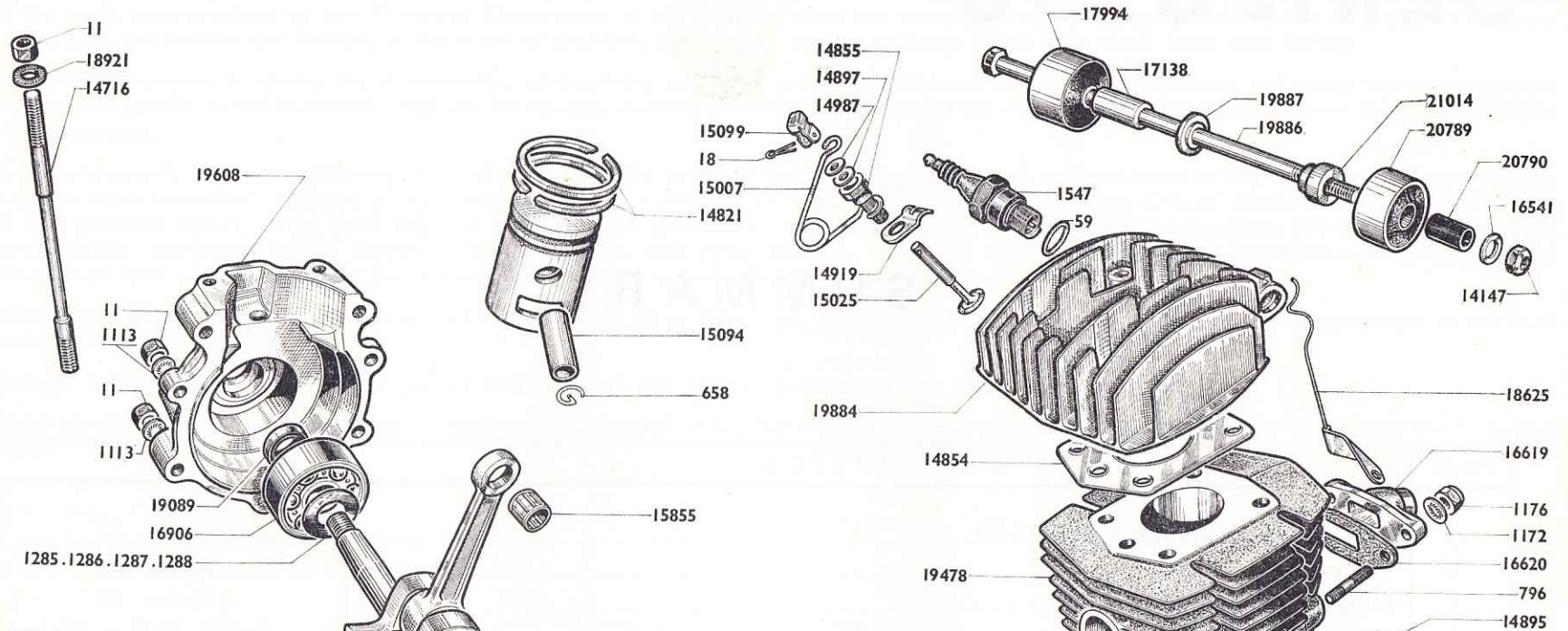

Vilebrequin complet: 19609

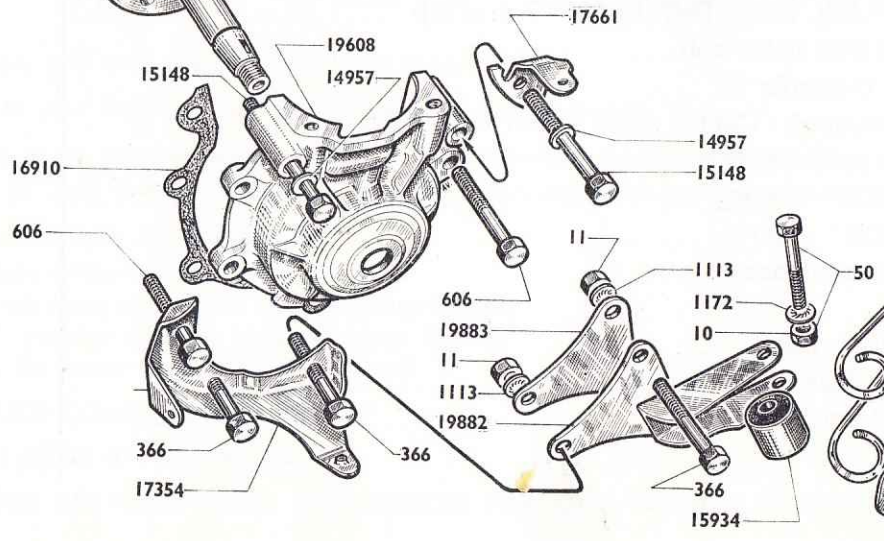

Jeu de Vis Carter moteur: 18568

Jeu de joints moteur: 16912

Culasse complète: 19885

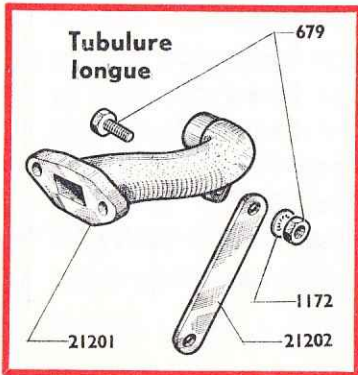

MOBYLETTE Series 50

ENGINE UNIT - SWIVELLING ATTACHMENT

Part N°	Quantity per machine	DESCRIPTION		Part N°	Quantity per machine	DESCRIPTION
ENGINE				15099	1	Valve link (C. 2)
ENGINE ATTACHMENT				15148	2	Screw $\varnothing 7\frac{m}{m} \times 125 \times 45\frac{m}{m}$
10		Nut $\varnothing 6\frac{m}{m} \times 100$ (C. 25)		15855	1	Small end needle cartridge (C. 3)
11		Nut $\varnothing 7\frac{m}{m} \times 100$ (C. 50)		15933	1	Set of two tensioner spring
18	1	Decompressor split pin (C. 50)		15934	1	Spring silentblock $\varnothing 6\frac{m}{m} \times 20\frac{m}{m} \times 22\frac{m}{m} \times 16\frac{m}{m}$ (C. 5)
50	1	Axle bolt, silentbloc $\varnothing 6\frac{m}{m} \times 100 \times 32\frac{m}{m}$ (C. 25)		16541	1	Upper articulation L.H. washer $\varnothing 8 \times 15 \times 1$ (C. 15)
59	1	Spark plug gasket (C. 10)		16619	1	Inlet pipe inner $13\frac{m}{m}$ - Outer $17\frac{m}{m}$ see NOTE II
366	3	Bolt $\varnothing 7\frac{m}{m} \times 100 \times 47\frac{m}{m}$ (C. 10)		16620	1	Inlet pipe gasket (C. 10)
606	2	Bolt $\varnothing 7\frac{m}{m} \times 100 \times 35\frac{m}{m}$ (C. 10)		16906	2	Crankshaft bearing $16\frac{m}{m} \times 42\frac{m}{m} \times 13\frac{m}{m}$ (C. 10)
658	2	Gudgeon pin circlips (C. 20)		16910	1	Crankcase gasket (C. 10)
796	2	Inlet pipe stud (C. 10)		16912	S.A.	Set of engine gasket
968	2	Bolt securing the springs $6\frac{m}{m} \times 100\frac{m}{m} \times 20\frac{m}{m}$ (C. 10)		16967		Cylinder aluminium wedge $2/10\frac{m}{m}$ (C. 5)
1113		"NOMEL" washer $\varnothing 7\frac{m}{m}$ (C. 50)		16968		Cylinder aluminium wedge $4/10\frac{m}{m}$ (C. 5)
1172	3	"NOMEL" washer $\varnothing 6\frac{m}{m}$ (C. 50)		17120	1	Tensioner spring stop lug
1176	2	"NYLSTOP" nut $\varnothing 6\frac{m}{m} \times 100$ (C. 10)		17138	1	R.H. distance piece upper articulation $\varnothing 8\frac{m}{m} \times 12\frac{m}{m} \times 22\frac{m}{m}$
1285		Crankshaft adjusting wedge $\varnothing 18.9 \times 24 \times 1/10$ (C. 10)		17354	1	Double lug, holding pulley guard
1286		Crankshaft adjusting wedge $\varnothing 18.9 \times 24 \times 2/10$ (C. 10)		17661	1	Upper lug crankcase
1287		Crankshaft adjusting wedge $\varnothing 18.9 \times 24 \times 3/10$ (C. 10)		17994	1	Upper rubber bush $8 \times 32 \times 23.2 \times 18\frac{m}{m}$ (R.H.). (C. 5)
1288		Crankshaft adjusting wedge $\varnothing 18.9 \times 24 \times 5/10$ (C. 10)		18568	S.A.	Set of bolts, crankcase
1547	1	Spark plug with gasket $\varnothing 14\frac{m}{m}$		18625	1	Retainer H.T. Cable (C. 5)
14147	1	Nut, swivel axle $\varnothing 8 \times 100\frac{m}{m}$		18921	4	Plain washer $\varnothing 7\frac{m}{m}$ (C. 10)
14716	4	Stud holding cylinder and cylinder head (C. 10)		19089	2	Leakproof gasket for crankcase (C. 6)
14721	S.A.	Decompressor assembly complete		19478	1	Cylinder with piston complete matched
14821	2	Piston ring width $2\frac{m}{m}$ (C. 10)		19608	1	Engine crankcase with leakproof gaskets
14854	1	Cylinder head gasket (C. 10)		19609	S.A.	Crankshaft complete (shaft $\varnothing 16\frac{m}{m}$)
14855	1	Decompressor body		19881	S.A.	Engine complete 50VS-50 VL
14895	1	Cylinder gasket (C. 20)		19882	1	L.H. lower engine support
14897	1	Decompressor valve gasket (C. 10)		19883	1	R.H. lower engine support
14919	1	Anchoring lug		19884	1	Cylinderhead stripped
14957	2	Flat washer $\varnothing 7\frac{m}{m}$ (C. 20)		19885	S.A.	Cylinderhead complete
14987	1	Washer for valve gasket (C. 20)		19886	1	Engine upper articulation bolt $8\frac{m}{m} \times 100 \times 137\frac{m}{m}$ (C. 6)
15007	1	Decompressor spring		19887	1	Upper articulation shouldered washer
15025	1	Decompressor valve (C. 5)		20035	S.A.	Engine complete 50S-50L
	S.A.	Piston complete see Note I.		20789	1	Upper rubber bush $11\frac{m}{m} \times 32\frac{m}{m} \times 23.2\frac{m}{m} \times 18\frac{m}{m}$ (L.H.)
15094	1	Piston pin		20790	1	Insulator ring, L.H. $\varnothing 11 \times 32 \times 23.2 \times 18$ L.H.
				21014	1	L.H. upper articulation shouldered washer

NOTE I. - For the reference of these various pistons see page 4.

NOTE II. - After September 10, 1971, the type 50 S and 50 L machines are equipped with a motor with a long inlet pipe.

See the different parts below :

- 21200 Complete motor
- 21201 Long inlet pipe in place of 16619
- 21202 Antivibration lug
- 21238 Lower motor fastening lug left side in place of 19882
- 21282 Tension spring stop lug in place of 17120

MOBYLETTE Series 50

EXHAUST

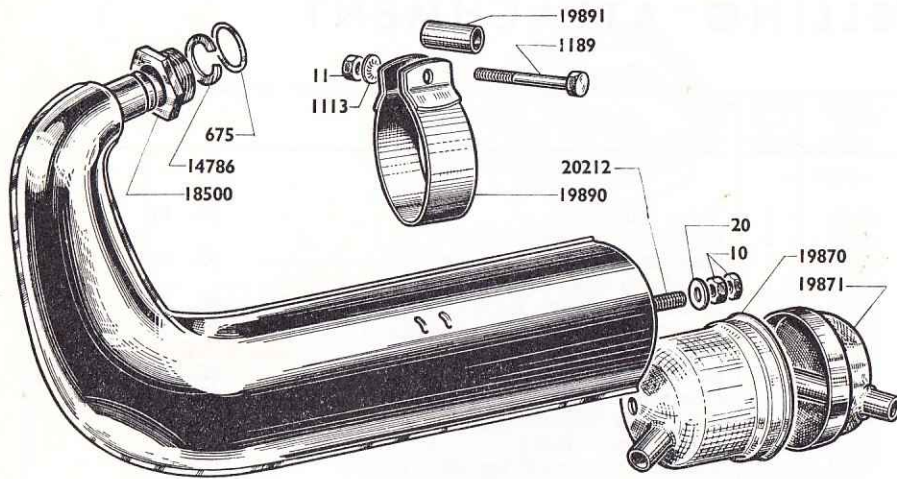

Part N°	Quantity per machine	DESCRIPTION	
EXHAUST			
10	2	Nut $\varnothing 6\frac{m}{m} \times 100$	(C. 25)
11	1	Nut $\varnothing 7\frac{m}{m} \times 100$	(C. 25)
20	1	Flat washer $\varnothing 6\frac{m}{m}$	(C. 25)
675	1	Exhaust gasket	(C. 30)
1113	1	"NOMEL" washer $\varnothing 7\frac{m}{m}$	(C. 50)
1189	1	Silencer bolt $\varnothing 7\frac{m}{m} \times 100 \times 52\frac{m}{m}$	(C. 25)
14786	1	Nut thrust ring	
18500	1	Nut exhaust pipe	(C. 5)
19869	S.A.	Exhaust complete	
19870	1	Filter complete	
19871	1	Tail cap	
19890	1	Silencer clip	
19891	1	Lower distance piece for silencer $\varnothing 8\frac{m}{m} \times 12\frac{m}{m}$ - L=30 $\frac{m}{m}$	(C. 6)
20212	1	Tail cap rod	(C. 5)

After 9/10/71 the 50 S - 50 L engines have an oval muffler.

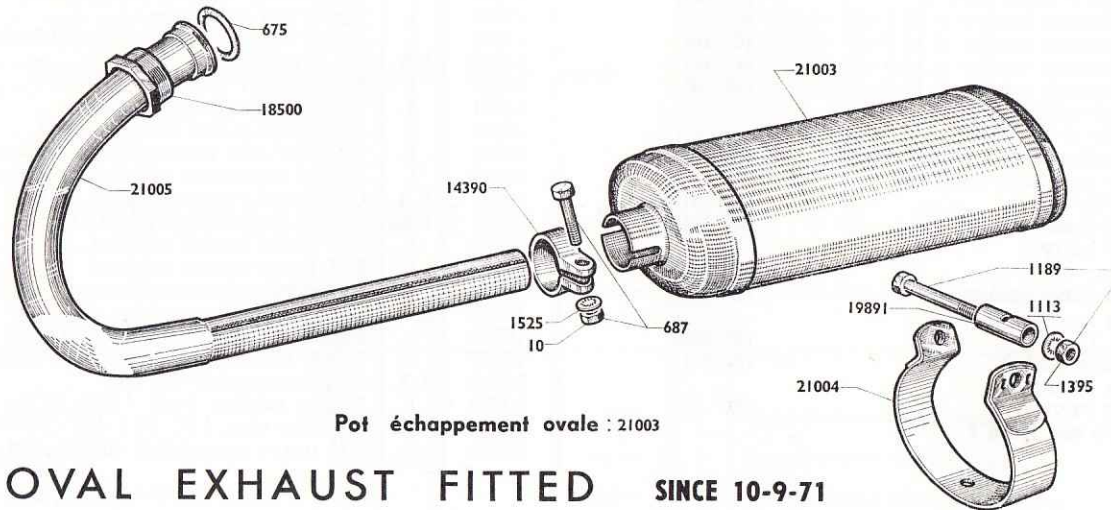

Pot échappement ovale : 21003

OVAL EXHAUST FITTED SINCE 10-9-71

Reprinting forbidden

Part N°	Quantity per machine	DESCRIPTION		Part N°	Quantity per machine	DESCRIPTION	
10	1	Nut $\varnothing 6 \times 100 \times 10 \times 6$	(C. 25)	14390	1	Clip securing silencer on pipe	(C. 5)
675	1	Exhaust gasket	(C. 30)	18500	1	Nut, exhaust pipe	(C. 5)
687	1	Bolt securing silencer on pipe $\varnothing 6 \times 100$ L=29	(C. 25)	19891	1	Spacer, silencer $\varnothing 8 \times 12$ L=30	(C. 6)
1113	1	"NOMEL" washer \varnothing	(C. 50)	21003	S.A.	Silencer complete	
1189	1	Bolt for silencer clip $\varnothing 7 \times 100$ L=52	(C. 25)	21004	1	Clip securing silencer on frame	
1395	1	Nut $\varnothing 7 \times 100$ L=52	(C. 25)	21005	1	Exhaust pipe	
1525	1	"NOMEL" washer $\varnothing 6\frac{m}{m}$	(C. 20)				

MARKING PISTON - CYLINDER

The matching "Piston-cylinder" is operated, thanks to a code illustrated by a letter marked on the cylinder top.

For every order of bare piston it is necessary to mention the letter with the N° (see chart).

The cylinders are never supplied bare.

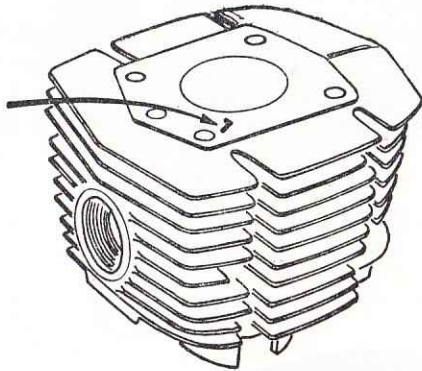

FOR INSTANCE :

For a cylinder, marked L, you should
order a piston N° 21250

REFERENCE LETTER	PISTON \varnothing $\frac{m}{m}$	SPARE PART NUMBER
A	38 - 940	21.240
C	- - 950	21.242
E	- - 960	21.244
G	- - 970	21.246
J	- - 980	21.248
L	- - 990	21.250
N	39 - 000	21.252
P	- - 010	21.254

MOBYLETTE

Types 50 S - 50 L

"DIMOBY" CLUTCH

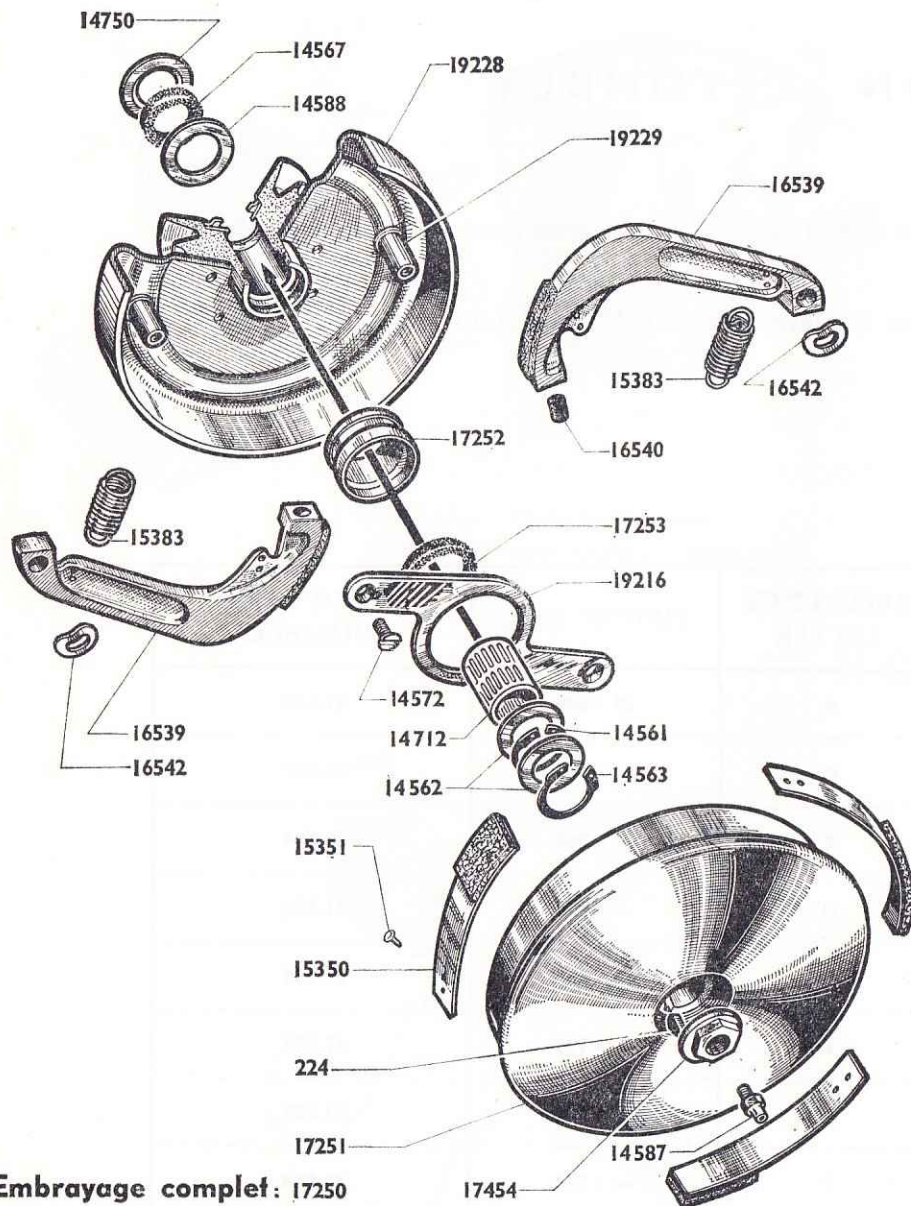

Embrayage complet: 17250

Part N°	Quantity per machine	DESCRIPTION	
224	1	Woodruff key, clutch drum	(C. 10)
14561	1	Outer circlips $\varnothing 15\frac{m}{m}$	(C. 25)
14562	2	Locating washer	(C. 10)
14563	1	Inner circlips $\varnothing 22\frac{m}{m}$	(C. 25)
14567	1	Clutch inner felt	(C. 20)
14572	2	Clutch counter flange screw $\varnothing 4\frac{m}{m} \times 75 \times 10\frac{m}{m}$	(C. 25)
14587	1	Grease nipple $\varnothing 4\frac{m}{m} \times 75$	(C. 25)
14588	1	Washer behind felt	
14712	1	Needle cartridge $\varnothing 15\frac{m}{m} \times 19\frac{m}{m} \times 22\frac{m}{m}$	(C. 12)
14750	1	Clutch inner dust deflector $8/10\frac{m}{m}$	
14931		Clutch thrust washer $10/100\frac{m}{m}$	(C. 25)
14932		Clutch thrust washer $25/100\frac{m}{m}$	(C. 25)
14933		Clutch thrust washer $40/100\frac{m}{m}$	(C. 25)
15350	3	Spring plate with Ferodo	(C. 12)
15351	6	Spring rivet	(C. 20)
15383	2	Clutch riser spring	(C. 10)
16539	2	Riser with lining	(C. 10)
16540	2	Riser stop	(C. 20)
16542	2	Small column spring washer inner $\varnothing 8\frac{m}{m}$	
17250	S.A.	Clutch complete	
17251	1	Drum with hub and springs	
17252	1	Oil deflector	
17253	1	Clutch outer felt	(C. 20)
17454	1	Drum lock nut $\varnothing 11\frac{m}{m} \times 100$ (R.H.)	
19216	1	Counter flange	
19228	1	Flange with hub column and pulley $\varnothing 63\frac{m}{m}$	
19229	2	Small column to be rivetted, length under neck $13\frac{m}{m}$	

Since November 1970, all clutches have been fitted without woodruff key.

Due to the possibility to fit drums with or without woodruff key, the parts numbers are unchanged. However we recommend, in case of assembling without woodruff key.

1° to fix the nut with "OMNIFIT" following our technical information 10056 in your possession.

2° to tighten the nut 17454 with a torque of 3 M.kg.

AUTOMATIC GEAR CHANGE

WITHOUT WOODRUFF KEY

FITTED SINCE NOVEMBER 1970

For this kind of assembling it is essential :

1° to fix the 17455 with OMNIFIT following the technical documentation 10056 in your possession.

2° to tighten this nut with a torque of 3 M.kg.

We recommend to continue to use the woodruff key as before with the formers drums having a slot.

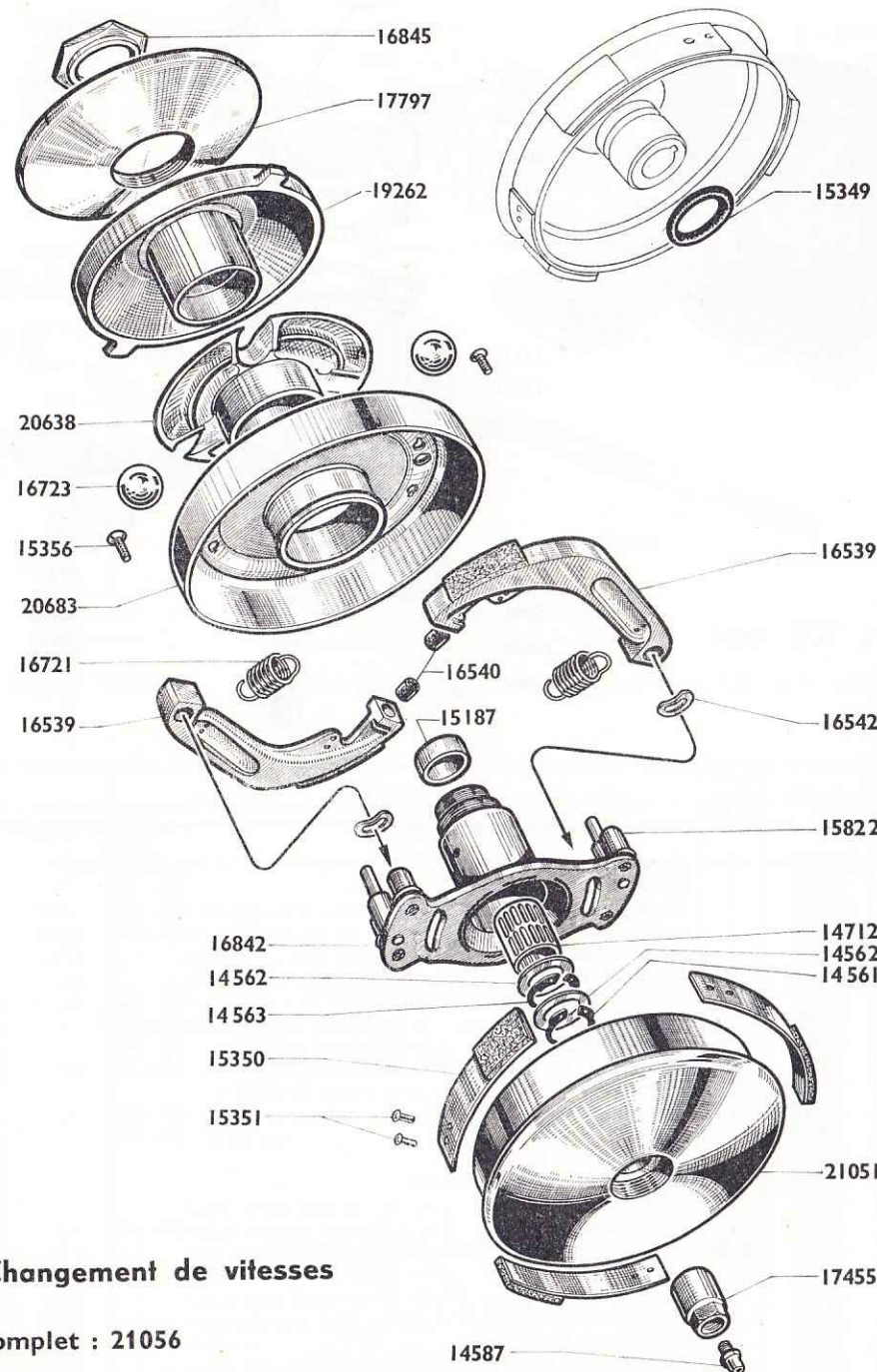

Changement de vitesses

complet : 21056

Part N°	Quantity per machine	DESCRIPTION	
224	1	Woodruff key, clutch drum.....	(C. 10)
14561	1	Outer circlips $\varnothing 15\frac{m}{m}$	(C. 25)
14562	2	Locating washer.....	(C. 10)
14563	1	Inner circlips $\varnothing 22\frac{m}{m}$	(C. 25)
14587	1	Grease nipple $\varnothing 4\frac{m}{m} \times 75$	(C. 25)
14712	1	Needle roller bearing $\times 15\frac{m}{m} \times 19\frac{m}{m} L=22\frac{m}{m}$	(C. 5)
15187	1	Plug, clutch hub.....	
15349	1	Drum gasket.....	
15350	3	Spring plate with Ferodo.....	(C. 12)
15351	6	Spring rivet.....	(C. 20)
15356	4	Screw, fixing flange $\varnothing 4\frac{m}{m} \times 75 \times 14\frac{m}{m}$	(C. 10)
15822	2	Clutch axle (column to be rivetted).....	
16539	2	Riser with lining.....	(C. 10)
16540	2	Riser stop.....	(C. 20)
16542	2	Spring washer.....	
16721	2	Spring, clutch riser.....	(C. 10)
16723	3	Ball $\varnothing 13.49\frac{m}{m}$	(C. 4)
16842	1	Clutch hub.....	
16845	1	Lock nut, fixed flange $\varnothing 25\frac{m}{m} \times 100$ L.H. thread.....	
17455	1	Lock nut drum.....	
17797	1	Fixed flange $\varnothing 27\frac{m}{m} \times 100$ R.H. thread.....	
19262	1	Mobile flange pulley.....	
20638	1	Cage for balls (nylon).....	
20683	1	Clutch flange.....	
21051	1	Drum with springs.....	
21056	S.A.	Gear change complete without woodruff key.....	

MOBYLETTE Series 50

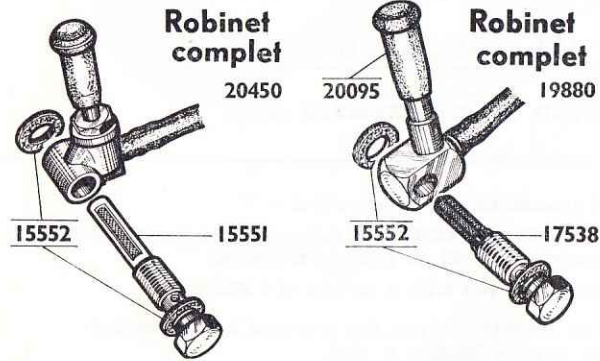

CARBURETTOR "GURTNER"

Type AR 2-12 - Adjusting 705

Carburateur complet Gurtner

Type AR2.12 - réglage 705 = 20026

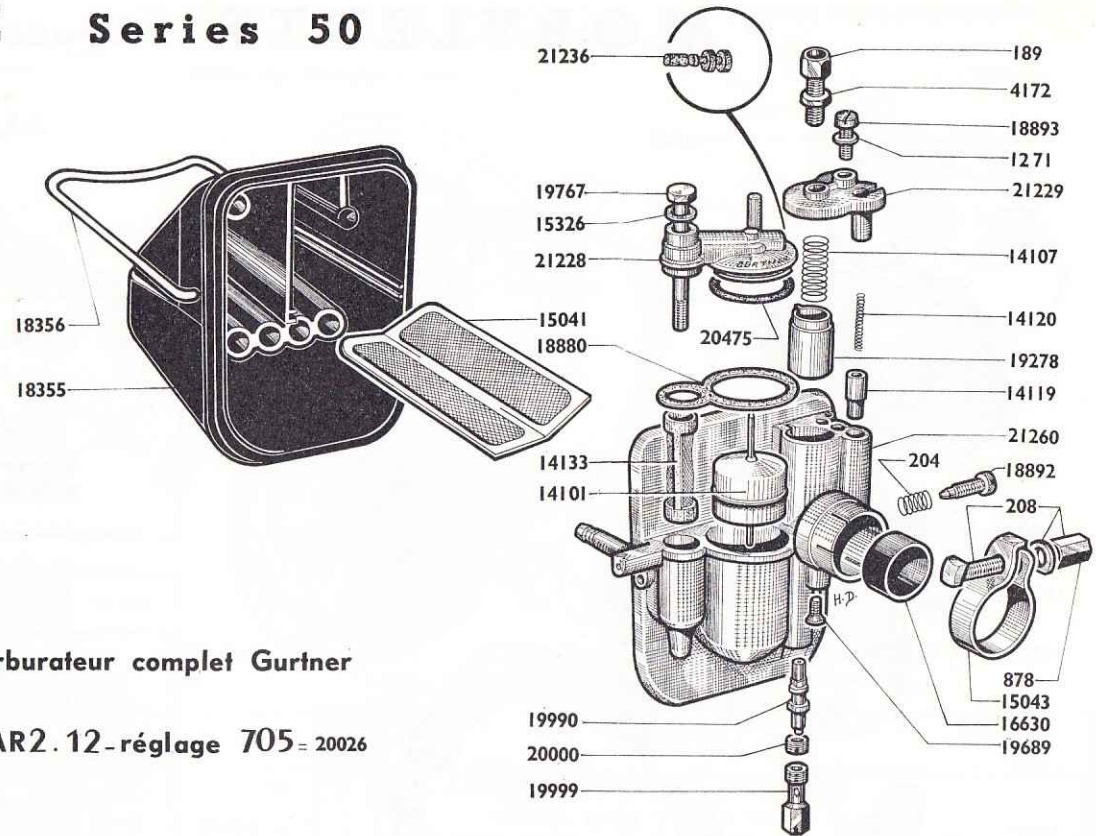

Reprinting forbidden

Part N°	Quantity per machine	DESCRIPTION	Part N°	Quantity per machine	DESCRIPTION
PETROL PIPE					
15497	1	Rubber petrol pipe	14133	1	Decanting filter
15514	2	Clip for petrol pipe	15041	1	Silencer wire mesh (C. 5)
PETROL TAP (Model to push)					
17538	1	Screw with filter and tap gasket (C. 5)	15043	1	Carburettor clip (C. 5)
19880	S. A.	Petrol tap with screw and pipe (C. 3)	15326	1	Lower blind nut gasket (C. 10)
20095	1	Tap knob plastic (C. 5)	16630	1	Fibre bush
PETROL TAP (Model to screw)					
15551	1	Petrol tap screw with filter (C. 10)	18356	1	Air intake cap
15552	2	Petrol tap screw joint	18356	1	Spring securing the silencer (C. 5)
20450	S. I.	Petrol tap complete (C. 4)	18880	1	Bowl cover gasket (C. 10)
CARBURETTOR AR 2-12 - Adj. 705					
189	1	Tensioner screw $\varnothing 6\frac{m}{m} \times 75 L=17.5\frac{m}{m}$ (C. 5)	18892	1	Throttle stop screw (C. 10)
204	1	Spring, idle screw (C. 10)	18893	1	Chamber cap screw $\varnothing 5\frac{m}{m} \times 80 L=12\frac{m}{m}$ (C. 5)
208	1	Bolt, clip carburettor $\varnothing 6\frac{m}{m} \times 100 L=21\frac{m}{m}$ (C. 5)	18975	1	Jet size 22
878	1	Nut, carburettor clip $\varnothing 6\frac{m}{m} \times 100$ (C. 10)	19278	1	Throttle (C. 10)
1271	1	Belleville washer $\varnothing 5\frac{m}{m}$ (C. 20)	19689	1	Screw (C. 10)
4172	1	Chamber cap tension screw, lock nut (C. 10)	19767	1	Screw cover bowl
14101	1	Float (C. 5)	19990	1	Diffuser, removable
14107	1	Throttle spring (C. 6)	19999	1	Jet size 22.5
14119	1	Choke valve (C. 5)	20000	1	Joint, diffuser (C. 3)
14120	1	Choke valve spring (C. 5)	20026	S. A.	Carburettor complete A.R. 2-12 Adj. 705
			20475	1	Float chamber joint
			21228	1	Bowl cover
			21229	1	Chamber cap
			21236	1	Cap cover bowl
			21260	1	Carburettor body A.R. 2-12 Adj. 705

MOBYLETTE Series 50

FLYWHEEL MAGNETO 8 watts

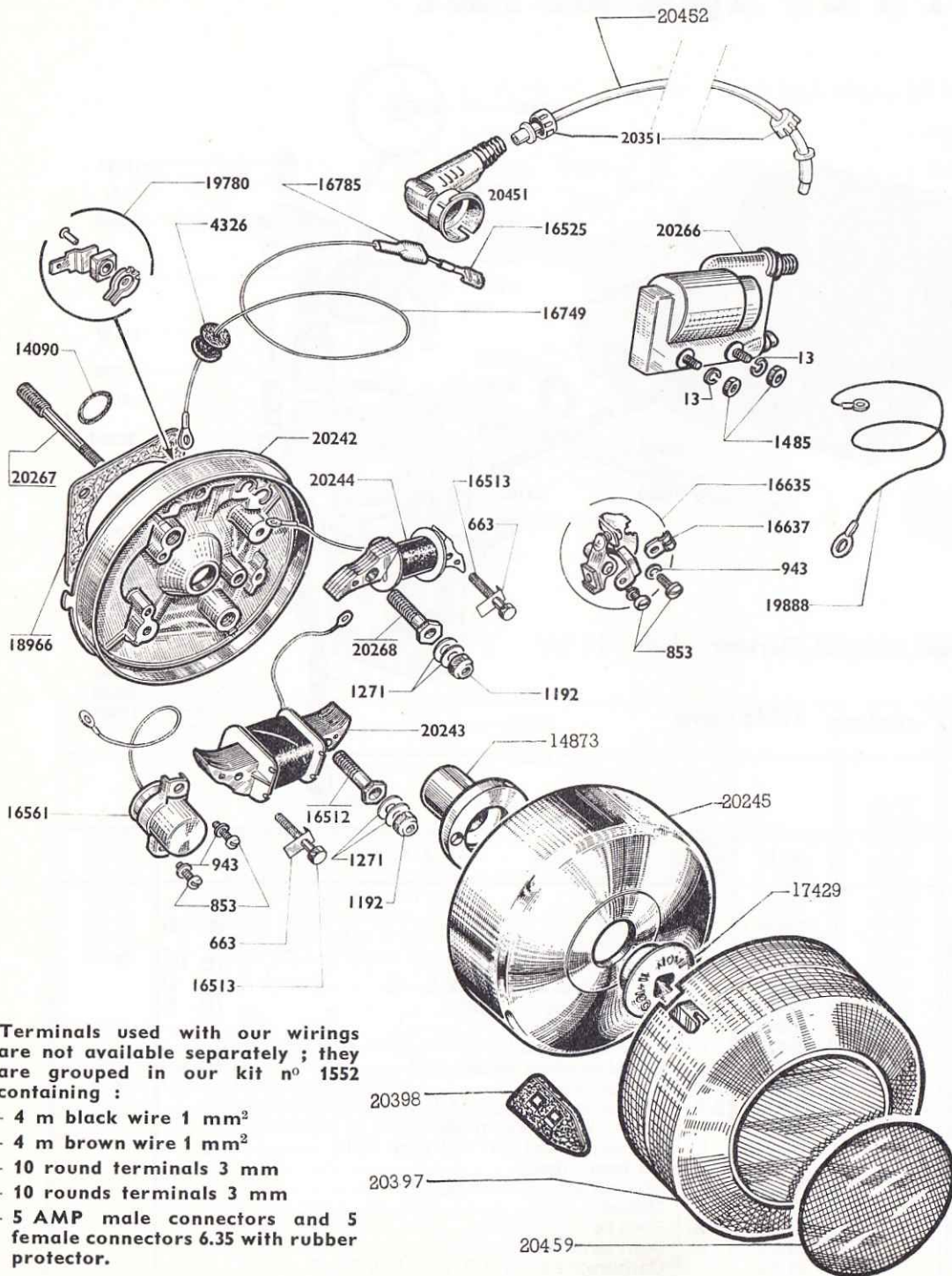

Terminals used with our wirings are not available separately ; they are grouped in our kit n° 1552 containing :

- 4 m black wire 1 mm²
- 4 m brown wire 1 mm²
- 10 round terminals 3 mm
- 10 rounds terminals 3 mm
- 5 AMP male connectors and 5 female connectors 6.35 with rubber protector.

Part N°	Quantity per machine	DESCRIPTION
663	2	Locking tab, coil securing screw (C. 50)
853	4	Screw 4 ^m / _m × 75 ^m / _m , length 10 ^m / _m
874	2	"NOMEL" washer ø 5 ^m / _m
943	3	Grower washer ø 4 ^m / _m (C. 50)
1271	4	Belleville washer ø 5 ^m / _m (C. 20)
1436	2	Nylstop nut ø 5 ^m / _m × 80 ^m / _m
1485	2	Nut 5 ^m / _m × 80 ^m / _m (C. 10)
4326	1	Grommet (C. 5)
14090	1	Leakproof washer (C. 25)
14873	1	Cam
16512	1	Hollow screw ø 7.5 ^m / _m × 100 × 24 ^m / _m securing the coil
16513	2	Screw ø 4 ^m / _m × 75 ^m / _m × 23 ^m / _m securing the coil (C. 6)
16525	1	Shell for lighting terminal (C. 10)
16561	1	Condenser (C. 10)
16635	S.A.	Breaker complete (C. 10)
16637	1	Breaker adjusting lever
16749	1	Connecting wire breaker coil
16785	2	Lighting terminal, rubber cover (C. 10)
17429	1	Flywheel lock nut ø 11 ^m / _m × 100 (L.H. thread) (C. 5)
18966	1	Paper gasket (C. 10)
19780	1	Lighting terminal complete (C. 5)
19888	1	Earth wire complete
20240	S.A.	Flywheel magneto complete
20241	S.A.	Flywheel stator complete
20242	1	Flywheel stator stripped
20243	1	Ignition coil
20244	1	Lighting coil
20245	1	Rotor (marked "C")
20266	1	Outer ignition coil with wire
20267	2	Stud ø 6 × 18 ^m / _m (C. 6)
20268	1	Hollow screw ø 7.5 ^m / _m × 100 L=22 ^m / _m securing the coil
20351	1	Securing nut H.T. cable on outer coil (C. 6)
20397	1	Plastic cover for magneto
20398	2	Plastic cover brace
20451	1	Radio-suppressor
20452	1	H.T. cable L=175 ^m / _m
20459	1	Plastic cover decal

NOTE. - In April 1971 and after, hardware used on the magnetic flywheels uses "ISO" threading. Therefore, the references below should be used :

- Screw 4 × 75 - L=10 - n° 853 becomes 4 × 70 - L=10 - n° 19249
- Screw 4 × 75 - L=23 - n° 16513 becomes 4 × 70 - L=23 - n° 21224
- Stator stud 5 × 75 n° 16731 becomes 5 × 80 n° 20267
- "NYLSTOP" nut ø 5 × 75 n° 1192 becomes 5 × 80 n° 1436

For more complete information, see Information Notice n° 10096.

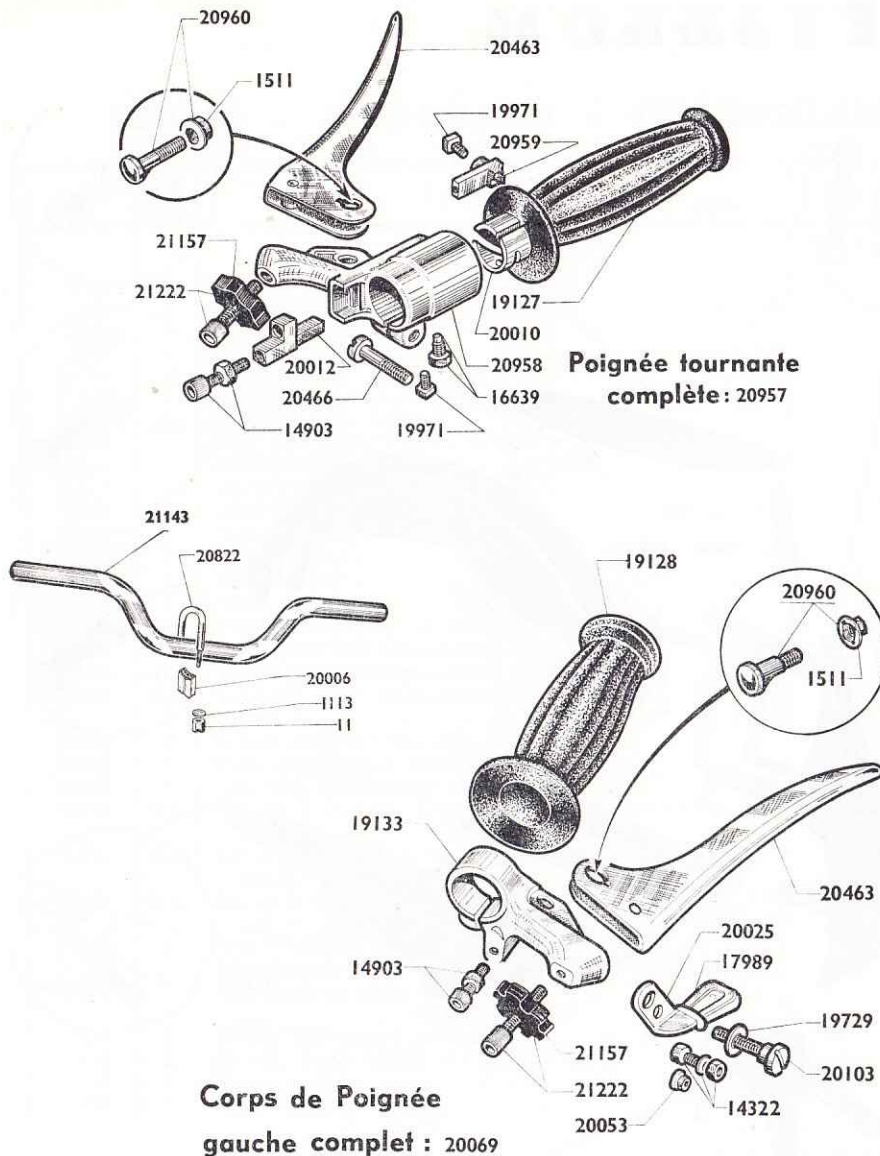

Part N°	Quantity per machine	DESCRIPTION	
HANDLEBAR			
11	4	Nut $\varnothing 7\frac{m}{m} \times 100$	(C. 50)
1113	4	"NOMEL" washer $\varnothing 7\frac{m}{m}$	(C. 50)
20004	S.A.	Handlebar complement	
20006	2	U clamp (2)	
20822	S.A.	Set of 2 U clamp spacer	
20971	S.A.	Handlebars fastening	
21143	1	Handlebar, bare	
R.H. TWIST GRIP			
1511	1	Nut $\varnothing 5 \times 80$	
14903	1	Decompressor adjuster	(C. 25)
16639	1	Securing screw with nut $\varnothing 5\frac{m}{m} \times 90 \times 12.5\frac{m}{m}$	(C. 20)
19127	1	Rubber grip R.H. (black)	
19971	2	Screw $\varnothing 4\frac{m}{m} \times 75 \times 8\frac{m}{m}$	(C. 20)
20010	1	Sleeve, twist grip	
20012	1	Slider, decompressor	(C. 5)
20463	1	R.H. brake lever	
20466	1	Twist grip set screw $\varnothing 6\frac{m}{m} \times 100 \times 23\frac{m}{m}$	(C. 10)
20957	S.A.	Twist grip complete	see NOTE
20958	1	Twist grip body	
20959	1	Slider, throttle	(C. 5)
20960	1	Lever axle with nut	(C. 25)
21157	1	Adjusting nut	(C. 10)
21222	1	Adjuster nipple for brake lever, with nut	(C. 25)
L.H. GRIP			
14322	1	Choke cable clamp	(C. 25)
14903	1	Decompressor adjuster	(C. 25)
17989	1	Plastic cap, choke lever	
19128	1	Rubber grip L.H. (black)	
19133	1	L.H. grip body	
19729	1	Onduflex washer $\varnothing 8\frac{m}{m} \times 13\frac{m}{m}$	
20025	1	Choke lever	
20053	1	Choke lever bush	(C. 5)
20054	S.A.	Choke lever complete	
20069	S.A.	Brake lever body complete L.H.	
20103	1	Securing screw brake lever body $\varnothing 6\frac{m}{m} \times 100 \times 24\frac{m}{m}$	(C. 10)
20463	1	L.H. brake lever	
20960	1	Lever axle with nut	(C. 25)
21157	1	Adjusting nut	(C. 10)
21222	1	Adjuster nipple for brake lever with nut	(C. 25)
CONTROLS (not illustrated)			
716	2	Solderless nipple	(C. 25)
14334	1	Throttle control complete	
14927	1	Choke cable	(C. 10)
14927	1	Throttle cable	(C. 10)
14974	1	Decompressor cable	(C. 10)
15576	1	Choke control complete	
15578	1	Decompressor control complete	
15579	1	Front brake control complete	
15580	1	Rear brake control complete	
15599	1	Front brake cable	(C. 5)
15600	1	Rear brake cable	(C. 5)
16944	1	Outer casing shouldered decompressor	(C. 10)
17739	2	Control guide	

NOTE. - After Septembre 10, 1971, type 50 S and 50 L engines are equipped with a motor with a long inlet pipe.

See the different parts below :

- 21283 Slider, decompressor instead of 20012.
- 21284 Twist grip complete instead of 20957.
- 21285 Choke control instead of 15576.
- 21286 Throttle and choke cable instead of 14927.
- 21287 Throttle control instead of 14334.
- 20528 Throttle and decompressor adjuster (SP 93 D - DL).
- 20529 Adjuster spring for 20528 (SP 93 D - DL).

MOBYLETTE Series 50

FRAME - MUDGUARD - CHAINGUARD - CENTRE STAND - REAR SUSPENSION

Part No	Quantity per machine	DESCRIPTION		Part No	Quantity per machine	DESCRIPTION
FRAME						
10553	1	Rubber ring		19848	S.A.	Set of 3 chainguard beads grey for white machine
14991	1	Bolt, seat pillar $\varnothing 8\frac{m}{m} \times 100$ L=46 $\frac{m}{m}$	(C. 10)	19849	S.A.	MOBYMATIC transfer 50VS-50VL (R.H. L.H.)
15563	1	Inflator L=250 $\frac{m}{m}$		20040	S.A.	Transfer (R.H. +L.H.)
16948	1	Rubber ring		20347	S.A.	Set of 3 beads blue for chainguard
16949	2	Grooved nail	(C. 550)	20760	S.A.	Set of 3 chainguard beads copper for coral machine ..
17202	1	Plastic bead frame		CENTRE STAND		
17260	1	Bracket, cable retainer		1422	2	"NOMEL" washer $\varnothing 8\frac{m}{m}$
19163	1	Clip, seat pillar		19834	1	Spring, centre stand
19223	1	MOTOBECANE transfer	(C. 6)	20586	2	Bolt, centre stand L=18.5 $\frac{m}{m}$
19243	1	MOTOCOMFORT transfer	(C. 5)	REAR SWINGING ARM		
19831	S.A.	MOBYLETTE transfer (R.H. L.H.)	(C. 3d + 3g)	15870	2	Silentblock, rear swinging arm
19851	1	Clutch fairing 50VL-50VS		15871	1	Spacer, silentbloc L=47 $\frac{m}{m}$
20094	2	Rubber plug	(C. 20)	15872	1	Pivot axle
20389	1	Rubber ring	(C. 10)	16555	1	Nylstop nut $\varnothing 10\frac{m}{m} \times 100$
20460	1	Filler cap joint		17780	2	Rear wheel adjuster $\varnothing 5\frac{m}{m} \times 90$ L=35 $\frac{m}{m}$
20810	2	Tank embellisher badge MOBYLETTE 50L - 50VL		REAR SUSPENSION SHOCK ABSORBERS		
21111	1	Lower stay front mudguard 50L-50VL		36	4	Nut $\varnothing 8\frac{m}{m} \times 100$
21112	1	Upper stay front mudguard 50L-50VL		137	4	Shakeproof washer $\varnothing 8\frac{m}{m}$
21114	S.A.	Beading set, rear mudguard L=140 $\frac{m}{m}$ 50S-50VS blue	(C. 5 set)	15874	2	Mounting bolt, lower $\varnothing 8\frac{m}{m} \times 100 \times 34\frac{m}{m}$
21126	4	Screw $\varnothing 3\frac{m}{m} \times 60$ L=11 $\frac{m}{m}$ F=5		15990	4	Rubber bush with spacer
21127	1	Tank embellisher chromed 50L - 50VL		16720	S.A.	Shock absorber complete (R.H. or L.H.)
21128	1	L.H. tank embellisher chromed 50L - 50VL		16947	8	Washer $\varnothing 8.5\frac{m}{m} \times 24\frac{m}{m} \times 1.5\frac{m}{m}$
21129	S.A.	Set of 2 beadings, rear mudguard L=140 $\frac{m}{m}$ grey 50L-50VL		20369	2	Mounting bolt complete with nut $\varnothing 8\frac{m}{m} \times 100 \times 51\frac{m}{m}$ (C.)
21130	S.A.	Set of 2 beadings, rear mudguard L=140 $\frac{m}{m}$ copper 50L-50VL		CYCLE BOLT ATTACHMENT		
21131	S.A.	Set of 2 rear mudguard embellisher (transfer) R.H. L.H.	(C. 3 set)	10	16	Nut $\varnothing 6\frac{m}{m} \times 100$
21151	1	Fuel filler cap (plastic) $\varnothing 30 \times 175$ with joint		20	3	Flat washer $\varnothing 6\frac{m}{m}$
21162	1	Manufacturer plate MB		137	1	"BLOCFOR" washer $\varnothing 8\frac{m}{m}$
21163	1	Manufacturer plate MC		679	1	Bolt $\varnothing 6 \times 100 \times 16$
CHAINGUARD						
17424	6	Screw chainguard $\varnothing 5\frac{m}{m} \times 90$	(C. 10)	702	8	Bolt $\varnothing 6 \times 100 \times 12$
17425	3	Screw, clutch fairing $\varnothing 5\frac{m}{m} \times 90 \times 7\frac{m}{m}$	(C. 10)	797	2	"BLOCFOR" washer $\varnothing 6\frac{m}{m}$
17426	9	Plastic washer	(C. 10)	874	2	"NOMEL" washer $\varnothing 5\frac{m}{m}$
18376	1	Clutch fairing 50S-50L		1172	16	"NOMEL" washer $\varnothing 6\frac{m}{m}$
CENTRE STAND						
REAR SUSPENSION SHOCK ABSORBERS						
CYCLE BOLT ATTACHMENT						

ENAMELLED PARTS

DESCRIPTION FOR ENAMELLED PARTS	50 S-50 VS			50 L-50 VL		
	Blue	Coral	White	Blue	Coral	White
Frame with steering lock	21100	21117	21136	21109		
Centre stand	21176	21176	21176	21107		
Luggage-carrier	21108	21122	21141		21123	21123
R.H. chainguard coral/white		21152			21121	21140
L.H. chainguard coral/white		21153			21125	21125
R.H. chainguard white/grey			21154			
L.H. chainguard white/grey			21155			
R.H. chainguard blue	20279				21124	21124
L.H. chainguard blue	20280			20309	21120	21139

MOBYLETTE Series 50

FORK 50 S - 50 VS FOR RECTANGULAR HEADLAMP

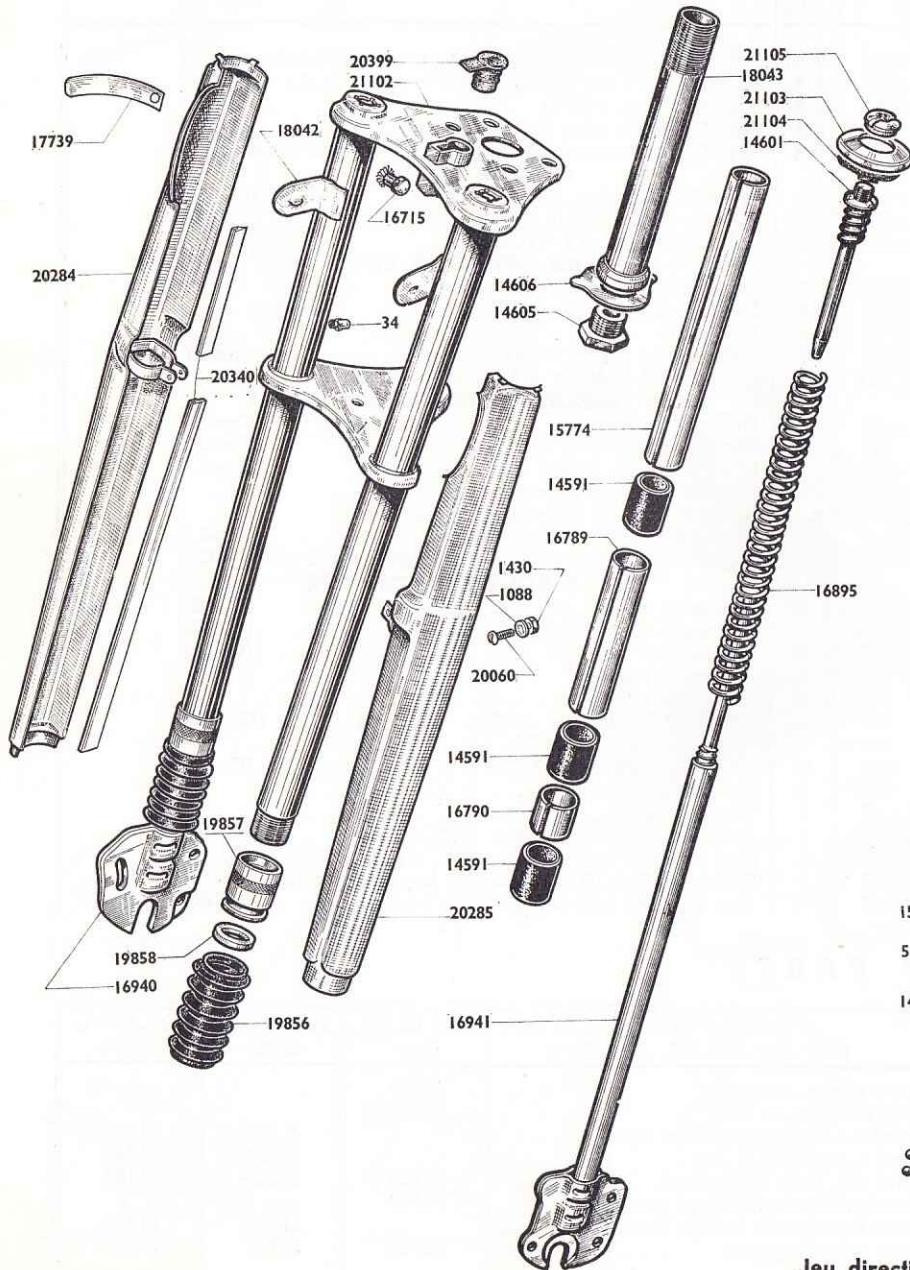

FORK 50 L - 50 VL FOR SQUARE HEADLAMP

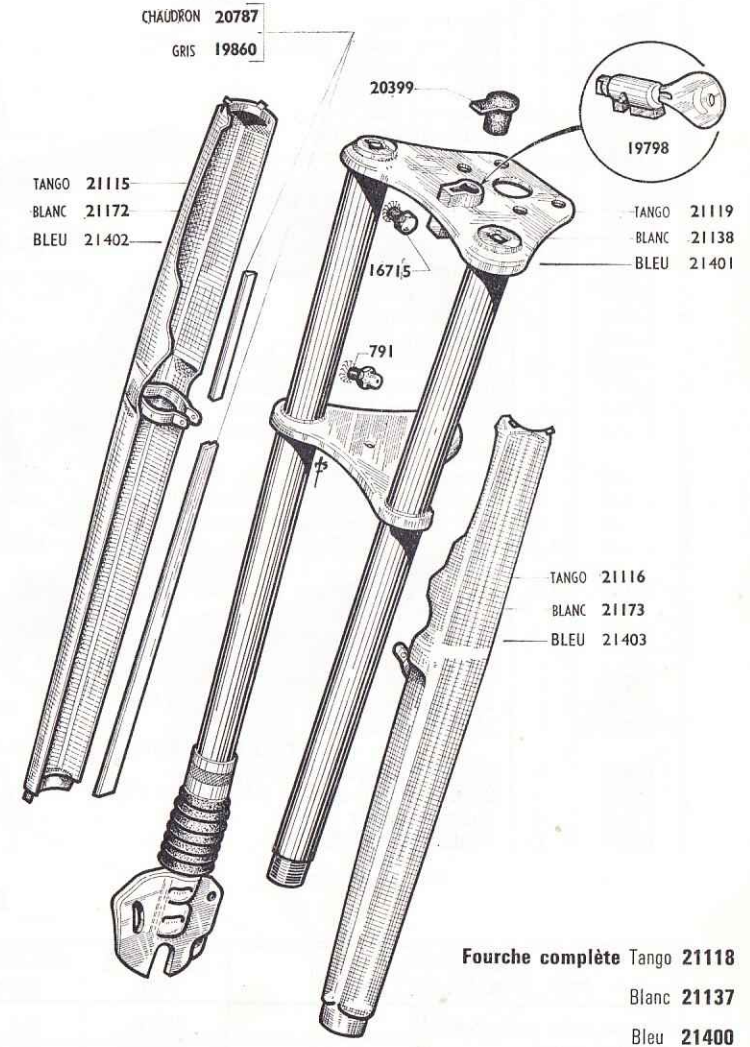

Jeu direction complet: 15524

MOBYLETTE Series 50

TELESCOPIC FORKS - STEERING HEAD RACES

FORK 50S - 50VS (blue)

FORK 50L - 50VL - 50S - 50VS (coral, white, blue) (different parts)

Part No	Quantity per machine	DESCRIPTION
FORK		
34	2	Grease nipple $\varnothing 5\frac{m}{m} \times 75\frac{m}{m}$ (C. 20)
1088	2	"NOMEL" washer $\varnothing 4\frac{m}{m}$ embellisher clip (C. 20)
1430	2	Nut $4\frac{m}{m} \times 75$ embellisher clip (C. 10)
14591	6	Fork bush (C. 12)
14601	2	Spring top fastener (C. 6)
14605	1	Pivot screw
14606	1	Pivot screw tab
15528	1	Pivot upper nylon plug (C. 5)
15774	2	Upper distance piece L= $243\frac{m}{m}$
16715	2	Screw $6 \times 100 \times 6.5$
16789	2	Middle distance piece L= $113\frac{m}{m}$
16790	2	Lower distance piece L= $22\frac{m}{m}$
16895	2	Fork spring (reinforced wire 30/10)
16940	1	R.H. plunger with spring guide
16941	1	L.H. plunger with spring guide
17739	2	Sheat fastener
18042	2	Headlamp support (to be welded)
18043	1	Fork pivot with cone
19856	2	Protecting rubber (C. 12)
19857	2	Lower nut, sheath (C. 12)
19858	2	Leakproof gasket $15\frac{m}{m} \times 23\frac{m}{m} \times 3\frac{m}{m}$ (C. 12)
20060	2	Screw $4\frac{m}{m} \times 70$ L= $11\frac{m}{m}$ embellisher clip (C. 10)
20101	S.A.	Telescopic fork for steering lock
20102	S.A.	Sheath assembly with embellisher
20284	1	R.H. embellisher fork
20285	1	L.H. embellisher fork
20340	S.A.	Set of beads (4) for embellisher (blue)
20399	1	Steering lock cap
21103	2	Upper round cover, under top fastener nut
21104	2	Rubber gasket
21105	2	Fastener nut

Part No	Quantity per machine	DESCRIPTION
FORK		
791	2	Grease nipple 6×100
797	2	"NOMEL" washer $\varnothing 6\frac{m}{m}$
19798	S.A.	Steering lock
19860	S.A.	Set of 4 beads for embellisher, grey
20787	S.A.	Set of 4 beads for embellisher, copper
21115	1	R.H. embellisher coral
21116	1	L.H. embellisher coral
21118	S.A.	Telescopic fork complete coral
21119	S.A.	Sheath assembly coral
21137	S.A.	Telescopic fork complete white
21138	S.A.	Sheath assembly white
21172	1	R.H. embellisher white
21173	1	L.H. embellisher white
21400	S.A.	Telescopic fork complete blue
21401	S.A.	Sheath assembly blue
21402	1	R.H. embellisher blue
21403	1	L.H. embellisher blue
STEERING HEAD RACES		
5	50	Balls of 3,96 (C. 25)
14207	1	Upper cone
14208	1	Lower cup
15524	S.A.	Steering head races complete
15525	1	Upper cup
15526	1	Steering locknut
18249	1	Washer for steering locknut (C. 5)

MOBYLETTE Series 50

21019: Moyeu AV complet Prior $\varnothing 80$ $\frac{7}{8}$ à Grandes Colletteres

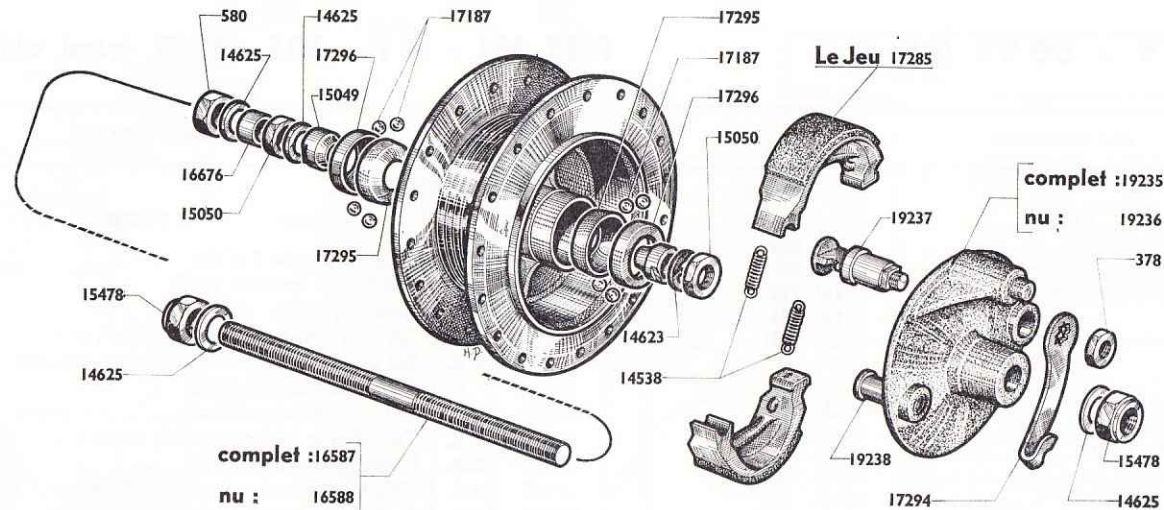

Reprinting forbidden

FRONT WHEEL AND HUB "PRIOR" $\varnothing 80$

Part N°	Quantity per machine	DESCRIPTION	Part N°	Quantity per machine	DESCRIPTION
WHEEL 50 S - 50 L - 50 VS - 50 VL					
17851	1	Rim tape 17"-1,50 (front or rear)	15049	2	Bearing cone
17859	36	Nipple gauge 18	15050	2	Lock nut cone
19625	36	Spoke with nut $17 \times 17 \times 18$ L= $166\frac{m}{m}$	15478	2	Spindle nut
19634	1	Rim 17"-1,50 (front or rear)	16587	S.A.	Front hub axle complete $\varnothing 11\frac{m}{m}$
21144	S.A.	Front wheel complete without tyre and inner tube	16588	1	Front hub axle stripped $\varnothing 11\frac{m}{m}$
21145	1	Inner tube $2\frac{m}{m} \times 17$ little valve (front or rear)	16676	1	Distance piece $\varnothing 11\frac{m}{m} \times 14$ thick $6.5\frac{m}{m}$ (cowel)
21146	1	Tyre $2\frac{m}{m} \times 17$ black (front or rear)	17187	22	Ball $\varnothing 5.55\frac{m}{m}$
HUB					
378	1	Nut, cam lever $\varnothing 7\frac{m}{m} \times 100$	17285	S.A.	Pair of jaw $\varnothing 80\frac{m}{m}$
580	1	Hub nut	17294	1	Cam lever
14538	2	Spring, brake shoes	17295	2	Cup $\times 29.8\frac{m}{m}$
14623	1	Tongued washer	17296	2	Oil deflector \varnothing inner= $18.5\frac{m}{m}$ \varnothing outer= $29.8\frac{m}{m}$
14625	2	Plain washer \varnothing inner $11\frac{m}{m}$	19235	1	Jaw flange complete
			19236	1	Jaw flange stripped
			19237	1	Cam, front brake
			19238	1	Fixed point (to be rivetted)
			21019	S.A.	Front hub complete
			21216	S.A.	Front hub body stripped

MOBYLETTE Series 50

REAR WHEEL AND HUB "PRIOR"

∅ 80 ^m/_m

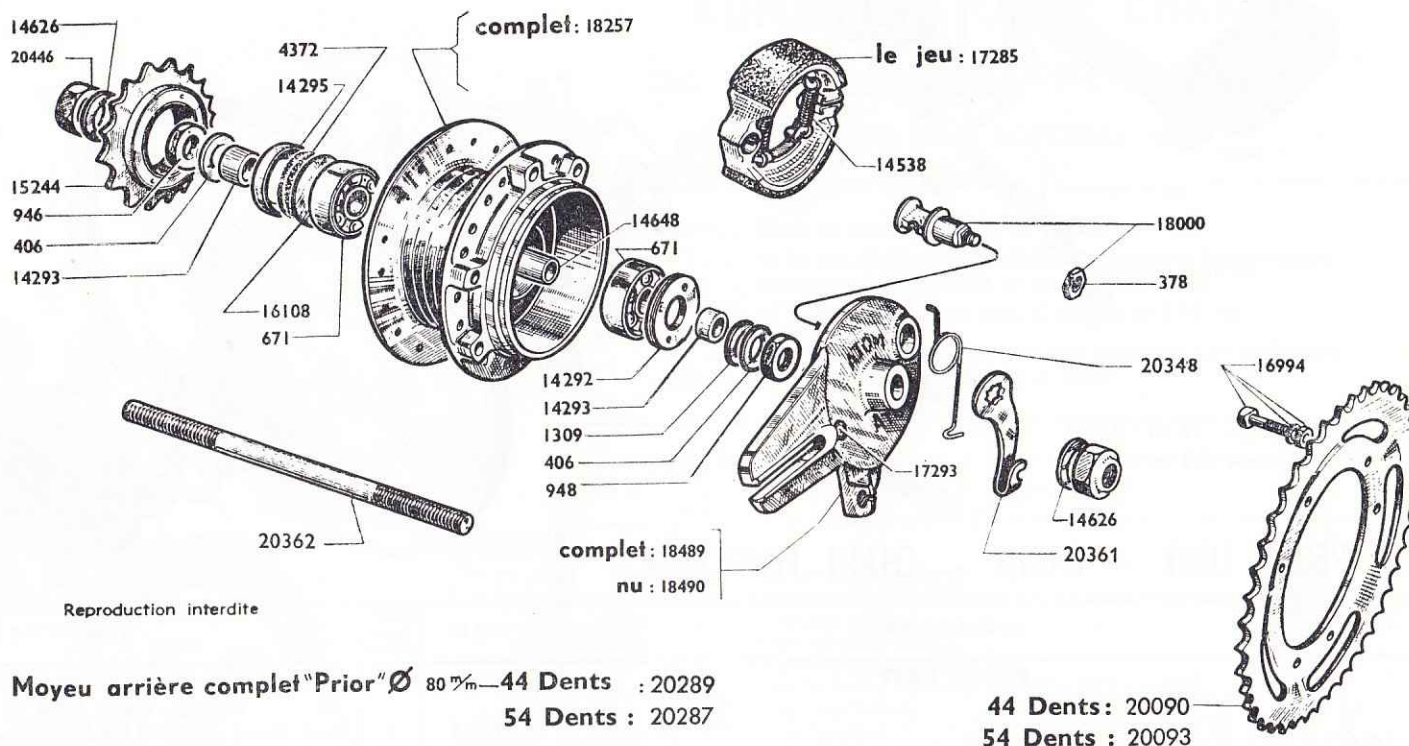

Reproduction interdite

Reprinting forbidden

Moyeu arrière complet "Prior" ∅ 80 ^m/_m - 44 Dents : 20289
54 Dents : 20287

44 Dents: 20090
54 Dents : 20093

Part No	Quantity per machine	DESCRIPTION	Part No	Quantity per machine	DESCRIPTION
17851	1	Rim tape 17"-1,50 (front or rear)	14293	2	Distance piece ∅ inner=10 ^m / _m - thick=6 ^m / _m
17859	36	Nipple gauge 18 (front or rear)	14295	1	Dust deflector ∅ outer=30 ^m / _m
19634	1	Rim 17" - 1,50 (front or rear)	14538	2	Jaw spring
21145	1	Inner tube 2 ^m / _m × 17 little valve (front or rear)	14648	1	Distance piece ball bearing L=53 ^m / _m
21146	1	Tyre 2 ^m / _m × 17 black (front or rear)	15244	1	Freewheel 18 teeth 34.7 × 100
21147	S.A.	Rear wheel complete without tyre and inner tube ∅ 80 ^m / _m 44 teeth 50S-50L	16108	1	Felt washer ∅ 16.5 ^m / _m × 30 ^m / _m × 5/10 ^m / _m
21149	S.A.	Rear wheel complete without tyre and inner tube ∅ 80 ^m / _m 54 teeth 50VS-50VL	16994	6	Bolt rear sprocket ∅ 6 ^m / _m × 10 ^m / _m × 20 ^m / _m
21156	36	Spoke with nut 17 × 17 × 18 L=172 ^m / _m 50 L-5p VL-50 S-50 VS	17285	S.A.	Pair of jaw ∅ 80 ^m / _m PRIOR
			17293	1	Fixed point (to be rivetted)
			18000	1	Brake cam with nut
			18257	S.A.	Hub shell complete without sprocket
			18489	S.A.	Jaw flange complete ∅ 80 ^m / _m
			18490	1	Jaw flange stripped ∅ 80 ^m / _m
			20090	1	Rear sprocket 44 teeth, bore=94 ^m / _m 50S-50L
			20093	1	Rear sprocket 54 teeth, bore=94 ^m / _m 40 VS-50VL
			20287	S.A.	Rear hub complete with sprocket 54 teeth 50VS-50VL
			20289	S.A.	Rear hub complete with sprocket 44 teeth 50S-50L
			20348	1	Spring cam lever
			20361	1	Cam lever
			20362	1	Rear hub axle stripped ∅ 10 ^m / _m L=168.5 ^m / _m
			20446	2	Hub nut ∅ 10 ^m / _m × 100 ^m / _m
378	1	Cam lever nut ∅ 7 × 100 ^m / _m			
406	4	Plain washer ∅ 10 ^m / _m × 18 ^m / _m × 10/10 ^m / _m (C. 20)			
671	2	Ball bearing 10 ^m / _m × 30 ^m / _m × 9 ^m / _m			
946	1	Hub nut 10 ^m / _m × 100 ^m / _m × 8 ^m / _m			
948	1	Lock nut, inner 10 ^m / _m × 100 ^m / _m × 4 ^m / _m			
1309	1	Hub washer 10 ^m / _m × 18 ^m / _m × 10/10 ^m / _m			
4372	1	Felt			
14292	1	Lock nut, ball bearing			

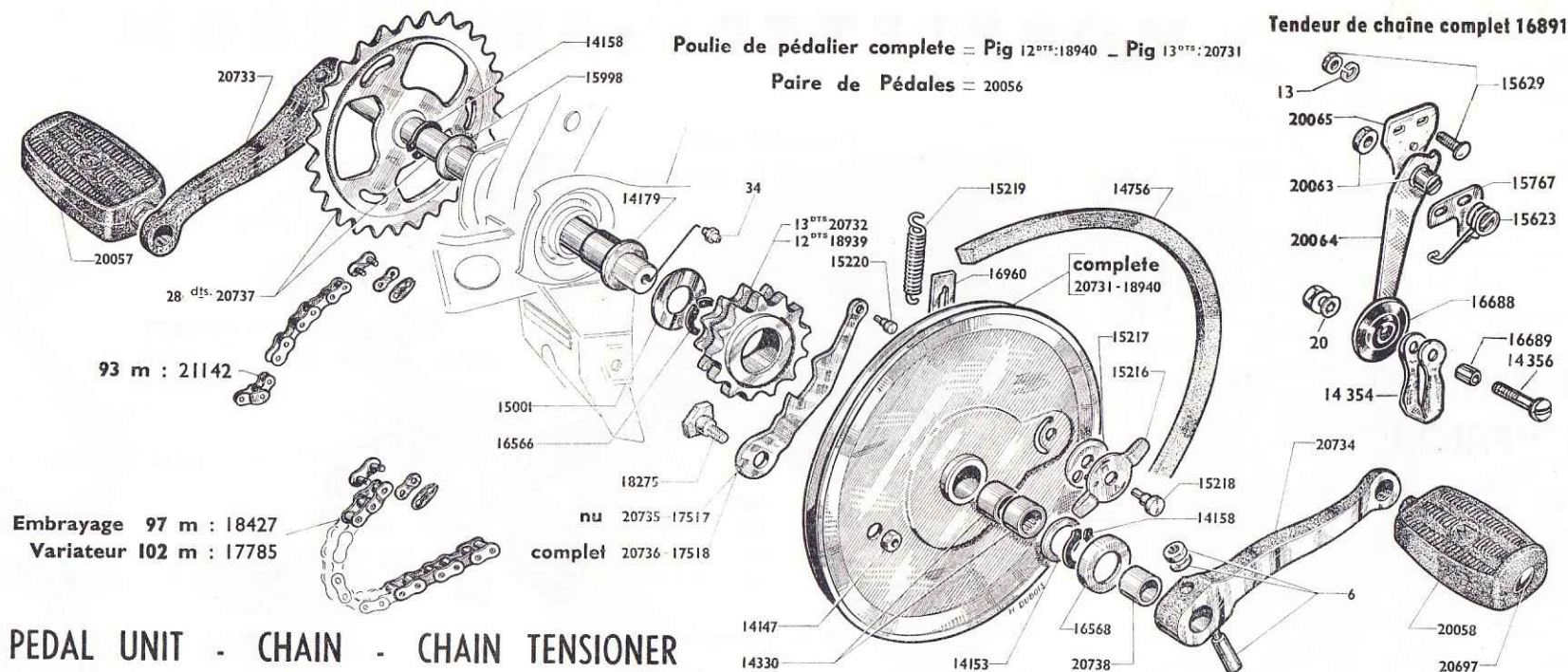

PEDAL UNIT - CHAIN - CHAIN TENSIONER

Part N°	Quantity per machine	DESCRIPTION	Part N°	Quantity per machine	DESCRIPTION
PEDAL UNIT					
6	2	Bracket cotter pin (C. 10)	20738	1	L.H. crank arm distance piece (12.8 ^m / _m thick)
34	1	Grease nipple $\varnothing 5^{\text{m}}_{\text{m}} \times 75$ (C. 20)	17517	1	Lock lever stripped for 12 teeth (C. 10)
14147	1	Nut lever axle $\varnothing 8^{\text{m}}_{\text{m}} \times 100$	17518	S.A.	Lock lever complete for 12 teeth (C. 10)
14153	1	Bracket thrust washer $\varnothing 16.5^{\text{m}}_{\text{m}} \times 27^{\text{m}}_{\text{m}} \times 20/100^{\text{m}}_{\text{m}}$ (C. 10)	17785	1	Transmission chain 102 links yellow
14158	2	Bracket circlips (C. 50)	18939	1	Sprocket 12 teeth
14179	2	Bracket bush (C. 20)	18940	S.A.	Bracket pulley with sprocket and needle cartridge
14330	2	Needle cartridge L=12 ^m / _m (C. 20)			CHAIN TENSIONER
14756	1	Belt 14x7 L=799 ^m / _m	13	2	Grower washer $\varnothing 5^{\text{m}}_{\text{m}}$ (C. 50)
15001	1	Bracket thrust washer $\varnothing 16.5^{\text{m}}_{\text{m}} \times 30^{\text{m}}_{\text{m}} \times 8/10^{\text{m}}_{\text{m}}$ (C. 10)	20	1	Flat washer $\varnothing 6^{\text{m}}_{\text{m}}$ (C. 25)
15216	1	Lock button	14354	1	Tensioner roller bridge
15217	1	Button friction washer	14356	1	Chain tensioner axle with nut
15218	1	Button axle	15623	1	Chain tensioner spring (C. 5)
15219	1	Lock lever spring (C. 20)	15629	2	Bolt securing chain tensioner $\varnothing 5^{\text{m}}_{\text{m}} \times 90$ L=13 ^m / _m (C. 10)
15220	1	Lever spring axle	15767	1	Tensioner spring
15998	1	Bracket thrust washer $\varnothing 16.5^{\text{m}}_{\text{m}} \times 26^{\text{m}}_{\text{m}} \times 10/10^{\text{m}}_{\text{m}}$ (C. 10)	16688	1	Chain tensioner roller complete (Rilsan) (C. 5)
16566	1	Bracket circlips (C. 20)	16689	1	Roller distance piece $\varnothing 8^{\text{m}}_{\text{m}}$ L=10.5 ^m / _m
16568	1	Bracket oil deflector (C. 5)	16891	S.A.	Chain tensioner complete (C. 10)
16960	1	Pulley spring limiter	20064	1	Lever stripped chair tensioner
18275	1	Lock lever axle with nut $\varnothing 12^{\text{m}}_{\text{m}}$ (C. 10)	20065	1	Chain tensioner support
20056	S.A.	Pair of pedals			CHAINS
20057	1	R.H. pedal	14364	1	Cranked link for transmission chain Yellow (C. 5)
20058	1	L.H. pedal	14365	1	Cranked link for pedal chain Yellow (C. 5)
20697	2	Pedal cap (C. 10)	14367	1	Spring link for transmission chain, Yellow (C. 5)
20731	S.A.	Bracket pulley with 13 teeth sprocket and needle cartridge 50S - 50L	14368	1	Spring link for pedal chain, Yellow (C. 5)
20732	1	Sprocket 13 teeth 50S-50L (C. 5)	14875	1	Spring link for transmission chain, Brampton (C. 5)
20733	1	R.H. crank arm L=135 ^m / _m	17590	1	Cranked link for pedal chain, Brampton (C. 5)
20734	1	L.H. crank arm	17591	1	Spring link for pedal chain, Brampton (C. 5)
20735	1	Lock lever stripped for 13 teeth 50S-50L (C. 10)	18427	1	Transmission chain 97 links 50S-50L
20736	S.A.	Lock lever complete for 13 teeth 50S-50L (C. 10)	21142	1	Pedal chain 93 links 50S-50L-50VS-50VL
20737	1	Bracket axle with sprocket welded 28 teeth			

MOBYLETTE Series 50

SADDLE (black cover)

Types 50 S - 50 VS

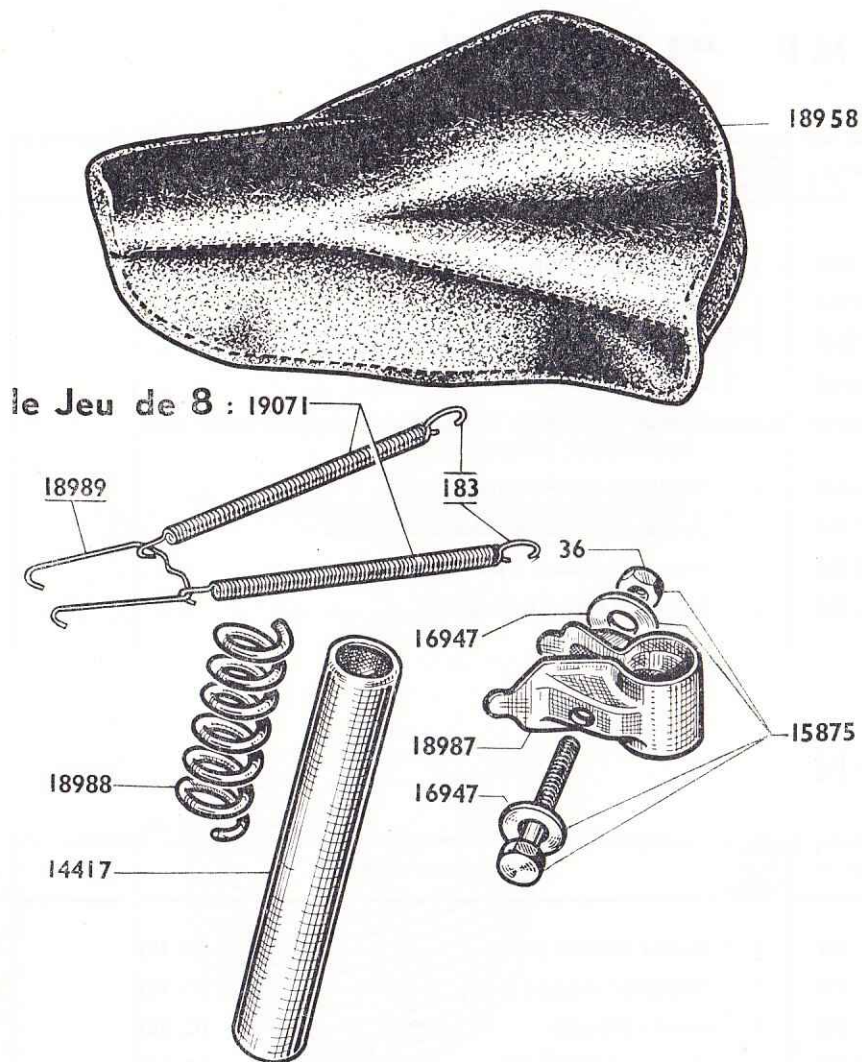

Part N°	Quantity per machine	DESCRIPTION
36	1	Nut $\varnothing 8\frac{3}{4} \times 100$ (C. 20)
183	8	Rear hook (short)..... (C. 10)
14417	1	Seat pillar $\varnothing 25.5\frac{3}{4}$
15875	1	Bolt, seat pillar clip 8×100 L= $56\frac{3}{4}$ (C. 4)
16947	2	Plain washer for 15875 (C. 10)
18957	S.A.	Saddle complete.....
18958	1	Saddle cover, black.....
18987	1	Clip, seat pillar
18988	1	Central spring
18989	1	Front hook
19071	1	Set of 8 springs.....
19171	1	Plastic tool bag

SADDLE "POUFF" (black cover)

Types 50 L - 50 VL (différents parts)

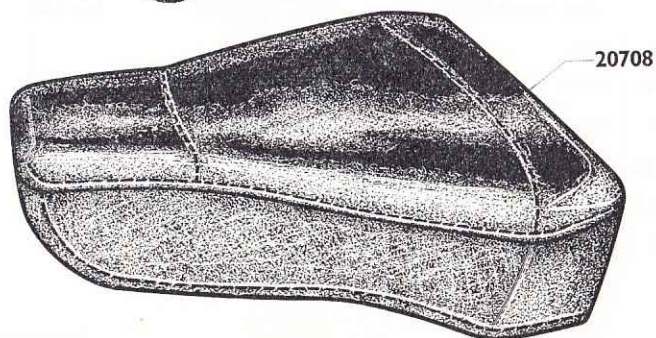

Part N°	Quantity per machine	DESCRIPTION
20705	S.A.	Saddle complete
20708	1	Saddle cover black

NOTE. - Although the original bolt, i. e. $\varnothing 8 \times 125$, we supply the standard bolt in Spare Parts of $\varnothing 8 \times 100$, Reference 15875.

MOBYLETTE Types 50 L - 50 VL

SQUARE HEADLAMP "LUXOR"

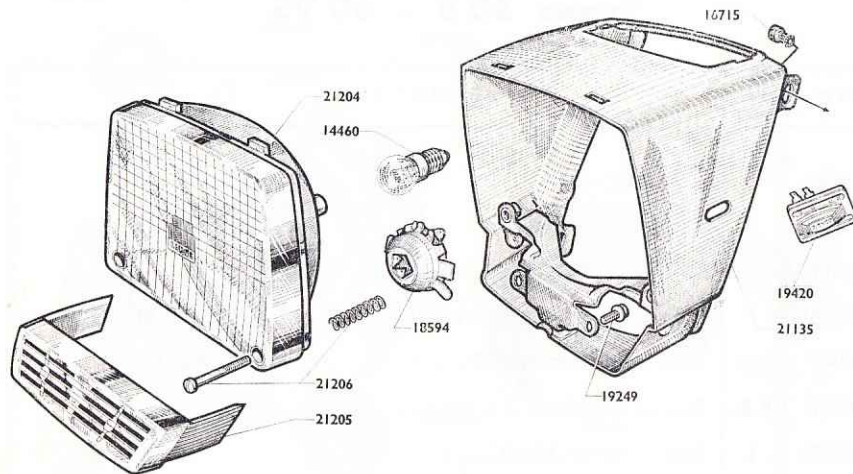

Phare Luxor complet :
avec Optique réglable : 21134

Part N°	Quantity per machine	DESCRIPTION
14460	1	Front bulb yellow 6 V-6 W (C. 25)
18594	1	Bulb holder
19249	1	Embellisher screw $\varnothing 4 \times 70 L=8\frac{m}{m}$
19420	1	Switch complete
21134	S.A.	Optical adjustable headlamp complete with horn embellisher (white)
21135	1	Headlamp shell (white)
21204	1	Optical assembly without bulb holder
21205	1	Horn embellisher with screw
21206	2	Adjusting screw with spring

HORN

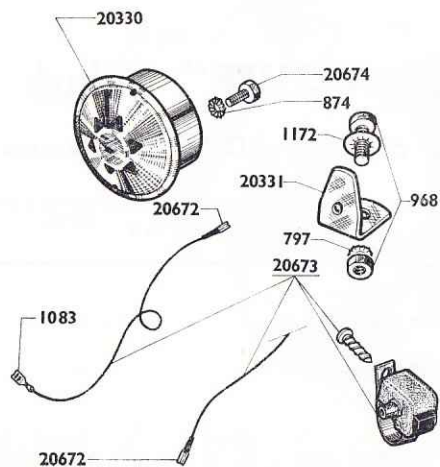

Part N°	Quantity per machine	DESCRIPTION
797	1	Blocfor washer $\varnothing 6\frac{m}{m}$ (C. 10)
874	1	"NOMEL" washer $\varnothing 5\frac{m}{m}$ (C. 25)
968	1	Bolt $6 \times 100 \times 20$ (C. 10)
1083	2	Clip width $5\frac{m}{m}$ (C. 10)
18415	1	Bell
20330	S.A.	Horn "NOVIPHONE" with button
20672	1	Shell width $2.8\frac{m}{m}$ (C. 10)
20673	S.A.	Set of 2 wire with button "NOVIPHONE"
20674	1	Screw $5 \times 80 L=8\frac{m}{m}$ (C. 10)
20331	1	Horn support

MOBYLETTE Types 50 S - 50 VS

RECTANGULAR HEADLAMP "LUXOR" - TAIL LAMP

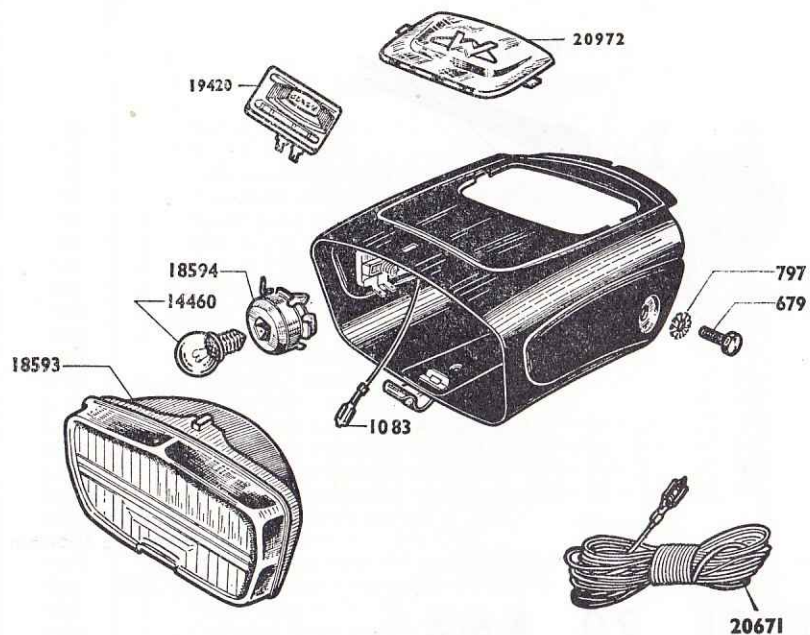

Part N°	Quantity per machine	DESCRIPTION
HEADLAMP LUXOR		
679	2	Side securing screw $\varnothing 6\frac{m}{m} \times 100\frac{m}{m} \times 15\frac{m}{m}$ (C. 10)
797	2	Shakeproof washer $\varnothing 6\frac{m}{m}$ (C. 100)
1083	2	Clip, width $5\frac{m}{m}$ (C. 10)
14460	1	Bulb 6V-6W..... (C. 25)
17739	2	Sheet fastener.....
18593	S.A.	Optical assembly complete.....
18594	1	Bulb holder..... (C. 5)
19420	1	Switch complete..... (C. 5)
19465	S.A.	Headlamp complete.....
19466	1	Headlamp shell.....
20671	1	Wiring.....
20972	1	Speedometer hole cover.....
TAIL LAMP		
756	1	Bulb to screw 6V-1.8W..... (C. 25)
1087	1	Nut $\varnothing 4\frac{m}{m} \times 75$ (C. 10)
8802	2	Socle bolt $\varnothing 4\frac{m}{m} \times 75$ L= $6\frac{m}{m}$ (C. 20)
14077	1	Plate washer $\varnothing 4.2 \times 8\frac{m}{m}$ thick= $8/10$ (C. 10)
19649	1	Tail light cover..... (C. 10)
19651	1	Tail light shell screw $\varnothing 4\frac{m}{m} \times 70$ L= $7\frac{m}{m}$ (C. 10)
19863	S.A.	Tail light complete.....
19864	1	Tail light socle.....
19865	1	Tail light gasket..... (C. 10)
21158	1	Fastener wire upon rear mudguard (not illustrated)..

Lanterne arrière complète : 19863

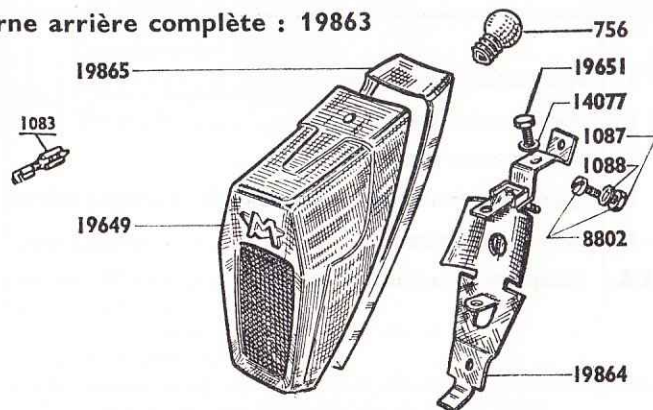

NOTE. - Certain wiring are not available separately. They can be obtained nevertheless from the kit n° 1552 containing :

- 4 m of black wire 1 mm²
- 4 m brown wire 1 mm²
- 10 round terminals 5 mm
- 10 rounds terminals 3 mm
- 5 AMP male connectors and 5 female connectors 6.35 with rubber protector.

MOBYLETTE

Types 50 L - 50 VL

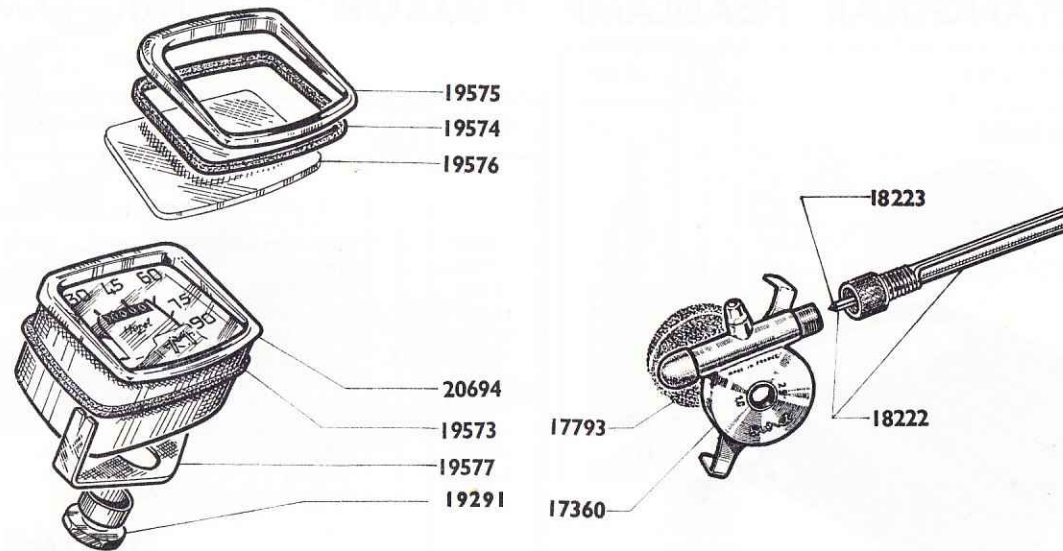

**Compteur HURET complet 90 Km.h: 20695
avec transmission**

Reprinting forbidden

"HURET" SPEEDOMETER 90 KMS

Part N°	Quantity per machine	DESCRIPTION	Part N°	Quantity per machine	DESCRIPTION
17360	1	Speedometer drive unit	19574	1	Speedometer glass gasket
17793	1	Gasket (nylon foam) (C. 10)	19575	1	Speedometer bezel
18222	1	Speedometer control L = 0.576 ^m	19576	1	Speedometer glass
18223	1	Speedometer cable L = 0.596 m	19577	1	Speedometer attachment bracket
19291	1	Speedometer attachment nut 12×100×19×5 ... (C. 5)	20694	1	Bare speedometer
19573	1	Speedometer gasket	20695	S.A.	Complete speedometer

MOBYLETTE Series 50

LEGSCHILD

Avant de la machine



Position impérative de la pièce n° 20254 vue de dessus.

Imperative position of part n° 20254 viewed from above

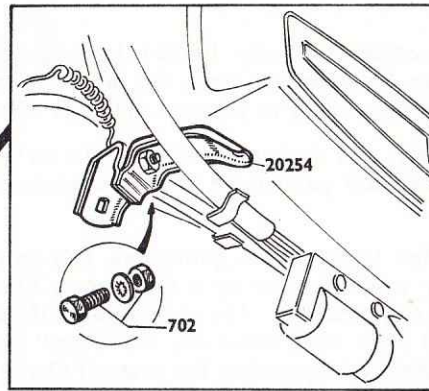

Faire passer les commandes comme indiqué au dessin.

Have orders made out as indicated in the drawing

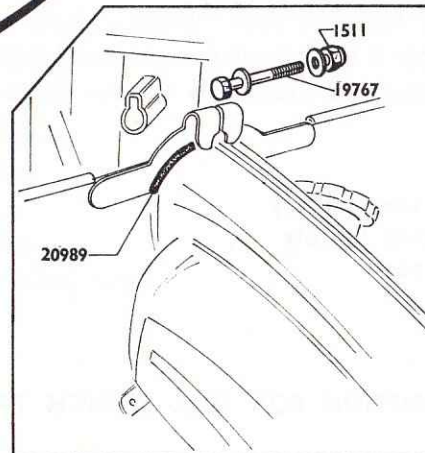
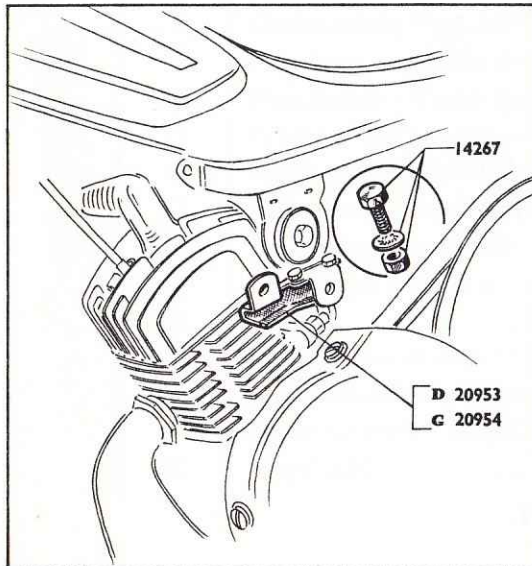
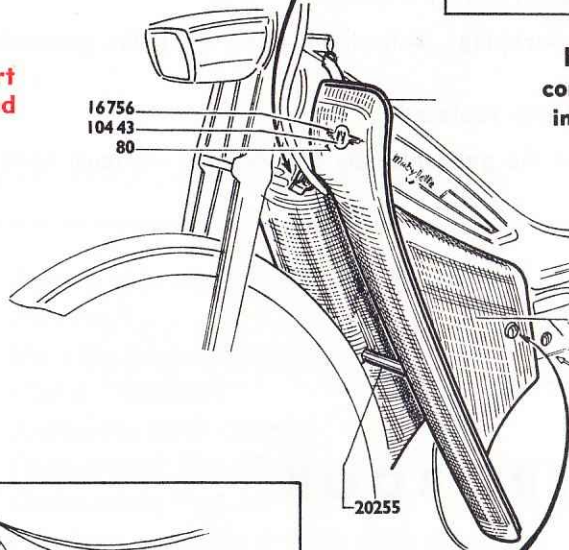

Part N°	Quantity per machine	DESCRIPTION
9	1	Nut $\varnothing 6\frac{m}{m} \times 100$ (C. 25)
52	1	Plain washer $\varnothing 5\frac{m}{m}$ (C. 50)
79	4	Nut $\varnothing 5\frac{m}{m} \times 9$ (C. 25)
80	2	Rivet badge (C. 25)
702	1	Screw $\varnothing 6\frac{m}{m} \times 100 \times 13\frac{m}{m}$ (C. 10)
874	4	Shakeproof washer $\varnothing 5\frac{m}{m}$ (C. 25)
1172	7	"NOMEL" washer $\varnothing 5\frac{m}{m}$ (C. 25)
1511	1	Nut $\varnothing 5\frac{m}{m} \times 80$ (C. 10)
8831	6	Knurled screw securing legshield 6×100 . (C. 20)
10443	1	Transfer under badge (C. 25)
14267	4	Bolt $\varnothing 5 \times 90 \times 10$ (C. 25)
16756	1	Badge (left side) (C. 25)
19767	1	Screw fixing the upper bracket $\varnothing 5 \times 80$ L=42 (C. 5)
20254	1	Double lug (C. 25)
20255	1	Rod (C. 25)
20950	S.A.	Fitting complete (C. 25)
20953	1	R.H. lower bracket (C. 25)
20954	1	L.H. lower bracket (C. 25)
20989	2	Bead for upper bracket L=32 $\frac{m}{m}$ (C. 25)

Part N°			Quantity per machine	DESCRIPTION
Blue	Coral	White		
20259	20751	20754	S.A.	Legshield assembly (without attachments) ..
20260	20752	20755	1	Legshield R.H. side (C. 25)
20261	20753	20756	1	Legshield L.H. side (C. 25)
20382	21015	20258	S.A.	Set of beads (C. 25)

CONDITIONS OF GUARANTEE

- 1st Our machines are guaranteed for six months. The guarantee is strictly limited to the replacement or reconditioning, at our convenience, of the parts acknowledged by our Technical Department to be defective from the manufacturing or material defect point of view. This guarantee does not involve our liability in the event of accidents occurring to persons or things which may result from such defects.
- 2nd All labour expenses involving the disassembly, re-assembly and testing of the machine, as well as the maintenance and return carriage expenses remain chargeable to the customer. We do not on any account participate in the expenses and consequences resulting from the immobilisation of the machine.
- 3rd Any replacements and reconditioning, carried out under the terms of the guarantee, can on no account result in the extension of the guarantee.
- 4th Any machines converted, modified or repaired outside our workshop, or by a third party other than our Official Dealers or **still with the use of non-genuine spare parts** shall lose the benefit of the guarantee. The same applies if the maintenance instructions (lubrication, running-in, maintenance) mentioned in the Owner's Guides supplied with each machine, have not been followed. The guarantee is subject to the compliance with indications given concerning the mixture, as indicated in the present Owner's Guide.
- 5th With regard to the parts and accessories not manufactured by us (bearings, tyres, sparkplugs, batteries if fitted, etc.), the guarantee is confined to that of the relevant supplier.
- 6th Springs, bulbs, glasses and controls (cables and sheaths) are neither guaranteed nor replaced.
- 7th When sending parts or components to be replaced or repaired under the terms of the guarantee by our dealers, we must have the following details :
 - a) the machine's frame and engine serial numbers,
 - b) the date of first circulation,
 - c) the number of kilometers completed,
 - d) brand and characteristic of the oil used.

SPARE PARTS ORDER BOOK

We have the opportunity to supply you with special spare parts order books.

These books have been printed to your attention, and are sent to you free of charge.

We shall deliver you other books at the same condition, but only if the following recommendations have been followed, i.e. :

1st PLEASE DO NOT WRITE IN THE DARK COLUMNS, they are exclusively for our Spare Parts Department.

2nd PLEASE COMPLETE YOUR ORDERS AS FOLLOWS :

- a) column N° 2 from left : type of the machine
- b) column N° 6 from left : reference of the part required **very legibly**
- c) column N° 7 from left : quantity of parts required **very legibly**
- d) column N° 9 from left : the exact description of the part

3rd MENTION YOUR NAME AND COMPLETE ADDRESS

4th SEND US YOUR ORDER SHEETS IN TRIPLICATE

5th PLEASE LEAVE A FREE LINE BETWEEN EACH DESCRIPTION FOR OUR FRENCH TRANSLATION.



EUROPEAN CONCESSIONNAIRES

KAMOTO S.A.

Brekerlaan 47
1703 KOBEGEM (Belgique)

KNUD MADSEN

Hovedkontor : Esplanaden 7
1263 COPENHAGUE K (Danemark)

MOBYLETTE GmbH.

4812 BRACKWEDE
Dieselstrasse 23 (Allemagne)

MOBYLETTE HELLAS

55, Rue Patission
ATHÈNES (Grèce)

MOTOBÉCANE S.A.

34, Route J.-Jacques Rigaud
1224 Chêne-Bougeries - GENÈVE (Suisse)

MOTOBÉCANE ITALIA S.p.A.

20156 MILANO
Viale Espinasse 93 (Italie)

MOTOR IMPORTS COMPANY Ltd

7 Gresham Road
LONDON S.W. 9 (Angleterre)

UNIKAP

DEN HULST (Ov.)
(Hollande)

MOTOBÉCANE

16, Rue Lesault — 93 - PANTIN
Téléphone : 845 27-94 - 845 27-67
TELEX : 22 206 MOTOBKN - PANTN

MOTOCONFORT

16, Rue Lesault — 93 - PANTIN
Téléphone : 845 27-94 - 845 27-67
TELEX : 22 206 MOTOBKN - PANTN

IceniCAM On-Line Library

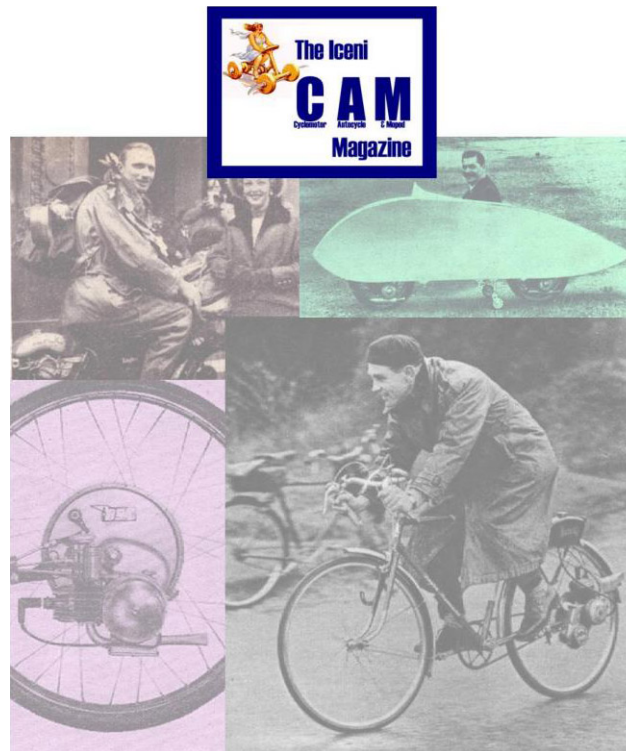

www.icenicam.org.uk