

Malaguti

MAINTENANCE
AND
OPERATING INSTRUCTIONS

INTRODUCTION TO THE MALAGUTI

Your Malaguti has been designed and built to give a sporting but reliable performance.

This cannot be achieved unless maintenance in accordance with the manufacturers recommendations contained in this handbook are adhered to.

To retain the attractive appearance of your Malaguti the paintwork and plating will benefit from regular cleaning and wax polishing. During the winter months a slightly oily cloth wiped over the plated parts will help to minimise corrosion.

In the interest of safety please ensure that your machine is maintained correctly and use only genuine Malaguti replacement spare parts.

Malaguti agents are appointed throughout the country to help you enjoy your machine. Please use their services for your satisfaction.

PETROL/OIL MIXTURE

Use only the highest quality two stroke oil. On no account use a different mixture other than the recommended ratio of 20:1.

Damage resulting from incorrect petrol/oil mixture will not have warranty coverage.

**Please Note: — Ratio of 16:1 is recommended for the running-in period.
Petrol of 96 Octane minimum to be used.**

SPECIFICATION

ENGINE	2 stroke
Capacity	49.93 cc
Bore	39 mm
Stroke	41.8 mm
B.P.H.	6.5 @ 8500 R.P.M. (2 @ 5000 R.P.M. 1977 On)
Ignition	Flywheel Magneto
Spark Plug	Bosch W240TI, Champion L85 or equivalent. For fast or hard riding Champion L78 or L4G
Carburettor	Dellorto SHB 19/19 (Dellorto SHB 14/12 1977 On)
Air Filter	Wire gauze type, or dry, replaceable element on some models.

GEARBOX

4 or 5 speed, foot change in unit construction with engine.

FRAME AND CYCLE PARTS

DUPLEX frame of tubular construction with swinging arm rear suspension controlled by hydraulically damped units. Telescopic front forks hydraulically damped on Monte and Cavalcone models.

TECHNICAL DATA

ENGINE

Petrol/Oil mixture ratio	20:1
Ignition contact points setting	.012"
Ignition timing	22° B.T.D.C. (2.5mm on stroke)
Spark Plug Electrode setting	.020"

GEARBOX

Oil capacity approx.	2 pints (Imp).
Oil Mineral	sae 20/50

FRONT FORKS

Monte and Cavalcone: Marzocchi hydraulically damped units.
Olympique: Sprung telescopic units.

STEERING HEAD BEARINGS

Ball race all models, except Cavalcone 1976/77 which is taper roller.

REAR FORK BEARINGS

All models except 1976/77 Cavalcone: Either bronze or nylon bushes.
Cavalcone 1976/77: Silent Bloc composite rubber bushes.

IMPORTANT Please read following note before riding your new Malaguti.

PETROL/OIL MIXTURE

Use only the highest quality two-stroke oil. On no account use a different mixture other than the recommended ratio of 20:1.

Damage resulting from incorrect petrol/oil mixture will not have warranty coverage. Please note, Ratio of 16:1 recommended for running-in period.

Petrol of 96 Octane minimum to be used.

GEARBOX

Check oil level in gearbox by removing screw in front of the pedal shaft on the right hand side of the engine. Keep machine upright when checking. Fill to level of screw hole through filler plug situated on the top of crankcase on right hand side, close to outer clutch cable stop. See Fig. 1.

Use mineral oil:— sae 20/50

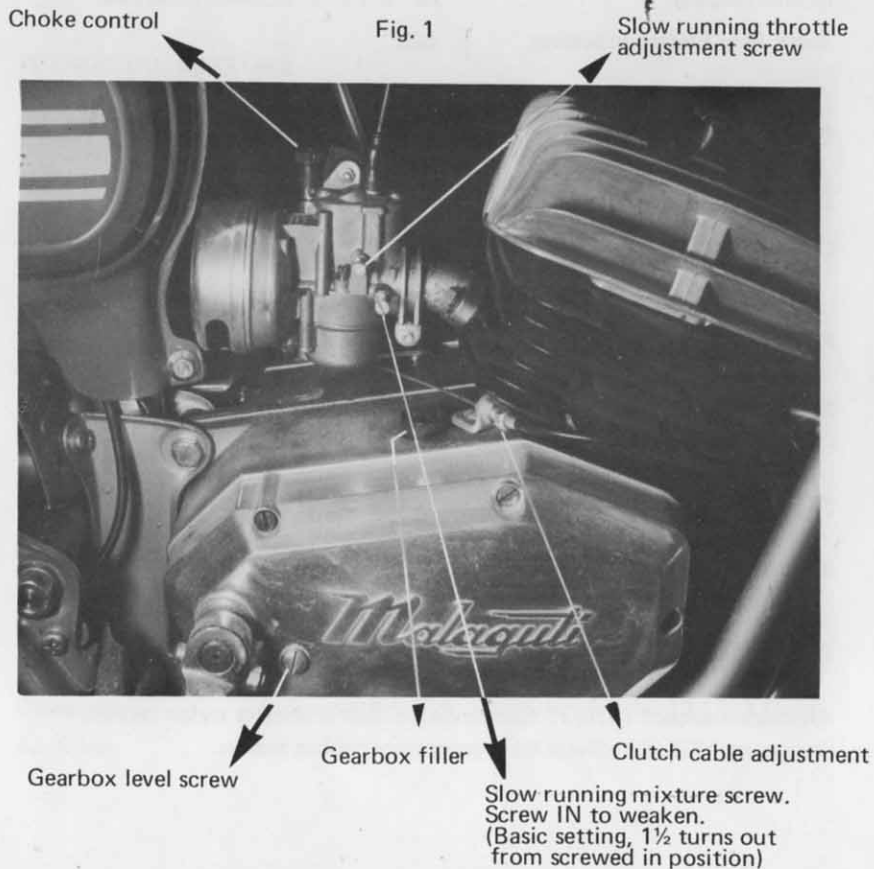

PETROL TAP

OFF "C" — "R" RESERVE

MAIN SUPPLY

The petrol tap has three positions, turn lever downwards for main supply, towards "C" for off and towards "R" for reserve.

Markings for reserve and off on sides of tap.

CHOKE CONTROL

When starting from cold it is essential to use the choke control. This is located on the carburettor and is operated by lifting the plastic knob; turning ¼ of a turn to lock in position. Release choke by turning a further ¼ turn when engine is sufficiently warm to operate without its use.

See Fig. 1.

TO STOP ENGINE

Close petrol tap and press earth button on top of lighting switch located on handlebars. See Fig. 2.

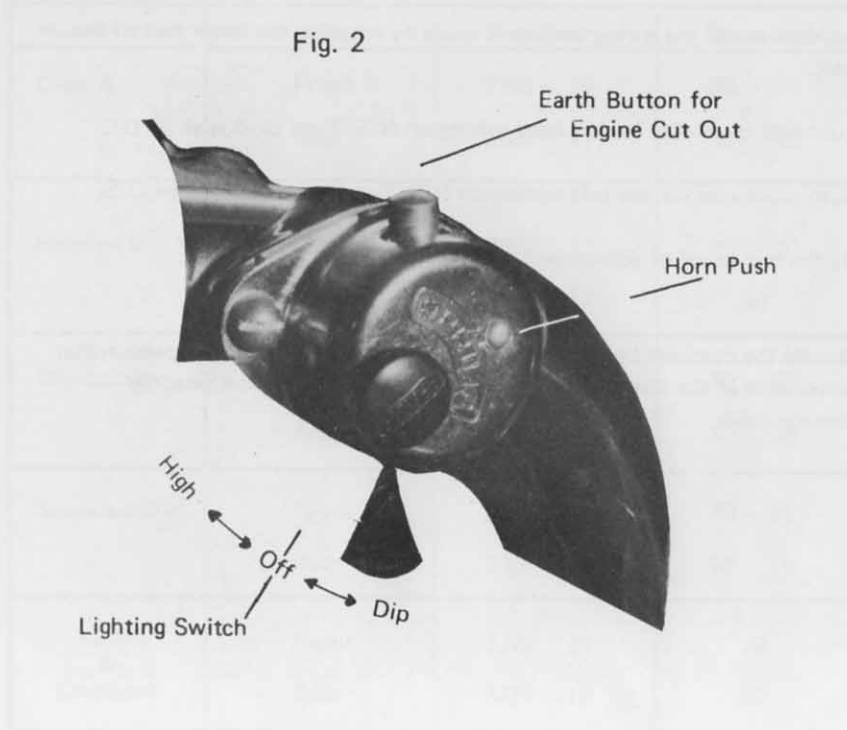

RUNNING-IN PROCEDURE

The importance of running-in a new engine cannot be overstressed if trouble free operation and efficient performance is to be expected.

FIRST 1200 MILES

Do not exceed 25 M.P.H. in top gear and use only a small throttle opening at all times.

1200 MILES – 2000 MILES

Progressively increase speed but avoid full throttle operation until mileage is in excess of 2000 miles.

REAR SUSPENSION RIDE CONTROL, MONTE AND CAVALCONE MODELS ONLY

Adjustment of the spring tension is made by rotating the lower half of the unit.

Turn anti-clockwise for the **hard setting** on N/S. Turn clockwise on O/S.

Turn clockwise for the **soft setting** on N/S. Turn anti-clockwise on O/S.

At the mid point of adjustment a **medium setting** is achieved.

Should the machine be used over rough ground disconnect the speedometer drive cable at the lower end as generous fork movement will possibly damage cable.

PLEASE NOTE

All the service intervals are dependant on the operating conditions the machine is subjected to and items such as chains, air filters and silencer decarbonising may require attention more frequently. Air filters and chains will require more servicing under dusty and wet weather conditions. The wire gauze type of air filter should be thoroughly cleaned in petrol, dried out and before refitting lightly oil the wire gauze. A heavily carbonised silencer will have the effect of reducing power output and may cause difficult starting with possible damage to the engine.

For Servicing Details please see last two pages of this manual

TYRE PRESSURES

Model		Tyre Size	lbs.sq.inch
Cross 5	Front	2.50 19	30 – 35
	Rear	3.00 17	30 – 35
Hombre 5	Front	2.50 17	25 – 30
	Rear	3.00 17	30
Olympique	Front	2.25 18	30 – 35
	Rear	2.50 18	30 – 35
Superquattro	Front	2.25 18	30 – 35
	Rear	2.50 18	30 – 35
Monte & Cavalcone	Front	2.50 21	28
	Rear	3.00 18	32

5 SPEED ENGINE AND GEARBOX

UP TO 1977

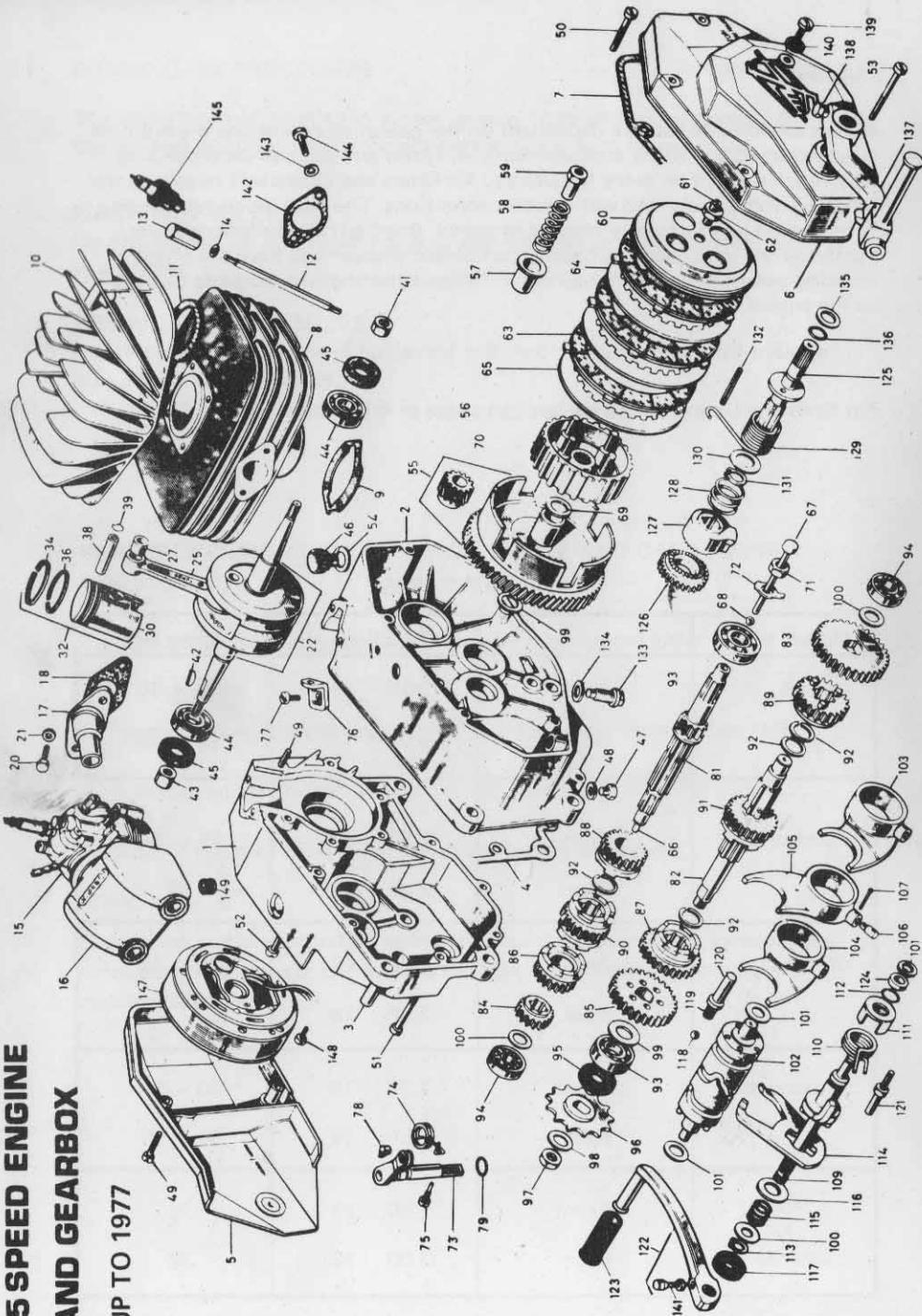

5 SPEED ENGINE AND GEARBOX PARTS

- | | | |
|------------------------------------------|--------------------------------------------|--------------------------------|
| 1. Crankcase N/S | 49. Points Cover Screw X2 | 95. Main Shaft GB Oil Seal |
| 2. Crankcase C/S | 50. Crankcase Bolt X5 | 96. Gear Box Sprocket |
| 3. N/S Crankcase Dowel | 51. Crankcase Bolt | 97. Sprocket Nut |
| 4. Crankcase Gasket | 52. Crankcase Bolt | 98. Sprocket Washer |
| 5. Points Cover | 53. Bolt | 99. Thrust Washer |
| 6. Clutch Cover | 54. Filler Plug Washer | 100. Washer |
| 7. Gear Box Cover Gaskets | 55. Clutch Drive | 101. Washer |
| 8. Barrel | 55A. Pinion Crankshaft | 102. Selector Barrel |
| 9. Barrel Gasket | 56. Clutch Carrier | 103. 1st Gear Selector |
| 10. Cylinder Head | 57. Clutch Spring Clip | 104. 2nd and 5th Gear Selector |
| 11. Head Gasket | 58. Clutch Spring X4 | 105. 3rd and 4th Gear Selector |
| 12. Cylinder Stud | 59. Clutch Spring Nut X4 | 106. Selector Pin X3 |
| 13. Cylinder Head Nut | 60. Clutch Outer Plate | 107. Selector Split Pin |
| 14. Cylinder Head Washer | 61. Clutch Push Rod Adjuster Screw | 108. Not Shown |
| 15. Carburettor * | 62. Clutch Push Rod Adjuster Screw Locknut | 109. Selector Shaft |
| 16. Air Cleaner * | 63. Clutch Friction Plate | 110. Selector Spring |
| 17. Inlet Flange | 64. Clutch Plate | 111. Spring Retainer |
| 18. Flange Gasket | 65. Clutch Plate | 112. Circlip |
| 19. Distance Piece | 66. Clutch Rod | 113. Circlip |
| 20. Flange Bolt X2 | 67. Clutch Push Rod * | 114. Selector Plate |
| 21. Flange Washer X2 | 68. Ball | 115. Selector Tension Spring |
| 22. Crankshaft Assembly | 69. Thrust Washer | 116. Washer |
| 23. Not Shown | 70. Clutch Bush | 117. Oil Seal Shaft Selector |
| 24. Not Shown | 71. Layshaft Nut | 118. Ball |
| 25. Con-Rod | 72. Layshaft Tab Washer | 119. Spring |
| 26. Not Shown | 73. Clutch Pivot Arm | 120. Cup |
| 27. Small End Bush | 74. Clutch Pivot Arm Spring | 121. Spring Stop |
| 28. Not Shown | 75. Lock Bolt Pivot Arm | 122. Gear Lever |
| 29. Not Shown | 76. Clutch Cable Stop | 123. Gear Lever Rubber |
| 30. Piston | 77. Clutch Stop Screw | 124. Distance Piece |
| 31. Not Shown | 78. Clutch Cable Nipple | 125. Kick Start Shaft |
| 32. Piston Complete | 79. Pivot Seal | 126. Kick Start Gear |
| 33. Not Shown | 80. Not Shown | 127. Kick Start Pawl |
| 34. Top Piston Ring | 81. Lay Shaft | 128. Pawl Spring |
| 35. Not Shown | 82. Main Shaft | 129. Kick Start Return Spring |
| 36. Bottom Piston Ring | 83. 1st Gear Secondary | 130. Washer |
| 37. Not Shown | 84. 2nd Primary | 131. Circlip |
| 38. Gudgeon Pin | 85. 2nd Secondary | 132. K.S. Spring Dowel |
| 39. Gudgeon Circlip | 86. 3rd Primary | 133. Kick Start Stop |
| 40. Not Shown | 87. 3rd Secondary | 134. Kick Start Washer |
| 41. Pinion Locknut | 88. 4th Primary | 135. Washer |
| 42. Magneto Key | 89. 4th Secondary | 136. O Ring |
| 43. Magneto Nut | 90. 5th Primary | 137. Kick Start |
| 44. Crankshaft Mainbearings | 91. 5th Secondary | 138. Kick Start Bolt |
| 45. Crankshaft Seal X2 | 92. Circlip X2 | 139. Oil Level Plug |
| 46. Gearbox and Primary Case Filler Plug | 93. Gear Box Mainshaft Bearing X2 | 140. Oil Level Plug Washer |
| 47. Crankcase Drain Plug | 94. Gear Box Mainshaft Bearing X2 | 141. Gear Lever Cotter |
| 48. Crankcase Drain Plug Washer | | 142. Exhaust Gasket |
| | | 143. Spring Washer |
| | | 144. Exhaust Flange Bolt |
| | | 145. Spark Plug |

* Modified Carburettor and Air Cleaner used after January 1974.

**4 SPEED ENGINE
AND GEARBOX
UP TO 1977**

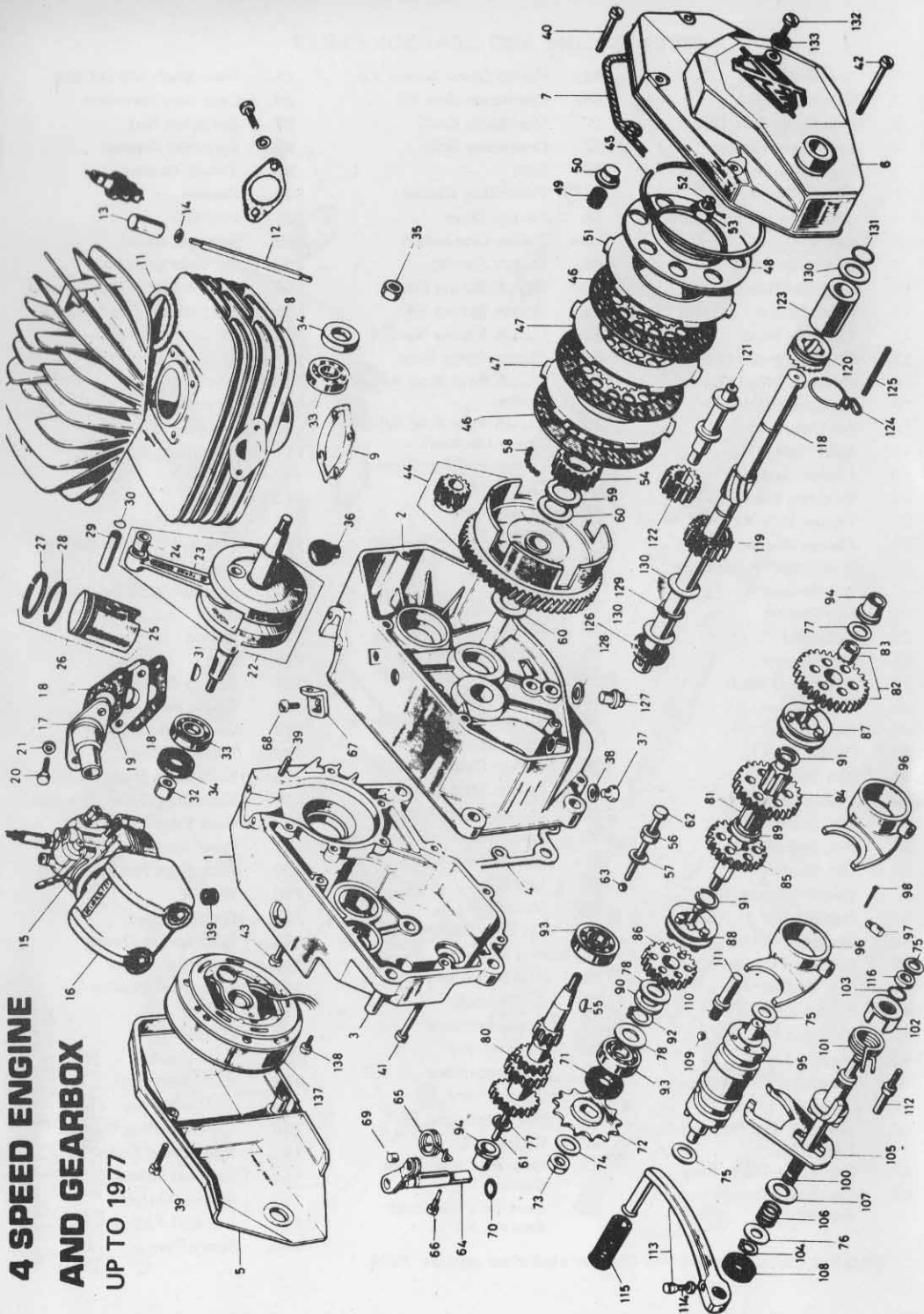

4 SPEED ENGINE AND GEARBOX PARTS

- | | | |
|--------------------------------|----------------------------------|-----------------------------------|
| 1. Crankcase N/S | 48.* Clutch Spring Carrier Plate | 92. Circlip |
| 2. Crankcase O/S | 49.* Clutch Spring | 93. Mainshaft Bearing |
| 3. Crankcase Dowel | 50.* Clutch Spring Cup | 94. Bushes |
| 4. Crankcase Gasket | 51.* Clutch Plate Steel | 95. Selector Barrel |
| 5. Points Cover | 52.* Clutch Push Rod | 96. Selector (2 off) |
| 6. Clutchcover | Adjustment screw | 97. Selector Index Pin |
| 7. Gearbox Cover Gasket | 53.* Clutch Adjuster Lock Nut | 98. Split Pin, Selector Index Pin |
| 8. Barrel | 54.* Clutch Hub | 99. C/mplete Assembly |
| 9. Barrel Gasket | 55. Clutch Key | 100. Selector Shaft |
| 10. Cylinder Head | 56. Layshaft Nut | 101. Selector Spring |
| 11. Head Gasket | 57. Layshaft Tab Washer | 102. Spring Retainer |
| 12. Cylinder Stud | 58.* Clutch Ball Bearings | 103. Circlip |
| 13. Cylinder Head Nut | 59. Thrust Washer | 104. Circlip |
| 14. Cylinder Head Washer | 60. Thrust Washer | 105. Selector Plate |
| 15. Carburettor** | 61. Clutch Push Rod | 106. Selector Tension Spring |
| 16. Air Cleaner** | 62. Clutch Push Rod | 107. Thrust Washer |
| 17. Inlet Manifold | 63. Clutch Push Rod Ball Bearing | 108. Selector Shaft Seal |
| 18. Inlet Manifold Gasket | 64. Clutch Pivot Arm | 109. Ball Bearing |
| 19. Distance Piece (when used) | 65. Clutch Pivot Arm | 110. Spring |
| 20. Flange Bolt (2 off) | Return Spring | 111. Cup |
| 21. Flange Bolt Washer (2 off) | 66. Clutch Pivot Arm Lock Bolt | 112. Spring Stop |
| 22. Crankshaft Assembly | 67. Clutch Cable Stop | 113. Gear Lever |
| 23. Connecting Rod | 68. Clutch Cable Stop Screw | 114. Gear Lever Cotter |
| 24. Small End Bush | 69. Clutch Cable Nipple | 115. Gear Lever Rubber |
| 25. Piston | 70. Clutch Pivot Arm Seal | 116. Spacer |
| 26. Piston Complete | 71. Gear Box Mainshaft Oil Seal | 117. Complete Assembly, |
| 27. Compression Ring | 72. Gearbox Sprocket | Pedal Shaft |
| 28. Second Ring | 73. Gearbox Mainshaft Nut | 118. Pedal Shaft |
| 29. Gudgeon Pin | (Sprocket) | 119. Pedal Shaft Gear |
| 30. Circlip (Piston) | 74. Gearbox Mainshaft Washer | 120. Pedal Shaft Pawl |
| 31. Magneto Key | (Sprocket) | 121. Pedal Shaft Idler Shaft |
| 32. Magneto Nut | 75. Thrust Washer | 122. Pedal Shaft Idler Gear |
| 33. Crankshaft Main Bearing | 76. Spacer Washer | 123. Spacer |
| (Timing Side) | 77. Thrust Washer | 124. Pawl Guide Clip |
| 34. Crankshaft Seal | 78. Thrust Washer | 125. Guide Clip Dowel |
| (Timing Side) | 79. Complete Assembly | 126. Seal |
| 35. Retaining Nut Primary | 80. Layshaft | 127. Blanking Plug |
| Drive Pinion | 81. Mainshaft | 128. Washer |
| 36. Oil Filler Plug | 82. First Gear Pinion | 129. Circlip |
| 37. Oil Drain Plug | 83. First Gear Bush | 130. Thrust Washer |
| 38. Oil Drain Plug Washer | 84. Second Gear Pinion | 131. 'O' Ring |
| 39. Points Cover Screw (2 off) | 85. Third Gear Pinion | 132. Oil Level Plug |
| 40. Screw Gearbox Case | 86. Fourth Gear Pinion | 133. Not Illustrated |
| 41. Crankcase Bolt | 87. First and Second Gear | 134. Not Illustrated |
| 42. Screw Gearbox Case | Selector Dog | 135. Not Illustrated |
| 43. Crankcase Bolt | 88. Third and Fourth Gear | 136. Spark Plug |
| 44. Primary Drive Assembly | Selector Dog | 137. Magneto |
| 45.* Clutch Retaining Circlip | 89. Spacer | 138. Magneto Back Plate Screw |
| 46.* Clutch Friction Plate | 90. Spacer | 139. Grommet |
| 47.* Clutch Plate Steel | 91. Circlip | |

* All clutch parts after January 1975 are same as 5 speed.
 ** Modified Carburettor and Air Cleaner used after January 1974.

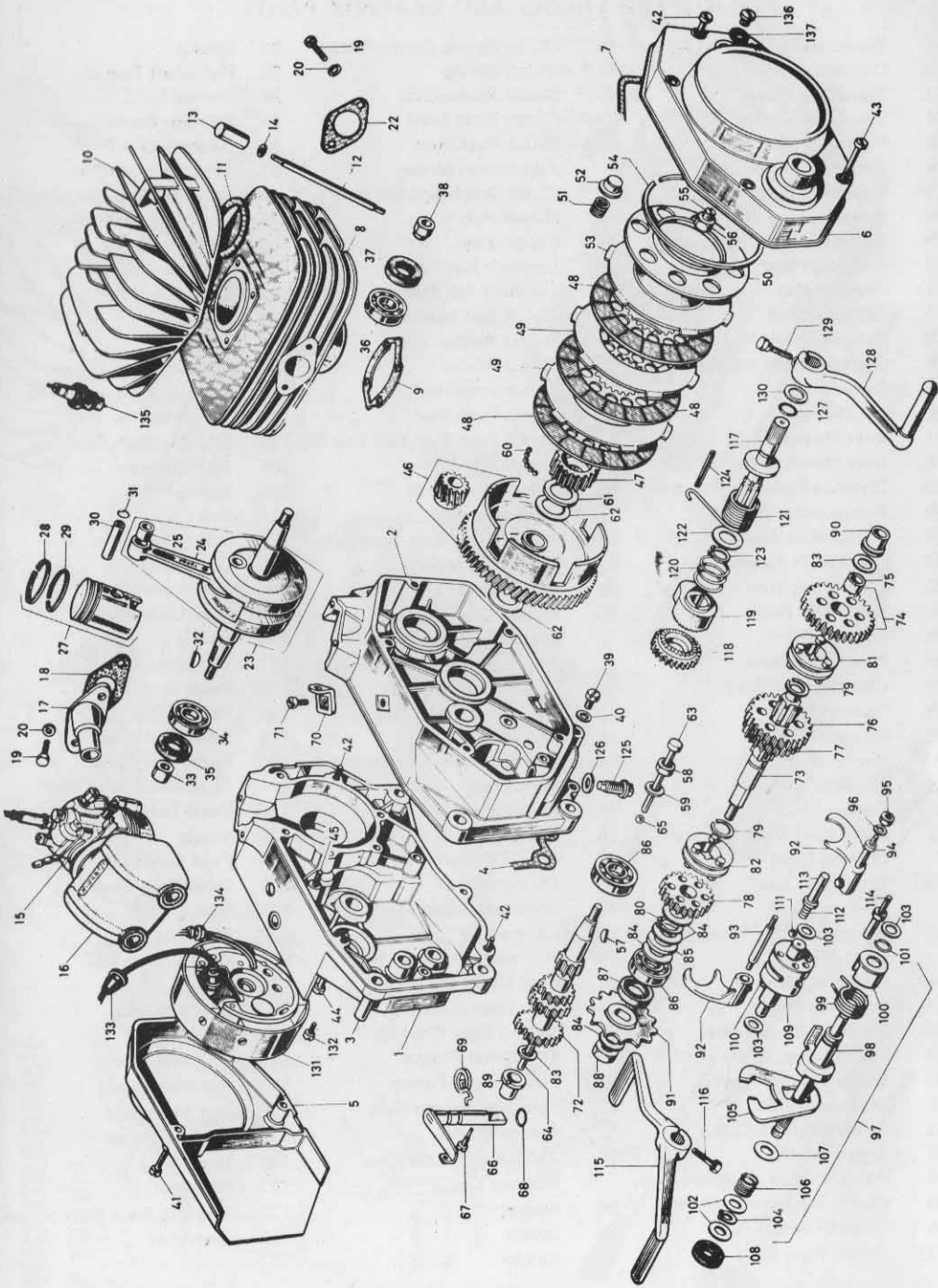

4 SPEED ENGINE AND GEARBOX PARTS
FOR CAVALCONE 1977 ON

- | | | |
|-----------------------------|------------------------|-----------------------------|
| 1. Crankcase L.H. | 49. Clutch Plate | 94. Guide Pin |
| 2. Crankcase R.H. | 50. Pressure Plate | 95. Nut |
| 3. Dowel | 51. Clutch Springs | 96. Washer |
| 4. Centre Gasket | 52. Spring Cup | 97. Selector Shaft Complete |
| 5. Cover L.H. | 53. Plate | 98. Selector Shaft |
| 6. Cover R.H. | 54. Circlip | 99. Return Spring |
| 7. Cover Gasket | 55. Adjuster | 100. Cup |
| 8. Cylinder Barrel | 56. Locknut | 101. Circlip |
| 9. Base Gasket | 57. Woodruff Key | 102. Washer |
| 10. Cylinder Head | 58. Nut | 103. Washer |
| 11. Head Gasket | 59. Washer | 104. Circlip |
| 12. Cylinder Stud | 60. Balls | 105. Selector Plate |
| 13. Cylinder Nut | 61. Washer | 106. Spring |
| 14. Washer | 62. Washer | 107. Washer |
| 15. Carburettor | 63. Push Rod | 108. Oil Seal |
| 16. Air Cleaner | 64. Push Rod | 109. Selector Barrel |
| 17. Inlet Tract | 65. Ball | 110. Index Pin |
| 18. Inlet Gasket | 66. Operating Lever | 111. Ball |
| 19. Screw | 67. Stop Screw | 112. Spring |
| 20. Washer | 68. O Ring | 113. Cup |
| 22. Exhaust Gasket | 69. Spring | 114. Spring Stop |
| 23. Crankshaft | 70. Adjuster Base | 115. Gear Change Lever |
| 24. Connecting Rod Assembly | 71. Screw | 116. Screw |
| 25. Needle Bearing | 72. Bearing | 117. Kickstart Shaft |
| 27. Piston Assembly | 73. Secondary Shaft | 118. Kickstart Gear |
| 28. Ring Set | 74. First Gear | 119. Kickstart Ratchet |
| 30. Gudgeon Pin | 75. Bush | 120. Ratchet Spring |
| 31. Circlip | 76. Second Gear | 121. Kickstart Spring |
| 32. Woodruff Key | 77. Third Gear | 122. Washer |
| 33. Crank Nut R.H. | 78. Fourth Gear | 123. Circlip |
| 34. Main Bearing L.H. | 79. Circlip | 124. Spring Stop |
| 35. Main Seal L.H. | 80. Circlip | 125. Ratchet Stop |
| 36. Main Bearing R.H. | 81. Selector Dog 1/2nd | 126. Washer |
| 37. Main Seal R.H. | 82. Selector Dog 3/4th | 127. O Ring |
| 38. Crank Nut R.H. | 83. Washer | 128. Kickstart Lever |
| 39. Drain Screw | 84. Washer | 129. Bolt |
| 40. Washer | 85. Spacer | 130. Washer |
| 41. Screw | 86. Bearing | 131. See Magneto List |
| 42. Screw | 87. Oil Seal | 133. Grommet |
| 43. Screw | 88. Nut | 134. Grommet |
| 44. Screw | 89. Bush | 135. Spark Plug |
| 45. Screw | 90. Bush | 136. Oil Level Plug |
| 46. Primary Gears | 91. Gearbox Sprocket | 137. Washer |
| 47. Clutch Hub | 92. Selector Fork | |
| 48. Clutch Plate | 93. Guide Pin | |

AT 350 MILES

Change gearbox oil, drain when warm.
Check for dirt in carburettor.
Check tightness of all cycle parts.
Check steering head bearings for excessive free play.
Check wheel spokes for breakage or looseness.
Check adjustment of cup and cone type wheel bearings.
Clean spark plug and reset electrode gap.

AT 1200 MILES

Change gearbox oil.
Check magneto contact breaker points for correct clearance, clean air filter gauze.
Check wheel spokes for breakage and looseness.

EVERY 650 MILES

Check gearbox oil level.
Lubricate chain.
Clean spark plug and reset electrode gap.

EVERY 1000 MILES

Clean air filter, wire gauze or replace dry type element if dirty.
Check all wheel spokes for breakage or looseness.
Clean exhaust system.

EVERY 1500 MILES

Remove chain, clean and lubricate. Under severe conditions service chain more frequently.
Adjust chain to give approximately 1" at its mid-point on the bottom run of the chain with the weight of the rider on the machine.

EVERY 2500 MILES

Dismantle front forks, clean and lubricate. Hydraulic forks only require checking for leaks and, if necessary, refilling with correct capacity of oil.
Recommended oil: CASTROLITE or CASTROL T9F.
Oil capacities each leg: Cross 5 — 165cc
Cavalcone 1976/77 — 140cc
Monte and Cavalcone 1977 On — 170cc

EVERY 3000 MILES

Check condition of contact points in magneto, reset clearance and lubricate cam felt with light grease.
Remove petrol tap and clean filter.
Remove carburettor, strip and clean.
Check steering head bearing adjustment.
Lubricate speedometer drive gearbox.

EVERY 4000 MILES

Repack wheel bearings with grease.

GENERAL SERVICE POINTS

SPARK PLUG

Remove and clean off carbon deposit with wire brush and reset electrode clearance.

CABLE LUBRICATION

Inject oil into throttle, clutch and brake cables at regular intervals.

CHAIN LUBRICATION

Apply oil frequently, more often under wet conditions.

CHECK BRAKE ADJUSTMENT

Adjust when free movement becomes excessive.

CLUTCH CABLE ADJUSTMENT

Adjust cable at lower end for free movement per diagram:

See Figs. 1 & 3

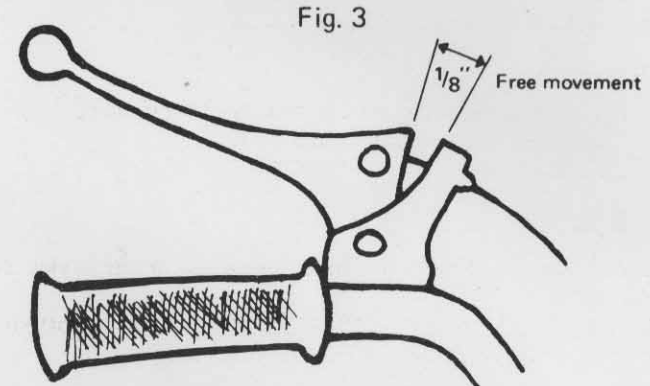

CLUTCH MAJOR ADJUSTMENT

Should be carried out by your Malaguti agent.

STEERING HEAD BEARINGS LUBRICATION

Once a year should be cleaned and re-packed with grease.

TYRE PRESSURE

Check weekly (see chart).

ALL CYCLE AND ENGINE PARTS

Check tightness of all nuts, bolts, screws, etc. weekly.

EXHAUST DRAIN POINT

Hombre model only. Remove plug on underside of exhaust at lowest point to drain off accumulated oil. Once weekly is recommended.

STEERING LOCK

Periodically lubricate with graphite.

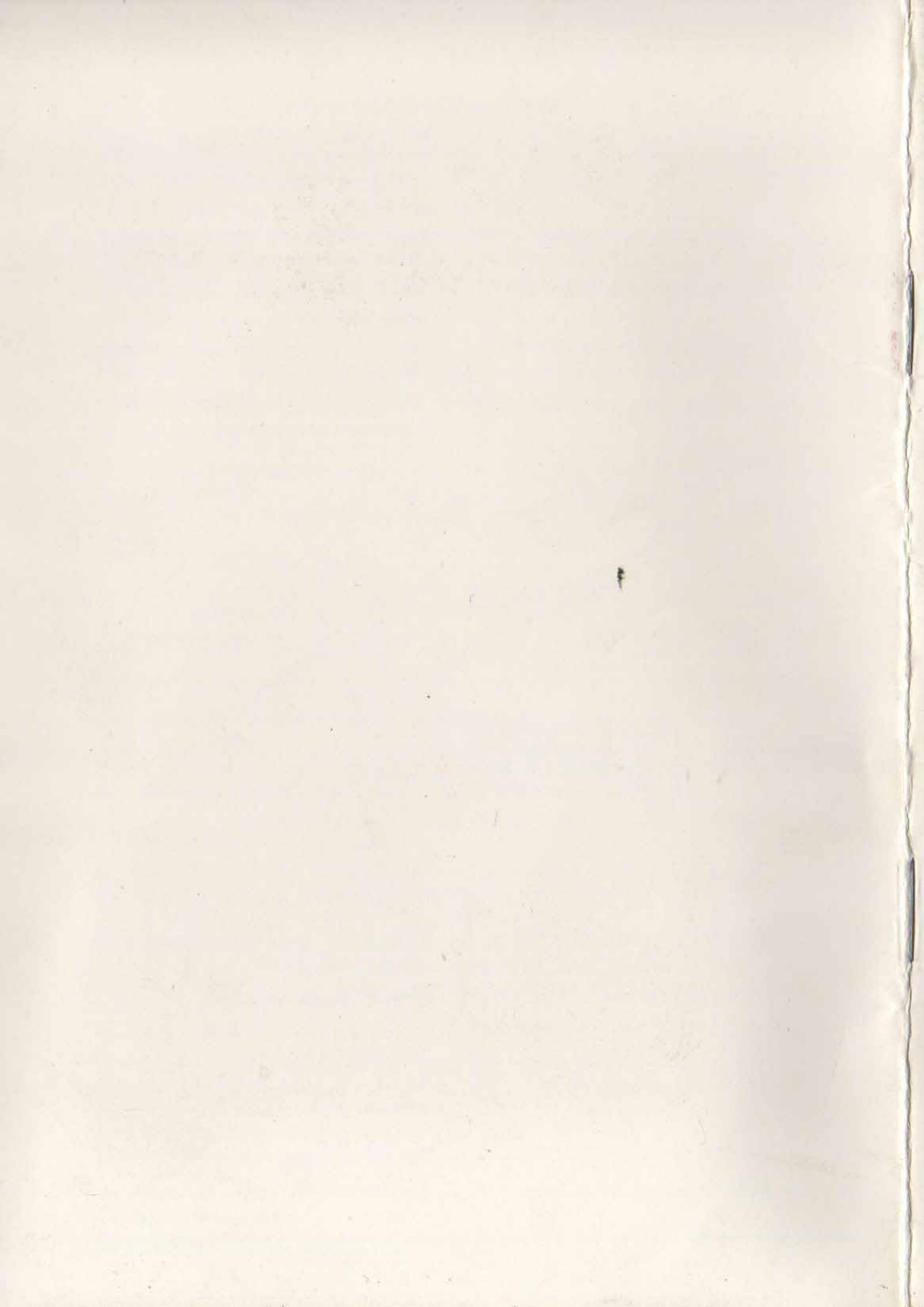

IceniCAM Information Service



www.icenicam.org.uk