

INDEX

COMPANY	PAGES
Esge-Marby	1 - 6
Bierreci	7
Laprade	9 - 10
Maillard	11 - 17
Ofmega	19 - 29
Sedis	31 - 33
Sella Italia	35 - 38
Steco	39 - 40
Vredestein	41 - 42
Weinmann	43 - 67

ITEM	PAGES
Bottom Brackets	19, 24
Brakes	49-51, 53-55, 57
Brake Levers	58-59, 61-63
Brake Spares	47-48, 52, 55-56, 60, 62, 64, 65, 68
Carriers	2, 3, 39, 40
Chain	31-33
Chainwheels	19-23, 28
Cranks	24
Freewheels	15, 16
Freewheel Removers	16
Headsets	24
Hubs	11-13, 17, 19, 26, 29
Kickstand.. .. .	1
Mudguards	4-6, 66
Pedals	13, 14, 19, 25
Rims	42-45, 67
Saddles	35-38
Seat Pins.. .. .	9-10, 38
Toe Straps	7
Tubes	41-42
Tyres	41-42



Ets. MAURICE MAILLARD, worldwide leaders in the manufacture of Freewheels and one of the largest manufacturers of hubs and pedals.

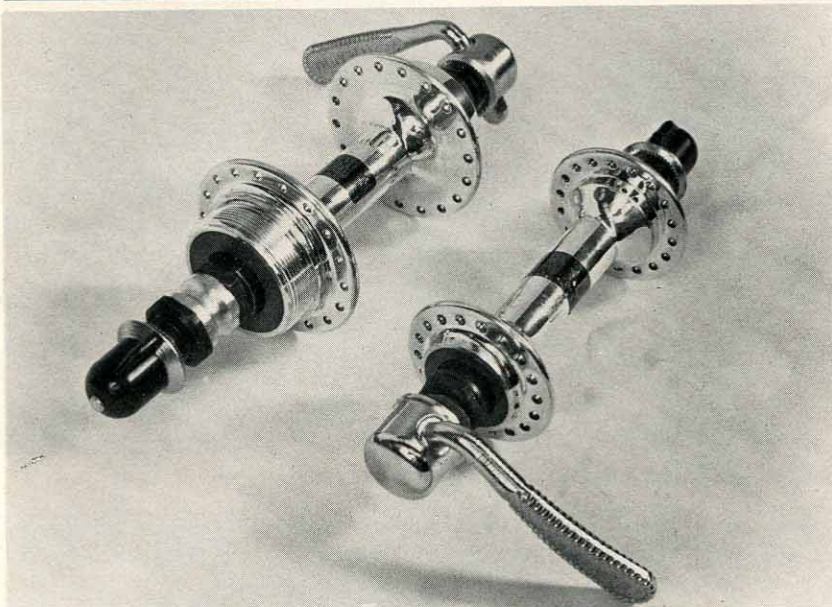

NORMANDY S/F De-Luxe w. Q/R

NORMANDY

small flange de-luxe competition hub with hollow spindles and quick-release skewers.

Weight : 510 gms.

Also available as standard small flange with quick-release.

MAILLARD ATOM & NORMANDY

large and small flange forged light alloy hubs. 36 hole drillings. 32/40 and 28 hole on request. Solid axles or hollow spindles. Precision made. Highly polished. Individually boxed.

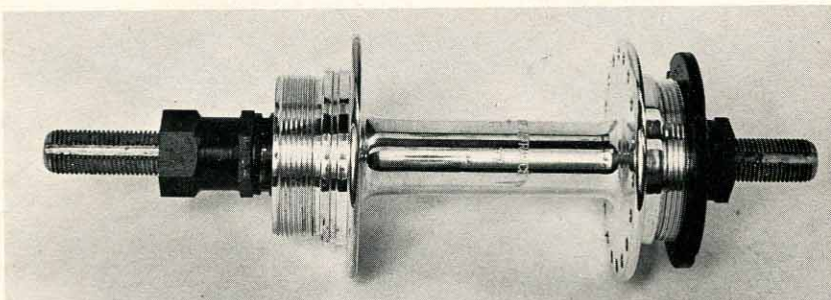

ATOM S/F D/S Gear & Fixed

ATOM

small flange rear hub.

Threading : Double Side/Gear & Fixed and Double Fixed.

Weight : 275 gms.

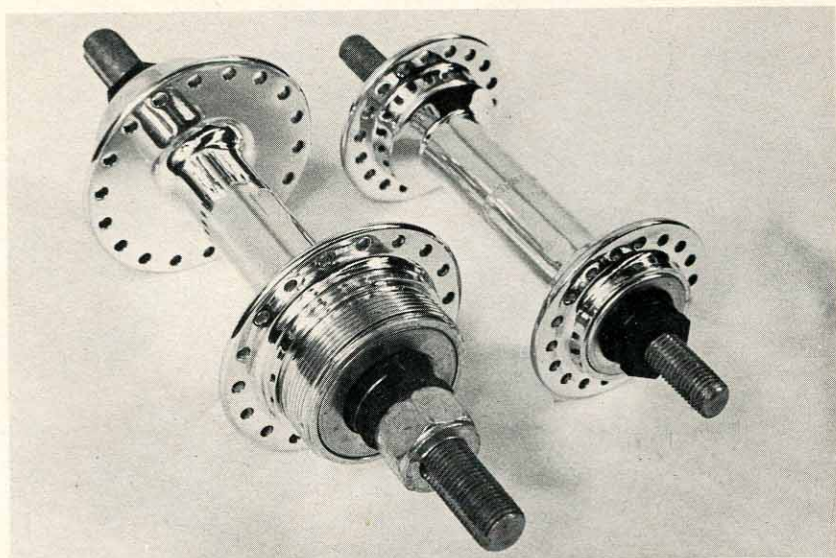

ATOM S/F Front & Rear

ATOM

small flange hubs.

Threading : Single Side/Gear.

Weight : 400 gms.



NORMANDY

large flange light alloy hubs.
36 hole drillings.
32/40 hole drillings available
on request.
Elongated flange cut-outs.
Threading :
Single Side/Gear.
Weight : 460 gms.

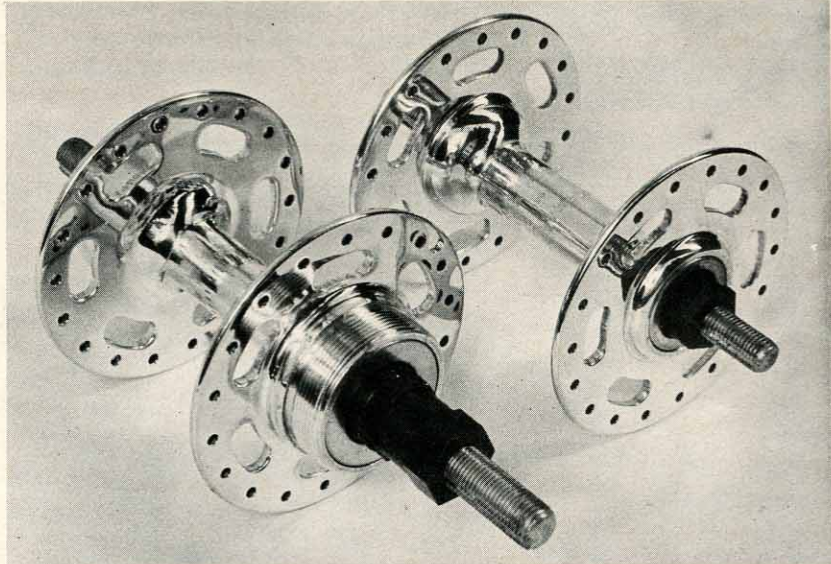

NORMANDY L/F Front & Rear

NORMANDY

large flange rear hub.
Threadings :
Double Side/Gear & Fixed.
Double Fixed.
Weight : 300 gms.

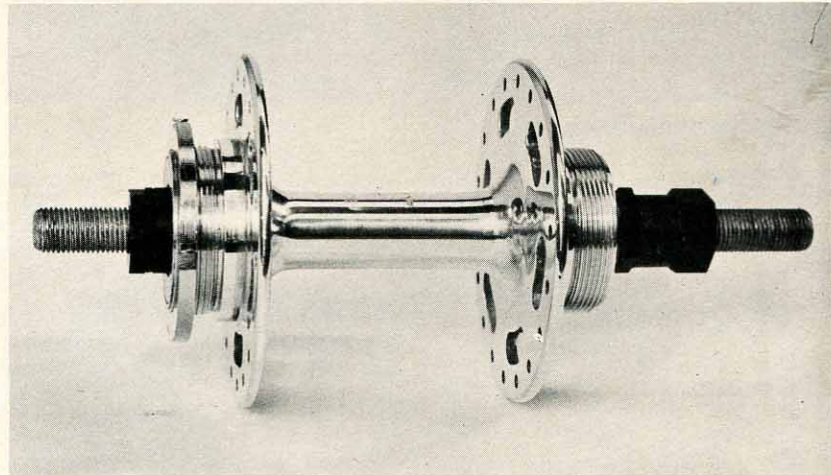

NORMANDY L/F D/S Gear & Fixed

NORMANDY

large flange with hollow
spindles and quick-release
skewers.
Weight : 600 gms.

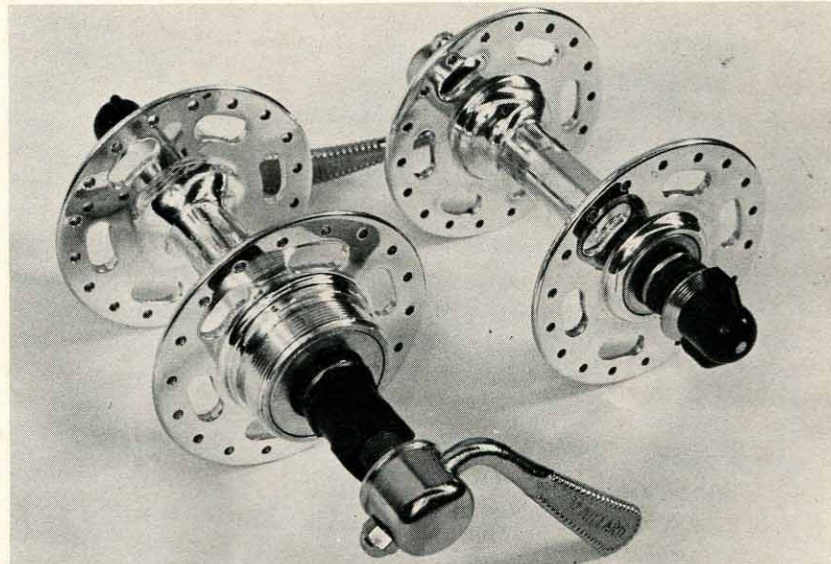

NORMANDY L/F Q/R

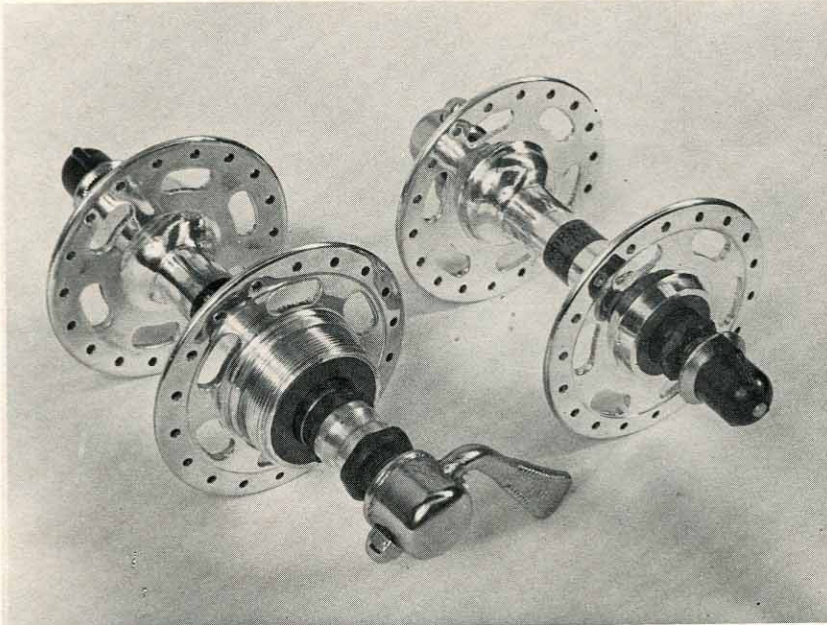

NORMANDY de-Luxe L/F Q/R

NORMANDY de-LUXE

competition large flange hub with hollow spindles and quick-release skewers.

Weight : 590 gms.

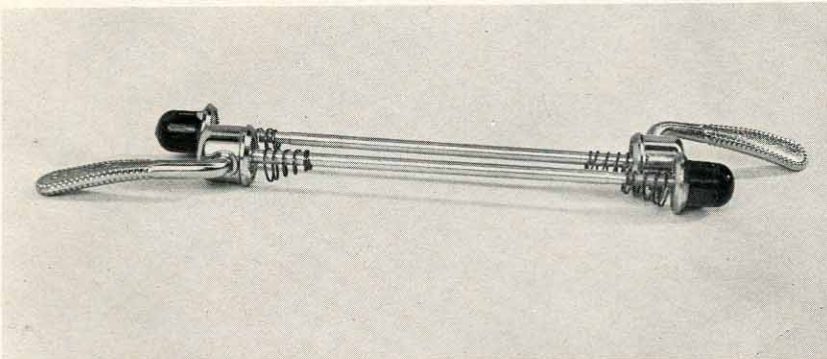

NORMANDY Q/R Skewers

NORMANDY

Front and Rear quick-release skewers and cones complete.

Weight : 290 gms.

NEWLY AVAILABLE
IN BLISTER PACKS

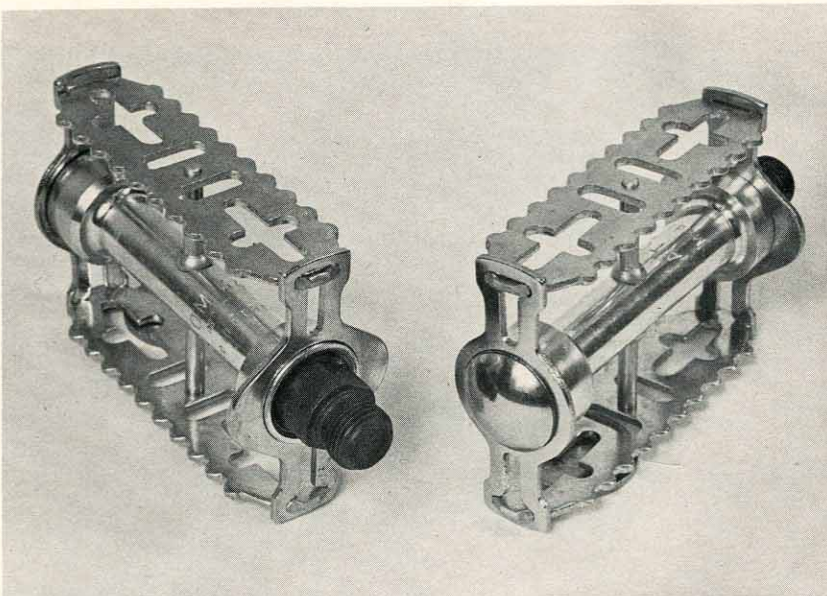

ATOM 440

ATOM 440

light alloy rat-trap, chrome pedals.

Boxed.

Weight : 410 gms.



ATOM 600RC

forged light alloy quill pedals in shrink-wrapped polythene.

* 13 mm long-thread spindle.

Weight: 430 gms.

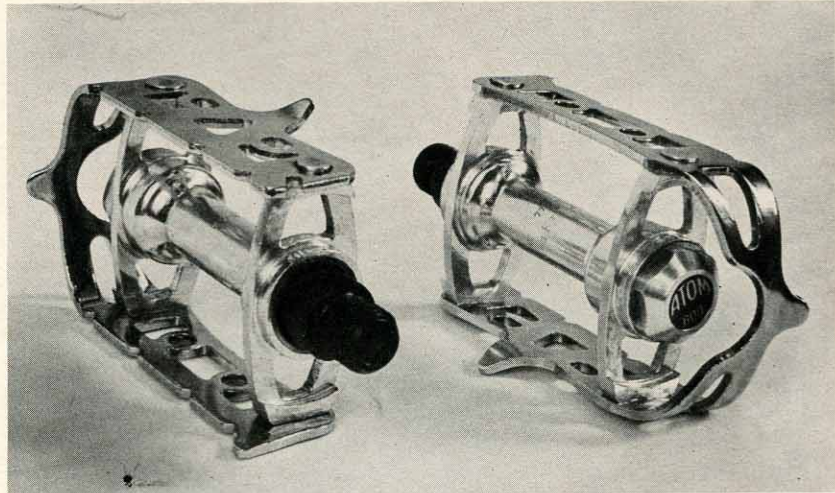

ATOM 600RC Pedals

ATOM 600RN

forged light alloy quill pedals in shrink-wrapped polythene.

* 13 mm long thread spindle.

* Black cage.

Weight: 430 gms.

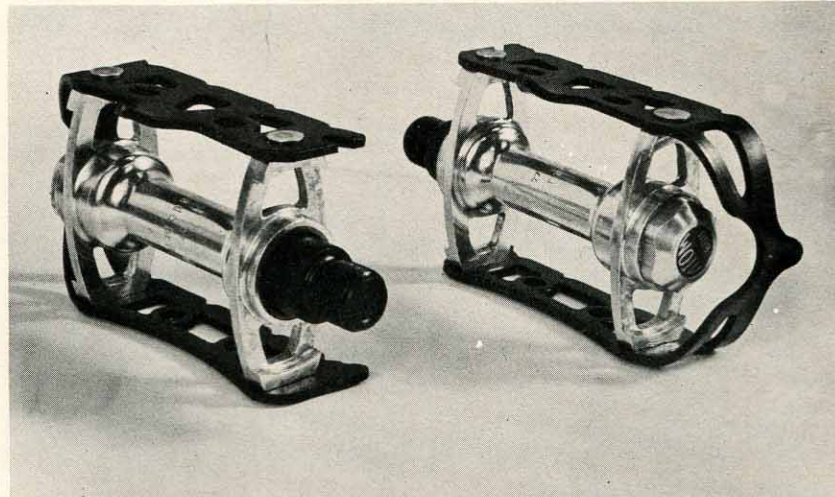

ATOM 600RN

ATOM 440

light alloy rat-trap, chrome pedals with removable reflectors.

Boxed.

Weight: 510 gms.

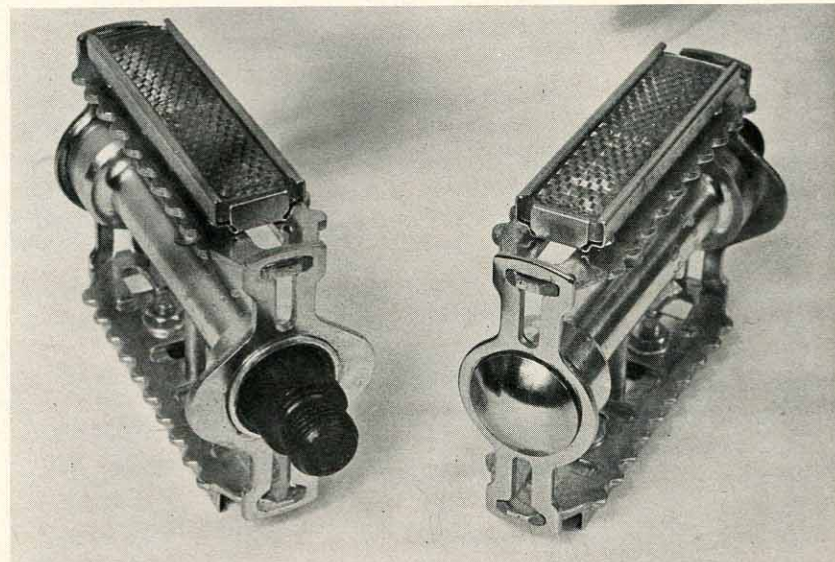

ATOM 440 with Reflectors



Many U.K. manufacturers choose MAILLARD because of the simple method of fitting and removal and because of the trouble-free life of the blocks and sprockets. These blocks are reliable and realistically priced.

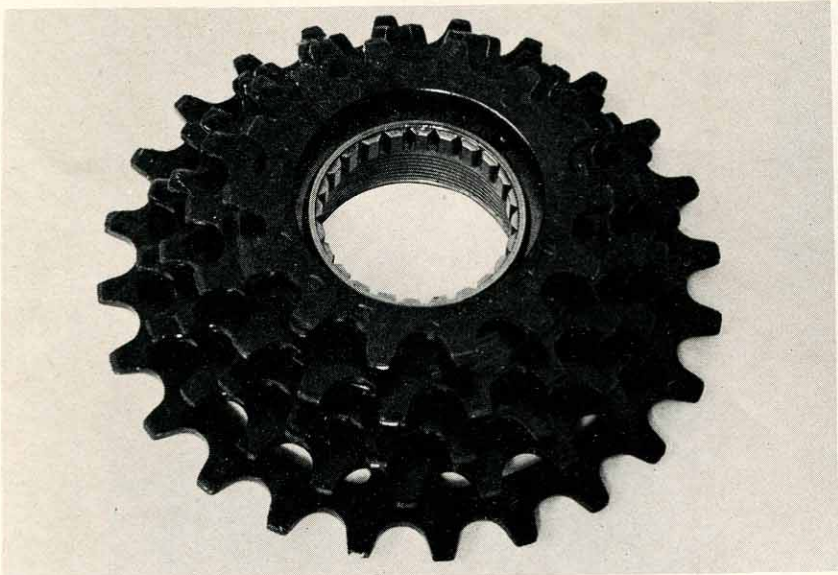

NORMANDY 14-24

ATOM and NORMANDY
FREEWHEEL COMBINATIONS AVAILABLE

14-16-18-20-22

14-16-18-21-24

14-17-20-23-26

14-17-20-24-28

14-17-21-26-32

- * Pawls are often thin and fragile. NORMANDY has wide, reinforced pawls to withstand the strongest stresses of competition.
- * Springs are often formed from thin, rust-prone steel wire. NORMANDY has rust-free, brass, flat springs that perform countless times at full strength.
- * One of the two ball races is often of smaller diameter than the other—the freewheel is unbalanced. NORMANDY's two ball races are of equal, large diameter. They are balanced and effective.

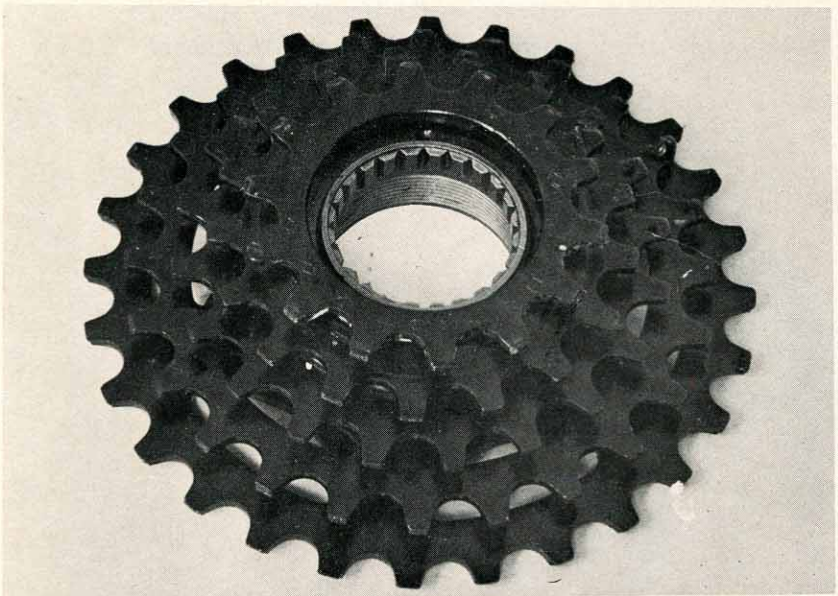

NORMANDY 14-28

- * Loads and stresses are best handled by bearings with a large number of balls. NORMANDY has 90 $\frac{1}{8}$ " precision balls.
- * Removing a freewheel often requires fragile or hard-to-use tools . . . or the removal of a hub nut. NORMANDY has extra-wide interior splines which allow the use of strong and practical tools, without touching the hub nuts.
- * Humidity, mud and dust deteriorate the internal operation of freewheels. NORMANDY undergoes complete and measured greasing with a special long-lasting grease. A watertight impervious seal protects the interior mechanism.



ATOM and NORMANDY Freewheels are attractively packaged in distinctive red boxes. Most have individually interior grease-proof wrappers.

The 407 small-splined and 408 large-splined remover are an essential tool to the retailer and keen cyclist alike. Supplied in blister packs of 5 units.

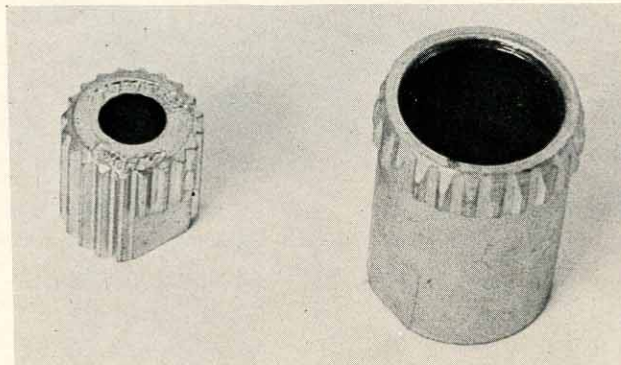

No: 407

No: 408

NEW

Maillard Cog Removing Tool

Like all Maillard products the removing tool is strong and well engineered.

- * Intended for use with all makes of 5- and 6-speed Freewheels.
- * Modern, practical design with good hand-grip affording protection to the sprockets themselves.
- * Essential for quick changes and useful to the cyclist who wishes to utilize the full potential of a Freewheel.

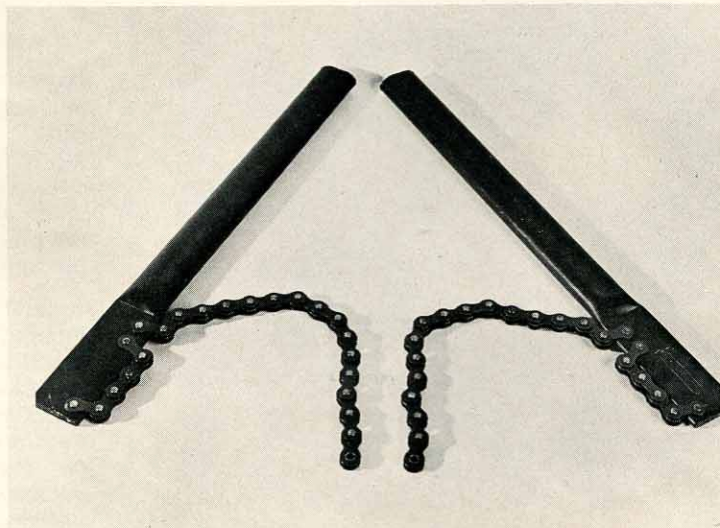



SPARE PARTS FOR MAILLARD SOLID AND QUICK-RELEASE AXLES

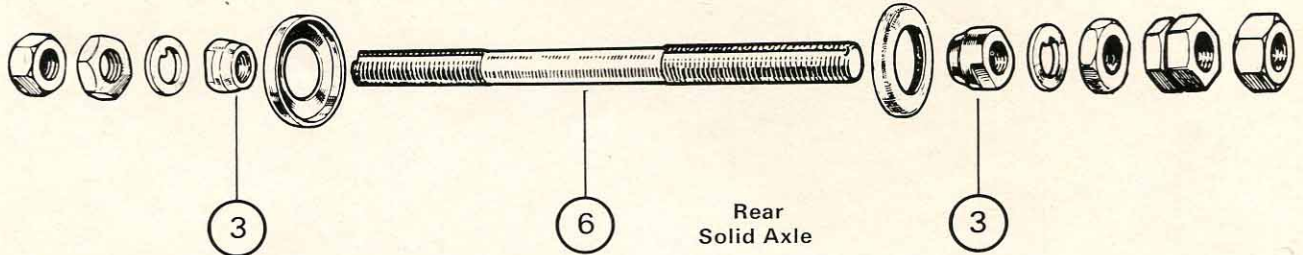
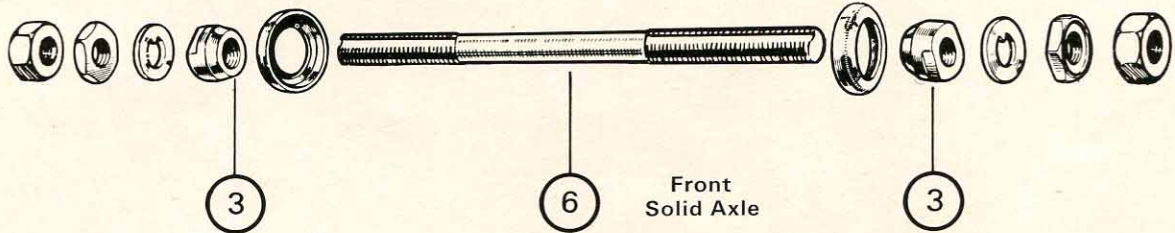



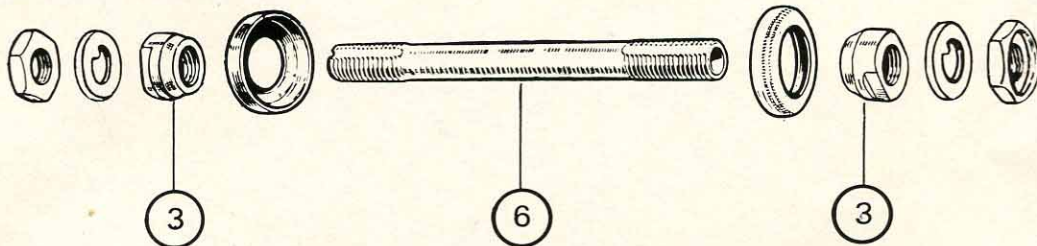

Ref.	Front	Rear	Description
3	3004	3054	Cone
6	3007	3057	Bare axle
-	3010	3062	Complete axle

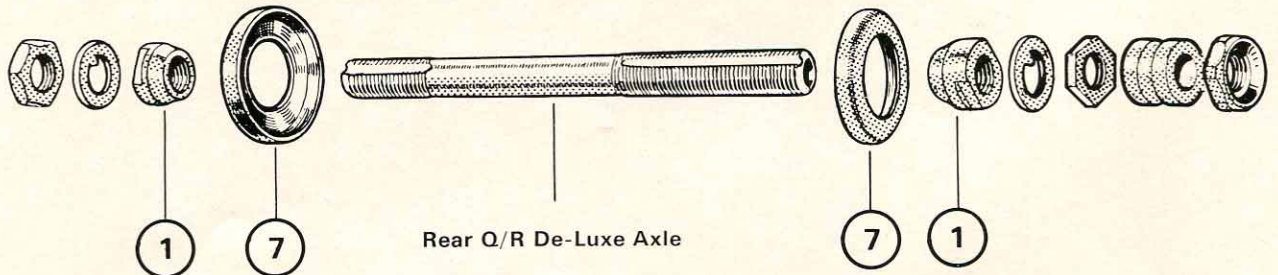
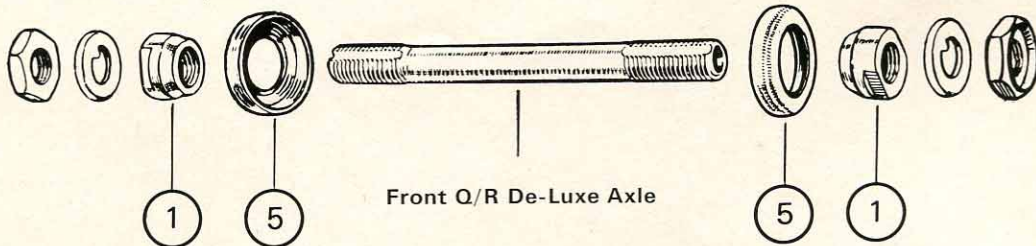

Ref.	Front	Rear	Description
3	3304	3354	Cone
6	3107	3157	Bare hollow axle
-	3110	3162	Complete hollow axle

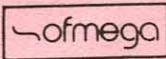

Ref.	Front	Rear	Description
1	3414	3464	Cone (precision ground)
5	3403	-	Red dust cap
7	-	3453	Red dust cap
-	3412	3461	Complete hollow axle

REF	DESCRIPTION	W/S Pack	Trade Price	PER	REF	DESCRIPTION	W/S Pack	Trade Price	PER
	 FREEWHEEL TOOLS					 OFMEGA ALLOY CHAIN RINGS			
406	De Luxe remover	1	5.35	ea		"Super Competition" Outer Rings			
407	Small splined remover	5	1.97	ea		52 Teeth	2	5.00	ea
408	Large splined remover	5	2.47	ea		53 Teeth	2	5.98	ea
	Cog removing tool (set of 2)	set	3.10	set		54 Teeth	2	6.30	ea
						"Competition"/"Gran Premio" Outer Rings			
						49, 50, 51, 52 Teeth	2	4.66	ea
						53 Teeth	2	4.97	ea
						54 Teeth	2	5.31	ea
						Inner Rings for "Super Competition" "Competition" and "Gran Premio" Sets.			
						42, 44, 45 Teeth	2	3.31	ea
						48 Teeth	2	3.65	ea
	 OFMEGA LIGHT ALLOY COTTERLESS CHAINWHEEL SETS					OFMEGA ALLOY CHAINWHEEL SPARES/ACCESSORIES			
1000	"Super Competition" 42/52	set	34.31	set		Replacement Left Hand Cranks			
1100	"Competition" 42/52	set	25.66	set		"Super Competition" and "Competition" and "Gran Premio"	ea	3.50	ea
1200	"Gran Premio" 42/52	set	18.31	set		"Super Corsa" & "Corsa"	ea	2.81	ea
1300	"Super Corsa" 42/52	set	11.25	set		Alloy chain protector	ea	1.98	ea
1400	"Corsa" 42/52	set	10.45	set		Extractor tool - special design	ea	1.39	ea
1920	"Turismo" single 48T	set	12.30	set		Nut, bolt, brace set			
	"Competition" single 48T	set	22.90	set		Black anodised or chrome	set	1.50	set
	OFMEGA LIGHT ALLOY HUBS					Dust Cap	ea	0.20	ea
6000	"Super Competition Q/R				1970	Pedal caps	pr	0.20	pr
	Drillings: 5 spd. 36H				9840	Screws for "Corsa" chainwheels	set	0.40	set
	6 spd. 24,28,32,36H	pr	17.31	pr	107/8				
6100	"Competition" Q/R					OFMEGA STEEL CHAINWHEEL SETS			
	Drillings: 5 spd. 36H					3/32" 42/52T Double 170mm cranks	24	4.25	set
	6 spd. 24,28,32,36H	pr	11.31	pr		3/32" 46 or 48T GCC or NGCC 170mm cranks	24	2.79	set
	Super Competition Q/R Skewers	pr	5.30	pr		1/8" 46 or 48T GCC or NGCC 170mm cranks	24	2.70	set
	Competition Q/R Skewers	pr	3.60	pr		Steel chain protector	ea	0.80	ea
					3950	Steel L/H crank	ea	0.93	ea
	OFMEGA LIGHT ALLOY PEDALS					OFMEGA STEEL HUBS			
9600	Quill, black anodized	pr	3.35	pr		S/F Front	ea	0.60	ea
9650	Quill, silver anodized	pr	5.20	pr		S/F s/s Rear	ea	0.85	ea
						S/F 5/s Rear	ea	0.90	ea
	OFMEGA STEEL HEADSETS w. BALL RACES					Fronts and rears available separately or in pairs			
8000	Nickelled chrome	set	5.75	set		Drillings: Front 28, 32, 36H			
8100	Chrome, part black anodized	set	1.33	set		Rear 28, 36, 40H			
8200	Chrome	10	0.93	set					
8300	Chrome	10	0.61	set					
	OFMEGA BOTTOM BRACKET SETS					 RUSTIN RUBBER PRODUCTS			
7000	"Competition" & "Super Competition"	set	4.70	set	149	"Gran Premio" repair outfit for standard tyres	100	3.30	10
7100	"Gran Premio"	set	2.60	set	2000.5	"Competition" repair outfit for N/S & tubular tyres	100	0.80	ea
7200	"Super Corsa"	set	2.30	set	215/112	Puncture repair aerosole	20	1.55	ea
	OFMEGA BOTTOM BRACKET SPARE PARTS					Extra thick rim tape	25	0.11	ea
	"Competition" axle & bolts	set	3.71	set					
	"Gran Premio" axle & bolts	set	2.05	set					
	"Super Corsa" axle & bolts	set	1.81	set					
	Parts for "Competition" & "Gran Premio"								
	Fixed cup	ea	0.65	ea					
	Adjusting cup	ea	0.65	ea					
	Lock ring	ea	0.28	ea					
	Ball races	pr	0.65	pr					
	Bolts and washers	set	0.28	set					

IceniCAM Information Service

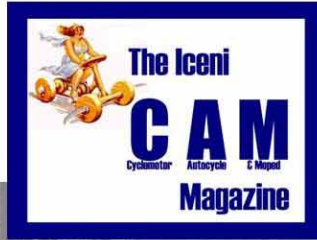

www.icenicam.org.uk