



MODEL RS. 80
TWO STROKE ENGINE
TYPE NUMBERS 3 & 9

SPARE PARTS LISTS
&
ILLUSTRATIONS

SL/O/05 8/58

J. A. PRESTWICH INDUSTRIES LTD.,
CHELMSFORD ROAD,
SOUTHGATE,
LONDON, N.14,
ENGLAND.

Phone : FOX Lane 1101

**MODEL RS.80, TYPE Nos. 3 and 9
ENGINE PARTS LIST**

Illus. No.	Part No.	Description	Qty.
1	22380	Cylinder Head	1
2	18315	Cylinder Head Bolt Washer	3
3	21864	Cylinder Head Fixing Bolt	1
4	22325	Cylinder Head Fixing Bolt—Special Head	2
5	20737	Cylinder Head Gasket	1
6	22294/5	Cylinder Barrel	1
7	20312	Cylinder Base Gasket	1
8	21865	Cylinder Base Fixing Nut	4
9	20941	Exhaust Flange Gasket	1
10	SA.3498	Exhaust Pipe Assembly	1
11	22543	Exhaust Pipe Fixing Screw	2
12	20504	Inlet Pipe Gasket	1
13	20976	Inlet Pipe Fixing Stud	2
14	22295/1	Inlet Pipe	1
15	21865	Inlet Pipe Fixing Nut	2
16	14939	Inlet Pipe Fixing Washer	2
—	22516/2	Carburettor—Amal 379/13 (See Carburettor Parts List, pages 7 and 8)	1
17	22299	Piston with Ring Pegs	1
18	20751	Piston Ring	2
19	20301	Piston Gudgeon Pin	1
20	18533	Piston Gudgeon Pin Circlip	2
—	SA.3460/21	Crankshaft and Conrod Assembly (Includes items Nos. 21 to 26)	1
21	SA.2867/1	Conrod with Small End Bush	1
22	20291/1	Conrod Bush—Small End	1
23	22478/1	Crankshaft—Magneto Side	1
24	20758/5	Crankshaft—Drive Side	1
25	22479/1	Crankpin	1
26	5619	Conrod Roller—Big End	11
27	16668	Crankshaft Key—Drive Side	1
28	20948	Crankshaft Nut—Drive Side	1
29 & 30	SA.3292	Crankcase Assembly, complete with Drain Plug, 2 Oil Seals, 1 "Oilite" Bush, 1 Magneto Side Ball Bearing, 4 Cylinder Fixing Studs, 4 Drive Side Flange Studs, 4 Clamping Studs, 1 Clamping Nut—Note: Crankcase Halves not supplied separately	1
31	20547	Crankcase Oil Seal—Magneto Side	1
32	20940	Crankcase Oil Seal—Drive Side	1
33	18337	Crankcase Ball Bearing—Magneto Side	1
34	21987	Crankcase "Oilite" Bush—Drive Side	1
35	21866	Crankcase Stud—Cylinder Fixing	4
36	20946	Crankcase Flange Stud—Drive Side	4

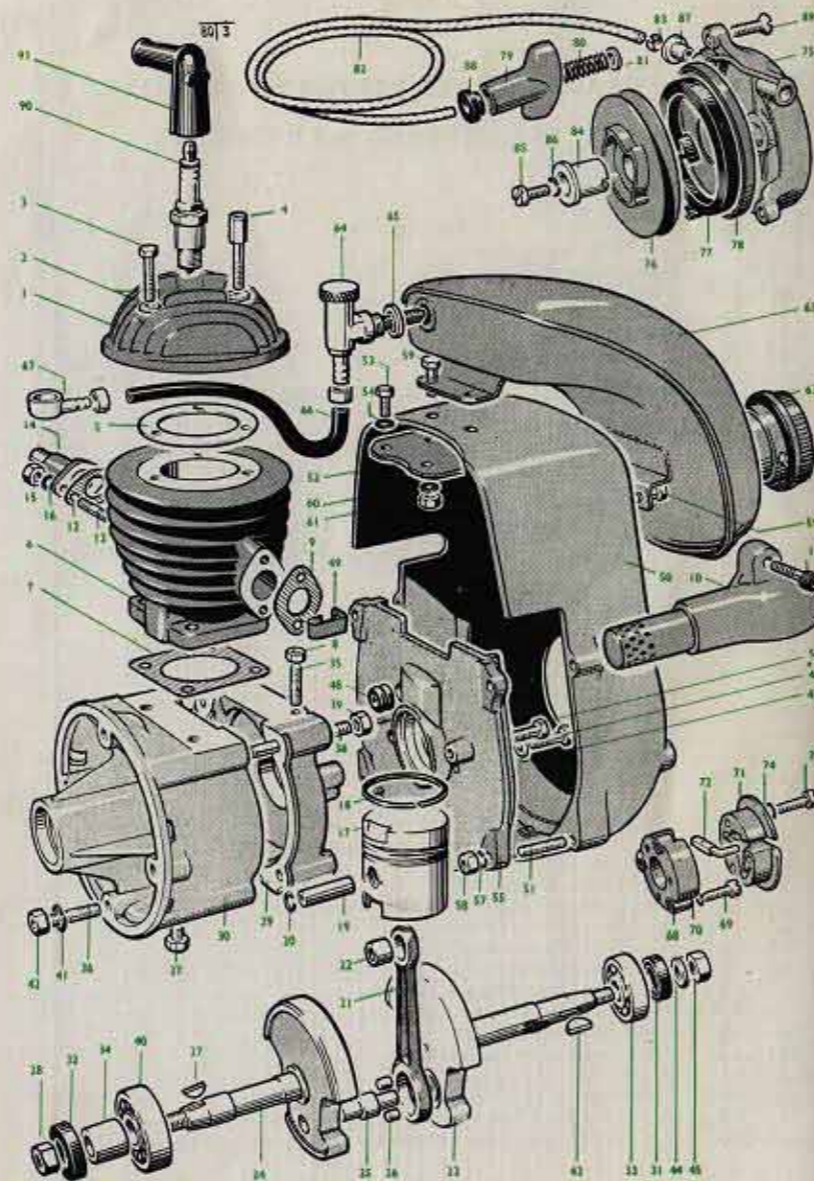

**MODEL RS.80, TYPE Nos. 3 and 9
ENGINE PARTS LIST—continued**

Illus. No.	Part No.	Description	Qty.
37	21863	Crankcase Drain Plug	1
38	21868	Crankcase Clamping Stud	4
39	21867	Crankcase Clamping Stud Nut	4
40	18753	Crankcase Ball Bearing—Drive Side	1
41	18321	Crankcase Flange Stud Washer—Drive Side	4
42	21867	Crankcase Flange Stud Fixing Nut—Drive Side	4
43	21228	Magneto Fixing Key	1
—	20529	Magneto—see Illustration on page 6	1
44	20537	Magneto Fixing Washer	1
45	284	Magneto Fixing Nut	1
46	20550	Magneto Back Plate Screw	2
47	20933	Magneto Back Plate Screw Washer	2
48	14413	Magneto H.T. Cable Grommet	1
49	14414	Magneto H.T. Cable Clip	1
50	SA.3479	Cowl Assembly with Fixing Studs	1
51	21866	Cowl Fixing Stud	4
52	22506	Cowl Top Fixing Plate	1
53	20984	Cowl Top Fixing Plate Screw	2
54	18320	Cowl Top Fixing Plate Washer	2
55	22088	Cowl Back Plate	1
56	22571	Cowl Back Plate Fixing Screw	1
—	14939	Cowl Back Plate Fixing Washer	1
57	18320	Cowl Fixing Stud Washer	4
58	21865	Cowl Fixing Stud Nut	4
59	20943	Fuel Tank Fixing Screw	4
60	18320	Fuel Tank Fixing Washer	4
61	21865	Fuel Tank Fixing Nut	4
62	SA.3366	Fuel Tank with Cap and Washer	1
63	SA.3367	Fuel Tank Cap and Sealing Washer	1
—	22284	Fuel Tank Cap Sealing Washer	1
64	21375	Fuel Tap	1
65	18317	Fuel Tap Washer	2
66	22484	Fuel Pipe	1
—	21906	Fuel Pipe Ferrule	2
67	21929	Fuel Pipe Banjo	1
90	18593	Sparking Plug	1
91	22349	Sparking Plug Protector and Suppressor	1
—	14967	Sparking Plug Spanner	1
—	16811	Spanner Tommy Bar	1
—	22363	Engine Instruction Transfer	1
—	22041	Magneto Extractor Plate—Special to order	1
—	20184	Magneto Extractor Plate Screw—Special to order	1
—	20996	Magneto Extractor Plate Fixing Screw—Special to order	3

**MODEL RS.80, TYPE Nos. 3 and 9
RECOIL STARTER SPARE PARTS LIST**

Illus. No.	Part No.	Description	Qty.
68	20974	Starter Plate Distance Piece	1
69	20996	Starter Plate Distance Piece Fixing Screw	3
70	18320	Starter Plate Distance Piece Fixing Washer	3
71 & 72	SA.3389/2	Starter Plate Assembly includes Spring, Drive Peg and Drive Screw	1
72	20968/1	Starter Plate Driving Peg	1
73	22046	Starter Plate Fixing Screw	3
74	22568	Starter Plate Fixing Washer	3
—	SA.3518/3	Starter Body Assembly includes items 75 to 88	1
75	20965/2	Starter Body	1
76	SA.3561	Starter Pulley Assembly	1
77 & 78	SA.3542	Starter Return Spring Assembly	1
—	22059	Starter Body Drive Screw	1
79	22561	Starter Handle	1
80	22551	Starter Handle Spring	1
81	20997/2	Starter Rope Bush	1
82 & 83	SA.3554	Starter Rope Assembly	1
84	22549	Starter Pulley Bush	1
85	20937	Starter Pulley Bush Screw	1
86	18320	Starter Pulley Bush Screw Washer	1
87	20997	Starter Rope Guide Bush	1
88	22560	Starter Handle Rubber Washer	1
89	22475	Starter Mounting Screw	3
—	22474	Starter Mounting Screw Washer	3
—	20717	Starter Instruction Transfer	1

It is essential to quote Engine Number with all symbols when ordering spares owing to the different Engine parts fitted to various customers' equipment. Failure to do this may result with incorrect spares being supplied. The Engine Number and symbols are stamped on the bottom of the Drive Side Half Crankcase.

Customer's patterns not returned unless specially requested.

FW 1269Z

SPARE PARTS LIST

UNITS	ASSEMBLIES	COMPONENTS	PARTS IN EXPLODED VIEW
90315 Magnet Unit		02891 Flashed Key	
92288 Breaker Cam Unit	92911 Breaker Cam Spring		
	92183 Breaker Cam		
X33445 Breaker Plate Unit	94706 Sensitized Spring Set		
	94707 Breaker Point Set	94708 Breaker Point Spring Set	
		94709 Breaker Point Gross Includes Gross Part 91181	
	94710 Coil and Primary Lead Spring Set		
	94711 Saddle Plate and Core Assembly		
94981 H.T. Coil Set			
97219 H.T. Lead Unit (187)			

MAGNETO ILLUSTRATION

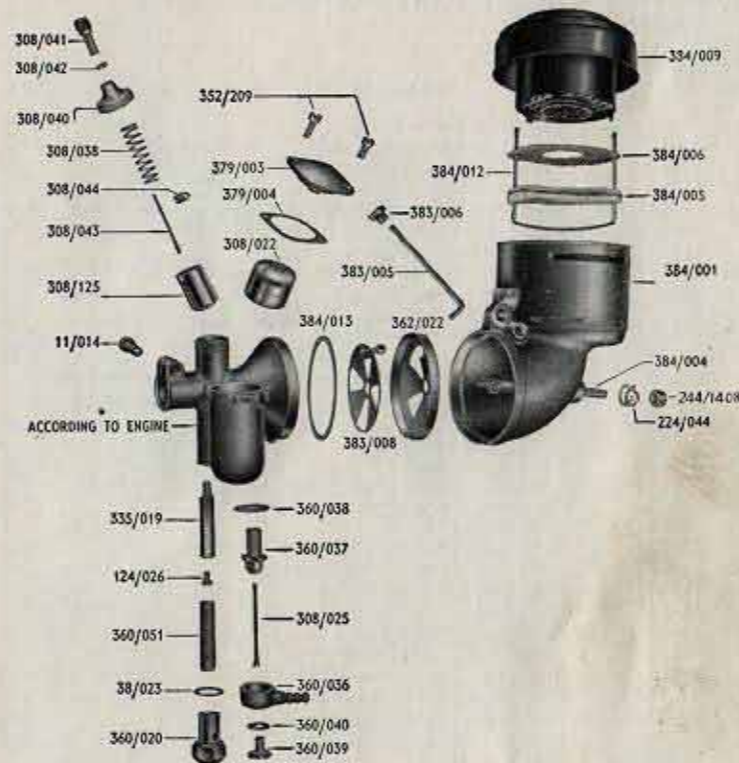

AMAL 379/13 CARBURETTER ILLUSTRATION

AMAL 379/13 CARBURETTER PARTS LIST, AS FITTED TO
MODEL RS.80, TYPES 3 and 9 ENGINES

Part No.	Description	No. off
379/005	Carburetter Body	1
308/022	Float Complete	1
308/025	Float Needle	1
360/037	Needle Seating	1
360/038	Needle Seating Washer	1
360/036	Banjo	1
360/040	Banjo Washer	1
360/039	Banjo Bolt	1
379/003	Float Chamber Cover	1
379/004	Float Chamber Cover Washer	1
352/209	Float Chamber Cover Screw	2
308/043	Metering Needle	1
308/044	Metering Needle Clip	1
335/019	Needle Jet -0745"	1
124/026	Main Jet No. 35 (State Jet No. when ordering)	1
360/051	Petrol Filter	1
360/020	Jet Plug	1
38/023	Jet Plug Washer	1
308/125	Throttle Valve No. 3	1
308/038	Throttle Valve Spring	1
308/040	Mixing Chamber Top	1
308/041	Throttle Cable Adjuster	1
308/042	Throttle Cable Adjuster Locknut	1
360/077	Throttle Cable Spring Sheath	1
244/1400	Throttle Cable complete—48" length	1
355/2	Throttle Control Lever Assembly, with $\frac{3}{8}$ " Clip	1
11/014	Outlet Clamp Screw	1
384/1	Air Filter complete	1
384/001	Air Filter Body	1
384/004	Air Filter Centre Stud	1
224/044	Air Filter Centre Stud Washer	1
362/022	Air Filter Centre Cover	1
383/008	Air Filter Shutter Assembly	1
383/005	Air Filter Operating Rod	1
383/006	Air Filter Operating Rod Guide	1
244/1408	Air Filter Centre Stud Locknut	1
384/013	Air Filter Seal Washer	1
384/012	Air Filter Gauze Extractor	1
384/005	Air Filter Felt Pad	1
384/006	Air Filter Felt Pad Gauze	1
384/009	Air Filter Pack Assembly	1
384/010	Air Filter Instruction Transfer	1

IceniCAM Information Service



www.icenicam.org.uk