

SAFARI-Moped

with Sachs Motor

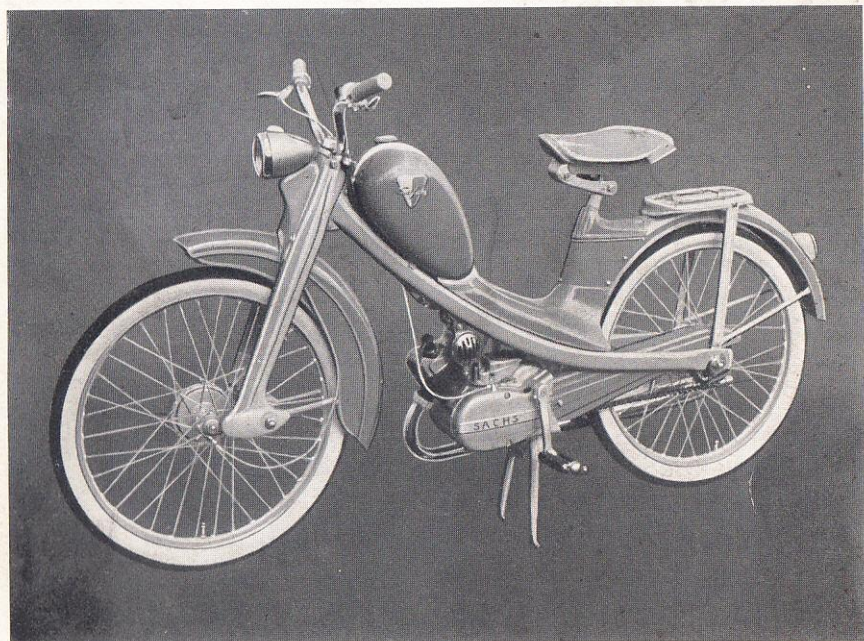

Spare Parts List and Price List 59



GEIER-WERKE

GMBH



Manufacturers of Bicycles and Motorcycles

Lengerich (Westfalen) - Germany

Sole concessionaires for United Kingdom
STUART & PAYNE LTD
London

Pict. and Article No.	pes per Moped	Description	Price per pes. £
1	1	Frame, skeleton, grey enamelled	£ 11.19.6.
2	1	Centre stand, grey	£ 1. 2.2.
3	1	Bolt for centre stand, complete	1/2
4	1	Kickstand spring	8 d
5	1	Fork, grey enamelled	£ 4.17.9.
6	1	Headlamp bracket	7/3
7	1	Upper fork bridge, complete with rubber socket and screw	6/9
8	1	Handlebar bridge	4/3
9	1	Nut for steering set	1/10
10	1	Snug disc	6 d
11	1	Upper steering cone	1/8
12	1	Upper steering shell	1/2
13	1	Lower steering shell	1/2
14	1	Lower fork cone	8 d
15	2	Ballrings	8 d
16	2	Rocker arms, front fork	12/2
17	2	Pressure spring, front fork	1/2
18	2	Rubber shock absorber, front fork	2/1
19	1	Rocker arm axle, left complete with disc and nut	7 d
20	1	Rocker arm axle, right complete with disc and nut	7 d
21	4	Bearing cone, nylon	11 d
22	1	Cover for tool box, blue or red	9/10
23	1	Tool box, blue or red	11/5
24	1	Engine fairing, between toolbox & tank	£ 1.16.8.
25	1	Rubber stop for cover No. 24	3/9
26	1	Front mudguard, blue or red	17/9
27	1	Rear carrier with springs, grey enamelled	19/2
28	2	Stay for carrier No. 27	10/6
29	1	Rear mudguard, blue or red	£ 1.3.6.
30	1	Stay for rear mudguard	7/8
31	1	Chain guard, blue or red	14/8
32	1	Rear light, complete	7/8
32 a	1	Bulb for rear light 6 volt/2 watt (not illustrated)	5/10 plus 1/-

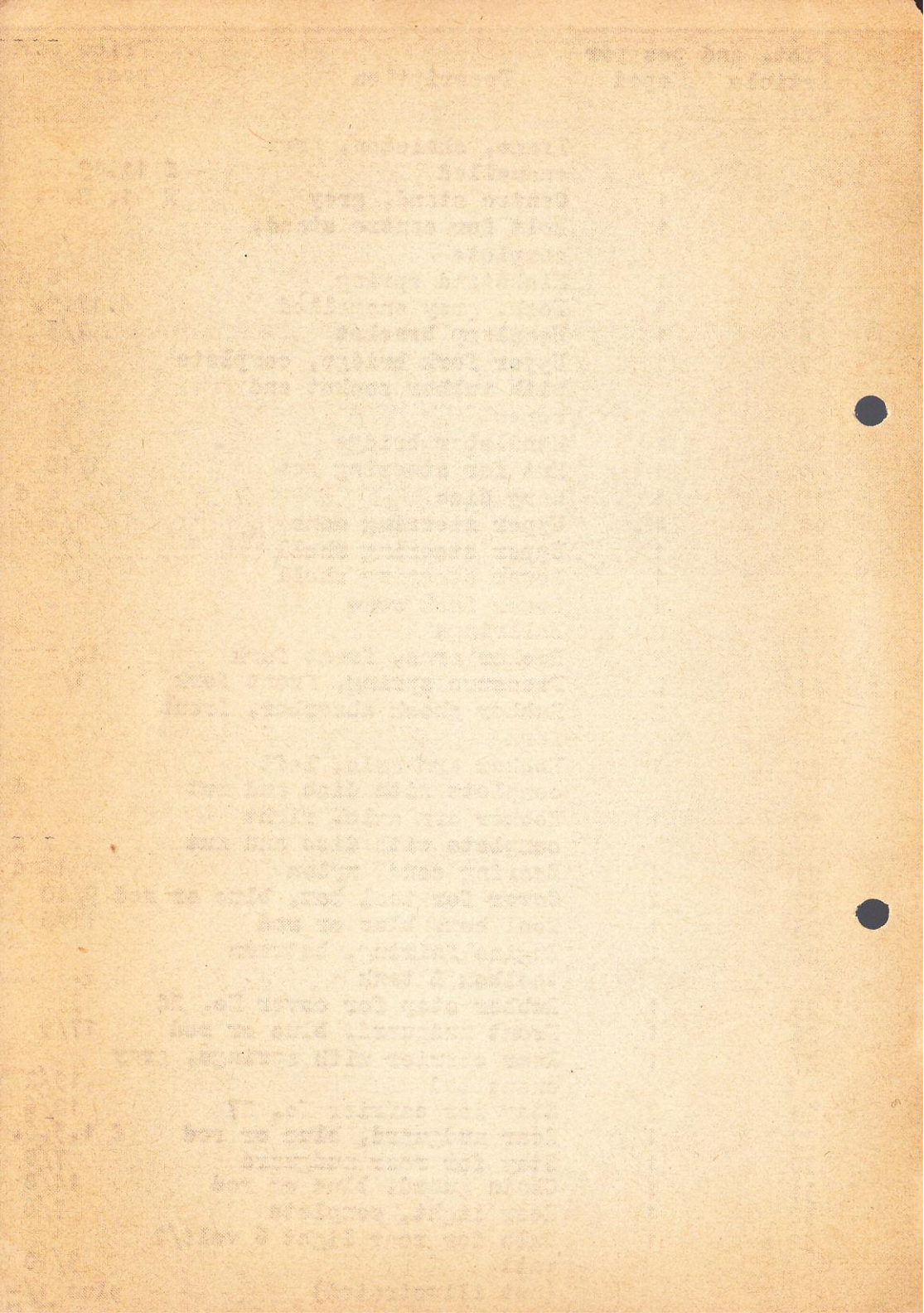

Pict. and Article No.	pes per Moped	Description	Price per pes. £
33	1	Screw M 8 x 50	6 d
34	1	Screw M 8 x 50	6 d
35	1	Distance roller	1/2
36	1	Screw M 6 x 50	6 d
37	1	Screw M 8 x 50	6 d
38	1	Engine holder complete, M 8 x 85	2/1
39	1	Saddle complete	£ 1.16.-.
40	1	Saddle pillar	4/2
40 a	1	Screw and clamp for Saddle pillar	1/6
41	1	Petrol tank, with "Safari", blue or red	£ 4.2.-.
42	1	Ornamental cleat for petrol tank	4/8
43	1	Tension hook with rubber disc	6 d
44	2	Rubber buffer for petrol tank	11 d
45	1	Fuel tap	9/6
46	1	Fuel pipe	8 d
47	1	Tank cap	1/9
48	1	Handlebar bend	£ 1.2.10.
49	1	Gear twist grip, complete, II speed	£ 1.1.-.
49 a	1	Gear twist grip, complete, III speed (not illustrated)	£ 1.1.-.
50	1	Accelerator twist grip, complete	16/-
51	1	Lever for decompression valve	3/9
52	1	Bell (not applicable)	3/3
53	1	Electric horn	£ 1.-.6.
54	1	Button for electric horn	3/-
55	1	Headlamp complete with bulb	£ 1.6.2.
55 a	1	Bulb 15 watt with retainer	5/10
55 b	1	Reflector	4/4
55 c	1	Glass for reflector	1/.10.
55 d	1	Chromiumring for reflector	7/.4.
56	1	Speedometer head with holder and scale for miles	£ 2.6.7.
57	1	Speedometer cable	8/9
58	1	Speedometer drive	19/7
59	1	Pedal righthand	7/8
59 a	1	Pedal lefthand	7/8
60	1	Exhaust pipe	18/2
61	1	Engine chain 1"3 x 1/4 95 links with spring link	10/6

1. ...
2. ...
3. ...

4. ...
5. ...
6. ...

7. ...
8. ...
9. ...

10. ...
11. ...
12. ...

13. ...
14. ...
15. ...

16. ...
17. ...
18. ...

19. ...
20. ...
21. ...

22. ...
23. ...
24. ...

25. ...
26. ...
27. ...

Pict. and Article No.	pes per Moped	Description	Price per pes. £
62	1	Brake rod complete	7/6
63	1	Pump	4/8
64	1	Cable for gear control II-speed	5/9
64 a	1	Cable for gear control III-speed	5/9
64 b	1	Cable for throttle control	2/7
64 c	1	Cable for clutch control	3/7
64 d	1	Cable for front brake	3/3
65	1	Tool box, plastic	2/1
66	1	Rear wheel less tube and tyre	£ 5.16.5.
66 a	2	Rim, grey enamelled (not illustrated)	14/3
67	1	Front wheel less tube and tyre	£ 4.5.10.
68	1	Rear hub complete	£ 3.15.2.
68 a	1	Rear axle with cones and nuts	11/2
68 b	1	Axle only	5/-
68 c	2	Cones for axle	1/-
68 d	2	Shells, right and left	1/-
68 e	2	Dust caps	1/-
68 f	20	Balls 1/4"	3 d
69	1	Front hub complete	£ 2.1.4.
69 a	1	Front axle with cones and collarnuts	£ 1.1.3.
69 b	2	Front hub cups	1/-
69 c	22	Balls 1/4"	3 d
70		Spokes and nipples	
70 a	18	Front wheel spokes and nipples left, 2.34 x 211	4 d
70 b	18	Front wheel spokes and nipples right, 2.34 x 224	4 d
70 c	18	Rear wheel spokes and nipples left, 2.34 x 213	4 d
70 d	18	Rear wheel spokes and nipples right, 2.34 x 218	4 d
71	1	Chain wheel 1/2 x 1/4, 28 teets for rear wheel	18/2
71 a	6	Screws M 6 x 15 with nuts for chain wheel No. 71	6 d
72	1	Front hub brake plate	11/6
72 a	1	Front hub lever for brake plate	1/5
72 b	1	Front hub cam for brake plate	3/-

Article no.	Description	Quantity	Price	Total
1	Cable for gear control	1
2	Cable for gear control	2
3	Cable for clutch control	1
4	Cable for front brake	1
5	Cable for front brake	1
6	Cable for front brake	1
7	Cable for front brake	1
8	Cable for front brake	1
9	Cable for front brake	1
10	Cable for front brake	1
11	Cable for front brake	1
12	Cable for front brake	1
13	Cable for front brake	1
14	Cable for front brake	1
15	Cable for front brake	1
16	Cable for front brake	1
17	Cable for front brake	1
18	Cable for front brake	1
19	Cable for front brake	1
20	Cable for front brake	1
21	Cable for front brake	1
22	Cable for front brake	1
23	Cable for front brake	1
24	Cable for front brake	1
25	Cable for front brake	1
26	Cable for front brake	1
27	Cable for front brake	1
28	Cable for front brake	1
29	Cable for front brake	1
30	Cable for front brake	1
31	Cable for front brake	1
32	Cable for front brake	1
33	Cable for front brake	1
34	Cable for front brake	1
35	Cable for front brake	1
36	Cable for front brake	1
37	Cable for front brake	1
38	Cable for front brake	1
39	Cable for front brake	1
40	Cable for front brake	1
41	Cable for front brake	1
42	Cable for front brake	1
43	Cable for front brake	1
44	Cable for front brake	1
45	Cable for front brake	1
46	Cable for front brake	1
47	Cable for front brake	1
48	Cable for front brake	1
49	Cable for front brake	1
50	Cable for front brake	1

Handwritten notes and signatures on the left margin.

Pict. and Article No.	pes per Moped	Description	Price per pes. £
73	1	Rear hub brake plate	11/6
73 a	1	Rear hub lever for brake plate	3/11
73 b	1	Rear hub cam for brake plate	5/6
74	1	pair Brake shoe with brake lining for front and rear	12/3 p. pair
74 a	2		
75	4	Brake shoe spring	6 d
76	2	Cover 23 x 2.00 white-wall	£ 1.10.6.
77	2	Tube with Schrader-valve 23 x 200, white-wall Tyre cover	8.6.
78	2	Rim tape 23"	8 d
79	1	Stay for front mudguard, grey enamelled	7/8



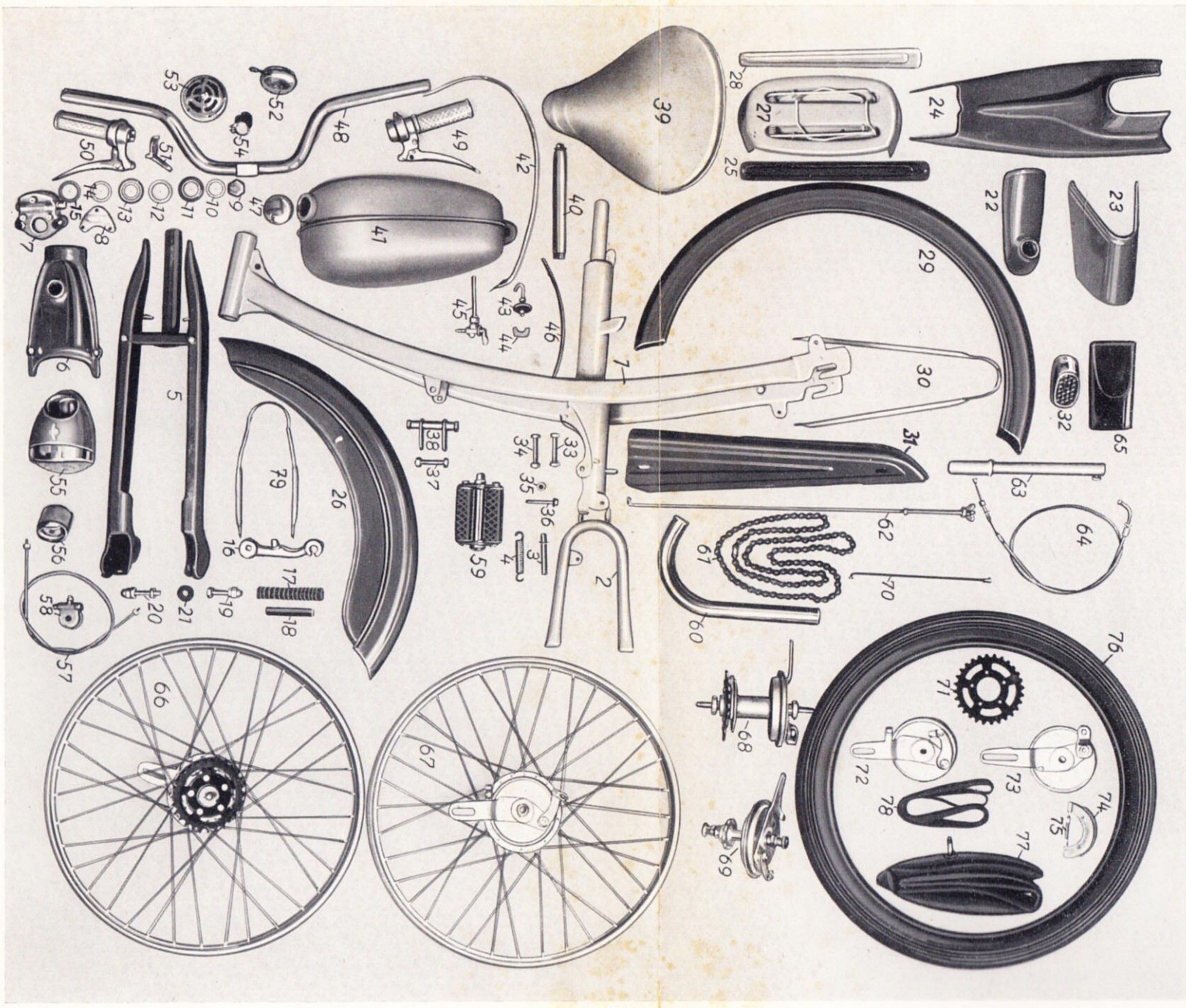

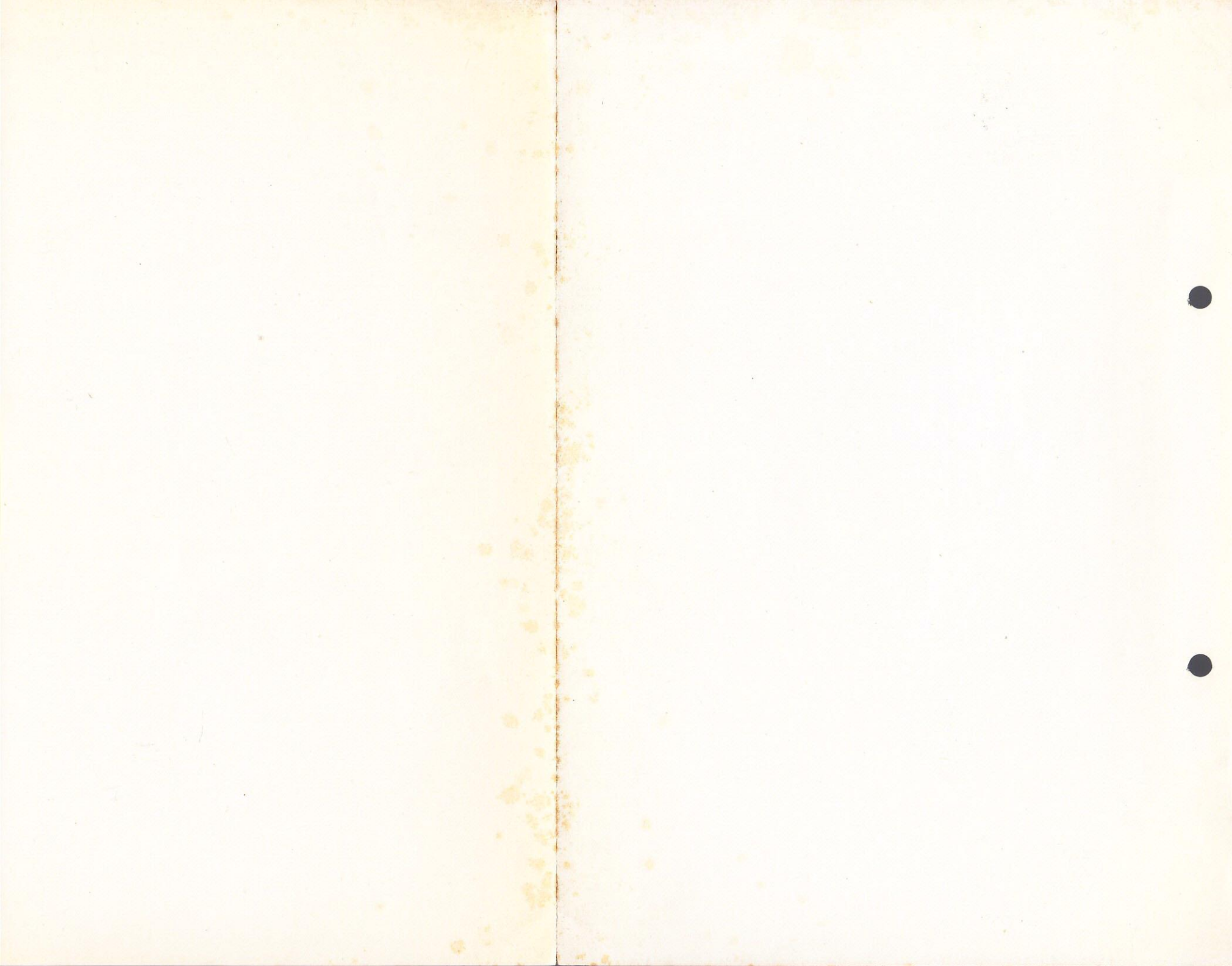





IceniCAM Information Service

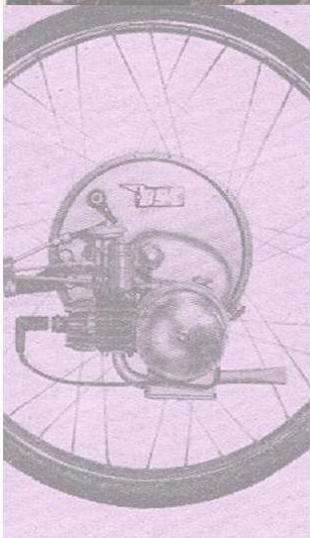

www.icenicam.org.uk