

IceniCAM Information Service

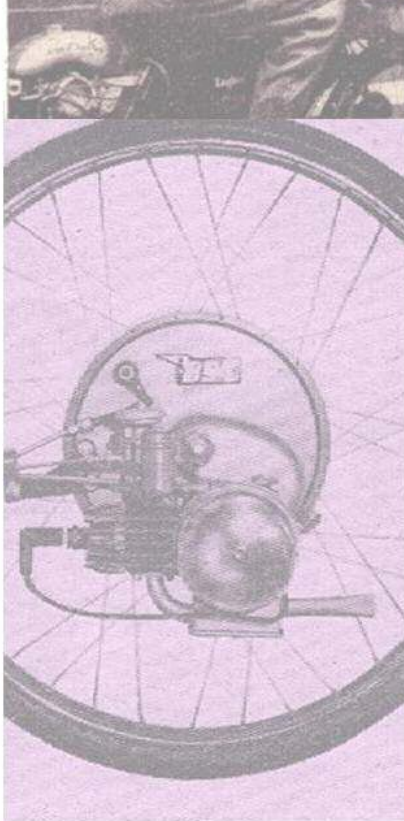

www.icenicam.org.uk

B0323K

SPARE PARTS CATALOGUE

FOR

Berini

bicycle engine



MANUFACTURED BY:

N.V. MOTORENFABRIEK PLUVIER

THE HAGUE HOLLAND

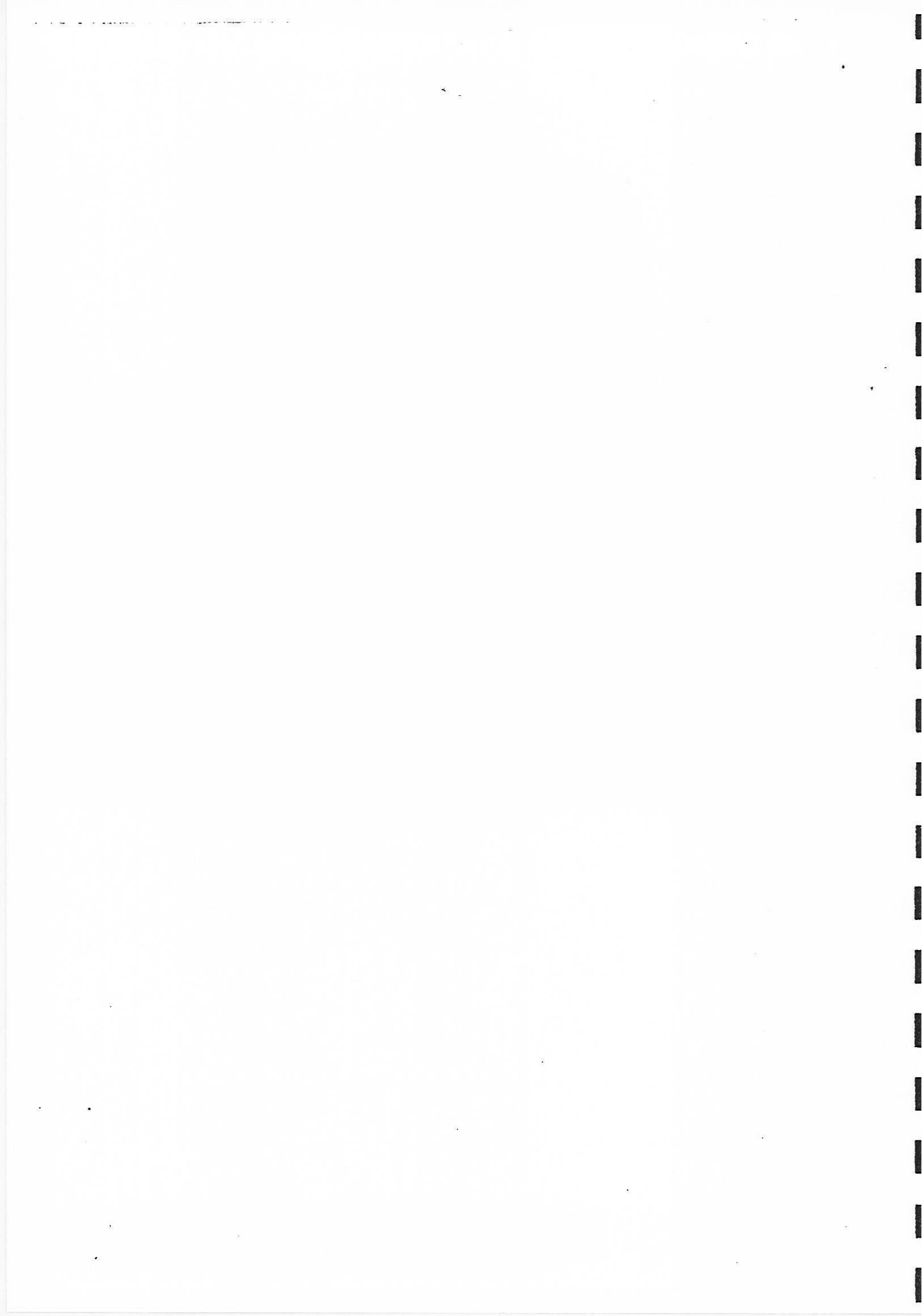

I M P O R T A N T

To obtain the best results of the 'Berini' engine, original 'Berini' spare parts should always be used.

In case of ordering spare parts from this catalogue, and to ensure the quickest way of delivery, we advise agents in their personal interest to pay particular attention to the following directions:

1. Orders should be addressed to:

2. State engine number.
3. Required number of parts.
4. Correct part number.
5. Way of delivery: sample without value, parcel post or airmail. Transport risks for account of consignee. Any complaints should be made within 8 days from receipt of the parts and must be accompanied by our packing chit.
6. Full postal address to avoid delay.
7. When sending parts to be exchanged, label with exact address of sender and advice should be attached and letter enclosed.
8. When making further inquiries, always mention the respective order number.
9. If parts sent as specimen are to be returned; this must be clearly stated on label and in accompanying letter. Otherwise used parts will irrevocably be scrapped.
10. Place of payment and delivery: The Hague, Netherlands.
11. If a spare part is forwarded for overhaul, it must have a label showing the address of sender and the particulars of the overhaul to be carried out.
12. Orders for spare parts must not be incorporated in other correspondence, but kept separate in order to expedite rapid delivery.

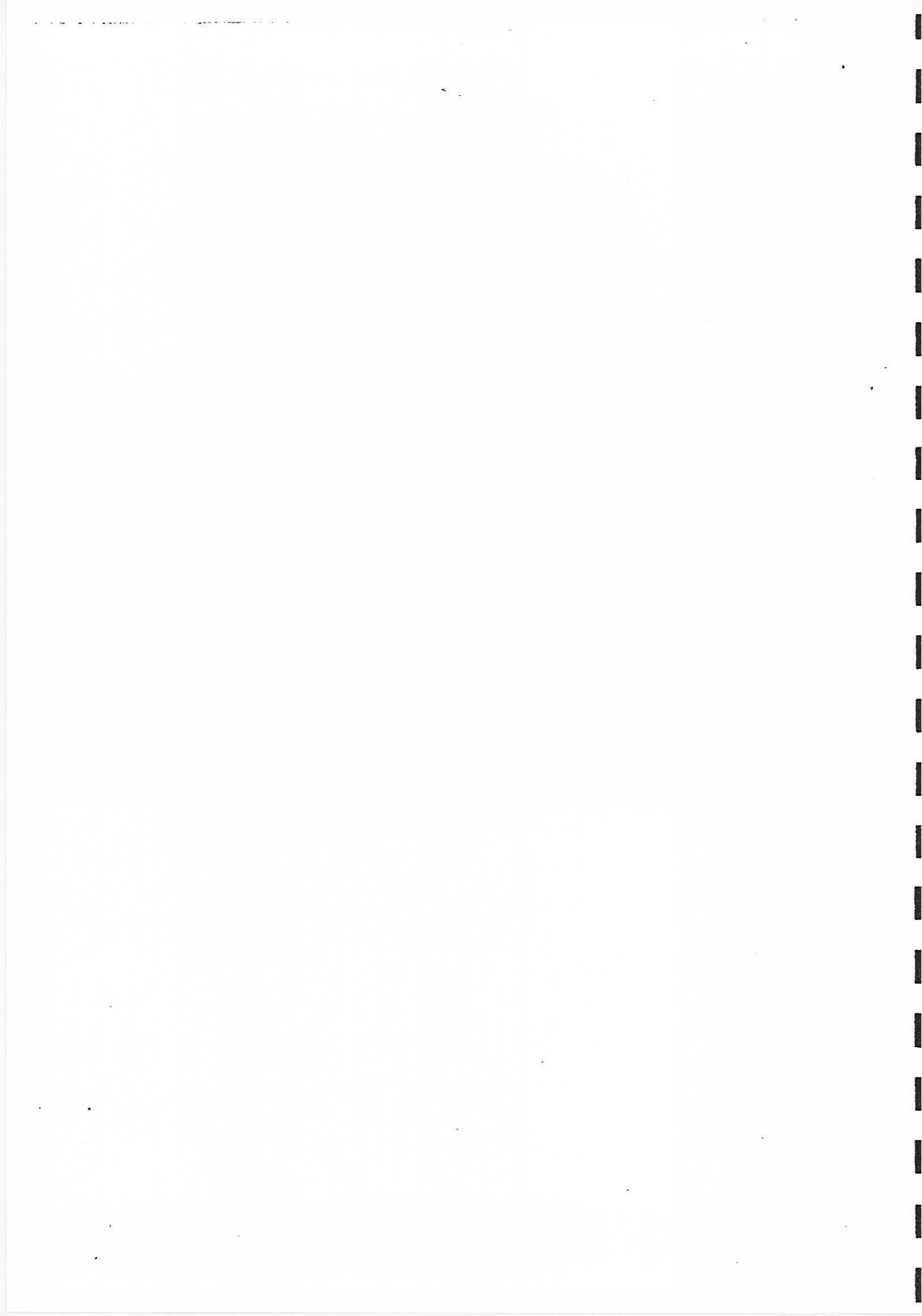

T A B L E O F C O N T E N T S

Crankcase	1
Cylinder and crankshaft	2
Carburettor	3
Ignition	4
Tank, mudguard and exhaust.	5
Clutch	6
Motor attachment	7

In the list of spare parts under the heading of CRANKCASE you will find for instance the following lines:

8	Screw for:			
	Crankcase cover No.3		3	
	Ignition base-plate No.112		2	5

This means that 8 is the spare part number of the screws which are used to fix both the crankcase cover No. 3 and the ignition base-plate No.112.

In the column under 'quantity' one finds that three screws No. 8 are required for the crankcase cover and two for the ignition base-plate.

For simplicity's sake the 'total' column shows that in all there are five of these screws No. 8 in the Berini motor.

CRANKCASE

1

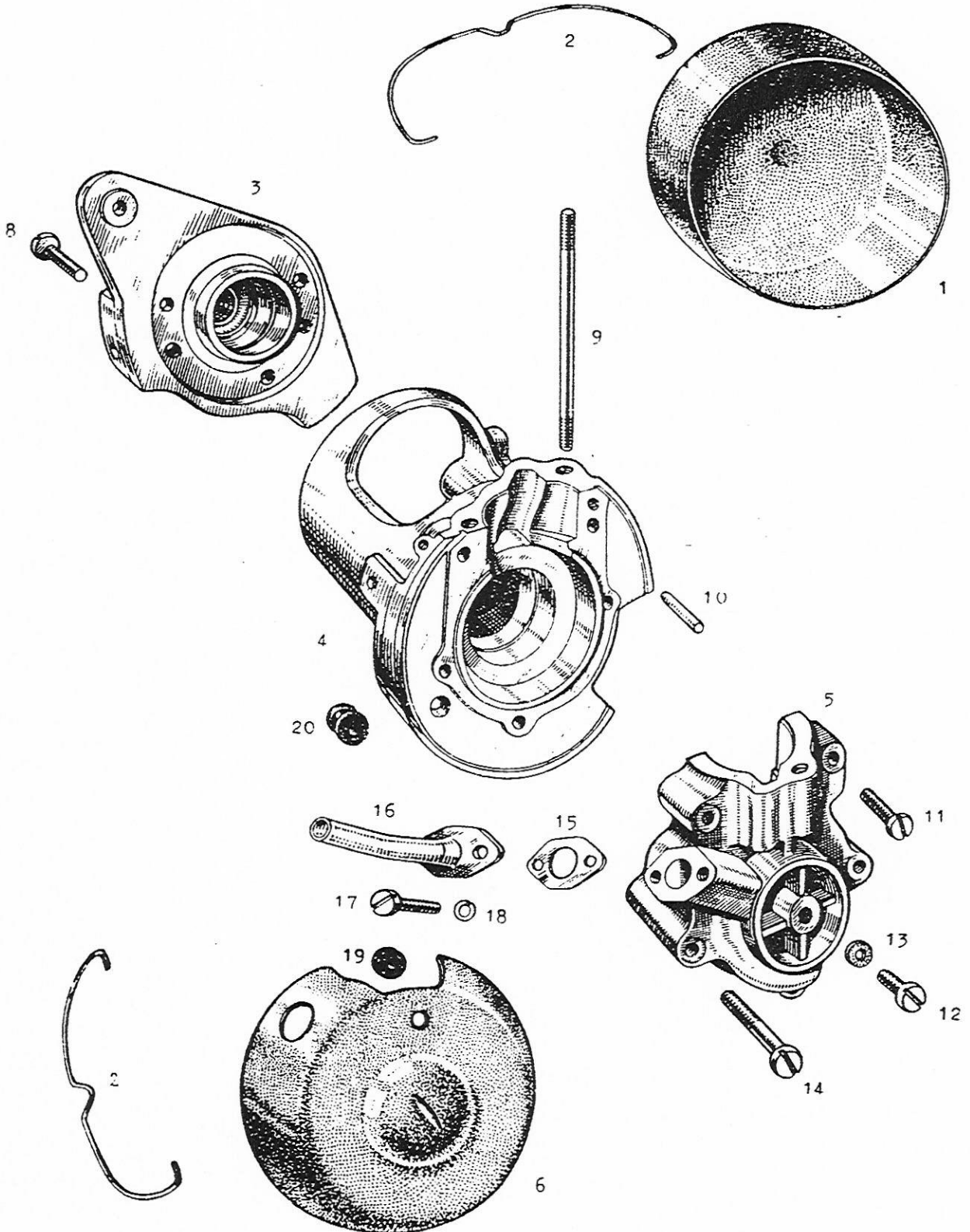

CRANKCASE

1

Spare Part Number	Description of spare part (type M.13)	Quantity	Total	Remarks
1	Flywheel cover	1		
2	wire spring for: flywheel No.1	1		
	ornamental cover No.6	1	2	
3	crankcase cover	1		
4	left half of crankcase	1		
5	right half of crankcase	1		
6	ornamental cover	1		
8	screw for: crankcase cover No.3	3		
	ignition base-plate No.112	2	5	
9	cylinder-stud	3		
10	locating pin	1		
11	crankcase screw	4		
12	screw in cross piece of right half of crankcase No.5	1		
13	fibre-ring for screw No.12	1		
14	crankcase screw	1		
15	intake gasket	1		
16	intake pipe	1		
17	screw for intake	2		
18	spring washer for: screw No.17	2		
	bolt No.144 for exhaust flange	2		
	bolt No.205	3		
	clamping screw No.162 for exhaust	2	9	
19	rubber protection ring in orna- mental cover No.6	1		
20	rubber protection ring in left half of crankcase No.4	1		
21	Gasket for crankcase halves 4 + 5	1		

CYLINDER AND CRANKSHAFT

2



29



30



31



32



33

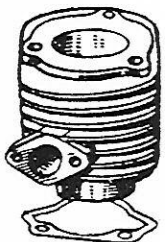

34

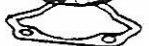

35



36



39



38



37



40

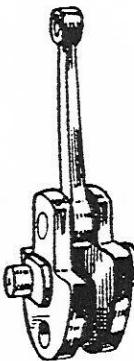

41



48



45



46



47



49

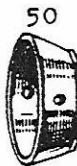

50



51



50



52



53



54



55



42



42



43



44



56



57



58

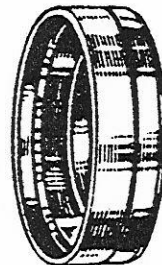

59



60



61

CYLINDER AND CRANKSHAFT

2

Spare Part Number	Description of spare part (type M.13)	Quantity	Total	Remarks
Cylinder				
28	Sparking plug KLG 50	1		
29	Sparking plug KLG 70	1		
30	nut for: cylinder head No.33	3		
	spring bolt No.171	1		
	swivel bolt No.177	1		
	bolt No. 197	1	6	
31	spring washer for: bolt No.30 of cylinder head	3		
	spring bolt No.171	1		
	swivel bolt No.177	1	5	
32	plain washer for: nut No.30 of cylinder head	3		
	screw No.8 of ignition base-plate	2	5	
33	cylinder head	1		
34	cylinder	1		
35	cylinder base gasket	1		
Crankshaft				
36	piston	1		
37	piston ring	2		
38	gudgeon pin	1		
39	circlip for gudgeon pin No.38	2		
40	bush for gudgeon pin No.38	1		
41	crankshaft with connecting rod	1		
42	ball-bearing for outer ends of crankshaft	2		
43	rotary induction valve	1		
44	star spring against rotary induc- tion valve No.43	1		
45	ball-bearing (centre) for crank- shaft No.41	1		
46	circlip for ball-bearing No.45	1		
47	oil seal for ball-bearing No.45	1		
48	distance piece	1		
49	distance washer	1		
50	protective cover	2		
51	driving roller	1		
52	lock-nut (27 mm spanner)	1		
53	lock-nut (19 mm spanner)	1		
54	oil seal for ball bearing No.42	1		
55	circlip for ball-bearing No.42	1		
56	contactbreaker cam for ignition	1		
57	circlip for contactbreaker No.56	1		
58	key for flywheel No.59	1		
59	flywheel	1		
60	spring washer for flywheel nut No.61	1		
61	flywheel nut	1		

CARBURETTOR

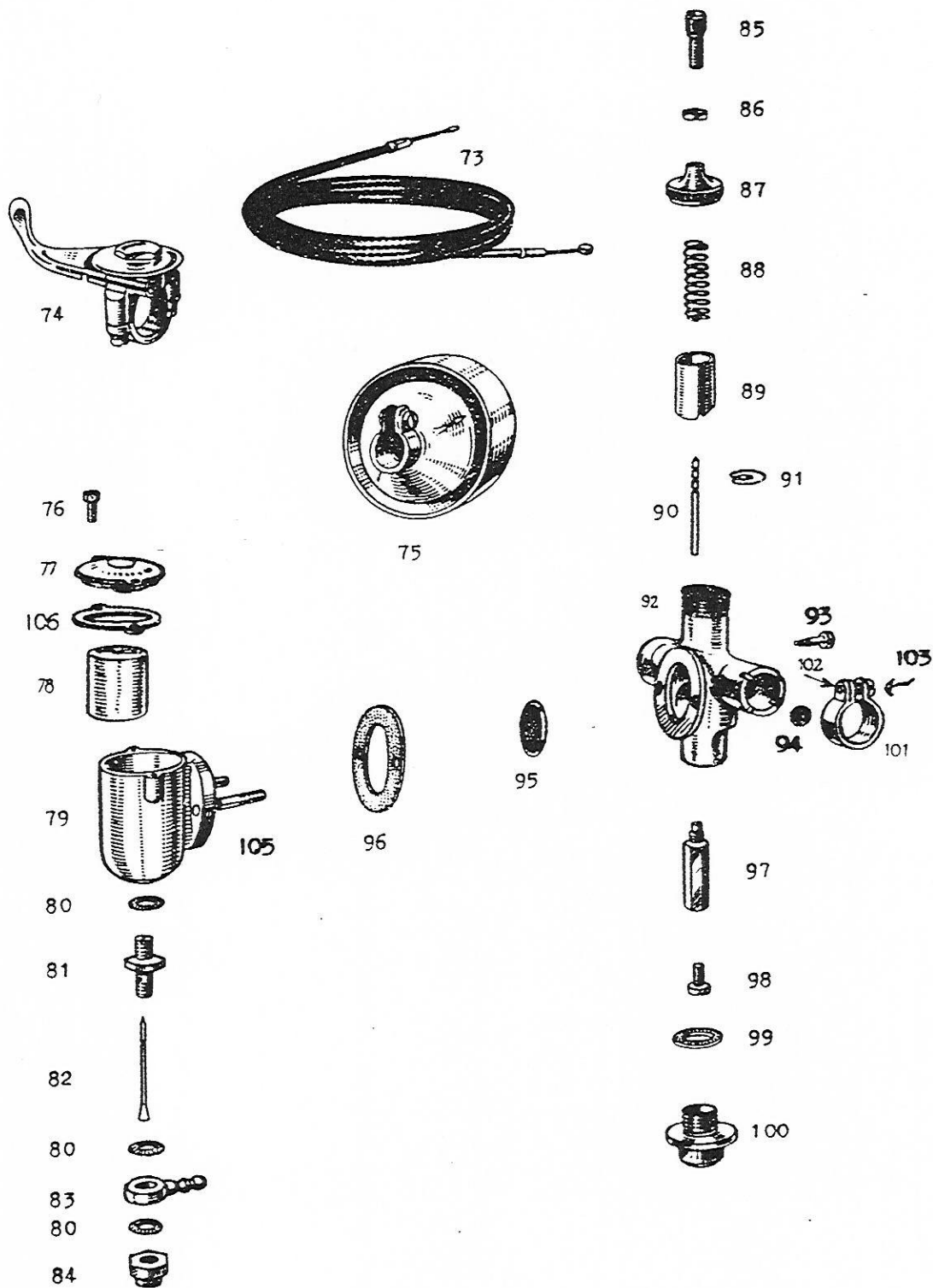

CARBURETTOR

3

Spare Part Number	Description of spare part (type M.13)	Quantity	Total	Remarks
71	Innercable with 2 nipples for Bowdencable No.73	1		
72	Carburettor complete	1		
73	Bowden cable complete	1		
74	throttle handle complete	1		
75	air filter complete	1		
76	screw for float-chamber cover No.77	2		
77	float-chamber cover	1		
78	float	1		
79	float-chamber	1		
80	fibre-ring for float-chamber No.79	3		
81	seat of float needle	1		
82	float needle	1		
83	banjo piece for petrol pipe No.143	1		
84	plug-nut for float-chamber No.79	1		
85	adjuster screw for Bowden cable No.73	1		
86	lock-nut for adjuster screw No.85	1		
87	screw-cap for mixing chamber No.92	1		
88	Coil spring for throttle valve No.89	1		
89	throttle valve (No.4)	1		
90	throttle needle	1		
91	clamping spring for throttle needle No.90	1		
92	mixing chamber	1		
93	guide screw for throttle valve No.89	1		
94	nut for studs in float chamber No.79	2		
95	petrol strainer between mixing chamber No.92 and float chamber No.79	1		
96	gasket between mixing chamber No.92 and float chamber No.79	1		
97	needle jet (.0745" diam)	1		
98	main jet (No.32)	1		
99	fibre ring for plug nut No.100	1		
100	plug-nut for mixing chamber No.92	1		
101	clamp for carb. No.92	1		
102	nut for clamping bolt No.103	1		
103	bolt for clamp No.101	1		
104	clamp complete	1		
105	Holding stud for floatch. 79	2		
106	Gasket for floatch. cover 77	1		

IGNITION

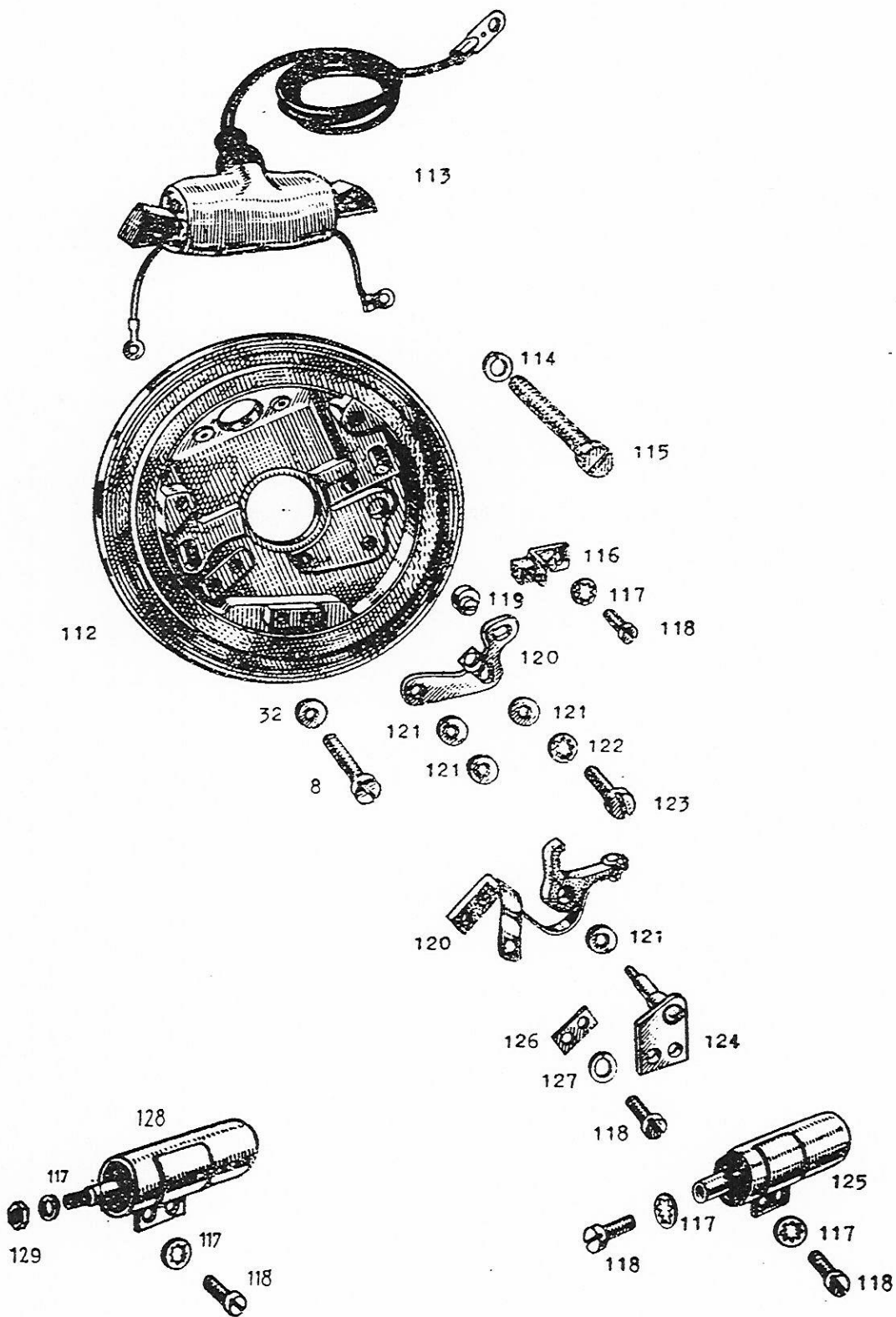

IGNITION

4

Spare Part Number	Description of spare part (type M. 13)	Quantity	Total	Remarks
8	screw for: ignition base-plate No.112			
	crankcase cover No.3	2		
32	plain washer for: screw No.8 of ignition baseplate	3	5	
	nut No.30 of cylinder head	2		
109	Ignition base-plate with coil and plug lead	3	5	
110	ignition complete with flywheel, cover and spring	1		
111	ignition complete	1		
112	ignition base-plate	1		
113	ignition coil with spark-plug lead	1		
114	spring-washer for screw No.115	2		
115	screw for ignition coil No.113	2		
116	felt holder with felt	1		
117	star washer for: screw No.118 of felt-holder - No.116	1		
	screw No.118 of condensor No.125	3	4	
118	screw for: felt holder No.116	1		
	condensor No.125	1		
	fibre block for contact breaker- hammer No.120	2	4	
119	excentric adjusting screw for breaker points gap	1		Omitted from eng.no.13101
120	set of contact breaker points	1		
121	plain washer for: screw No.123 of adjustable breaker point	1		
	breaker-hammer No.120 (two below and one above)	3	4	
122	star washer for screw No.123	1		
123	screw for adjustable breaker point	1		
124	spindle for breaker-hammer	1		
125	condenser	1		
126	small metal plate for fibre block of breaker-hammer No.120	1		
127	spring washer for plate No.126	2		
128	condenser	1		
129	nut for condenser No.128	1		

TANK, MUDGUARD AND EXHAUST

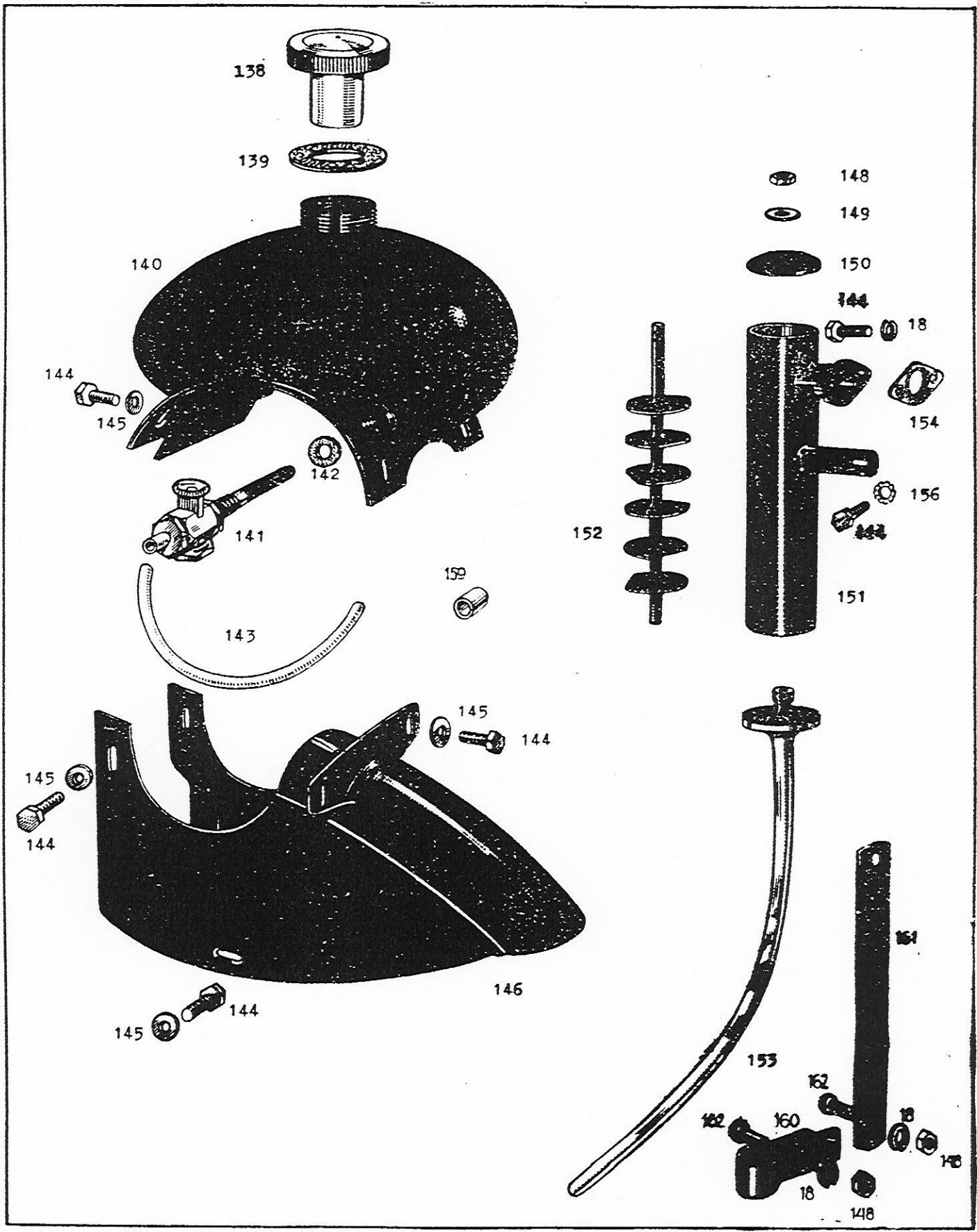

TANK, MUDGUARD AND EXHAUST

5

Spare Part Number	Description of spare part (type M.13)	Quantity	Total	Remarks
138	petrol tank cap with sealing ring complete	1		
139	sealing ring in petrol tank cap No.138	1		
140	petrol tank	1		
141	petrol tap with strainer	1		
142	fibre ring for petrol tap No.141	1		
143	petrol pipe	1		
144	bolt for: tank No.140 and mudguard No.146 together	4		
	mudguard No.146	3		
	silencer No.151	3		
	adjustable catch No.176	1	11	
145	plain washer for: bolt No.144	7		
146	mudguard	1	8	
18	spring-washer for: bolt No.144 of exhaust flange	2		
	screw No.17	2		
	bolt No.205	3		
	screw No.162	2	9	
147	exhaust complete	1		
148	nut for: cover No.150	2		
	press-bolt No.204	2		
	bolt No.205	3		
	screw No.162	2	9	
149	aluminium plain-washer for nut No.148	1		
150	cover for silencer No.151	1		
151	silencer	1		
152	interior of silencer No.151	1		
153	exhaust pipe	1		
154	exhaust gasket	1		
156	star washer for bolt No.144 in cylinder head	1		
157	interior of silencer with pipe complete	1		
158	sealing rings inside petrol tap No.141	2		
159	clamp for petrol pipe	1		
160	clamp for exhaustpipe support	1		
161	bracket for exhaustpipe support	1		
162	screw for clamp No.160	2		
163	support complete	1		

CLUTCH

6

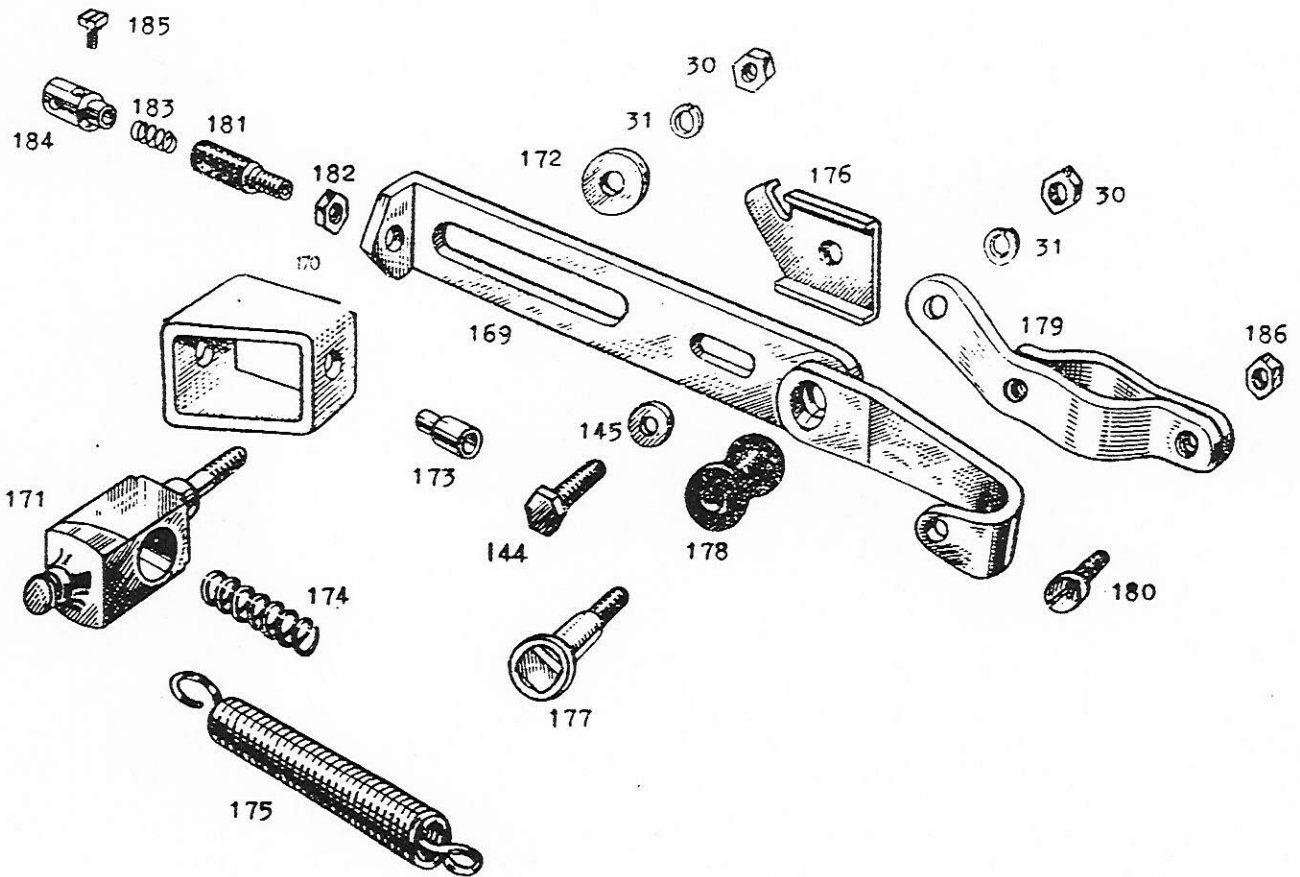
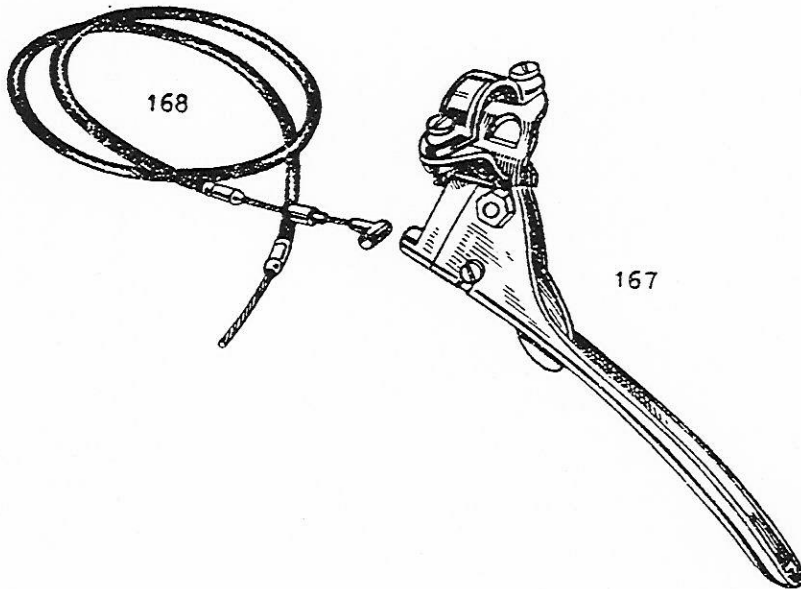

CLUTCH

6

Spare Part Number	Description of spare part (type M.13)	Quantity	Total	Remarks
30	nut for: spring holder No.171 bearing bolt No.177 cylinder head No.33 bolt No.197	1 1 3 1	6	
31	spring-washer for: spring bolt No.171 bearing bolt No.177 nut No.30 of cylinder head	1 1 3	5	
144	bolt for: adjustable catch No.176 silencer No.151 mudguard No.146 tank No.140	1 3 4 3	11	
145	plain washer for: bolt No.144 of adj.catch No.176 bolt No.144	1 7	8	
167	clutch handle complete	1		
168	clutch cable complete	1		
169	clutch guiding bracket	1		
170	slide	1		
171	spring bolt	1		
172	plain washer between clutch guiding bracket and crankcase cover No.3	1		
173	terminal socket for outer cable cable No.168	1		
174	pressure spring between spring bolt No.171 and slide No.170	1		
175	draw-spring	1		
176	adjustable catch	1		
177	swivel bolt	1		
178	rubber bush for swivel bolt No.177	1		
179	front fork clamp complete	1		
180	screw for front fork clamp No.179	2		
181	adjusting screw for clutch cable No.168	1		
182	lock-nut for adjusting screw No.181	1		
183	pressure-spring between end nipple No.184 and adjusting screw No.181	1		
184	end nipple for clutch cable assembly No.168	1		
185	screw in end nipple No.184	2		
186	nut for screw No.180	2		
187	innercable with 2 nipples for Bowden cable No.168	1		

MOTOR ATTACHMENT

7

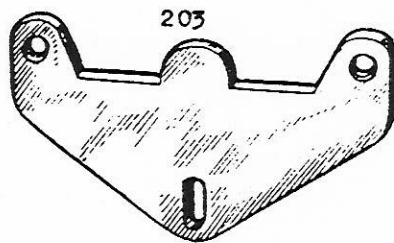
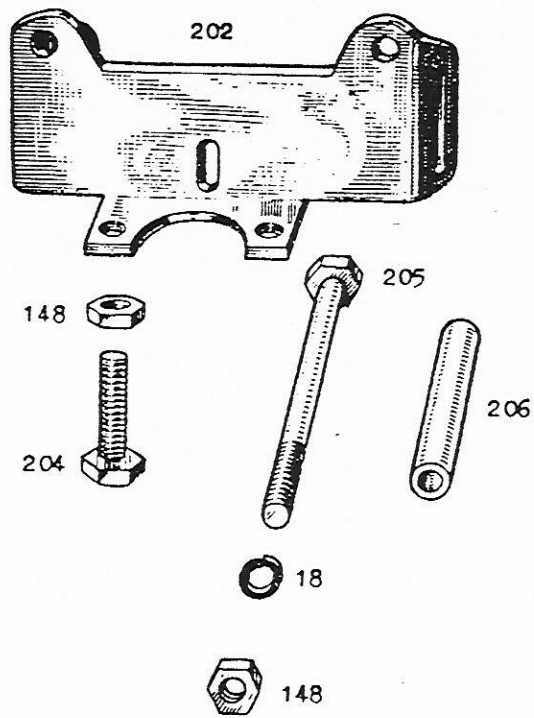
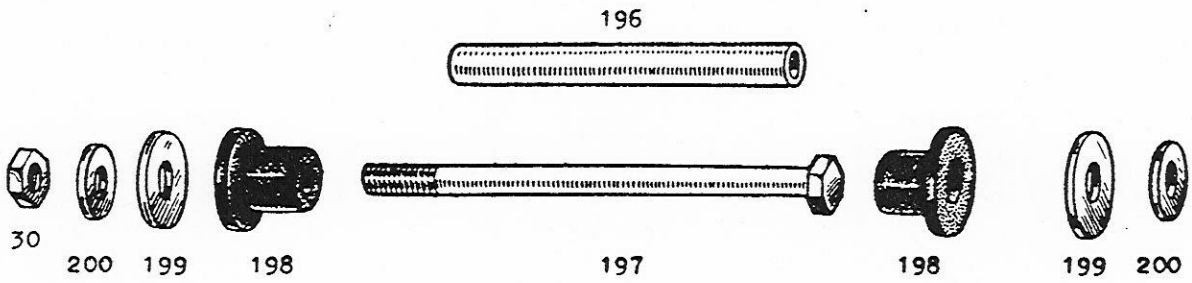

MOTOR ATTACHMENT

7

Spare Part Number	Description of spare part (type M.13)	Quantity	Total	Remarks
18	spring washer for: bolt No.205	3		
	screw No.17	2		
	bolt No.144 of exhaust flange	2		
	screw No.162 for exhaust clamp	2	9	
30	nut for: bolt No.197	1		
	cylinderhead No.33	3		
	spring bolt No.171	1		
	swivel bolt No.177	1	6	
148	nut for: pressure bolt No.204	2		
	bolt No.205	3		
	cover No.150	1		
	clamp screw No.162	2	8	
196	distance bush for bolt No.197	1		
197	bolt for front motor attachment plate No.202	1		
198	rubber bush	2		
199	distance ring between rubber bush No.198 and front motor attachment plate No.202	2		
200	plain washer for bolt No.197	2		
202	front motor attachment plate	1		
203	rear motor attachment plate	1		
204	pressure bolt for front motor attachment plate No.202	2		
205	bolt for motor attachment plates No.s 202 and 203	3		
206	distance bush for bolt No.205	2		
207	distance bush OVERSIZE for bolt No.205	2		

