

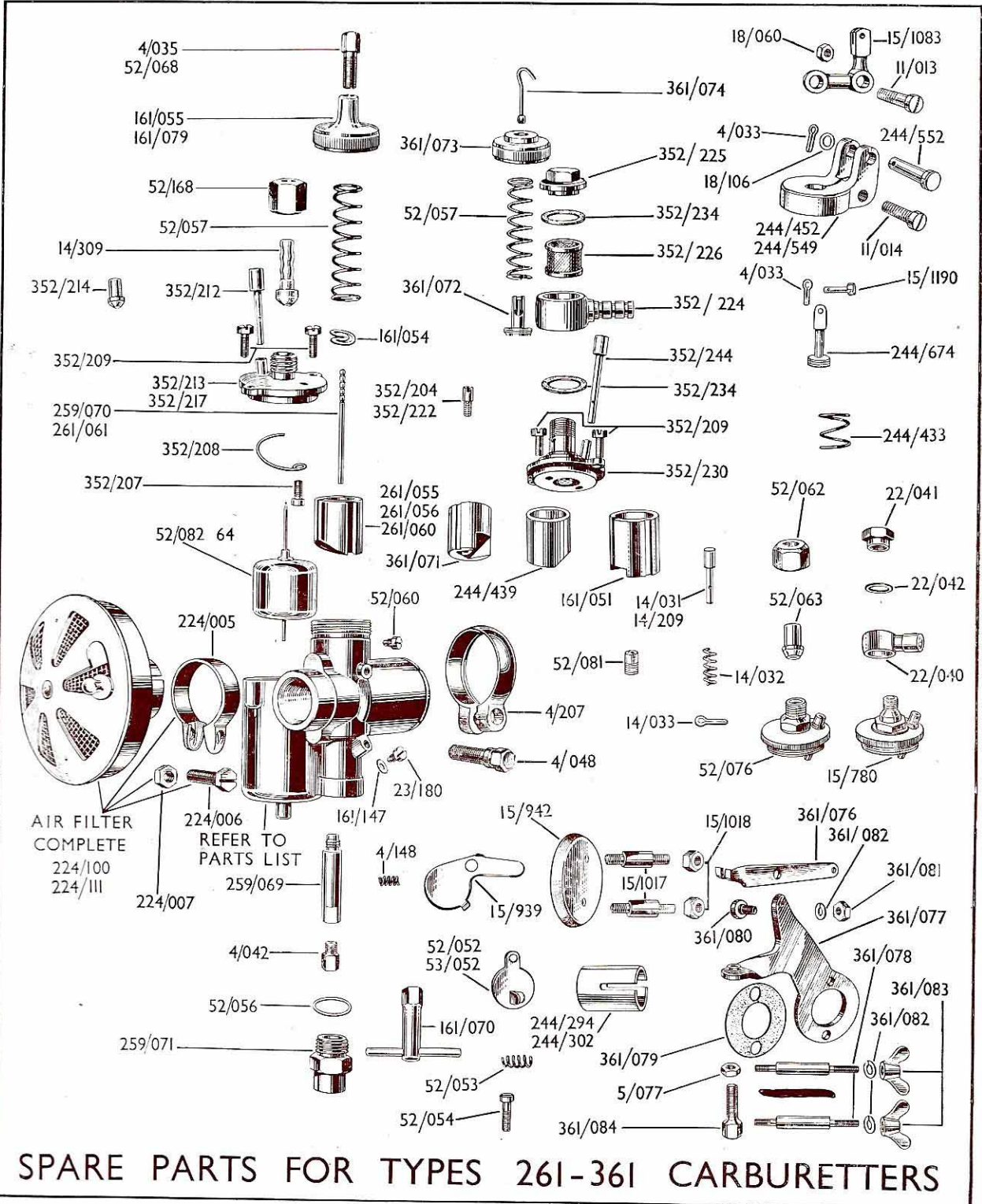

LIST No. 465.

Settings and Spare Parts List for Types 261 and 361 CARBURETTORS



SPARE PARTS FOR TYPES 261-361 CARBURETTORS

AMAL LTD., BIRMINGHAM, England.

Telephone: BIRchfields 4571 (6 lines).

Telegrams: Amalcarb, Birmingham.

Carburetter Type No.	261/001A	261/001D	261/001D	261/001D	261/001D	261/001D		
Specification No.	—	AF1121	A3562	A3512	AF1094	AF1143	AF1149	List
Component								Price
								s. d.
Mixing Chamber Body	261/001	261/001D	261/001D	261/001D	261/001D	261/001D	261/001D	18 9
Mixing Chamber Top	161/055	161/055	161/055	161/055	161/055	161/055	161/055	2 3
Cable Adjuster	52/068	52/068	52/068	52/068	52/068	52/068	4/035	6
Throttle Valve	161/051	161/051	161/051	161/051	161/051	161/051	261/060	3 9
Throttle Valve Spring	52/057	52/057	52/057	52/057	52/057	52/057	52/057	4
Throttle Valve Locating Screw	52/060	52/060	52/060	52/060	52/060	52/060	52/060	2
Throttle Valve Wire Nipple ..	4/036	4/036	4/036	4/036	4/036	4/036	4/036	2
Jet Needle	259/070	259/070	259/070	259/070	259/070	259/070	259/070	2 0
Jet Needle Clip	161/054	161/054	161/054	161/054	161/054	161/054	161/054	2
Needle Jet	259/069	259/069	259/069	259/069	259/069	259/069	259/069	2 6
Main Jet	4/042	4/042	4/042	4/042	4/042	4/042	4/042	8
Jet Key	161/070	161/070	161/070	161/070	161/070	161/070	161/070	1 6
Jet Plug	259/071	259/071	259/071	259/071	259/071	259/071	259/071	1 6
Jet Plug Washer	52/056	52/056	52/056	52/056	52/056	52/056	52/056	2
Outlet Clip	4/207	4/207	4/207	4/207	4/207	4/207	4/207	2 6
Outlet Clip Pin	4/048	4/048	4/048	4/048	4/048	4/048	4/048	6
Outlet Liner	—	244/302	244/302	—	—	—	—	1 0
Strangler Lever	52/052	—	—	—	—	—	—	9
Strangler Lever Screw	52/054	—	—	—	—	—	—	2
Strangler Lever Spring	52/053	—	—	—	—	—	—	2
Air Filter	—	224/100	224/100	224/100	224/100	224/100	224/100	10 0
Float Chamber Cover complete	52/076	52/076	15/780	52/076	52/076	52/076	52/076	3 9
Banjo	—	—	22/040	—	—	—	—	2 3
Banjo Nut	—	—	22/041	—	—	—	—	9
Banjo Washer	—	—	22/042	—	—	—	—	2
Tickler	14/031	14/209	14/209	14/209	14/031	14/209	14/209	10
Tickler Spring	14/032	14/032	14/032	14/032	14/032	14/032	14/032	2
Tickler Cotter	14/033	14/033	14/033	14/033	14/033	14/033	14/033	1
Tickler Bush	—	—	52/081	—	—	—	—	9
Float and Needle	52/082-64	52/082-64	52/082-64	52/082-64	52/082-64	52/082-64	52/082-64	3 9
Petrol Union Nut	52/062	52/062	—	52/062	52/062	52/168	52/168	9
Petrol Union Nipple	52/063	52/063	—	52/063	52/063	14/309	14/309	5
Plug Screw	23/180	23/180	23/180	23/180	23/180	23/180	23/180	2
Plug Screw Washer	116/147	116/147	116/147	116/147	116/147	116/147	116/147	1

Carburetter Type No.	261/001D	261/001E	261/020D	261/020E	261/021D	261/021E	List Price
Specification No.	A3517	—	—	—	A3561	—	
Component							
Mixing Chamber Body	261/001D	261/001E	261/020D	261/020E	261/021D	261/021E	s. d. 18 9
Mixing Chamber Top	161/055	161/079	161/055	161/055	161/055	161/055	2 3
Cable Adjuster	52/068	52/068	52/068	52/068	52/068	52/068	6
Throttle Valve	261/055	161/051	261/056	261/056	161/051	161/051	3 9
Throttle Valve Spring	52/057	52/057	52/057	52/057	52/057	52/057	4
Throttle Valve Locating Screw	52/060	52/060	52/060	52/060	52/060	52/060	2
Throttle Valve Wire Nipple ..	4/036	4/036	4/036	4/036	4/036	4/036	2
Jet Needle	259/070	259/070	259/070	259/070	259/070	259/070	2 0
Jet Needle Clip	161/054	161/054	161/054	161/054	161/054	161/054	2
Needle Jet	259/069	259/069	259/069	259/069	259/069	259/069	2 6
Main Jet	4/042	4/024	4/042	4/042	4/042	4/042	8
Jet Key	161/070	161/070	161/070	161/070	161/070	161/070	1 6
Jet Plug	259/071	259/071	259/071	259/071	259/071	259/071	1 6
Jet Plug Washer	52/056	52/056	52/056	52/056	52/056	52/056	2
Outlet Clip	4/207	4/207	4/207	4/207	4/207	4/207	2 6
Outlet Clip Pin	4/048	4/048	4/048	4/048	4/048	4/048	6
Strangler Cowl	—	15/942	—	15/942	—	15/942	1 2
Strangler Plate	—	15/939	—	15/939	—	15/939	1 6
Strangler Spring	—	4/148	—	4/148	—	4/148	3
Strangler Cowl Studs	—	15/1017	—	15/1017	—	15/1017	4
Strangler Cowl Nuts	—	15/1018	—	15/1018	—	15/1018	1
Air Filter	224/100	—	224/100	—	224/100	—	10 0
Float Chamber Cover complete	52/076	15/780	52/076	52/076	52/076	52/076	3 9
Banjo	—	22/040	—	—	—	—	2 3
Banjo Nut	—	22/041	—	—	—	—	9
Banjo Washer	—	22/042	—	—	—	—	2
Tickler	14/209	14/031	14/209	14 209	14/031	14/031	10
Tickler Spring	14/032	14/032	14/032	14 032	14/032	14/032	2
Tickler Cotter	14/033	14/033	14/033	14 033	14/033	14/033	1
Tickler Bush	—	52/081	—	—	—	—	9
Float and Needle	52/082-64	52/082-64	52/082-64	52 082-64	52/082-64	52/082-64	3 9
Petrol Union Nut	52/062	—	52/062	52 062	52/062	52/062	9
Petrol Union Nipple	52/063	—	52/063	52 063	52/063	52/063	5
Plug Screw	23/180	23/180	23/180	23 180	23/180	23/180	2
Plug Screw Washer	116/147	116/147	116/147	116/147	116/147	116/147	1

Carburettor Type No.	261/032D	261/032D	261/050	261/052	261/054D	List Price
Specification No.	A3545	AF1095	AF1100	—	A3526	
Component						
Mixing Chamber Body	261/032D	261/032D	261/050	261/052	261/054D	s. d. 18 9
Mixing Chamber Top	161/055	161/055	161/055	161/055	—	2 3
Cable Adjuster	52/068	52/068	52/068	52/068	—	6
Throttle Valve	161/051	161/051	161/051	161/051	—	3 9
Throttle Valve Spring	52/057	52/057	52/057	52/057	244/433	4
Throttle Valve Locating Screw	52/060	52/060	52/060	52/060	52/060	2
Throttle Valve Wire Nipple	4/036	4/036	4/036	4/036	—	2
Throttle Valve	—	—	—	—	244/439	3 9
Plunger and Link	—	—	—	—	244/674	1 6
Plunger and Link Swivel	—	—	—	—	15/1190	2
Plunger and Link Cotter	—	—	—	—	14/033	1
Mixing Chamber Top	—	—	—	—	244/549	2 3
Mixing Chamber Top Screw	—	—	—	—	11/014	3
Lever Fulcrum Pin	—	—	—	—	244/552	4
Washer for Fulcrum Pin	—	—	—	—	18/106	1
Jet Needle	259/070	259/070	259/070	259/070	259/070	2 0
Jet Needle Clip	161/054	161/054	161/054	161/054	161/054	2
Needle Jet	259/069	259/069	259/069	259/069	259/069	2 6
Main Jet	4/042	4/042	4/042	4/042	4/042	8
Jet Key	161/070	161/070	161/070	161/070	161/070	1 6
Jet Plug	259/071	259/071	259/071	259/071	259/071	1 6
Jet Plug Washer	52/056	52/056	52/056	52/056	52/056	2
Outlet Clip	4/207	4/207	4/207	4/207	4/207	2 6
Outlet Clip Pin	4/048	4/048	4/048	4/048	4/048	6
Outlet Liner	244/302	244/302	244/302	244/294	—	1 0
Air Filter	224/100	224/100	224/100	224/100	224/100	10 0
Float Chamber Cover complete	52/076	52/076	52/076	52/076	15/780	3 9
Banjo	—	—	—	—	22/040	2 3
Banjo Nut	—	—	—	—	22/041	9
Banjo Washer	—	—	—	—	22/042	2
Tickler	14/031	14/209	14/031	14/031	14/209	10
Tickler Spring	14/032	14/032	14/032	14/032	14/032	2
Tickler Cotter	14/033	14/033	14/033	14/033	14/033	1
Tickler Bush	—	—	—	—	52/081	9
Float and Needle	52/082-64	52/082-64	52/082-64	52/082-64	52/082-64	3 9
Petrol Union Nut	52/062	52/062	52/062	52/062	—	9
Petrol Union Nipple	52/063	52/063	52/063	52/063	—	5
Plug Screw	23/180	23/180	23/180	23/180	23/180	2
Plug Screw Washer	116/147	116/147	116/147	116/147	116/147	1

Carburettor Type No.	361/001D	361/001D	361/001D	361/001D	361/001D	List Price
Specification No.	AF1151	A3512	A3517	A3562	AF1149	
Component						
Mixing Chamber Body	361/001D	361/001D	361/001D	361/001D	361/001D	s. d. 18 9
Mixing Chamber Top	161/055	161/055	161/055	161/055	161/055	2 3
Cable Adjuster	52/068	52/068	52/068	52/068	4/035	6
Throttle Valve	161/051	161/051	261/055	161/051	261/060	3 9
Throttle Valve Spring	52/057	52/057	52/057	52/057	52/057	4
Throttle Valve Locating Screw	52/060	52/060	52/060	52/060	52/060	2
Throttle Valve Wire Nipple ..	4/036	4/036	4/036	4/036	4/036	2
Jet Needle	261/061	259/070	259/070	259/070	259/070	2 0
Jet Needle Clip	161/054	161/054	161/054	161/054	161/054	2
Needle Jet	259/069	259/069	259/069	259/069	259/069	2 6
Main Jet	4/042	4/042	4/042	4/042	4/042	8
Jet Key	161/070	161/070	161/070	161/070	161/070	1 6
Jet Plug	259/071	259/071	259/071	259/071	259/071	1 6
Jet Plug Washer	52/056	52/056	52/056	52/056	52/056	2
Outlet Clip	4/207	4/207	4/207	4/207	4/207	2 6
Outlet Clip Pin	4/048	4/048	4/048	4/048	4/048	6
Outlet Liner	—	—	—	244/302	—	1 0
Air Filter	224/111	224/100	224/100	224/100	224/100	10 0
Float Chamber Cover complete	352/213	352/213	352/213	352/217	352/213	3 9
Cover Screws	352/209	352/209	352/209	352/209	352/209	2
Banjo	—	—	—	22/040	—	2 3
Banjo Nut	—	—	—	22/041	—	9
Banjo Washer	—	—	—	22/042	—	2
Tickler	352/212	352/212	352/212	352/212	352/212	10
Tickler Spring	352/208	352/208	352/208	352/208	352/208	2
Tickler Bush	352/204	352/204	352/204	352/204	352/204	1 0
Float and Needle	52/082-64	52/082-64	52/082-64	52/082-64	52/082-64	3 9
Petrol Union Nut	52/062	52/062	52/062	—	52/062	9
Petrol Union Nipple	352/214	52/063	52/063	—	14/309	5
Plug Screw	23/180	23/180	23/180	23/180	23/180	2
Plug Screw Washer	116/147	116/147	116/147	116/147	116/147	1

Carburetter Type No.	361/020E	361/021D	361/021E	361/032D	361/032D	List Price
Specification No.	—	AF1127	AF1155	AF1095	A3466	
Component						
						s. d.
Mixing Chamber Body	361/020E	361/021D	361/021E	361/032D	361/032D	18 9
Mixing Chamber Top	161/055	161/055	161/055	161/055	161/055	2 3
Cable Adjuster	52/068	52/068	52/068	52/068	52/068	6
Throttle Valve	261/056	161/051	161/051	161/051	161/051	3 9
Throttle Valve Spring	52/057	52/057	52/057	52/057	52/057	4
Throttle Valve Locating Screw	52/060	52/060	52/060	52/060	52/060	2
Throttle Valve Wire Nipple ..	4/036	4/036	4/036	4/036	4/036	2
Jet Needle	259/070	259/070	259/070	259/070	259/070	2 0
Jet Needle Clip	161/054	161/054	161/054	161/054	161/054	2
Needle Jet	259/069	259/069	259/069	259/069	259/069	2 6
Main Jet	4/042	4/042	4/042	4/042	4/042	8
Jet Key	161/070	161/070	161/070	161/070	161/070	1 6
Jet Plug	259/071	259/071	259/071	259/071	259/071	1 6
Jet Plug Washer	52/056	52/056	52/056	52/056	52/056	2
Outlet Clip	4/207	4/207	4/207	4/207	4/207	2 6
Outlet Clip Pin	4/048	4/048	4/048	4/048	4/048	6
Outlet Liner	—	—	—	244/302	—	1 0
Strangler Cowl	15/942	—	15/942	—	—	1 2
Strangler Plate	15/939	—	15/939	—	—	1 6
Strangler Spring	4/148	—	4/148	—	—	3
Strangler Cowl Studs	15/1017	—	15/1017	—	—	4
Strangler Cowl Nuts	15/1018	—	15/1018	—	—	1
Air Filter	—	224/100	—	224/100	224/100	10 0
Float Chamber Cover complete	352/213	352/213	352/213	352/213	352/217	3 9
Cover Screws	352/209	352/209	352/209	352/209	352/209	2
Banjo	—	—	—	—	22/040	2 3
Banjo Nut	—	—	—	—	22/041	9
Banjo Washer	—	—	—	—	22/042	2
Tickler	352/212	352/212	352/212	352/212	352/212	10
Tickler Spring	352/208	352/208	352/208	352/208	352/208	2
Tickler Bush	352/204	352/204	352/204	352/204	352/204	1 0
Float and Needle	52/082-64	52/082-64	52/082-64	52/082-64	52/082-64	3 9
Petrol Union Nut	52/062	52/062	52/062	52/062	—	9
Petrol Union Nipple	52/063	52/063	52/063	52/063	—	5
Plug Screw	23/180	23/180	23/180	23/180	23/180	2
Plug Screw Washer	116/147	116/147	116/147	116/147	116/147	1

Carburetter Type No.	361/050	361/053D	361/054D	361/1—361/2	361/200	List Price s. d.
Specification No.	AF1100	AF1132	A3526	—	A3606	
Component						
Mixing Chamber Body	361/050	361/053D	361/054D	361/085D	361/070	18 9
Mixing Chamber Top	161/055	—	—	161/055	—	2 3
Cable Adjuster	52/068	—	—	52/068	—	6
Throttle Valve	161/051	—	—	161/051	—	3 9
Throttle Valve Spring	52/057	244/433	244/433	52/057	52/057	4
Throttle Valve Locating Screw	52/060	52/060	52/060	52/060	52/060	2
Throttle Valve Wire Nipple ..	4/036	—	—	4/036	—	2
Throttle Valve	—	244/439	244/439	—	361/071	3 9
Plunger and Link	—	244/674	244/674	—	361/072	1 6
Plunger and Link Rod	—	—	—	—	361/074	6
Plunger and Link Swivel	—	15/1190	15/1190	—	—	2
Plunger and Link Cotter	—	14/033	14/033	—	—	1
Mixing Chamber Top	—	244/452	244/549	—	361/073	2 3
Mixing Chamber Top Screw	—	—	11/014	—	—	3
Lever	—	15/1083	—	—	—	3 0
Lever Fulcrum Pin	—	11/013	244/552	—	—	4
Nut for Fulcrum Pin	—	18/060	—	—	—	3
Washer for Fulcrum Pin	—	—	18/106	—	—	1
Jet Needle	259/070	259/070	259/070	259/070	259/070	2 0
Jet Needle Clip	161/054	161/054	161/054	161/054	161/054	2
Needle Jet	259/069	259/069	259/069	259/069	259/069	2 6
Main Jet	4/042	4/042	4/042	4/042	4/042	8
Jet Key	161/070	161/070	161/070	161/070	161/070	1 6
Jet Plug	259/071	259/071	259/071	259/071	259/071	1 6
Jet Plug Washer	52/056	52/056	52/056	52/056	52/056	2
Outlet Clip	4/207	4/207	4/207	4/207	4/207	2 6
Outlet Clip Pin	4/048	4/048	4/048	4/048	4/048	6
Air Filter	224/100	224/100	224/100	224/100	—	10 0
Strangler Lever	—	—	—	—	361/076	1 6
Strangler Bracket	—	—	—	—	361/077	2 6
Strangler Washer for Bracket	—	—	—	—	361/079	2
Strangler Pivot	—	—	—	—	361/080	4
Strangler Wing Nut	—	—	—	—	361/083	6
Strangler Studs	—	—	—	—	361/078	6
Strangler Nuts	—	—	—	—	361/081	2
Strangler Washer	—	—	—	—	361/082	1
Strangler Adjusting Screw	—	—	—	—	361/084	6
Strangler Locknut	—	—	—	—	5/077	2
Float Chamber Cover complete	352/213	352/213	352/217	352/213	352/230	3 9
Cover Screws	352/209	352/209	352/209	352/209	352/209	2
Banjo	—	—	22/040	—	352/224	2 3
Banjo Nut	—	—	22/041	—	352/225	9
Banjo Washer	—	—	22/042	—	352/234	2
Banjo Filter	—	—	—	—	352/226	1 0
Tickler	352/212	352/212	352/212	352/212	352/244	10
Tickler Spring	352/208	352/208	352/208	352/208	352/208	2
Tickler Bush	352/204	352/204	352/204	352/204	352/222	1 0
Float and Needle	52/082-64	52/082-64	52/082-64	52/082-64	52/082-64	3 9
Petrol Union Nut	52/062	52/062	—	52/062	—	9
Petrol Union Nipple	52/063	52/063	—	52/063	—	5
Pug Screw	23/180	23/180	23/180	23/180	23/180	2
Pug Screw Washer	116/147	116/147	116/147	116/147	116/147	1

For overhead lever control

ENGINE	Specific'n No.	Carb. Type No.	Internal Bore	Jet Size	Throttle Valve	Needle Position	Needle Jet
B.S.A., 125cc.	A3512	261 001D	51.5"	110	5	2	-106
125cc.	A3512	361 001D	51.5"	110	5	2	-106
125cc.	361 1	361 1	51.5"	110	5	2	-106
125cc., Competition ..	361 2	361 2	51.5"	110	5	2	-106
DOUGLAS. "Vespar," 125cc.	A3606	361 200	51.5"	80	3	3	-105
DOT. 200cc.	A3561	261 021D	51.5"	65	3	3	-107
EXCELSIOR. 125cc. ..	A3562	261 001D	51.5"	75	3	3	-107
PARKINSON. 123cc. ..	A3517	261 001D	51.5"	60	3	2	-107
123cc.	A3517	361 001D	51.5"	85	3	3	-107
PUGH (ATCO). 147cc. Mower	A3466	161 032C	53		3	3	-1075
(ATCO). 147cc. Mower	A3466	261 032D	53	60	3	3	-1075
ROYAL ENFIELD. 98cc. Mower	A3545	261 032D	53.1	60	4	3	-1065
SPRYT (Brockhouse). 125cc.	A3526	261 054D	51.5"	65	3	3	-109
(Brockhouse). 125cc. ..	A3526	361 054D	51.5"	65	3	3	-109
BELSI. 175cc.	AF1155	261 021E	51.5"	70	3	3	-107
DUELL	AF1100	261 050	53.1	55	2	3	-1075
	AF1095	261 032D	53.1	55	2	3	-1075
GRANDJEAN. 125cc., Villiers	AF1121	261 001D	51.5"	65	3	3	-1075
GUDENAAS FABRIKER ..	AF1094	261 001D	51.5"	65	3	3	-1075
HUSQVANA. 120cc. ..	AF1151	261 001D	51.5"	65	3	5	-107
MAISON SAROLEA. 120cc.	AF1149	261 001D	51.5"	90	3	2	-107
120cc.	AF1149	361 001D	51.5"	90	3	2	-107
MOTOS READY. 125cc. ..	AF1127	261 021D	51.5"	70	3	3	-107
NOVA-WERKE. 200cc., S.V.	AF1132	261 053D	52.5"	65	3	3	-1075
POVAZSKE STROJARNE. 100cc.	AF1143	261 001D	51.5"	65	3	3	-107

IceniCAM Information Service

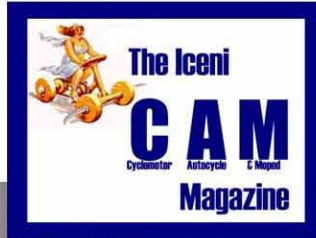

www.icenicam.org.uk