

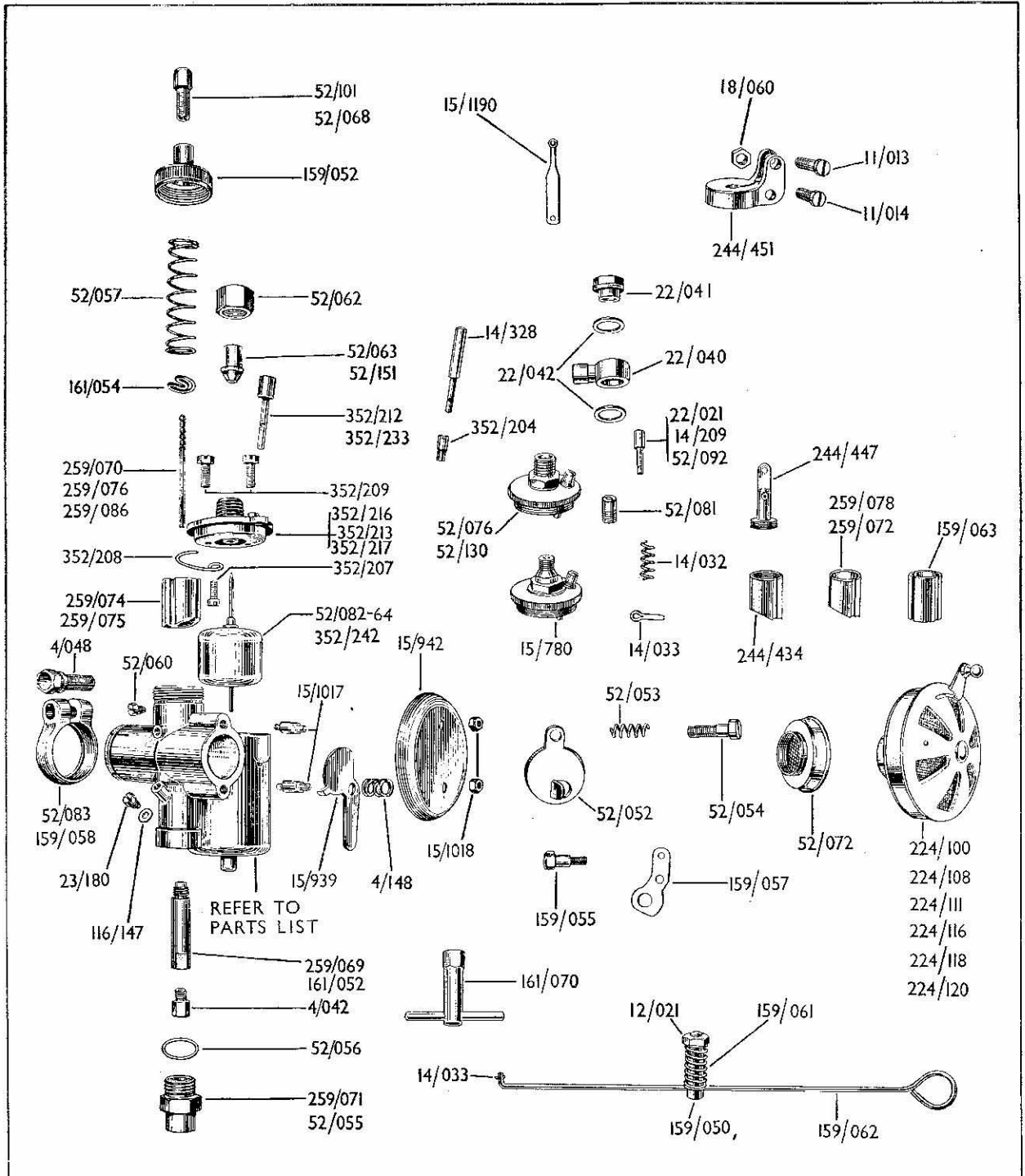

Settings and Spare Parts List

FOR TYPES 159, 259 and 359 CARBURETTORS



SPARE PARTS FOR TYPES 159-259-359 CARBURETTORS

All Prices are subject to alteration without notice.

AMAL LTD., BIRMINGHAM, England.

Telephone: BIRchfields 4571 (5 lines).

Telegrams: Amalcarb, Birmingham.

Carburetter Type No.	259/001B	259/001B	259/001D	259/005A	259/005D	List Price
Specification No.	(A3449) (A3493)	(A3499) (A3476)	Std. (A3587)	(AF1145)	Std.	
Component						
Mixing Chamber Body	259/056	259/056	259/001D	259/005A	259/005D	s. d. 18 9
Mixing Chamber Top	159/052	159/052	159/052	159/052	159/052	2 3
Cable Adjuster	52/068	52/068	52/068	52/068	52/068	6
Throttle Valve	259/072	259/072	259/072	259/074	259/074	3 9
Throttle Valve Spring	52/057	52/057	52/057	52/057	52/057	4
Throttle Valve Locating Screw	52/060	52/060	52/060	52/060	52/060	2
Throttle Valve Wire Nipple ..	4/036	4/036	4/036	4/036	4/036	2
Jet Needle	259/070	259/070	259/070	259/070	259/070	2 0
Jet Needle Clip	161/054	161/054	161/054	161/054	161/054	2
Needle Jet	259/069	259/069	259/069	259/069	259/069	2 6
Main Jet	4/042	4/042	4/042	4/042	4/042	8
Jet Key	161/070	161/070	161/070	161/070	161/070	1 6
Jet Plug	259/071	259/071	259/071	259/071	259/071	1 6
Jet Plug Washer	52/056	52/056	52/056	52/056	52/056	2
Outlet Clip	52/083	52/083	52/083	52/083	52/083	2 0
Outlet Clip Pin	4/048	4/048	4/048	4/048	4/048	6
Strangler Lever	159/057	159/057	—	52/052	—	9
Strangler Lever Screw	159/055	159/055	—	52/054	—	2
Strangler Lever Spring	—	—	—	52/053	—	2
Strangler Rod	—	159/062	—	—	—	9
Strangler Rod Cotter	—	14/033	—	—	—	1
Strangler Rod Spring	—	159/061	—	—	—	3
Frame Clip	—	159/058	—	—	—	9
Frame Clip Pin	—	159/059	—	—	—	3
Frame Clip Nut	—	12/021	—	—	—	2
Gauze Intake	52/072	52/072	—	—	—	2 3
Air Filter complete	—	—	224/108	—	—	10 0
Float Chamber Cover	15/780	52/076	52/076	52/076	52/076	3 9
Banjo	22/040	—	—	—	—	2 3
Banjo Nut	22/041	—	—	—	—	9
Banjo Washer	22/042	—	—	—	—	2
Tickler	14/209	14/209	14/209	14/209	14/209	10
Tickler Spring	14/032	14/032	14/032	14/032	14/032	2
Tickler Cotter	14/033	14/033	14/033	14/033	14/033	1
Tickler Bush	52/081	—	—	—	—	9
Float and Needle	52/082-64	52/082 64	52/082 64	52/082-64	52/082-64	3 9
Petrol Union Nut	—	52/062	52/062	52/062	52/062	9
Petrol Union Nipple	—	52/063	52/063	52/063	52/063	5
Plug Screw	23/180	23/180	23/180	23/180	23/180	2
Plug Screw Washer	116/147	116/147	116/147	116/147	116/147	1

Carburetter Type No.	259/021D	159/001B 159/021A	259/021D	259/025	259/025D	List Price
Specification No.	(AF1128)	AF1069	Std. (AF1093) (A3548)	AF1101	AF1146	
Component						
Mixing Chamber Body	259/077	159/021A	259/021D	259/025	259/025D	s. d. 18 9
Mixing Chamber Top	159/052	159/052	159/052	159/052	159/052	2 3
Cable Adjuster	52/068	52/068	52/068	52/101	52/101	6
Throttle Valve	259/078	159/063	259/078	259/075	259/075	3 9
Throttle Valve Spring	52/057	52/057	52/057	52/057	52/057	4
Throttle Valve Locating Screw	52/060	52/060	52/060	52/060	52/060	2
Throttle Valve Wire Nipple ..	4/036	4/036	4/036	4/036	4/036	2
Jet Needle	—	—	259/076 (for Spec. A3548)	—	—	2 0
Jet Needle	259/076	159/053	259/070	259/070	259/070	2 0
Jet Needle Clip	161/054	161/054	161/054	161/054	161/054	2
Needle Jet	259/069	161/052	259/069	259/069	259/069	2 6
Main Jet	4/042	—	4/042	4/042	4/042	8
Jet Key	161/070	161/070	161/070	161/070	161/070	1 6
Jet Plug	259/071	52/055	259/071	259/071	259/071	1 6
Jet Plug Washer	52/056	52/056	52/056	52/056	52/056	2
Outlet Clip	52/083	52/083	52/083	52/083	52/083	2 0
Outlet Clip Pin	4/048	4/048	4/048	4/048	4/048	6
Strangler Lever	—	52/052	—	—	—	9
Strangler Lever Screw	—	52/054	—	—	—	2
Strangler Lever Spring	—	52/053	—	—	—	2
Strangler Cowl	—	—	—	15/942	—	1 2
Strangler Plate	—	—	—	15/939	—	1 6
Strangler Spring	—	—	—	4/148	—	3
Studs for Cowl	—	—	—	15/1017	—	4
Nuts for Cowl	—	—	—	15/1018	—	1
Strangler Rod	—	159/062	—	—	—	9
Strangler Rod Cotter	—	14/033	—	—	—	1
Strangler Rod Spring	—	159/061	—	—	—	3
Frame Clip	—	159/058	—	—	—	9
Frame Clip Pin	—	159/059	—	—	—	3
Frame Clip Nut	—	12/021	—	—	—	2
Gauze Intake	—	52/072	—	—	—	2 3
Air Filter complete	224/111	—	224/100	—	224/118	10 0
Float Chamber Cover	52/076	52/150	52/076	52/076	52/076	3 9
Tickler	14/209	52/092	14/209	14/209	14/209	10
Tickler Spring	14/032	14/032	14/032	14/032	14/032	2
Tickler Cotter	14/033	14/033	14/033	14/033	14/033	1
Float and Needle	52/082-64	52/082-64	52/082-64	52/082-64	52/082-64	3 9
Petrol Union Nut	52/062	52/062	52/062	52/062	52/062	9
Petrol Union Nipple	52/151	52/063	52/063	52/063	52/063	5
Plug Screw	23/180	23/180	23/180	23/180	23/180	2
Plug Screw Washer	116/147	116/147	116/147	116/147	116/147	1

Carburetter Type No.	259/077	259/082	259/087E	259/088	
Specification No.	AF1107	A3507	A3572	A3577	List
Component					Price
					s. d.
Mixing Chamber Body	259/077	259/082	259/087E	259/088	18 9
Mixing Chamber Top	159/052	—	159/052	159/052	2 3
Cable Adjuster	52/068	—	52/101	52/068	6
Throttle Valve	259/078	—	259/072	259/072	3 9
Throttle Valve Spring	52/057	244/433	52/057	52/057	4
Throttle Valve Locating Screw	52/060	52/060	52/060	52/060	2
Throttle Valve Wire Nipple	4/036	—	4/036	4/036	2
Throttle Valve	—	244/434	—	—	3 9
Plunger and Link	—	244/447	—	—	1 6
Plunger Link Swivel	—	15/1190	—	—	2
Plunger Link Cotter	—	14/033	—	—	1
Mixing Chamber Top	—	244/451	—	—	2 3
Mixing Chamber Top Screw	—	11/014	—	—	3
Lever Fulcrum Pin	—	11/013	—	—	3
Nut for Lever Fulcrum Pin	—	18/060	—	—	3
Jet Needle	259/076	259/070	259/086	259/086	2 0
Jet Needle Clip	161/054	161/054	161/054	161/054	2
Needle Jet	259/069	259/069	259/069	259/069	2 6
Main Jet	4/042	4/042	4/042	4/042	8
Jet Key	161/070	161/070	161/070	161/070	1 6
Jet Plug	259/071	259/071	259/071	259/071	1 6
Jet Plug Washer	52/056	52/056	52/056	52/056	2
Outlet Clip	52/083	52/083	52/083	52/083	2 0
Outlet Clip Pin	4/048	4/048	4/048	4/048	6
Strangler Cowl	—	—	15/942	15/942	1 2
Strangler Plate	—	—	15/939	15/939	1 6
Strangler Spring	—	—	4/148	4/148	3
Studs for Cowl	—	—	15/1017	15/1017	4
Nuts for Cowl	—	—	15/1018	15/1018	1
Air Filter complete	224/100	224/116	—	—	10 0
Float Chamber Cover	52/076	15/780	15/780	52/167	3 9
Banjo	—	22/040	22/040	—	2 3
Banjo Nut	—	22/041	22/041	—	9
Banjo Washer	—	22/042	22/042	—	2
Tickler	14/209	14/328	14/209	14/209	10
Tickler Spring	14/032	14/032	14/032	14/032	2
Tickler Cotter	14/033	14/033	14/033	14/033	1
Tickler Bush	—	52/081	52/081	—	9
Float and Needle	52/082-64	52/082-64	52/082-64	52/082-64	3 9
Petrol Union Nut	52/062	—	52/062	—	9
Petrol Union Nipple	52/063	—	52/063	—	5
Plug Screw	23/180	23/180	23/180	23/180	2
Plug Screw Washer	116/147	116/147	116/147	116/147	1

Carburetter Type No.	359/001B	359/001B	359/001B	359/011D	List Price
Specification No. Component	A3476	A3578	A3449	Std.	
Mixing Chamber Body	359/056	359/001B	359/056	359/011D	s. d. 18 9
Mixing Chamber Top	159/052	159/052	159/052	159/052	2 3
Cable Adjuster	52/068	52/068	52/068	52/068	6
Throttle Valve	259/072	259/072	257/072	259/078	3 9
Throttle Valve Spring	52/057	52/057	52/057	52/057	4
Throttle Valve Locating Screw	52/060	52/060	52/060	52/060	2
Throttle Valve Wire Nipple ..	4/036	4/036	4/036	4/036	2
Jet Needle	259/070	259/076	259/070	259/076	2 0
Jet Needle Clip	161/054	161/054	161/054	161/054	2
Needle Jet	259/069	259/069	259/069	259/069	2 6
Main Jet	4/042	4/042	4/042	4/042	8
Jet Key	161/070	161/070	161/070	161/070	1 6
Jet Plug	259/071	259/071	259/071	259/071	1 6
Jet Plug Washer	52/056	52/056	52/056	52/056	2
Outlet Clip	52/083	52/083	52/083	52/083	2 0
Outlet Clip Pin	4/048	4/048	4/048	4/048	6
Strangler Lever	159/057	159/057	159/057	—	9
Strangler Lever Screw	159/055	159/055	159/055	—	2
Gauze Intake	52/072	52/072	52/072	—	2 3
Float Chamber Cover	352/216	352/213	352/217	352/213	3 9
Banjo	—	—	22/040	—	2 3
Banjo Nut	—	—	22/041	—	9
Banjo Washer	—	—	22/042	—	2
Tickler	352/212	352/212	352/212	352/212	10
Tickler Spring	352/208	352/208	352/208	352/208	2
Tickler Screw	352/207	352/207	352/207	352/207	2
Tickler Bush	352/204	352/204	352/204	352/204	1 0
Float and Needle	52/082-64	52/082-64	52/082-64	52/082-64	3 9
Petrol Union Nut	52/062	52/062	—	52/062	9
Petrol Union Nipple	52/063	52/063	—	52/063	5
Plug Screw	23/180	23/180	23/180	23/180	2
Plug Screw Washer	116/147	116/147	116/147	116/147	1
Cover Screws	352/209	352/209	352/209	352/209	2

Carburetter Type No.	359/105E	359/021D	359/021E	359/025E	List Price
Specification No.	AF1154 AF1072	AF1128	Std.	AF1101	
Component					
Mixing Chamber Body	359/015E	359/021D	359/021E	359/025E	s. d. 18 9
Mixing Chamber Top	159/052	159/052	159/052	159/052	2 3
Cable Adjuster	52/101	52/068	52/068	52/101	6
Throttle Valve	259/074	259/078	259/078	259/074	3 9
Throttle Valve Spring	52/057	52/057	52/057	52/057	4
Throttle Valve Locating Screw	52/060	52/060	52/060	52/060	2
Throttle Valve Wire Nipple ..	4/036	4/036	4/036	4/036	2
Jet Needle	259/070	259/076	259/070	259/070	2 0
Jet Needle Clip	161/054	161/054	161/054	161/054	2
Needle Jet	259/069	259/069	259/069	259/069	2 6
Main Jet	4/042	4/042	4/042	4/042	8
Jet Key	161/070	161/070	161/070	161/070	1 6
Jet Plug	259/071	259/071	259/071	259/071	1 6
Jet Plug Washer	52/056	52/056	52/056	52/056	2
Outlet Clip	52/083	52/083	52/083	52/083	2 0
Outlet Clip Pin	4/048	4/048	4/048	4/048	6
Strangler Cowl	15/942	—	15/942	15/942	1 2
Strangler Plate	15/939	—	15/939	15/939	1 6
Strangler Spring	4/148	—	4/148	4/148	3
Strangler Studs for Cowl	15/1017	—	15/1017	15/1017	4
Strangler Nuts for Cowl	15/1018	—	15/1018	15/1018	1
Air Filter complete	—	224/111	—	—	10 0
Float Chamber Cover	352/213	352/213	352/213	352/213	3 9
Tickler	352/212	352/212	352/212	352/212	10
Tickler Spring	352/208	352/208	352/208	352/208	2
Tickler Screw	352/207	352/207	352/207	352/207	2
Tickler Bush	352/204	352/204	352/204	352/204	1 0
Float and Needle	52/082-64	52/082-64	52/082-64	52/082-64	3 9
Petrol Union Nut	52/062	52/062	52/062	52/062	9
Petrol Union Nipple	52/063	52/151	52/063	52/063	5
Plug Screw	23/180	23/180	23/180	23/180	2
Plug Screw Washer	116/147	116/147	116/147	116/147	1
Cover Screws	352/209	352/209	352/209	352/209	2

Carburetter Type No.	359/025D	359/087E	359/091D	359/1 359/2	List Price
Specification No.	AF1146	A3572	A3598 A3605	—	
Component					
Mixing Chamber Body	359/025D	359/087E	359/091D	359/091D	s. d 18 9
Mixing Chamber Top	159/052	159/052	159/052	159/052	2 3
Cable Adjuster	52/101	52/101	52/068	52/068	6
Throttle Valve	259/075	259/072	259/072	259/072	3 9
Throttle Valve Spring	52/057	52/057	52/057	52/057	4
Throttle Valve Locating Screw	52/060	52/060	52/060	25/060	2
Throttle Valve Wire Nipple ..	4/036	4/036	4/036	4/036	2
Jet Needle	259/070	259/086	259/070	259/070	2 0
Jet Needle Clip	161/054	161/054	161/054	161/054	2
Needle Jet	259/069	259/069	259/069	259/069	2 6
Main Jet	4/042	4/042	4/042	4/042	8
Jet Key	161/070	161/070	161/070	161/070	1 6
Jet Plug	259/071	259/071	259/071	159/071	1 6
Jet Plug Washer	52/056	52/056	52/056	52/056	2
Outlet Clip	52/083	52/083	52/083	52/083	2 0
Outlet Clip Pin	4/048	4/048	4/048	4/048	6
Strangler Cowl	—	15/942	—	—	1 2
Strangler Plate	—	15/939	—	—	1 6
Strangler Spring	—	4/148	—	—	3
Strangler Studs for Cowl	—	15/1017	—	—	4
Strangler Nuts for Cowl	—	15/1018	—	—	1
Air Filter complete	224/118	—	224/120	224/120	10 0
Float Chamber Cover	352/213	352/217	352/213	352/245	3 9
Banjo	—	22/040	—	—	2 3
Banjo Nut	—	22/041	—	—	9
Banjo Washer	—	22/042	—	—	2
Tickler	352/212	352/212	352/233	352/233	10
Tickler Spring	352/208	352/208	352/208	352/208	2
Tickler Screw	352/207	352/207	352/207	352/207	2
Tickler Bush	352/204	352/204	352/204	352/204	1 0
Float and Needle	52/082-64	52/082-64	352/242	352/242	3 9
Petrol Union Nut	52/062	—	52/062	52/062	9
Petrol Union Nipple	52/063	—	52/063	52/063	5
Plug Screw	23/180	23/180	23/180	23/180	2
Plug Screw Washer	116/147	116/147	116/147	116/147	1
Cover Screws	352/209	352/209	352/209	352/209	2

ENGINE	Specific'n No.	Carb. Type No.	Internal Bore	Jet Size	Throttle Valve	Needle Position	Needle Jet Size
BROCKHOUSE. 2-stroke, Industrial ..	A3507	259/001B	.425"	60	3	2	.109
BRITISH ANZANI. 60cc., Outboard ..	A3572	259/087E	.471	60	3 Stepped	3	.106
60cc., Outboard ..	A3572	359/087E	.471	60	3 Stepped	3	.106
CORGI. 98cc., 2-stroke	A3493	259/001B	.425	55	3	2	.1075
CYC-AUTO. 78cc., 2-stroke	A3476	259/001B	.425	55	3	3	.1075
EXCELSIOR. 98cc.	A3449	259/001B	.425	55	3	3	.1075
100cc., Minor	A3548	259/021D	.531	70	5	2	.107
G.Y.S. 50cc.	A3577	259/088	$\frac{11}{32}$ "	35	2	2	.107
LEVIS. 80cc., 2-stroke	A3578	259/001B	.425	50	3	3	.106
POWER PAK. 49cc., Power Unit ..	A3598	259/091D	.425	45	5	3	.106
49cc., Power Unit ..	A3605	359/091D	.425	45	5	3	.106
49cc., Power Unit ..	359/1	359/1	.425	45	5	3	.106
49cc., Power Unit ..	359/2	359/2	.425	45	5	3	.106
BELSI. 60cc., Comet	AF1146	359/025	.531	70	2	2	.107
GILLET. 100cc., 2-stroke	AF1072	259/015E	.475	55	3	3	.107
100cc., 2-stroke	AF1154	359/015E	.475	55	3	3	.107
100cc., 2-stroke	AF1145	259/005A	.425	60	2	3	.107
125cc., 2-stroke	AF1101	359/025E	.531	70	2	3	.107
GUDENAS. 128cc., 2-stroke	AF1093	259/021D	.531	50	3	3	.1075
HUSQVARNA. 120cc.	AF1107	259/021D	.531	50	3	3	.1075
120cc.	AF1128	359/021D	.531	55	3	5	.1075

IceniCAM Information Service

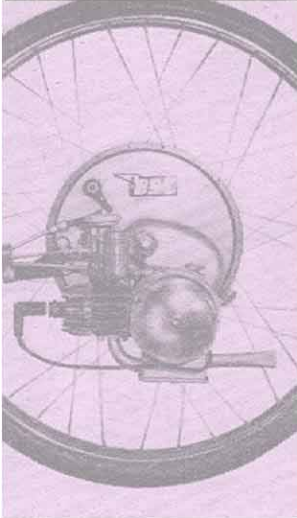

www.icenicam.org.uk