

AMAL

SPARE PARTS LIST FOR R.N. CARBURETTORS

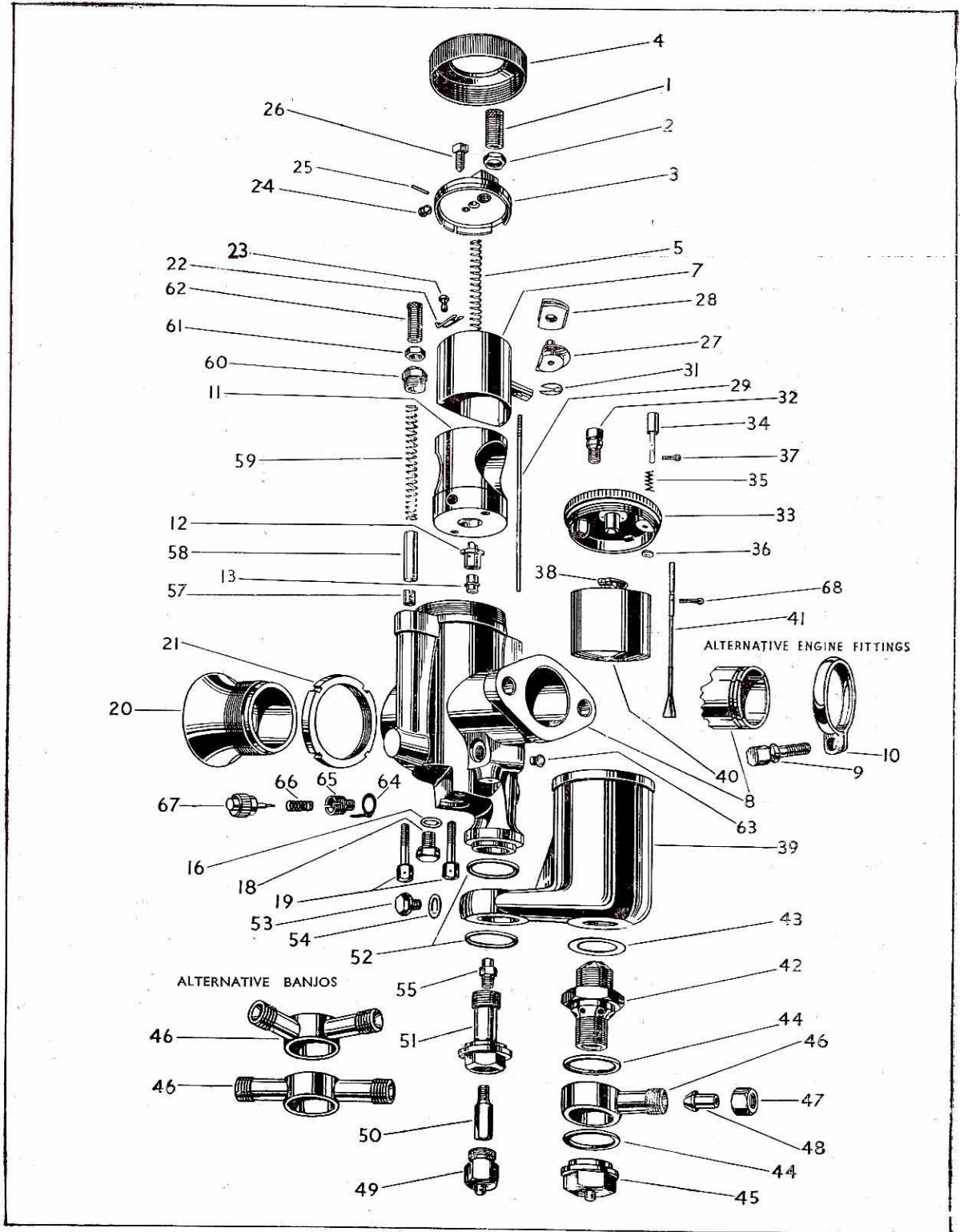



TYPE RN CARBURETTERS (PETROL)
Price List of MIXING CHAMBER PARTS

Illustration Ref. No.	Component	For Type 15 R N Carburetter	Price	For Type 10 R N Carburetter	Price
		Quote engine details		Quote engine details	
3	Mixing Chamber Body	85 0		90 0	
	Mixing Chamber Top	3333	5 0	3334	5 0
4	Mixing Chamber Cap	185/102	5 0	185/108	5 0
62	Air Cable Adjuster	2626	6	2626	6
61	Air Cable Adjuster Locknut	2627	2	2627	2
1	Throttle Cable Adjuster	3360	6	3360	6
2	Throttle Cable Adjuster Locknut	3369	2	3369	2
24	Lock Plunger for Mixing Chamber Top	3366	6	3366	6
26	Adjusting Screw for Mixing Chamber Top	3367	2	3367	2
25	Rivet for Lock Plunger	3368	1	3368	1
11	Choke Adaptor, 1" Bore	185/103	25 0	—	—
	Choke Adaptor, 1 1/16" Bore	185/293	25 0	—	—
	Choke Adaptor, 1 1/8" Bore	—	—	185/107	25 0
	Choke Adaptor, 1 3/32" Bore	—	—	185/294	25 0
	Choke Adaptor, 1 3/16" Bore	—	—	185/295	25 0
50	Main Jet	3326	1 6	3326	1 6
13	Jet Choke Tube	185/113	1 0	185/113	1 0
55	Needle Jet	185/109	2 6	185/109	2 6
29	Jet Needle	185/119	3 0	185/119	3 0
31	Jet Needle Clip	185/150	2	185/150	2
7	Throttle Valve, complete with Needle Carrier. (Please state Cutaway Number)	4606	10 0	134/104	10 0
5	Throttle Valve Spring	2558	4	2558	4
51	Jet Holder	15/625	5 0	15/625	5 0
49	Jet Holder Plug	3348	1 6	3348	1 6
18	Mixing Chamber Base Plug	185/137	1 6	185/137	1 6
16	Mixing Chamber Base Plug Washer	59/027	2	59/027	2
12	Primary Choke	185/110	2 0	185/110	2 0
19	Choke Adaptor Screws	185/138	6	185/138	6
58	Air Valve	2502	1 6	2502	1 6
59	Air Valve Spring	2558	4	2558	4
60	Air Barrel Top	2507	1 0	2507	1 0
6 & 56	Cable Nipple (Air and Throttle)	2629	2	2629	2
57	Air Valve Nipple Holder	2503	2	2503	2
27	Needle Chamber Top Cap	185/106	1 6	185/106	1 6
28	Needle Chamber Top Cap Spring	185/120	9	185/120	9
23	Cable Stop Peg	185/105	3	185/105	3
22	Needle Clip for Cable Stop Peg	185/141	6	185/141	6
67	Pilot Adjuster Needle	2981/2967	2 0	2981/2967	2 0
65	Pilot Adjuster Needle Insert	2966	1 6	2966	1 6
66	Pilot Adjuster Needle Spring	2980	3	2980	3
64	Pilot Adjuster Needle Spring Catch	2982	2	2982	2
20	Air Intake Tube, 1" Bore	175/109	10 0	—	—
	Air Intake Tube, 1 1/16" Bore	175/102	10 0	—	—
	Air Intake Tube, 1 1/8" Bore	—	—	175/108	10 0
	Air Intake Tube, 1 3/32" Bore	—	—	185/121	10 0
	Air Intake Tube, 1 3/16" Bore	—	—	175/101	10 0
21	Air Intake Tube Lock Ring	175/115	4 0	175/119	4 0
52	Washer for Float Chamber	36/006	2	36/006	2
10	Outlet Clip, 1 1/8" Outlet	27/073	2 6	—	—
	Outlet Clip, 1 1/4" Outlet	27/073	2 6	—	—
	Outlet Clip, 1 3/8" Outlet	—	—	27/072	3 0
	Outlet Clip, 1 3/2" Outlet	—	—	27/072	4 0
9	Outlet Clip Pin	1962	9	1962	9



Price List of FLOAT CHAMBER PARTS

Illustration Ref. No.	Component	Type of Float Chamber					Price s. d.
		14/600	14/532	14/533	14/534	14/538	
	Float Ch'b'r comp'te	14/600	—	—	—	—	60 0
	Ditto	—	14/532	14/533	—	14/538	47 6
	Ditto	—	—	—	14/534	—	43 9
3	Fl. Ch'b'r Body only	14/315	—	—	—	—	40 0
39	Ditto	—	14/225R	14/225R	14/225R	14/217R	27 0
	Cover Complete ..	14/138	14/138	14/138	14/138	14/138	3 9
32	Cover Lock Screw ..	14/021	14/021	14/021	14/021	14/021	4 4
34	Tickler ..	14/031	14/031	14/031	14/031	14/031	10 1
35	Tickler Spring ..	14/032	14/032	14/032	14/032	14/032	2 2
37	Tickler Cotter Pin ..	14/033	14/033	14/033	14/033	14/033	1 1
36	Tickler Washer ..	14/189	14/189	14/189	14/189	14/189	1 1
	Float Needle ..	14/024S	—	—	—	—	1 6
41	Float Needle ..	—	14/245	14/245	14/245	14/245	3 9
	Float ..	14/017	—	—	—	—	3 9
40	Float ..	—	14/304	14/304	14/304	14/304	3 9
38	Float Bow Spring ..	14/279	14/279	14/279	14/279	14/279	4 4
68	Float Securing Cotter Pin ..	—	193/084	193/084	193/084	193/084	1 1
42	Needle Valve Seating ..	—	14/253	14/253	14/253	14/253	5 0
43	Needle Valve Seating Washer ..	—	14/252	14/252	14/252	14/252	2 2
55	Body Base Plug Screw ..	—	14/232	14/232	14/232	14/232	6 6
54	Washer for Body Base Plug Screw ..	—	14/241	14/241	14/241	14/241	1 1
46	Banjo (Single) ..	14/035	—	—	—	—	3 0
46	Banjo (Single) ..	—	—	—	14/249	—	3 9
46	Banjo (Twin) 90° ..	—	—	14/250	—	14/250	7 6
46	Banjo (Twin) 180° ..	—	14/251	—	—	—	7 6
44	Washers for Banjo ..	14/037	14/275	14/275	14/275	14/275	2 2
	Banjo Nut ..	14/036	—	—	—	—	9 9
45	Banjo Nut ..	—	14/255	14/255	14/255	14/255	1 6
	Flex. Pipe Connection for Mix. Ch'b'r	—	—	—	—	14/218	1 6
	Flex. Pipe Connection for Fl. Ch'b'r	—	—	—	—	14/219	3 9
	Washer for Float Ch'b'r Connection ..	—	—	—	—	120/036	2 2
47	Petrol Union Nut ..	14/042	14/042	14/042	14/042	14/042	9 9
48	Petrol Union Nipple ..	14/041	14/041	14/041	14/041	14/041	5 5

All prices are subject to alteration without notice.

AMAL LTD., Birmingham, England.

Telephone: BIRchfields 4571 (5 lines).

Telegrams: Amalcarb, Birmingham.

IceniCAM Information Service



www.icenicam.org.uk